



Search the Directory

Search

# Mattie Parker

Last modified on: 05-05-2025 15:26:39

[↩ Back to Fort Worth \(/online/city/detail.php?id=500\)](/online/city/detail.php?id=500)

## Mayor

(Fort Worth (/online/city/detail.php?id=500))

Entered Office: 06-16-2023

Term Ends: 05-2027

---

## General Information

Download vCard (/online/vcard/?id=67748&office=5747) (? (/online/aboutvcards/))



✚ [Add to Favorites \(/online/add\\_favorite/?name=Mattie Parker\)](/online/add_favorite/?name=Mattie Parker)

---

## Personal Information

Mayor Parker is the youngest mayor of a top-25 U.S. City.

She graduated from the University of Texas at Austin with a Bachelor of Arts in Government and has a law degree from Texas A&M University School of Law where she was awarded the prestigious MacLean & Boulware Endowed Law Scholarship.

Prior to being elected mayor of Fort Worth in 2021, Ms. Parker served as the chief of staff to the Fort Worth

mayor and council and was the founding chief executive officer of Fort Worth Cradle to Career and the Tarrant To & Through (T3) Partnership.

---

## Contact and Phone Numbers

100 Fort Worth Trail  
Fort Worth, TX 76102

☎ (817) 392-6118

✉ [mattie.parker@fortworthtexas.gov](mailto:mattie.parker@fortworthtexas.gov) (mailto:mattie.parker@fortworthtexas.gov)

### General Contact for Fort Worth

Mailing:

100 Fort Worth Trail  
Fort Worth, TX 76102

☎ (817) 392-6161

🌐 [www.fortworthtexas.gov](http://www.fortworthtexas.gov) (http://www.fortworthtexas.gov)

✉ [csadmin@fortworthtexas.gov](mailto:csadmin@fortworthtexas.gov) (mailto:csadmin@fortworthtexas.gov)

### 🔄 Recent Searches

Randall C. "Randy" Jackson (County Judge) (/online/search/?  
tosearch=Randall+C.+%22Randy%22+Jackson+%28County+Judge%29&searchcat=1)

Lori An Gobert (Mayor) (/online/search/?tosearch=Lori+An+Gobert+%28Mayor%29&searchcat=1)

Eric Johnson (Mayor) (/online/search/?tosearch=Eric+Johnson+%28Mayor%29&searchcat=1)

### ⚡ Helpful Links

Find My Incumbent (<http://www.fyi.legis.state.tx.us/>)

Capitol Maps (<https://tspb.texas.gov/plan/maps/maps.html>)

Bill Filings (<http://www.legis.state.tx.us/>)

Bill Search (<http://www.legis.state.tx.us/Search/BillSearch.aspx>)

Texas at Your Fingertips (<https://texas.gov/>)

State Symbols (<https://www.thestoryoftexas.com/education/texas-symbols>)

Governor Appointment (<https://gov.texas.gov/news/category/appointment>)

Addressing Procedures (<https://lrl.texas.gov/genInfo/ContactLeg.cfm>)

Since 1935 the Texas State Directory has been a trusted resource and has been referred to as the bible for anyone working in or wanting to learn about state, city and county government.

## Recent Searches

---

RANDALL C. "RANDY" JACKSON (COUNTY JUDGE) (</ONLINE/SEARCH/?TOSEARCH=RANDALL+C.+%22RANDY%22+JACKSON+%28COUNTY+JUDGE%29&SEARCHCAT=1>)

---

LORI AN GOBERT (MAYOR) (</ONLINE/SEARCH/?TOSEARCH=LORI+AN+GOBERT+%28MAYOR%29&SEARCHCAT=1>)

---

ERIC JOHNSON (MAYOR) (</ONLINE/SEARCH/?TOSEARCH=ERIC+JOHNSON+%28MAYOR%29&SEARCHCAT=1>)

---

MILTON POWERS (COUNTY JUDGE) (</ONLINE/SEARCH/?TOSEARCH=MILTON+POWERS+%28COUNTY+JUDGE%29&SEARCHCAT=1>)

---

CHRIS DAVIES (MAYOR) (</ONLINE/SEARCH/?TOSEARCH=CHRIS+DAVIES+%28MAYOR%29&SEARCHCAT=1>)

## Useful Links

---

FIND MY INCUMBENT ([HTTP://WWW.FYI.LEGIS.STATE.TX.US/](http://www.fyi.legis.state.tx.us/)) >

---

CAPITOL MAPS ([HTTPS://TSPB.TEXAS.GOV/PLAN/MAPS/MAPS.HTML](https://tspb.texas.gov/plan/maps/maps.html)) >

---

BILL FILINGS ([HTTP://WWW.LEGIS.STATE.TX.US/](http://www.legis.state.tx.us/)) >

---

BILL SEARCH ([HTTP://WWW.LEGIS.STATE.TX.US/SEARCH/BILLSEARCH.ASPX](http://www.legis.state.tx.us/search/billsearch.aspx)) >

---

TEXAS AT YOUR FINGERTIPS ([HTTPS://TEXAS.GOV/](https://texas.gov/)) >

---

STATE SYMBOLS ([HTTP://WWW.LEGIS.STATE.TX.US/RESOURCES/STATESYMBOLS.ASPX](http://www.legis.state.tx.us/resources/statesymbols.aspx)) >

---

GOVERNOR APPOINTMENT ([HTTPS://GOV.TEXAS.GOV/NEWS/CATEGORY/APPOINTMENT](https://gov.texas.gov/news/category/appointment)) >

## Contact Us

---

Texas State Directory Press

1800 Nueces St.

Austin, Texas 78701

 (512) 473-2447

 [Contact Us \(/contact/\)](/contact/)

2026 © All Rights Reserved. [Privacy Policy \(/privacy/\)](#) | [Terms of Service \(/terms/\)](#)

[f \(https://www.facebook.com/Texas-State-Directory-142890752404984/\)](https://www.facebook.com/Texas-State-Directory-142890752404984/) [t \(https://twitter.com/TSDPress\)](https://twitter.com/TSDPress)



Search the Directory

Search

# The Honorable Tim O'Hare (R)

Last modified on: 06-10-2024 09:28:51

[↩ Back to Tarrant \(/online/county/detail.php?id=220\)](/online/county/detail.php?id=220)

## County Judge (Tarrant (/online/county/detail.php?id=220))

Entered Office: 01-01-2023

Term Ends: 12-31-2026

---

### General Information

[Download vCard \(/online/vcard/?id=69315&office=16568\)](/online/vcard/?id=69315&office=16568) (? (/online/aboutvcards/))

[+ Add to Favorites \(/online/add\\_favorite/?name=The Honorable Tim O'Hare\)](/online/add_favorite/?name=The+Honorable+Tim+O'Hare)

---

### Contact and Phone Numbers

100 E. Weatherford St.

Fort Worth, TX 76196

 (817) 884-1441

 (817) 884-2793

 [countyjudge@tarrantcountytx.gov](mailto:countyjudge@tarrantcountytx.gov) (mailto:countyjudge@tarrantcountytx.gov)

---

#### General Contact for Tarrant

Street:

100 E. Weatherford

Fort Worth, TX 76196

 (817) 884-1441

 (817) 884-2793

✉ [countyjudge@tarrantcountytx.gov](mailto:countyjudge@tarrantcountytx.gov) (mailto:countyjudge@tarrantcountytx.gov)

🌐 <https://www.tarrantcountytx.gov/en.html> (https://www.tarrantcountytx.gov/en.html)

### 🔄 Recent Searches

Randall C. "Randy" Jackson (County Judge) (/online/search/?  
tosearch=Randall+C.+%22Randy%22+Jackson+%28County+Judge%29&searchcat=1)

Lori An Gobert (Mayor) (/online/search/?tosearch=Lori+An+Gobert+%28Mayor%29&searchcat=1)

Eric Johnson (Mayor) (/online/search/?tosearch=Eric+Johnson+%28Mayor%29&searchcat=1)

### ⚡ Helpful Links

Find My Incumbent (<http://www.fyi.legis.state.tx.us/>)

Capitol Maps (<https://tspb.texas.gov/plan/maps/maps.html>)

Bill Filings (<http://www.legis.state.tx.us/>)

Bill Search (<http://www.legis.state.tx.us/Search/BillSearch.aspx>)

Texas at Your Fingertips (<https://texas.gov/>)

State Symbols (<https://www.thestoryoftexas.com/education/texas-symbols>)

Governor Appointment (<https://gov.texas.gov/news/category/appointment>)

Addressing Procedures (<https://lrl.texas.gov/genInfo/ContactLeg.cfm>)

## TEXAS STATE DIRECTORY (1)

Since 1935 the Texas State Directory has been a trusted resource and has been referred to as the bible for anyone working in or wanting to learn about state, city and county government.

## Recent Searches

---

RANDALL C. "RANDY" JACKSON (COUNTY JUDGE) (/ONLINE/SEARCH/?  
TOSEARCH=RANDALL+C.+%22RANDY%22+JACKSON+%28COUNTY+JUDGE%29&SEARCHCAT=1)

---

[LORI AN GOBERT \(MAYOR\) \(/ONLINE/SEARCH/?TOSEARCH=LORI+AN+GOBERT+%28MAYOR%29&SEARCHCAT=1\)](#)

---

[ERIC JOHNSON \(MAYOR\) \(/ONLINE/SEARCH/?TOSEARCH=ERIC+JOHNSON+%28MAYOR%29&SEARCHCAT=1\)](#)

---

[MILTON POWERS \(COUNTY JUDGE\) \(/ONLINE/SEARCH/?TOSEARCH=MILTON+POWERS+%28COUNTY+JUDGE%29&SEARCHCAT=1\)](#)

---

[CHRIS DAVIES \(MAYOR\) \(/ONLINE/SEARCH/?TOSEARCH=CHRIS+DAVIES+%28MAYOR%29&SEARCHCAT=1\)](#)

## Useful Links

---

[FIND MY INCUMBENT \(HTTP://WWW.FYI.LEGIS.STATE.TX.US/\)](http://www.fyi.legis.state.tx.us/) >

---

[CAPITOL MAPS \(HTTPS://TSPB.TEXAS.GOV/PLAN/MAPS/MAPS.HTML\)](https://tspb.texas.gov/plan/maps/maps.html) >

---

[BILL FILINGS \(HTTP://WWW.LEGIS.STATE.TX.US/\)](http://www.legis.state.tx.us/) >

---

[BILL SEARCH \(HTTP://WWW.LEGIS.STATE.TX.US/SEARCH/BILLSEARCH.ASPX\)](http://www.legis.state.tx.us/search/billsearch.aspx) >

---

[TEXAS AT YOUR FINGERTIPS \(HTTPS://TEXAS.GOV/\)](https://texas.gov/) >

---

[STATE SYMBOLS \(HTTP://WWW.LEGIS.STATE.TX.US/RESOURCES/STATESYMBOLS.ASPX\)](http://www.legis.state.tx.us/resources/statesymbols.aspx) >

---

[GOVERNOR APPOINTMENT \(HTTPS://GOV.TEXAS.GOV/NEWS/CATEGORY/APPOINTMENT\)](https://gov.texas.gov/news/category/appointment) >

## Contact Us

---

Texas State Directory Press



1800 Nueces St.

Austin, Texas 78701

 (512) 473-2447

 [Contact Us \(/contact/\)](/contact/)

2026 © All Rights Reserved. [Privacy Policy \(/privacy/\)](/privacy/) | [Terms of Service \(/terms/\)](/terms/)

 (<https://www.facebook.com/Texas-State-Directory-142890752404984/>)  (<https://twitter.com/TSDPress>)

Follow these links to contact your representatives:

Address not found. ZIP Code results displayed.

Representative Helen Kerwin  
Texas House District 58



Representative David Cook  
Texas House District 96



Representative John W. McQueeney  
Texas House District 97



**U.S. CONGRESSIONAL DISTRICTS FOR 2026 ELECTIONS**

U.S. Representatives (2) Districts 6 and 25

## Steven Piper

---

**From:** eNotice TCEQ  
**Sent:** Tuesday, May 5, 2026 10:48 AM  
**To:** phil.king@senate.texas.gov; david.cook@house.texas.gov;  
mattie.parker@fortworthtexas.gov; countyjudge@tarrantcountytx.gov  
**Subject:** TCEQ Notice - Permit Number 177918L002  
**Attachments:** TCEQ Notice - 177918L002\_408759.pdf

This email is being sent to electronically transmit an official document issued by the Office of Air of the Texas Commission on Environmental Quality.

This email is being sent to you because either (a) you filed a document with the Office of the Chief Clerk that made you part of the official mailing list for the above referenced matter, or (b) notice to you is legally required. As authorized by Texas Water Code 5.128, this electronic transmittal is replacing the previous practice of hard copy distribution. Amendments to Texas Government Code 552.137 prompted a change to the agency's privacy policy regarding confidentiality of certain email addresses. The revised privacy policy can be viewed at [http://www.tceq.state.tx.us/help/policies/electronic\\_info\\_policy.html](http://www.tceq.state.tx.us/help/policies/electronic_info_policy.html).

Questions regarding this email may be submitted either by replying directly to this email or by calling Bonnie Evridge with the Air Permits Division at (512) 239-5222.

The attached document is provided in an Adobe Acrobat .pdf format. If you cannot display the attachment, you may need to visit the Adobe web site (<http://get.adobe.com/reader>) to download the free Adobe Acrobat Reader software.

Follow these links to contact your representatives:

Address not found. ZIP Code results displayed.

**U.S. Representatives (2)**   
Districts 6 and 25

**State Representatives (3)**   
Districts 58, 96, and 97

**Senator Phil King**   
Texas Senate District 10

[Open member's website](#)

**State Board of Education Members (2)**   
Districts 11 and 14

**Senator John Cornyn**   
U.S. Senate

**Senator Ted Cruz**   
U.S. Senate

**U.S. CONGRESSIONAL DISTRICTS FOR 2026 ELECTIONS**

**U.S. Representatives (2) Districts 6 and 25**

Brooke T. Paup, *Chairwoman*  
Catarina R. Gonzales, *Commissioner*  
Tonya R. Miller, *Commissioner*  
Kelly Keel, *Executive Director*



## TEXAS COMMISSION ON ENVIRONMENTAL QUALITY

*Protecting Texas by Reducing and Preventing Pollution*

May 5, 2026

THE HONORABLE PHIL KING  
TEXAS SENATE  
PO BOX 12068  
AUSTIN TX 78711-2068

Re: Small Business Stationary Source Registration under an Air Quality Standard Permit for Concrete Batch Plants  
Concrete Batch Plant

Dear Senator King:

Pursuant to the requirements of Section 382.0516 of the Texas Clean Air Act, Texas Health and Safety Code, Chapter 382, this letter is to notify you of the recent receipt of an application for an air quality standard permit registration for a concrete batch plant which is located in your district. The status of all pending air quality applications may be viewed by visiting our agency Web site at [www2.tceq.texas.gov/airperm/index.cfm](http://www2.tceq.texas.gov/airperm/index.cfm).

Raptor Ready Mix Inc, 1620 Riverview Drive, Lewisville, Texas 75056-4830, has applied to construct a Concrete Batch Plant located at east side of South Freeway approximately 0.3 mile south of Garden Acres Drive, Fort Worth, Tarrant County, Texas 76028. This application is being processed in an expedited manner, as allowed by the commission's rules in 30 Texas Administrative Code, Chapter 101, Subchapter J. The following link to an electronic map of the site or facility's general location is provided as a public courtesy and not part of the application or notice. For the exact location, refer to the application. <https://gisweb.tceq.texas.gov/LocationMapper/?marker=-97.316833,32.595139&level=13>. The Air Quality Permit Number is 177918L002.

If you need further information or have any questions, please call Mr. Joe Nicosia at (512) 239-1644 or write him at the Texas Commission on Environmental Quality, Office of Air, Air Permits Division, MC-163, P.O. Box 13087, Austin, Texas 78711-3087.

Sincerely,

A handwritten signature in cursive script that reads "Nancy Birdsong".

Nancy Birdsong, Team Leader  
Air Permits Initial Review Team  
Air Permits Division

Brooke T. Paup, *Chairwoman*  
Catarina R. Gonzales, *Commissioner*  
Tonya R. Miller, *Commissioner*  
Kelly Keel, *Executive Director*



## TEXAS COMMISSION ON ENVIRONMENTAL QUALITY

*Protecting Texas by Reducing and Preventing Pollution*

May 5, 2026

THE HONORABLE TIM O HARE  
TARRANT COUNTY JUDGE  
100 E WEATHERFORD ST  
FORT WORTH TX 76196

Re: Small Business Stationary Source Registration under an Air Quality Standard Permit for Concrete Batch Plants  
Concrete Batch Plant

Dear Judge O Hare:

Pursuant to the requirements of Section 382.0516 of the Texas Clean Air Act, Texas Health and Safety Code, Chapter 382, this letter is to notify you of the recent receipt of an application for an air quality standard permit registration for a concrete batch plant which is located in your county. The status of all pending air quality applications may be viewed by visiting our agency Web site at [www2.tceq.texas.gov/airperm/index.cfm](http://www2.tceq.texas.gov/airperm/index.cfm).

Raptor Ready Mix Inc, 1620 Riverview Drive, Lewisville, Texas 75056-4830, has applied to construct a Concrete Batch Plant located at east side of South Freeway approximately 0.3 mile south of Garden Acres Drive, Fort Worth, Tarrant County, Texas 76028. This application is being processed in an expedited manner, as allowed by the commission's rules in 30 Texas Administrative Code, Chapter 101, Subchapter J. The following link to an electronic map of the site or facility's general location is provided as a public courtesy and not part of the application or notice. For the exact location, refer to the application. <https://gisweb.tceq.texas.gov/LocationMapper/?marker=-97.316833,32.595139&level=13>. The Air Quality Permit Number is 177918L002.

If you need further information or have any questions, please call Mr. Joe Nicosia at (512) 239-1644 or write him at the Texas Commission on Environmental Quality, Office of Air, Air Permits Division, MC-163, P.O. Box 13087, Austin, Texas 78711-3087.

Sincerely,

A handwritten signature in cursive script that reads "Nancy Birdsong".

Nancy Birdsong, Team Leader  
Air Permits Initial Review Team  
Air Permits Division

Brooke T. Paup, *Chairwoman*  
Catarina R. Gonzales, *Commissioner*  
Tonya R. Miller, *Commissioner*  
Kelly Keel, *Executive Director*



## TEXAS COMMISSION ON ENVIRONMENTAL QUALITY

*Protecting Texas by Reducing and Preventing Pollution*

May 5, 2026

THE HONORABLE MATTIE PARKER  
MAYOR OF FORT WORTH  
100 FORT WORTH TRAIL  
FORT WORTH TX 76102

Re: Small Business Stationary Source Registration under an Air Quality Standard Permit for Concrete Batch Plants  
Concrete Batch Plant

Dear Honorable Mayor Parker:

Pursuant to the requirements of Section 382.0516 of the Texas Clean Air Act, Texas Health and Safety Code, Chapter 382, this letter is to notify you of the recent receipt of an application for an air quality standard permit registration for a concrete batch plant which is located in your municipality. The status of all pending air quality applications may be viewed by visiting our agency Web site at [www2.tceq.texas.gov/airperm/index.cfm](http://www2.tceq.texas.gov/airperm/index.cfm).

Raptor Ready Mix Inc, 1620 Riverview Drive, Lewisville, Texas 75056-4830, has applied to construct a Concrete Batch Plant located at east side of South Freeway approximately 0.3 mile south of Garden Acres Drive, Fort Worth, Tarrant County, Texas 76028. This application is being processed in an expedited manner, as allowed by the commission's rules in 30 Texas Administrative Code, Chapter 101, Subchapter J. The following link to an electronic map of the site or facility's general location is provided as a public courtesy and not part of the application or notice. For the exact location, refer to the application. <https://gisweb.tceq.texas.gov/LocationMapper/?marker=-97.316833,32.595139&level=13>. The Air Quality Permit Number is 177918L002.

If you need further information or have any questions, please call Mr. Joe Nicosia at (512) 239-1644 or write him at the Texas Commission on Environmental Quality, Office of Air, Air Permits Division, MC-163, P.O. Box 13087, Austin, Texas 78711-3087.

Sincerely,

A handwritten signature in black ink that reads "Nancy Birdsong".

Nancy Birdsong, Team Leader  
Air Permits Initial Review Team  
Air Permits Division

Brooke T. Paup, *Chairwoman*  
Catarina R. Gonzales, *Commissioner*  
Tonya R. Miller, *Commissioner*  
Kelly Keel, *Executive Director*



## TEXAS COMMISSION ON ENVIRONMENTAL QUALITY

*Protecting Texas by Reducing and Preventing Pollution*

May 5, 2026

THE HONORABLE DAVID COOK  
TEXAS HOUSE OF REPRESENTATIVES  
PO BOX 2910  
AUSTIN TX 78768-2910

Re: Small Business Stationary Source Registration under an Air Quality Standard Permit for Concrete Batch Plants  
Concrete Batch Plant

Dear Representative Cook:

Pursuant to the requirements of Section 382.0516 of the Texas Clean Air Act, Texas Health and Safety Code, Chapter 382, this letter is to notify you of the recent receipt of an application for an air quality standard permit registration for a concrete batch plant which is located in your district. The status of all pending air quality applications may be viewed by visiting our agency Web site at [www2.tceq.texas.gov/airperm/index.cfm](http://www2.tceq.texas.gov/airperm/index.cfm).

Raptor Ready Mix Inc, 1620 Riverview Drive, Lewisville, Texas 75056-4830, has applied to construct a Concrete Batch Plant located at east side of South Freeway approximately 0.3 mile south of Garden Acres Drive, Fort Worth, Tarrant County, Texas 76028. This application is being processed in an expedited manner, as allowed by the commission's rules in 30 Texas Administrative Code, Chapter 101, Subchapter J. The following link to an electronic map of the site or facility's general location is provided as a public courtesy and not part of the application or notice. For the exact location, refer to the application. <https://gisweb.tceq.texas.gov/LocationMapper/?marker=-97.316833,32.595139&level=13>. The Air Quality Permit Number is 177918L002.

If you need further information or have any questions, please call Mr. Joe Nicosia at (512) 239-1644 or write him at the Texas Commission on Environmental Quality, Office of Air, Air Permits Division, MC-163, P.O. Box 13087, Austin, Texas 78711-3087.

Sincerely,

A handwritten signature in cursive script that reads "Nancy Birdsong".

Nancy Birdsong, Team Leader  
Air Permits Initial Review Team  
Air Permits Division

## **Tóm tắt bằng ngôn ngữ phổ thông về Đơn xin Cấp phép Tiêu chuẩn cho Trạm trộn Bê tông Số đăng ký Giấy phép Tiêu chuẩn cho Trạm trộn Bê tông (177918L002)**

*Bản tóm tắt dưới đây được cung cấp cho đơn xin cấp phép khí thải hiện đang chờ xử lý và được Ủy ban Chất lượng Môi trường Texas (Texas Commission on Environmental Quality) xem xét, theo yêu cầu của Chương 39, Bộ luật Hành chính Texas (Texas Administrative Code), Tiêu đề 30. Thông tin được cung cấp trong bản tóm tắt này có thể thay đổi trong quá trình xem xét kỹ thuật đối với đơn xin cấp phép, và không được coi là những tuyên bố mang tính ràng buộc pháp lý ở cấp liên bang đối với nội dung của đơn xin cấp phép đó.*

Raptor Ready Mix Inc (CN606227288) đã nộp đơn đăng ký thiết lập một trạm trộn bê tông tạm thời theo Giấy phép Tiêu chuẩn về Chất lượng Không khí dành cho các Trạm trộn Bê tông, với số đăng ký (177918L002). Trạm trộn bê tông này (RN112001938) sẽ được đặt tại phía đông của đường South Fwy, cách đường Garden Acres Drive khoảng 0,3 dặm về phía nam, thuộc thành phố Fort Worth, Quận Tarrant.

Việc đăng ký này sẽ cho phép trạm trộn bê tông đạt công suất sản xuất tối đa dưới 200 yard khối bê tông mỗi giờ và hoạt động tối đa 8.760 giờ mỗi năm. Bụi sẽ được phát thải từ quá trình xử lý cốt liệu, xi măng và tro bay. Đường sá, khu vực giao thông và bãi chứa vật liệu sẽ được tưới nước để kiểm soát bụi. Các thiết bị che chắn và hệ thống lọc bụi túi sẽ được sử dụng để kiểm soát bụi xi măng và tro bay.

**Resumen en Lenguaje Sencillo del Permiso Estándar para Plantas de Hormigón**  
**Solicitud de Permiso Estándar para Plantas de Hormigón Número de Registro**  
**(177918L002)**

*El siguiente resumen se proporciona para esta solicitud de permiso de aire pendiente que está siendo revisada por la Comisión de Calidad Ambiental de Texas, según lo dispuesto en el capítulo 39 del Código Administrativo de Texas. La información proporcionada en este resumen puede cambiar durante la revisión técnica de la solicitud y no son representaciones federales ejecutables de la solicitud de permiso.*

Raptor Ready Mix Inc (CN606227288) ha presentado una solicitud de registro de planta temporal de hormigón en virtud del Permiso de la Norma de Calidad del Aire para Plantas de Hormigón para el número de registro (177918L002). La planta de hormigón (RN112001938) estará ubicada en el lado este de South Fwy aproximadamente 0,3 milla al sur de Garden Acres Drive en Fort Worth, Condado de Tarrant.

Este registro autorizará a la planta de hormigón a tener una producción máxima de menos que 200 yardas cúbicas por hora de hormigón y a operar hasta 8760 horas al año. Se emitirán partículas por la manipulación de áridos, cemento y cenizas volantes. Las carreteras, las zonas de tráfico, y los acopios serán regados para controlar el polvo. Para el control del polvo de cemento y cenizas volantes se utilizarán cerramientos y filtros de mangas.

**Plain Language Summary for Concrete Batch Plant Standard Permit  
Application for Concrete Batch Plant Standard Permit Registration Number  
(177918L002)**

*The following summary is provided for this pending air permit application being reviewed by the Texas Commission on Environmental Quality as required by 30 Texas Administrative Code Chapter 39. The information provided in this summary may change during the technical review of the application and are not federal enforceable representations of the permit application.*

Raptor Ready Mix Inc (CN606227288) has submitted an application to register a temporary concrete batch plant under the Air Quality Standard Permit for Concrete Batch Plants for registration number (177918L002). The concrete batch plant (RN112001938) will be located on the east side of South Fwy approximately 0.3 mile south of Garden Acres Drive in Fort Wort, Tarrant County.

This registration will authorize the concrete batch plant to have a maximum production rate of less than 200 cubic yards per hour of concrete and operate up to 8760 hours per year. Particulate matter will be emitted from the handling of aggregate, cement, and flyash. Roads, traffic areas, and stockpiles will be watered to control dust. Enclosures and baghouses will be used to control cement and flyash dust.



April 29, 2026

Texas Commission on Environmental Quality  
Air Permits Initial Review Team, MC-161  
P.O. Box 13087  
Austin, Texas 78711-3087

Project No.: 11616-007

Attention: Mr. Samuel Short

Subject: New Air Quality Standard Permit for a Temporary Concrete Batch Plant  
**EXPEDITED SURCHARGE INCLUDED**  
Raptor Ready Mix Inc – CN606227288  
Concrete Batch Plant SN7592 – RN112001938  
Fort Worth, Tarrant County, Texas

Mr. Short,

On behalf of Raptor Ready Mix Inc, we are submitting this Air Quality Standard Permit Application for a temporary concrete batch plant to be located within the city limits of Fort Worth, Tarrant County, Texas. A Form PI-1S-CBP, checklists, tables, maps, and supporting documents are attached. Raptor Ready Mix Inc will satisfy the applicable requirements of the Standard Permit for Temporary Concrete Batch Plants.

Westward Environmental, Inc. (WESTWARD) will serve as the technical representative for Raptor Ready Mix Inc on this project. **Please ensure that WESTWARD is copied on all correspondence including, but not limited to, the public notice packages and final approval letter.** If you have any questions regarding this application, please contact our office.

Respectfully Submitted,  
WESTWARD ENVIRONMENTAL, INC.

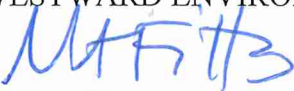
  
Melissa Fitts  
Senior Vice President

Distribution: Addressee  
TCEQ Region 4  
City of Fort Worth Environmental Quality Division  
Crowley Public Library (Public Notice)  
Mr. John Grobe – Raptor Ready Mix Inc  
WEI 11616-007 File

Attachments

Office PO. Box 2205 Boerne, TX 78006

Main 830.249.8284 | Fax 830.249.0221

Texas Registered Engineering Firm # F-4524

Texas Registered Geoscience Firm # 50112



westwardenv.com

**Raptor Ready Mix Inc**  
**New Air Quality Standard Permit Application**  
**Concrete Batch Plant SN7592**  
**Fort Worth, Tarrant County, Texas**

**Table of Contents**

DOCUMENT	PAGE #
Form APD-EXP	1
Form APD-APS	2
Core Data Form	3 - 4
Form PI-1S Workbook	5 - 18
Plain Language Summaries	19 - 21
Public Involvement Plan	22
Project Description	23
Area Map	24
Plot Plans	25 - 26
Process Description	27
Flow Diagram	28
Emissions Calculations	29 - 34
Manufacturer Drawings for Fabric Filters	35 - 40
TCEQ Air Quality Standard Permit for Concrete Batch Plants	41 - 52



April 2026

**Westward Environmental, Inc.**

Project No.: 11616-007

[www.westwardenv.com](http://www.westwardenv.com)

## Form APD-EXP Expedited Permitting Request

<b>I. Contact Information</b>	
Company or Other Legal Customer Name: Raptor Ready Mix Inc	
Customer Reference Number (CN): CN606227288	
Regulated Entity Number (RN): RN112001938	
Technical Contact Name: Melissa Fitts – Westward Environmental, Inc.	
Phone Number: 830-249-8284	
Email: mfitts@westwardenv.com	
<b>II. Project Information</b>	
Facility Type: Concrete Batch Plant	
Permit Number: New	
Project Number: New	
<b>III. Economic Justification</b>	
The purpose of the application associated with this request to expedite will benefit the economy of this state or an area of this state.	<input checked="" type="checkbox"/> YES <input type="checkbox"/> NO
<b>IV. Delinquent Fees and Penalties</b>	
Applications will not be expedited if any delinquent fees and/or penalties are owed to the TCEQ or the Office of the Attorney General on behalf of the TCEQ. For more information regarding Delinquent Fees and Penalties, go to the TCEQ Web site at: <a href="http://www.tceq.texas.gov/agency/delin/index.html">www.tceq.texas.gov/agency/delin/index.html</a> .	
<b>V. Signature</b>	
The signature below confirms that I have knowledge of the facts included in this application and that these facts are true and correct to the best of my knowledge and belief. As the applicant, I commit to fulfilling all expectations of the expedited permitting program and application requirements promptly. Failure to meet any expectation or requirement may cause my application to be removed from the expedited permitting program and possibly voided at the discretion of the TCEQ Executive Director. The signature further signifies awareness that intentionally or knowingly making or causing to be made false material statements or representations in the application is a criminal offense subject to criminal penalties.	
Name: John Grobe	
Signature: STEERS	
Date:	

**Air Permit Division Air Permit Support (APD-APS) Air Permitting Surcharge Payment  
Texas Commission on Environmental Quality**

<b>I. Contact Information</b>	
Company or Other Legal Customer Name: Raptor Ready Mix Inc	
Customer Reference Number (CN): CN606227288	
Regulated Entity Number (RN): RN112001938	
Company Official or Technical Contact Information	
<input type="checkbox"/> Mr. <input checked="" type="checkbox"/> Mrs. <input type="checkbox"/> Ms. <input type="checkbox"/> Dr. <input type="checkbox"/> Other:	
Name: Melissa Fitts	
Title: Senior Vice President – Westward Environmental, Inc.	
Mailing Address: P.O. Box 2205	
City: Boerne	
State: Texas	
ZIP Code: 78006	
Telephone Number: (830) 249-8284	
E-mail Address: mfitts@westwardenv.com	
<b>II. Project Information</b>	
Facility Name: Concrete Batch Plant SN7592	
Permit Number: New	
Project Number: New	
<b>III. Surcharge Payment</b>	
Project Type: Standard Permit	
Fee Amount: \$3,000	
Check, Money Order, Transaction Number, and/or ePay Voucher Number: <i>(below)</i>	
STEERS	
Paid Online: <span style="float: right;"><input checked="" type="checkbox"/> YES <input type="checkbox"/> NO</span>	
Company Name on Check: N/A	



TCEQ Use Only

# TCEQ Core Data Form

For detailed instructions on completing this form, please read the Core Data Form Instructions or call 512-239-5175.

## SECTION I: General Information

1. Reason for Submission (If other is checked please describe in space provided.)		
<input checked="" type="checkbox"/> New Permit, Registration or Authorization (Core Data Form should be submitted with the program application.)		
<input type="checkbox"/> Renewal (Core Data Form should be submitted with the renewal form)	<input type="checkbox"/> Other	
2. Customer Reference Number (if issued)	<a href="#">Follow this link to search for CN or RN numbers in Central Registry**</a>	3. Regulated Entity Reference Number (if issued)
CN 606227288		RN 112001938

## SECTION II: Customer Information

4. General Customer Information		5. Effective Date for Customer Information Updates (mm/dd/yyyy)	
<input type="checkbox"/> New Customer		<input type="checkbox"/> Update to Customer Information	
<input type="checkbox"/> Change in Legal Name (Verifiable with the Texas Secretary of State or Texas Comptroller of Public Accounts)		<input type="checkbox"/> Change in Regulated Entity Ownership	
<i>The Customer Name submitted here may be updated automatically based on what is current and active with the Texas Secretary of State (SOS) or Texas Comptroller of Public Accounts (CPA).</i>			
6. Customer Legal Name (If an individual, print last name first: eg: Doe, John)		If new Customer, enter previous Customer below:	
Raptor Ready Mix Inc			
7. TX SOS/CPA Filing Number	8. TX State Tax ID (11 digits)	9. Federal Tax ID (9 digits)	10. DUNS Number (if applicable)
0804111999	32079722180		
11. Type of Customer:	<input checked="" type="checkbox"/> Corporation	<input type="checkbox"/> Individual	Partnership: <input type="checkbox"/> General <input type="checkbox"/> Limited
Government: <input type="checkbox"/> City <input type="checkbox"/> County <input type="checkbox"/> Federal <input type="checkbox"/> Local <input type="checkbox"/> State <input type="checkbox"/> Other		<input type="checkbox"/> Sole Proprietorship	<input type="checkbox"/> Other:
12. Number of Employees	13. Independently Owned and Operated?		
<input type="checkbox"/> 0-20 <input checked="" type="checkbox"/> 21-100 <input type="checkbox"/> 101-250 <input type="checkbox"/> 251-500 <input type="checkbox"/> 501 and higher	<input type="checkbox"/> Yes <input type="checkbox"/> No		
14. Customer Role (Proposed or Actual) – as it relates to the Regulated Entity listed on this form. Please check one of the following			
<input type="checkbox"/> Owner <input type="checkbox"/> Operator <input checked="" type="checkbox"/> Owner & Operator <input type="checkbox"/> Other:			
<input type="checkbox"/> Occupational Licensee <input type="checkbox"/> Responsible Party <input type="checkbox"/> VCP/BSA Applicant			
15. Mailing Address:	1620 Riverview Drive		
	City	Lewisville	State TX ZIP 75056 ZIP + 4
16. Country Mailing Information (if outside USA)		17. E-Mail Address (if applicable)	
		john@raptorreadymix.com	
18. Telephone Number	19. Extension or Code	20. Fax Number (if applicable)	
972-906-9988			

## SECTION III: Regulated Entity Information

21. General Regulated Entity Information (If "New Regulated Entity" is selected, a new permit application is also required.)	
<input type="checkbox"/> New Regulated Entity <input type="checkbox"/> Update to Regulated Entity Name <input checked="" type="checkbox"/> Update to Regulated Entity Information	
<i>The Regulated Entity Name submitted may be updated, in order to meet TCEQ Core Data Standards (removal of organizational endings such as Inc, LP, or LLC).</i>	
22. Regulated Entity Name (Enter name of the site where the regulated action is taking place.)	
Concrete Batch Plant SN7592	

23. Street Address of the Regulated Entity: <i>(No PO Boxes)</i>							
	City		State		ZIP		ZIP + 4
24. County	Tarrant						

If no Street Address is provided, fields 25-28 are required.

25. Description to Physical Location:	Located on the east side of South Fwy approx 0.3 mile south of Garden Acres Drive.						
26. Nearest City					State	Nearest ZIP Code	
Fort Worth					TX	76028	
<i>Latitude/Longitude are required and may be added/updated to meet TCEQ Core Data Standards. (Geocoding of the Physical Address may be used to supply coordinates where none have been provided or to gain accuracy).</i>							
27. Latitude (N) In Decimal:	32.595139			28. Longitude (W) In Decimal:	-97.316833		
Degrees	Minutes	Seconds	Degrees	Minutes	Seconds		
32	35	42.5	97	19	06.0		
29. Primary SIC Code (4 digits)	30. Secondary SIC Code (4 digits)		31. Primary NAICS Code (5 or 6 digits)		32. Secondary NAICS Code(5 or 6 digits)		
3273			327320				
33. What is the Primary Business of this entity? <i>(Do not repeat the SIC or NAICS description.)</i>							
Construction Materials							
34. Mailing Address:	1620 Riverview Drive						
	City	Lewisville	State	TX	ZIP	75056	ZIP + 4
35. E-Mail Address:	john@raptorreadymix.com						
36. Telephone Number	37. Extension or Code		38. Fax Number <i>(if applicable)</i>				
972-906-9988							

39. TCEQ Programs and ID Numbers Check all Programs and write in the permits/registration numbers that will be affected by the updates submitted on this form. See the Core Data Form instructions for additional guidance.

<input type="checkbox"/> Dam Safety	<input type="checkbox"/> Districts	<input type="checkbox"/> Edwards Aquifer	<input type="checkbox"/> Emissions Inventory Air	<input type="checkbox"/> Industrial Hazardous Waste
<input type="checkbox"/> Municipal Solid Waste	<input checked="" type="checkbox"/> New Source Review Air	<input type="checkbox"/> OSSF	<input type="checkbox"/> Petroleum Storage Tank	<input type="checkbox"/> PWS
<input type="checkbox"/> Sludge	New <input type="checkbox"/> Storm Water	<input type="checkbox"/> Title V Air	<input type="checkbox"/> Tires	<input type="checkbox"/> Used Oil
<input type="checkbox"/> Voluntary Cleanup	<input type="checkbox"/> Wastewater	<input type="checkbox"/> Wastewater Agriculture	<input type="checkbox"/> Water Rights	<input type="checkbox"/> Other:

## SECTION IV: Preparer Information

40. Name:	Melissa Fitts		41. Title:	Senior Vice President	
42. Telephone Number	43. Ext./Code	44. Fax Number	45. E-Mail Address		
830-249-8284		830-249-0221	mfitts@westwardenv.com		

## SECTION V: Authorized Signature

46. By my signature below, I certify, to the best of my knowledge, that the information provided in this form is true and complete, and that I have signature authority to submit this form on behalf of the entity specified in Section II, Field 6 and/or as required for the updates to the ID numbers identified in field 39.

Company:	Raptor Ready Mix Inc		Job Title:	VP/GM	
Name <i>(In Print)</i> :	John Grobe			Phone:	972-906-9988
Signature:	STEERS			Date:	

**PI-1S Registrations for Air Standard Permit: Concrete Batch Plants**

[Click here to go back to the Cover sheet.](#)

This sheet provides administrative information needed by the TCEQ.

**Instructions:**

- Complete all applicable sections below.
  - For facilities authorized under CBPSP 6004 amendment (Jan. 24 2024), use the 6004Checklist worksheet.
  - For facilities authorized under CBPECSP 6008 rule, use the 6008Checklist worksheet.
  - For facilities authorized under TPWCBPSP 6024 temporary public works rule, use the 6024ChecklistTPW worksheet.
  - For facilities authorized under the previous CBPSP 6004 rule (2021) submitting a limited change of representation under the previous (2021) rule, use the 6004ChecklistCOR2021 worksheet.
  - For facilities authorized under the previous CBPSP 6004 rule (2021) submitting a significant change of representation under the current amendment (2024), use the 6004Checklist worksheet.

**I. Acknowledgement**

**I acknowledge that I am submitting an authorized TCEQ application workbook and any necessary attachments. Except for inputting the requested data and adjusting row height and column width, I have not changed the TCEQ application workbook in any way, including but not limited to changing formulas, formatting, content, or**

I agree

**II. Rule Selection**

**A. Registration and Action Type**

Select the type of action requested using the dropdown. Options include Initial, Change of Representation.

Standard Permit and Description	Action Type Requested
6004: Concrete Batch Plants	Initial (move to new location)
Registration Number	176797L001
Expiration Date	10/3/2034

**Requested Information**

**Response**

**Notes**

Is a registered portable facility moving to a site for support of a public works project in which the proposed site is located in or contiguous to the right-of-way of the public works project?	No	Section 10(A) of Standard Permit 6004 or consider Standard Permit 6024.
Is a registered portable facility moving to a site in which a portable facility was located at the site at any time during the previous two years and was the site subject to public notice?	No	Section 10(A) of Standard Permit 6004.

[Air New Source Review Guidance for ePermitting in STEERS](#)

**B. Company Information:**

Requested Information	Response
Company or Legal Name:	Raptor Ready Mix Inc
Texas Secretary of State Charter/Registration Number (if given):	804111999

Registrations are issued to either the facility owner or operator, commonly referred to as the applicant or registration holder. List the legal name of the [Texas Secretary of State](#)

**C. Company Official Contact Information:**

Requested Information	Response
Prefix (Mr., Ms., Dr., etc.):	Mr.
First Name:	John
Last Name:	Grobe
Title:	VP/GM
Mailing Address:	1620 Riverview Drive
Address Line 2:	
City:	Lewisville

**Texas Commission on Environmental Quality**  
**Form PI-1S-CBP**  
**PI-1S-CBP**

Date: April 2026  
Registration #: New  
Company: Raptor Ready Mix Inc

State:	TX
ZIP Code:	75056
Telephone Number:	972-906-9988
Fax Number:	
Email Address:	john@raptorreadymix.com

Note: All correspondence and issued permit documents will be sent via e-mail within one business day of TCEQ's decision. Ensure that the e-mail address

**D. Technical Contact Information:**

Requested Information	Response
Prefix (Mr., Ms., Dr., etc.):	Mrs.
First Name:	Melissa
Last Name:	Fitts
Title:	Senior Vice President
Company or Legal Name:	Westward Environmental, Inc.
Mailing Address:	P.O. Box 2205
Address Line 2:	
City:	Boerne
State:	TX
ZIP Code:	78006
Telephone Number:	830-249-8284
Fax Number:	830-249-0221
Email Address:	mfitts@westwardenv.com

**E. Assigned Numbers:**

The Customer Reference Number (CN) and Regulated Entity Number (RN) below are assigned when a Core Data Form is initially submitted to the Central

Requested Information	Response	Notes
Enter the CN:	CN606227288	The CN is a unique number given to each business, governmental body, association, individual, or other entity that owns, operates, is responsible for, or is affiliated with a regulated entity.
Enter the RN:	RN112001938	The RN is a unique agency assigned number given to each person, organization, place, or thing that is of environmental interest to us and where regulated activities will occur. The RN replaces existing air account numbers. The RN for portable units is assigned to the unit itself, and that same RN should be used when applying for authorization at a different location.

**III. Delinquent Fees and Penalties**

Requested Information	Response	Notes
Does the applicant have unpaid delinquent fees and/or penalties owed to the TCEQ?	No	This form will not be processed until all delinquent fees and/or penalties owed to the TCEQ or the Office of the Attorney General on behalf of the TCEQ are paid in accordance with the Delinquent Fee and Penalty Protocol. For more information regarding Delinquent Fees and Penalties, use the TCEQ website at the link below.

[Delinquent Fees and Penalties](#)

**IV. Registration Information**

**A. Other Facilities at this Site Authorized by Standard Exemption, PBR, or Standard Permit:**

Requested Information	Response	Notes
Are there any other facilities at this site that are authorized by Exemption, PBR, or Standard Permit?	No	If "YES," enter the standard exemption number(s), PBR registration number(s), and Standard Permit registration number(s), and associated effective date(s)

**B. Other Air Preconstruction Permits:**

Requested Information	Response
Are there any other air preconstruction permits at this site?	No

**C. Associated Federal Operating Permits:**

Requested Information	Response	Notes
Is this facility located at a site required to obtain a site operating permit (SOP) or general operating permit (GOP)?	No	-

**Texas Commission on Environmental Quality**  
**Form PI-1S-CBP**  
**PI-1S-CBP**

Date: April 2026  
 Registration #: New  
 Company: Raptor Ready Mix Inc

<b>V. Facility Location and General Information</b>		
<b>A. Location:</b>		
<b>Requested Information</b>	<b>Response</b>	<b>Notes</b>
County:	Tarrant	Enter the county where the facility is physically located.
TCEQ Region:	Region 4	Automatically updated based on selection above.
Street Address:		-
City:	Fort Worth	If the address is not located in a city, then enter the city or town closest to the facility, even if it is not in the same county as the facility.
ZIP Code:	76028	Include the ZIP Code of the physical facility site, not the ZIP Code of the applicant's mailing address.
Site Location Description:	Located on east side of South Fwy approximately 0.3 mile south of Garden Acres Drive.	If there is no street address, provide written driving directions to the site. Identify the location by distance and direction from well-known landmarks such as major highway intersections.
<b>B. General Information:</b>		
<b>Requested Information</b>	<b>Response</b>	<b>Notes</b>
Facility Name:	Concrete Batch Plant SN7592	-
Area Name:	Concrete Batch Plant SN7592	Must indicate the general type of operation, process, equipment or facility. Include numerical designations, if appropriate. Examples are Sulfuric Acid Plant and No. 5 Steam Boiler. Vague names such as Chemical Plant are not acceptable.
Is the facility currently registered as a temporary facility in Texas?	Yes	-
Are there any schools located within 3,000 feet of the site boundary?	No	-
<b>C. Type of Plant:</b>		
<b>Requested Information</b>	<b>Response</b>	<b>Notes</b>
Type of plant:	Temporary	Note: A temporary plant is limited to 180 consecutive days on site or for the duration required to complete a single project.
Length of time at site (days):	Single Project	-
Provide single project name and any identifying project numbers:	Huguley Development	For example, indicate Texas Department of Transportation (TXDOT) project name.
Serial number of the equipment to be authorized, if applicable:	7592	-
Serial number of the equipment to be authorized, if applicable:		-
<b>D. Industry Type:</b>		
<b>Requested Information</b>	<b>Response</b>	
Principal Company Product/Business:	Construction Materials	
Principal Standard Industry Classification (SIC) code:	3273: Ready-Mixed Concrete	
<b>E. State Senator and Representative for this site:</b>		
This information can be found at the link below: <a href="#">Who Represents Me?</a>		
<b>Requested Information</b>	<b>Response</b>	
State Senator:	Phil King	
District:	10	
State Representative:	David Cook	
District:	96	
<b>F. County Judge and Presiding Officer:</b>		
<a href="#">Texas State Directory</a>		
Provide the information for the <b>County Judge</b> for the location where the facility is or will be located:		
<b>County Judge:</b>		
<b>Requested Information</b>	<b>Response</b>	<b>Notes</b>
The Honorable:	Tim O'Hare	-
Mailing Address:	100 E Weatherford St	-
Address Line 2:	Suite 501	-
City:	Fort Worth	-
State:	TX	-
ZIP Code:	76196	-
<b>Presiding Officer:</b>		
Presiding officer(s) of the municipality. This is frequently the mayor. An attachment may be used for multiple.		

**Texas Commission on Environmental Quality**  
**Form PI-1S-CBP**  
**PI-1S-CBP**

Date: April 2026  
Registration #: New  
Company: Raptor Ready Mix Inc

Requested Information	Response	Notes
Is the facility located in any municipality or an extraterritorial jurisdiction of any municipality?	Yes	Provide the information for the presiding officer(s) of the municipality. This is frequently the Mayor. An attachment may be used for multiple
First Name:	Mattie	-
Last Name:	Parker	-
Title:	Mayor	-
Mailing Address:	100 Fort Worth Trail	-
Address Line 2:		-
City:	Fort Worth	-
State:	TX	-
ZIP Code:	76102	-

**VI. Project Information**

**A. Description:**

Requested Information	Response	Notes
Is a project description attached to this application?	Yes	Attach supporting documentation with detailed project description.

**B. Enforcement Projects:**

Requested Information	Response	Notes
Is this application in response to, or related to, an agency investigation, notice of violation, or enforcement action?	No	

**VII. Application Materials**

All representations regarding construction plans and operation procedures contained in the registration application shall be conditions upon which the

**A. Confidential Application Materials:**

Requested Information	Response	Notes
Is confidential information submitted with this application?	No	

[Confidential Information in Air Permit Applications](#)

Requested Information	Response	Notes
<b>C. Is a current area map attached?</b>	Yes	-
Is the area map a current map with: <ul style="list-style-type: none"> <li>• a true north arrow,</li> <li>• an accurate scale,</li> <li>• the entire plant property,</li> <li>• the location of the property relative to prominent geographical features?</li> </ul>	Yes	Location of the property relative to prominent geographical features : including, but not limited to, highways, roads, streams, and significant landmarks such as buildings, residences, schools, parks, hospitals, day care centers, and churches
Does the map show a 3,000 foot radius from the property boundary?	Yes	-
<b>D. Is a plot plan attached?</b>	Yes	-
Does your plot plan clearly show: <ul style="list-style-type: none"> <li>• a north arrow,</li> <li>• an accurate scale,</li> <li>• all property lines,</li> <li>• all emission points, buildings, tanks, process vessels, other process equipment,</li> <li>• and two benchmark locations?</li> </ul>	Yes	-
Does your plot plan identify all emission points on the affected property, including: <ul style="list-style-type: none"> <li>• all emission points authorized by other air authorizations,</li> <li>• construction permits,</li> <li>• PBRs,</li> <li>• special permits,</li> <li>• and standard permits?</li> </ul>	Yes	-
Did you include a table of emission points indicating the authorization type and authorization identifier, such as: <ul style="list-style-type: none"> <li>• a permit number,</li> <li>• registration number,</li> <li>• or rule citation under which each emission point is currently authorized?</li> </ul>	Yes	-
Does your plot plan clearly mark all distances to other property or structures? To demonstrate compliance with all distance, setback, and buffer requirements	Yes	-

**Texas Commission on Environmental Quality**  
**Form PI-1S-CBP**  
**PI-1S-CBP**

Date: April 2026  
Registration #: New  
Company: Raptor Ready Mix Inc

<b>E. Is a process flow diagram attached?</b>	Yes	-
Is the process flow diagram sufficiently descriptive so the permit reviewer can determine the raw materials to be used in the process; <ul style="list-style-type: none"> <li>• all major processing steps and major equipment items;</li> <li>• individual emission points associated with each process step;</li> <li>• the location and identification of all emission abatement devices;</li> <li>• and the location and identification of all waste streams?</li> </ul>	Yes	For water streams: including wastewater streams that may have associated air emissions.
<b>F. Is a process description attached?</b>	Yes	-
Does the process description emphasize: <ul style="list-style-type: none"> <li>• where the emissions are generated,</li> <li>• why the emissions must be generated,</li> <li>• what air pollution controls are used,</li> <li>• and where the emissions enter the atmosphere?</li> </ul>	Yes	For air pollution controls used: including process design features that minimize emissions.
Does the process description also explain how the facility or facilities will be operating when the maximum possible emissions are produced?	Yes	-
<b>G. Are details for each different filter system attached?</b>	Yes	-
Is there a description of the principle operation for each different filter system?	Yes	-
Is there an assembly drawing of the abatement device drawn to scale clearly showing the design, size, and shape?	Yes	For assembly drawings include front and top view.
Is there a manufacturers specification sheet or equivalent technical document demonstrating the central filter system's ability to meet volumetric flow and control efficiency requirements?	Yes	
<b>H. Is a Public Involvement Plan (PIP) form required for this project?</b>	Yes	All air permit applications which require public notice must now include a completed PIP form (TCEQ Form 20960)
Is the PIP Form attached?	Yes	TCEQ Form 20960.
Requirements and Forms can be found at the following link:	<a href="#">Air Permitting - Texas Commission on Environmental Quality</a>	

**Concrete Batch Plant Standard Permit Checklist: 6004**

[Click here to go back to the PI-1S-CBP sheet.](#)

This sheet provides information needed by the TCEQ to determine if the proposed project meets all of the requirements of the Standard Permit for Concrete Batch Plants under the current 2024 amendment.

[Air Quality Standard Permit for Concrete Batch Plants](#)

2. Complete all applicable sections below.

[TexasEnviroHelp - TexasEnviroHelp - Small Business and Local Government Assistance](#)

**Preliminary Questions**

Description	Response	Notes
Type of plant:	Temporary	Not an input. Linked to a response in PI-1S-CBP.
Type of operation:	Truck Mix	-
Will the owner or operator of truck mix plant(s) shelter the truck loading operation with a three-sided solid enclosure or equivalent that extends from the ground level to three feet above the truck-receiving funnel?	No	-
Are any engines being authorized in this registration?	No	-
Are multiple concrete batch plants being operated on the same site?	No	-

**Section 3: Administrative Requirements**

Condition Number	Description	Response	Notes
(3)(A)-(K)	Will you meet the requirements of Section 3 of the Standard Permit regarding administrative, record-keeping and Maintenance, Startup, and Shutdown (MSS) requirements?	Yes	-

**Section 4: Public Notice**

Condition Number	Description	Response	Notes
(4)	Will you meet all of the requirements of Section 4 of the Standard Permit regarding public notice?	Yes	-
	Is this a portable facility moving to a site for support of a public works project in which the proposed site is located in or contiguous to the right-of-way of the public works project?	No	-
	Is this a registered portable facility moving to a site in which a portable facility was located at the site at any time during the previous two years and was the site subject to public notice?	No	Not an input. Addressed in section 'Preliminary Questions' above.

**Section 5: General Requirements**

Condition Number	Description	Response	Notes
(5)(A)	Are the storage silos and auxiliary storage tanks controlled by a cartridge or filter system?	Yes	-
	How will the weigh hopper be vented?	Vented to fabric/cartridge filter	More than one may be selected using the following row.
	Select second method, if applicable.		-
(5)(B)(i)	Will fabric/cartridge filters and collection systems be operated properly with no tears or leaks?	Yes	-
(5)(B)(ii)	What is the control efficiency of the filter system (including any central filter systems) for particle sizes of 2.5 microns and smaller? (%)	99.50%	Minimum control efficiency of at least 99.5% at particle sizes of 2.5 microns and smaller.

**Texas Commission on Environmental Quality**  
**Form PI-1S-CBP**  
**6004Checklist**

Date: April 2026  
Registration #: New  
Company: Raptor Ready Mix Inc

(5)(B)(iii)	Will all filter systems meet visible emissions performance standards?	Yes	-
(5)(B)(iv)	Will cement and/or fly ash silo filter exhausts be equipped with sufficient illumination to observe visible emissions performance if filled during non-daylight hours?	Yes	-
(5)(C)(i)	Will conveying systems to and from the storage silos be properly operated, remain totally enclosed, and maintained with no tears or leaks?	Yes	-
(5)(C)(ii)	During cement/fly ash storage silo filling, except for connecting or disconnecting, will you keep a standard of having no visible emissions for more than 30 seconds in any six-minute period from the conveying system?	Yes	-
(5)(D)	What type of device is utilized onsite to warn when silos are reaching capacity?	Warning device	-
(5)(D)(ii)	If a warning device is used, will it alert operators in sufficient time to prevent an adverse impact on the pollution abatement equipment or other parts of the loading operation?	Yes	-
	Do you regularly prevent particle build-up on visible warning devices?	Yes	-
(5)(D)(iii)	Will warning devices or shut-off systems for silos and auxiliary storage tanks be tested at least monthly during operations and records kept indicating test and repair results in accordance with Section (3)(J) of this standard permit?	Yes	-
(5)(E)(i)-(iv)	Select which method(s) will be used to control emissions from in-plant roads and traffic areas. Select the second control method, if applicable. Select the third control method, if applicable. Select the fourth control method, if applicable.	(i) Watering	More than one may be selected using the following rows.
			-
			-
			-
(5)(F)	How will dust emissions from all stockpiles be minimized at all times? Select the second control method, if applicable. Select the third control method, if applicable. Will stockpiles be limited to a total ground surface area of no more than 1.5 acres.	Sprinkling with water	More than one may be selected using the following rows.
			-
			-
		Yes	-
(5)(G)	Confirm that all material spills will be immediately cleaned up and contained or dampened so dust emissions are minimized.	I agree	-
(5)(H)	Confirm visible emissions will not leave the property for more than 30 seconds in duration in any six-minute period during normal plant operations as determined using EPA Test Method 22? Will quarterly visible emission observations be performed and recorded in accordance with Section (3)(J) of this standard permit? If visible emissions exceed Test Method 22 criteria, will immediate corrective action be taken and documented?	I agree	-
		Yes	-
		Yes	-
(5)(I)	What is the distance from the concrete batch plant to any crushing plant or hot mix asphalt plant? (ft)	N/A	Unless N/A, input requires values.
(5)(J)	Are multiple concrete batch plants being operated on the same site?	No	Not an input. Addressed in section 'Preliminary Questions' above.
(5)(K)	Confirm that none of the concrete additives will emit volatile organic compounds. (VOC)	I agree	-
(5)(L)	Will all sand and aggregate be washed prior to delivery to the site?	Yes	-

**Texas Commission on Environmental Quality**  
**Form PI-1S-CBP**  
**6004Checklist**

Date: April 2026  
Registration #: New  
Company: Raptor Ready Mix Inc

(5)(M)(i)-(vii)	Will all claims under this standard permit comply with the following:	Respond below.	Not an input. Relevant for inputs below in this rule.
	30 TAC § 116.604, Duration and Renewal of Registrations to Use Standard Permits.	Yes	-
	30 TAC § 116.605(d)(1), Standard Permit Amendment and Revocation.	Yes	-
	30 TAC § 116.614, Standard Permit Fees.	Yes	-
	The public notice processes established in THSC, § 382.055, Review and Renewal of Preconstruction Permit.	Yes	-
	The public notice processes established in THSC, § 382.056,	Yes	-
	The contested case hearing and public notice requirements established in 30 TAC § 55.152(a)(2), Public Comment Period.	Yes	-
(5)(N)	The contested case hearing and public notice requirements established in 30 TAC § 55.201(h)(i)(C), Requests for Reconsideration or Contested Case Hearing?	Yes	-
	Will the owner or operator comply with 30 TAC § 101.4, Nuisance?	Yes	-

<b>Section 7: Planned Maintenance, Startup, and Shutdown (MSS) Activities</b>			
Condition Number	Description	Response	Notes
(7)	Will planned maintenance activities receive separate authorization, unless the activity can meet the conditions of 30 TAC § 116.119. De Minimis Facilities or Sources?	Yes	-

<b>Section 8: Operational Requirements for Permanent and Temporary Concrete Plants</b>			
Condition Number	Description	Response	Notes
8(A)(i)	Will the single truck mix plant operate under the requirements in subsection (8)(E) and comply with the production rate and setback distance limits found in Table 1?	Yes	-
	What is the production rate of the single truck mix plant with the shrouded mixer truck-receiving funnel? (yd <sup>3</sup> /hr)	200	Production rates must be no more than the 200 cubic yards per hour limit.
	What is the setback distance of the single truck mix plant with the shrouded mixer truck-receiving funnel? (ft)	100	Setback distances should be a minimum of 100 ft.



**Table 20: Concrete Batch Plants – Concrete Batch Plant Standard Permits**

[Click here to go back to the 6024 Checklist TPW sheet.](#)

This sheet provides information needed by the TCEQ to determine if the proposed project meets all of the requirements of the Standard Permit for Concrete Batch Plants.

<b>Type of batching that will be accomplished</b>	Truck mix
---	-----------

**Section 1: Maximum operating schedule**

Requested Information	Response
What is the maximum hours per day?	24
What is the maximum days per week?	7
What is the maximum weeks per year?	52
What is the maximum hours per year?	8760

**Section 2: Aggregate Information**

Requested Information	Response
Will sand and aggregate be washed prior to delivery at your site?	Yes
What is the total ground surface area of aggregate stockpiles? (acres)	1.5
Indicate where water sprays will be used, if applicable.	
Additional location for water sprays, if applicable.	
Additional location for water sprays, if applicable.	
Additional location for water sprays, if applicable.	

**Section 3: Filter System Information**

Requested Information	Response
How many filter systems will this plant have?	3
Will all filter systems be operated the same way?	No

**Table 11: Fabric Filters – Concrete Batch Plant Standard Permits**

[Click here to go back to the Table20 sheet.](#)

This sheet provides information needed by the TCEQ to determine if the proposed project meets all of the requirements of the Standard Permit for Concrete Batch Plants.

**Filter System 1**

Requested Information	Response
EPN:	5
Manufacturer:	WAM
Model Number:	Silotop Zero
List the sources being controlled:	Silo & Pig
Type of particulate controlled:	PM/PM10/PM2.5, cement dust
Design maximum flow rate: (acfm)	1,500
Average expected flow rate: (acfm)	1,500
Inlet: Particulate grain loading: (grain/scf)	
Outlet: Particulate grain loading: (grain/scf)	<0.01

**Filter System 2**

Requested Information	Response
EPN:	6
Manufacturer:	C&W
Model Number:	CP-35
List the sources being controlled:	Weigh Hopper
Type of particulate controlled:	PM/PM10/PM2.5, cement dust
Design maximum flow rate: (acfm)	216
Average expected flow rate: (acfm)	216
Inlet: Particulate grain loading: (grain/scf)	
Outlet: Particulate grain loading: (grain/scf)	<0.01

**Filter System 3**

Requested Information	Response
EPN:	8
Manufacturer:	C&W
Model Number:	CP-7500
List the sources being controlled:	Truck Loadout
Type of particulate controlled:	PM/PM10/PM2.5, cement dust
Design maximum flow rate: (acfm)	7500
Average expected flow rate: (acfm)	7500
Inlet: Particulate grain loading: (grain/scf)	
Outlet: Particulate grain loading: (grain/scf)	<0.01

**Public Notice Information and Small Business Classification**

[Click here to go back to Table29 Sheet.](#)

This sheet is intended to assist in this determination of public notice requirements and is not a replacement for 30 TAC Chapter 39 (Public Notice). **If you can see the page header, there are questions applicable to your** The THSC §382.056 and corresponding rules in 30 TAC Chapter 39 (Public Notice) require that you publish a [Public Notice Requirements for Air Permit Applications](#)

**Instructions:**

**I. Public Notice Information**

**A. Contact Information**

Enter the contact information for the **person responsible for publishing**. This is a designated representative

Requested Information	Response
Prefix (Mr., Ms., Dr., etc.):	Ms.
First Name:	Debbi
Last Name:	Mathews
Title:	Public Notice Manager
Company Name:	Westward Environmental, Inc.
Mailing Address:	P.O. Box 2205
Address Line 2:	
City:	Boerne
State:	TX
ZIP Code:	78006
Telephone Number:	830-249-8284
Fax Number:	830-249-0221
Email Address:	dmathews@westwardenv.com

Enter the contact information for the **Technical Contact**. This is the designated representative who will be listed

Requested Information	Response
Prefix (Mr., Ms., Dr., etc.):	Mrs.
First Name:	Melissa
Last Name:	Fitts
Title:	Senior Vice President
Company Name:	Westward Environmental, Inc.
Mailing Address:	P.O. Box 2205
Address Line 2:	
City:	Boerne
State:	TX
ZIP Code:	78006
Telephone Number:	830-249-8284
Fax Number:	830-249-0221
Email Address:	mfitts@westwardenv.com

**B. Public place**

Requested Information	Response
Name of Public Place:	Crowley Public Library
Physical Address:	409 S. Oak Street
Address Line 2:	
City:	Crowley
ZIP Code:	76036
County:	Tarrant
Has the public place granted authorization to place the application for public viewing and copying?	Yes

**C. Alternate Language Publication**

Requested Information	Response
Is a bilingual program required by the Texas Education Code in the School District?	Yes
Are the children who attend either the elementary school or the middle school closest to your facility eligible to be enrolled in a bilingual program provided by the district?	Yes
If yes to either question above, list which language(s) are required by the bilingual program?	Spanish
List second required language:	Vietnamese
List third required language:	
List fourth required language:	

**III. Small Business Classification**

Complete this section to determine small business classification. If a small business requests a permit, agency

Requested Information	Response
Does the company (including parent companies and subsidiary companies) have fewer than 100 employees or less than \$6 million in annual gross receipts?	Yes
Is the site a major source under 30 TAC Chapter 122, Federal Operating Permit Program?	No
Are the site emissions of any individual air contaminant greater than or equal to 50 tpy?	No
Are the site emissions of all air contaminants combined greater than or equal to 75 tpy?	No
Small business classification:	Yes

**IV. Plain Language Summary**

Applications deemed administratively complete by May 1, 2022 must provide a plain language summary of the [New Source Review Application Tools](#)

Requested Information	Response
Is a Plain Language Summary as required by 30 TAC § 39.405(k) provided with the application?	Yes
Is a Plain Language Summary in an alternative language as required by 30 TAC § 39.426(c) provided with the application?	Yes

<b>Fee Verification</b>	
<a href="#">Click here to go back to the Public Notice sheet.</a>	
This sheet is for requesting expedited permitting and determines application fee requirements for projects which require a <a href="#">ePay, TCEQ's online payment application</a>	
<b>Instructions:</b>	
<b>I. Expedited Permitting Request</b>	
Requested Information	Response
Are you requesting to expedite this project?	Yes
Does the purpose of the application associated with this request to expedite benefit the economy of this state or an area of this state. If no, this project does not qualify for expedited permitting.	Yes
Surcharge amount due	\$3,000.00
Surcharge amount paid	\$3,000.00
Enter the check, money order, ePay Voucher, or other transaction number. Enter "STEERS" if submitting and paying through STEERS.	STEERS
<b>Unless submitting through STEERS, you must also submit the Form APD-APS Air Permitting Surcharge Payment Fees for Air Permitting</b>	
<b>II. Application Fee</b>	
All standard permit types and actions (unless the facility meets the requirements of being in or adjacent to the right of way of a public works project)	\$900.00
<b>III. Payment Information</b>	
Requested Information	Response
Was the fee paid online?	Yes
Enter the fee amount	\$ 900.00
Enter the check, money order, ePay Voucher, or other transaction number. Enter "STEERS" if submitting and paying through STEERS.	STEERS
Enter the company name as it appears on the check	N/A
<b>IV. Professional Engineer Seal Requirement</b>	
Requested Information	Response
Is the estimated capital cost of the project above \$2 million?	No
Is the application required to be submitted under the seal of a Texas licensed P.E.? Note: an electronic PE seal is acceptable.	No

**Plain Language Summary for Concrete Batch Plant Standard Permit  
Application for Concrete Batch Plant Standard Permit Registration Number (New)**

*The following summary is provided for this pending air permit application being reviewed by the Texas Commission on Environmental Quality as required by 30 Texas Administrative Code Chapter 39. The information provided in this summary may change during the technical review of the application and are not federal enforceable representations of the permit application.*

Raptor Ready Mix Inc (CN606227288) has submitted an application to register a temporary concrete batch plant under the Air Quality Standard Permit for Concrete Batch Plants for registration number (New). The concrete batch plant (RN112001938) will be located on the east side of South Fwy approximately 0.3 mile south of Garden Acres Drive in Fort Wort, Tarrant County.

This registration will authorize the concrete batch plant to have a maximum production rate of less than 200 cubic yards per hour of concrete and operate up to 8760 hours per year. Particulate matter will be emitted from the handling of aggregate, cement, and flyash. Roads, traffic areas, and stockpiles will be watered to control dust. Enclosures and baghouses will be used to control cement and flyash dust.

## **Resumen en Lenguaje Sencillo del Permiso Estándar para Plantas de Hormigón Solicitud de Permiso Estándar para Plantas de Hormigón Número de Registro (Nuevo)**

*El siguiente resumen se proporciona para esta solicitud de permiso de aire pendiente que está siendo revisada por la Comisión de Calidad Ambiental de Texas, según lo dispuesto en el capítulo 39 del Código Administrativo de Texas. La información proporcionada en este resumen puede cambiar durante la revisión técnica de la solicitud y no son representaciones federales ejecutables de la solicitud de permiso.*

Raptor Ready Mix Inc (CN606227288) ha presentado una solicitud de registro de planta temporal de hormigón en virtud del Permiso de la Norma de Calidad del Aire para Plantas de Hormigón para el número de registro (Nuevo). La planta de hormigón (RN112001938) estará ubicada en el lado este de South Fwy aproximadamente 0,3 milla al sur de Garden Acres Drive en Fort Worth, Condado de Tarrant.

Este registro autorizará a la planta de hormigón a tener una producción máxima de menos que 200 yardas cúbicas por hora de hormigón y a operar hasta 8760 horas al año. Se emitirán partículas por la manipulación de áridos, cemento y cenizas volantes. Las carreteras, las zonas de tráfico, y los acopios serán regados para controlar el polvo. Para el control del polvo de cemento y cenizas volantes se utilizarán cerramientos y filtros de mangas.

## **Tóm tắt bằng ngôn ngữ phổ thông về Đơn xin Cấp phép Tiêu chuẩn cho Trạm trộn Bê tông Số đăng ký Giấy phép Tiêu chuẩn cho Trạm trộn Bê tông (Mới)**

*Bản tóm tắt dưới đây được cung cấp cho đơn xin cấp phép khí thải hiện đang chờ xử lý và được Ủy ban Chất lượng Môi trường Texas (Texas Commission on Environmental Quality) xem xét, theo yêu cầu của Chương 39, Bộ luật Hành chính Texas (Texas Administrative Code), Tiêu đề 30. Thông tin được cung cấp trong bản tóm tắt này có thể thay đổi trong quá trình xem xét kỹ thuật đối với đơn xin cấp phép, và không được coi là những tuyên bố mang tính ràng buộc pháp lý ở cấp liên bang đối với nội dung của đơn xin cấp phép đó.*

Raptor Ready Mix Inc (CN606227288) đã nộp đơn đăng ký thiết lập một trạm trộn bê tông tạm thời theo Giấy phép Tiêu chuẩn về Chất lượng Không khí dành cho các Trạm trộn Bê tông, với số đăng ký (Mới). Trạm trộn bê tông này (RN112001938) sẽ được đặt tại phía đông của đường South Fwy, cách đường Garden Acres Drive khoảng 0,3 dặm về phía nam, thuộc thành phố Fort Worth, Quận Tarrant.

Việc đăng ký này sẽ cho phép trạm trộn bê tông đạt công suất sản xuất tối đa dưới 200 yard khối bê tông mỗi giờ và hoạt động tối đa 8.760 giờ mỗi năm. Bụi sẽ được phát thải từ quá trình xử lý cốt liệu, xi măng và tro bay. Đường sá, khu vực giao thông và bãi chứa vật liệu sẽ được tưới nước để kiểm soát bụi. Các thiết bị che chắn và hệ thống lọc bụi túi sẽ được sử dụng để kiểm soát bụi xi măng và tro bay.



Texas Commission on Environmental Quality

## Public Involvement Plan Form for Permit and Registration Applications

The Public Involvement Plan is intended to provide applicants and the agency with information about how public outreach will be accomplished for certain types of applications in certain geographical areas of the state. It is intended to apply to new activities; major changes at existing plants, facilities, and processes; and to activities which are likely to have significant interest from the public. This preliminary screening is designed to identify applications that will benefit from an initial assessment of the need for enhanced public outreach.

All applicable sections of this form should be completed and submitted with the permit or registration application. For instructions on how to complete this form, see TCEQ-20960-inst.

### Section 1. Preliminary Screening

- New Permit or Registration Application  
 New Activity - modification, registration, amendment, facility, etc. (see instructions)

**If neither of the above boxes are checked, completion of the form is not required and does not need to be submitted.**

### Section 2. Secondary Screening

- Requires public notice,  
 Considered to have significant public interest, **and**  
 Located within any of the following geographical locations:
- Austin
  - Dallas
  - Fort Worth
  - Houston
  - San Antonio
  - West Texas
  - Texas Panhandle
  - Along the Texas/Mexico Border
  - Other geographical locations should be decided on a case-by-case basis

**If all the above boxes are not checked, a Public Involvement Plan is not necessary.  
Stop after Section 2 and submit the form.**

- Public Involvement Plan not applicable to this application. Provide **brief** explanation.

Significant public interest is not expected.

**Raptor Ready Mix Inc**  
**New Air Quality Standard Permit for Temporary Concrete Batch Plant**  
**Concrete Batch Plant SN7592**  
**Fort Worth, Tarrant County, Texas**

Project Description

Pursuant to a new Air Quality Standard Permit for a Temporary Concrete Batch Plant, Raptor Ready Mix Inc proposes to authorize construction and operation of a temporary concrete batch plant to be located on the east side of South Fwy approximately 0.3 mile south of Garden Acres Drive within the city limits of Fort Worth, Tarrant County, Texas. This temporary facility will support construction of the Huguley Development project.

The total site-wide production will not exceed 200 cubic yards per hour and 650,000 cubic yards per year. The facility will be located on site temporarily for completion of a single project with a maximum operating schedule of less than 24 hours per day, 7 days per week, and 52 weeks per year.

The facility's central dust collector exhaust and silo will be located at least 100 feet from any property line as required. Stationary equipment, stockpiles, and vehicles used for operation of the concrete batch plant (except for incidental traffic and the entrance/exit to the site) will be located and operated more than 50 feet from the property line as required.



Any emissions from planned Startup and Shutdown activities are not expected to be any worse over a full hour than emissions during normal operation, and thus should be included in this permit authorization. Any planned maintenance activities for this facility will be considered De Minimis (30 TAC 116.119) or authorized under a separate Permit By Rule (30 TAC 106), as necessary.

Raptor Ready Mix Inc will utilize BACT at the subject facility. The truck loadout is sheltered by an intact three-sided shroud vented to the central dust collector. The silo is controlled by a silo top dust collector. The pig is vented to the silo, thus controlled by the same silo top dust collector. The weigh hopper is controlled by its own bin vent dust collector. In-plant roads, traffic areas associated with operation of the concrete batch plant, and stockpiles will be sprinkled with water as necessary to minimize dust emissions.

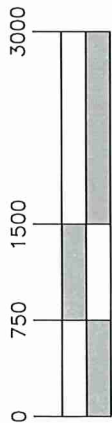
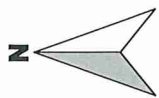
A Form PI-1S, checklists, tables, maps, emission calculations, and supporting documents have been submitted with this application.



SCALE: 1" = 1500'

-  RESIDENCE
-  HOSPITAL
-  INDUSTRIAL

3000-FOOT  
OFFSET OF  
PROPERTY LINE

GARDEN ACRES

APPROX.  
PLANT  
LOCATION

APPROX.  
PROPERTY  
LINE

Texas  
Health  
Hospital  
Fort  
Worth  
Souths

THE PARKS OF  
DEER CREEK

Deer  
Creek  
Park

COVENTRY

EST. 1996

# WESTWARD

Environmental • Geology • Engineering  
P.O. Box 2205 Boerne, Texas 78006  
(830) 249-8284 Fax: (830) 249-0221  
TBPE REG. NO.: F-4524  
TBPG REG. NO.: 50112

### AREA MAP

EXP TEMP SP CBP  
RAPTOR READY MIX, INC.  
FORT WORTH, TARRANT COUNTY, TEXAS

DESCRIPTION

BY

DATE

REV.

IMAGE:

BING ROAD MAP

ISSUE DATE: 04/28/2026

DRAWN BY: KS

CHECKED BY: MF

SCALE: 1" = 1500'

JOB NO.: 11616-007

SHEET NO.:

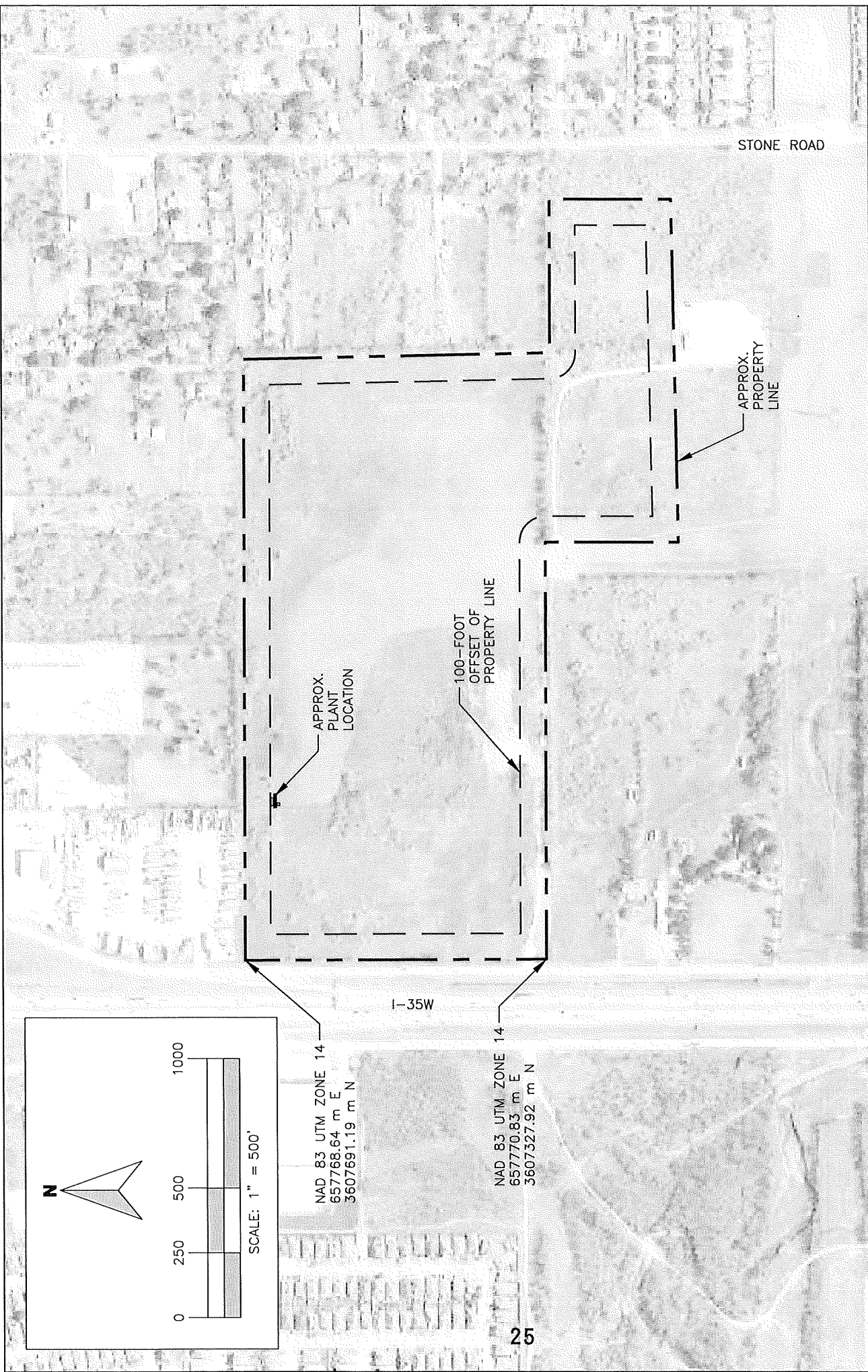
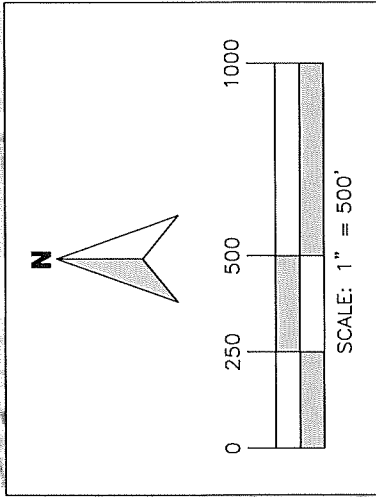

NAD 83 UTM ZONE 14  
657768.64 m E  
3607691.19 m N

NAD 83 UTM ZONE 14  
657770.83 m E  
3607327.92 m N

I-35W

STONE ROAD

APPROX.  
PROPERTY  
LINE

APPROX.  
PLANT  
LOCATION

100-FOOT  
OFFSET OF  
PROPERTY LINE

EST. 1996

**WESTWARD**  
Environmental • Geology • Engineering  
P.O. Box 2205 Boerne, Texas 78006  
(830) 249-8284 Fax: (830) 249-0221  
TBPE REG. NO.: F-4524  
TBPG REG. NO.: 50112

--

**PLOT PLAN**  
EXP TEMP SP CBP  
RAPTOR READY MIX, LLC  
FORT WORTH, TARRANT COUNTY, TEXAS

REV.	DESCRIPTION	BY	DATE

IMAGE:	BING AERIAL
ISSUE DATE:	04/28/2026
DRAWN BY:	KS
CHECKED BY:	MF
SCALE:	1" = 500'
JOB NO.:	11616-007

SHEET NO.:

**2**

OF 3

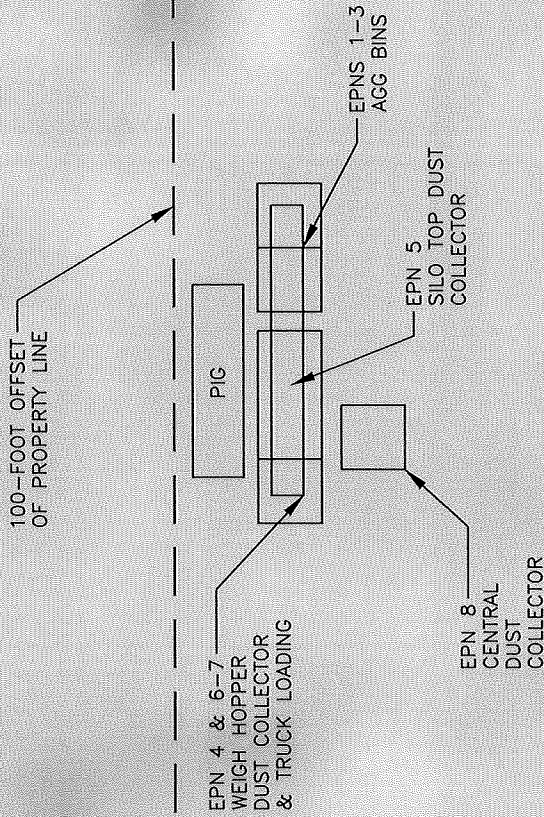
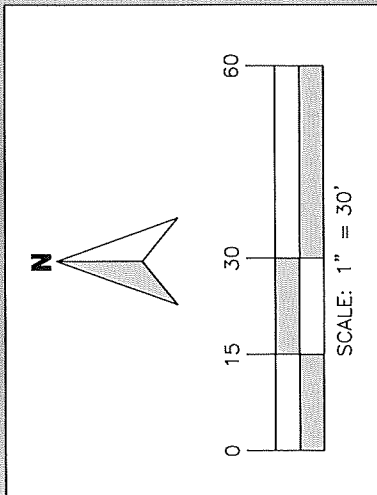

IMAGE:	BING AERIAL
ISSUE DATE:	04/28/2026
DRAWN BY:	KS
CHECKED BY:	MF
SCALE:	1" = 30'
JOB NO.:	11616-007

SHEET NO.:

**3**

OF 3

### DETAILED PLOT PLAN

EXP TEMP SP CBP  
 RAPTOR READY MIX, LLC  
 FORT WORTH, TARRANT COUNTY, TEXAS

REV.	DESCRIPTION	BY	DATE

EST. 1996

**WESTWARD**  
 Environmental • Geology • Engineering  
 P.O. Box 2205 Boerne, Texas 78006  
 (830) 249-8284 Fax: (830) 249-0221  
 TBPE REG. NO.: F-4524  
 TBPG REG. NO.: 50112

**Raptor Ready Mix Inc**  
**New Air Quality Standard Permit for Temporary Concrete Batch Plant**  
**Concrete Batch Plant SN7592**  
**Fort Worth, Tarrant County, Texas**

Process Description

Washed sand and aggregate materials are delivered to the facility location by trucks and placed in appropriate stockpiles (EPN STK) by size. Other materials such as cement, flyash, and admixtures used to change the properties of the concrete are also transported and delivered to the plant by truck.

Sand and aggregates are delivered from the stockpiles to the aggregates storage bins (EPN 1) by a front-end loader. The material falls into the aggregate weigh bins (EPN 2) and measured amounts are transferred (EPN 3) to a conveyor to the mixer trucks at the batch point (EPN 4).

Cement and flyash are transferred to the silo and pig pneumatically and delivered to the cement weigh hopper for measurement. The desired amount of materials are transferred to the truck batch point where sand, aggregate, cement, flyash, admixtures, and water are combined and mixed by trucks which deliver the wet concrete to the desired location onsite.

The truck loadout is sheltered by an intact three-sided shroud vented to the central dust collector (EPN 8). The silo is controlled by a silo top dust collector (EPN 5). The pig is vented to the silo, thus controlled by the same silo top dust collector. The weigh hopper is controlled by its own bin vent dust collector (EPN 6). The loading of trucks (EPN 7) accounts for any cement/flyash not captured by the central dust collector.

Please refer to the flow diagram included in this application in order to follow the process description detailed above.

# Process Flow Diagram

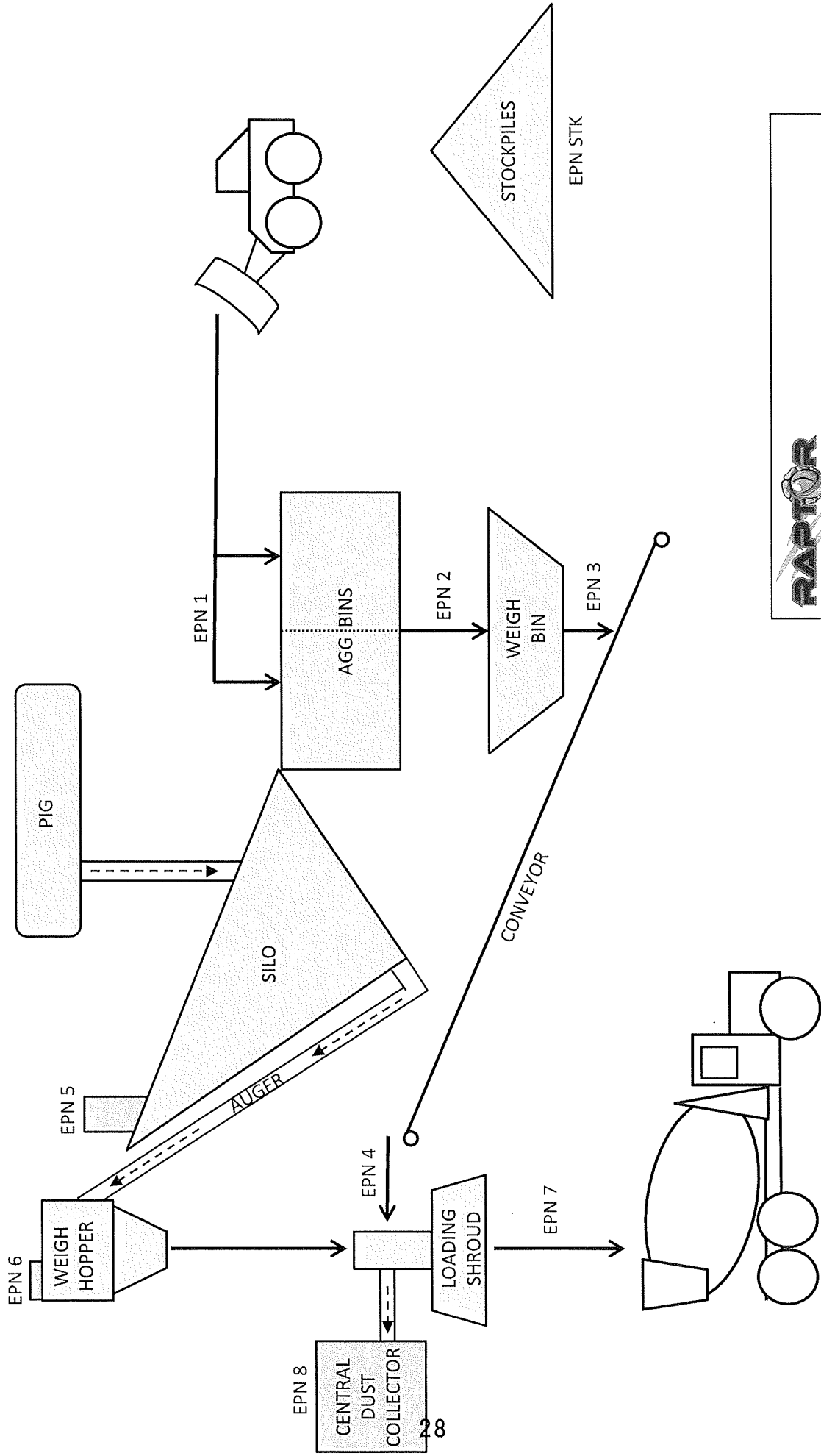

**RAPTOR**  
Raptor Ready Mix Inc  
Fort Worth, Tarrant County, Texas

## General Plant Information

This worksheet is used to document the material composition and maximum expected production level. The values entered will be used to calculate the estimated emission rates in subsequent worksheets within this workbook.

**Instructions:**

1. Enter the requested information in the input cells below, or if prompted, select the appropriate answer from the drop-down menu provided.

<b>Operating Schedule</b>	hours/day	days/week	weeks/year	hours/year
	24	7	52	8,760
<b>Concrete Production Rate</b>	yd <sup>3</sup> / hour	yd <sup>3</sup> / year		
	200	650,000		
<b>Type of Batch Plant</b>	Truck or Central Mix?			
	Truck Mix			

**Concrete Composition**

Would you like to use the default composition of concrete?		Yes
<b>Material</b>	<b>Default (lbs/yd3)</b>	
Aggregate	1,865	
Sand	1,428	
Cement	491	
Supplement	73	

**Maximum Material Mass Flow Rate**

<b>Material</b>	<b>ton/hr</b>	<b>ton/yr</b>
Aggregate	186.5	606,125.0
Sand	142.8	464,100.0
Cement	49.1	159,575.0
Supplement	7.3	23,725.0

### Material Handling & Stockpile Emissions

This worksheet is used to calculate emissions from material handling and stockpiles. Enter the requested information in the input cells, or if prompted, select the appropriate answer using the drop-down menu provided.

A list of commonly accepted emission control methods and their associated efficiency ratings are provided below:

- Wet material = 50%
- Water sprays = 70%
- Chemical foam = 80%
- Partial enclosure = 50 - 85%
- Full enclosure = 90%
- Enclosed by building = Up to 90%
- Washed material = 95%
- Washed material with water spray = 98.5%

#### Material Handling - Coarse Aggregate Transfer Points

Enter the number of Aggregate Transfer Points	4		Maximum Mass Flow Rate (ton/hr)	187
Use the maximum material mass flow rate?	Yes		Maximum Mass Flow Rate (ton/yr)	606,125

Emission Point Number	1	2	3	4
Hourly Mass Flow Rate (ton/hr) =	187			
Annual Mass Flow Rate (ton/yr) =	606,125			
Control Type	Washed	Washed	Washed	Washed
Control Efficiency (%)	95	95	95	95
PM (lb/hr)	0.0643	0.0643	0.0643	0.0643
PM (ton/yr)	0.1046	0.1046	0.1046	0.1046
PM <sub>10</sub> (lb/hr)	0.0308	0.0308	0.0308	0.0308
PM <sub>10</sub> (ton/yr)	0.0500	0.0500	0.0500	0.0500
PM <sub>2.5</sub> (lb/hr)	0.0047	0.0047	0.0047	0.0047
PM <sub>2.5</sub> (ton/yr)	0.0076	0.0076	0.0076	0.0076

#### Material Handling - Sand Transfer Points

Enter the number of Sand Transfer Points	4		Maximum Mass Flow Rate (ton/hr)	143
Use the maximum material mass flowrate?	Yes		Maximum Mass Flow Rate (ton/yr)	464,100

Emission Point Numbers	1	2	3	4
Hourly Mass Flow Rate (ton/hr) =	143			
Annual Mass Flow Rate (ton/yr) =	464,100			
Control Type	Washed	Washed	Washed	Washed
Control Efficiency (%)	95	95	95	95
PM (lb/hr)	0.0150	0.0150	0.0150	0.0150
PM (ton/yr)	0.0244	0.0244	0.0244	0.0244
PM <sub>10</sub> (lb/hr)	0.0071	0.0071	0.0071	0.0071
PM <sub>10</sub> (ton/yr)	0.0115	0.0115	0.0115	0.0115
PM <sub>2.5</sub> (lb/hr)	0.0011	0.0011	0.0011	0.0011
PM <sub>2.5</sub> (ton/yr)	0.0017	0.0017	0.0017	0.0017

#### Raw Material Stockpile Emissions

Stockpile Emission Point Number	STK
Stockpile Area (acres)	1.5
Control Type	Washed
Control Efficiency (%)	95
Number of Active Days per Year	365
PM Inactive Emissions (ton/yr)	0.0000
PM <sub>10</sub> Inactive Emissions (ton/yr)	0.0000
PM <sub>2.5</sub> Inactive Emissions (ton/yr)	0.0000
PM Active Emissions (ton/yr)	0.1807
PM <sub>10</sub> Active Emissions (ton/yr)	0.0903
PM <sub>2.5</sub> Active Emissions (ton/yr)	0.0136
<b>TOTAL PM Emissions (ton/yr)</b>	<b>0.1807</b>
<b>TOTAL PM<sub>10</sub> Emissions (ton/yr)</b>	<b>0.0903</b>
<b>TOTAL PM<sub>2.5</sub> Emissions (ton/yr)</b>	<b>0.0136</b>

## Silo Emissions

This worksheet is used to calculate emissions from storage silos. Enter the requested information in the input cells below, or if prompted, select the appropriate answer from the drop-down menu provided.

### Cement Silo Emissions

How many cement silos? (Up to 4)	2
Would you like to use the manufacturer's filter efficiency?	Yes

Emission Factors - Cement Silo		
lb <sub>PM</sub> /ton	lb <sub>PM10</sub> /ton	lb <sub>PM2.5</sub> /ton
0.730	0.470	0.080
Cement Silo EPN(s)		5
Hourly Loading Rate (ton/hr)	49	N/A
Annual Loading Rate (ton/yr)	159,575	Vented to Silo
Control Efficiency (%)	99.5	
PM (lb/hr)	0.1792	
PM (ton/yr)	0.2912	
PM <sub>10</sub> (lb/hr)	0.1154	
PM <sub>10</sub> (ton/yr)	0.1875	
PM <sub>2.5</sub> (lb/hr)	0.0197	
PM <sub>2.5</sub> (ton/yr)	0.0321	

### Supplement Silo Emissions

How many supplement silos? (Up to 4)	0
Would you like to use the manufacturer's filter efficiency?	

Emission Factors - Supplement Silo		
lb <sub>PM</sub> /ton	lb <sub>PM10</sub> /ton	lb <sub>PM2.5</sub> /ton
Cement Supplement Silo EPN(s)		
Hourly Loading Rate (ton/hr)		
Annual Loading Rate (ton/yr)		
PM (lb/hr)		
PM (ton/yr)		
PM <sub>10</sub> (lb/hr)		
PM <sub>10</sub> (ton/yr)		
PM <sub>2.5</sub> (lb/hr)		
PM <sub>2.5</sub> (ton/yr)		

### Cement/Supplement Weigh Hopper Emissions

Is there a cement/supplement weigh hopper?	Yes
What is the EPN for the cement/supplement weigh hopper?	6
Is it equipped with its own dust collector?	Yes

Please select your preferred method of calculating emissions from the dust collector:	System Efficiency
Control Efficiency (%)	99.5
Mass Flow Rate (ton/hr)	56
Mass Flow Rate (ton/yr)	183,300
PM (lb/hr)	0.0302
PM (ton/yr)	0.0491
PM <sub>10</sub> (lb/hr)	0.0143
PM <sub>10</sub> (ton/yr)	0.0232
PM <sub>2.5</sub> (lb/hr)	0.0022
PM <sub>2.5</sub> (ton/yr)	0.0035

## Loading and Baghouse Emissions

This worksheet is used to calculate emissions from a baghouse stack and truck/mixer loading. Enter the requested information in the input cells below, or if prompted, select the appropriate answer from the drop-down menu provided. Emission rates are automatically calculated and displayed in the table at the bottom of the worksheet.

### Truck Loading Information

What is the EPN for fugitive emissions from central/truck mixer loading?	7
What is the central baghouse stack EPN?	8
What is the central baghouse efficiency? (%)	99.5
Use the Default Suction Shroud Capture Efficiency?	Yes

**Default Capture Efficiency % = 97.3**

Maximum Throughput		
Material	ton/hr	ton/yr
Aggregate	187	606,125
Sand	143	464,100
Cement	49	159,575
Supplement	7	23,725

Truck Loading Emission Factors		
lb <sub>PM</sub> /ton	lb <sub>PM10</sub> /ton	lb <sub>PM2.5</sub> /ton
1.118	0.310	0.053

Pollutant	Central Baghouse Stack Emission Rates	Truck Loading Fugitive Emission Rates
PM (lb/hr)	0.3068	1.7025
PM (ton/yr)	0.4985	2.7665
PM10 (lb/hr)	0.0851	0.4721
PM10 (ton/yr)	0.1382	0.7671
PM2.5 (lb/hr)	0.0145	0.0807
PM2.5 (ton/yr)	0.0236	0.1312

## Emissions Summary Table

This worksheet compiles and displays the calculated emission rates for each source of air emissions listed within this workbook.

Emission Point Number(s)	Name	PM			PM <sub>10</sub>			PM <sub>2.5</sub>		
		lb/hr	ton/yr	lb/hr	ton/yr	lb/hr	ton/yr	lb/hr	ton/yr	
1 - 4	Material Handling	0.317	0.516	0.151	0.246	0.023	0.037			
STK	Stockpiles	---	0.181	---	0.090	---	0.014			
8	Central Baghouse Stack	0.307	0.498	0.085	0.138	0.015	0.024			
7	Loading Fugitives	1.702	2.767	0.472	0.767	0.081	0.131			
6	Cement Weigh Hopper	0.030	0.049	0.014	0.023	0.002	0.004			
5	Silo	0.179	0.291	0.115	0.188	0.020	0.032			
N/A	Pig *									

\* The pig is vented to the silo

## References

The purpose of this worksheet is to provide information regarding the source of emission factors and capture efficiencies that were used throughout this workbook. Emission Factors are in units of pound (lb) of pollutant per ton of material (see footnote "a" from AP-42 Ch. 11.12 Table 11.12-2) unless specified otherwise.

---

### Concrete Composition

---

The default composition of concrete is from AP-42 Ch. 11.12 Concrete Batching. Footnote "a" from AP-42 Ch. 11.12 Table 11.12-2

---

### Material Handling - Sand and Aggregate Transfer Points

---

The emission factors are from AP-42 Ch. 11.12 Table 11.12-2. The PM<sub>2.5</sub> emission factors are based on a ratio of the aerodynamic particle size multipliers (k multiplier) represented in Aggregate Handling and Storage Piles AP-42 Ch. 13.2.4. The emission factors for PM and PM<sub>10</sub> listed in Ch. 11.12 for material transfer points are derived using the Aggregate Handling and Storage Piles AP-42 Ch. 13.2.4 equation. See AP-42 Ch. 11.12 Table 11.12-2 footnote "b".

---

### Raw Material Stockpile Emissions

---

Emission Factors for the stockpiles have the following units: lb of pollutant per acre per day. The PM active and inactive emission factors are from "Cowherd, Jr., C. Development Of Emission Factors For Fugitive Dust Sources. EPA document Number. EPA-450/3-74-037. Research Triangle Park: U. S. Environmental Protection, 1974". PM<sub>10</sub> is estimated as 50% of PM based on the "k" factors listed in Aggregate Handling and Storage Piles AP-42 Ch. 13.2.4. The PM<sub>2.5</sub> factor is derived from a ratio listed in the Background Document for Revisions to Fine Fraction Ratios Used for AP-42 Fugitive Dust Emission Factors (Ch. 13.2) and "k" factors listed in Aggregate Handling and Storage Piles AP-42 Ch. 13.2.4.

---

### Material Silos

---

The emission factors are from AP-42 Ch. 11.12 Table 11.12-2. Emission factor units are lb of pollutant per ton of material. The emission factor for PM<sub>2.5</sub> was assumed to be 17.1% of PM<sub>10</sub>. The value of 17.1% represents the percentage of PM<sub>10</sub> that is PM<sub>2.5</sub> according to the worst case loading emission factors for a truck mix operation. The PM<sub>2.5</sub> factors listed in the AP-42 documents for truck and mixer loading are based on lbPM<sub>2.5</sub> per ton cement and cement supplement (see Loading Emission Rates). The worst case percentage of PM<sub>2.5</sub> in PM<sub>10</sub> from the EPA loading factors is 17.1%.

---

### Cement/Supplement Weigh Hopper Emissions

---

Emission factors are not quantified for this potential emission point. Since an emission factor was not quantified there are three preferred approaches: assume the emissions negligible if it is vented to another device meeting BACT; treat it as a material drop point and apply a control efficiency; and the outlet grain loading method. The control efficiency method is used in conjunction with the Aggregate Handling and Storage Piles AP-42 Ch. 13.2.4 equation to estimate emissions. The same wind speed used to develop the aggregate drop point emission factors listed in AP-42 Ch. 11.12 Table 11.12-2 was used in the Ch.13 Equation. The lowest acceptable moisture content of 0.25% was assumed.

---

### Loading Emission Rates

---

PM emission factor units are lb of pollutant per ton of cement and cement supplement. Emission factors (PM & PM<sub>10</sub>) are from AP-42 Ch. 11.12 Table 11.12-2. The emission factors for PM<sub>2.5</sub> are located in AP-42 Ch. 11.12 Background Document Table 18.6. The default emissions captured by the suction shroud is the average listed in AP-42 Ch 11.12 Background Document Table 17.1 and Table 17.2.

# CP-Series Silo Dust Collectors

## General Information

C&W's CP-Series of Silo Dust Collectors offer you Pulse-Jet Technology combined with our cartridge filters to provide a highly effective, yet inexpensive solution for dust control. Our CP Silo Collectors are engineered by dust control specialists with careful attention to efficiency and user-friendliness. Also, available are weigh batcher collectors and round silo collectors.

## Options

- Pressure Switch for Automatic Cleaning
- Mini-helic Gauge
- Custom Designs and Sizes
- Special Mounting Flange for Adapting to Existing Flange
- Blower Packages, Standard or Custom-Built
- Special Filter Media
- Silo Anti-Overflow System
- Pressure Relief Valves and Bin Indicators

## Specs

Benefits	Features:
Easy to Maintain	Tool-less Exchange of Filter Media Top Entry for Clean Side Filter Exchange
Efficiency	99.99% Filtration Efficiency*
Efficiency, Compact	Vertical, Wide-Pleat Cartridges
Performance	Inlet Air Regulator and Moisture Separator Test Ports for Monitoring Filter Media
Reliable, Easy to Operate	Solid State Adjustable Timers w/ LED Display
Long-Lasting, Durable	12 Gauge, Heavy Duty Steel Construction

Specifications	CP-35	CP-70	CP-100	CP-230	CP-305	CP450-1239
Total Filtration Area (sq. ft.)	44	88	110	276	368	552
Number of Cartridges	2	4	1	6	8	12
Air to Cloth Ratio	4.9	4.9	3.64	3.07	5.43	4.52
Cartridge Size	8" x 19"	8" x 19"	12" x 27"	8" x 39"	8" x 39"	8" x 39"
Static Pressure Drop	6"	6"	6"	6"	6"	6"
Approx. Weight (lbs.)	165	300	450	610	975	1025
Compressed Air Req.	2	2	1	2	3	3
CFM Recommended	216	432	400	850	2000	2500
Min. Design Efficiency*	99.99%	99.99%	99.99%	99.99%	99.99%	99.99%
Cleaning Mechanism	Pulse Jet	Pulse Jet	Pulse Jet	Pulse Jet	Pulse Jet	Pulse Jet

Specifications	CP-610	CP-760	CP-900	CP-1220	CP-1520
Total Filtration Area (sq. ft.)	827	1034	1240	1654	2068
Number of Cartridges	8	10	12	16	20
Air to Cloth Ratio	3.67	3.86	4.03	4.05	4.11
Cartridge Size	8" x 78"	8" x 78"	8" x 78"	8" x 78"	8" x 78"
Static Pressure Drop	6"	6"	6"	6"	6"
Approx. Weight (lbs.)	1,395	1,495	3,000	4,000	4,500
Compressed Air Required	3	4	5	5	6
CFM Recommended	3,000	4,000	5,000	6,700	8,500
Min. Design Efficiency*	99.99%	99.99%	99.99%	99.99%	99.99%
Cleaning Mechanism	Pulse Jet	Pulse Jet	Pulse Jet	Pulse Jet	Pulse Jet

\* At Standard Test Conditions



Galvanized or Stainless Steel units are available for specialized applications.

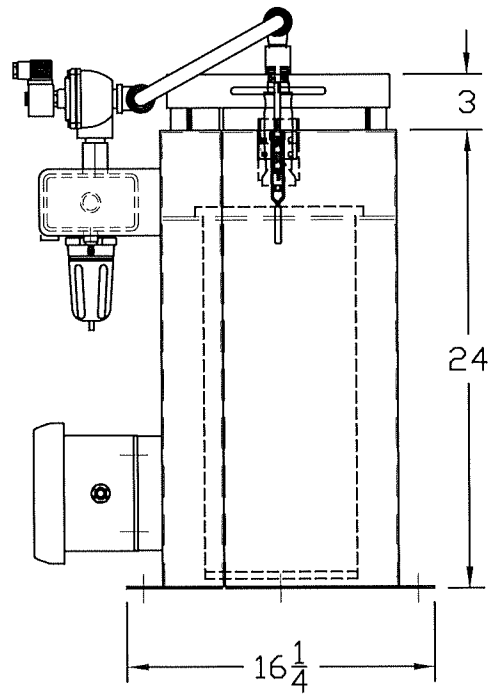
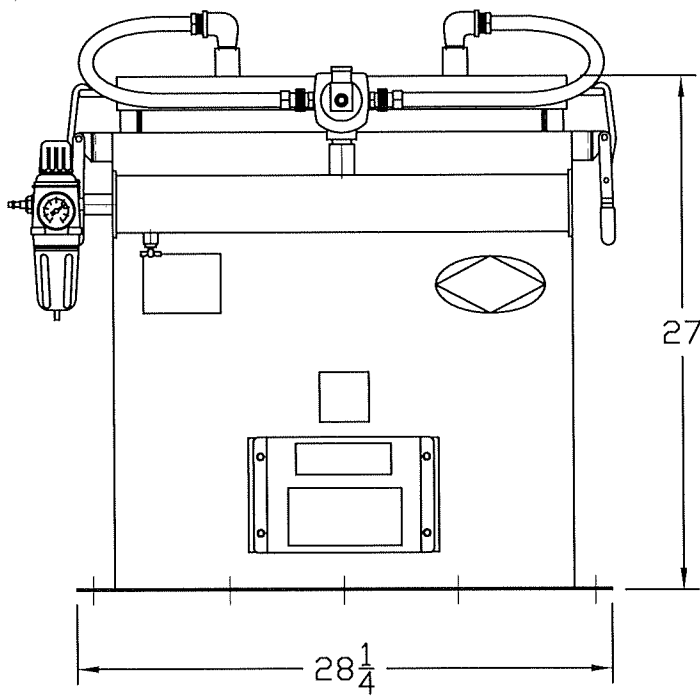
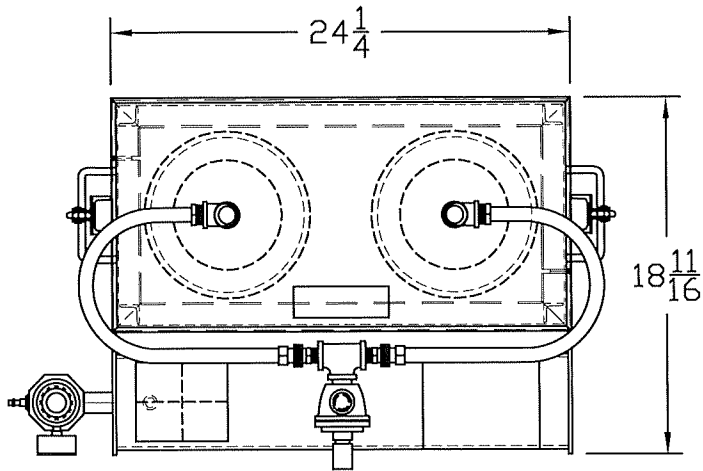

CP-35-219 PULSE JET COLLECTOR  
FLANGE MOUNT



C & W MFG. & SALES CO.  
6933 SHEL MOR RD.  
ALVARADO, TX. 76009 (817) 790-5000



# WAM<sup>®</sup> USA, Inc.

*Bulk Materials Handling and Processing Equipment*

1300 Triad Blvd  
Ft. Worth, TX 76131

75 Boulderbrook Circle  
Lawrenceville, GA 30045

Tel: 817-232-2678

Tel: 770-339-6767

## Bin Vent dust collector type SILOTOP ZERO

Specifications:	
Filtering elements	POLYPLEATS
Element count	7
Element size	D= 16.7", L= 36.5"
Dust collector filtering surface	264 sqft
Recommended air/cloth ratio	6:1
Filtering media	Spunbond nanofiber polyester
Pressure drop	4" H2O
Max. design air capacity	1500 ACFM
Cleaning system	Pulse Jet with compressed air at 80 PSI, incl. electronic timer board
Number of solenoid valves	3
Filtration efficiency (at Standard Test Conditions)	99.9995% (cement)
Housing material	Stainless steel
Dust collector weight	174 lbs

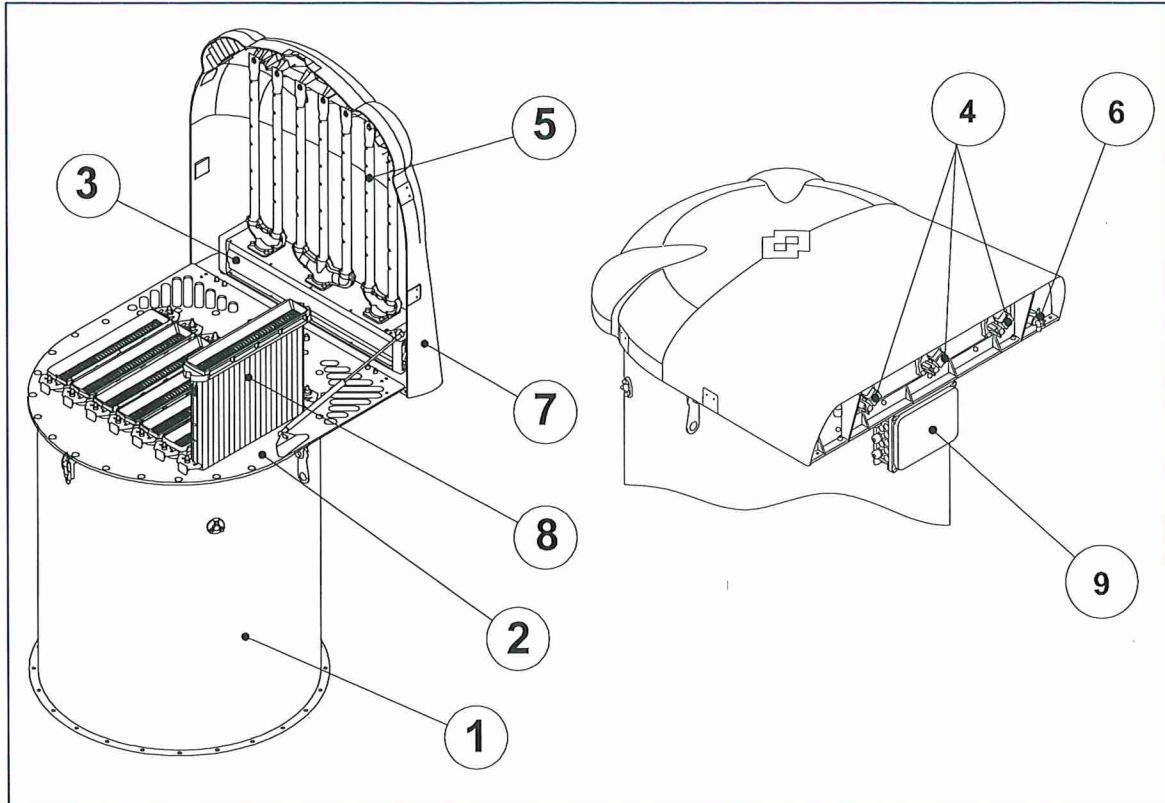

**3.1 Standard machine description**

ITEM	DESCRIPTION	MATERIAL	THICKNESS	FINISHING
1	Filter body	304 SS / 430 SS	1 mm	2B (UNI EN 10088-2/4-1997)
2	Seal frame	CARBON STEEL	6 mm	Powder - coated RAL 7001
3	Air tank	Aluminium	3 mm	Anodized light
4	Solenoid valves	Aluminium	-	Black opaque electrophoresis
5	Blowing pipes	Plastic	-	-
6	Condensate drainage cock	-	-	-
7	Weather protection cover	-	-	-
8	Filter elements <b>POLYPLEAT®</b>	-	-	-
9	Electronic timer	-	-	-

\*Accordin to UNI-EN 10088 (1997)/AISI (1974) /DIN 17440 (1985).

# CP-Series Central Dust Collectors

## General Information

Benefits	Features:
Easy to Maintain	Tool-less Exchange of Filter Media
	Top Entry for Clean Side Filter Exchange
Efficiency	Spun Bound Polyester
	99.99% Filtration Efficiency* * At Standard Test Conditions
Performance	Magnehelic Gauge
	Laser Aligned Cleaning System
Reliable, Easy to Operate	Electrical Control Panel
	Solid State Adjustable Timers w/ LED Display
Long-Lasting, Durable	10 Gauge, Corrugated Steel Construction
Safety, OSHA-Compliant	Ladders, Platforms, and Handrails



Save time during installation, we offer snap together ducting packages

## Options

- Manual or Automatic Recycle Systems
  - Custom Shrouds and Snorkels
  - Silo Anti-Overfill System
  - Spare Parts Kit
  - Custom or Standard Duct Packages
- Additional Services:
    - Turn-Key & Supervised Installations
    - Customized Layouts
    - Start-up, Maintenance & Training
    - Professional Consultation

## Specs



SPECIFICATIONS	CP-5250	CP-7500	CP-10000	CP12500	CP-14000
<b>Total Filtration Area</b>	787	1654	2068	2585	3102
<b>Number of Cartridges</b>	15	16	20	25	30
<b>Cartridge Diameter &amp; Length</b>	8" X 39"	8" X 78"	8" X 78"	8" X 78"	8" X 78"
<b>Type of Media</b>	Spun Bound Polyester	Spun Bound Polyester	Spun Bound Polyester	Spun Bound Polyester	Spun Bound Polyester
<b>Normal Air Capacity (CFM)</b>	5250	7500	10000	12500	14000
<b>Static Pressure Drop</b>	8" W.C.	8" W.C.	8" W.C.	8" W.C.	8" W.C.
<b>Air to Cloth Ratio (ACFM/ft.<sup>2</sup>)</b>	6.67	4.53	4.83	4.83	4.51
<b>Blower Horsepower (optional)</b>	15	15	20	25	30
<b>Blower CFM</b>	5,250	7,500	10,000	12,500	14,000
<b>Min. Design Efficiency*</b>	99.99%*	99.99%*	99.99%*	99.99%*	99.99%*
<b>Cleaning Mechanism</b>	Pulse Jet w/ Timer	Pulse Jet w/ Timer	Pulse Jet w/ Timer	Pulse Jet w/ Timer	Pulse Jet w/ Timer

\*At Standard Test Conditions

C&W Environmental Solutions

P.O. Box 908 ♦ Crowley, TX 76036 ♦ 1-800-880-DUST ♦ www.cwmfg.com

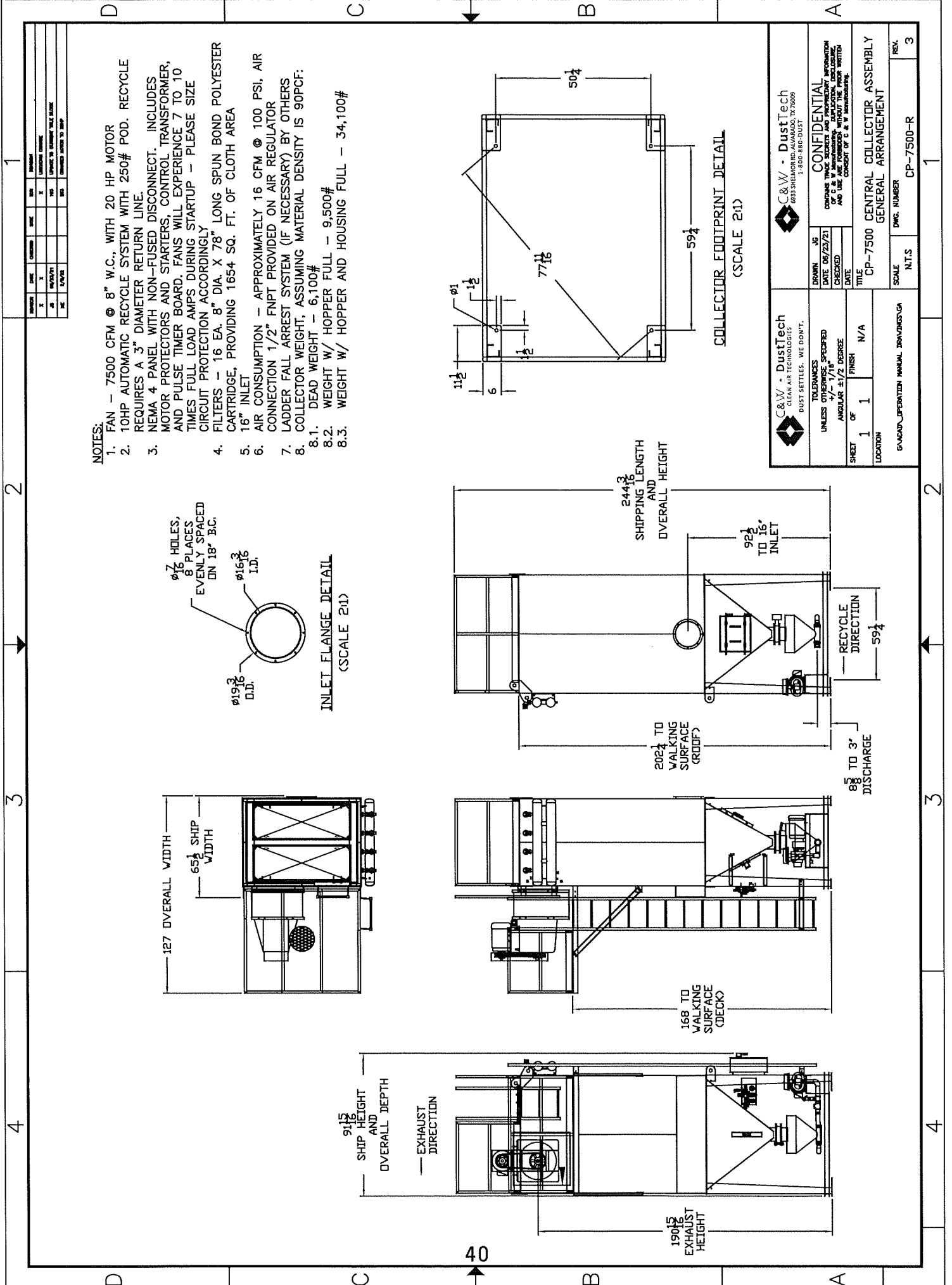

**NOTES:**

1. FAN - 7500 CFM @ 8" W.C., WITH 20 HP MOTOR
2. 10HP AUTOMATIC RECYCLE SYSTEM WITH 250# POD. RECYCLE REQUIRES A 3" DIAMETER RETURN LINE.
3. NEMA 4 PANEL WITH NON-FUSED DISCONNECT. INCLUDES MOTOR PROTECTORS AND STARTERS, CONTROL TRANSFORMER, AND PULSE TIMER BOARD. FANS WILL EXPERIENCE 7 TO 10 TIMES FULL LOAD AMPS DURING STARTUP - PLEASE SIZE CIRCUIT PROTECTION ACCORDINGLY
4. FILTERS - 16 EA. 8" DIA. X 78" LONG SPUN BOND POLYESTER CARTRIDGE, PROVIDING 1654 SQ. FT. OF CLOTH AREA
5. 16" INLET
6. AIR CONSUMPTION - APPROXIMATELY 16 CFM @ 100 PSI, AIR CONNECTION 1/2" FNPT PROVIDED ON AIR REGULATOR
7. LADDER FALL ARREST SYSTEM (IF NECESSARY) BY OTHERS
8. COLLECTOR WEIGHT, ASSUMING MATERIAL DENSITY IS 90PCF:
  - 8.1. DEAD WEIGHT - 6,100#
  - 8.2. WEIGHT W/ HOPPER FULL - 9,500#
  - 8.3. WEIGHT W/ HOPPER AND HOUSING FULL - 34,100#

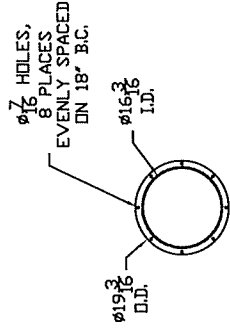

 C&W - DustTech 6933 SHELBOURNE AVENUE, TX 76069 1-800-888-DUST		<b>CONFIDENTIAL</b> CONTAINS TRADE SECRETS AND PROPRIETARY INFORMATION AND IS TO BE KEPT STRICTLY CONFIDENTIAL BY THE RECIPIENT AND NOT TO BE REPRODUCED OR TRANSMITTED IN ANY MANNER WITHOUT THE WRITTEN CONSENT OF C & W Manufacturing.	
DRAWN: JC DATE: 06/23/21 CHECKED: [ ] DATE: [ ]	TOLERANCES UNLESS OTHERWISE SPECIFIED ANGULAR ±1/2 DEGREE FINISH N/A	TITLE CP-7500 GENERAL ARRANGEMENT	
SHEET 1 OF 1 LOCATION		SCALE N.T.S.	DWS. NUMBER CP-7500-R
© VADUO CORPORATION MANUAL DRAWINGS/CA		REV. 3	

## Air Quality Standard Permit for Concrete Batch Plants

Effective Date: January 24, 2024

### (1) Applicability

- (A) This air quality standard permit authorizes concrete batch plant facilities that meet all of the conditions listed in sections (1) through (7) and sections (8) or (9). Concrete batch plants that are authorized as temporary operations shall also comply with section (10) for relocation requirements. If a concrete batch plant operates using sections (8) or (9) of this standard permit and operational changes are proposed that would change the applicable section, the owner or operator shall reregister for the concrete batch plant standard permit prior to operating the change.
- (B) This standard permit does not authorize emission increases of any air contaminant that is specifically prohibited by a condition or conditions in any permit issued under Title 30 Texas Administrative Code (30 TAC) Chapter 116, Control of Air Pollution by Permits for New Construction or Modification, at the site.
- (C) This standard permit does not relieve the owner or operator from complying with any other applicable provision of the Texas Health and Safety Code (THSC), Texas Water Code, rules of the Texas Commission on Environmental Quality (TCEQ), or any additional state or federal regulations.
- (D) Facilities that meet the conditions of this standard permit do not have to meet the emissions and distance limitations in 30 TAC § 116.610(a)(1).

### (2) Definitions

- (A) Auxiliary storage tank – Storage containers used to hold raw materials for use in the batching process not including petroleum products and fuel storage tanks.
- (B) Cohesive hard surface - An in-plant road surface preparation including, but not limited to, paving with concrete, asphalt, or other similar surface preparation where the road surface remains intact during vehicle and equipment use and is capable of being cleaned. Cleaning mechanisms may include water washing, sweeping, or vacuuming.
- (C) Concrete batch plant - For the concrete batch plant standard permit, it is a plant that consists of a concrete batch facility and associated abatement equipment, including, but not limited to: material storage silos, aggregate storage bins, auxiliary storage tanks, conveyors, weigh hoppers, and a mixer. Concrete batch plants can add water, Portland cement, and aggregates into a delivery truck, or the concrete may be prepared in a central mix drum and transferred to a delivery truck for transport. This definition does not include operations that meet the requirements of 30 TAC § 106.141, Batch Mixer or 30 TAC § 106.146, Soil Stabilization Plants.
- (D) Central mix plant (also known as wet mix) – A concrete batch plant where sand, aggregate, cement, cement supplement, and water are all combined and mixed in a central mix drum before being transferred to a transport truck.

- (E) Dust suppressing fencing or other equivalent barrier - A manmade obstruction that is at least 12 feet high that is used to prevent fugitive dust from stationary equipment, stockpiles, in-plant roads, and traffic areas from leaving the plant property.
- (F) Permanent concrete batch plant - For the concrete batch plant standard permit, it is a concrete batch plant that is not a temporary or specialty concrete batch plant.
- (G) Related project segments - For plants on a Texas Department of Transportation right-of-way, related project segments are one contract with multiple project locations or one contractor with multiple contracts in which separate project limits are in close proximity to each other. A plant that is sited on the right-of-way is usually within project limits. However, a plant located at an intersection or wider right-of-way outside project limits is acceptable if it can be easily associated with the project.
- (H) Right-of-way of a public works project - Any public works project that is associated with a right-of-way. Examples of right-of-way public works projects are public highways and roads, water and sewer pipelines, electrical transmission lines, and other similar works. A facility must be in or contiguous to the right-of-way of the public works project to be exempt from the public notice requirements listed in THSC, § 382.056, Notice of Intent to Obtain Permit or Permit Review; Hearing.
- (I) Setback distance - The minimum distance from the nearest suction shroud fabric/cartridge filter exhaust (truck mix plant), drum feed fabric/cartridge filter exhaust (central mix plant), batch mixer feed exhaust (specialty plant), cement/fly ash storage silos, and/or engine to any property line.
- (J) Site - The total of all stationary sources located on one or more contiguous or adjacent properties, that are under common control of the same person (or persons under common control).
- (K) Specialty concrete batch plant - For the concrete batch plant standard permit, it is a concrete batch plant with a low production concrete mixing plant that manufactures concrete less than or equal to 60 cubic yards per hour (yd<sup>3</sup>/hr). These plants are typically dedicated to manufacturing precast concrete products, including but not limited to burial vaults, septic tanks, yard ornaments, concrete block, and pipe, etc. This does not include small repair projects using mortar, grout, gunite, or other concrete repair materials.
- (L) Stationary internal combustion engine - For the concrete batch plant standard permit, it is any internal combustion engine that remains at a location for more than 12 consecutive months and is not defined as a nonroad engine according to 40 Code of Federal Regulations (CFR) 89.2, Definitions.
- (M) Temporary concrete batch plant - For the concrete batch plant standard permit, it is a concrete batch plant that occupies a designated site for not more than 180 consecutive days or that supplies concrete for a single project (single contract or same contractor for related project segments), but not for other unrelated projects.
- (N) Traffic areas - For the concrete batch plant standard permit, it is an area within the concrete batch plant that includes stockpiles and the area where mobile equipment moves or supplies aggregate to the batch plant and trucks supply aggregate and cement.

- (O) Truck mix plant – A concrete batch plant where sand, aggregate, cement, cement supplement, and water are all gravity fed from the weigh hopper into mixer trucks. The concrete is mixed on the way to the site where the concrete is to be placed.

**(3) Administrative Requirements**

- (A) The owner or operator of any concrete batch plant seeking authorization under this standard permit shall register in accordance with 30 TAC § 116.611, Registration to Use a Standard Permit. Owners or operators shall submit a completed, current PI-1S-CBP, Concrete Batch Plant Standard Permit Registration Application.
- (B) Owners or operators shall also comply with 30 TAC § 116.614, Standard Permit Fees when they are required to complete public notice under section four of this standard permit.
- (C) No owner or operator of a concrete batch plant shall begin construction or operation without obtaining written approval from the executive director.
- (D) The time period in 30 TAC § 116.611(b) (45 days) does not apply to owners or operators registering plants under this standard permit.
- (E) Beginning on the effective date, all new and modified sources must comply with this standard permit.
- (F) Renewals shall comply with this standard permit on the later of:
  - (i) Two years from the effective date; or
  - (ii) the date the facility's registration is renewed.
- (G) Owners or operators of temporary concrete plants seeking registration and those already registered for this standard permit that qualify for relocation under subsection (10)(A) are exempt from public notice requirements in section (4) of this standard permit.
- (H) During start of construction, the owner or operator of a plant shall comply with 30 TAC § 116.120(a)(1), Voiding of Permits, and commence construction within 18 months of written approval from the executive director.
- (I) Owners or operators are not required to submit air dispersion modeling as a part of this concrete batch plant standard permit registration.
- (J) Owners or operators shall keep written records on-site for a rolling 24-month period. Owners or operators shall make these records available at the request of TCEQ personnel or any air pollution control program having jurisdiction. Records shall be maintained on-site for the following including, but not limited to:
  - (i) 30 TAC § 101.201, Emissions Event Reporting and Recordkeeping Requirements;
  - (ii) 30 TAC § 101.211, Scheduled Maintenance, Startup, and Shutdown Reporting and Recordkeeping Requirements;

- (iii) production rates for hourly and annual operations that demonstrate compliance with the tables in subsection (8)(A) or the production limitations in subsection (9)(A) of this standard permit, as applicable;
  - (iv) all repairs and maintenance of abatement systems and other dust suppression controls;
  - (v) Material Safety Data Sheets for all additives and other chemicals used at the site;
  - (vi) road cleaning, application of road dust control, or road maintenance for dust control;
  - (vii) stockpile dust suppression;
  - (viii) monthly silo warning device or shut-off system tests;
  - (ix) quarterly visible emissions observations and any corrective actions required to control excess visible emissions;
  - (x) demonstration of compliance with subsection (6)(B) of this standard permit;
  - (xi) type of fuel used to power engines authorized by this standard permit; and
  - (xii) demonstration of compliance with subsection (5)(L) of this standard permit.
- (K) Owners or operators will document and report abatement equipment failure or visible emissions deviations in excess of paragraph (5)(B)(iii) in accordance with 30 TAC Chapter 101, General Air Quality Rules as appropriate.

**(4) Public Notice**

The owner or operator shall follow the notice requirements in 30 TAC Chapter 39, Public Notice, unless a temporary concrete batch plant is exempted from public notice under 30 TAC § 116.178(b), Relocations and Changes of Location of Portable Facilities.

**(5) General Requirements**

- (A) Owners or operators shall vent all cement/fly ash storage silos, weigh hoppers, and auxiliary storage tanks to a fabric/cartridge filter or to a central fabric/cartridge filter system except as allowed by subsection (9)(B).
- (B) Owners or operators shall maintain fabric or cartridge filters and collection systems in good working condition by meeting all the following:
  - (i) operating them properly with no tears or leaks;
  - (ii) using filter systems (including any central filter system) designed to meet a minimum control efficiency of at least 99.5 percent at particle sizes of 2.5 microns and smaller;
  - (iii) meeting a performance standard of no visible emissions exceeding 30 seconds in any six-minute period as determined using United States Environmental

Protection Agency (EPA) Test Method (TM) 22 in Appendix A-7 to Part 60 - Test Methods 19 through 25E; and

- (iv) sufficiently illuminating silo filter exhaust systems when cement or fly ash silos are filled during non-daylight hours to enable a determination of compliance with the visible emissions requirement in paragraph (5)(B)(iii) of this standard permit.
- (C) When transferring cement/fly ash, owners or operators shall:
- (i) totally enclose conveying systems to and from storage silos and auxiliary storage tanks, operate them properly, and maintain them with no tears or leaks; and
  - (ii) maintain the conveying system using a performance standard of no visible emissions exceeding 30 seconds in any six-minute period as determined using EPA TM 22 in Appendix A-7 to Part 60 - Test Methods 19 through 25E, except during cement and fly ash tanker connect and disconnect.
- (D) The owner or operator shall install an automatic shut-off or warning device on storage silos.
- (i) An automatic shut-off device on the silo shall shut down the loading of the silo or auxiliary storage tank prior to reaching its capacity during loading operations to avoid adversely impacting the pollution abatement equipment or other parts of the loading operation.
  - (ii) If a warning device is used, it shall alert operators in sufficient time to prevent an adverse impact on the pollution abatement equipment or other parts of the loading operation. Visible warning devices shall be kept free of particulate build-up at all times.
  - (iii) Silo and auxiliary storage tank warning devices or shut-off systems shall be tested at least once monthly during operations and records shall be kept indicating test and repair results according to subsection (3)(J) of this standard permit. Silo and auxiliary storage tank loading and unloading shall not be conducted with inoperative or faulty warning or shut-off devices.
- (E) Owners or operators shall control emissions from in-plant roads and traffic areas at all times by one or more of the following methods:
- (i) watering them;
  - (ii) treating them with dust-suppressant chemicals as described in the application of aqueous detergents, surfactants, and other cleaning solutions in the de minimis list;
  - (iii) covering them with a material such as, (but not limited to), roofing shingles or tire chips and used in combination with (i) or (ii) of this subsection; or
  - (iv) paving them with a cohesive hard surface that is maintained intact and cleaned regularly.

- (F) Owners or operators shall use water, dust-suppressant chemicals, or cover stockpiles, as necessary to minimize dust emissions. Stockpiles shall be limited to a total of no more than 1.5 acres.
- (G) Owners or operators shall immediately clean up spilled materials. To minimize dust emissions, owners or operators shall contain, or dampen spilled materials.
- (H) There shall be no visible fugitive emissions leaving the property. Observations for visible emissions shall be performed and recorded quarterly. The visible emissions determination shall be made during normal plant operations. Observations shall be made on the downwind property line for a minimum of six minutes. If visible emissions are observed, an evaluation must be accomplished in accordance with EPA TM 22 in Appendix A-7 to Part 60 - Test Methods 19 through 25E, using the criteria that visible emissions shall not exceed a cumulative 30 seconds in duration in any six-minute period. If visible emissions exceed the TM 22 criteria, immediate action shall be taken to eliminate the excessive visible emissions. The corrective action shall be documented within 24 business hours of completion.
- (I) The owner or operator shall locate the concrete batch plant operating under this standard permit at least 550 feet from any crushing plant or hot mix asphalt plant. The owner or operator shall measure from the closest point on the concrete batch plant to the closest point on any other facility. If the owner or operator cannot meet this distance, then the owner or operator shall not operate the concrete batch plant at the same time as the crushing plant or hot mix asphalt plant.
- (J) When operating multiple concrete batch plants on the same site, the owner or operator shall comply with the appropriate site production and setback limits specified in sections (8) or (9) of this standard permit.
- (K) Concrete additives shall not emit volatile organic compounds (VOCs).
- (L) All sand and aggregate shall be washed prior to delivery to the site.
- (M) Any claim under this standard permit shall comply with the following:
  - (i) 30 TAC § 116.604, Duration and Renewal of Registrations to Use Standard Permits;
  - (ii) 30 TAC § 116.605(d)(1), Standard Permit Amendment and Revocation;
  - (iii) 30 TAC § 116.614;
  - (iv) the public notice processes established in THSC, § 382.055, Review and Renewal of Preconstruction Permit;
  - (v) the public notice processes established in THSC, § 382.056;
  - (vi) the contested case hearing and public notice requirements established in 30 TAC § 55.152(a)(2), Public Comment Period; and
  - (vii) the contested case hearing and public notice requirements established in 30 TAC § 55.201(h)(i)(C), Requests for Reconsideration or Contested Case Hearing.

- (N) The owner or operator of any concrete batch plant authorized by this standard permit shall comply with 30 TAC § 101.4, Nuisance.

**(6) Engines**

- (A) This standard permit authorizes emissions from a stationary compression ignition internal combustion engine (or combination of engines) of no more than 1,000 total horsepower (hp).
- (B) Owners or operators of concrete batch plants that include one or more stationary compression ignition internal combustion engines shall comply with additional applicable engine requirements in 40 CFR 60 Subpart IIII, Standards of Performance for Stationary Compression Ignition Internal Combustion Engines, 40 CFR 63, Subpart ZZZZ, National Emissions Standards for Hazardous Air Pollutants for Stationary Reciprocating Internal Combustion Engines, 30 TAC Chapter 117, Control of Air Pollution from Nitrogen Compounds, and any other applicable state or federal regulation.
- (C) Engine exhaust stacks shall be a minimum of eight feet tall.
- (D) Fuel for the engine shall be liquid fuel with a maximum sulfur content of no more than 0.0015 percent by weight and shall not consist of a blend containing waste oils or solvents.
- (E) Emissions from the engine(s) shall not exceed 2.61 grams per horsepower-hour (g/hp-hr) of NO<sub>x</sub>, per manufacturer's specifications. A copy of the manufacturer's specifications shall be kept at the site.
- (F) If engines are being used for electrical power or equipment operations, then the site is limited to a total of 1,000 hp in simultaneous operation. There are no restrictions to engine operations if the engines will be on-site for less than 12 consecutive months.

**(7) Planned Maintenance, Startup, and Shutdown (MSS) Activities**

This standard permit authorizes operations including planned startup and shutdown emissions. Maintenance activities are not authorized by this standard permit and will need separate authorization unless the activity can meet the conditions of 30 TAC § 116.119, De Minimis Facilities or Sources.

**(8) Operational Requirements for Permanent and Temporary Concrete Plants**

- (A) Concrete batch plants authorized under this standard permit shall be limited to the maximum hourly production rate, and minimum setback distances for the suction shroud fabric/cartridge filter exhaust (truck mix plant), drum feed fabric/cartridge filter exhaust (central mix plant), cement/fly ash storage silos, and/or engine, based upon the plant location as follows:
  - (i) A single truck mix plant shall operate under the requirements in subsection (8)(E) and shall comply with Table 1 below, except as provided in paragraph (A)(ii) of this section.

**Table 1: Production Rates and Setback Distances, single truck mix plant with shrouded mixer truck-receiving funnel.**

Location (County)	Production Rate	Setback Distance (ft)
Brazoria, Chambers, Fort Bend, Galveston, Harris, Liberty, Montgomery, and Waller	200 yd <sup>3</sup> /hour	200
Cameron and Hidalgo		300
All other counties		100

- (ii) A single truck mix plant operating under the requirements in subsection (8)(E) and subsection (8)(F) shall comply with Table 2 below.

**Table 2: Production Rates and Setback Distances, single truck mix plant with shrouded mixer truck-receiving funnel and enclosure.**

Location (County)	Production Rate	Setback Distance (ft)
All counties	200 yd <sup>3</sup> /hour	100

- (iii) Multiple truck mix plants at the same site operating under the requirements in subsection (8)(E) and subsection (8)(F) shall comply with Table 3 below.

**Table 3: Production Rates and Setback Distances, multiple truck mix plants at a single site with enclosure.**

Location (County)	Total Site Production Rate	Setback Distance (ft) for each Plant
Brazoria, Chambers, Fort Bend, Galveston, Harris, Liberty, Montgomery, and Waller	300 yd <sup>3</sup> /hour	200
Cameron and Hidalgo		200
All other counties		100

- (iv) Central mix plants shall comply with Table 4 below.

**Table 4: Production Rates and Setback Distances, central mix plants.**

Location (County)	Production Rate	Setback Distance (ft)
Cameron and Hidalgo	300 yd <sup>3</sup> /hour	200
All other counties		100

- (B) Temporary concrete batch plants approved to operate in or contiguous to the right-of-way of a public works project are exempt from subsections (8)(E) and (F) and the minimum setback distances.
- (C) Concrete batch plants shall be limited to a maximum production rate of no more than 650,000 cubic yards per year (yd<sup>3</sup>/yr) in any rolling 12-month period.
- (D) The owner or operator shall install and properly maintain a suction shroud at the truck mix batch drop point or a total enclosure of the central mix drum feed exhaust and vent the captured emissions to a fabric/cartridge filter system with a minimum of 5,000 actual cubic feet per minute (acfm) of air.
- (E) For truck mix plants, the owner or operator shall shelter the drop point by an intact three-sided enclosure with a flexible shroud hanging from above the truck, or equivalent dust collection technology that extends below the mixer truck-receiving funnel.
- (F) For alternative setback distances as listed in subsection (8)(A) Tables 2 and 3, in addition to subsection (8)(E), the owner or operator of truck mix plants shall shelter the truck loading operation with a three-sided solid enclosure or equivalent that extends from the ground level to three feet above the truck-receiving funnel.
- (G) For permanent plants, the owner or operator shall prevent tracking of sediment onto adjacent roadways and reduce the generation of dust by one or more of the following methods:
  - (i) watering, sweeping, and cleaning the plant road entrances;
  - (ii) the use of a rumble grate (or equivalent) that is placed at least 50 feet from a public road to dislodge sediment from the wheels and undercarriage of trucks that haul aggregate, cement, and/or concrete;
  - (iii) the use of a vacuum truck (or equivalent) to clean the plant road entrances; or
  - (iv) the use of a tire-wash system (or equivalent) to remove sediment from the wheels and undercarriage of trucks that haul aggregate, cement, and/or concrete. It shall be (1) located in front of some type of traffic restriction such as a scale, plant gate or a stop sign to encourage its proper use, and (2) shall be set back at least 50 feet from the public road. This permit does not authorize the construction and/or use of a truck washing system under Texas Water Code Chapter 26.
- (H) Stationary equipment (excluding the suction shroud fabric/cartridge filter exhaust, drum feed fabric/cartridge filter exhaust, cement/fly ash storage silos, and engine), stockpiles, and vehicles used for the operation of the concrete batch plant (except for incidental traffic and the entrance and exit to the site), shall not be located closer than 50 feet less than the applicable minimum setback distance listed in subsection (8)(A) from any property line.
- (I) In lieu of meeting the distance requirements for roads of subsection (8)(H) of this standard permit, the owner or operator shall:

- (i) construct and maintain in good working order dust suppressing fencing or other equivalent barriers as a border around roads, other traffic areas, and work areas; and
  - (ii) construct these borders to a height of at least 12 feet.
- (J) In lieu of meeting the distance requirements for stockpiles of subsection (8)(H) of this standard permit, the owner or operator shall contain stockpiles within a three-walled bunker that extends at least two feet above the top of the stockpile.
- (K) For permanent plants, the owner or operator shall pave all entry and exit roads and main traffic routes associated with the operation of the concrete batch plant (including batch truck and material delivery truck roads) with a cohesive hard surface that shall be cleaned and maintained intact. All batch trucks and material delivery trucks shall remain on the paved surface when entering, conducting primary function, and leaving the property. The owner or operator shall maintain other traffic areas using the control requirements of subsection (5)(E) of this standard permit.

**(9) Additional Requirements for Specialty Concrete Batch Plants**

- (A) Specialty concrete batch plants authorized under this standard permit shall be limited to the maximum hourly production rate, maximum annual production rate in any rolling 12-month period, and minimum setback distance for the batch mixer feed exhaust as follows:

**Table 5: Hourly and Annual Maximum Production Rates and Minimum Setback Distances, Specialty Concrete Batch Plants**

Maximum Hourly Production Rate (yd <sup>3</sup> /hr)	Maximum Annual Production Rate (yd <sup>3</sup> /yr)	Minimum Setback Distance (ft)
No more than 30	131,400	100
More than 30 but less than or equal to 60	262,800	200

- (B) As an alternative to the requirement in subsection (5)(A) of this standard permit, the owner or operator may vent the cement/fly ash weigh hopper inside the batch mixer.
- (C) The owner or operator shall control dust emissions at the batch mixer feed so that no outdoor visible emissions occur by one of the following:
- (i) using a suction shroud or other pickup device delivering air to a fabric or cartridge filter;
  - (ii) using an enclosed batch mixer feed; or
  - (iii) conducting the entire mixing operation inside an enclosed process building.
- (D) The owner or operator shall not operate vehicles used for the operation of the concrete batch plant (except for incidental traffic and the entrance and exit to the site) within a minimum buffer distance of 50 feet less than the applicable minimum setback distance listed in subsection (9)(A) from any property line.

- (E) In lieu of meeting the buffer distance requirement for roads and other traffic areas in subsection (9)(D) of this standard permit, owners or operators shall:
  - (i) construct dust suppressing fencing or other barriers as a border around roads, other traffic areas, and work areas; and
  - (ii) construct these borders to a height of at least 12 feet.

**(10) Temporary Concrete Plants Relocation Requirements**

- (A) The appropriate TCEQ regional office may approve, without the need of public notice referenced in section (4) of this standard permit, the relocation of a temporary concrete batch plant that has previously been determined by the commission to be in compliance with the technical requirements of the concrete batch plant standard permit version adopted at registration that provides the information listed under section (10)(B) and meets one of the following conditions:
  - (i) a registered portable facility and associated equipment are moving to a site for support of a public works project in which the proposed site is located in or contiguous to the right-of-way of the public works project; or
  - (ii) a registered portable facility is moving to a site in which a portable facility has been located at the site at any time during the previous two years and the site was subject to public notice.
- (B) For relocations meeting subsection (10)(A) of this standard permit, the owner or operator must submit to the regional office and any local air pollution control agency having jurisdiction at least 12 business days prior to locating at the site:
  - (i) the company name, address, company contact, and telephone number;
  - (ii) the regulated entity number (RN), customer reference number (CN), applicable permit or registration numbers, and if available, the TCEQ account number;
  - (iii) the location from which the facility is moving (current location);
  - (iv) a location description of the proposed site (city, county, and exact physical location description);
  - (v) a scaled plot plan that identifies the location of all equipment and stockpiles, and also indicates that the required setback distances to the property lines can be met at the new location;
  - (vi) representation of maximum hourly and annual site production;
  - (vii) a scaled area map that clearly indicates how the proposed site is contiguous or adjacent to the right-of-way of a public works project (if required);
  - (viii) the proposed date for start of construction and expected date for start of operation;

- (ix) the expected time period at the proposed site;
  - (x) the permit or registration number of the portable facility that was located at the proposed site any time during the last two years, and the date the facility was last located there. This information is not necessary if the relocation request is for a public works project that is contiguous or adjacent to the right-of-way of a public works project; and
  - (xi) proof that the proposed site had accomplished public notice, as required by 30 TAC Chapter 39. This proof is not necessary if the relocation request is for a public works project that is contiguous or adjacent to the right-of-way of a public works project.
- (C) The owner or operator shall submit a completed current TCEQ Regional Notification Standard Permit/PBR Relocation Form when applying to relocate a temporary concrete batch plant.