

Texas Commission on Environmental Quality

Edwards Aquifer Application Cover Page

Our Review of Your Application

The Edwards Aquifer Program staff conducts an administrative and technical review of all applications. The turnaround time for administrative review can be up to 30 days as outlined in 30 TAC 213.4(e). Generally administrative completeness is determined during the intake meeting or within a few days of receipt. The turnaround time for technical review of an administratively complete Edwards Aquifer application is 90 days as outlined in 30 TAC 213.4(e). Please know that the review and approval time is directly impacted by the quality and completeness of the initial application that is received. In order to conduct a timely review, it is imperative that the information provided in an Edwards Aquifer application include final plans, be accurate, complete, and in compliance with [30 TAC 213](#).

Administrative Review

1. [Edwards Aquifer applications](#) must be deemed administratively complete before a technical review can begin. To be considered administratively complete, the application must contain completed forms and attachments, provide the requested information, and meet all the site plan requirements. The submitted application and plan sheets should be final plans. Please submit one full-size set of plan sheets with the original application, and half-size sets with the additional copies.

To ensure that all applicable documents are included in the application, the program has developed tools to guide you and web pages to provide all forms, checklists, and guidance. Please visit the below website for assistance: <http://www.tceq.texas.gov/field/eapp>.

2. This Edwards Aquifer Application Cover Page form (certified by the applicant or agent) must be included in the application and brought to the administrative review meeting.
3. Administrative reviews are scheduled with program staff who will conduct the review. Applicants or their authorized agent should call the appropriate regional office, according to the county in which the project is located, to schedule a review. The average meeting time is one hour.
4. In the meeting, the application is examined for administrative completeness. Deficiencies will be noted by staff and emailed or faxed to the applicant and authorized agent at the end of the meeting, or shortly after. Administrative deficiencies will cause the application to be deemed incomplete and returned.

An appointment should be made to resubmit the application. The application is re-examined to ensure all deficiencies are resolved. The application will only be deemed administratively complete when all administrative deficiencies are addressed.

5. If an application is received by mail, courier service, or otherwise submitted without a review meeting, the administrative review will be conducted within 30 days. The applicant and agent will be contacted with the results of the administrative review. If the application is found to be administratively incomplete, it can be retrieved from the regional office or returned by regular mail. If returned by mail, the regional office may require arrangements for return shipping.
6. If the geologic assessment was completed before October 1, 2004 and the site contains “possibly sensitive” features, the assessment must be updated in accordance with the *Instructions to Geologists* (TCEQ-0585 Instructions).

Technical Review

1. When an application is deemed administratively complete, the technical review period begins. The regional office will distribute copies of the application to the identified affected city, county, and groundwater conservation district whose jurisdiction includes the subject site. These entities and the public have 30 days to provide comments on the application to the regional office. All comments received are reviewed by TCEQ.
2. A site assessment is usually conducted as part of the technical review, to evaluate the geologic assessment and observe existing site conditions. The site must be accessible to our staff. The site boundaries should be

clearly marked, features identified in the geologic assessment should be flagged, roadways marked and the alignment of the Sewage Collection System and manholes should be staked at the time the application is submitted. If the site is not marked the application may be returned.

3. We evaluate the application for technical completeness and contact the applicant and agent via Notice of Deficiency (NOD) to request additional information and identify technical deficiencies. There are two deficiency response periods available to the applicant. There are 14 days to resolve deficiencies noted in the first NOD. If a second NOD is issued, there is an additional 14 days to resolve deficiencies. If the response to the second notice is not received, is incomplete or inadequate, or provides new information that is incomplete or inadequate, the application must be withdrawn or will be denied. Please note that because the technical review is underway, whether the application is withdrawn or denied **the application fee will be forfeited**.
4. The program has 90 calendar days to complete the technical review of the application. If the application is technically adequate, such that it complies with the Edwards Aquifer rules, and is protective of the Edwards Aquifer during and after construction, an approval letter will be issued. Construction or other regulated activity may not begin until an approval is issued.

Mid-Review Modifications

It is important to have final site plans prior to beginning the permitting process with TCEQ to avoid delays.

Occasionally, circumstances arise where you may have significant design and/or site plan changes after your Edwards Aquifer application has been deemed administratively complete by TCEQ. This is considered a "Mid-Review Modification". Mid-Review Modifications may require redistribution of an application that includes the proposed modifications for public comment.

If you are proposing a Mid-Review Modification, two options are available:

- If the technical review has begun your application can be denied/withdrawn, your fees will be forfeited, and the plan will have to be resubmitted.
- TCEQ can continue the technical review of the application as it was submitted, and a modification application can be submitted at a later time.

If the application is denied/withdrawn, the resubmitted application will be subject to the administrative and technical review processes and will be treated as a new application. The application will be redistributed to the affected jurisdictions.

Please contact the regional office if you have questions. If your project is located in Williamson, Travis, or Hays County, contact TCEQ's Austin Regional Office at 512-339-2929. If your project is in Comal, Bexar, Medina, Uvalde, or Kinney County, contact TCEQ's San Antonio Regional Office at 210-490-3096

Please fill out all required fields below and submit with your application.

1. Regulated Entity Name: LTISD TRANSPORTATION & DISTRIBUTION CENTER					2. Regulated Entity No.: 105841654				
3. Customer Name: LAKE TRAVIS INDEPENDENT SCHOOL DISTRICT					4. Customer No.: 600783575				
5. Project Type: (Please circle/check one)	New	Modification			Extension		Exception		
6. Plan Type: (Please circle/check one)	WPAP	CZP	SCS	UST	AST	EXP	EXT	Technical Clarification	Optional Enhanced Measures
7. Land Use: (Please circle/check one)	Residential	Non-residential				8. Site (acres):		Project Site = 0.154 ac Property = 121.82 ac	
9. Application Fee:	\$500	10. Permanent BMP(s):				Retention/Irrigation Water Quality Pond			
11. SCS (Linear Ft.):	N/A	12. AST/UST (No. Tanks):				N/A			
13. County:	Travis	14. Watershed:				Little Barton Creek			

Application Distribution

Instructions: Use the table below to determine the number of applications required. One original and one copy of the application, plus additional copies (as needed) for each affected incorporated city, county, and groundwater conservation district are required. Linear projects or large projects, which cross into multiple jurisdictions, can require additional copies. Refer to the “Texas Groundwater Conservation Districts within the EAPP Boundaries” map found at:

http://www.tceq.texas.gov/assets/public/compliance/field_ops/eapp/EAPP%20GWCD%20map.pdf

For more detailed boundaries, please contact the conservation district directly.

Austin Region			
County:	Hays	Travis	Williamson
Original (1 req.)	—	—	—
Region (1 req.)	—	—	—
County(ies)	—	—	—
Groundwater Conservation District(s)	<input type="checkbox"/> Edwards Aquifer Authority <input type="checkbox"/> Barton Springs/ Edwards Aquifer <input type="checkbox"/> Hays Trinity <input type="checkbox"/> Plum Creek	<input type="checkbox"/> Barton Springs/ Edwards Aquifer	NA
City(ies) Jurisdiction	<input type="checkbox"/> Austin <input type="checkbox"/> Buda <input type="checkbox"/> Dripping Springs <input type="checkbox"/> Kyle <input type="checkbox"/> Mountain City <input type="checkbox"/> San Marcos <input type="checkbox"/> Wimberley <input type="checkbox"/> Woodcreek	<input type="checkbox"/> Austin <input type="checkbox"/> Bee Cave <input type="checkbox"/> Pflugerville <input type="checkbox"/> Rollingwood <input type="checkbox"/> Round Rock <input type="checkbox"/> Sunset Valley <input type="checkbox"/> West Lake Hills	<input type="checkbox"/> Austin <input type="checkbox"/> Cedar Park <input type="checkbox"/> Florence <input type="checkbox"/> Georgetown <input type="checkbox"/> Jerrell <input type="checkbox"/> Leander <input type="checkbox"/> Liberty Hill <input type="checkbox"/> Pflugerville <input type="checkbox"/> Round Rock

San Antonio Region					
County:	Bexar	Comal	Kinney	Medina	Uvalde
Original (1 req.)	—	—	—	—	—
Region (1 req.)	—	—	—	—	—
County(ies)	—	—	—	—	—
Groundwater Conservation District(s)	<input type="checkbox"/> Edwards Aquifer Authority <input type="checkbox"/> Trinity-Glen Rose	<input type="checkbox"/> Edwards Aquifer Authority	<input type="checkbox"/> Kinney	<input type="checkbox"/> EAA <input type="checkbox"/> Medina	<input type="checkbox"/> EAA <input type="checkbox"/> Uvalde
City(ies) Jurisdiction	<input type="checkbox"/> Castle Hills <input type="checkbox"/> Fair Oaks Ranch <input type="checkbox"/> Helotes <input type="checkbox"/> Hill Country Village <input type="checkbox"/> Hollywood Park <input type="checkbox"/> San Antonio (SAWS) <input type="checkbox"/> Shavano Park	<input type="checkbox"/> Bulverde <input type="checkbox"/> Fair Oaks Ranch <input type="checkbox"/> Garden Ridge <input type="checkbox"/> New Braunfels <input type="checkbox"/> Schertz	NA	<input type="checkbox"/> San Antonio ETJ (SAWS)	NA

I certify that to the best of my knowledge, that the application is complete and accurate. This application is hereby submitted to TCEQ for administrative review and technical review.

Cameron Ballman, P.E.

Print Name of Customer/Authorized Agent



03/31/2025

Signature of Customer/Authorized Agent

Date

****FOR TCEQ INTERNAL USE ONLY****

Date(s) Reviewed:		Date Administratively Complete:	
Received From:		Correct Number of Copies:	
Received By:		Distribution Date:	
EAPP File Number:		Complex:	
Admin. Review(s) (No.):		No. AR Rounds:	
Delinquent Fees (Y/N):		Review Time Spent:	
Lat./Long. Verified:		SOS Customer Verification:	
Agent Authorization Complete/Notarized (Y/N):		Fee Check:	Payable to TCEQ (Y/N):
Core Data Form Complete (Y/N):			Signed (Y/N):
Core Data Form Incomplete Nos.:			Less than 90 days old (Y/N):



TCEQ Core Data Form

For detailed instructions on completing this form, please read the Core Data Form Instructions or call 512-239-5175.

SECTION I: General Information

1. Reason for Submission (If other is checked please describe in space provided.)		
<input type="checkbox"/> New Permit, Registration or Authorization (Core Data Form should be submitted with the program application.)		
<input type="checkbox"/> Renewal (Core Data Form should be submitted with the renewal form)		<input checked="" type="checkbox"/> Other CZP Exception Request
2. Customer Reference Number (if issued)	Follow this link to search for CN or RN numbers in Central Registry**	3. Regulated Entity Reference Number (if issued)
CN 600783575		RN 105841654

SECTION II: Customer Information

4. General Customer Information		5. Effective Date for Customer Information Updates (mm/dd/yyyy)						
<input type="checkbox"/> New Customer <input checked="" type="checkbox"/> Update to Customer Information <input type="checkbox"/> Change in Regulated Entity Ownership								
<input type="checkbox"/> Change in Legal Name (Verifiable with the Texas Secretary of State or Texas Comptroller of Public Accounts)								
<i>The Customer Name submitted here may be updated automatically based on what is current and active with the Texas Secretary of State (SOS) or Texas Comptroller of Public Accounts (CPA).</i>								
6. Customer Legal Name (If an individual, print last name first: eg: Doe, John)			<i>If new Customer, enter previous Customer below:</i>					
Lake Travis Independent School District								
7. TX SOS/CPA Filing Number	8. TX State Tax ID (11 digits)	9. Federal Tax ID (9 digits)	10. DUNS Number (if applicable)					
11. Type of Customer:		<input type="checkbox"/> Corporation <input type="checkbox"/> Individual Partnership: <input type="checkbox"/> General <input type="checkbox"/> Limited						
Government: <input type="checkbox"/> City <input type="checkbox"/> County <input type="checkbox"/> Federal <input type="checkbox"/> Local <input type="checkbox"/> State <input checked="" type="checkbox"/> Other		<input type="checkbox"/> Sole Proprietorship <input type="checkbox"/> Other:						
12. Number of Employees		13. Independently Owned and Operated?						
<input type="checkbox"/> 0-20 <input type="checkbox"/> 21-100 <input type="checkbox"/> 101-250 <input type="checkbox"/> 251-500 <input checked="" type="checkbox"/> 501 and higher		<input checked="" type="checkbox"/> Yes <input type="checkbox"/> No						
14. Customer Role (Proposed or Actual) – as it relates to the Regulated Entity listed on this form. Please check one of the following								
<input type="checkbox"/> Owner <input type="checkbox"/> Operator <input checked="" type="checkbox"/> Owner & Operator <input type="checkbox"/> Other: <input type="checkbox"/> Occupational Licensee <input type="checkbox"/> Responsible Party <input type="checkbox"/> VCP/BSA Applicant								
15. Mailing Address:	3322 Ranch Road 620 South							
	City	Austin	State	TX	ZIP	78738	ZIP + 4	
16. Country Mailing Information (if outside USA)					17. E-Mail Address (if applicable)			
					info@Itidschools.org			

18. Telephone Number	19. Extension or Code	20. Fax Number (if applicable)
(512) 533-6000		() -

SECTION III: Regulated Entity Information

21. General Regulated Entity Information (If 'New Regulated Entity' is selected, a new permit application is also required.)								
<input type="checkbox"/> New Regulated Entity <input type="checkbox"/> Update to Regulated Entity Name <input checked="" type="checkbox"/> Update to Regulated Entity Information								
<i>The Regulated Entity Name submitted may be updated, in order to meet TCEQ Core Data Standards (removal of organizational endings such as Inc, LP, or LLC).</i>								
22. Regulated Entity Name (Enter name of the site where the regulated action is taking place.)								
LTISD TRANSPORTATION & DISTRIBUTION CENTER								
23. Street Address of the Regulated Entity: (No PO Boxes)	16101 W STATE HWY 71							
	City	Austin	State	TX	ZIP	78738	ZIP + 4	
24. County	Travis							

If no Street Address is provided, fields 25-28 are required.

25. Description to Physical Location:								
26. Nearest City					State	Nearest ZIP Code		
<i>Latitude/Longitude are required and may be added/updated to meet TCEQ Core Data Standards. (Geocoding of the Physical Address may be used to supply coordinates where none have been provided or to gain accuracy).</i>								
27. Latitude (N) In Decimal:					28. Longitude (W) In Decimal:			
Degrees	Minutes	Seconds	Degrees	Minutes	Seconds			
29. Primary SIC Code (4 digits)	30. Secondary SIC Code (4 digits)		31. Primary NAICS Code (5 or 6 digits)		32. Secondary NAICS Code (5 or 6 digits)			
8211	4151		611110		485410			
33. What is the Primary Business of this entity? (Do not repeat the SIC or NAICS description.)								
School district transportation center, equipment distribution, and technology center								
34. Mailing Address:	16101 W STATE HWY 71							
	City	Austin	State	TX	ZIP	78738	ZIP + 4	
35. E-Mail Address:	info@ltisdschools.org							
36. Telephone Number	37. Extension or Code		38. Fax Number (if applicable)					
(512) 533-6070			() -					

39. TCEQ Programs and ID Numbers Check all Programs and write in the permits/registration numbers that will be affected by the updates submitted on this form. See the Core Data Form instructions for additional guidance.

<input type="checkbox"/> Dam Safety	<input type="checkbox"/> Districts	<input checked="" type="checkbox"/> Edwards Aquifer	<input type="checkbox"/> Emissions Inventory Air	<input type="checkbox"/> Industrial Hazardous Waste
		11001506		
<input type="checkbox"/> Municipal Solid Waste	<input type="checkbox"/> New Source Review Air	<input type="checkbox"/> OSSF	<input type="checkbox"/> Petroleum Storage Tank	<input type="checkbox"/> PWS
<input type="checkbox"/> Sludge	<input type="checkbox"/> Storm Water	<input type="checkbox"/> Title V Air	<input type="checkbox"/> Tires	<input type="checkbox"/> Used Oil
<input type="checkbox"/> Voluntary Cleanup	<input type="checkbox"/> Wastewater	<input type="checkbox"/> Wastewater Agriculture	<input type="checkbox"/> Water Rights	<input type="checkbox"/> Other:

SECTION IV: Preparer Information

40. Name:	Cameron Ballman, PE	41. Title:	Project Manager
42. Telephone Number	43. Ext./Code	44. Fax Number	45. E-Mail Address
(512) 899-0601		() -	cameronb@malonewheeler.com

SECTION V: Authorized Signature

46. By my signature below, I certify, to the best of my knowledge, that the information provided in this form is true and complete, and that I have signature authority to submit this form on behalf of the entity specified in Section II, Field 6 and/or as required for the updates to the ID numbers identified in field 39.

Company:	Malone/Wheeler, Inc.	Job Title:	Project Manager
Name (In Print):	Cameron Ballman, PE	Phone:	(512) 899-0601
Signature:		Date:	03-31-25

Contributing Zone Exception Request Form

Texas Commission on Environmental Quality

for Regulated Activities on the Contributing Zone to the Edwards Aquifer and Relating to 30 TAC §213.24(1), Effective June 1, 1999

To ensure that the application is administratively complete, confirm that all fields in the form are complete, verify that all requested information is provided, consistently reference the same site and contact person in all forms in the application, and ensure forms are signed by the appropriate party.

Note: Including all the information requested in the form and attachments contributes to more streamlined technical reviews.

Signature

To the best of my knowledge, the responses to this form accurately reflect all information requested concerning the proposed regulated activities and methods to protect the Edwards Aquifer. This **Contributing Zone Exception Request Form** is hereby submitted for TCEQ review and executive director approval. The request was prepared by:

Print Name of Customer/Agent: Cameron Ballman, P.E.

Date: 03/31/2025

Signature of Customer/Agent:



Regulated Entity Name: _____

Project Information

1. County: Travis
2. Stream Basin: Little Barton Creek
3. Groundwater Conservation District (if applicable): N/A
4. Customer (Applicant):

Contact Person: Robert Winovitch

Entity: Lake Travis ISD

Mailing Address: 16101 W State Hwy 71, Building B

City, State: Austin, TX

Zip: 78738

Telephone: 512-533-5963

Fax: _____

Email Address: winovitchr@ltsidschools.org

5. Agent/Representative (If any):

Contact Person: Cameron Ballman

Entity: Malone/Wheeler, Inc.

Mailing Address: 5113 Southwest Parkway, Suite 260

City, State: Austin, TX

Zip: 78735

Telephone: (512) 899.0601

Fax: _____

Email Address: cameronb@malonewheeler.com

6. Project Location

☐ This project is inside the city limits of _____.

☒ This project is outside the city limits but inside the ETJ (extra-territorial jurisdiction) of Bee Cave, TX.

☐ This project is not located within any city limits or ETJ.

7. ☒ The location of the project site is described below. Sufficient detail and clarity has been provided so that the TCEQ's Regional staff can easily locate the project and site boundaries for a field investigation.

16101 W State Hwy 71, Building B, Austin, TX 78738

8. ☒ **Attachment A - Road Map.** A road map showing directions to and location of the project site is attached. The map clearly shows the boundary of the project site.

9. ☒ **Attachment B - USGS Quadrangle Map.** A copy of the USGS Quadrangle Map (Scale: 1" = 2000') is attached. The map(s) should clearly show:

☒ Project site boundaries.

☒ USGS Quadrangle Name(s).

10. ☒ **Attachment C - Project Narrative.** A detailed narrative description of the proposed project is provided at the end of this form. The project description is consistent throughout the application and contains, at a minimum, the following details:

☒ Area of the site

☒ Offsite areas

☒ Impervious cover

☒ Permanent BMP(s)

☒ Proposed site use

☒ Site history

☒ Previous development

☒ Area(s) to be demolished

11. Existing project site conditions are noted below:

☐ Existing commercial site

☐ Existing industrial site

☐ Existing residential site

☐ Existing paved and/or unpaved roads

- ☐ Undeveloped (Cleared)
- ☐ Undeveloped (Undisturbed/Not cleared)
- ☒ Other: Existing School District/Institutional site

12. ☒ **Attachment D - Nature Of Exception.** A narrative description of the nature of each exception requested is attached. All provisions of 30 TAC §213 Subchapter B for which an exception is being requested have been identified in the description.
13. ☒ **Attachment E - Equivalent Water Quality Protection.** Documentation demonstrating equivalent water quality protection for surface streams which enter the Edwards Aquifer is attached.

Administrative Information

14. ☐ Submit one (1) original and one (1) copy of the application, plus additional copies as needed for each affected incorporated city, groundwater conservation district, and county in which the project will be located. The TCEQ will distribute the additional copies to these jurisdictions.
15. ☐ The applicant understands that prior approval under this section must be obtained from the executive director for the exception to be authorized.

CONTRIBUTING ZONE EXEMPTION REQUEST ATTACHMENT "A'

ROAD MAP

LAKE TRAVIS ISD TECHNOLOGY CENTER ADDITION

(Please see attached)

FLTRD OVERLAPING RECT 18446-445 LTSD T TECHNOLOGY EXPANSION DOCUMENT APPLICATIONS TO THE CO-CONTRIBUTING ZONE EXCEPT FOR RESIDENTIAL AND COMMERCIAL ZONES

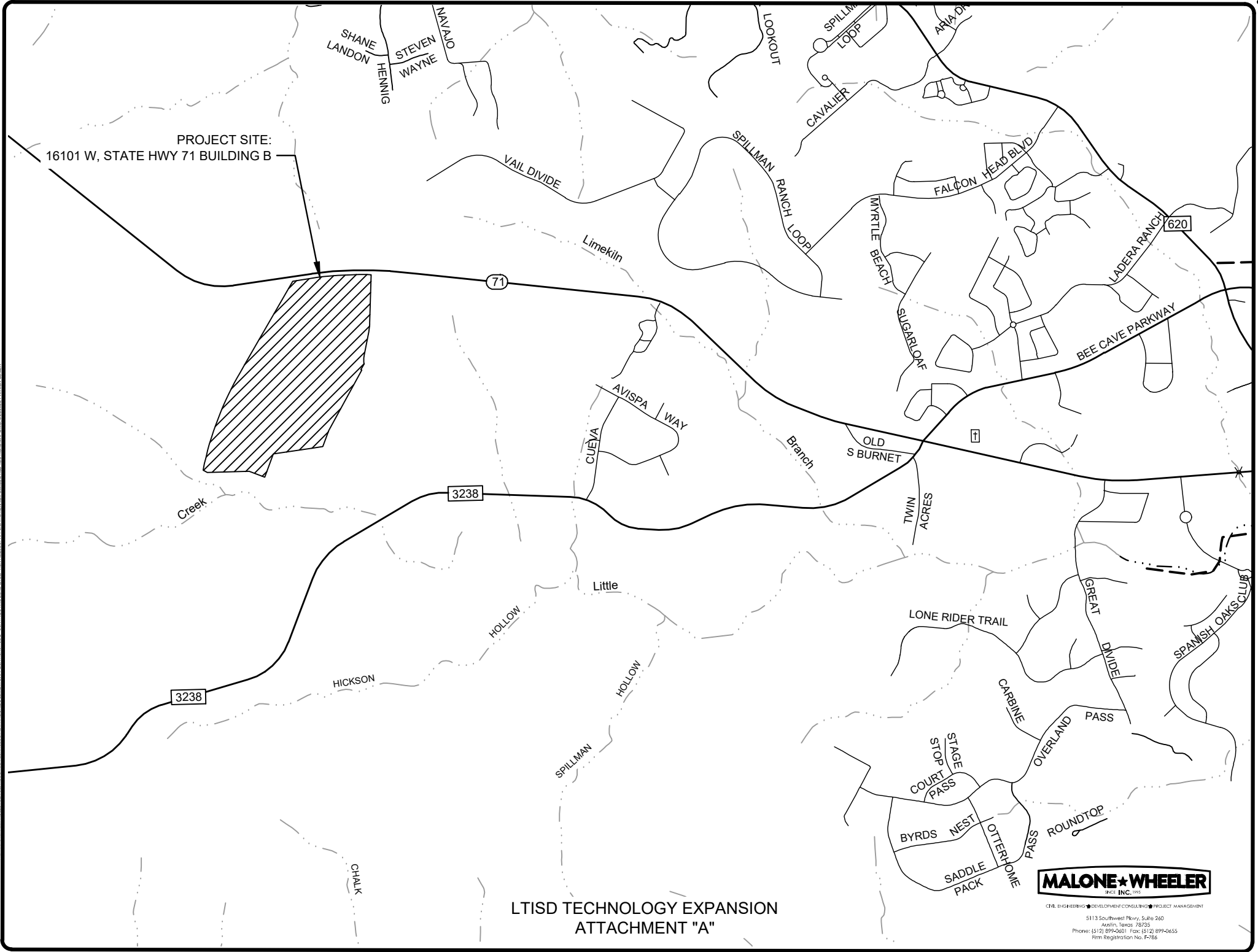

LTISD TECHNOLOGY EXPANSION
ATTACHMENT "A"



Civil Engineering • Development Consulting • Project Management
5113 Southwest Pkwy, Suite 260
Austin, Texas 78735
Phone: (512) 899-0601 Fax: (512) 899-0655
Firm Registration No. F-766

CONTRIBUTING ZONE EXEMPTION REQUEST ATTACHMENT "B'

USGS QUADRANGLE MAP

LAKE TRAVIS ISD TECHNOLOGY CENTER ADDITION

(Please see attached)



U.S. DEPARTMENT OF THE INTERIOR
U.S. GEOLOGICAL SURVEY



BEE CAVE QUADRANGLE
TEXAS - TRAVIS COUNTY
7.5-MINUTE TOPO



Produced by the United States Geological Survey
North American Datum of 1983 (NAD83)
World Geodetic System of 1984 (WGS84). Projection and
1 000-meter grid/Universal Transverse Mercator, Zone 14R.
Data is provided by The National Map (TNM), is the best available at the time of map
generation, and includes data content from supporting themes of Elevation,
Hydrography, Geographic Names, Boundaries, Transportation, Structures, Land Cover,
and Orthimagery. Refer to associated Federal Geographic Data Committee (FGDC)
Metadata for additional source data information.

This map is not a legal document. Boundaries may be generalized for this map scale.
Private lands within government reservations may not be shown. Obtain permission
before entering private lands. Temporal changes may have occurred since these data
were collected and some data may no longer represent actual surface conditions.

Learn About The National Map: <https://nationalmap.gov>

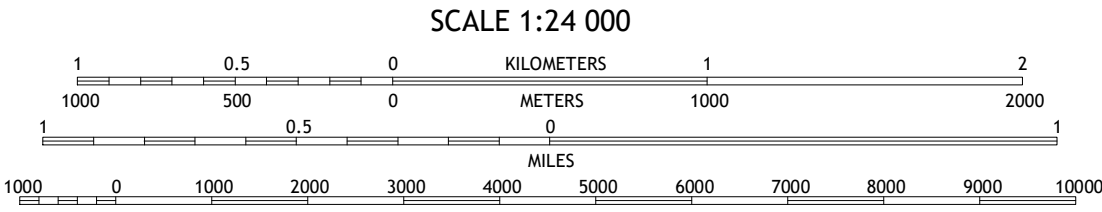
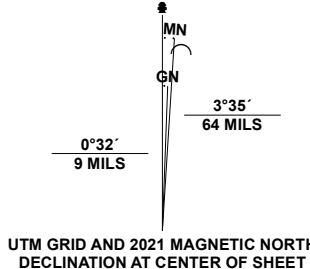

CONTOUR INTERVAL 20 FEET
NORTH AMERICAN VERTICAL DATUM OF 1988
CONTOUR SMOOTHNESS = Medium



QUADRANGLE LOCATION		
Pace Bend	Mansfield Dam	Jollyville
Shingle Hills	Bee Cave	Austin West
Dripping Springs	Signal Hill	Oak Hill

ADJOINING QUADRANGLES

ROAD CLASSIFICATION
Expressway
Secondary Hwy
Ramp
Interstate Route
Local Connector
Local Road
4WD
US Route
State Route

BEE CAVE, TX
2025

CONTRIBUTING ZONE EXEMPTION REQUEST ATTACHMENT "C"

PROJECT DESCRIPTION

LAKE TRAVIS ISD TECHNOLOGY CENTER ADDITION

(Please see attached)



CIVIL ENGINEERING ★ DEVELOPMENT CONSULTING ★ PROJECT MANAGEMENT

LTISD Technology & Distribution Center Technology Building Addition – Project Narrative

The proposed project proposes the expansion of the existing Lake Travis ISD Transportation and Distribution Center's Technology Building, located at 16101 W Hwy 71, Bldg B, Austin, TX 78738, within the ETJ of the City of Bee Cave. The project is situated within a larger 122-acre property, TCAD parcel #987773. The limits of construction for this Technology Building addition project is 0.159 acres. The project site was an undeveloped greenfield site prior to the development of the Transportation and Distribution Center's construction (Phase 1 of construction on the entire property) in 2011.

In addition to Building B on the Property, the 122-acre property includes the LTISD Transportation Center to the East, and Bee Cave Middle School to the south. Offsite areas surrounding the project area are an adjacent commercial property to the West, Highway 71 to the North, Vail Divide roadway to the East, and an undeveloped creek buffer area to the south along with single family residential across the buffer area.

Existing impervious cover on-site consists of the existing Technology Building, paved roads, loading areas, and parking areas. There is an existing on-site detention pond that stormwater in the drainage area that contains the project's limits of construction, as well as an existing water quality retention/irrigation pond that was previously designed, sized, and constructed for impervious cover across multiple phases of construction on the property. The ponds both have sufficient capacity to accommodate the increase in additional impervious cover. Currently and after the proposed LTISD Transportation and Distribution Center's Technology Building Addition, 0.68 acres of additional impervious cover capacity remain within the existing ponds.

The expansion will add approximately 1,450 SF of new building over an existing loading dock at the rear of the facility. The expansion area will cover an existing strip of pervious landscape, resulting in a net increase of approximately 168 SF of new impervious cover, and the addition of 168 SF of impervious cover is expected to have minimal to no impact on the BMPs or water quality pond.

LTISD utilizes the property as a transportation and distribution facility. The technology center that is proposed to be modified is a part of the distribution facility. The overall site includes the Transportation Center to the east and Bee Cave Middle School to the south. The most recent development occurred in 2018, consisting of improvements and additions to the Technology Building. Construction was concluded in 2020.

Demolition requirements for this project are minimal and primarily involve modifications to the existing loading dock. The site modifications include removal of the existing loading dock pavement, and preparation and resurfacing of the existing loading dock for the proposed building addition. A small portion of a landscape strip is now proposed to be replaced with the building addition, resulting in a minimal net increase (168 SF) to impervious cover.

CONTRIBUTING ZONE EXEMPTION REQUEST ATTACHMENT "D"

NATURE OF EXCEPTION

LAKE TRAVIS ISD TECHNOLOGY CENTER ADDITION

(Please see attached)



CIVIL ENGINEERING ★ DEVELOPMENT CONSULTING ★ PROJECT MANAGEMENT

LTISD Transportation & Distribution Center Technology Building Addition – Nature of Exception

The proposed project involves the expansion of the existing LTISD Technology Building located at 16101 W Hwy 71, Bldg B, Austin, TX 78738, within the ETJ of the City of Bee Cave. The project is part of a larger 122-acre site with TCEQ CZP No. 11001506 for previously approved and constructed facilities.

An exception is requested for the project's addition of 1,450 SF of new building, primarily over pre-existing paved surfaces, which minimizes land disturbance. The addition to the building will create an increase in impervious cover by approximately 168 SF, occurring over a pervious strip of river rock landscape. The existing on-site water quality pond was sized for additional impervious cover, with 0.68 acres of reserve capacity. The building addition will have no substantial effect on the existing permanent BMP, a water quality retention/irrigation pond, ensuring no significant impact on water quality.

An application fee of \$500 will be submitted as required for processing the Contributing Zone Exception Request.

- BLANK PAGE -

- Email from Bo Sloan Follows -



Outlook

RE: LTISD Technology Building Expansion - Predevelopment Meeting

From James Slone <james.slone@tceq.texas.gov>

Date Thu 1/16/2025 12:17 PM

To Cameron Ballman <cameronb@malonewheeler.com>; Dan Brown <danb@malonewheeler.com>

Cameron

You can submit the application as a CZP Exception. Be sure to hang on to this email. You may be asked for it during admin review.

Generally speaking, the timeframe is the same for a CZP – 90 days per the rules. That being said, we shoot for less than 50 days from admin complete date. This plan is pretty simple. So, assuming you guys submit a really good plan, it should be under 60 days (I cannot guarantee that, though). Keep in mind it is very dependent on what is in the queue ahead of you and the volume of plans we receive.

Bo

James “Bo” Slone, P.G.

Team Leader

Edwards Aquifer Protection Program

Texas Commission on Environmental Quality

(512) 239-6994

From: Cameron Ballman <cameronb@malonewheeler.com>

Sent: Thursday, January 16, 2025 11:14 AM

To: James Slone <james.slone@tceq.texas.gov>; Dan Brown <danb@malonewheeler.com>

Subject: RE: LTISD Technology Building Expansion - Predevelopment Meeting

Good Morning, Bo,

Thanks for taking the time to meet with us to discuss this project today. To summarize the project, we are expanding the existing Lake Travis ISD Technology Building located at 16101 West Hwy 71, Building B, Austin, TX 78738. The project is located within the ETJ of the City of Bee Cave. This project is part of a larger 136 acre project area and the TCEQ CZP Permit Number is 11001506 for the previously approved and constructed facilities on this site.

This proposed building expansion will add approximately 1450 SF of new building over an existing loading dock in the back of the facility. There is an existing strip of pervious landscape where the new building will cover, effectively netting an additional 180 SF of new impervious cover. The existing BMPs on site have previously been designed and sized for additional impervious cover. As the project stands today, there is a reserve of 0.68 acres of capacity within these ponds, in which the proposed addition of 180 SF of impervious cover is expected to have little to no impact on the BMPs. Since this project will have a minor impact on impervious cover and the BMPs, we are seeking to submit a Contributing Zone Exception Request through your office for approval of this project.

Would you please confirm that we can submit a CZ Exception Request for this project? Would you also please let us know the approximate timeframe for the review and approval of this CZ Exception

Request? We would like to have this timeframe to update our project schedule.

Thank you,



ENGINEERING | CONSULTING | MANAGEMENT

CAMERON BALLMAN, P.E.

O: (512) 899.0601 | C: (806) 282.3063

E: cameronb@malonewheeler.com

5113 Southwest Parkway, Suite 260 | Austin, Texas 78735

Firm No. F-786

DISCLAIMER: This data is authorized "AS IS" without any warranty as to its performance, accuracy, freedom from error, or as to any results generated through its use, including without limitation, any implied warranties of merchantability or fitness for a particular purpose. You assume the entire risk as to the results and performance of the data.

-----Original Appointment-----

From: Cameron Ballman

Sent: Monday, January 13, 2025 2:41 PM

To: Cameron Ballman; James "Bo" Slone; Dan Brown

Subject: LTISD Technology Building Expansion - Predevelopment Meeting

When: Thursday, January 16, 2025 10:00 AM-10:30 AM (UTC-06:00) Central Time (US & Canada).

Where: Microsoft Teams Meeting

Microsoft Teams [Need help?](#)

[Join the meeting now](#)

Meeting ID: 265 738 266 770

Passcode: Qm3BP6uR

For organizers: [Meeting options](#)

Please follow the instructions above to join the meeting. Thank you!

CONTRIBUTING ZONE EXEMPTION REQUEST ATTACHMENT "E"

EQUIVALENT WATER QUALITY PROTECTION

LAKE TRAVIS ISD TECHNOLOGY CENTER ADDITION

(Please see attached)



CIVIL ENGINEERING ★ DEVELOPMENT CONSULTING ★ PROJECT MANAGEMENT

LTISD Transportation & Distribution Center Technology Building Addition – Equivalent Water Quality Protection

The proposed project involves the expansion of the existing LTISD Technology Building located at 16101 W Hwy 71, Bldg B, Austin, TX 78738, within the ETJ of the City of Bee Cave. The project is part of a larger 122-acre site with TCEQ CZP No. 11001506 for previously approved and constructed facilities.

The previously approved and constructed water quality pond that treats stormwater for the drainage area that wholly contains the proposed project's limits of construction (0.158 acres) for the Technology Building Addition has 0.68 acres of additional impervious cover capacity beyond what is proposed. As the proposed project has a net increase in impervious cover of 168 SF, there is little to no impact on the performance of the existing permanent BMP, which is a retention/irrigation pond located immediately to the west of the intersection of Vail Divide and Los Flores Lane.

F:\LTSD OVERALL\PROJECTS\04-065-AUS LTSD TECHNOLOGY EXPANSION\DRAWINGS\PLAN\BET10 EROSION & SEDIMENTATION CONTROL PLAN.DWG, 3/31/2025, CAMERON BALLMAN

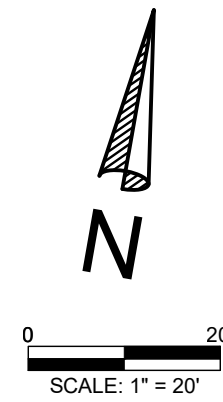
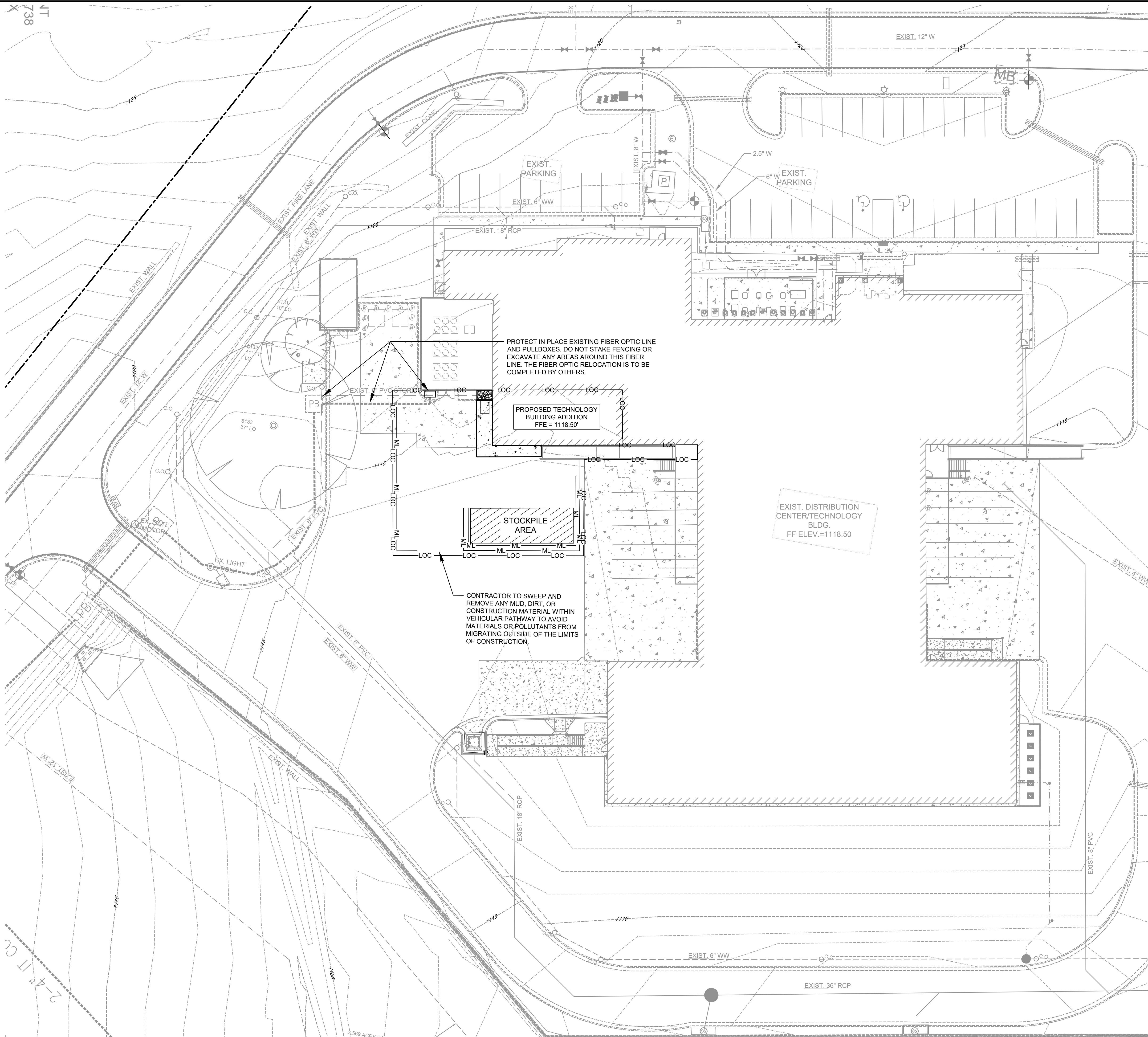

- LEGEND**
- PROPERTY BOUNDARY
 - - - LIMITS OF CONSTRUCTION
 - IP - INLET PROTECTION
 - TP - TREE PROTECTION
 - [Hatched Box] CONTRACTOR'S STAGING/SPOILS AREA
 - [Dashed Line] PROPOSED FINISHED GRADE
 - [Stippled Box] EXISTING CONCRETE PAVEMENT
 - [Patterned Box] PROPOSED CONCRETE PAVEMENT
 - IP - INLET PROTECTION
 - ML - MULCH LOG
 - [Square Box] CONCRETE WASHOUT

NOTES:

- 1) IF AN ADDITIONAL CONCRETE WASHOUT IS NEEDED, THE LOCATION WILL BE DETERMINED ONCE CONSTRUCTION HAS BEGUN AND WILL BE PROPERLY NOTATED ON THE ESC PLAN SHEET AND SWP3 AT THAT TIME.
- 2) ALL REQUIRED NOTICES AND PERMITS MUST BE PLACED IN A HIGHLY VISIBLE LOCATION ONSITE BEFORE THE COMMENCEMENT OF CONSTRUCTION.
- 3) ALL EROSION AND SEDIMENTATION CONTROLS (ESC) MUST BE INSTALLED PRIOR TO ANY DISTURBANCE TO THE PROJECT SITE.
- 4) INSTALL SILT FENCE ACCORDINGLY FOR RUN-ON DIVERSION OR OFFSITE SEDIMENT CONTROL DEPENDING ON UP OR DOWN SLOPE, FACING POST SIDE ON THE DOWN GRADIENT SIDE.
- 5) ALL ESC USED ONSITE MUST BE REGULARLY MONITORED AND MAINTAINED AS NEEDED.
- 6) MUD AND DIRT TRACKED INTO THE ROADWAY MUST BE IMMEDIATELY REMOVED UPON DISCOVERY.
- 7) EXCESS MATERIALS THAT WILL BE TRANSPORTED TO AN OFFSITE LOCATION MUST HAVE THAT LOCATION CLEARED BY COUNTY INSPECTOR.
- 8) LOOSE TRASH AND DEBRIS MUST BE DISPOSED OF PROPERLY ONSITE.
- 9) CONTRACTOR SHALL MAINTAIN AND UTILIZE DUST CONTROL FOR THE DURATION OF THE PROJECT.
- 10) THE STABILIZED CONSTRUCTION ENTRANCE SHALL BE MAINTAINED IN A CONDITION THAT PREVENTS TRACKING ONTO THE PUBLIC ROADWAY ON AN ONGOING/REGULAR BASIS.
- 11) INLET PROTECTION SHALL BE INSTALLED IMMEDIATELY UPON INLET INSTALLATION.
- 12) INITIATE TEMPORARY STABILIZATION WHEN CONSTRUCTION CEASES IN A DISTURBED AREA FOR 14 DAYS.
- 13) INITIATE PERMANENT STABILIZATION IMMEDIATELY ONCE WORK HAS CEASED AND FINAL GRADE HAS BEEN ACHIEVED.
- 14) ALL DISTURBED/BARE AREAS WILL REQUIRE PERMANENT STABILIZATION BEFORE FINAL ACCEPTANCE CAN BE ACHIEVED. AVOID DISTURBING AREAS OF THE PROJECT THAT ARE NOT NECESSARY FOR CONSTRUCTION.
- 15) COUNTY INSPECTOR MAY REQUEST ADDITIONAL CONTROLS TO BE INSTALLED ONSITE AS NEEDED.
- 16) TEMPORARY ESC MEASURES SHALL REMAIN IN PLACE IN ALL DISTURBED AREAS UNTIL ADEQUATE STABILIZATION HAS BEEN ACHIEVED.
- 17) CONTRACTOR MUST REMOVE SEDIMENT FROM ALL STORM SEWER INLET BOXES, LINES, PIPES AND CULVERTS BEFORE CONDITIONAL/FINAL ACCEPTANCE CAN BE OBTAINED.
- 18) TRAVIS COUNTY REQUIRES CERTIFIED SWP3 INSPECTORS TO CONDUCT SWP3 INSPECTIONS AND REPORTING ON ALL PROJECTS WITH ONE ACRE OF DISTURBANCE AND LARGER.
- 19) PERMITTEE SHALL INSPECT ALL INLET PROTECTION DEVICES AS PART OF THE WEEKLY SWP3 REPORT, UPON RECEIVING A FORECAST CALLING FOR RAIN EVENT FOR AN EXTENDED PERIOD, MODIFICATION OF INLET PROTECTION.

**LTSD TDC TECHNOLOGY BLDG ADDITION
AUSTIN, TEXAS 78738**

EROSION & SEDIMENTATION CONTROL PLAN

MALONE ★ WHEELER
INC. SINCE 1975

CIVIL ENGINEERING ★ DEVELOPMENT CONSULTING ★ PROJECT MANAGEMENT
5113 Southwest Pkwy, Suite 260
Austin, Texas 78735
Phone: (512) 899-0601 Fax: (512) 899-0655
Firm Registration No. F-786

FOR REVIEW ONLY

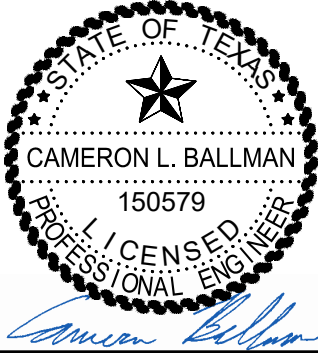

DESIGN BY: PC
CHECKED BY: DB
APPROVED BY: CB
DATE: 3/31/2025

**SHEET C-11
OF C-12**

Agent Authorization Form
For Required Signature
Edwards Aquifer Protection Program
Relating to 30 TAC Chapter 213
Effective June 1, 1999

I ROBERT WINOVITCH,
Print Name

DIRECTOR OF FACILITIES AND CONSTRUCTION,
Title - Owner/President/Other

of Lake Travis Independent School District,
Corporation/Partnership/Entity Name

have authorized Cameron Ballman, P.E.
Print Name of Agent/Engineer

of Malone/Wheeler, Inc.
Print Name of Firm

to represent and act on the behalf of the above named Corporation, Partnership, or Entity for the purpose of preparing and submitting this plan application to the Texas Commission on Environmental Quality (TCEQ) for the review and approval consideration of regulated activities.

I also understand that:

1. The applicant is responsible for compliance with 30 Texas Administrative Code Chapter 213 and any condition of the TCEQ's approval letter. The TCEQ is authorized to assess administrative penalties of up to \$10,000 per day per violation.
2. For those submitting an application who are not the property owner, but who have the right to control and possess the property, additional authorization is required from the owner.
3. Application fees are due and payable at the time the application is submitted. The application fee must be sent to the TCEQ cashier or to the appropriate regional office. The application will not be considered until the correct fee is received by the commission.
4. A notarized copy of the Agent Authorization Form must be provided for the person preparing the application, and this form must accompany the completed application.
5. No person shall commence any regulated activity on the Edwards Aquifer Recharge Zone, Contributing Zone or Transition Zone until the appropriate application for the activity has been filed with and approved by the Executive Director.

SIGNATURE PAGE:

[Signature]
Applicant's Signature

3-24-25
Date

ROBERT WINOVICH, LTICB,

THE STATE OF Texas §

County of Travis §

BEFORE ME, the undersigned authority, on this day personally appeared Robert Winovich known to me to be the person whose name is subscribed to the foregoing instrument, and acknowledged to me that (s)he executed same for the purpose and consideration therein expressed.

GIVEN under my hand and seal of office on this 24th day of March, 2025

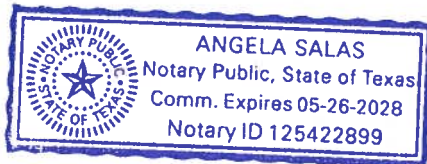

[Signature]
NOTARY PUBLIC

ANGELA SALAS
Typed or Printed Name of Notary

MY COMMISSION EXPIRES: 05-26-2028

Application Fee Form

Texas Commission on Environmental Quality

Name of Proposed Regulated Entity: Lake Travis ISD Technology & Distribution Center

Regulated Entity Location: 16101 W, STATE HWY 71 Building B

Name of Customer: Lake Travis Independent School District

Contact Person: Robert Winovitch Phone: 512-533-5963

Customer Reference Number (if issued): CN 600783575

Regulated Entity Reference Number (if issued): RN 105841654

Austin Regional Office (3373)

☐ Hays

☒ Travis

☐ Williamson

San Antonio Regional Office (3362)

☐ Bexar

☐ Medina

☐ Uvalde

☐ Comal

☐ Kinney

Application fees must be paid by check, certified check, or money order, payable to the **Texas Commission on Environmental Quality**. Your canceled check will serve as your receipt. **This form must be submitted with your fee payment.** This payment is being submitted to:

☒ Austin Regional Office

☐ San Antonio Regional Office

☐ Mailed to: TCEQ - Cashier

☐ Overnight Delivery to: TCEQ - Cashier

Revenues Section

Mail Code 214

P.O. Box 13088

Austin, TX 78711-3088

12100 Park 35 Circle

Building A, 3rd Floor

Austin, TX 78753

(512)239-0357

Site Location (Check All That Apply):

☐ Recharge Zone

☒ Contributing Zone

☐ Transition Zone

Type of Plan	Size	Fee Due
Water Pollution Abatement Plan, Contributing Zone Plan: One Single Family Residential Dwelling	Acres	\$
Water Pollution Abatement Plan, Contributing Zone Plan: Multiple Single Family Residential and Parks	Acres	\$
Water Pollution Abatement Plan, Contributing Zone Plan: Non-residential	Acres	\$
Sewage Collection System	L.F.	\$
Lift Stations without sewer lines	Acres	\$
Underground or Aboveground Storage Tank Facility	Tanks	\$
Piping System(s)(only)	Each	\$
Exception	Each	\$ 500
Extension of Time	Each	\$

Signature: 

Date: 03/31/2025

Application Fee Schedule

Texas Commission on Environmental Quality

Edwards Aquifer Protection Program 30 TAC Chapter 213 (effective 05/01/2008)

Water Pollution Abatement Plans and Modifications

Contributing Zone Plans and Modifications

<i>Project</i>	<i>Project Area in Acres</i>	<i>Fee</i>
One Single Family Residential Dwelling	< 5	\$650
Multiple Single Family Residential and Parks	< 5	\$1,500
	5 < 10	\$3,000
	10 < 40	\$4,000
	40 < 100	\$6,500
	100 < 500	\$8,000
	≥ 500	\$10,000
Non-residential (Commercial, industrial, institutional, multi-family residential, schools, and other sites where regulated activities will occur)	< 1	\$3,000
	1 < 5	\$4,000
	5 < 10	\$5,000
	10 < 40	\$6,500
	40 < 100	\$8,000
	≥ 100	\$10,000

Organized Sewage Collection Systems and Modifications

<i>Project</i>	<i>Cost per Linear Foot</i>	<i>Minimum Fee- Maximum Fee</i>
Sewage Collection Systems	\$0.50	\$650 - \$6,500

Underground and Aboveground Storage Tank System Facility Plans and Modifications

<i>Project</i>	<i>Cost per Tank or Piping System</i>	<i>Minimum Fee- Maximum Fee</i>
Underground and Aboveground Storage Tank Facility	\$650	\$650 - \$6,500

Exception Requests

<i>Project</i>	<i>Fee</i>
Exception Request	\$500

Extension of Time Requests

<i>Project</i>	<i>Fee</i>
Extension of Time Request	\$150