

July 1, 2025

Mr. Eric Beller, P.G.
MSW Permits Section
Texas Commission on Environmental Quality
P.O. Box 13087
Austin, Texas 78711-3087

Re: Lonestar Wastewater Solutions LLC., MSW Permit No. 2231
Application for Permit Modification for Permit Transfer
NOD, TCEQ Tracking No. 31565160

Dear Mr. Beller:

We have received and reviewed the Notice of Deficiency (NOD) issued by TCEQ and received via email on May 30, 2025. The initial TCEQ review determined that the permit modification submittal lacked sufficient information, and supplemental documentation is required for continued review and processing. The NOD requested a response within 30 days of the email date, setting a deadline of June 29, 2025, but an extension was granted to respond to the NOD through July 29, 2025.

Enclosed are revisions made to the Application for Permit Modification for Permit Transfer for the Lonestar Wastewater Solutions LLC facility in Lubbock, Texas. In response to the comments received, the following are our responses to each addressed comment.

1. Please provide documentation that financial assurance will be maintained and identify the type of instrument to be provided in accordance with 30 TAC §330.63(j).

Response: Financial assurance in the amount to cover hiring a third-party to close the facility will be provided through a surety bond in the amount of \$48,993. Attachment 6 was added to the permit modification to address financial assurance and facility closure. Attachment 6.A was added to the permit modification to provide closure cost estimates to hire a third-party to safely shut down operations, including removal and proper disposal of liquid waste, decommissioning of equipment, cleaning and decontamination of process area, post closure inspection, and securing of facility.

2. Please provide confirmation from the Financial Assurance Section of TCEQ of acceptance and adequacy of financial assurance that complies with §305.64(b)(3) and (d).

Response: Financial assurance in the amount to cover hiring a third-party to close the facility will be provided through a surety bond in the amount of \$48,993. An executed copy of the bond from The Hanover Insurance Company is included in Attachment 6.

3. Please provide updated closure cost estimates for the facility.

Response: Attachment 6.A was added to the permit modification to provide closure cost estimates to hire a third-party to safely shut down operations, including removal and proper disposal of liquid waste, decommissioning of equipment, cleaning and decontamination of process area, post closure inspection, and securing of facility.

4. In Attachment 2, the application states "prior to the time that the facility begins operating as a municipal solid waste landfill facility under Lonestar Wastewater Solutions, LLC, and to file a final recording upon completion or disposal operations and closure of the landfill units in accordance with §330.19". This statement appears to imply that MSW permit no. 2231 authorizes the operation of landfill units when this facility is a Type V liquid waste processing facility. Please revise the text to eliminate landfill references and address what is authorized by the existing permit.

Response: The permit modification was updated to indicate the facility is a Municipal Solid Waste Processing facility and removed the mention of municipal solid waste landfill facility.

5. Please provide a core data form for both parties, the transferor and the transferee.

Response: A core data form for both transferor and transferee are provided in Attachment 1.

6. Please provide adjacent landowners mailing labels in Avery 5160 format electronically, hardcopy labels are not necessary.

Response: Avery 5160 labels were created in Microsoft Word and will be transmitted to Mr. Eric Beller, P.G. via email once the submission is mailed.

We believe this submittal addresses all your comments. Per instructions in the correspondence email, one original, two unmarked, and one marked (redline/strikeout) copy is being provided. One of the unmarked copies will be transmitted to the TCEQ Region 2 office in Lubbock. Please feel free to contact me with any questions.

Sincerely,

PARKHILL

By

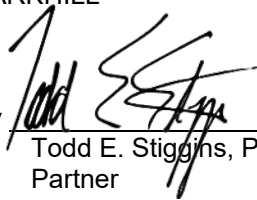
Todd E. Stiggins, P.E.
Partner

TS/nc

cc:

Burgess Stengl, TCEQ

Alison Owen, TCEQ

Phil Johnson, Lonestar Wastewater Solutions, LLC.

ORIGINAL COPY

PERMIT MODIFICATION

LONESTAR WASTEWATER SOLUTIONS LLC

(FORMERLY SOUTHWASTE DISPOSAL LLC)

PERMIT OWNERSHIP CHANGE AND NAME CHANGE

TCEQ PERMIT NO. 2231

Lubbock, Lubbock County, Texas

PERMIT MODIFICATION

**LONESTAR WASTEWATER SOLUTIONS LLC
(FORMERLY SOUTHWASTE DISPOSAL LLC)**

PERMIT OWNERSHIP CHANGE AND NAME CHANGE

TCEQ PERMIT NO. 2231

Lubbock, Lubbock County, Texas

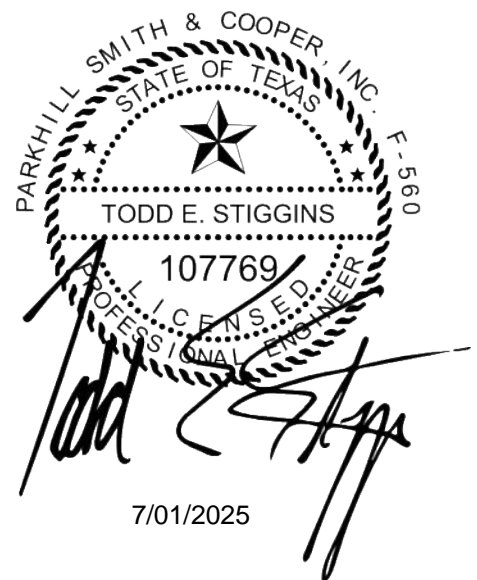

Revision 01 – 07-01-2025

Revision 00 – 04-22-2025

Parkhill Project # 45042.25

TABLE OF CONTENTS

PURPOSE..... 1

REVISIONS TO PERMIT DOCUMENTS 1

APPENDICES

APPENDIX A: REQUIRED TCEQ FORMS AND ATTACHMENTS

ATTACHMENTS

ATTACHMENT 1: CORE DATA FORMS
ATTACHMENT 2: PROPERTY OWNER INFORMATION
ATTACHMENT 2.A: ON-SITE EASEMENTS DRAWING
ATTACHMENT 3: LAND OWNERSHIP INFORMATION
ATTACHMENT 3.A: LAND OWNERSHIP MAP AND OWNERSHIP LIST
ATTACHMENT 4: VERIFICATION OF LEGAL STATUS
ATTACHMENT 4.A: CERTIFICATE OF INCORPORATION
ATTACHMENT 5: EVIDENCE OF COMPETENCY
ATTACHMENT 6: FINANCIAL ASSURANCE
ATTACHMENT 6.A: FACILITY CLOSURE COST ESTIMATES

PURPOSE

Lonestar Wastewater Solutions, LLC requests a permit modification, with public notice, in accordance with 30 TAC § 305.64 and §305.70(13) to reflect the transfer of ownership of MSW Permit No. 2231 from Southwaste Disposal, LLC to Lonestar Wastewater Solutions, LLC. This modification does not involve any physical or operational changes to the existing facility.

In compliance with §330.70(f), one original and two unmarked copies of this permit modification will be submitted. Since the modification pertains solely to the transfer of ownership, no marked version is included.

REVISIONS TO PERMIT DOCUMENTS

TCEQ-20650 – Application Form for Municipal Solid Waste Permit or Registration Modification or Temporary Authorization

Attachments for Permit Name Change or Transfer Modification:

- Attachment 1 – TCEQ Core Data Form documenting the transfer of ownership/control and facility name change from Southwaste Disposal, LLC to Lonestar Wastewater Solutions, LLC.
- Attachment 2 – Required property owner information, including:
 - Legal description of the facility
 - Metes and bounds and property boundary
 - Easements map within the facility boundary
 - Property owner affidavit confirming Lonestar Waster Solutions, LLC as the new permit holder.
- Attachment 3 – Updated land ownership map and landowners list within a one-fourth mile radius of the facility.
- Attachment 4 – Verification of legal status for Lonestar Wastewater Solutions, LLC.
- Attachment 5 – Evidence of competency for Lonestar Wastewater Solutions, LLC
- Attachment 6 – Financial Assurance for Lonestar Wastewater Solutions, LLC
 - Facility Closure Cost Estimates

APPENDIX A: REQUIRED TCEQ FORMS AND ATTACHMENTS



Texas Commission on Environmental Quality

Application Form for Municipal Solid Waste Permit or Registration Modification or Temporary Authorization

Application Tracking Information

Facility Name: _____

Permittee or Registrant Name: _____

MSW Authorization Number: _____

Initial Submission Date: _____

Revision Date: _____

Instructions for completing this form are provided in [form TCEQ-20650-instr](#)¹. If you have questions, contact the Municipal Solid Waste Permits Section by email to [\[REDACTED\]](#) or by phone at 512-239-2335.

Application Data

1. Submission Type

☐ Initial Submission ☐ Notice of Deficiency (NOD) Response

2. Authorization Type

☐ Permit ☐ Registration

3. Application Type

☐ Modification with Public Notice ☐ Modification without Public Notice
☐ Temporary Authorization (TA) ☐ Modification for Name Change or Transfer

4. Application Fee

Amount

The application fee for a modification or temporary authorization is \$150.

Payment Method

☐ Check
☐ Online through ePay portal www3.tceq.texas.gov/epay/

If paid online, enter ePay Trace Number [\[REDACTED\]](#)

¹ www.tceq.texas.gov/downloads/permitting/waste-permits/msw/forms/20650-instr.pdf

5. Electronic Versions of Application

For modifications that require notice, TCEQ will publish electronic versions of the application online. Applicants must provide a clean copy of the administratively complete application and technically complete application. TCEQ will also publish electronic versions of NOD responses online.

6. Party Responsible for Mailing Notice

For modifications that require notice, indicate who will be responsible for mailing notice:

☐ Applicant

☐ Agent in Service

☐ Consultant

Contact Name: _____

Title: _____

Email Address: _____

7. Confidential Documents

Does the application contain confidential documents?

☐ Yes ☐ No

If "Yes", reference the confidential documents in the application, but submit the confidential documents as an attachment in a separate binder marked "CONFIDENTIAL."

8. Facility General Information

Facility Name: _____

Contact Name: _____ Title: _____

MSW Authorization Number (if existing): _____

Regulated Entity Reference Number: **RN** _____

Physical or Street Address: _____

City: _____ County: _____ State: TX Zip Code: _____

Phone Number: _____

Latitude (Degrees, Minutes, Seconds): _____

Longitude (Degrees, Minutes, Seconds): _____

9. Facility Types

☐ Type I

☐ Type IV

☐ Type V

☐ Type IAE

☐ Type IVAE

☐ Type VI

10. Description of the Revisions to the Facility

Provide a brief description of revisions to permit or registration conditions and supporting documents referred to by the permit or registration, and a reference to the specific provisions under which the modification or temporary authorization application is being made. Also, provide an explanation of why the modification or temporary authorization is needed:

11. Facility Contact Information

Site Operator (Permittee or Registrant)

Name: _____

Customer Reference Number: **CN**_____

Contact Name: _____ Title: _____

Mailing Address: _____

City: _____ County: _____ State: _____ Zip Code: _____

Phone Number: _____

Email Address: _____

Texas Secretary of State (SOS) Filing Number: _____

Operator (if different from *Site Operator*)

Name: _____

Customer Reference Number: **CN**_____

Contact Name: _____ Title: _____

Mailing Address: _____

City: _____ County: _____ State: _____ Zip Code: _____

Phone Number: _____

Email Address: _____

Texas Secretary of State (SOS) Filing Number: _____

Consultant (if applicable)

Firm Name: _____

Consultant Name: _____

Texas Board of Professional Engineers Firm Registration Number: _____

Contact Name: _____ Title: _____

Mailing Address: _____

City: _____ County: _____ State: _____ Zip Code: _____

Phone Number: _____

Email Address: _____

Agent in Service (required for out-of-state applicants)

Name: _____

Mailing Address: _____

City: _____ County: _____ State: TX Zip Code: _____

Phone Number: _____

Email Address: _____

12. Ownership Status of the Facility

Is this a modification that changes the legal description, the property owner, or the Site Operator (Permittee or Registrant)?

☐ Yes ☐ No

If the answer is "No", skip this section.

Does the Site Operator (Permittee or Registrant) own all the facility units and all the facility property?

☐ Yes ☐ No

If "No", provide the following information for other owners.

Owner Name: _____

Mailing Address: _____

City: _____ County: _____ State: TX Zip Code: _____

Phone Number: _____

Email Address: _____

Signature Page

Site Operator or Authorized Signatory

I certify under penalty of law that this document and all attachments were prepared under my direction or supervision in accordance with a system designed to assure that qualified personnel properly gather and evaluate the information submitted. Based on my inquiry of the person or persons who manage the system, or those persons directly responsible for gathering the information, the information submitted is, to the best of my knowledge and belief, true, accurate, and complete. I am aware there are significant penalties for submitting false information, including the possibility of fine and imprisonment for knowing violations.

Name: Phil Johnson Title: President

Email Address: [REDACTED]

Signature: *Phil Johnson* Date: 7/1/25

Operator or Principal Executive Officer Designation of Authorized Signatory

To be completed by the operator if the application is signed by an authorized representative for the operator.

I hereby designate _____ as my representative and hereby authorize said representative to sign any application, submit additional information as may be requested by the Commission; and/or appear for me at any hearing or before the Texas Commission on Environmental Quality in conjunction with this request for a Texas Water Code or Texas Solid Waste Disposal Act permit. I further understand that I am responsible for the contents of this application, for oral statements given by my authorized representative in support of the application, and for compliance with the terms and conditions of any permit which might be issued based upon this application.

Operator or Principal Executive Officer Name: _____

Email Address: _____

Signature: _____ Date: _____

Notary

SUBSCRIBED AND SWORN to before me by the said PHILIP JOHNSON

On this 1ST day of JULY, 2025

My commission expires on the 30TH day of APRIL, 2026

Notary Public in and for

LUBBOCK County, Texas

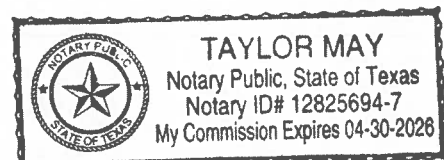

Note: Application Must Bear Signature and Seal of Notary Public

Attachments for Permit or Registration Name Change or Transfer Modification

Refer to instruction document **200650-instr** for professional engineer seal requirements.

Attachments Table 5. Required attachments.

Required Attachments	Attachment Number
TCEQ Core Data Form(s)	
Property Legal Description	
Property Metes and Bounds Description	
Metes and Bounds Drawings	
On-Site Easements Drawing	
Land Ownership Map	
Land Ownership List	
Property Owner Affidavit	
Verification of Legal Status	
Evidence of Competency	

Attachments Table 6. Additional attachments as applicable.

Additional Attachments as Applicable (select all that apply and add others as needed)	Attachment Number
<input type="checkbox"/> Signatory Authority Delegation	
<input type="checkbox"/> Fee Payment Receipt	
<input type="checkbox"/> Confidential Documents	
<input type="checkbox"/> Final Plat Record of Property	
<input type="checkbox"/> Assumed Name Certificate	

ATTACHMENT 1: CORE DATA FORMS



TCEQ Core Data Form

For detailed instructions on completing this form, please read the Core Data Form Instructions or call 512-239-5175.

SECTION I: General Information

1. Reason for Submission (If other is checked please describe in space provided.)		
<input type="checkbox"/> New Permit, Registration or Authorization (Core Data Form should be submitted with the program application.)		
<input type="checkbox"/> Renewal (Core Data Form should be submitted with the renewal form)	<input checked="" type="checkbox"/> Other	Transfer of Ownership/Control & Facility Name Change
2. Customer Reference Number (if issued)	Follow this link to search for CN or RN numbers in Central Registry**	3. Regulated Entity Reference Number (if issued)
CN 603436114		RN 101289171

SECTION II: Customer Information

4. General Customer Information		5. Effective Date for Customer Information Updates (mm/dd/yyyy)						
<input type="checkbox"/> New Customer <input type="checkbox"/> Update to Customer Information <input checked="" type="checkbox"/> Change in Regulated Entity Ownership								
<input type="checkbox"/> Change in Legal Name (Verifiable with the Texas Secretary of State or Texas Comptroller of Public Accounts)								
<i>The Customer Name submitted here may be updated automatically based on what is current and active with the Texas Secretary of State (SOS) or Texas Comptroller of Public Accounts (CPA).</i>								
6. Customer Legal Name (If an individual, print last name first: eg: Doe, John)			<i>If new Customer, enter previous Customer below:</i>					
			SOUTHWASTE DISPOSAL LLC					
7. TX SOS/CPA Filing Number	8. TX State Tax ID (11 digits)	9. Federal Tax ID (9 digits)	10. DUNS Number (if applicable)					
203596390	12035963656							
11. Type of Customer:	<input checked="" type="checkbox"/> Corporation	<input type="checkbox"/> Individual	Partnership: <input type="checkbox"/> General <input type="checkbox"/> Limited					
Government: <input type="checkbox"/> City <input type="checkbox"/> County <input type="checkbox"/> Federal <input type="checkbox"/> Local <input type="checkbox"/> State <input type="checkbox"/> Other	<input type="checkbox"/> Sole Proprietorship	<input type="checkbox"/> Other:						
12. Number of Employees		13. Independently Owned and Operated?						
<input checked="" type="checkbox"/> 0-20 <input type="checkbox"/> 21-100 <input type="checkbox"/> 101-250 <input type="checkbox"/> 251-500 <input type="checkbox"/> 501 and higher		<input checked="" type="checkbox"/> Yes <input type="checkbox"/> No						
14. Customer Role (Proposed or Actual) – as it relates to the Regulated Entity listed on this form. Please check one of the following								
<input type="checkbox"/> Owner <input type="checkbox"/> Operator <input type="checkbox"/> Owner & Operator <input checked="" type="checkbox"/> Other: Former owner/operator								
<input type="checkbox"/> Occupational Licensee <input type="checkbox"/> Responsible Party <input type="checkbox"/> VCP/BSA Applicant								
15. Mailing Address:	16350 Park Ten Pl, Suite 215							
	City	Houston	State	TX	ZIP	77084	ZIP + 4	
16. Country Mailing Information (if outside USA)					17. E-Mail Address (if applicable)			

18. Telephone Number	19. Extension or Code	20. Fax Number (if applicable)
(866) 413-9494		() -

SECTION III: Regulated Entity Information

21. General Regulated Entity Information (If 'New Regulated Entity' is selected, a new permit application is also required.)								
<input type="checkbox"/> New Regulated Entity <input checked="" type="checkbox"/> Update to Regulated Entity Name <input checked="" type="checkbox"/> Update to Regulated Entity Information								
<i>The Regulated Entity Name submitted may be updated, in order to meet TCEQ Core Data Standards (removal of organizational endings such as Inc, LP, or LLC).</i>								
22. Regulated Entity Name (Enter name of the site where the regulated action is taking place.)								
Lonestar Wastewater Solutions, LLC								
23. Street Address of the Regulated Entity: (No PO Boxes)	801 N. Avenue P							
	City	Lubbock	State	TX	ZIP	79403	ZIP + 4	
24. County	Lubbock							

If no Street Address is provided, fields 25-28 are required.

25. Description to Physical Location:								
26. Nearest City						State	Nearest ZIP Code	
<i>Latitude/Longitude are required and may be added/updated to meet TCEQ Core Data Standards. (Geocoding of the Physical Address may be used to supply coordinates where none have been provided or to gain accuracy).</i>								
27. Latitude (N) In Decimal:						28. Longitude (W) In Decimal:		
Degrees	Minutes		Seconds		Degrees	Minutes		Seconds
29. Primary SIC Code	30. Secondary SIC Code		31. Primary NAICS Code			32. Secondary NAICS Code		
(4 digits)	(4 digits)		(5 or 6 digits)			(5 or 6 digits)		
4952			221320					
33. What is the Primary Business of this entity? (Do not repeat the SIC or NAICS description.)								
Grease and Grit Processing								
34. Mailing Address:	1901 E. County Road 7110							
	City	Lubbock	State	TX	ZIP	79404	ZIP + 4	
35. E-Mail Address:	[REDACTED]							
36. Telephone Number	37. Extension or Code				38. Fax Number (if applicable)			
(806) 863-4777					() -			

39. TCEQ Programs and ID Numbers Check all Programs and write in the permits/registration numbers that will be affected by the updates submitted on this form. See the Core Data Form instructions for additional guidance.

<input type="checkbox"/> Dam Safety	<input type="checkbox"/> Districts	<input type="checkbox"/> Edwards Aquifer	<input type="checkbox"/> Emissions Inventory Air	<input type="checkbox"/> Industrial Hazardous Waste
<input checked="" type="checkbox"/> Municipal Solid Waste	<input type="checkbox"/> New Source Review Air	<input type="checkbox"/> OSSF	<input type="checkbox"/> Petroleum Storage Tank	<input type="checkbox"/> PWS
2231				
<input type="checkbox"/> Sludge	<input type="checkbox"/> Storm Water	<input type="checkbox"/> Title V Air	<input type="checkbox"/> Tires	<input type="checkbox"/> Used Oil
<input type="checkbox"/> Voluntary Cleanup	<input type="checkbox"/> Wastewater	<input type="checkbox"/> Wastewater Agriculture	<input type="checkbox"/> Water Rights	<input checked="" type="checkbox"/> Other:
				LN0283K

SECTION IV: Preparer Information

40. Name:	Edward Crawley, P.E.	41. Title:	Engineer
42. Telephone Number	43. Ext./Code	44. Fax Number	45. E-Mail Address
{ 806 } 473-3736		() -	

SECTION V: Authorized Signature

46. By my signature below, I certify, to the best of my knowledge, that the information provided in this form is true and complete, and that I have signature authority to submit this form on behalf of the entity specified in Section II, Field 6 and/or as required for the updates to the ID numbers identified in field 39.

Company:	Southwest Disposal LLC	Job Title:	Director of Permitting & Compliance
Name (In Print):	Ben Camacho	Phone:	(713) 413- 9400
Signature:		Date:	6-12-2025



TCEQ Core Data Form

For detailed instructions on completing this form, please read the Core Data Form Instructions or call 512-239-5175.

SECTION I: General Information

1. Reason for Submission (If other is checked please describe in space provided.)		
<input type="checkbox"/> New Permit, Registration or Authorization (Core Data Form should be submitted with the program application.)		
<input type="checkbox"/> Renewal (Core Data Form should be submitted with the renewal form)	<input checked="" type="checkbox"/> Other	Transfer of Ownership/Control & Facility Name Change
2. Customer Reference Number (if issued)	Follow this link to search for CN or RN numbers in Central Registry**	3. Regulated Entity Reference Number (if issued)
CN 603793993		RN 101289171

SECTION II: Customer Information

4. General Customer Information		5. Effective Date for Customer Information Updates (mm/dd/yyyy)		
<input checked="" type="checkbox"/> New Customer <input type="checkbox"/> Update to Customer Information <input checked="" type="checkbox"/> Change in Regulated Entity Ownership				
<input checked="" type="checkbox"/> Change in Legal Name (Verifiable with the Texas Secretary of State or Texas Comptroller of Public Accounts)				
<i>The Customer Name submitted here may be updated automatically based on what is current and active with the Texas Secretary of State (SOS) or Texas Comptroller of Public Accounts (CPA).</i>				
6. Customer Legal Name (If an individual, print last name first: eg: Doe, John)			<i>If new Customer, enter previous Customer below:</i>	
Lonestar Wastewater Solutions, LLC			SouthWaste Disposal, LLC	
7. TX SOS/CPA Filing Number		8. TX State Tax ID (11 digits)		9. Federal Tax ID (9 digits)
0801184688		32040526793		10. DUNS Number (if applicable)
11. Type of Customer:		<input checked="" type="checkbox"/> Corporation <input type="checkbox"/> Individual <input type="checkbox"/> Partnership: <input type="checkbox"/> General <input type="checkbox"/> Limited		
Government: <input type="checkbox"/> City <input type="checkbox"/> County <input type="checkbox"/> Federal <input type="checkbox"/> Local <input type="checkbox"/> State <input type="checkbox"/> Other		<input type="checkbox"/> Sole Proprietorship <input type="checkbox"/> Other:		
12. Number of Employees				13. Independently Owned and Operated?
<input checked="" type="checkbox"/> 0-20 <input type="checkbox"/> 21-100 <input type="checkbox"/> 101-250 <input type="checkbox"/> 251-500 <input type="checkbox"/> 501 and higher				<input checked="" type="checkbox"/> Yes <input type="checkbox"/> No
14. Customer Role (Proposed or Actual) – as it relates to the Regulated Entity listed on this form. Please check one of the following				
<input type="checkbox"/> Owner <input type="checkbox"/> Operator <input checked="" type="checkbox"/> Owner & Operator <input type="checkbox"/> Other: <input type="checkbox"/> Occupational Licensee <input type="checkbox"/> Responsible Party <input type="checkbox"/> VCP/BSA Applicant				
15. Mailing Address:	1901 E. County Road 7110			
	City	Lubbock	State	TX
		ZIP	79404	ZIP + 4
16. Country Mailing Information (if outside USA)			17. E-Mail Address (if applicable)	
			[REDACTED]	

18. Telephone Number	19. Extension or Code	20. Fax Number (if applicable)
(806) 863-4777		() -

SECTION III: Regulated Entity Information

21. General Regulated Entity Information (If 'New Regulated Entity' is selected, a new permit application is also required.)								
<input type="checkbox"/> New Regulated Entity <input checked="" type="checkbox"/> Update to Regulated Entity Name <input checked="" type="checkbox"/> Update to Regulated Entity Information								
<i>The Regulated Entity Name submitted may be updated, in order to meet TCEQ Core Data Standards (removal of organizational endings such as Inc, LP, or LLC).</i>								
22. Regulated Entity Name (Enter name of the site where the regulated action is taking place.)								
Lonestar Wastewater Solutions, LLC								
23. Street Address of the Regulated Entity: (No PO Boxes)	801 N. Avenue P							
	City	Lubbock	State	TX	ZIP	79403	ZIP + 4	
24. County	Lubbock							

If no Street Address is provided, fields 25-28 are required.

25. Description to Physical Location:								
26. Nearest City						State	Nearest ZIP Code	
<i>Latitude/Longitude are required and may be added/updated to meet TCEQ Core Data Standards. (Geocoding of the Physical Address may be used to supply coordinates where none have been provided or to gain accuracy).</i>								
27. Latitude (N) In Decimal:						28. Longitude (W) In Decimal:		
Degrees	Minutes		Seconds		Degrees	Minutes		Seconds
29. Primary SIC Code	30. Secondary SIC Code		31. Primary NAICS Code			32. Secondary NAICS Code		
(4 digits)	(4 digits)		(5 or 6 digits)			(5 or 6 digits)		
4952			221320					
33. What is the Primary Business of this entity? (Do not repeat the SIC or NAICS description.)								
Grease and Grit Processing								
34. Mailing Address:	1901 E. County Road 7110							
	City	Lubbock	State	TX	ZIP	79404	ZIP + 4	
35. E-Mail Address:	[REDACTED]							
36. Telephone Number	37. Extension or Code				38. Fax Number (if applicable)			
(806) 863-4777					() -			

39. TCEQ Programs and ID Numbers Check all Programs and write in the permits/registration numbers that will be affected by the updates submitted on this form. See the Core Data Form instructions for additional guidance.

<input type="checkbox"/> Dam Safety	<input type="checkbox"/> Districts	<input type="checkbox"/> Edwards Aquifer	<input type="checkbox"/> Emissions Inventory Air	<input type="checkbox"/> Industrial Hazardous Waste
<input checked="" type="checkbox"/> Municipal Solid Waste	<input type="checkbox"/> New Source Review Air	<input type="checkbox"/> OSSF	<input type="checkbox"/> Petroleum Storage Tank	<input type="checkbox"/> PWS
2231				
<input type="checkbox"/> Sludge	<input type="checkbox"/> Storm Water	<input type="checkbox"/> Title V Air	<input type="checkbox"/> Tires	<input type="checkbox"/> Used Oil
<input type="checkbox"/> Voluntary Cleanup	<input type="checkbox"/> Wastewater	<input type="checkbox"/> Wastewater Agriculture	<input type="checkbox"/> Water Rights	<input checked="" type="checkbox"/> Other: Former Air Account
				LN0283K

SECTION IV: Preparer Information

40. Name:	Edward Crawley, P.E.	41. Title:	Project Engineer
42. Telephone Number	43. Ext./Code	44. Fax Number	45. E-Mail Address
(806) 473-3736		() -	

SECTION V: Authorized Signature

46. By my signature below, I certify, to the best of my knowledge, that the information provided in this form is true and complete, and that I have signature authority to submit this form on behalf of the entity specified in Section II, Field 6 and/or as required for the updates to the ID numbers identified in field 39.

Company:	Lonestar Wastewater Solutions, LLC	Job Title:	President
Name (In Print):	Phil Johnson	Phone:	(806) 863- 4777
Signature:		Date:	7/1/25 7/1/25

ATTACHMENT 2: PROPERTY OWNER INFORMATION

PROPERTY DESCRIPTION

The Lubbock County Central Appraisal District denotes the legal description of the property as SOJO L1 with a physical address of 801 N Avenue P, Lubbock, Texas 79403. An additional parcel located directly south housing an easement is associated with the transfer, with the legal description from Lubbock County as BLK A SEC 16 AB 820 TR 2.

EASEMENTS

All existing easements within the facility property boundary are identified in the attached City of Lubbock ROW Sectional Map (Attachment 2.B). The referenced property boundary is marked on the figure in red.

PROPERTY OWNER AFFIDAVIT

In accordance with 30 TAC §330.59(d)(2)(A), Lonestar Wastewater Solutions, LLC acknowledges the State of Texas may hold them jointly or severally responsible for the operation, maintenance, closure, and post-closure care of the facility.

In accordance with 30 TAC §330.59(d)(2)(B), Lonestar Wastewater Solutions, LLC has recorded this affidavit in the county deed records to notify the public that the facility remains a permitted municipal solid waste site. A final recording will also be filed upon completion of disposal operations and closure of the landfill units, as required by 30 TAC §330.19.

In accordance with 30 TAC §330.59(d)(2)(C), the State of Texas retains access to the site during its active life and post-closure care for inspection and maintenance.

The signed Property Owner Affidavit is included in this Attachment.

PROPERTY OWNER AFFIDAVIT FOR PERMIT OWNERSHIP TRANSFER

State of Texas

County of Lubbock

Southwaste Disposal, LLC is the owner of the 3.25 property in Lubbock County, Texas, SOJO L1 with a physical address of 801 N Avenue P, Lubbock, Texas 79403. The property is currently permitted as a Type V Municipal Solid Waste Processing Facility under TCEQ Permit No. 2231.

Effective May 31, 2025, ownership of the property and the associated municipal solid waste permit is being transferred to Lonestar Wastewater Solutions, LLC, in accordance with 30 TAC §305.64 and 30 TAC §330.59(d)(2)(A).

In accordance with §330.63(d)(2), the parties acknowledge and affirm that upon transfer of ownership and permit rights, Lonestar Wastewater Solutions, LLC assumes full responsibility for the regulatory compliance, operation, maintenance, closure, and post-closure care of the facility. Southwaste Disposal, LLC relinquishes all control and liability associated with the MSW permit and its compliance.

Lonestar Wastewater Solutions, LLC acknowledges that the State of Texas may hold them either jointly or severally responsible for the operation, maintenance, and closure or post-closure care of the facility

Lonestar Wastewater Solutions, LLC acknowledges their responsibility to file with the county deed records an affidavit to the public advising that the land will be used for a solid waste processing facility following the permit transfer, and prior to the time that the facility begins operating under Lonestar Wastewater Solutions, LLC, and to file a final recording upon completion or disposal operations and closure of the landfill units in accordance with §330.19.

Lonestar Wastewater Solutions, LLC acknowledges the State of Texas shall have access to the property during the active life and post-closure care period, if required, after closure for the purpose of inspection and maintenance.

Edward Hickman

[Signature]

Edward Hickman

[Name]

CFO

[Title]

Southwaste Disposal, LLC

Phil Johnson

[Signature]

Phil Johnson

[Name]

PRESIDENT

[Title]

Lonestar Wastewater Solutions, LLC

SUBSCRIBED AND SWORN IN to before me by the said _____

On this 16th day of April, 2025

My commission expires on the 8th day of April, 2025

Tiffany Garza

Notary Public in and for

LUBBOCK County, Texas

Note: Application Must Bear Signature and Seal of Notary Public

Notary Public, State of Texas

[Notary Seal]

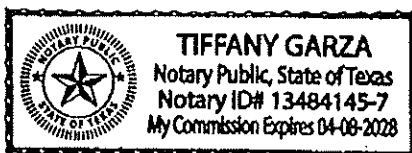

ATTACHMENT 2.A: ON-SITE EASEMENT DRAWING

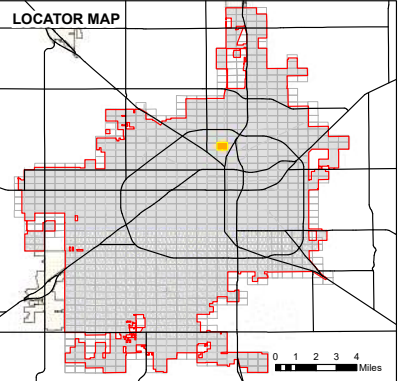
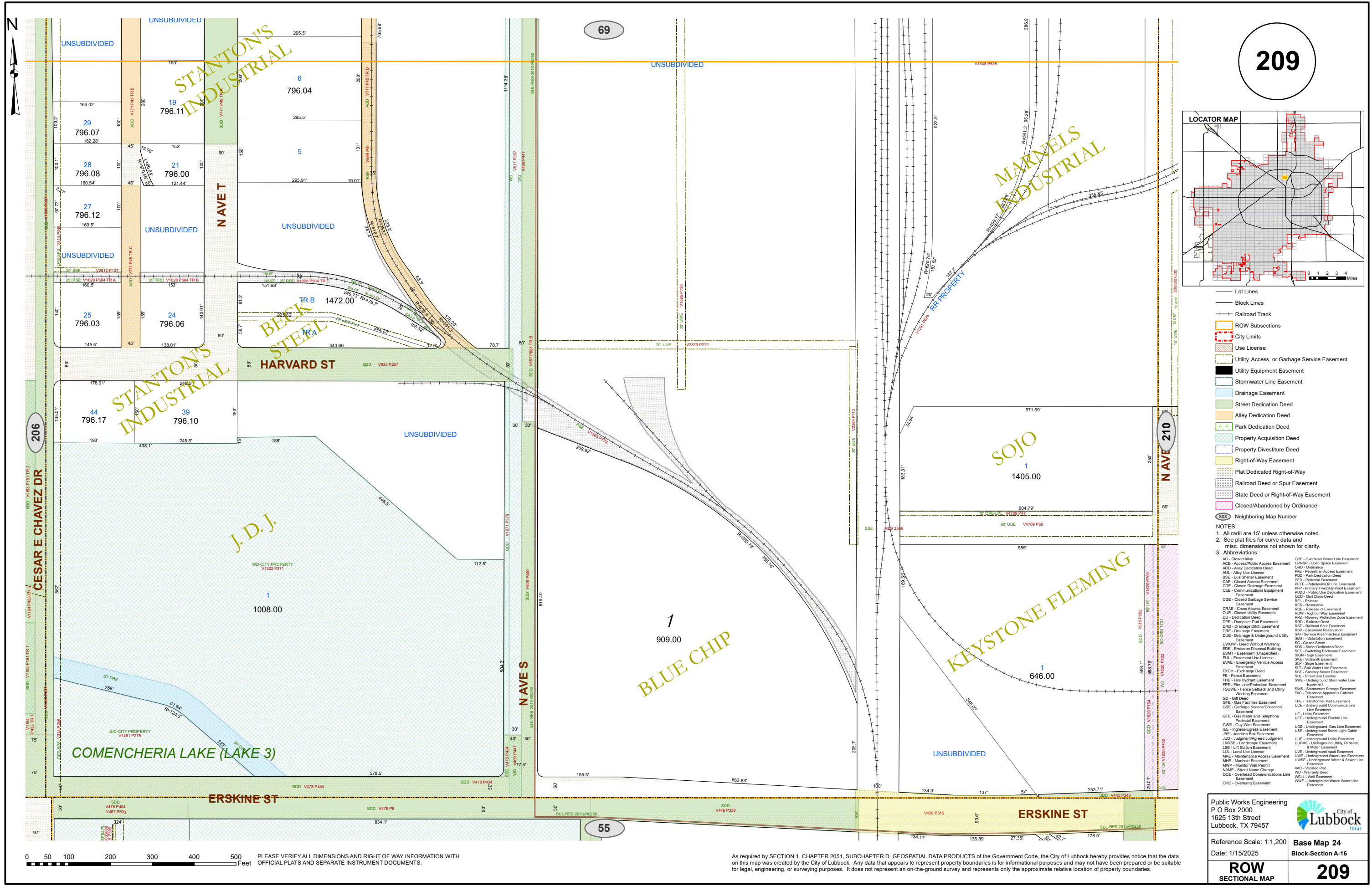

- Lot Lines
- Block Lines
- Railroad Track
- City Limits
- ROW Subsections
- Use License
- Utility Access, or Garbage Service Easement
- Utility Equipment Easement
- Stormwater Line Easement
- Drainage Easement
- Street Dedication Deed
- Alley Dedication Deed
- Park Dedication Deed
- Property Acquisition Deed
- Property Divestiture Deed
- Right-of-Way Easement
- Plat Dedicated Right-of-Way
- Railroad Deed or Spur Easement
- State Deed or Right-of-Way Easement
- Closed/Abandoned by Ordinance
- Neighboring Map Number

NOTES:
1. All radii are 15' unless otherwise noted.
2. See plat files for curve data and misc. dimensions not shown for clarity.
3. Abbreviations:

AC - Closed Alley	OPE - Overhead Power Line Easement
ACE - Access/Public Access Easement	OPSP - Open Space Easement
ADD - Alley Dedication Deed	ORD - Ordinance
ALE - Alley Use License	PAC - Pedestrian Access Easement
BSE - Bus Shelter Easement	PDD - Park Dedication Deed
CAE - Closed Access Easement	PEL - Pedestal Easement
CDE - Closed Drainage Easement	PETE - Petroleum/Oil Line Easement
CCE - Closed Communications Equipment Easement	PPF - Primary Flexibility Point Easement
CCE - Closed Garbage Service Easement	PUD - Public Use Dedication Easement
CRAE - Cross Access Easement	QCD - Quit Claim Deed
CUE - Closed Utility Easement	REL - Release
DD - Dedication Deed	RES - Resolution
DPE - Dumpster Pad Easement	ROE - Release of Easement
DRD - Drainage Ditch Easement	ROW - Right of Way Easement
DRE - Drainage Easement	RPP - Railway Protection Zone Easement
DUE - Drainage & Underground Utility Easement	RSD - Railroad Deed
DWOW - Deed Without Warranty	RSN - Railroad Spur Easement
EDD - Emission Disposal Building	RSV - Easement Reservation
ESMT - Easement (Unspecified)	SAI - Service Area Interface Easement
EUL - Easement Use License	SST - Substation Easement
EVAE - Emergency Vehicle Access Easement	SC - Closed Street
EXCH - Exchange Deed	SDD - Street Dedication Deed
FE - Fence Easement	SEE - Switching Enclosure Easement
FHE - Fire Hydrant Easement	SGN - Sign Easement
FSLWE - Fence Setback and Utility Working Easement	SLE - Sidewalk Easement
GD - GRI Deed	SLP - Slope Easement
GFE - Gas Facilities Easement	SLS - Salt Water Line Easement
GSE - Garbage Service/Collection Line Easement	SSE - Sanitary Sewer Easement
GTE - Gas Meter and Telephone Pedestal Easement	SUL - Street Use License
GW - Guy Wire Easement	SWE - Underground Stormwater Line Easement
HE - High-Signals Easement	SWS - Stormwater Storage Easement
JBE - Junction Box Easement	TAC - Telephone Apparatus Cabinet Easement
JUD - Judgment/Agreed Judgment	TPE - Transformer Pad Easement
LANDSE - Landscape Easement	UCE - Underground Communications Line Easement
LSE - LRT Station Easement	UEE - Underground Electric Line Easement
LUL - Land Use License	UGE - Underground Gas Line Easement
MAE - Maintenance Access Easement	USE - Underground Street Light Easement
MRE - Manhole Easement	UUE - Underground Utility Easement
MWP - Monitor Well Permit	UUE - Underground Utility, Pedestal, & Meter Easement
NAME - Street Name Change	UWE - Underground Water Line Easement
OCE - Overhead Communications Line Easement	UWE - Underground Water & Sewer Line Easement
OHE - Overhang Easement	VAC - Vacated Plat
	WD - Warranty Deed
	WEL - Well Easement
	WWE - Underground Waste Water Line Easement

Public Works Engineering
P O Box 2000
1625 13th Street
Lubbock, TX 79457

City of Lubbock
TEXAS

Reference Scale: 1:1,200
Date: 1/15/2025

Base Map 24
Block-Section A-16

ROW
SECTIONAL MAP

209

As required by SECTION 1, CHAPTER 2051, SUBCHAPTER D. GEOSPATIAL DATA PRODUCTS of the Government Code, the City of Lubbock hereby provides notice that the data on this map was created by the City of Lubbock. Any data that appears to represent property boundaries is for informational purposes and may not have been prepared or be suitable for legal, engineering, or surveying purposes. It does not represent an on-the-ground survey and represents only the approximate relative location of property boundaries.

ATTACHMENT 3: LAND OWNERSHIP INFORMATION

LAND OWNERSHIP

All property owners within a quarter mile of the Lonestar Wastewater Solutions, LLC facility were compiled from the Lubbock County Central Appraisal District. The land ownership drawing and a tabular list of properties and ownership information is included in Attachment 3.A.

MINERAL INTEREST

Information listed in the Lubbock Country Central Appraisal District did not indicate any mineral interest ownership within the referenced facility property boundary.

ATTACHMENT 3.A: LAND OWNERSHIP MAP AND OWNERSHIP LIST

\\PROJECTS-DES\PROJECTS\2025\45042.25\03_DSGN01_DWG\050_CIVIL\02_CONTENT\45042.24_LAND-OWNERSHIP-MAP.DWG, 2/19/2025 3:15 PM, nrcrawley

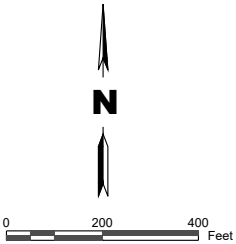
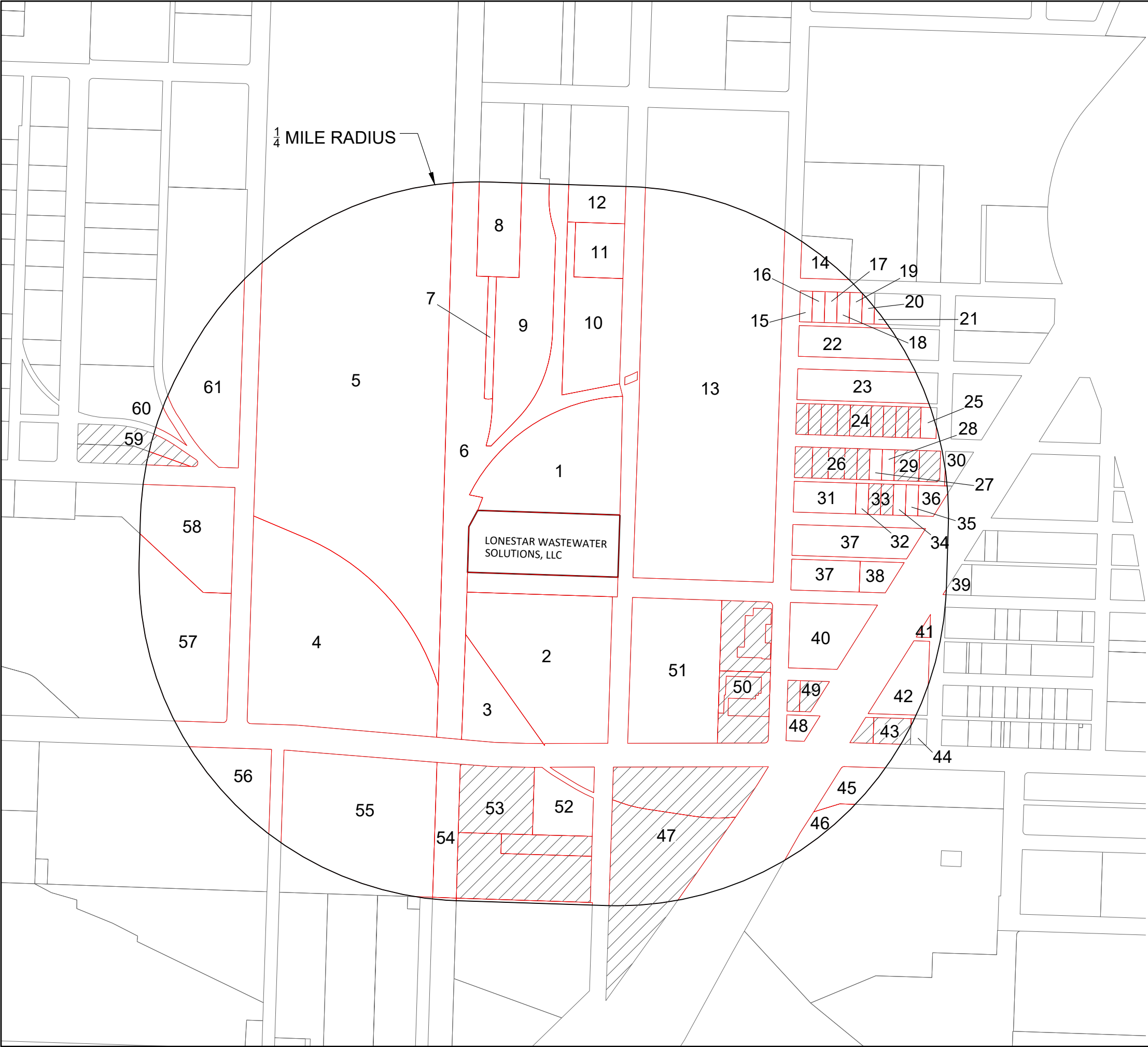

Parkhill



4/19/2025

Parkhill.com

**Lonestar Wastewater
Solutions LLC
TCEQ MSW Permit No. 2231
Permit Transfer Modification**

CLIENT

Lonestar Wastewater
Solutions LLC
801 N. Ave P
Lubbock, Texas 79403

PROJECT NO.

45042.25

#	DATE	DESCRIPTION
---	------	-------------

**Land Ownership
Map**

FIGURE 1

No.	Legal Description	Street Address	Owner	Mailing Address	City, State	Zip Code
1	BLK A SEC 15 AB 85 & BLK A SEC 16 AB 820 TR 2A	901 N AVE P	ERGON ASPHALT & EMULSIONS INC	2829 LAKELAND DR	FLOWOOD, MS	39232
2	KEYSTONE FLEMING BLK 1	1508 ERSKINE ST	FEATHERLITE CORP	PO Box 425	FORT WORTH, TX	76101-0425
3	BLK A SEC 16 AB 820 TR 5 LESS RR CORR	1608 ERSKINE ST	ACME BRICK CO	PO Box 425	FORT WORTH, TX	76101-0425
4	BLUE CHIP BLK 1	1802 ERSKINE ST	MARTINEZ JUAN D	1802 ERSKINE ST	LUBBOCK, TX	79415-1908
5	BLK A SEC 16 AB 820 TR 1C & 1C1A	810 N AVE U	TI HOLDINGS LLC	1209 E 24TH ST	PLAINVIEW, TX	79072
6	BLK A SEC 16 AB 820 RR CORR	1610 MARSHALL ST 1610 ERSKINE ST	BNSF RAILWAY COMPANY	2650 LOU MENK DR	FORT WORTH, TX	76161-0089
7	BLK A SEC 16 AB 840 TR RR1	1623 MARSHALL ST	ERGON ASPHALT & EMULSIONS INC	2829 LAKELAND DR	FLOWOOD, MS	39232
8	MARNELS INDUSTRIAL TR 3 L 1	1621 MARSHALL ST	HC ONE LTD PARTNERSHIP	6211 N ANN ARBOR RD	DUNDEE, MI	48131-9527
9	MARNELS INDUSTRIAL TR 3 L 2	1619 MARSHALL ST	ERGON ASPHALT & EMULSIONS INC	2829 LAKELAND DR	FLOWOOD, MS	39232
10	MARNELS INDUSTRIAL S PT TR 2 & STRIP ON E SIDE	1101 N AVE P	ERGON ASPHALT & EMULSIONS INC	2829 LAKELAND DR	FLOWOOD, MS	39232
11	MARNELS INDUSTRIAL MID PT OF TR 2 & STRIP ON E SIDE	1103 N AVE P	ERGON ASPHALT & EMULSIONS INC	2829 LAKELAND DR	FLOWOOD, MS	39232
12	MARNELS INDUSTRIAL N PT TR 2 & STRIP ADJACENT	1615 MARSHALL ST 1611 MARSHALL ST	ERGON ASPHALT & EMULSIONS INC	2829 LAKELAND DR	FLOWOOD, MS	39232
13	BLK A SEC 15 AB 85 TR B4	1501 MARSHALL ST	ATTEBURY GRAIN INC	PO BOX 2707	AMARILLO, TX	79105-2707
14	BLK A SEC 15 AB 85 TR AF9C	1318 KEMPER ST	SEYMOUR PROPERTY HOLDINGS LLC	5713 3RD ST	LUBBOCK, TX	79416
15	COUNTRY CLUB BLK 4 L 11	1321 KEMPER ST	EAGLE, DIANE	6318 9TH ST	LUBBOCK, TX	79416-5910
16	COUNTRY CLUB BLK 4 L 10	1319 KEMPER ST	EAGLE, DIANE	6318 9TH ST	LUBBOCK, TX	79416-5910
17	COUNTRY CLUB BLK 4 L 9	1317 KEMPER ST	MARTIN, NELSON	1313 KEMPER ST	LUBBOCK, TX	79403-2524
18	COUNTRY CLUB BLK 4 L 8	1315 KEMPER ST	EAGLE, DIANE	6318 9TH ST	LUBBOCK, TX	79416-5910
19	COUNTRY CLUB BLK 4 L 7	1313 KEMPER ST	EAGLE, DIANE	6318 9TH ST	LUBBOCK, TX	79416-5910
20	COUNTRY CLUB BLK 4 L 6	1311 KEMPER ST	JIMENEZ JOE JR & SHAILA D	1311 KEMPER ST	LUBBOCK, TX	79403-2510
21	COUNTRY CLUB BLK 4 L 1 THRU 5	1305 KEMPER ST	WORD OF LIFE TABERNACLE	1311 KEMPER ST	LUBBOCK, TX	79403-2510
22	COUNTRY CLUB BLK 4 L 14-24	1310 JARVIS ST	DELTA LAND SURVEYING LLC	1310 JARVIS ST	LUBBOCK, TX	79403
23	COUNTRY CLUB BLK 5 L 1 THRU 11	1305 JARVIS ST 1321 JARVIS ST 1319 JARVIS ST 1317 JARVIS ST 1315 JARVIS ST 1313 JARVIS ST 1311 JARVIS ST 1309 JARVIS ST 1307 JARVIS ST 1305 JARVIS ST 1303 JARVIS ST 1301 JARVIS ST	RMFT COMMERCIAL HOLDINGS	9606 UTICA DR	LUBBOCK, TX	79424
24	COUNTRY CLUB BLK 5 L 14 THRU 23	1324 ITASCA ST	HALL CHARLES M	3612 106TH ST	LUBBOCK, TX	79423
25	COUNTRY CLUB BLK 5 L 24	1302 ITASCA ST	PHARR JIMMY R & JOHN K	PO BOX 2791	LUBBOCK, TX	79409-2791
26	COUNTRY CLUB BLK 12 L 6 THRU 11	1323 ITASCA ST 1321 ITASCA ST 1319 ITASCA ST 1313 ITASCA ST 1311 ITASCA ST	HALL CHARLES M	3612 106TH ST	LUBBOCK, TX	79423
27	COUNTRY CLUB BLK 12 L 5	1309 ITASCA ST	REYNA CONCEPCION & JULIA N JUAREZ	1910 AVE N	LUBBOCK, TX	79405
28	COUNTRY CLUB BLK 12 L 4	1307 ITASCA ST	PENA SERGIO H U & LILIANA M MORALES & GRISEL Y U MENDOZA	506 E 37TH STREET	LUBBOCK, TX	79404
29	COUNTRY CLUB BLK 12 L 1 THRU 3	1303 ITASCA ST 1301 ITASCA ST	PHARR JIMMY R & JOHN K	PO BOX 2791	LUBBOCK, TX	79408-2791
30	COUNTRY CLUB BLK 11 L 11-12 & 12A	907 N AVE Q DR	PHARR CONSTRUCTION CO INC	PO BOX 2791	LUBBOCK, TX	79408-2791
31	COUNTRY CLUB BLK 12 L 14-18	1320 HARVARD ST 1324 HARVAD ST	HALL CHARLES M	3612 106TH ST	LUBBOCK, TX	79423
32	COUNTRY CLUB BLK 12 L 19	1312 HARVARD ST	THUNDER SUN INC	6303 INDIANA AVE	LUBBOCK, TX	79413-5713
33	COUNTRY CLUB BLK 12 L 20 THRU 21	1310 HARVARD ST 1308 HARVARD ST	ALCORTA MANUEL & YOLANDA	1308 HARVARD ST	LUBBOCK, TX	79403

No.	Legal Description	Street Address	Owner	Mailing Address	City, State	Zip Code
34	COUNTRY CLUB BLK 12 L 22	1306 HARVARD ST	CAPETILLO GILBERT & VICKY C	1306 HARVARD ST	LUBBOCK, TX	79403
35	COUNTRY CLUB BLK 12 L 23	1304 HARVARD ST	HERRING, ALTON	PO BOX 2006	SHALLOWATER, TX	79363-2006
36	COUNTRY CLUB BLK 12 L 24 & 24A	901 N AVE Q DR	PHARR JIMMY R & JOHN K	PO BOX 2791	LUBBOCK, TX	79409-2791
37	COUNTRY CLUB BLK 13 L 1 THRU 18 & W 25' OF 19	1309 HARVARD ST 1322 GRINNELL ST 1320 GRINNELL ST 1318 GRINNELL ST 1316 GRINNELL ST 1314 GRINNELL ST 1312 GRINNELL ST 1311 HARVARD ST 1313 HARVARD ST 1315 HARVARD ST 1317 HARVARD ST 1307 HARVARD ST 1317 HARVARD ST 1319 HARVARD ST 1321 HARVARD ST	RMFT COMMERCIAL HOLDINGS	9606 UTICA DR	LUBBOCK, TX	79424
38	COUNTRY CLUB BLK 13 E 25' OF L 19 & ALL OF 20 & PT OF 21-22	803 N AVE Q DR	LITTLED A PROPERTIES LLC	4415 66TH ST	LUBBOCK, TX	79414
39	COUNTRY CLUB BLK 14 L 13 & 14	802 N AVE Q DR	KOLN HOLDINGS LLC	7001 MIAMI AVE	LUBBOCK, TX	79413
40	COUNTRY CLUB BLK 20 L 5-19 & ALLEY LESS L 12& 13	1322 FORHAM ST	OTOOL COMMERCIAL HOLDINGS LLC	8606 TOLEDO AVE	LUBBOCK, TX	79424
41	COUNTRY CLUB BLK 20 L 1	VACANT LOT	FLYNN CAROLYN & ELAINE DUNCAN & BILL C & JAMES R TOWNLEY	3004 ROCKBROOK DRIVE	PLANO, TX	75074
42	COUNTRY CLUB BLK 20 & 21 TR A	604 N AVE Q DR	FRESNO VALVES & CASTINGS INC	PO BOX 40	SELMA, CA	93662
43	COUNTRY CLUB BLK 21 L 19 THRU 23	1308 ERSKINE ST	FRESNO VALVES & CASTINGS INC	PO BOX 40	SELMA, CA	93662
44	COUNTRY CLUB BLK 21 L 24	1302 ERSKINE ST	MEEK, CAROL	3809 43RD ST	LUBBOCK, TX	79413
45	GYP PIT TR 6 & PT OF 5	1301 ERSKINE ST	BNSF RAILWAY COMPANY	2650 LOU MENK DR	FORT WORTH, TX	76161-0089
46	BLK A SEC 80 AB 995 TR 5 & GYP PIT PT OF TR 5	401 N AVE K	YELLOWHOUSE MATERIALS LLC	401 N I-27 HWY	LUBBOCK, TX	79403
47	GYP PIT TR 4; BLK A SEC 80 AB 995	1521 ERSKINE ST 1503 ERSKINE ST	TRIPLE C CONCRETE OF LUBBOCK LTD	8308 COUNTY ROAD 6940	LUBBOCK, TX	79407
48	COUNTRY CLUB BLK 21 L 14 THRU 16	1322 ERSKINE ST	OTOOL COMMERCIAL HOLDINGS LLC	8606 TOLEDO AVE	LUBBOCK, TX	79424
49	COUNTRY CLUB BLK 21 L 8 THRU 11	1319 FORDHAM ST 1321 FORDHAM ST	OTOOL COMMERCIAL HOLDINGS LLC	8606 TOLEDO AVE	LUBBOCK, TX	79424
50	VANCE INDUSTRIAL L 1 & 2	1502 ERSKINE ST 609 N AVE N	GUADALUPE ECONOMIC SERV	1502 ERSKINE ST	LUBBOCK, TX	79403-3214
51	SWEATT L 1 & CLOSED STREET	1508 ERSKINE ST	FEATHERLITE CORP	PO Box 425	FORT WORTH, TX	76101-0425
52	GYP PIT TR 2 & NE/PT OF TR 3	1601 ERSKINE ST	BROOKES, MICHAEL A	PO BOX 3633	LUBBOCK, TX	79452-3633
53	K O C L 1; BLK A SEC 19 AB 92; GYP PIT TR 3 LESS NE/PT	1619 ERSKINE ST 423 N AVE P 511 N AVE P	8097 BUILDING ASSOC INC	PO BOX 1604	LUBBOCK, TX	79408
54	ROBERTS-MCWHORTER BLK 90 RR CORR; ROBERTS-MCWHORTER BLK 83 RR CORR	1621 ERSKINE ST 402 N AVE P REAR	BNSF RAILWAY COMPANY	2650 LOU MENK DR	FORT WORTH, TX	76161-0089
55	PIERCE BLK 4 & 5 & 6 L 1 TO 11	1801 ERSKINE ST	LANGLEY, JOHN	6515 E COUNTY ROAD 6700	LUBBOCK, TX	79403-7667
56	ROBERTS-MCWHORTER BLK 89 LESS SW 50X100'	1901 ERSKINE ST	CITY OF LUBBOCK	PO BOX 2000	LUBBOCK, TX	79457-0001
57	J D J L 1	1906 ERSKINE ST 1912 ERSKINE ST	CITY OF LUBBOCK	PO BOX 2000	LUBBOCK, TX	79457-0001
58	BLK A SEC 16 AB 820 TR 1N	1901 HARVARD ST	NGS LOGISTICS LLC	175 S KIMBALL AVE	SOUTHLAKE, TX	76092
59	BECK STEEL TR A & B	904 N AVE T 902 N AVE T 1910 HARVARD ST	BATRICE, MAZEN	118 SHERMAN AVE	LUBBOCK, TX	79415-3608
60	BLK A SEC 16 AB 820 TR S4	1108 N AVE T 1010 N AVE T	RANDOLPH, DOUGLAS	3404 MONIOCA RD	LUBBOCK, TX	79403-1414
61	BLK A SEC 16 AB 820 TR S2	901 N AVE S	RANDOLPH, DOUGLAS	3404 MONIOCA RD	LUBBOCK, TX	79403-1414

ATTACHMENT 4: VERIFICATION OF LEGAL STATUS

OWNERSHIP

Lonestar Wastewater Solutions, LLC will assume ownership and operation of the Type V waste processing facility, TCEQ MSW Permit No. 2231. Verification of legal authority and status for Lonestar Wastewater Solutions, LLC is included in this Attachment, as required by §330.59(e) and §281.5. No other person or entity holds ownership of the facility. Lonestar Wastewater Solutions, LLC is the sole owner of the facility.

ATTACHMENT 4.A: CERTIFICATE OF INCORPORATION



Office of the Secretary of State

CERTIFICATE OF FILING OF

Lonestar Wastewater Solutions, LLC
File Number: 801184688

The undersigned, as Secretary of State of Texas, hereby certifies that a Certificate of Formation for the above named Domestic Limited Liability Company (LLC) has been received in this office and has been found to conform to the applicable provisions of law.

ACCORDINGLY, the undersigned, as Secretary of State, and by virtue of the authority vested in the secretary by law, hereby issues this certificate evidencing filing effective on the date shown below.

The issuance of this certificate does not authorize the use of a name in this state in violation of the rights of another under the federal Trademark Act of 1946, the Texas trademark law, the Assumed Business or Professional Name Act, or the common law.

Dated: 10/21/2009

Effective: 10/21/2009



A handwritten signature in black ink, appearing to read "Hope Andrade".

Hope Andrade
Secretary of State

Secretary of State
P.O. Box 13697
Austin, TX 78711-3697
FAX: 512/463-5709



Filing Fee: \$300

**Certificate of Formation
Limited Liability Company**

Filed in the Office of the
Secretary of State of Texas
Filing #: 801184688 10/21/2009
Document #: 280376820002
Image Generated Electronically
for Web Filing

Article 1 - Entity Name and Type

The filing entity being formed is a limited liability company. The name of the entity is:

Lonestar Wastewater Solutions, LLC

The name of the entity must contain the words "Limited Liability Company" or "Limited Company," or an accepted abbreviation of such terms. The name must not be the same as, deceptively similar to or similar to that of an existing corporate, limited liability company, or limited partnership name on file with the secretary of state. A preliminary check for "name availability" is recommended.

Article 2 - Registered Agent and Registered Office

☐ A. The initial registered agent is an organization (cannot be company named above) by the name of:

OR

☒ B. The initial registered agent is an individual resident of the state whose name is set forth below:

Name:

Keith C Thompson

C. The business address of the registered agent and the registered office address is:

Street Address:

4216 102nd Street Lubbock TX 79423

Article 3 - Governing Authority

☐ A. The limited liability company is to be managed by managers.

OR

☒ B. The limited liability company will not have managers. Management of the company is reserved to the members. The names and addresses of the governing persons are set forth below:

Managing Member 1: **Phillip Johnson**

Title: **Managing Member**

Address: **4320 Woodrow Road Lubbock TX, USA 79423**

Article 4 - Purpose

The purpose for which the company is organized is for the transaction of any and all lawful business for which limited liability companies may be organized under the Texas Business Organizations Code.

Supplemental Provisions / Information

[The attached addendum, if any, is incorporated herein by reference.]

Organizer

The name and address of the organizer are set forth below.

Phillip Johnson **4320 Woodrow Road, Lubbock, Texas 79423**

Effectiveness of Filing

☒ A. This document becomes effective when the document is filed by the secretary of state.

OR

☐ B. This document becomes effective at a later date, which is not more than ninety (90) days from the date of its signing. The delayed effective date is:

Execution

The undersigned signs this document subject to the penalties imposed by law for the submission of a materially false or fraudulent instrument.

Phillip Johnson

Signature of Organizer

FILING OFFICE COPY



Office of the Secretary of State

October 21, 2009

Attn: Jo C Brazell

Jo C Brazell
2411 94th Street
Lubbock, TX 79423 USA

RE: Lonestar Wastewater Solutions, LLC
File Number: 801184688

It has been our pleasure to file the certificate of formation and issue the enclosed certificate of filing evidencing the existence of the newly created domestic limited liability company (llc).

Unless exempted, the entity formed is subject to state tax laws, including franchise tax laws. Shortly, the Comptroller of Public Accounts will be contacting the entity at its registered office for information that will assist the Comptroller in setting up the franchise tax account for the entity. Information about franchise tax, and contact information for the Comptroller's office, is available on their web site at <http://window.state.tx.us/taxinfo/franchise/index.html>.

The entity formed does not file annual reports with the Secretary of State. Documents will be filed with the Secretary of State if the entity needs to amend one of the provisions in its certificate of formation. It is important for the entity to continuously maintain a registered agent and office in Texas. Failure to maintain an agent or office or file a change to the information in Texas may result in the involuntary termination of the entity.

If we can be of further service at any time, please let us know.

Sincerely,

Corporations Section
Business & Public Filings Division
(512) 463-5555

Enclosure

ATTACHMENT 5: EVIDENCE OF COMPETENCY

EVIDENCE OF COMPETENCY

Lonestar Wastewater Solutions, LLC is solely owned by Phil Johnson, who serves as the sole principal and shareholder. Phil Johnson is also the owner and operator of Johnson Pumping, Inc. (Customer Number CN603225632), which operates (Regulated Entity RN103092615) as a registered sludge transporter (ID Number 20170).

Supervision of facility operations for Lonestar Wastewater Solution, LLC will be directed by Phil Johnson and Tommy Carrasco. Phil Johnson, the owner, does not currently own or operate any additional solid waste sites beyond those identified herein, nor have any direct financial interest in any other solid waste facilities outside of Lonestar Wastewater Solutions, LLC, and Johnson Pumping, Inc.

Lonestar Wastewater Solutions, LLC previously submitted a permit application (MSW Processing Permit No. 2372) for a Type V facility in 2011: however, this application was voluntarily withdrawn during the permitting review process.

In accordance with Title 30 Texas Administrative Code §330.58(f)(3), Lonestar Wastewater Solutions, LLC shall employ a licensed solid waste facility supervisor posing a valid Class A license as defined Chapter 30 (relating to Occupational Licenses and Registrations), prior to commencing.

ATTACHMENT 6: FINANCIAL ASSURANCE

FINANCIAL ASSURANCE AND FACILITY CLOSURE

Closure cost estimates have been prepared in accordance with 30 TAC §330.505 to reflect the total cost of hiring a third party, unaffiliated with the owner or operator, to close the facility. The estimate includes all activities necessary to safely shut down operations, including the removal and proper disposal of liquid waste, decommissioning of equipment, cleaning and decontamination of process areas, general site cleanup, post-closure inspections, and securing the site with signage and access controls.

The estimate was developed using conservative assumptions and current unit rates for labor, equipment, and disposal services. All cost elements reflect the maximum volume and worst-case conditions reasonably anticipated during facility operation.

To satisfy the financial assurance requirements under 30 TAC §305.64(b)(3) and (d) and 30 TAC Chapter 37, Subchapter R, financial assurance will be provided via a surety bond issued by The Hanover Insurance Company in accordance with §37.8031(c). The bonding instrument will be submitted in TCEQ-approved format for the full amount of the closure cost estimate and will be adjusted annually for inflation, as required, until the executive director determines the site has been properly closed. All bonding documentation will be submitted to TCEQ for review and approval prior to permit issuance or transfer.

Figure: 30 TAC §37.311

PAYMENT BOND

Date bond executed: July 1, 2025.

Effective Date: July 1, 2025.

Principal: (legal name and business address of owner and operator)

Lonestar Wastewater Solutions, LLC 801 N. Ave. P, Lubbock, TX 79403.

Type of Organization: Corporation.

(Insert "Individual," "joint venture," "partnership," or "corporation,")

State of Incorporation: TX.

Surety(ies): (name(s) and business address(es))

The Hanover Insurance Company at 333 Pierce Road, Suite 300, Itasca, IL 60143.

Permit number, name, physical and mailing addresses, and closure, post closure, or corrective action amount(s) for each facility guaranteed by this bond (indicate closure, post closure, or corrective action amounts separately for each facility):_____.

Total penal sum of bond: \$ 48,993.00.

Surety's bond number: 1117944.

Know All Persons By These Presents, That we, the Principal and Surety(ies) hereto are firmly bound to the Texas Commission on Environmental Quality, hereinafter called TCEQ, in the above penal sum for the payment of which we bind ourselves, our heirs, executors, administrators, successors, and assigns jointly and severally; provided that, where the Surety (ies) are corporations acting as co-sureties, we, the Sureties, bind ourselves in such sum "jointly and severally" only for the purpose of allowing a joint action or actions against any or all of us, and for all other purposes each Surety binds itself, jointly and severally with the Principal, for the payment of such sum only as is set forth opposite the name of such Surety, but if no limit of liability is indicated, the limit of liability shall be the full amount of the penal sum.

Whereas said Principal is required, under the appropriate program area, to comply with permit requirements in order to own or operate each facility identified above, and

Whereas said Principal is required to provide financial assurance for closure, post closure, or corrective action as a condition of the permit or other applicable requirements, and

Whereas said Principal shall establish a standby trust fund as is required when a surety bond is used to provide such financial assurance;

Now, therefore, the conditions of the obligation are such that if the Principal shall faithfully, before the beginning of final closure of, or corrective action at, each facility identified above, fund into the standby trust fund the amount(s) identified above for the facility,

Or, if the Principal shall fund into the standby trust fund in such amount(s) within 15 days

after a final order to begin final closure or perform corrective action is issued by the TCEQ executive director or a U.S. district court or other court of competent jurisdiction,

Or, if the Principal shall provide alternate financial assurance, as specified in 30 Texas Administrative Code, Chapter 37 (relating to Financial Assurance) and obtain the TCEQ executive director's written approval of such assurance, within 90 days after the date notice of cancellation is received by both the Principal and the TCEQ executive director from the Surety (ies), then this obligation shall be null and void; otherwise it is to remain in full force and effect.

The Surety(ies) shall become liable on this bond obligation only when the Principal has failed to fulfill the conditions described above. Upon notification by the TCEQ executive director that the Principal has failed to perform as guaranteed by this bond, the Surety(ies) shall place funds in the amount guaranteed for the facility(ies) into the standby trust fund as directed by the TCEQ executive director.

The liability of the Surety(ies) shall not be discharged by any payment or succession of payments hereunder, unless and until such payment or payments shall amount in the aggregate to the penal sum of the bond, but in no event shall the obligation of the Surety(ies) hereunder exceed the amount of said penal sum.

The Surety(ies) may cancel the bond by sending notice of cancellation by certified mail to the Principal and to the TCEQ executive director provided, however, that cancellation shall not occur during the 120 days beginning on the date of receipt of the notice of cancellation by both the Principal and the TCEQ executive director, as evidenced by the return receipts.

The Principal may terminate this bond by sending written notice to the Surety(ies), provided, however, that no such notice shall become effective until the Surety(ies) receive(s) written authorization for termination of the bond by the TCEQ executive director.

(The following paragraph is an optional rider that may be included but is not required.)

Principal and Surety(ies) hereby agree to adjust the penal sum of the bond yearly so that it guarantees a new closure, post closure, or corrective action amount, provided that the penal sum does not increase by more than 20 percent in any one year, and no decrease in the penal sum takes place without the written permission of the TCEQ executive director.

In Witness Whereof, the Principal and Surety(ies) have executed this Payment Bond and have affixed their seals on the date set forth above.

The persons whose signatures appear below hereby certify that they are authorized to execute this surety bond on behalf of the Principal and Surety(ies) and that the wording of this surety bond is identical to the wording specified in 30 Texas Administrative Code §37.311 as such regulations were constituted on the date this bond was executed.

Lonestar Wastewater Solutions, LLC

Principal

(Signature(s)) Phil Johnson

(Name(s)) Phil Johnson

(Title(s)) PRESIDENT

(Corporate seal)



Corporate Surety(ies)

(Name and address)

The Hanover Insurance Company - 1411 Opus Place, Suite 450, Downers Grove, IL 60515

NM

State of Incorporation: New Hampshire

Liability limit: \$ 48,993.00

(Signature(s))



(Name(s) and title(s)) James I. Moore - Attorney-in-Fact

(Corporate Seal)

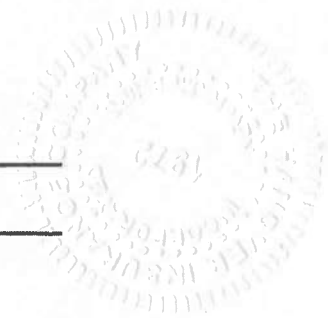

(For every co-surety, provide signature(s), corporate seal, and other information in the same manner as for Surety above.)

Bond premium: \$ 1,371.00

THE HANOVER INSURANCE COMPANY
MASSACHUSETTS BAY INSURANCE COMPANY
CITIZENS INSURANCE COMPANY OF AMERICA

POWER OF ATTORNEY

THIS Power of Attorney limits the acts of those named herein, and they have no authority to bind the Company except in the manner and to the extent herein stated.

KNOW ALL PERSONS BY THESE PRESENTS:

That THE HANOVER INSURANCE COMPANY and MASSACHUSETTS BAY INSURANCE COMPANY, both being corporations organized and existing under the laws of the State of New Hampshire, and CITIZENS INSURANCE COMPANY OF AMERICA, a corporation organized and existing under the laws of the State of Michigan, (hereinafter individually and collectively the "Company") does hereby constitute and appoint,

Kelly A. Gardner, Tariesse M. Plisciotto, Melissa Schmidt, James I. Moore, Martin Moss, Amy Wickett, Jennifer J. McComb and/or Diane M. Rubright Of HUB International Midwest Limited of Downers Grove, IL each individually, if there be more than one named, as its true and lawful attorney(s)-in-fact to sign, execute, seal, acknowledge and deliver for, and on its behalf, and as its act and deed any place within the United States, any and all surety bonds, recognizances, undertakings, or other surety obligations. The execution of such surety bonds, recognizances, undertakings or surety obligations, in pursuance of these presents, shall be as binding upon the Company as if they had been duly signed by the president and attested by the secretary of the Company, in their own proper persons. Provided however, that this power of attorney limits the acts of those named herein; and they have no authority to bind the Company except in the manner stated and to the extent of any limitation stated below:

Any such obligations In the United States, not to exceed Forty Million and No/100 (\$40,000,000) In any single instance

That this power is made and executed pursuant to the authority of the following Resolutions passed by the Board of Directors of said Company, and said Resolutions remain in full force and effect:

RESOLVED: That the President or any Vice President, in conjunction with any Vice President, be and they hereby are authorized and empowered to appoint Attorneys-in-fact of the Company, in its name and as it acts, to execute and acknowledge for and on its behalf as surety, any and all bonds, recognizances, contracts of indemnity, waivers of citation and all other writings obligatory in the nature thereof, with power to attach thereto the seal of the Company. Any such writings so executed by such Attorneys-in-fact shall be binding upon the Company as if they had been duly executed and acknowledged by the regularly elected officers of the Company in their own proper persons.

RESOLVED: That any and all Powers of Attorney and Certified Copies of such Powers of Attorney and certification in respect thereto, granted and executed by the President or Vice President in conjunction with any Vice President of the Company, shall be binding on the Company to the same extent as if all signatures therein were manually affixed, even though one or more of any such signatures thereon may be facsimile. (Adopted October 7, 1981 – The Hanover Insurance Company; Adopted April 14, 1982 – Massachusetts Bay Insurance Company; Adopted September 7, 2001 – Citizens Insurance Company of America and affirmed by each Company on March 24, 2014)

IN WITNESS WHEREOF, THE HANOVER INSURANCE COMPANY, MASSACHUSETTS BAY INSURANCE COMPANY and CITIZENS INSURANCE COMPANY OF AMERICA have caused these presents to be sealed with their respective corporate seals, duly attested by two Vice Presidents, this 21st day of June, 2023



The Hanover Insurance Company
Massachusetts Bay Insurance Company
Citizens Insurance Company of America

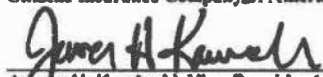

James H. Kawlecki, Vice President

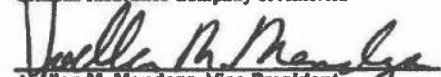
The Hanover Insurance Company
Massachusetts Bay Insurance Company
Citizens Insurance Company of America

Jaelen M. Mendoza, Vice President

STATE OF CONNECTICUT)
COUNTY OF HARTFORD) ss.

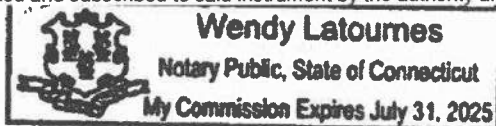
On this 21st day of June 2023 before me came the above named Executive Vice President and Vice President of The Hanover Insurance Company, Massachusetts Bay Insurance Company and Citizens Insurance Company of America, to me personally known to be the individuals and officers described herein, and acknowledged that the seals affixed to the preceding instrument are the corporate seals of The Hanover Insurance Company, Massachusetts Bay Insurance Company and Citizens Insurance Company of America, respectively, and that the said corporate seals and their signatures as officers were duly affixed and subscribed to said instrument by the authority and direction of said Corporations.





Wendy Latoumes, Notary Public
My commission expires July 31, 2025

I, the undersigned Vice President of The Hanover Insurance Company, Massachusetts Bay Insurance Company and Citizens Insurance Company of America, hereby certify that the above and foregoing is a full, true and correct copy of the Original Power of Attorney issued by said Companies, and do hereby further certify that the said Powers of Attorney are still in force and effect.

GIVEN under my hand and the seals of said Companies, at Worcester, Massachusetts, this 1st day of July 2025.

CERTIFIED COPY

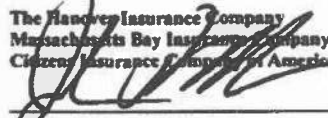
The Hanover Insurance Company
Massachusetts Bay Insurance Company
Citizens Insurance Company of America



John Rowedder, Vice President

STATE OF ILLINOIS }
COUNTY OF DU PAGE}

On July 1, 2025, before me, Diane M. Rubright, a Notary Public in and for said County and State, duly commissioned and sworn, personally appeared, James I. Moore, known to me to be Attorney-in-Fact of The Hanover Insurance Company, the corporation described in and that executed the within and foregoing instrument, and known to me to be the person who executed the said instrument on behalf of the said corporation, and he duly acknowledged to me that such corporation executed the same.

IN WITNESS WHEREOF, I have hereunto set my hand and affixed my official seal, the day and year stated in this certificate above.

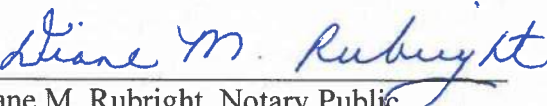
My Commission Expires March 23, 2027

Diane M. Rubright, Notary Public
Commission No. 817036

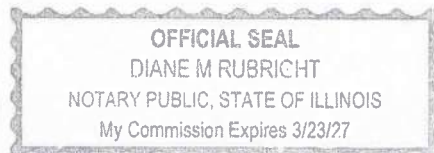

ATTACHMENT 6.A: FACILITY CLOSURE COST ESTIMATES

<p style="text-align: center;">Lonestar Wastewater Solutions, LLC Type V MSW Facility Closure Cost Estimate</p> <p style="text-align: right;">7/1/2025</p>						
ITEM	DESCRIPTION	UNITS	QUANTITY PER UNIT	QUANTITY	UNIT COST	TOTAL COST
1	Waste Disposal					
	Pump/Remove, transport, and dispose of contents at approved disposal facility					
1.1	Receiving Pit	GAL	7,500	1	\$ 0.39	\$ 2,925.00
1.2	Compressed Air Tank	GAL	80	1	\$ 0.39	\$ 32.00
1.3	Grit Settling Tank	GAL	3,000	1	\$ 0.39	\$ 1,170.00
1.4	Grease Settling Tank	GAL	9,000	1	\$ 0.39	\$ 3,510.00
1.5	Separation Tank	GAL	3,500	1	\$ 0.39	\$ 1,365.00
1.6	Separation Tank	GAL	1,500	1	\$ 0.39	\$ 585.00
1.7	Grit Waste Pits	GAL	750	2	\$ 0.39	\$ 585.00
1.8	Grit Waste Tanks	GAL	1,750	2	\$ 0.39	\$ 1,365.00
1.9	Grease Reclamation Pit	GAL	2,000	1	\$ 0.39	\$ 780.00
1.10	Sludge Dewatering Bed	GAL	360	1	\$ 0.39	\$ 141.00
1.11	Facility Wash Water	GAL	2,500	1	\$ 0.39	\$ 975.00
	Total					\$ 13,433.00
2	Process Unit Decommission					
2.1	Equipment Decommission, Cleaup, Decontamination, and Removal - Labor (28 man-day)	DAY		28	\$ 350.00	\$ 9,800.00
	Total					\$ 9,800.00
3	General Cleanup of Processing Facility					
3.1	Labor General Cleanup (8 man-day)	DAY		8	\$ 350.00	\$ 2,800.00
3.2	Oversight (including facility visual inspection) (1 day)	DAY		1	\$ 1,500.00	\$ 1,500.00
	Total					\$ 4,300.00
4	Secure Facility					
4.1	Install Facility Signage	LS		1	\$ 500.00	\$ 500.00
4.2	Secure Fences/Gates, Lock-Down Facility	LS		1	\$ 1,500.00	\$ 1,500.00
	Total					\$ 2,000.00
5	Management					
5.1	Sampling/Testing/Classification of Waste	LS		1	\$ 10,000.00	\$ 10,000.00
5.2	Facility Inspection/Closure Certificate	LS		1	\$ 5,000.00	\$ 5,000.00
	Total					\$ 15,000.00
	Subtotal					\$ 44,533.00
	Contingency (10%)					\$ 4,460.00
	Grand Total					\$ 48,993.00

1. Values are in 2025 dollars.
2. All tanks are assumed to be full.