



# Texas Commission on Environmental Quality

## Application Form for Municipal Solid Waste Permit or Registration Modification or Temporary Authorization

### Application Tracking Information

Facility Name: Celina Recycle Center

Permittee or Registrant Name: BFI Waste Services of Texas, LP

MSW Authorization Number: 40284

Initial Submission Date: 2/25/2025

Revision Date: 3/18/2025

Instructions for completing this form are provided in [form TCEQ-20650-instr](#)<sup>1</sup>. If you have questions, contact the Municipal Solid Waste Permits Section by email to [\[REDACTED\]](#) or by phone at 512-239-2335.

### Application Data

#### 1. Submission Type

☐ Initial Submission ☒ Notice of Deficiency (NOD) Response

#### 2. Authorization Type

☐ Permit ☒ Registration

#### 3. Application Type

☐ Modification with Public Notice ☐ Modification without Public Notice  
☐ Temporary Authorization (TA) ☒ Modification for Name Change or Transfer

#### 4. Application Fee

##### Amount

The application fee for a modification or temporary authorization is \$150.

##### Payment Method

☐ Check  
☒ Online through ePay portal [www3.tceq.texas.gov/epay/](http://www3.tceq.texas.gov/epay/)

If paid online, enter ePay Trace Number: 582EA000647626

<sup>1</sup> [www.tceq.texas.gov/downloads/permitting/waste-permits/msw/forms/20650-instr.pdf](http://www.tceq.texas.gov/downloads/permitting/waste-permits/msw/forms/20650-instr.pdf)

## 5. Electronic Versions of Application

For modifications that require notice, TCEQ will publish electronic versions of the application online. Applicants must provide a clean copy of the administratively complete application and technically complete application. TCEQ will also publish electronic versions of NOD responses online.

## 6. Party Responsible for Mailing Notice

For modifications that require notice, indicate who will be responsible for mailing notice:

☒ Applicant

☐ Agent in Service

☐ Consultant

Contact Name: Scott Trebus

Title: Area Environmental Manager

Email Address: [REDACTED]

## 7. Confidential Documents

Does the application contain confidential documents?

☐ Yes ☒ No

If "Yes", reference the confidential documents in the application, but submit the confidential documents as an attachment in a separate binder marked "CONFIDENTIAL."

## 8. Facility General Information

Facility Name: Celina Recycle Center

Contact Name: Modesto Dominguez Title: Area Vice President

MSW Authorization Number (if existing): 40284

Regulated Entity Reference Number: **RN** 105240196

Physical or Street Address: 4160 N PRESTON RD

City: Celina County: Collin State: TX Zip Code: 75009

Phone Number: (210) 378-5573

Latitude (Degrees, Minutes, Seconds): 33' 22' 39.2" N

Longitude (Degrees, Minutes, Seconds): 96' 46' 5.2" W

## 9. Facility Types

☐ Type I ☐ Type IV ☒ Type V

☐ Type IAE ☐ Type IVAE ☐ Type VI

## 10. Description of the Revisions to the Facility

Provide a brief description of revisions to permit or registration conditions and supporting documents referred to by the permit or registration, and a reference to the specific provisions under which the modification or temporary authorization application is being made. Also, provide an explanation of why the modification or temporary authorization is needed:

Application for registration transfer, facility name change pursuant to 30 TAC §305.64 and 305.70(k)(13) in anticipation of the transfer of ownership and operations from Champion Waste & Recycling Services, LLC to BFI Waste Services of Texas, LP

## 11. Facility Contact Information

### Site Operator (Permittee or Registrant)

Name: BFI Waste Services of Texas, LP

Customer Reference Number: **CN** 601527963

Contact Name: Modesto Dominguez Title: Area Vice President

Mailing Address: 4160 N PRESTON RD

City: Celina County: Collin State: TX Zip Code: 75009

Phone Number: (210) 378-5573

Email Address: [REDACTED]

Texas Secretary of State (SOS) Filing Number: 0014867711

### Operator (if different from Site Operator)

Name: \_\_\_\_\_

Customer Reference Number: **CN** \_\_\_\_\_

Contact Name: \_\_\_\_\_ Title: \_\_\_\_\_

Mailing Address: \_\_\_\_\_

City: \_\_\_\_\_ County: \_\_\_\_\_ State: \_\_\_\_\_ Zip Code: \_\_\_\_\_

Phone Number: \_\_\_\_\_

Email Address: \_\_\_\_\_

Texas Secretary of State (SOS) Filing Number: \_\_\_\_\_

**Consultant (if applicable)**

Firm Name: \_\_\_\_\_

Consultant Name: \_\_\_\_\_

Texas Board of Professional Engineers Firm Registration Number: \_\_\_\_\_

Contact Name: \_\_\_\_\_ Title: \_\_\_\_\_

Mailing Address: \_\_\_\_\_

City: \_\_\_\_\_ County: \_\_\_\_\_ State: \_\_\_\_\_ Zip Code: \_\_\_\_\_

Phone Number: \_\_\_\_\_

Email Address: \_\_\_\_\_

**Agent in Service (required for out-of-state applicants)**Name: CT Corporation SystemMailing Address: 1999 Bryan Street, Suite 900City: Dallas County: Dallas State: TX Zip Code: 75201Phone Number: (214) 979-1172Email Address: [REDACTED]**12. Ownership Status of the Facility**

Is this a modification that changes the legal description, the property owner, or the Site Operator (Permittee or Registrant)?

☒ Yes ☐ No

If the answer is "No", skip this section.

Does the Site Operator (Permittee or Registrant) own all the facility units and all the facility property?

☒ Yes ☐ No

If "No", provide the following information for other owners.

Owner Name: \_\_\_\_\_

Mailing Address: \_\_\_\_\_

City: \_\_\_\_\_ County: \_\_\_\_\_ State: TX Zip Code: \_\_\_\_\_

Phone Number: \_\_\_\_\_

Email Address: \_\_\_\_\_



## Signature Page

### Site Operator or Authorized Signatory

I certify under penalty of law that this document and all attachments were prepared under my direction or supervision in accordance with a system designed to assure that qualified personnel properly gather and evaluate the information submitted. Based on my inquiry of the person or persons who manage the system, or those persons directly responsible for gathering the information, the information submitted is, to the best of my knowledge and belief, true, accurate, and complete. I am aware there are significant penalties for submitting false information, including the possibility of fine and imprisonment for knowing violations.

Name: Scott Trebus Title: Area Environmental Manager

Email Address: [REDACTED]

Signature: Scott Trebus Date: 3/19/2025  
7BA1F322B139427...

### Operator or Principal Executive Officer Designation of Authorized Signatory

To be completed by the operator if the application is signed by an authorized representative for the operator.

I hereby designate Scott Trebus as my representative and hereby authorize said representative to sign any application, submit additional information as may be requested by the Commission; and/or appear for me at any hearing or before the Texas Commission on Environmental Quality in conjunction with this request for a Texas Water Code or Texas Solid Waste Disposal Act permit. I further understand that I am responsible for the contents of this application, for oral statements given by my authorized representative in support of the application, and for compliance with the terms and conditions of any permit which might be issued based upon this application.

Operator or Principal Executive Officer Name: Brady Loesch

Email Address: [REDACTED]

Signature: [Signature] Date: 3/20/25

### Notary

SUBSCRIBED AND SWORN to before me by the said Brady Loesch

On this 20 day of March, 2025

My commission expires on the 3 day of FEB, 2027

Lauri A. Tarango

Notary Public in and for  
Harris County, Texas

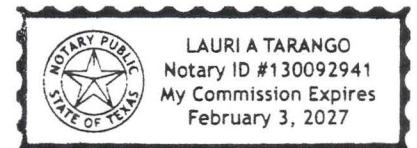

Note: Application Must Bear Signature and Seal of Notary Public

## Attachments for Permit or Registration Name Change or Transfer Modification

Refer to instruction document **200650-instr** for professional engineer seal requirements.

### ***Attachments Table 5. Required attachments.***

<b>Required Attachments</b>	<b>Attachment Number</b>
TCEQ Core Data Form(s)	1
Property Legal Description	2
Property Metes and Bounds Description	10
Metes and Bounds Drawings	10
On-Site Easements Drawing	2
Land Ownership Map	3
Land Ownership List	4
Property Owner Affidavit	5
Verification of Legal Status	6
Evidence of Competency	7

### ***Attachments Table 6. Additional attachments as applicable.***

<b>Additional Attachments as Applicable (select all that apply and add others as needed)</b>	<b>Attachment Number</b>
<input checked="" type="checkbox"/> Signatory Authority Delegation	8
<input checked="" type="checkbox"/> Fee Payment Receipt	9
<input type="checkbox"/> Confidential Documents	N/A
<input checked="" type="checkbox"/> Final Plat Record of Property	10
<input type="checkbox"/> Assumed Name Certificate	N/A



# TCEQ Core Data Form

For detailed instructions on completing this form, please read the Core Data Form Instructions or call 512-239-5175.

## SECTION I: General Information

<b>1. Reason for Submission</b> (If other is checked please describe in space provided.)		
<input type="checkbox"/> New Permit, Registration or Authorization (Core Data Form should be submitted with the program application.)		
<input type="checkbox"/> Renewal (Core Data Form should be submitted with the renewal form)	<input checked="" type="checkbox"/> Other <b>Name Change/Ownership Transfer</b>	
<b>2. Customer Reference Number</b> (if issued)	<a href="#">Follow this link to search for CN or RN numbers in Central Registry**</a>	<b>3. Regulated Entity Reference Number</b> (if issued)
CN 601527963		RN 105240196

## SECTION II: Customer Information

<b>4. General Customer Information</b>		<b>5. Effective Date for Customer Information Updates</b> (mm/dd/yyyy)		2/28/2025	
<input type="checkbox"/> New Customer <input checked="" type="checkbox"/> Update to Customer Information <input checked="" type="checkbox"/> Change in Regulated Entity Ownership					
<input type="checkbox"/> Change in Legal Name (Verifiable with the Texas Secretary of State or Texas Comptroller of Public Accounts)					
<b>The Customer Name submitted here may be updated automatically based on what is current and active with the Texas Secretary of State (SOS) or Texas Comptroller of Public Accounts (CPA).</b>					
<b>6. Customer Legal Name</b> (If an individual, print last name first: eg: Doe, John)				<i>If new Customer, enter previous Customer below:</i>	
BFI Waste Services of Texas, LP					
<b>7. TX SOS/CPA Filing Number</b>		<b>8. TX State Tax ID</b> (11 digits)		<b>9. Federal Tax ID</b> (9 digits)	
0014867711		18610245278		86-1024527	
<b>10. DUNS Number</b> (if applicable)		015912744			
<b>11. Type of Customer:</b>		<input type="checkbox"/> Corporation		<input type="checkbox"/> Individual	
Government: <input type="checkbox"/> City <input type="checkbox"/> County <input type="checkbox"/> Federal <input type="checkbox"/> Local <input type="checkbox"/> State <input type="checkbox"/> Other		<input type="checkbox"/> Sole Proprietorship		Partnership: <input type="checkbox"/> General <input checked="" type="checkbox"/> Limited	
<b>12. Number of Employees</b>				<b>13. Independently Owned and Operated?</b>	
<input type="checkbox"/> 0-20 <input type="checkbox"/> 21-100 <input type="checkbox"/> 101-250 <input type="checkbox"/> 251-500 <input checked="" type="checkbox"/> 501 and higher				<input type="checkbox"/> Yes <input checked="" type="checkbox"/> No	
<b>14. Customer Role</b> (Proposed or Actual) – as it relates to the Regulated Entity listed on this form. Please check one of the following					
<input type="checkbox"/> Owner <input type="checkbox"/> Operator <input checked="" type="checkbox"/> Owner & Operator <input type="checkbox"/> Other:					
<input type="checkbox"/> Occupational Licensee <input type="checkbox"/> Responsible Party <input type="checkbox"/> VCP/BSA Applicant					
<b>15. Mailing Address:</b>		551 Huffines Blvd			
City		Lewisville		State	TX
ZIP		75056		ZIP + 4	
<b>16. Country Mailing Information</b> (if outside USA)				<b>17. E-Mail Address</b> (if applicable)	
				[REDACTED]	

<b>18. Telephone Number</b>	<b>19. Extension or Code</b>	<b>20. Fax Number (if applicable)</b>
( 210 ) 378-5573		(   ) -

## SECTION III: Regulated Entity Information

<b>21. General Regulated Entity Information</b> (If 'New Regulated Entity' is selected, a new permit application is also required.)								
<input type="checkbox"/> New Regulated Entity <input checked="" type="checkbox"/> Update to Regulated Entity Name <input checked="" type="checkbox"/> Update to Regulated Entity Information								
<i>The Regulated Entity Name submitted may be updated, in order to meet TCEQ Core Data Standards (removal of organizational endings such as Inc, LP, or LLC).</i>								
<b>22. Regulated Entity Name</b> (Enter name of the site where the regulated action is taking place.)								
Celina Recycle Center								
<b>23. Street Address of the Regulated Entity:</b>  (No PO Boxes)	4160 N PRESTON RD							
	<b>City</b>	CELINA	<b>State</b>	TX	<b>ZIP</b>	75212	<b>ZIP + 4</b>	4607
<b>24. County</b>	Collin							

If no Street Address is provided, fields 25-28 are required.

<b>25. Description to Physical Location:</b>								
<b>26. Nearest City</b>						<b>State</b>	<b>Nearest ZIP Code</b>	
<i>Latitude/Longitude are required and may be added/updated to meet TCEQ Core Data Standards. (Geocoding of the Physical Address may be used to supply coordinates where none have been provided or to gain accuracy).</i>								
<b>27. Latitude (N) In Decimal:</b>		33°22'39.2"N			<b>28. Longitude (W) In Decimal:</b>		96°46'5.2"W	
Degrees	Minutes	Seconds	Degrees	Minutes	Seconds			
<b>29. Primary SIC Code</b> (4 digits)	<b>30. Secondary SIC Code</b> (4 digits)		<b>31. Primary NAICS Code</b> (5 or 6 digits)			<b>32. Secondary NAICS Code</b> (5 or 6 digits)		
5093								
<b>33. What is the Primary Business of this entity?</b> (Do not repeat the SIC or NAICS description.)								
Recycling								
<b>34. Mailing Address:</b>	551 Huffines Blvd							
	<b>City</b>	Lewisville	<b>State</b>	TX	<b>ZIP</b>	75056	<b>ZIP + 4</b>	
<b>35. E-Mail Address:</b>								
<b>36. Telephone Number</b>			<b>37. Extension or Code</b>			<b>38. Fax Number (if applicable)</b>		
( 210 ) 378-5573						(   ) -		

**39. TCEQ Programs and ID Numbers** Check all Programs and write in the permits/registration numbers that will be affected by the updates submitted on this form. See the Core Data Form instructions for additional guidance.

<input type="checkbox"/> Dam Safety	<input type="checkbox"/> Districts	<input type="checkbox"/> Edwards Aquifer	<input type="checkbox"/> Emissions Inventory Air	<input type="checkbox"/> Industrial Hazardous Waste
<input checked="" type="checkbox"/> Municipal Solid Waste	<input type="checkbox"/> New Source Review Air	<input type="checkbox"/> OSSF	<input type="checkbox"/> Petroleum Storage Tank	<input type="checkbox"/> PWS
<input type="checkbox"/> Sludge	<input checked="" type="checkbox"/> Storm Water	<input type="checkbox"/> Title V Air	<input type="checkbox"/> Tires	<input type="checkbox"/> Used Oil
<input type="checkbox"/> Voluntary Cleanup	<input type="checkbox"/> Wastewater	<input type="checkbox"/> Wastewater Agriculture	<input type="checkbox"/> Water Rights	<input type="checkbox"/> Other:

## SECTION IV: Preparer Information

<b>40. Name:</b>	Adam Hart		<b>41. Title:</b>	Team Environmental Manager
<b>42. Telephone Number</b>	<b>43. Ext./Code</b>	<b>44. Fax Number</b>	<b>45. E-Mail Address</b>	
( 903 ) 539-4065		( ) -		

## SECTION V: Authorized Signature

**46.** By my signature below, I certify, to the best of my knowledge, that the information provided in this form is true and complete, and that I have signature authority to submit this form on behalf of the entity specified in Section II, Field 6 and/or as required for the updates to the ID numbers identified in field 39.

<b>Company:</b>	BFI Waste Services of Texas, LP		<b>Job Title:</b>	Area Environmental Manager	
<b>Name (In Print):</b>	Scott Trebus			<b>Phone:</b>	( 281 ) 222- 8251
<b>Signature:</b>	<i>Scott Trebus</i>			<b>Date:</b>	3/18/2025



TCEQ Use Only

# TCEQ Core Data Form

For detailed instructions on completing this form, please read the Core Data Form Instructions or call 512-239-5175.

## SECTION I: General Information

<b>1. Reason for Submission</b> (If other is checked please describe in space provided.)		
<input type="checkbox"/> New Permit, Registration or Authorization (Core Data Form should be submitted with the program application.)		
<input type="checkbox"/> Renewal (Core Data Form should be submitted with the renewal form)		<input checked="" type="checkbox"/> Other <b>Name change/ownership transfer</b>
<b>2. Customer Reference Number</b> (if issued)		<b>3. Regulated Entity Reference Number</b> (if issued)
CN 605894591		RN 105240196

[Follow this link to search for CN or RN numbers in Central Registry\\*\\*](#)

## SECTION II: Customer Information

<b>4. General Customer Information</b>		<b>5. Effective Date for Customer Information Updates</b> (mm/dd/yyyy)		3/12/2025	
<input type="checkbox"/> New Customer <input checked="" type="checkbox"/> Update to Customer Information <input type="checkbox"/> Change in Regulated Entity Ownership					
<input type="checkbox"/> Change in Legal Name (Verifiable with the Texas Secretary of State or Texas Comptroller of Public Accounts)					
<i>The Customer Name submitted here may be updated automatically based on what is current and active with the Texas Secretary of State (SOS) or Texas Comptroller of Public Accounts (CPA).</i>					
<b>6. Customer Legal Name</b> (If an individual, print last name first: eg: Doe, John)				If new Customer, enter previous Customer below:	
CFG Realty, LLC					
<b>7. TX SOS/CPA Filing Number</b>		<b>8. TX State Tax ID</b> (11 digits)		<b>9. Federal Tax ID</b> (9 digits)	
802000786		32054212157			
<b>10. DUNS Number</b> (if applicable)					
<b>11. Type of Customer:</b>		<input checked="" type="checkbox"/> Corporation		<input type="checkbox"/> Individual	
Government: <input type="checkbox"/> City <input type="checkbox"/> County <input type="checkbox"/> Federal <input type="checkbox"/> Local <input type="checkbox"/> State <input type="checkbox"/> Other		<input type="checkbox"/> Sole Proprietorship		Partnership: <input type="checkbox"/> General <input checked="" type="checkbox"/> Limited	
<b>12. Number of Employees</b>		<b>13. Independently Owned and Operated?</b>			
<input checked="" type="checkbox"/> 0-20 <input type="checkbox"/> 21-100 <input type="checkbox"/> 101-250 <input type="checkbox"/> 251-500 <input type="checkbox"/> 501 and higher		<input checked="" type="checkbox"/> Yes <input type="checkbox"/> No			
<b>14. Customer Role</b> (Proposed or Actual) – as it relates to the Regulated Entity listed on this form. Please check one of the following					
<input type="checkbox"/> Owner <input type="checkbox"/> Operator <input type="checkbox"/> Owner & Operator <input checked="" type="checkbox"/> Other: Former property owner					
<input type="checkbox"/> Occupational Licensee <input type="checkbox"/> Responsible Party <input type="checkbox"/> VCP/BSA Applicant					
<b>15. Mailing Address:</b>		P.O. Box 1500			
City		TX		ZIP	
Celina				75009	
State		ZIP + 4			
16. Country Mailing Information (if outside USA)		17. E-Mail Address (if applicable)			
		[REDACTED]			
<b>18. Telephone Number</b>		<b>19. Extension or Code</b>		<b>20. Fax Number</b> (if applicable)	

SECTION III: Regulated Entity Information

21. General Regulated Entity Information (If "New Regulated Entity" is selected, a new permit application is also required.)

☐ New Regulated Entity    ☒ Update to Regulated Entity Name    ☒ Update to Regulated Entity Information

The Regulated Entity Name submitted may be updated, in order to meet TCEQ Core Data Standards (removal of organizational endings such as Inc, LP, or LLC).

22. Regulated Entity Name (Enter name of the site where the regulated action is taking place.)

Celina Recycle Center

23. Street Address of the Regulated Entity:  
  
(No PO Boxes)

4160 N Preston Road

City

Celina

State

TX

ZIP

75009

ZIP + 4

3862

24. County

Collin

If no Street Address is provided, fields 25-28 are required.

25. Description to Physical Location:

26. Nearest City

State

Nearest ZIP Code

Latitude/Longitude are required and may be added/updated to meet TCEQ Core Data Standards. (Geocoding of the Physical Address may be used to supply coordinates where none have been provided or to gain accuracy).

27. Latitude (N) In Decimal:

33° 22' 39.2" N

28. Longitude (W) In Decimal:

96° 46' 5.2" W

Degrees

Minutes

Seconds

Degrees

Minutes

Seconds

29. Primary SIC Code  
(4 digits)

30. Secondary SIC Code  
(4 digits)

31. Primary NAICS Code  
(5 or 6 digits)

32. Secondary NAICS Code  
(5 or 6 digits)

5093

4212

562111

33. What is the Primary Business of this entity? (Do not repeat the SIC or NAICS description.)

34. Mailing Address:

P.O. Box 1500

City

Celina

State

TX

ZIP

75009

ZIP + 4

3862

35. E-Mail Address:

36. Telephone Number

37. Extension or Code

38. Fax Number (if applicable)

( 214 ) 876-3356

( 214 ) 638-2945

39. TCEQ Programs and ID Numbers Check all Programs and write in the permits/registration numbers that will be affected by the updates submitted on this form. See the Core Data Form instructions for additional guidance.

<input type="checkbox"/> Dam Safety	<input type="checkbox"/> Districts	<input type="checkbox"/> Edwards Aquifer	<input type="checkbox"/> Emissions Inventory Air	<input type="checkbox"/> Industrial Hazardous Waste
<input checked="" type="checkbox"/> Municipal Solid Waste	<input type="checkbox"/> New Source Review Air	<input type="checkbox"/> OSSF	<input type="checkbox"/> Petroleum Storage Tank	<input type="checkbox"/> PWS
40284				
<input type="checkbox"/> Sludge	<input checked="" type="checkbox"/> Storm Water	<input type="checkbox"/> Title V Air	<input type="checkbox"/> Tires	<input type="checkbox"/> Used Oil
	TXR05DO93			
<input type="checkbox"/> Voluntary Cleanup	<input type="checkbox"/> Wastewater	<input type="checkbox"/> Wastewater Agriculture	<input type="checkbox"/> Water Rights	<input type="checkbox"/> Other:

## SECTION IV: Preparer Information

<b>40. Name:</b>	Isabella Aguirre			<b>41. Title:</b>	Sr. Project Professional
<b>42. Telephone Number</b>	<b>43. Ext./Code</b>	<b>44. Fax Number</b>	<b>45. E-Mail Address</b>		
( 817 ) 358-6103		(   ) -	[REDACTED]		

## SECTION V: Authorized Signature

46. By my signature below, I certify, to the best of my knowledge, that the information provided in this form is true and complete, and that I have signature authority to submit this form on behalf of the entity specified in Section II, Field 6 and/or as required for the updates to the ID numbers identified in field 39.

<b>Company:</b>	CFG Realty, LLC		<b>Job Title:</b>	President	
<b>Name (In Print):</b>	Michelle Kuhar			<b>Phone:</b>	( 214 ) 876- 3356
<b>Signature:</b>				<b>Date:</b>	4/3/2025





TCEQ Use Only

# TCEQ Core Data Form

For detailed instructions on completing this form, please read the Core Data Form Instructions or call 512-239-5175.

## SECTION I: General Information

<b>1. Reason for Submission</b> (If other is checked please describe in space provided.)		
<input type="checkbox"/> New Permit, Registration or Authorization (Core Data Form should be submitted with the program application.)		
<input type="checkbox"/> Renewal (Core Data Form should be submitted with the renewal form)		<input checked="" type="checkbox"/> Other <b>Name change/ownership transfer</b>
<b>2. Customer Reference Number</b> (if issued)		<b>3. Regulated Entity Reference Number</b> (if issued)
CN 603340563		RN 105240196

[Follow this link to search for CN or RN numbers in Central Registry\\*\\*](#)

## SECTION II: Customer Information

<b>4. General Customer Information</b>		<b>5. Effective Date for Customer Information Updates</b> (mm/dd/yyyy)		3/12/2025	
<input type="checkbox"/> New Customer <input type="checkbox"/> Update to Customer Information <input checked="" type="checkbox"/> Change in Regulated Entity Ownership					
<input type="checkbox"/> Change in Legal Name (Verifiable with the Texas Secretary of State or Texas Comptroller of Public Accounts)					
<i>The Customer Name submitted here may be updated automatically based on what is current and active with the Texas Secretary of State (SOS) or Texas Comptroller of Public Accounts (CPA).</i>					
<b>6. Customer Legal Name</b> (If an individual, print last name first: eg: Doe, John)				If new Customer, enter previous Customer below:	
Champion Waste & Recycling Services, LLC					
<b>7. TX SOS/CPA Filing Number</b>		<b>8. TX State Tax ID</b> (11 digits)		<b>9. Federal Tax ID</b> (9 digits)	
0800837343		32033248611			
<b>10. DUNS Number</b> (if applicable)					
<b>11. Type of Customer:</b>		<input checked="" type="checkbox"/> Corporation		<input type="checkbox"/> Individual	
Government: <input type="checkbox"/> City <input type="checkbox"/> County <input type="checkbox"/> Federal <input type="checkbox"/> Local <input type="checkbox"/> State <input type="checkbox"/> Other		<input type="checkbox"/> Sole Proprietorship		Partnership: <input type="checkbox"/> General <input checked="" type="checkbox"/> Limited	
<b>12. Number of Employees</b>				<b>13. Independently Owned and Operated?</b>	
<input type="checkbox"/> 0-20 <input type="checkbox"/> 21-100 <input checked="" type="checkbox"/> 101-250 <input type="checkbox"/> 251-500 <input type="checkbox"/> 501 and higher				<input checked="" type="checkbox"/> Yes <input type="checkbox"/> No	
<b>14. Customer Role</b> (Proposed or Actual) – as it relates to the Regulated Entity listed on this form. Please check one of the following					
<input type="checkbox"/> Owner <input type="checkbox"/> Operator <input type="checkbox"/> Owner & Operator <input checked="" type="checkbox"/> Other: Former owner/operator					
<input type="checkbox"/> Occupational Licensee <input type="checkbox"/> Responsible Party <input type="checkbox"/> VCP/BSA Applicant					
<b>15. Mailing Address:</b>		P.O. Box 1500			
City		Celina		State TX	
ZIP		75009		ZIP + 4	
16. Country Mailing Information (if outside USA)		17. E-Mail Address (if applicable)			
		[REDACTED]			
<b>18. Telephone Number</b>		<b>19. Extension or Code</b>		<b>20. Fax Number</b> (if applicable)	

( 215 ) 876-3356	( 214 ) 638-2945
------------------	------------------

SECTION III: Regulated Entity Information

21. General Regulated Entity Information (If 'New Regulated Entity' is selected, a new permit application is also required.)								
<input type="checkbox"/> New Regulated Entity <input checked="" type="checkbox"/> Update to Regulated Entity Name <input checked="" type="checkbox"/> Update to Regulated Entity Information								
The Regulated Entity Name submitted may be updated, in order to meet TCEQ Core Data Standards (removal of organizational endings such as Inc, LP, or LLC).								
22. Regulated Entity Name (Enter name of the site where the regulated action is taking place.)								
Celina Recycle Center								
23. Street Address of the Regulated Entity:  (No PO Boxes)	4160 N Preston Road							
	City	Celina	State	TX	ZIP	75009	ZIP + 4	3862
24. County	Collin							

If no Street Address is provided, fields 25-28 are required.

25. Description to Physical Location:								
26. Nearest City			State			Nearest ZIP Code		
Latitude/Longitude are required and may be added/updated to meet TCEQ Core Data Standards. (Geocoding of the Physical Address may be used to supply coordinates where none have been provided or to gain accuracy).								
27. Latitude (N) In Decimal:		33° 22' 39.2" N		28. Longitude (W) In Decimal:		96° 46' 5.2" W		
Degrees	Minutes	Seconds	Degrees	Minutes	Seconds			
29. Primary SIC Code (4 digits)		30. Secondary SIC Code (4 digits)		31. Primary NAICS Code (5 or 6 digits)		32. Secondary NAICS Code (5 or 6 digits)		
5093		4212		562111				
33. What is the Primary Business of this entity? (Do not repeat the SIC or NAICS description.)								
34. Mailing Address:		P.O. Box 1500						
		City	Celina	State	TX	ZIP	75009	ZIP + 4 3862
35. E-Mail Address:								
36. Telephone Number			37. Extension or Code			38. Fax Number (if applicable)		
( 214 ) 876-3356						( 214 ) 638-2945		

39. TCEQ Programs and ID Numbers Check all Programs and write in the permits/registration numbers that will be affected by the updates submitted on this form. See the Core Data Form instructions for additional guidance.

<input type="checkbox"/> Dam Safety	<input type="checkbox"/> Districts	<input type="checkbox"/> Edwards Aquifer	<input type="checkbox"/> Emissions Inventory Air	<input type="checkbox"/> Industrial Hazardous Waste
<input checked="" type="checkbox"/> Municipal Solid Waste	<input type="checkbox"/> New Source Review Air	<input type="checkbox"/> OSSF	<input type="checkbox"/> Petroleum Storage Tank	<input type="checkbox"/> PWS
40284				
<input type="checkbox"/> Sludge	<input checked="" type="checkbox"/> Storm Water	<input type="checkbox"/> Title V Air	<input type="checkbox"/> Tires	<input type="checkbox"/> Used Oil
	TXR05DO93			
<input type="checkbox"/> Voluntary Cleanup	<input type="checkbox"/> Wastewater	<input type="checkbox"/> Wastewater Agriculture	<input type="checkbox"/> Water Rights	<input type="checkbox"/> Other:

## SECTION IV: Preparer Information

<b>40. Name:</b>	Isabella Aguirre			<b>41. Title:</b>	Sr. Project Professional
<b>42. Telephone Number</b>	<b>43. Ext./Code</b>	<b>44. Fax Number</b>	<b>45. E-Mail Address</b>		
( 817 ) 358-6103		(   ) -	[REDACTED]		

## SECTION V: Authorized Signature

46. By my signature below, I certify, to the best of my knowledge, that the information provided in this form is true and complete, and that I have signature authority to submit this form on behalf of the entity specified in Section II, Field 6 and/or as required for the updates to the ID numbers identified in field 39.

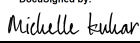
<b>Company:</b>	Champion Waste & Recycling Services, LLC		<b>Job Title:</b>	President	
<b>Name (In Print):</b>	Michelle Kuhar			<b>Phone:</b>	( 214 ) 876- 3356
<b>Signature:</b>	<small>DocuSigned by:</small>  <small>8D406786F2EC4A2...</small>			<b>Date:</b>	4/3/2025

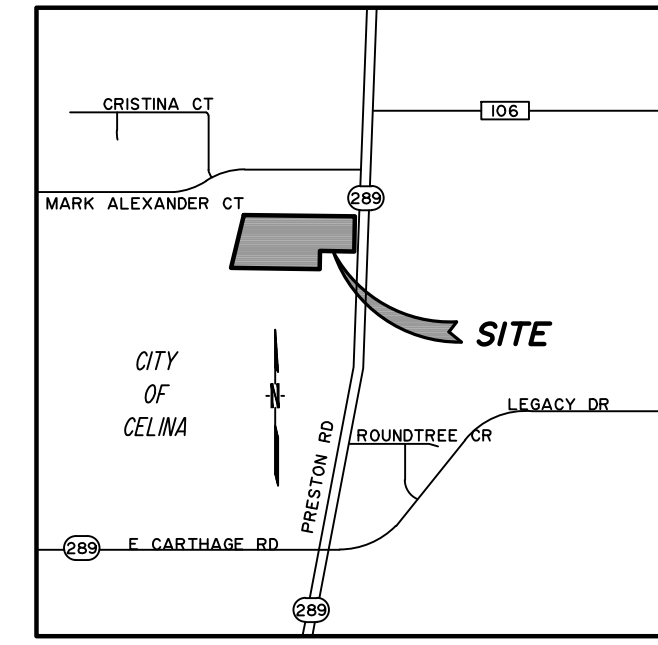
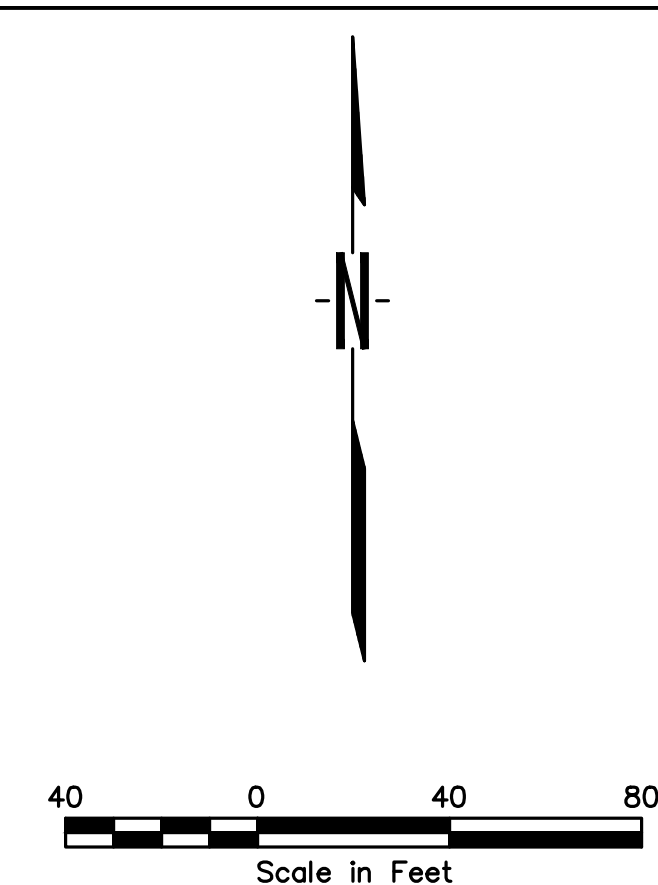
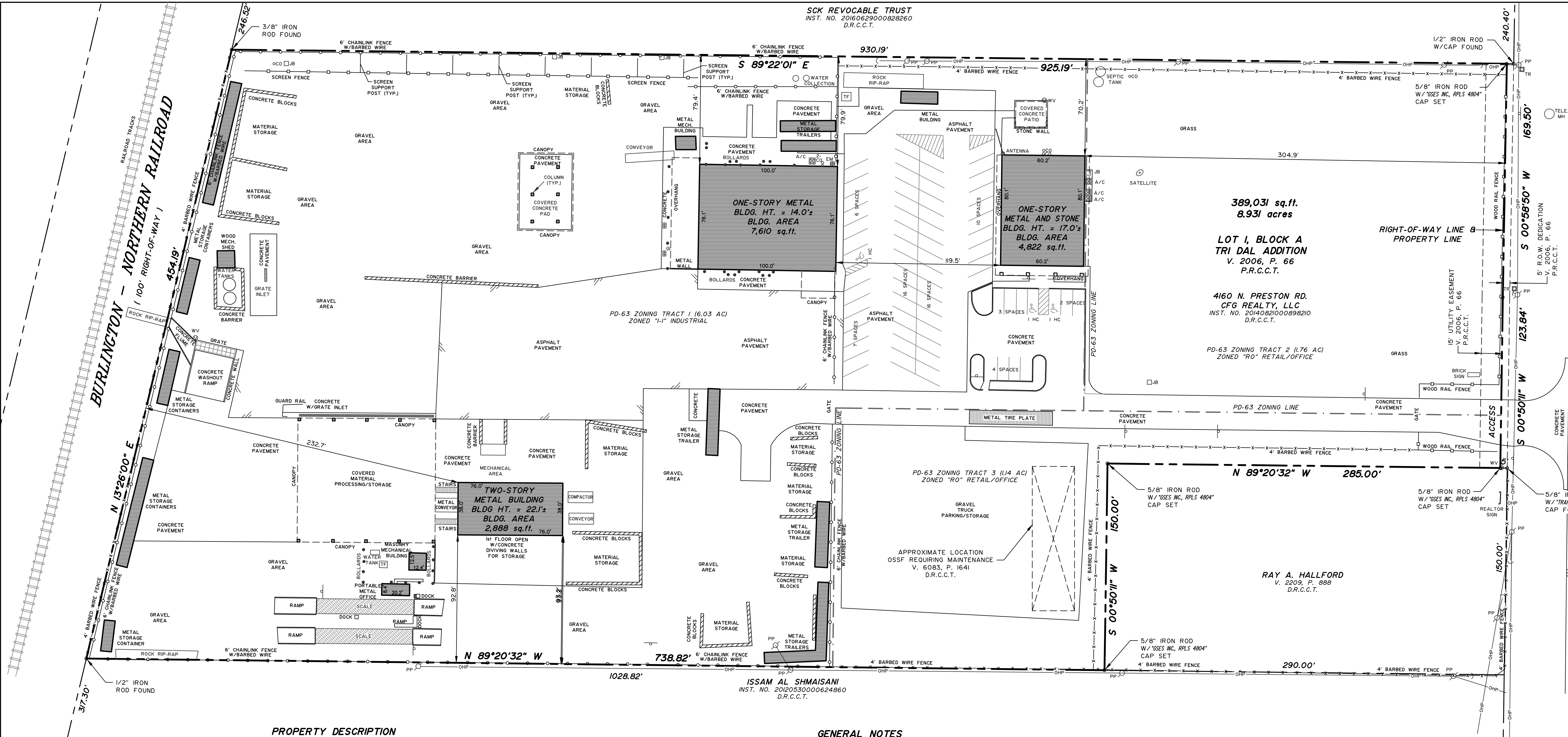

- LEGEND**
- PP POWER POLE
  - WM WATER METER
  - WV WATER VALVE
  - LS LIGHT STANDARD
  - TF TRANSFORMER
  - OCO CLEANOUT
  - ICV IRRIGATION CONTROL VALVE
  - JB JUNCTION BOX
  - WV WATER VAULT
  - GM GAS METER
  - GV GAS VALVE
  - MS METAL SIGN
  - PP POWER POLE ANCHOR
  - SS SANITARY SEWER MANHOLE
  - OHP OVERHEAD POWER LINE
  - F FENCE
  - A/C AIR CONDITION UNIT
  - TR TELEPHONE RISER
  - CR CABLE RISER
  - EM ELECTRIC METER
  - GI GRATE INLET
  - GL FLOOD LIGHT
  - B BOLLARD

SHEET 1 OF 1

"ALTA/NSPS LAND TITLE SURVEY"  
PREPARED FOR:

**THE MATTHEWS COMPANY** Inc.<sup>®</sup>

17220 Newhope Street, Suites 108-110, Fountain Valley, CA 92708  
Tel: (714) 979-7181 Fax: (714) 641-2840  
www.themattthewscompany.com

2	9/13/24	updated title, comments	GSES	GSES
1	7/18/24	comments	GSES	GSES
MARK	DATE	REVISION	BY	AP/V/D

Republic Services

4160 North Preston Road  
Celina, TX

SCALE: 1"=40'	CHKD./AP/V/D:
DATE: JULY 5, 2024	APPROVED:
DWN. BY: GSES	
CHKD. BY: RWS	

PROPERTY DESCRIPTION

Being all of Lot 1, Block A, of TRI DAL ADDITION, an addition to Collin County, Texas, according to the plat thereof recorded in Volume 2006, Page 66, Map Records, Collin County, Texas.

SURVEYOR'S CERTIFICATION

To: Republic Industrial and Energy Solutions, LLC, a Delaware limited liability company; Republic Waste Services of Texas, Ltd., a Texas limited partnership; Republic Services, Inc., its subsidiaries and affiliates; SpotsFain PC; Fidelity National Title Insurance Company; and The Matthews company, Inc.

This is to certify that this map or plat and the survey on which it is based were made in accordance with the 2021 Minimum Standard Detail Requirements for ALTA/NSPS Land Title Surveys, jointly established and adopted by ALTA and NSPS, and includes Items 1, 2, 3, 4, 6a, 6b, 7a, 7b, 7c, 8, 9, 10, 13, 14, 16, 17, 18 and 19 of Table A thereof. The fieldwork was completed on June 24, 2024.

Date of Plat or Map: July 5, 2024.

*Robert W. Schneeberg*

Robert W. Schneeberg, Texas R.P.L.S. No. 4804  
Gonzalez & Schneeberg, Engineers & Surveyors, Inc.  
801 East Campbell Road, Suite 330  
Richardson, Texas 75081  
Phone (972) 516-8855  
email: robert.schneeberg@gs-engineers.com  
GSES No: 7624-24-06-03  
Date: July 5, 2024

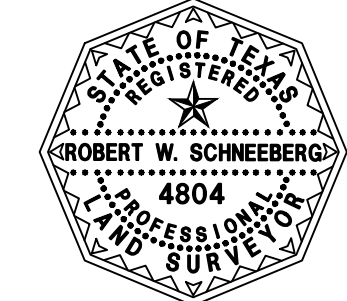

Date of Last Revision: September 13, 2024

The property described and shown hereon is the same property described in Fidelity National Title Insurance Company Title Commitment 6F No. SAT-41-4000412401223R, effective date July 15, 2024, issued September 11, 2024.

NOTES REGARDING SCHEDULE B EXCEPTIONS

10d. 15' utility easement recorded in Volume 2006, Page 66, Map Records, Collin County, Texas affects the subject tract and is plotted hereon.

10e. Affidavit of OSSF Requiring Maintenance recorded in Volume 6083, Page 1641, Land Records, Collin County, Texas affects the subject tract and the area is plotted hereon in it's approximate location.

10f. Terms, conditions and stipulations contained in Ordinance No. 2015-29 recorded in Document 20150605000670860, Land Records, Collin County, Texas affect the subject tract but are not plotted hereon as they are blanket in nature.

GENERAL NOTES

- Bearings are based on the north line of Lot 1, Block A, Tri Dal Addition bearing south 89 degrees 22 minutes 01 seconds East according to the plat thereof recorded in Volume 2006, Page 66, Map Records, Collin County, Texas.
- This survey is based on deeds, easements and/or recorded plats and other records furnished by the client and/or the client's representative as well as significant visible monuments found on the subject property and adjacent properties, field measurements and evidence of boundaries found on the ground. However, this survey shall not represent warranty of title or guarantee of ownership. The surveyor did not abstract the subject property. This survey was performed with the benefit of a current title policy provided by Fidelity National Title Insurance Company Title Commitment 6F No. SAT-41-4000412401223R, effective date July 15, 2024, issued September 11, 2024.
- Subject tract has direct access to State Highway No. 289, a public right-of-way.
- From a visual inspection only, all utilities appear to enter subject tract via public right-of-way.
- By graphical plotting only, subject tract is located in Zone "X", areas outside a flood hazard area according to the Flood Insurance Rate Map Community Panel No. 48085C0020J June 2, 2009.
- There is no observable evidence of earth moving work, building construction or building additions within recent months.
- There are no changes in street right-of-way lines either completed or proposed, and available from the controlling jurisdiction.
- There is no observable evidence of recent street or sidewalk construction or repairs.
- There is no observable evidence of site use as a solid waste dump, sump or sanitary landfill.
- From a visual inspection only, the subject tract appears to drain into a public right-of-way.
- No evidence found of cemeteries, burial grounds or isolated grave sites.
- No evidence of potential wetlands were observed on the subject property at the time the survey was conducted, nor have we received any documentation of any wetlands being located on the subject property. No markers were found at the time of the survey. Observed evidence of waterways on the property, as shown hereon.
- Professional Liability Insurance policy obtained by the surveyor to be in effect throughout the contract term. Certificate of Insurance to be furnished upon request.
- Title Commitment description matches the description used hereon.
- The boundary line dimensions as shown on this Survey Map form a mathematically closed figure within +/-0.1 foot, with no gaps or gores.
- Except as noted hereon, the boundary lines of the Property are contiguous with the boundary lines of all adjoining streets, highways, rights of way and easements, public or private, as described in their most recent respective legal descriptions of record;
- Except as otherwise noted below, if the Property consists of two or more parcels, there are no gaps or gores between said parcels.
- There are no observable party walls and no observable above ground encroachments either (A) by the improvements on the subject property upon adjoining properties, streets, alleys, easement or rights of way, or (B) by the improvements on any adjoining properties, streets or alleys upon the subject property, except as otherwise shown hereon.
- There is no observable evidence of easements or rights of way on or across the surveyed property, or on any adjoining properties if they appear to affect the subject property, except as otherwise shown hereon.
- The subject property does not appear to serve any adjoining property for drainage, utilities structural support, ingress or egress.

ZONING NOTES

Source of Information: celina-tx.gov

ZONED: "Champion Waste PD-63" - Planned Development District 63

SETBACKS:  
FRONT YARD: Per Development Plan  
SIDE YARD: Per Development Plan  
REAR YARD: Per Development Plan

BUILDING HEIGHT: Per Development Plan

PARKING REQUIRED: Per Development Plan

PARKING PROVIDED: 64 regular spaces  
3 handicap space  
67 total spaces

ENCROACHMENT NOTE

None noted

This Survey has been prepared solely for the benefit of the parties set forth in this Surveyor's Certification and may not be quoted or relied upon by, nor may copies be delivered to, any other party or used for any other purpose including, without limitation, the preparation of zoning reports or any other third party reports, without The Matthews Company, Inc. and Gonzalez & Schneeberg, Inc.'s prior written consent. The Matthews Company, Inc. and Gonzalez & Schneeberg, Inc. expressly disclaims any duty or obligation towards any party that is not identified in this Surveyor's Certification.

Please be advised that The Matthews Company, Inc. and Gonzalez & Schneeberg, Inc. will not include the providers of any third party reports in the Surveyor's Certification.

**Gonzalez & Schneeberg**  
engineers - surveyors  
Engineering Firm No. F-3376 Surveying License No. 100752-00

**SURVEY PLAT**  
OF A  
**8.931 ACRE TRACT**  
BEING ALL OF  
LOT 1, BLOCK A  
TRI DAL ADDITION  
M.E.P. & P. RAILROAD COMPANY SURVEY, ABSTRACT NO. 653  
CITY OF CELINA, COLLIN COUNTY, TEXAS

DWG. NO.: 7624-24-06-03 PROJ. NO.: S7624



10/20/2015 9:23 AM C:\Champion\16214088.00 - Registration - MSW Recycling Facility\3 - LANDOWNERS MAP

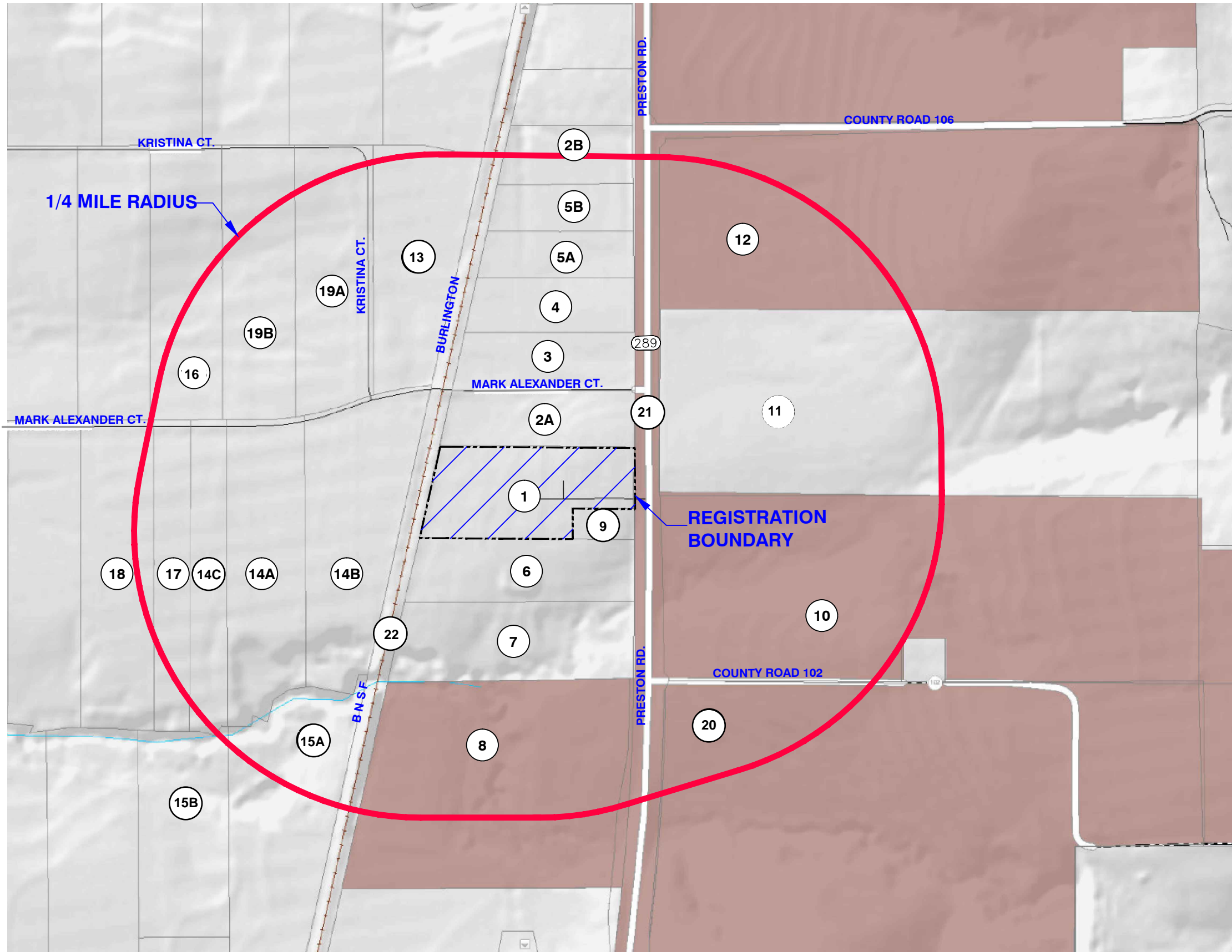

Source: Collin County Appraisal District

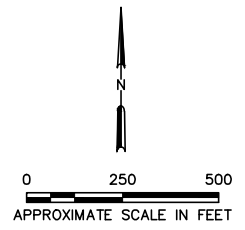

### LEGEND

- PERMIT BOUNDARY
- ① ADJACENT LAND OWNER (SEE NOTE 1)

#### NOTES:

- ① CORRESPONDS TO LANDOWNERS LISTED ON LANDOWNERS LIST.
- THE APPROXIMATE PROPERTY LINES SHOWN ON THIS MAP ARE FROM THE COLLIN COUNTY APPRAISAL DISTRICT WEBSITE.

Type text here

FOR PERMITTING PURPOSES ONLY

DRAWING TITLE		REV	DATE	DESCRIPTION	BY
LAND OWNERS MAP		A	10/2015	ADD PROPERTY NO. 21	KY
PROJECT TITLE					
REGISTRATION APPLICATION TO OPERATE A MSW					
TRANSFER STATION AND MATERIAL RECOVERY FACILITY					
CLIENT					
TOWN AND COUNTRY					
ENVIRONMENTAL SERVICES, LLC					
SCS ENGINEERS					
STEARNS, CONRAD AND SCHMIDT					
CONSULTING ENGINEERS					
1801 CENTRAL DRIVE, SUITE 550, BEDFORD, TX 76021					
PH (817) 571-2288 FAX NO. (817) 571-2188					
PROJ. NO.	DWN. BY	CHECKED BY	DATE	APP. BY	DATE
16214088.00	KMP/LLJ	JAA	06/2015	KDY	
CADD FILE:					
3 - LANDOWNERS MAP					
DATE:		06/2015			
SCALE:		AS SHOWN			
DRAWING NO.		I/II-3			

## Attachment 4

### Landowners List

1.	CFG Realty 254560 Westview Ct Prosper, TX 74078 Property ID 2598721	9.	Hallford Ray A 3801 N Capital of TX Hwy Ste E-240, PMB 162 Austin, Tx 78746-1482 Property ID 2564092	16.	Seven Hills DFW Realty LLC 3512 Ashley Gardens The Colony, TX 75056 Property I15BND 1497927
2A.	Sck Revocable Trust Suzanne Cannaday King Trustee PO Box 1034 Frisco, Tx 75034-0018 Property ID 1584501	10.	Preston 51 CR 102 LP 4541 Lancelot Dr Plano, TX 75024 Property ID 2121275	17.	Chitturu Srirama 4451 Desert Willow Dr Prosper, TX 75078 Property ID 2611596
2B.	Sck Revocable Trust Suzanne Cannaday King Trustee PO Box 1034 Frisco, Tx 75034-0018 Property ID 1498114	11.	Glazers Celina TIC 1 LLC Glazer Investments 14911 Quorum Dr Ste 200 Dallas, TX 75254 Property ID 985580	18.	Silver Peak Investments Group LLC 5069 Toledo Bend Dr Frisco, TX 75033 Property ID 1497838
3.	TA Properties II LTD 5060 Chaucer CT Plano, TX 75093 Property ID 1498150	12.	S F Collin County LLC 4541 Lancelot Dr Plano, TX 75024 Property ID 985553	19A.	Raya Cellular LLC 7800 Preston Rd Ste 150 Plano, TX 74024 Property ID 1497945
4.	JDG Land Holding Co 4320 N Preston Rd Celina, TX 75009 Property ID 1498141	13.	Celina289 Holdings LLC 421 Country Club Rd Fairview, TX 75069 Property ID 1497954	19B.	Raya Cellular LLC 7800 Preston Rd Ste 150 Plano, TX 74024 Property ID 1497936
5A.	Michael Family Trust 6005 Jericho Ct Dallas, TX 74248 Property ID 1498132	14A.	TR 13 Acres Preston Road LLC 3409 Rambling Way Plano, TX 75093 Property ID 1497856	20.	Bluerise Capital LLC 5850 Twin Country Blvd STE 1303 Frisco, TX 75034 Property ID 2719544
5B.	Michael Family Trust 6005 Jericho Ct Dallas, TX 74248 Property ID 1498123	14B.	TR 13 Acres Preston Road LLC 3409 Rambling Way Plano, TX 75093 Property ID 1497865	21.	Easement Holder: City of Celina 142 N Ohio St Celina, TX 75009
6	Shmaisani Issam Al 5608 Normandy Dr Colleyville, TX 76034 Property ID 996667	14C.	TR 13 Acres Preston Road LLC 3409 Rambling Way Plano, TX 75093 Property ID 2611595	22.	BNSF Railway Company 2650 LOU MENK DR Fort Worth, TX 76131
7	Van Family Trust 26612 White Oaks Dr Laguna Hills, CA 92653 Property ID 996685	15A.	NSH Collin County Investment LLC 4541 Lancelot Dr Plano, TX 75024 Property ID 1497785		
8.	28 & 12 Farm on Preston Road LTD 4541 Lancelot Dr Plano, TX 75024 Property ID 996596	15B.	NSH Collin County Investment LLC 4541 Lancelot Dr Plano, TX 75024 Property ID 2758470		

CFG REALTY LLC  
2560 WESTVIEW CT  
PROSPER TX 75078

HALLFORD RAY A  
3801 N CAPITAL OF TX HWY  
STE E-240, PMB 162  
AUSTIN TX 78746-1482

SEVEN HILLS DFW REALTY  
LLC  
3512 ASHLEY GARDENS  
THE COLONY TX 75056

SCK REVOCABLE TRUST  
SUZANNE CANNADAY KING  
TRUSTEE  
PO BOX 1034  
FRISCO TX 75034-0018

PRESTON 51 CR 102 LP  
4541 LANCELOT DR  
PLANO TX 75024

CHITTURU SRIRAMA  
4451 DESERT WILLOW DR  
PROSPER TX 75078

SCK REVOCABLE TRUST  
SUZANNE CANNADAY KING  
TRUSTEE  
PO BOX 1034  
FRISCO TX 75034-0018

GLAZERS CELINA TIC 1 LLC  
GLAZER INVESTMENTS  
14911 QUORUM DR STE 200  
DALLAS TX 75254

SILVER PEAK INVESTMENTS  
GROUP LLC  
5069 TOLEDO BEND DR  
FRISCO TX 75033

TA PROPERTIES II LTD  
5060 CHAUCER CT  
PLANO TX 75093

S F COLLIN COUNTY LLC  
4541 LANCELOT DR  
PLANO TX 75024

RAYA CELLULAR LLC  
7800 PRESTON RD STE 150  
PLANO TX 75024

JDG LAND HOLDING CO  
4320 N PRESTON RD  
CELINA TX 75009

CELINA289 HOLDINGS LLC  
421 COUNTRY CLUB RD  
FAIRVIEW TX 75069

RAYA CELLULAR LLC  
7800 PRESTON RD STE 150  
PLANO TX 75024

MICHAEL FAMILY TRUST  
6005 JERICO CT  
DALLAS TX 75248

TR 13 ACRES PRESTON ROAD  
LLC  
3409 RAMBLING WAY  
PLANO TX 75093

BLUERISE CAPITAL LLC  
5850 TOWN COUNTRY BLVD  
STE 1303  
FRISCO TX 75034

MICHAEL FAMILY TRUST  
6005 JERICO CT  
DALLAS TX 75248

TR 13 ACRES PRESTON ROAD  
LLC  
3409 RAMBLING WAY  
PLANO TX 75093

EASEMENT HOLDER:  
CITY OF CELINA  
142 N OHIO ST  
CELINA TX 75009

SHMAISANI ISSAM AL  
5608 NORMANDY DR  
COLLEYVILLE TX 76034

TR 13 ACRES PRESTON ROAD  
LLC  
3409 RAMBLING WAY  
PLANO TX 75093

BNSF RAILWAY COMPANY  
2650 LOU MENK DR  
FORT WORTH TX 76131

VAN FAMILY TRUST  
26612 WHITE OAKS DR  
LAGUNA HILLS CA 92653

NSH COLLIN COUNTY  
INVESTMENT LLC  
4541 LANCELOT DR  
PLANO TX 75024

28 & 12 FARM ON PRESTON  
ROAD LTD  
4541 LANCELOT DR  
PLANO TX 75024

NSH COLLIN COUNTY  
INVESTMENT LLC  
4541 LANCELOT DR  
PLANO TX 75024

## Attachment 5

### Property Owner Affidavit

I, Brady Loesch, as Area President for BFI Waste Services of Texas, LP, acknowledge that the State of Texas may hold me either jointly or severally responsible for the operation, maintenance, and closure of the facility. I further acknowledge that I or the operator and the State of Texas shall have access to the property during the active life, and after closure, for the purpose of inspection and maintenance, if required.

**Signed:**  **Date:** 2/4/2025

**Area President**  
**BFI Waste Services of Texas, LP**





## Office of the Secretary of State

### Certificate of Fact

The undersigned, as Secretary of State of Texas, does hereby certify that the document, Registration Of Limited Partnership for BFI WASTE SERVICES OF TEXAS, LP (file number 14867711), a DELAWARE, USA, Foreign Limited Partnership, was filed in this office on April 03, 2001.

It is further certified that the entity status in Texas is in existence.

In testimony whereof, I have hereunto signed my name officially and caused to be impressed hereon the Seal of State at my office in Austin, Texas on January 27, 2025.



A handwritten signature of Jane Nelson in black ink.

Jane Nelson  
Secretary of State

**Attachment 6.2**

**Verification of Legal Status/Legal Authority**

**Table 1**

**Persons having greater than 20% ownership in the facility**

<b>Name</b>	<b>Title</b>	<b>Contact Information</b>
Allied Waste Systems Holdings, Inc.	General Partner (99% Ownership) of BFI Waste Services of Texas, LP	18500 North Allied Way, Phoenix, AZ 85054 (480) 627-2700

**Attachment 7.1**

**Evidence of Competency**

**Table 2**

**Texas solid waste sites owned or operated within the last ten years**

<b>Site Name</b>	<b>Site Type</b>	<b>Permit/Reg. No.</b>	<b>County</b>	<b>Dates of Operation</b>
La Feria Transfer Station	Transfer Station	Solid Waste Permit to Operate Number 2375	Cameron	04/25/2011 - Present

## Attachment 7.2

### Evidence of Competency

Table 3

**Solid waste sites in all states, territories, or countries in which the owner or operator has a direct financial interest**

<b>Site Name</b>	<b>Location</b>	<b>Dates of Operation</b>	<b>Regulatory Agency (Name and Address)</b>
La Feria Transfer Station	1800 North Solis Rd, La Feria, TX 75889	04/25/2011 - Present	Texas Commission on Environmental Quality 12100 Park 35 Circle, Austin, TX 78753

### Attachment 7.3

#### Evidence of Competency

**Table 4**

Names and principals and supervisors of owner's and operator's organization, and previous affiliations with other organizations engaged in solid waste activities.

<b>Name</b>	<b>Previous Affiliation</b>	<b>Other Organization</b>
Brady Loesch, Area President	Area President, South (Texas)	Allied Waste Systems, Inc
Scott Trebus, Area Environmental Manager	Area Environmental Manager (Texas)	Allied Waste Systems, Inc
Modesto Dominguez, Area Vice President	General Manager	Blue Ridge Landfill TX, LP; McCarty Road Landfill TX, LP
Allied Waste Systems Holdings, Inc.	General Partner	Adrian Landfill, Inc.
Allied Waste Systems Holdings, Inc.	General Partner	Belleville Landfill, Inc.
Allied Waste Systems Holdings, Inc.	General Partner	Celina Landfill, Inc.
Allied Waste Systems Holdings, Inc.	General Partner	Central Sanitary Landfill, Inc.
Allied Waste Systems Holdings, Inc.	General Partner	Cherokee Run Landfill, Inc.
Allied Waste Systems Holdings, Inc.	General Partner	Citizens Disposal, Inc.
Allied Waste Systems Holdings, Inc.	General Partner	Environmental Reclamation Company
Allied Waste Systems Holdings, Inc.	General Partner	Harland's Sanitary Landfill, Inc.
Allied Waste Systems Holdings, Inc.	General Partner	Ottawa County Landfill, Inc.
Allied Waste Systems Holdings, Inc.	General Partner	Roxana Landfill, LLC
Allied Waste Systems Holdings, Inc.	General Partner	Williams County Landfill Inc.
Allied Waste Landfill Holdings, Inc.	Limited Partner	Allied Services, LLC
Allied Waste Landfill Holdings, Inc.	Limited Partner	BFI Waste Services of Texas, LP

Allied Waste Landfill Holdings, Inc.	Limited Partner	Clinton County Landfill Partnership
Allied Waste Landfill Holdings, Inc.	Limited Partner	County Line Landfill Partnership
Allied Waste Landfill Holdings, Inc.	Limited Partner	Ellis Scott Landfill MO, LLC
Allied Waste Landfill Holdings, Inc.	Limited Partner	Great Plains Landfill OK, LLC
Allied Waste Landfill Holdings, Inc.	Limited Partner	Illiana Disposal Partnership
Allied Waste Landfill Holdings, Inc.	Limited Partner	Lake County C & D Development Partnership
Allied Waste Landfill Holdings, Inc.	Limited Partner	Lee County Landfill SC, LLC
Allied Waste Landfill Holdings, Inc.	Limited Partner	Newton County Landfill Partnership
Allied Waste Landfill Holdings, Inc.	Limited Partner	Pinecrest Landfill OK, LLC
Allied Waste Landfill Holdings, Inc.	Limited Partner	Springfield Environmental General Partnership
Allied Waste Systems Holdings, Inc. Allied Waste Landfill Holdings, Inc.	General Partner  Limited Partner	Abilene Landfill TX, LP
Allied Waste Systems Holdings, Inc. Allied Waste Landfill Holdings, Inc.	General Partner  Limited Partner	BFI Transfer Systems of Texas, LP
Allied Waste Systems Holdings, Inc. Allied Waste Landfill Holdings, Inc.	General Partner  Limited Partner	Blue Ridge Landfill TX, LP
Allied Waste Systems Holdings, Inc. Allied Waste Landfill Holdings, Inc.	General Partner  Limited Partner	Camelot Landfill TX, LP
Allied Waste Systems Holdings, Inc. Allied Waste Landfill Holdings, Inc.	General Partner  Limited Partner	Crow Landfill TX, L.P.
Allied Waste Systems Holdings, Inc. Allied Waste Landfill Holdings, Inc.	General Partner  Limited Partner	Desarrollo del Rancho La Gloria TX, LP

Allied Waste Systems Holdings, Inc. Allied Waste Landfill Holdings, Inc.	General Partner  Limited Partner	El Centro Landfill, L.P.
Allied Waste Systems Holdings, Inc. Allied Waste Landfill Holdings, Inc.	General Partner  Limited Partner	Ellis County Landfill TX, LP
Allied Waste Systems Holdings, Inc. Allied Waste Landfill Holdings, Inc.	General Partner  Limited Partner	Fort Worth Landfill TX, LP
Allied Waste Systems Holdings, Inc. Allied Waste Landfill Holdings, Inc.	General Partner  Limited Partner	Galveston County Landfill TX, LP
Allied Waste Systems Holdings, Inc. Allied Waste Landfill Holdings, Inc.	General Partner  Limited Partner	Golden Triangle Landfill TX, LP
Allied Waste Systems Holdings, Inc. Allied Waste Landfill Holdings, Inc.	General Partner  Limited Partner	Greenwood Landfill TX, LP
Allied Waste Systems Holdings, Inc. Allied Waste Landfill Holdings, Inc.	General Partner  Limited Partner	Gulf West Landfill TX, LP
Allied Waste Systems Holdings, Inc. Allied Waste Landfill Holdings, Inc.	General Partner  Limited Partner	Itasca Landfill TX, LP
Allied Waste Systems Holdings, Inc. Allied Waste Landfill Holdings, Inc.	General Partner  Limited Partner	Kerrville Landfill TX, LP
Allied Waste Systems Holdings, Inc. Allied Waste Landfill Holdings, Inc.	General Partner  Limited Partner	Lewisville Landfill TX, LP
Allied Waste Systems Holdings, Inc. Allied Waste Landfill Holdings, Inc.	General Partner  Limited Partner	McCarty Road Landfill TX, LP
Allied Waste Systems Holdings, Inc.	General Partner	Mesquite Landfill TX, LP

Allied Waste Landfill Holdings, Inc.	Limited Partner	
Allied Waste Systems Holdings, Inc. Allied Waste Landfill Holdings, Inc.	General Partner Limited Partner	Mexia Landfill TX, LP
Allied Waste Systems Holdings, Inc. Allied Waste Landfill Holdings, Inc.	General Partner Limited Partner	Pine Hill Farms Landfill TX, LP
Allied Waste Systems Holdings, Inc. Allied Waste Landfill Holdings, Inc.	General Partner Limited Partner	Pleasant Oaks Landfill TX, LP
Allied Waste Systems Holdings, Inc. Allied Waste Landfill Holdings, Inc.	General Partner Limited Partner	Southwest Landfill TX, LP
Allied Waste Systems Holdings, Inc. Allied Waste Landfill Holdings, Inc.	General Partner Limited Partner	Whispering Pines Landfill TX, LP





## LEVELS OF AUTHORITY POLICY

*Note: This Policy is the property of Republic Services, Inc. and/or its subsidiaries (collectively referred to herein as “Republic” or the “Company”) and is to be used in connection with the conduct of Republic’s business. This Policy is not intended to and does not constitute or create contractual terms of employment. Refer to the [Policies and Procedures Manual](#) (“PPM”) section of [Inside Republic Services](#) for the most current versions of Republic’s Policies.*

POLICY NUMBER: LOA-101

CATEGORY: Levels of Authority

ORIGINAL EFFECTIVE DATE: 12/05/2008

LATEST REVISION DATE: 9/23/2024

POLICY CONTACT(S) AND QUESTIONS: Director, Ethics & Compliance

Questions also may be directed to [REDACTED].

### POLICY HIGHLIGHTS:

- Provides required scope and levels of management needed to review and approve significant business transactions and other commitments prior to their consummation.
- Provides guidance as to those positions/titles authorized to sign appropriate documentation to effectuate business transactions and other commitments – subject to all required approvals within the Levels of Authority.

## PURPOSE

This Policy defines the scope and levels of management required to review and approve business transactions and other commitments (“Levels of Authority”) as delegated by Republic Services, Inc. (“Parent Company”), for itself and its subsidiaries (“Subsidiaries”) (collectively, the Parent Company and Subsidiaries are referred to herein as “Republic” or the “Company”). This Policy further provides guidance as to those positions/titles that are authorized to sign the appropriate documentation to effectuate business transactions and other commitments on behalf of the Company, subject to all required approvals within the Levels of Authority being granted.

## SCOPE

This Policy applies to all employees and third parties acting as representatives of the Company. Managers are expected to review this Policy with their employees and any representatives as it applies to positions and responsibilities to ensure an understanding of the requirements and that all approvals and signatures are properly obtained.

## REQUIREMENTS AND RESPONSIBILITIES

### Approval Authority

The Levels of Authority set forth all required levels of management that need to review and approve significant business transactions and other commitments prior to their consummation ("Approval Authority"). Unless indicated in the Levels of Authority, the designated Approval Authority may not be further delegated. All approvals must be documented in writing (includes emails and electronic signatures as acceptable formats) and retained for auditing purposes.

It is the responsibility of the Corporate Departments, having oversight of those transactions as set forth in the Levels of Authority, to establish and coordinate formal review processes to ensure that the appropriate responsible parties have performed all required reviews and due diligence **prior** to submitting documents to the designated Approval Authority. For example, Engineering, Finance and Legal approvals may not be included under the required Approval Authority; however, prior review may be required under the due diligence procedures established by the Corporate Departments.

### Combining Transactions

Dividing a transaction into two or more parts to evade a limit of authority is prohibited and is a violation of this Policy. The Levels of Authority shall be interpreted broadly so that a series of reasonably related transactions and expenditures shall be considered as a single transaction for purposes of determining approval and authority levels required by this Policy.

### Policy Exceptions

The CEO, COO, CFO or CLO may approve exceptions to this Policy, but not beyond the limits of their authority. Any exceptions must be documented in writing and maintained by the [Director, Ethics & Compliance](#).

### Signatory Authority

The required Approval Authority as set forth in the Levels of Authority does not represent the authorization to sign documents on behalf of the Parent Company and/or its Subsidiaries. Only those individuals and/or positions/titles that have been formally designated with the authority to sign documents as an officer or authorized agent by the appropriate governing authorities of the Parent Company and Subsidiaries may do so ("Signatory Authority"). The Levels of Authority provide a listing of positions/titles by action with Signatory Authority to execute documents (on behalf of the appropriate legal entity that is party to the specified transaction) for effectuating business transactions and other commitments **after** all Approval Authority requirements within the Levels of Authority have been granted in writing.

In addition to positions designated as authorized agents to sign certain documents, elected officers of the Parent Company and respective Subsidiaries have implied Signatory Authority to execute all documents on behalf of such legal entities. Examples include (i) Area Presidents serve as officers of Subsidiaries operating within their Areas; (ii) and Senior Vice President, Operations serves as an officer of all operating Subsidiaries. For additional information on routine signatory authorizations, refer to the [Global Signatory Authority Resolutions](#) as posted under the [Legal Department section](#) on [Inside Republic Services](#).

Under no circumstances may any officer or designated authorized agent of Subsidiaries sign or agree to any obligation or agreement in the name or on behalf of the Parent Company (Republic Services, Inc.) or of any other legal entity of which the person is not authorized to do so. Any questions as to those elected officers that are authorized to sign on behalf of any Subsidiaries should be directed to the [Legal Department](#). Inquiries related to officers of the Parent Company should be directed to the Senior Manager, Ethics & Compliance. For information as to the Subsidiaries and proper legal entity and fictitious names assigned to each operating location, refer to the [Legal Entity by Division List](#) as posted under the [Legal Department section](#) on [Inside Republic Services](#).

## Ethics and Compliance Responsibilities

All employees and third parties acting as representatives are expected to observe high standards of business and personal ethics in the conduct of their duties and responsibilities for Republic. Employees approving transactions and/or executing documents are required to ensure that all appropriate reviews and approvals required by the Levels of Authority and all other relevant policies and procedures of the Company have been obtained and that the appropriate documentation of these approvals is maintained. Violations of this Policy can significantly damage the Company and expose it to unintended legal and business consequences. Employees found to be in violation of this Policy may be subject to disciplinary action, up to and including termination of employment. Employees should report all instances of non-compliance with this Policy to a member of management or at



## POLICIES, PROCEDURES AND OTHER RESOURCES

- [Code of Business Ethics and Conduct](#)
- [PPM SharePoint Site](#)
- [Speak Up Poster](#)

## SECTION 14: ENVIRONMENTAL PERMITS AND REPORTS – continued

[Note: Any indemnification provisions are subject to the Approval Authority set forth in [Section 1](#) of this policy.]

**The following Approval Authority and Signatory Authority under this Section 14 do not apply to the Parent Company (Republic Services, Inc.)**

### (Clean Water Act)

DESCRIPTION OF ACTIONS	APPROVAL AUTHORITY (Approvals Required <i>Prior</i> to Signing Documents to Effectuate Transaction) <a href="#">[Click Here for List of Abbreviated Titles]</a> <a href="#">[Click Here for Further Guidance]</a>	SIGNATORY AUTHORITY (Authorized to Sign Transaction Documents) <a href="#">[Click Here for Further Guidance]</a>
<b>NPDES Permit Applications, Stormwater Permits, Applications/NOI.</b> (Federal Citation 40 CFR 122.22 (a)(1), 123 (a)(5))	<ul style="list-style-type: none"> <li>Environmental Manager, AEM and GM</li> <li>GM, EHS Manager, DESD or AP</li> </ul>	<ul style="list-style-type: none"> <li>Positions listed under Approval Authority have signatory authority on behalf of the Subsidiaries, although the GM is the preferred signer and AP also may sign as an Officer</li> </ul>
<b>Reports and Other Information Required by Permit.</b> (Federal Citation 40 CFR 122.22 (a)(1), 123 (a)(5)) [Note: Includes stormwater pollution prevention plans, reports and certifications required by general permit.]	<ul style="list-style-type: none"> <li>Environmental Manager, AEM and GM</li> <li>GM, EHS Manager, DESD or AP</li> </ul>	<ul style="list-style-type: none"> <li>Positions listed under Approval Authority have signatory authority on behalf of the Subsidiaries, although the Environmental Manager or DESD is the preferred signer and AP also may sign as an Officer</li> </ul>
<b>Wetlands Permit.</b> (CWA Section 404) (Federal Citation 40 CFR 320-330; also state requirements must be addressed)	<ul style="list-style-type: none"> <li>Environmental Manager, AEM and GM</li> <li>GM, EHS Manager, DESD or AP</li> </ul>	<ul style="list-style-type: none"> <li>Positions listed under Approval Authority have signatory authority on behalf of the Subsidiaries, although the GM is the preferred signer and AP also may sign as an Officer</li> </ul>
<b>POTW/Industrial User Reports (Annual).</b> (Federal Citation 40 CFR 403.12)	<ul style="list-style-type: none"> <li>Environmental Manager, AEM and GM</li> <li>GM, EHS Manager, DESD or AP</li> </ul>	<ul style="list-style-type: none"> <li>Positions listed under Approval Authority have signatory authority on behalf of the Subsidiaries, although the Environmental Manager or DESD is the preferred signer and AP also may sign as an Officer</li> <li>Periodic (monthly and quarterly) POTW reporting can be signed by site operations management with authorization from GM</li> </ul>

### (RCRA – Solid Waste Facilities)

DESCRIPTION OF ACTIONS	APPROVAL AUTHORITY (Approvals Required <i>Prior</i> to Signing Documents to Effectuate Transaction) <a href="#">[Click Here for List of Abbreviated Titles]</a> <a href="#">[Click Here for Further Guidance]</a>	SIGNATORY AUTHORITY (Authorized to Sign Transaction Documents) <a href="#">[Click Here for Further Guidance]</a>
<b>Permit Applications.</b> (Federal Citation 40 CFR 270.11 (a)(1))	<ul style="list-style-type: none"> <li>Environmental Manager, AEM and GM</li> <li>GM, EHS Manager, DESD or AP</li> </ul>	<ul style="list-style-type: none"> <li>Positions listed under Approval Authority have signatory authority on behalf of the Subsidiaries, although the GM is the preferred signer and AP also may sign as an Officer</li> </ul>
<b>Reports and Other Information Required by Permit.</b> (Federal Citation 40 CFR 270.11 (b))	<ul style="list-style-type: none"> <li>Environmental Manager, AEM and GM</li> <li>GM, EHS Manager, DESD or AP</li> </ul>	<ul style="list-style-type: none"> <li>Positions listed under Approval Authority have signatory authority on behalf of the Subsidiaries, although the Environmental Manager or DESD is the preferred signer and AP also may sign as an Officer</li> </ul>

Your transaction is complete. Thank you for using TCEQ ePay.

**Note: It may take up to 3 working days for this electronic payment to be processed and be reflected in the TCEQ ePay system. Print this receipt and the vouchers for your records. An email receipt has also been sent.**

**Transaction Information**

**Trace Number:** [REDACTED]  
**Date:** 01/29/2025 02:05 PM  
**Payment Method:** CC - Authorization [REDACTED]  
**ePay Actor:** ADAM HART  
**Actor Email:** [REDACTED]  
**IP:** 163.116.253.50  
**TCEQ Amount:** \$150.00  
**Texas.gov Price:** \$153.63\*

\* This service is provided by Texas.gov, the official website of Texas. The price of this service includes funds that support the ongoing operations and enhancements of Texas.gov, which is provided by a third party in partnership with the State.

**Payment Contact Information**

**Name:** ADAM HART  
**Company:** BFI WASTE SERVICES OF TEXAS LP  
**Address:** 1212 HARRISON AVE, ARLINGTON, TX 76011  
**Phone:** 903-539-4065

**Cart Items**

Click on the voucher number to see the voucher details.

Voucher	Fee Description	AR Number	Amount
<a href="#">745138</a>	MSW PERMIT/REGISTRATION/AMEND/MOD/TEMP AUTHORIZATIONS APPLICATION FEE		\$100.00
<a href="#">745139</a>	30 TAC 305.53B MWP NOTIFICATION FEE		\$50.00
<b>TCEQ Amount:</b>			<b>\$150.00</b>

[ePay Again](#)[Exit ePay](#)

**Note: It may take up to 3 working days for this electronic payment to be processed and be reflected in the TCEQ ePay system. Print this receipt for your records.**

This map/plat is being furnished as an aid in locating the herein described Land in relation to adjoining streets, natural boundaries and other land, and is not a survey of the land depicted. Except to the extent a policy of title insurance is expressly modified by endorsement, if any, the Company does not insure dimensions, distances, location of easements, acreage or other matters shown thereon.

PL 2006-66

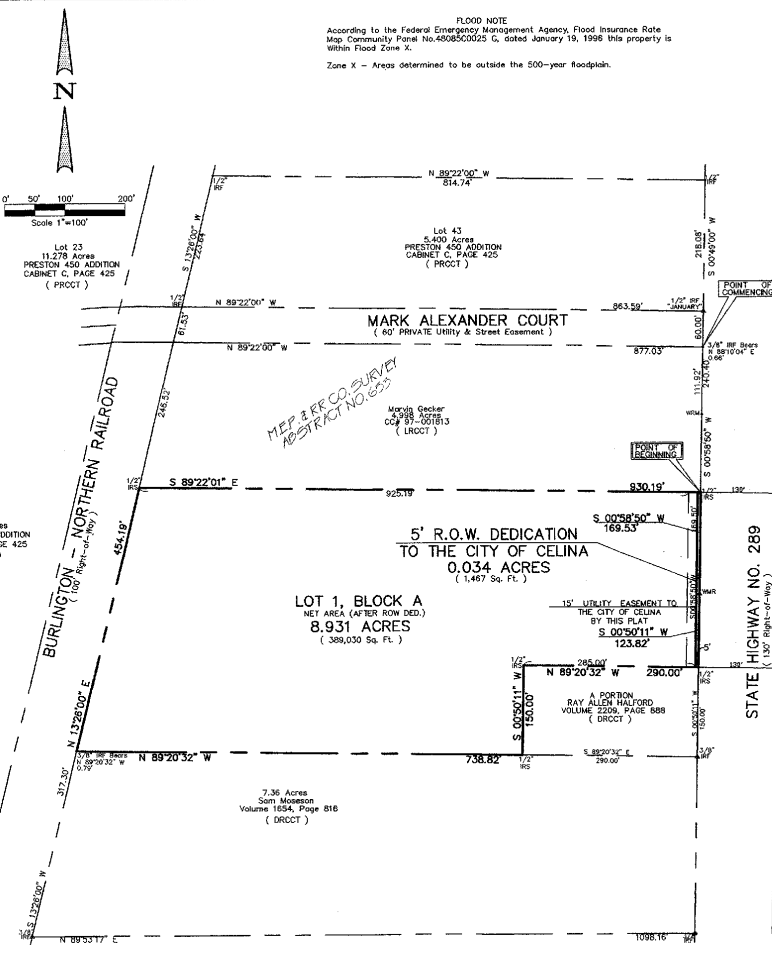
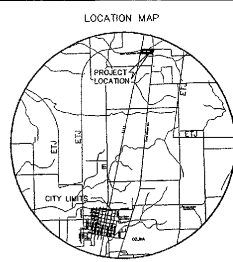

PL 2006-66



**FLOOD NOTE**  
According to the Federal Emergency Management Agency, Flood Insurance Rate Map Community Panel No. 48085C0025 G, dated January 19, 1996 this property is within Flood Zone X.  
Zone X - Areas determined to be outside the 500-year floodplain.

STATE OF TEXAS  
COUNTY OF COLLIN  
WHEREAS, Tri Dal Real Estate, Ltd. is the Owner of a tract of land situated in the M.E.P. & P. RAILROAD COMPANY SURVEY, Abstract No. 653, Collin County, Texas and being all of an 8.997 acre tract conveyed to RAY ALLEN HALFORD recorded in a deed in Volume 2209, Page 891 of the Deed Records of Collin County, Texas (DRCCT), and being more particularly described as follows:

COMMENCING at the most southeasterly corner of LOT 43 of the PRESTON 450 ADDITION, an addition to Collin County, Texas as recorded in Cabinet C, Page 425 of the Plat Records of Collin County, Texas (PRCCT), said point being in the westerly Right-of-Way line of STATE HIGHWAY NO. 289 (variable width Right-of-Way) which a 3/8 inch iron rod found bears North 68 deg 10 min 04 sec East a distance of 0.66 feet;  
THENCE departing the southerly line of said LOT 43 and along the westerly Right-of-Way line of said STATE HIGHWAY NO. 289 South 00 deg 58 min 50 sec West passing through a Wood Highway Monument found a distance of 111.92 feet continuing in all a distance of 240.40 feet to the 1/2 inch iron rod set with a red plastic cap stamped "W.A.I." for the POINT OF BEGINNING, said point being the most southeasterly corner of a tract of land conveyed to Mark Gecker as recorded in 004 97-00813 of the Land Records of Collin County, Texas (LRCT);  
THENCE departing the southerly line of said Gecker tract and continuing along the westerly Right-of-Way line of said STATE HIGHWAY NO. 289 as follows:  
South 00 deg 58 min 50 sec West a distance of 169.53 feet to a Wood Highway Monument found for corner;  
South 00 deg 50 min 11 sec West a distance of 123.82 feet to a 1/2 inch iron rod set with a red plastic cap stamped "W.A.I." for the most northeasterly corner of a proposed 1.0 acre tract of land;  
THENCE departing the westerly Right-of-Way line of said STATE HIGHWAY NO. 289 and along the northerly line of said proposed 1.0 acre tract North 89 deg 20 min 32 sec East a distance of 290.00 feet to a 1/2 inch iron rod set with a red plastic cap stamped "W.A.I." for the most northeasterly corner of said proposed 1.0 acre tract;  
THENCE along the westerly line of said proposed 1.0 acre tract South 00 deg 50 min 11 sec West a distance of 150.00 feet to a 1/2 inch iron rod set with a red plastic cap stamped "W.A.I." for the most southeasterly corner of said proposed 1.0 acre tract, said point being set in the northerly line of a tract of land conveyed to Sam Moseman as recorded in Volume 1654, Page 816 (LRCT);  
THENCE departing the westerly line of said Moseman tract and along the northerly line of said Moseman tract a distance of 738.82 feet to the most northeasterly corner of said Moseman tract, said point being in the easterly Right-of-Way line of the BURLINGTON NORTHERN RAILROAD (107' Right-of-Way) which a 3/8 inch iron rod found bears North 89 deg 20 min 32 sec West a distance of 0.79 feet;  
THENCE departing the northerly line of said Moseman tract and along the easterly Right-of-Way line of said BURLINGTON NORTHERN RAILROAD North 13 deg 20 min 00 sec East a distance of 454.19 feet to a 1/2 inch iron rod set with a red plastic cap stamped "W.A.I." for the most southeasterly corner of said Gecker tract;  
THENCE departing the easterly Right-of-Way line of said BURLINGTON NORTHERN RAILROAD and along the southerly line of said Gecker tract South 89 deg 20 min 32 sec East a distance of 930.19 feet to the POINT OF BEGINNING;  
CONTAINING within these metes and bounds 8.965 acres or 390,497 square feet of land more or less. Bearings contained within this field note description are based upon an on the ground survey performed in the field on the 15th day of November, 2004 utilizing the bearings as found on the First Plat of the PRESTON 450 ADDITION, an addition to Collin County, Texas as recorded in Cabinet C, Page 425 of the Plat Records of Collin County, Texas (PRCCT).

NOW, THEREFORE, KNOW ALL MEN BY THESE PRESENTS:  
That TRI DAL REAL ESTATE, LTD., acting herein by and through its (its) duly authorized officer(s), does hereby adopt this plat designating the herein above described property as TRI DAL ADDITION, an addition to the City of Celina, Texas, and does hereby dedicate, in fee simple, to the public use forever, the streets, rights-of-way, and other public improvements shown thereon. The streets and alleys, if any, are dedicated for street purposes. The easements and public use areas, as shown, are dedicated, for the public use forever, for the purposes indicated on this plat. No buildings, fences, trees, shrubs or other improvements or growths shall be constructed or placed upon, over or across the easements as shown, except that landscape improvements may be placed in conjunction with easements, if approved by the City Council of the City of Celina. In addition, utility easements may be used for the mutual use and accommodation of all public utilities desiring to use or using the same unless the easement limits the use to particular utilities, said use by public utilities being subordinate to the public and City of Celina's use thereof. The City of Celina and public utility entities shall have the right to remove all and keep removed all or parts of any buildings, fences, trees, shrubs or other improvements or growths which may in any way encroach or interfere with the construction, maintenance, or efficiency of their respective systems in said easements. The City of Celina and public utility entities shall at all times have the full right of ingress and egress to or from their respective easements for the purpose of constructing, reconstructing, inspecting, patrolling, maintaining, reading meters, and adding to or removing all or parts of their respective systems without the necessity at any time procuring permission from anyone.  
This plat approved subject to all pitting ordinances, rules, regulations and resolutions of the City of Celina, Texas.  
WITNESS my hand, this 14th day of December, 2005.  
BY: TRI DAL REAL ESTATE, LTD.  
Authorized Signature of Owner  
Jack D. Service  
Printed Name  
STATE OF TEXAS  
COUNTY OF COLLIN  
Before me, the undersigned authority, a Notary Public in and for the State of Texas, on this day personally appeared Jack D. Service, Owner, known to me to be the person whose name is subscribed to the foregoing instrument and acknowledged to me that he executed the same for the purposes and considerations therein expressed.  
Given under my hand and seal of office, this 14th day of Dec., 2005.

**PROPERTY LOCATION STATEMENT**  
This property is located in the extrajurisdictional jurisdiction of the City of Celina, Collin County, Texas.  
City Secretary, City of Celina  
ATTEST:  
City Secretary, City of Celina  
**NOTICE:**  
SELLING A PORTION OF THIS ADDITION BY METES & BOUNDS IS A VIOLATION OF CITY ORDINANCE AND STATE LAW, AND IS SUBJECT TO FINES AND WITHHOLDING OF UTILITIES AND BUILDING PERMITS.

**NOTE: OWNER SHALL, WITHIN 90 DAYS OF BEING ADVISED IN WRITING BY CELINA THAT THERE IS CITY/OWNER WATER ADEQUATE TO SUPPORT A FIRE HYDRANT WITHIN 400 FEET OF THE SUBJECT PROPERTY, COMMENCE CONSTRUCTION OF A FIRE HYDRANT ON ITS PROPERTY AT A LOCATION ACCEPTABLE TO THE FIRE MARSHAL AND SHALL CONSTRUCT AN 8" WATERLINE FROM THE HYDRANT TO THE EAST PROPERTY LINE. THE WATERLINE SHALL BE ON THE WEST SIDE OF SH289.**

**SURVEYOR CERTIFICATE**  
KNOW ALL MEN BY THESE PRESENTS:  
That I, B.J. Elum, do hereby certify that I prepared this plat from an actual and accurate survey of the land and that the corner monuments shown thereon as "set" were properly placed under my personal supervision in accordance with the Subdivision Ordinance of the City of Celina.  
B. J. Elum  
Registered Professional Land Surveyor  
Texas Registration No. 4581  
Winkelmänn & Associates, Inc.  
6750 Hillcrest Plaza Drive, Suite 100  
Dallas, Texas 75230  
(972) 490-7090

STATE OF TEXAS  
COUNTY OF DALLAS  
Before me, the undersigned authority, a Notary Public in and for the State of Texas, on this day personally appeared B. J. Elum, Registered Professional Land Surveyor, known to me to be the person whose name is subscribed to the foregoing instrument and acknowledged to me that he executed the same for the purposes and considerations therein expressed.  
Given under my hand and seal of office, this 14th day of Dec., 2005.  
Notary Public in and for the State of Texas  
My Commission Expires On: 3-4-09

**APPROVAL BLOCK**  
Approved by the City of Celina for filing at the office of the County Clerk of Collin County, Texas.  
**RECOMMENDED BY:**  
not applicable  
Signature of Chairperson  
**APPROVED BY:**  
Signature of Mayor  
**ATTEST:**  
City Secretary  
Planning and Zoning Commission  
City of Celina, Texas  
Date of Recommendation  
City Council  
City of Celina, Texas  
Date of Approval  
City Secretary

**FINAL PLAT**  
**TRI DAL ADDITION**  
**LOTS 1 OF BLOCK A**  
**COLLIN COUNTY, TEXAS**  
**8.965 ACRES**

BEING A TRACT OF LAND SITUATED IN THE  
M.E.P. & P. RAILROAD COMPANY SURVEY  
ABSTRACT NO. 653  
COLLIN COUNTY, TEXAS  
ZONING: NONE

**OWNER:**  
TRI DAL REAL ESTATE, LTD.  
540 COMMERCE  
SOUTH LAKE, TEXAS 76092

**ENGINEER/SURVEYOR:**  
WINKELMANN & ASSOCIATES, INC.  
6750 HILLCREST PLAZA DRIVE  
DALLAS, TEXAS 75230  
TEL: (972) 490-7090

THIS PLAT IS RECORDED IN CABINET, SLIDE

QTY	COUNCIL ACTION	M.D.C.
4	12/14/05	M.D.C.
3	05/06/05	M.D.C.
2	03/15/05	M.D.C.
1	02/07/05	M.D.C.
REVISION	DATE	APPROVAL

**Winkelmänn & Associates, Inc.**  
CONSULTING CIVIL ENGINEERS • SURVEYORS  
540 COMMERCE  
SOUTH LAKE, TEXAS 76092  
TEL: (972) 490-7090

M.E.P. & P. RAILROAD COMPANY SURVEY  
ABSTRACT NO. 653  
COLLIN COUNTY, TEXAS  
TRI DAL REAL ESTATE, LTD.  
540 COMMERCE  
SOUTH LAKE, TEXAS 76092

**FINAL PLAT**  
**TRI DAL ADDITION**  
**LOT 1, BLOCK A**

Scale: 1" = 100' Date: 12/30/04  
Designed By: M.D.C.  
Drawn By: W & A  
Checked By: M.D.C.  
File: 45501trp.dwg  
Project No.: 45501.00





ROS

----- MAUN  
TAX ASSESSOR COLLECTOR  
COLLIN COUNTY  
1800 N. GRAVES STREET STE 170  
P.O. BOX 8006  
MCKINNEY TEXAS 75070-8006  
972-547-5020  
METRO 972-424-1460 EXT. 5020

TAX CERTIFICATE

FEE 10.00

ACCOUNT: R-6653-000-0110-1

CERTIFICATE NUMBER: 18,993

OWNER NAME & ADDRESS  
TRI DAL REAL ESTATE LTD  
540 COMMERCE ST  
SOUTHLAKE TX 76092-9113

LEGAL DESCRIPTION  
ABS A0653 M. E. P. & P. RY.  
CO., TRACT 11, 5.0 ACRES

JUR# GCN, JCN, SCL, CAD  
5.0000 ACRES

SITUS: 4160 PRESTON RD N

\*-----\*  
| NO TAXES ARE DUE. |  
\*-----\*

JURIS = TAXING ENTITY CODES:  
01 COLLIN COUNTY 60 JR COLLEGE

THE 2005 TAXES: 2.78 PAID ON: 12/15/2005  
THE 2006 TAXES HAVE NOT BEEN CALCULATED.  
CURRENT TAX ROLL MARKET VALUE: 820

THIS IS TO CERTIFY THAT AFTER A CAREFUL CHECK OF THE TAX RECORDS,  
ALL TAXES DUE THE TAX ASSESSOR COLLECTOR OF COLLIN COUNTY ON THE  
ABOVE DESCRIBED PROPERTY HAVE BEEN PAID UP TO AND INCLUDING 2005  
WITH THE ABOVE LISTED EXCEPTIONS.

ISSUED TO - CITY OF DALLAS NA FIDO CODE - 333367

AUTHORIZED AGENT: L. MAUN TAX ASSESSOR COLLECTOR OF COLLIN COUNTY

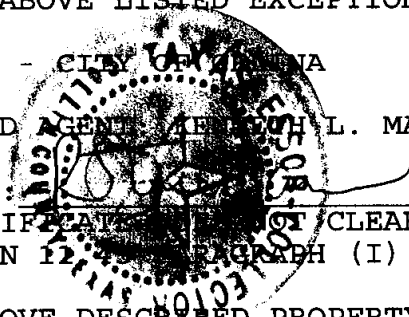
SIGNED BY:  DATE: 2/3/06  
THIS CERTIFICATE NOT CLEAR ABUSE OF GRANTED EXEMPTIONS AS DEFINED  
IN SECTION 12.40 PARAGRAPH (I) OF THE TEXAS PROPERTY TAX CODE.

IF THE ABOVE-DESCRIBED PROPERTY HAS RECEIVED SPECIAL VALUATION BASED ON  
THE USE VALUE, ADDITIONAL ROLLBACK TAXES MAY BECOME DUE BASED ON THE  
PROVISIONS OF THE SPECIAL VALUATION. SPTB RULE 155.40 (B) PARAGRAPH 6.

Filed and Recorded  
Official Public Records  
Brenda Taylor, County Clerk  
Collin County, TEXAS  
02/06/2006 01:22:13 PM  
\$21.00 PHORN  
20060206010000410

06-66



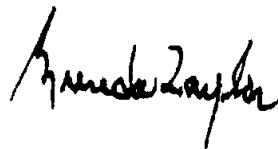



20060206010000410 02/06/2006 01:22:13 PM PL 1/1



ROS

MAUN  
TAX ASSESSOR COLLECTOR  
COLLIN COUNTY  
1800 N. GRAVES STREET STE 170  
P.O. BOX 8006  
MCKINNEY TEXAS 75070-8006  
972-547-5020  
METRO 972-424-1460 EXT. 5020

TAX CERTIFICATE

FEE 10.00

ACCOUNT: R-6653-000-0220-1

CERTIFICATE NUMBER: 18,992

OWNER NAME & ADDRESS  
TRI DAL REAL ESTATE LTD  
540 COMMERCE ST  
SOUTHLAKE TX 76092-9113

LEGAL DESCRIPTION  
ABSTRACT A0653 M. E. P. & P.  
RY. CO., TRACT 22, ACRF~  
3.965

JUR# GCN, JCN, SCL, CAD  
3.9650 ACRES

SITUS:

STATE HWY 289 N

\*-----\*  
| NO TAXES ARE DUE. |  
\*-----\*

JURIS = TAXING ENTITY CODES:

01 COLLIN COUNTY 60 JR COLLEGE

THE 2005 TAXES: 2.21 PAID ON: 12/19/2005  
THE 2006 TAXES HAVE NOT BEEN CALCULATED.  
CURRENT TAX ROLL MARKET VALUE: 650

THIS IS TO CERTIFY THAT AFTER A CAREFUL CHECK OF THE TAX RECORDS,  
ALL TAXES DUE THE TAX ASSESSOR COLLECTOR OF COLLIN COUNTY ON THE  
ABOVE DESCRIBED PROPERTY HAVE BEEN PAID UP TO AND INCLUDING 2005  
WITH THE ABOVE LISTED EXCEPTIONS.

ISSUED TO -

FIDO CODE - 333367

AUTHORIZED AGENT: L. MAUN TAX ASSESSOR COLLECTOR OF COLLIN COUNTY

SIGNED BY:

DATE: 2/3/06

THIS CERTIFICATE DOES NOT CLEAR ABUSE OF GRANTED EXEMPTIONS AS DEFINED  
IN SECTION 114.03 PARAGRAPH (I) OF THE TEXAS PROPERTY TAX CODE.

IF THE ABOVE-DESCRIBED PROPERTY HAS RECEIVED SPECIAL VALUATION BASED ON  
THE USE VALUE, ADDITIONAL ROLLBACK TAXES MAY BECOME DUE BASED ON THE  
PROVISIONS OF THE SPECIAL VALUATION. SPTB RULE 155.40 (B) PARAGRAPH 6.

Filed and Recorded  
Official Public Records  
Brenda Taylor, County Clerk  
Collin County, TEXAS  
02/06/2006 01:22:13 PM  
\$21.00 PHORN  
20060206010000410

06-66



*Brenda Taylor*

1/1  
02/06/2006 01:22:13 PM PL  
20060206010000410

## TAX CERTIFICATE

NO: 0000389

Collecting Office: Celina I.S.D.  
P. O. BOX 40  
Celina, Texas 75009



20060206010000410 02/06/2006 01:22:13 PM PL 1/1

Collecting Taxes For: Celina I.S.D.

PROPERTY OWNER  
TRI DAL REAL ESTATE LTD  
540 COMMERCE ST  
SOUTHLAKE, TX 76092-9113

PROPERTY DESCRIPTION  
STATE HWY 289 N 0000000  
ABSTRACT A0653 M. E. P. & P.  
RY. CO., TRACT 22, ACRES 3.965

ACRES: 3.9650

Property Account Number: 002564093

PIDN: R665300002201

-----  
This is to certify that after a careful check of the tax records of this office,  
the following delinquent taxes, penalties and interest are due on the described  
property for this taxing unit.

Year Delinquent	Taxing Unit	Other Type	Base Tax Due	Delinquent Taxes, Penalties & Interest
TOTAL DELINQUENT:				\$ 0.00

\* \* \* \* \* CURRENT YEAR TAXES \* \* \* \* \*

YEAR	ENTITY	TYPE	NET VALUE	BASE LEVY	AMOUNT PAID	AMOUNT DUE
2005	903		650	11.57	11.57	0.00
TOTAL DUE:						\$ 0.00

-----  
(if applicable) The above property has/is receiving special valuation based on  
its use, and additional rollback taxes may become due based on the provisions of  
the special valuation.  
-----

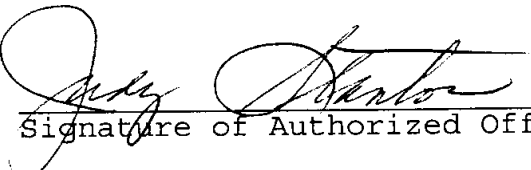
  
Signature of Authorized Officer

FEBRUARY 6, 2006  
Date of Tax Certificate

Filed and Recorded  
Official Public Records  
Brenda Taylor, County Clerk  
Collin County, TEXAS  
02/06/2006 01:22:13 PM  
\$21.00 PHORN  
20060206010000410

06-66



## TAX CERTIFICATE

NO: 0000388

Collecting Office: Celina I.S.D.  
P. O. BOX 40  
Celina, Texas 75009



20060206010000410

02/06/2006 01:22:13 PM PL 1/1

Collecting Taxes For: Celina I.S.D.

PROPERTY OWNER  
TRI DAL REAL ESTATE LTD  
540 COMMERCE ST  
SOUTHLAKE, TX 76092-9113

PROPERTY DESCRIPTION  
PRESTON RD N 0004160  
ABS A0653 M. E. P. & P. RY.  
CO., TRACT 11, 5.0 ACRES

ACRES: 5.0000

Property Account Number: 000996658

PIDN: R665300001101

This is to certify that after a careful check of the tax records of this office, the following delinquent taxes, penalties and interest are due on the described property for this taxing unit.

Year Delinquent	Taxing Unit	Other Type	Base Tax Due	Delinquent Taxes, Penalties & Interest
--------------------	----------------	---------------	--------------	---

TOTAL DELINQUENT: \$ 0.00

\* \* \* \* \* CURRENT YEAR TAXES \* \* \* \* \*

YEAR	ENTITY TYPE	NET VALUE	BASE LEVY	AMOUNT PAID	AMOUNT DUE
2005	903	820	14.60	14.60	0.00

TOTAL DUE: \$ 0.00

(if applicable) The above property has/is receiving special valuation based on its use, and additional rollback taxes may become due based on the provisions of the special valuation.

  
Signature of Authorized Officer

FEBRUARY 6, 2006  
Date of Tax Certificate

Filed and Recorded  
Official Public Records  
Brenda Taylor, County Clerk  
Collin County, TEXAS  
02/06/2006 01:22:13 PM  
\$21.00 PHORN  
20060206010000410

06-41-01

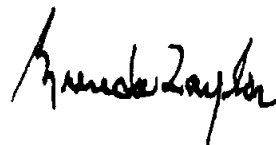



March 17, 2025

*Via FedEx and email* [REDACTED]

Ms. Megan Henson  
Executive Director  
MC 124 Municipal Solid Waste Permits Section  
Texas Commission on Environmental Quality  
PO Box 13087  
Austin TX 78711-3087

RE: Anticipated Owner/Operator Change – MSW Registration No. 40284

Ms. Hanson:

By way of this letter, Champion Waste & Recycling Services, LLC, (“Champion”), and CFG Realty, LLC (collectively, “Transferors”) and BFI Waste Services of Texas, LP (“BFI” or “Transferee”) (CN601527963), which is a subsidiary of Republic Services (“Republic”), provide documentation supporting the transfer of the Champion Construction Recycling Material Recovery Facility (the “Facility”) located at 4160 N Preston Road, Celina, Texas 75009 ((RN105240196) to BFI. The Facility is a Type V Municipal Solid Waste Transfer Station/Material Recovery Facility with MSW Registration No. 40284 (the “MSW Registration”).

Transferors and Transferee entered into an agreement to transfer the property and Facility on January 10, 2025 (the “Purchase Agreement”). The anticipated date of this transfer is March 31, 2025 (“Closing Date”). A Bill of Sale, which is to be executed on the Closing Date, is enclosed.

There have been no changes in the boundary lines of the property or any new easements recorded against the property since the MSW Registration was issued on June 8, 2016. Mineral interest ownership under the facility is also unchanged since the MSW Registration was issued. Additionally, there have been no operational or site development changes since issuance of the MSW Registration, and none are anticipated as a result of the Transaction. Financial assurance shall be maintained in accordance with 30 TAC Chapter 330 Subchapter L and 30 TAC Chapter 37.

The name of the Facility will become “Celina Recycle Center.”

- Registrant: BFI Waste Services of Texas, LP
- Facility Name: Celina Recycle Center
- Facility Address: 4160 N Preston Road, Celina, Texas 75009

For questions, please contact Scott Trebus, Area Environmental Manager, BFI Waste Services of Texas, LP by telephone at (281) 222-8251 or email at [REDACTED]

TRANSFERORS

Champion Waste & Recycling Services, LLC,  
a Texas limited liability company

By: \_\_\_\_\_

Name: Michelle Kuhar

Title: President

CFG Realty, LLC,  
a Texas limited liability company

By: \_\_\_\_\_

Name: Michelle Kuhar

Title: President

TRANSFeree

BFI Waste Services of Texas, LP  
a Delaware limited partnership

By: 

Name: Brady Loesch

Title: Area President

STATE OF Texas

:

COUNTY OF Harris

:SS

:

On this, the 17<sup>th</sup> day of March, 2025, before me, Brady Loesch, the undersigned officer, personally appeared Brady Loesch, known to me or satisfactorily proven to be the person whose name is subscribed to the within letter, and acknowledged that he executed the same for the purposes therein contained.

In witness whereof, I hereunto set my hand and official seal.

Lauri A. Tarango  
Notary Public



*Acknowledgment*

For questions, please contact Scott Trebus, Area Environmental Manager, BFI Waste Services of Texas, LP by telephone at (281) 222-8251 or email at [REDACTED]

TRANSFERORS

Champion Waste & Recycling Services, LLC,  
a Texas limited liability company

By: \_\_\_\_\_

eSigned by Black Knight EXP-DocVerify: 2025-03-17 13:58:50 EDT  
*Michelle Kuhar*  
5161601.29271641.36864420

Name: Michelle Kuhar

Title: President

CFG Realty, LLC,  
a Texas limited liability company

By: \_\_\_\_\_

eSigned by Black Knight EXP-DocVerify: 2025-03-17 13:58:57 EDT  
*Michelle Kuhar*  
5161601.29271641.36864421

Name: Michelle Kuhar

Title: President

TRANSFeree

BFI Waste Services of Texas, LP  
a Delaware limited partnership

By: \_\_\_\_\_

Name: Brady Loesch

Title: Area President

COMMONWEALTH OF PENNSYLVANIA :  
:SS  
COUNTY OF PHILADELPHIA :

On this, the 17<sup>th</sup> day of March, 2025, before me, Lisa Whiteley, the undersigned officer,  
personally appeared Michelle Kuhar, known to me or satisfactorily proven to be the person  
whose name is subscribed to the within letter, and acknowledged that she executed the same for  
the purposes therein contained.

In witness whereof, I hereunto set my hand and official seal.

eSigned by Black Knight EXP-DocVerify: 2025-03-17 13:59:22 EDT  
5161601.29271641.189636

---

Notary Public

Commonwealth of Pennsylvania - Notary Seal  
LISA WHITELEY, Notary Public  
Philadelphia County  
My commission expires Nov 15, 2027  
Commission number 1178196

Notarial Act Performed by Audio visual communication

*Acknowledgment*



## GENERAL CONVEYANCE, ASSIGNMENT AND BILL OF SALE

Effective as of \_\_\_\_\_, 2025, Champion Waste & Recycling Services, LLC, a Texas limited liability company, Deyulio Industries, LLC, a Texas limited liability company, and CFG Realty, LLC, a Texas limited liability company (collectively, "Grantors"), for good and valuable consideration and pursuant to that certain Asset Purchase Agreement, dated as of January 10, 2025 (the "Purchase Agreement"), among Grantors, CWSL Holdings, Inc., a Delaware corporation, Michelle G. Kuhar Irrevocable 2021 Trust, Frank P. Giannattasio, Jr., Michelle G. Kuhar, Paul E. Kuhar, Jr., and Carol A. Giannattasio, the sole owners of Grantors, and BFI Waste Services of Texas, LP, a Delaware limited partnership ("Grantee"), hereby sell, assign, transfer, convey and deliver to Grantee all of Grantors' right, title and interest in all of the Assets, except for the Excluded Assets and the Assets transferred by that certain General Conveyance, Assignment and Bill of Sale (RWS Texas Leasing Company, LLC, as Grantee), of even date herewith.

TO HAVE AND TO HOLD all such Assets unto Grantee and its successors and assigns to and for its or their use forever.

This General Conveyance, Assignment and Bill of Sale is delivered pursuant to Section 4.2.1 of the Purchase Agreement and shall be construed consistently with the Purchase Agreement. Capitalized terms used in this instrument shall have the meanings given them in the Purchase Agreement.

*[Signature Page Follows]*

**IN WITNESS WHEREOF**, Grantors have executed and delivered this General Conveyance, Assignment and Bill of Sale effective as of the date first above written.

**GRANTORS:**

Champion Waste & Recycling Services, LLC,  
a Texas limited liability company

By: \_\_\_\_\_  
Name: \_\_\_\_\_  
Title: \_\_\_\_\_

Deyulio Industries, LLC,  
a Texas limited liability company

By: \_\_\_\_\_  
Name: \_\_\_\_\_  
Title: \_\_\_\_\_

CFG Realty, LLC,  
a Texas limited liability company

By: \_\_\_\_\_  
Name: \_\_\_\_\_  
Title: \_\_\_\_\_

*[Signature Page to General Conveyance, Assignment, and Bill of Sale (Assets)]*

## PAYMENT BOND

Date bond executed: March 17, 2025

Effective Date: March 31, 2025.

Principal: BFI Waste Services of Texas, LP, 4160 N Preston Road, Celina, TX 75009

Type of Organization: Limited Partnership.

State of Incorporation: Delaware.

Surety(ies): Liberty Mutual Insurance Company, 175 Berkeley St, Boston, MA 02116.

Permit number, name, physical and mailing addresses, and closure, post closure, or corrective action amount(s) for each facility guaranteed by this bond (indicate closure, post closure, or corrective action amounts separately for each facility):

Permit Number: MSW - Registration No. 40284

Name: Celina Recycle Center

Physical Address: 4160 N Preston Road, Celina, TX 75009

Mailing Address: 4160 N Preston Road, Celina, TX 75009

\$ 61,069.00 for closure

\$ \_\_\_\_\_ for post closure

\$ \_\_\_\_\_ for corrective action

Total penal sum of bond: \$61,069.00 (Sixty One Thousand Sixty Nine and 00/100 Dollars)

Surety's bond number: 016244663.

Know All Persons By These Presents, That we, the Principal and Surety(ies) hereto are firmly bound to the Texas Commission on Environmental Quality, hereinafter called TCEQ, in the above penal sum for the payment of which we bind ourselves, our heirs, executors, administrators, successors, and assigns jointly and severally; provided that, where the Surety(ies) are corporations acting as co-sureties, we, the Sureties, bind ourselves in such sum "jointly and severally" only for the purpose of allowing a joint action or actions against any or all of us, and for all other purposes each Surety binds itself, jointly and severally with the Principal, for the payment of such sum only as is set forth opposite the name of such Surety, but if no limit of liability is indicated, the limit of liability shall be the full amount of the penal sum.

Whereas said Principal is required, under the appropriate program area, to comply with permit requirements in order to own or operate each facility identified above, and

Whereas said Principal is required to provide financial assurance for closure, post closure, or corrective action as a condition of the permit or other applicable requirements, and

Whereas said Principal shall establish a standby trust fund as is required when a surety bond is used to provide such financial assurance;

Now, therefore, the conditions of the obligation are such that if the Principal shall faithfully, before the beginning of final closure of, or corrective action at, each facility identified above, fund into the standby trust fund the amount(s) identified above for the facility,

Or, if the Principal shall fund into the standby trust fund in such amount(s) within 15 days after a final order to begin final closure or perform corrective action is issued by the TCEQ executive director or a U.S. district court or other court of competent jurisdiction,

Or, if the Principal shall provide alternate financial assurance, as specified in 30 Texas Administrative Code, Chapter 37 (relating to Financial Assurance) and obtain the TCEQ executive director's written approval of such assurance, within 90 days after the date notice of cancellation is received by both the Principal and the TCEQ executive director from the Surety(ies), then this obligation shall be null and void; otherwise it is to remain in full force and effect.

The Surety(ies) shall become liable on this bond obligation only when the Principal has failed to fulfill the conditions described above. Upon notification by the TCEQ executive director that the Principal has failed to perform as guaranteed by this bond, the Surety(ies) shall place funds in the amount guaranteed for the facility(ies) into the standby trust fund as directed by the TCEQ executive director.

The liability of the Surety(ies) shall not be discharged by any payment or succession of payments hereunder, unless and until such payment or payments shall amount in the aggregate to the penal sum of the bond, but in no event shall the obligation of the Surety(ies) hereunder exceed the amount of said penal sum.

The Surety(ies) may cancel the bond by sending notice of cancellation by certified mail to the Principal and to the TCEQ executive director provided, however, that cancellation shall not occur during the 120 days beginning on the date of receipt of the notice of cancellation by both the Principal and the TCEQ executive director, as evidenced by the return receipts.

The Principal may terminate this bond by sending written notice to the Surety(ies), provided, however, that no such notice shall become effective until the Surety(ies)

receive(s) written authorization for termination of the bond by the TCEQ executive director.

In Witness Whereof, the Principal and Surety(ies) have executed this Payment Bond and have affixed their seals on the date set forth above.

The persons whose signatures appear below hereby certify that they are authorized to execute this surety bond on behalf of the Principal and Surety(ies) and that the wording of this surety bond is identical to the wording specified in 30 Texas Administrative Code §37.311 as such regulations were constituted on the date this bond was executed.

BFI Waste Services of Texas, LP                      Principal

  
\_\_\_\_\_

(Signature(s))

\_\_\_\_\_  
Kathleen M. Mitchell

(Name(s))

\_\_\_\_\_  
Attorney-in-Fact

(Title(s))

(Corporate seal)

Corporate Surety(ies)

Liberty Mutual Insurance Company, 175 Berkeley St., Boston, MA 02116

State of Incorporation: MA

Liability limit: \$61,069.00

  
\_\_\_\_\_

(Signature(s))

\_\_\_\_\_  
Amber Engel, Attorney-in-Fact

(Name(s) and title(s))

(Corporate Seal)

(For every co-surety, provide signature(s), corporate seal, and other information in the same manner as for Surety above.)

Bond premium: \$180.00





## POWER OF ATTORNEY

REPUBLIC SERVICES, INC., a Delaware corporation having its principal place of business at 18500 N. Allied Way, Phoenix, Arizona 85054, hereby makes, constitutes and appoints KIBBLE & PRENTICE HOLDING COMPANY dba USI INSURANCE SERVICES NORTHWEST, acting through and by any one of Debbie Lindstrom, Kathleen M. Mitchell, Scott C. Alderman, Amber Engel, Jamie Armfield, Holly E. Ulfers, Tatiana Geffer, Laura Kovarik or Roxana Palacios, its true and lawful attorney to sign and seal any and all surety bonds, bid bonds, performance bonds and payment bonds at or below the monetary threshold of Five Million Dollars (\$5,000,000.00) on behalf of REPUBLIC SERVICES, INC. and its subsidiaries, relating to the provision of solid waste collection, transportation, transfer, recycling, disposal and/or energy services by REPUBLIC SERVICES, INC. and its subsidiaries and affix its corporate seal to and deliver for and on behalf as surety thereon or otherwise, bonds of any of the following classes, to wit:

1. Surety bonds, bid bonds, performance bonds and payment bonds to the United States of America or agency thereof, including those required or permitted under the laws or regulations relating to Customs or Internal Revenue; license and permit bonds or other indemnity bonds under the laws, ordinances or regulations of any state, city, town, village, board, other body organization, public or private; bonds to transportation companies; lost instrument bonds; lease bonds; worker's compensation bonds; miscellaneous surety bonds; and bonds on behalf of notaries public, sheriffs, deputy sheriffs and similar public officials.

2. Surety bonds, bid bonds, performance bonds and payment bonds on behalf of REPUBLIC SERVICES, INC. and its subsidiaries in connection with bids, proposals or contracts.

REPUBLIC SERVICES, INC. hereby agrees to ratify and confirm whatsoever KIBBLE & PRENTICE HOLDING COMPANY dba USI INSURANCE SERVICES NORTHWEST shall lawfully do pursuant to this power of attorney, and until notice or revocation has been given by REPUBLIC SERVICES, INC., the acts of said attorney shall be binding on the undersigned.

IN WITNESS WHEREOF, this Power of Attorney has been signed this 5<sup>th</sup> day of February, 2025 on behalf of REPUBLIC SERVICES, INC. by its Assistant Secretary, Adrienne W. Wilhoit.

REPUBLIC SERVICES, INC.,  
a Delaware corporation

  
Adrienne W. Wilhoit

STATE OF ARIZONA

COUNTY OF MARICOPA

Subscribed and sworn to before me this 5<sup>th</sup> day of February, 2025 by Kiara Gonzalez, Notary Public.

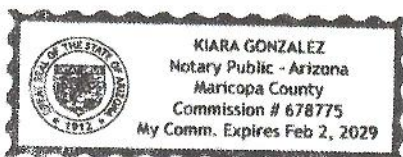

  
Notary Public

### CERTIFICATE

I, the undersigned, John B. Nickerson, Assistant Secretary of Republic Services, Inc., a Delaware corporation, do hereby certify that the foregoing Power of Attorney is true, correct, remains in full force and effect, and has not been revoked.

IN WITNESS WHEREOF, this Certification has been signed this 17<sup>th</sup> day of March, 2025 on behalf of REPUBLIC SERVICES, INC. by its Assistant Secretary, John B. Nickerson.

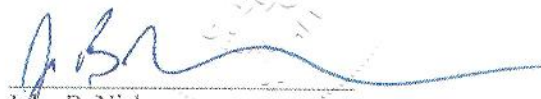
  
John B. Nickerson





## POWER OF ATTORNEY

Liberty Mutual Insurance Company  
The Ohio Casualty Insurance Company  
West American Insurance Company

**KNOWN ALL PERSONS BY THESE PRESENTS:** That The Ohio Casualty Insurance Company is a corporation duly organized under the laws of the State of New Hampshire, that Liberty Mutual Insurance Company is a corporation duly organized under the laws of the State of Massachusetts, and West American Insurance Company is a corporation duly organized under the laws of the State of Indiana (herein collectively called the "Companies"), pursuant to and by authority herein set forth, does hereby name, constitute and appoint Amber Engel all of the city of Seattle state of WA its true and lawful attorney-in-fact, with full power and authority hereby conferred to sign, execute and acknowledge the following surety bonds, undertakings, recognizances, contracts of indemnity, and all other surety obligations related thereto, the execution of which shall be binding upon the Companies as if it had been duly signed and executed by its own officers:

Principal Name: BFI Waste Services of Texas, LP

Obligee Name: Texas Commission of Environmental Quality

Surety Bond Number: 016244663

Bond Amount: See Bond Form

IN WITNESS WHEREOF, this Power of Attorney has been subscribed by an authorized officer or official of the Companies and the corporate seals of the Companies have been affixed thereto this 17th day of March 2025



Liberty Mutual Insurance Company  
The Ohio Casualty Insurance Company  
West American Insurance Company

By: Nathan J. Zangerle  
Nathan J. Zangerle, Assistant Secretary

STATE OF PENNSYLVANIA ss  
COUNTY OF MONTGOMERY

On this 17th day of March 2025, before me personally appeared Nathan J. Zangerle, who acknowledged himself to be the Assistant Secretary of Liberty Mutual Insurance Company, The Ohio Casualty Company, and West American Insurance Company, and that he, as such, being authorized so to do, execute the foregoing instrument for the purposes therein contained by signing on behalf of the corporations by himself as a duly authorized officer.

IN WITNESS WHEREOF, I have hereunto subscribed my name and affixed my notarial seal at Plymouth Meeting, Pennsylvania, on the day and year first above written.



Commonwealth of Pennsylvania - Notary Seal  
Teresa Pastella, Notary Public  
Montgomery County  
My commission expires March 28, 2029  
Commission number 1126044  
Member, Pennsylvania Association of Notaries

By: Teresa Pastella  
Teresa Pastella, Notary Public

This Power of Attorney is made and executed pursuant to and by authority of the following By-laws and Authorizations of The Ohio Casualty Insurance Company, Liberty Mutual Insurance Company, and West American Insurance Company which resolutions are now in full force and effect reading as follows:

#### ARTICLE IV - OFFICERS: Section 12. Power of Attorney.

Any officer or other official of the Corporation authorized for that purpose in writing by the Chairman or the President, and subject to such limitation as the Chairman or the President may prescribe, shall appoint such attorneys-in-fact, as may be necessary to act in behalf of the Corporation to make, execute, seal, acknowledge and deliver as surety any and all undertakings, bonds, recognizances and other surety obligations. Such attorneys-in-fact, subject to the limitations set forth in their respective powers of attorney, shall have full power to bind the Corporation by their signature and execution of any such instruments and to attach thereto the seal of the Corporation. When so executed, such instruments shall be as binding as if signed by the President and attested to by the Secretary. Any power or authority granted to any representative or attorney-in-fact under the provisions of this article may be revoked at any time by the Board, the Chairman, the President or by the officer or officers granting such power or authority.

#### ARTICLE XIII - Execution of Contracts: Section 5. Surety Bonds and Undertakings.

Any officer of the Company authorized for that purpose in writing by the chairman or the president, and subject to such limitations as the chairman or the president may prescribe, shall appoint such attorneys-in-fact, as may be necessary to act in behalf of the Company to make, execute, seal, acknowledge and deliver as surety any and all undertakings, bonds, recognizances and other surety obligations. Such attorneys-in-fact, subject to the limitations set forth in their respective powers of attorney, shall have full power to bind the Company by their signature and execution of any such instruments and to attach thereto the seal of the Company. When so executed such instruments shall be as binding as if signed by the president and attested by the secretary.

**Certificate of Designation** - The President of the Company, acting pursuant to the Bylaws of the Company, authorizes Nathan J. Zangerle, Assistant Secretary to appoint such attorneys-in-fact as may be necessary to act on behalf of the Company to make, execute, seal, acknowledge and deliver as surety any and all undertakings, bonds, recognizances and other surety obligations.

**Authorization** - By unanimous consent of the Company's Board of Directors, the Company consents that facsimile or mechanically reproduced signature of any assistant secretary of the Company, wherever appearing upon a certified copy of any power of attorney issued by the Company in connection with surety bonds, shall be valid and binding upon the Company with the same force and effect as though manually affixed.

I, Renee C. Llewellyn, the undersigned, Assistant Secretary, of Liberty Mutual Insurance Company, The Ohio Casualty Insurance Company, and West American Insurance Company do hereby certify that this power of attorney executed by said Companies is in full force and effect and has not been revoked.

IN TESTIMONY WHEREOF, I have hereunto set my hand and affixed the seals of said Companies this 17th day of March 2025



By: Renee C. Llewellyn  
Renee C. Llewellyn, Assistant Secretary





USI Insurance Services  
601 Union Street  
Suite 1000  
Seattle, WA 98101  
www.usi.com  
Tel: 206.441.6300

[March 17, 2025]

Texas Commission on Environmental Quality  
Financial Assurance Unit  
MC-184 Attn: John Martinez  
1200 Park 35 Circle, Bldg. A  
Austin, TX 78753

RE: Financial Assurance in Support of Anticipated Owner/Operator Change –  
MSW Registration No. 40284

Mr. Martinez:

BFI Waste Services of Texas, LP (“BFI”) (CN601527963) has entered into an agreement (the “Agreement”) to purchase certain assets and real property from CFG Realty, LLC (“CFG” or “Landowner”) and Champion Waste & Recycling Services, LLC (“Champion” or “Operator”). Champion operates the Champion Construction Recycling Material Recovery Facility (the “Facility”) located at 4160 N Preston Road, Celina, Texas 75009 ((RN105240196). The Facility is a Type V Municipal Solid Waste Transfer Station/Material Recovery Facility with MSW Registration No. 40284 (the “MSW Registration”).

As part of the agreement between BFI, CFG, and Champion, CFG and Champion will transfer ownership and operation of the Facility to BFI (the “Transaction”). The anticipated date of this transfer is March 31, 2025. The enclosed bond in the amount of \$61,069.00 is issued to BFI and provided to satisfy the financial assurance requirements under 30 TAC Chapter 330 Subchapter L and 30 TAC Chapter 37.

BFI affirms that the existing financial instrument will remain in place until the new instrument has been established. Additionally, there have been no operational or site development changes since the initial date of issuance. No operational changes affecting the MSW Registration are proposed at this time, and none are anticipated as a result of the Transaction. The name of the Facility will become “Celina Recycle Center.”

- Registrant: BFI Waste Services of Texas, LP
- Facility Name: Celina Recycle Center
- Facility Address: 4160 N Preston Road, Celina, Texas 75009

Please write with any questions.

Best regards,

  
Amber Engel  
Account Manager - Surety  
(main) 206-441-6300 | (direct) 206-695-3102

ORIGIN ID:BEA (854) 529-1602

SHIP DATE: 17MAR25

AMBER ENGEL  
UST INSURANCE SERVICES  
601 UNION ST. SUITE 1000  
SEATTLE, WA 98101  
UNITED STATES US

ACTWG1: 1.00 LB  
CAD: 1124472/NET4535  
BILL SENDER

TO JOHN MARTINEZ  
TX COMMISSION ON ENVIRONMENTAL QUAL  
1200 PARK 35 CIRCLE  
BLDG. A  
FINANCIAL ASSURANCE UNIT, MC-184  
AUSTIN TX 78753

REF: (206) 695-3102  
INV: PO: DEPT:

58CJ3/5027/C6C4

  
J251024121701uv

  
TK# 7727 8216 9150  
TUE - 18 MAR 10:30A  
PRIORITY OVERNIGHT  
XA MMRA 78753  
TX-US AUS



After printing this label:  
**CONSIGNEE COPY - PLEASE PLACE IN FRONT OF POUCH**  
1. Fold the printed page along the horizontal line.  
2. Place label in shipping pouch and affix it to your shipment.

Use of this system constitutes your agreement to the service conditions in the current FedEx Service Guide, available on [fedex.com](http://fedex.com). FedEx will not be responsible for any claim in excess of \$100 per package, whether the result of loss, damage, delay, non-delivery, misdelivery, or misinformation, unless you declare a higher value, pay an additional charge, document your actual loss and file a timely claim. Limitations found in the current FedEx Service Guide apply. Your right to recover from FedEx for any loss, including intrinsic value of the package, loss of sales, income interest, profit, attorney's fees, costs, and other forms of damage whether direct, incidental, consequential, or special is limited to the greater of \$100 or the authorized declared value. Recovery cannot exceed actual documented loss. Maximum for items of extraordinary value is \$1,000, e.g. jewelry, precious metals, negotiable instruments and other items listed in our Service Guide. Written claims must be filed within strict time limits, see current FedEx Service Guide.