



# Texas Commission on Environmental Quality Waste Permits Division Correspondence Cover Sheet

Date: 08/19/2025

Facility Name: City of McCamey Landfill

Permit or Registration No.: 566

Nature of Correspondence:

Initial/New

Response/Revision to TCEQ Tracking No.:  
32617839 (from subject line of TCEQ letter regarding initial submission)

Affix this cover sheet to the front of your submission to the Waste Permits Division. Check appropriate box for type of correspondence. Contact WPD at (512) 239-2335 if you have questions regarding this form.

**Table 1 - Municipal Solid Waste Correspondence**

Applications	Reports and Notifications
<input type="checkbox"/> New Notice of Intent	<input type="checkbox"/> Alternative Daily Cover Report
<input type="checkbox"/> Notice of Intent Revision	<input type="checkbox"/> Closure Report
<input type="checkbox"/> New Permit (including Subchapter T)	<input type="checkbox"/> Compost Report
<input type="checkbox"/> New Registration (including Subchapter T)	<input type="checkbox"/> Groundwater Alternate Source Demonstration
<input type="checkbox"/> Major Amendment	<input type="checkbox"/> Groundwater Corrective Action
<input type="checkbox"/> Minor Amendment	<input type="checkbox"/> Groundwater Monitoring Report
<input checked="" type="checkbox"/> Limited Scope Major Amendment	<input type="checkbox"/> Groundwater Background Evaluation
<input type="checkbox"/> Notice Modification	<input type="checkbox"/> Landfill Gas Corrective Action
<input type="checkbox"/> Non-Notice Modification	<input type="checkbox"/> Landfill Gas Monitoring
<input type="checkbox"/> Transfer/Name Change Modification	<input type="checkbox"/> Liner Evaluation Report
<input type="checkbox"/> Temporary Authorization	<input type="checkbox"/> Soil Boring Plan
<input type="checkbox"/> Voluntary Revocation	<input type="checkbox"/> Special Waste Request
<input type="checkbox"/> Subchapter T Disturbance Non-Enclosed Structure	<input type="checkbox"/> Other:
<input type="checkbox"/> Other:	

**Table 2 - Industrial & Hazardous Waste Correspondence**

Applications	Reports and Responses
<input type="checkbox"/> New	<input type="checkbox"/> Annual/Biennial Site Activity Report
<input type="checkbox"/> Renewal	<input type="checkbox"/> CPT Plan/Result
<input type="checkbox"/> Post-Closure Order	<input type="checkbox"/> Closure Certification/Report
<input type="checkbox"/> Major Amendment	<input type="checkbox"/> Construction Certification/Report
<input type="checkbox"/> Minor Amendment	<input type="checkbox"/> CPT Plan/Result
<input type="checkbox"/> CCR Registration	<input type="checkbox"/> Extension Request
<input type="checkbox"/> CCR Registration Major Amendment	<input type="checkbox"/> Groundwater Monitoring Report
<input type="checkbox"/> CCR Registration Minor Amendment	<input type="checkbox"/> Interim Status Change
<input type="checkbox"/> Class 3 Modification	<input type="checkbox"/> Interim Status Closure Plan
<input type="checkbox"/> Class 2 Modification	<input type="checkbox"/> Soil Core Monitoring Report
<input type="checkbox"/> Class 1 ED Modification	<input type="checkbox"/> Treatability Study
<input type="checkbox"/> Class 1 Modification	<input type="checkbox"/> Trial Burn Plan/Result
<input type="checkbox"/> Endorsement	<input type="checkbox"/> Unsaturated Zone Monitoring Report
<input type="checkbox"/> Temporary Authorization	<input type="checkbox"/> Waste Minimization Report
<input type="checkbox"/> Voluntary Revocation	<input type="checkbox"/> Other:
<input type="checkbox"/> 335.6 Notification	
<input type="checkbox"/> Other:	



TCEQ Use Only

# TCEQ Core Data Form

For detailed instructions on completing this form, please read the Core Data Form Instructions or call 512-239-5175.

## SECTION I: General Information

1. Reason for Submission (If other is checked please describe in space provided.)		
<input type="checkbox"/> New Permit, Registration or Authorization (Core Data Form should be submitted with the program application.)		
<input type="checkbox"/> Renewal (Core Data Form should be submitted with the renewal form)	<input checked="" type="checkbox"/> Other Change of public hours	
2. Customer Reference Number (if issued)	Follow this link to search for CN or RN numbers in Central Registry**	3. Regulated Entity Reference Number (if issued)
CN 600669535		RN 102696051

## SECTION II: Customer Information

4. General Customer Information		5. Effective Date for Customer Information Updates (mm/dd/yyyy)		7/1/2023	
<input type="checkbox"/> New Customer		<input checked="" type="checkbox"/> Update to Customer Information		<input type="checkbox"/> Change in Regulated Entity Ownership	
<input type="checkbox"/> Change in Legal Name (Verifiable with the Texas Secretary of State or Texas Comptroller of Public Accounts)					
The Customer Name submitted here may be updated automatically based on what is current and active with the Texas Secretary of State (SOS) or Texas Comptroller of Public Accounts (CPA).					
6. Customer Legal Name (If an individual, print last name first: eg: Doe, John)			If new Customer, enter previous Customer below:		
City of McCamey					
7. TX SOS/CPA Filing Number		8. TX State Tax ID (11 digits)		9. Federal Tax ID (9 digits)	10. DUNS Number (if applicable)
				75-6000597	607348620
11. Type of Customer:		<input type="checkbox"/> Corporation		<input type="checkbox"/> Individual	
Government: <input checked="" type="checkbox"/> City <input checked="" type="checkbox"/> County <input type="checkbox"/> Federal <input type="checkbox"/> Local <input type="checkbox"/> State <input type="checkbox"/> Other		<input type="checkbox"/> Sole Proprietorship		Partnership: <input type="checkbox"/> General <input type="checkbox"/> Limited	
12. Number of Employees			13. Independently Owned and Operated?		
<input checked="" type="checkbox"/> 0-20 <input type="checkbox"/> 21-100 <input type="checkbox"/> 101-250 <input type="checkbox"/> 251-500 <input type="checkbox"/> 501 and higher			<input type="checkbox"/> Yes <input checked="" type="checkbox"/> No		
14. Customer Role (Proposed or Actual) – as it relates to the Regulated Entity listed on this form. Please check one of the following					
<input type="checkbox"/> Owner		<input type="checkbox"/> Operator		<input checked="" type="checkbox"/> Owner & Operator	
<input type="checkbox"/> Occupational Licensee		<input type="checkbox"/> Responsible Party		<input type="checkbox"/> VCP/BSA Applicant	
<input type="checkbox"/> Other:					
15. Mailing Address: PO Box 1409					
City	McCamey		State	TX	ZIP
					79752
				ZIP + 4	
16. Country Mailing Information (if outside USA)			17. E-Mail Address (if applicable)		
			[REDACTED]		
18. Telephone Number		19. Extension or Code		20. Fax Number (if applicable)	
( 432 ) 652-3333				( )	

## SECTION III: Regulated Entity Information

21. General Regulated Entity Information (If 'New Regulated Entity' is selected, a new permit application is also required.)	
<input type="checkbox"/> New Regulated Entity <input type="checkbox"/> Update to Regulated Entity Name <input checked="" type="checkbox"/> Update to Regulated Entity Information	
The Regulated Entity Name submitted may be updated, in order to meet TCEQ Core Data Standards (removal of organizational endings such as Inc, LP, or LLC).	
22. Regulated Entity Name (Enter name of the site where the regulated action is taking place.)	
City of McCamey Landfill	

Rev date 4/8/2024

23. Street Address of the Regulated Entity: <i>(No PO Boxes)</i>							
	City		State		ZIP		ZIP + 4
24. County	Upton						

If no Street Address is provided, fields 25-28 are required.

25. Description to Physical Location:	1.25 Miles SE of FM 30S and FM 1901 Intersection - 1000 feet E of FM 30S							
26. Nearest City			State		Nearest ZIP Code			
McCamey			TX		7752			
Latitude/Longitude are required and may be added/updated to meet TCEQ Core Data Standards. (Geocoding of the Physical Address may be used to supply coordinates where none have been provided or to gain accuracy).								
27. Latitude (N) In Decimal:		31.10778194 N		28. Longitude (W) In Decimal:		-102.20097897 W		
Degrees	Minutes	Seconds	Degrees	Minutes	Seconds			
29. Primary SIC Code (4 digits)		30. Secondary SIC Code (4 digits)		31. Primary NAICS Code (5 or 6 digits)		32. Secondary NAICS Code (5 or 6 digits)		
9511				562212				
33. What is the Primary Business of this entity? (Do not repeat the SIC or NAICS description.)								
Accept solid waste from residents.								
34. Mailing Address:		PO Box 1409						
		City	McCamey	State	TX	ZIP	79752	ZIP + 4
35. E-Mail Address:		patty@mccameycity.com						
36. Telephone Number			37. Extension or Code		38. Fax Number (if applicable)			
(432) 652-3333					( ) -			

39. TCEQ Programs and ID Numbers Check all Programs and write in the permits/registration numbers that will be affected by the updates submitted on this form. See the Core Data Form Instructions for additional guidance.

<input type="checkbox"/> Dam Safety	<input type="checkbox"/> Districts	<input type="checkbox"/> Edwards Aquifer	<input type="checkbox"/> Emissions Inventory Air	<input type="checkbox"/> Industrial Hazardous Waste
<input checked="" type="checkbox"/> Municipal Solid Waste	<input type="checkbox"/> New Source Review Air	<input type="checkbox"/> OSSF	<input type="checkbox"/> Petroleum Storage Tank	<input type="checkbox"/> PWS
<input type="checkbox"/> Sludge	<input type="checkbox"/> Storm Water	<input type="checkbox"/> Title V Air	<input type="checkbox"/> Tires	<input type="checkbox"/> Used Oil
<input type="checkbox"/> Voluntary Cleanup	<input type="checkbox"/> Wastewater	<input type="checkbox"/> Wastewater Agriculture	<input type="checkbox"/> Water Rights	<input type="checkbox"/> Other:

### SECTION IV: Preparer Information

40. Name:	Patty Jones		41. Title:	City Secretary	
42. Telephone Number	43. Ext./Code	44. Fax Number	45. E-Mail Address		
(432) 652-3333		( ) -	[REDACTED]		

### SECTION V: Authorized Signature

46. By my signature below, I certify, to the best of my knowledge, that the information provided in this form is true and complete, and that I have signature authority to submit this form on behalf of the entity specified in Section II, Field 6 and/or as required for the updates to the ID numbers identified in field 39.

Company:	City of McCamey		Job Title:	City Secretary	
Name (In Print):	Patty Jones		Phone:	(432) 652-3333	
Signature:			Date:	4/8/2026	

Reupdate 4/8/2026



**Texas Commission on Environmental Quality**  
**Part I Application Form for New Permit, Permit**  
**Amendment, or Registration for a**  
**Municipal Solid Waste Facility**

Instructions for completing this Part I Application Form are provided in TCEQ 00650-Instr<sup>1</sup>. Include a Core Data Form (TCEQ 10400)<sup>2</sup> with the application for the facility owner, and Core Data Forms for the operator and property owner if different from the facility owner. If you have questions, contact the Municipal Solid Waste (MSW) Permits Section by email to [mswiper@tceq.texas.gov](mailto:mswiper@tceq.texas.gov), or by phone at 512-239-2335. Rules cited on this form are in Title 30 Texas Administrative Code (30 TAC) and may be viewed online at [www.tceq.texas.gov/goto/view-30tac](http://www.tceq.texas.gov/goto/view-30tac).

**Application Tracking Information**

Facility Regulated Entity Name<sup>3</sup>:  
 City of McCamey Landvill

Site Operator (Permittee or Registrant Name)<sup>4</sup>:  
 City of McCamey

MSW Authorization Number: 566

Initial Submission Date: 2/17/2020

Revision Date: 4/8/2020

**Application Data**

<b>1. Submission Type</b>	
<input type="checkbox"/> Initial Submission	<input checked="" type="checkbox"/> Notice of Deficiency (NOD) Response

<b>2. Authorization Type</b>	
<input checked="" type="checkbox"/> Permit	<input type="checkbox"/> Registration

<b>3. Application Type</b>	
<input type="checkbox"/> New Permit	
<input type="checkbox"/> Permit Major Amendment	<input checked="" type="checkbox"/> Permit Limited Scope Major Amendment
<input type="checkbox"/> New Registration	

<sup>1</sup> [www.tceq.texas.gov/downloads/permitting/waste-permits/msw/forms/00650-Instr.pdf](http://www.tceq.texas.gov/downloads/permitting/waste-permits/msw/forms/00650-Instr.pdf)

<sup>2</sup> [www.tceq.texas.gov/goto/coredata](http://www.tceq.texas.gov/goto/coredata)

<sup>3</sup> Facility Regulated Entity Name must match the Regulated Entity Name indicated on the TCEQ Core Data Form.

<sup>4</sup> Site Operator is defined in 30 TAC 330.3(148) as the holder of, or the applicant for, an authorization (or license) for a municipal solid waste facility.

<b>4. Application Fee</b>
<b>Amount</b>
<input type="checkbox"/> \$2,050—New Landfill Permits, and Landfill Permit Major Amendments Described in 30 TAC 305.62(j)(1)
<input checked="" type="checkbox"/> \$150—Other Permits, Permit Amendments, Limited Scope Major Amendments, and all Registrations
<b>Payment Method</b>
<input type="checkbox"/> Online through ePay portal <a href="http://www3.tceq.texas.gov/epay/">www3.tceq.texas.gov/epay/</a> Enter ePay Trace Number: _____
<input checked="" type="checkbox"/> Check (send to TCEQ Financial Administration Division) Payor Name: <u>City of McCamey</u> Check Number: <u>29681</u>

<b>5. Electronic Versions of Application</b>
TCEQ will publish electronic versions of applications online. Applicants are required to submit complete clean (unmarked) copies of their applications in electronic format once they are administratively complete and technically complete. Additionally, applicants must provide electronic copies of responses to notices of deficiencies for publishing online. (Refer to Instructions for this form for how to submit electronically.)

<b>6. Party Responsible for Publishing Notice</b>
Indicate who will be responsible for publishing notice:
<input checked="" type="checkbox"/> Applicant <input type="checkbox"/> Agent in Service <input type="checkbox"/> Consultant
Contact Name: <u>Patty Jones</u>
Title: <u>City Secretary</u>
Email Address: <u>[REDACTED]</u>

<b>7. Alternative Language Notice</b>
Use the Alternative Language Checklist on Public Notice Verification Form TCEQ-20244-Waste-NORI, TCEQ-20244-Waste-NAPD, or TCEQ-20244-Waste-NAORPM available at <a href="http://www.tceq.texas.gov/permitting/waste_permits/msw_permits/msw_notice.html">www.tceq.texas.gov/permitting/waste_permits/msw_permits/msw_notice.html</a> to determine if an alternative language notice is required.
Is an alternative language notice required for this application?
<input checked="" type="checkbox"/> Yes <input type="checkbox"/> No
Indicate the alternative language: <u>Spanish</u>

<b>8. Public Place for Copy of Application</b>
Name of the Public Place: <u>McCamey City Hall</u>
Physical Address: <u>207 E 6th Street</u>
City: <u>McCamey</u> County: <u>Upton</u> State: <u>TX</u> Zip Code: <u>79752</u>
Phone Number: <u>432-652-3333</u>

<b>9. Consolidated Permit Processing</b>
Is this submittal part of a consolidated permit processing request, in accordance with 30 TAC Chapter 33?
<input type="checkbox"/> Yes <input checked="" type="checkbox"/> No
If "Yes", indicate the other TCEQ program authorizations requested:

<b>10. Confidential Documents</b>
Does the application contain confidential documents?
<input type="checkbox"/> Yes <input checked="" type="checkbox"/> No
If "Yes", reference the confidential documents in the application, but submit the confidential documents as an attachment in a separate binder marked "CONFIDENTIAL."

**11. Permits and Construction Approvals**

Mark the following table to indicate status of other permits or approvals.

**Table 1. Permits and Construction Approvals.**

Permit or Approval	Received	Pending	Not Applicable
Hazardous Waste Management Program under Texas Solid Waste Disposal Act			n/a
Underground Injection Control Program under Texas Injection Well Act			n/a
National Pollutant Discharge Elimination System Program under Clean Water Act; Waste Discharge Program under Texas Water Code, Chapter 26			n/a
Prevention of Significant Deterioration Program under Federal Clean Air Act (FCAA); Nonattainment Program under the FCAA			n/a
National Emission Standards for Hazardous Air Pollutants Preconstruction Approval under the FCAA			n/a
Ocean Dumping Permits under Marine Protection Research and Sanctuaries Act			n/a
Dredge or Fill Permits under Clean Water Act			n/a
Licenses under the Texas Radiation Control Act			n/a
Other (describe):			
Other (describe):			

**12. General Information About the Facility**

Facility Regulated Entity Name:  
City of McCamey Landfill

Contact Name: Patty Jones Title: City Secretary

MSW Authorization Number (if existing): 566

Regulated Entity Reference Number: RN 1026960

Physical or Street Address (if available): none

City: McCamey County: Upton State: TX Zip Code: 79752

Phone Number: 432-652-3333

Latitude (decimal degrees, six decimal places): 31.11083

Longitude (decimal degrees, six decimal places): -102.20167

Elevation (above mean sea level): 2369 feet (benchmark elevation for landfills)

Description of facility location with respect to known or easily identifiable landmarks:  
1.25 MILES SE OF FM 305 AND FM 1901 INTERSECTION 1000 FEET E OF FM 305 MCCAMEY TX

Access routes from the nearest United States or state highway to the facility:  
Highway 305

**Coastal Management Program**

Is the facility within the Coastal Management Program boundary?

Yes  No

**13. Facility Types**

Facility types are described in 30 TAC 330.5(a).

Indicate facility type (select all that apply):

Type I  Type IV  Type V

Type IAE  Type IVAE  Type VI

**14. Activities Conducted at the Facility**

Storage  Processing  Disposal

**15. Facility Waste Management Units**

Check the box for each type of waste management unit proposed.

- |  |   |
|--|---|
| <input checked="" type="checkbox"/> Landfill Unit(s) | <input type="checkbox"/> Container(s)                 |
| <input type="checkbox"/> Incinerator(s)              | <input type="checkbox"/> Roll-off Boxes               |
| <input type="checkbox"/> Class 1 Landfill Unit(s)    | <input type="checkbox"/> Surface Impoundment          |
| <input type="checkbox"/> Process Tank(s)             | <input type="checkbox"/> Autoclave(s)                 |
| <input type="checkbox"/> Storage Tank(s)             | <input type="checkbox"/> Refrigeration Unit(s)        |
| <input type="checkbox"/> Tipping Floor               | <input type="checkbox"/> Mobile Processing Unit(s)    |
| <input type="checkbox"/> Storage Area                | <input type="checkbox"/> Compost Pile(s) or Vessel(s) |
| <input type="checkbox"/> Other (specify):            |   |

**16. Description of Proposed Facility or Changes to Existing Facility**

Provide a brief description of the proposed activities if application is for a new facility, or the proposed changes to an existing facility or permit conditions if the application is for an amendment.

The City of McCamey is requesting a change in the permitted days of public operation. Current allowed public days are Tuesday 9-12 / 1-4 and Saturday 9-1.

Requested days open to the public and work days for landfill attendant are:

- Tuesday 9-12 / 1-6
- Wednesday 9-12 / 1-6
- Thursday 9-12 / 1-6
- Saturday 9-12 / 1-6

**17. Facility Contact Information**

**Site Operator (Permittee or Registrant)**

Name: City of McCamey  
Customer Reference Number: CN 600869535  
Contact Name: Patty Jones Title: City Secretary  
Mailing Address: PO Box 1409  
City: McCamey County: Upton State: TX Zip Code: 79752  
Phone Number: 432-652-3333  
Email Address: [REDACTED]

**Operator (if different from Site Operator)**

Name: \_\_\_\_\_  
Customer Reference Number: CN \_\_\_\_\_  
Contact Name: \_\_\_\_\_ Title: \_\_\_\_\_  
Mailing Address: \_\_\_\_\_  
City: \_\_\_\_\_ County: \_\_\_\_\_ State: \_\_\_\_\_ Zip Code: \_\_\_\_\_  
Phone Number: \_\_\_\_\_  
Email Address: \_\_\_\_\_

**Consultant (if applicable)**

Firm Name: \_\_\_\_\_  
Consultant Name: \_\_\_\_\_  
Texas Board of Professional Engineers Firm Registration Number: \_\_\_\_\_  
Contact Name: \_\_\_\_\_ Title: \_\_\_\_\_  
Mailing Address: \_\_\_\_\_  
City: \_\_\_\_\_ County: \_\_\_\_\_ State: \_\_\_\_\_ Zip Code: \_\_\_\_\_  
Phone Number: \_\_\_\_\_  
Email Address: \_\_\_\_\_

**Agent in Service (required for out-of-state applicants)**

Name: \_\_\_\_\_  
Mailing Address: \_\_\_\_\_  
City: \_\_\_\_\_ County: \_\_\_\_\_ State: TX Zip Code: \_\_\_\_\_  
Phone Number: \_\_\_\_\_  
Email Address: \_\_\_\_\_

**18. Facility Supervisor License**

Indicate the level of Municipal Solid Waste Facility Supervisor license, as defined in 30 TAC Chapter 30, Occupational Licenses and Registrations, Subchapter F that the individual who supervises or manages the operations will obtain prior to commencing operations.

Class A Supervisor License  Class B Supervisor License

**19. Facility Ownership**

**Facility Owner**

Does the Site Operator (Permittee or Registrant) own all the facility units and all the facility property?

Yes  No

If "No", provide the following information for the other owner, and include a Core Data Form for the other owner. Attach supplemental sheet if more than one other owner.

Other Owner Name: \_\_\_\_\_

What is Owned:  Facility Units  Property

Other (describe): \_\_\_\_\_

Mailing Address: \_\_\_\_\_

City: \_\_\_\_\_ County: \_\_\_\_\_ State: \_\_\_\_\_ Zip Code: \_\_\_\_\_

Phone Number: \_\_\_\_\_

Email Address: \_\_\_\_\_

**20. Other Government Entities Information**

**Texas Department of Transportation**

District: 6

District Engineer's Name: Saul Romero, P.E.

Mailing Address: 3901 E Hwy 80

City: Odessa County: Ector State: TX Zip Code: 79761

Phone Number: 432-498-4711

Email Address: [REDACTED]

**Local Government Authority Responsible for Road Maintenance (if applicable)**

Government or Agency Name: Upton County

Contact Person's Name: County Judge Dusty Kilgore

Mailing Address: PO Box 482

City: Rankin County: Upton State: TX Zip Code: 79778

Phone Number: 432-693-2321

Email Address: [REDACTED]

**City Mayor Information**

City Mayor's Name: Pedro Rosales  
Mailing Address: PO Box 1409  
City: McCamey County: Upton State: TX Zip Code: 79752  
Phone Number: 432-212-2356  
Email Address: [REDACTED]

**City Health Authority**

Authority Name: none  
Contact Person's Name: \_\_\_\_\_  
Contact Person's Title: \_\_\_\_\_  
Mailing Address: \_\_\_\_\_  
City: \_\_\_\_\_ County: \_\_\_\_\_ State: TX Zip Code: \_\_\_\_\_  
Phone Number: \_\_\_\_\_  
Email Address: \_\_\_\_\_

**County Judge Information**

County Judge's Name: Dusty Kilgore  
Mailing Address: PO Box 482  
City: Rankin County: Upton State: TX Zip Code: 79778  
Phone Number: 432-693-2321  
Email Address: [REDACTED]

**County Health Authority**

Agency Name: DSHA Public Health Region 9/10  
Contact Person's Name: Mr. David Kolberson, RN, CCHP  
Contact Person's Title: Program Manager  
Mailing Address: 401 East Franklin Ave 79901  
City: El Paso County: El Paso State: TX Zip Code: \_\_\_\_\_  
Phone Number: \_\_\_\_\_  
Email Address: \_\_\_\_\_

**State Representative Information**

House District Number: 53  
State Representative's Name: Wes Virdeil  
District Office Mailing Address: Room E2.304 P.O. Box 12910  
City: Austin County: Travis State: TX Zip Code: 78711  
Phone Number: (512) 463-0536  
Email Address: [REDACTED]

**State Senator Information**

District Number: 31  
State Senator's Name: Kevin Sparks  
District Office Mailing Address: 1100 Congress Ave Room E1.708 P.O. Box 12068  
City: Austin County: Travis State: TX Zip Code: 78711  
Phone Number: (512) 463-0131  
Email Address: [REDACTED]

**Council of Governments (COG)**

COG Name: Permian Basin Regional Planning Commission  
COG Representative's Name: Virginia Below  
COG Representative's Title: Executive Director  
Mailing Address: PO Box 60680  
City: Midland County: Midland State: TX Zip Code: 79711  
Phone Number: 432-262-4923  
Email Address: [REDACTED]

**River Basin Authority**

Authority Name: n/a Upton County Water District  
Contact Person's Name: Angie Jackson  
Watershed Sub-Basin Name: \_\_\_\_\_  
Mailing Address: 205 10th Ave. PO Box 330  
City: Rankin County: Upton State: TX Zip Code: 79778  
Phone Number: 432-693-2597  
Email Address: [REDACTED]

**Local Drainage or Flood Management Authority**

Authority Name: n/a City of McCamey  
Contact Person's Name: Patty Jones  
Mailing Address: PO Box 1409  
City: McCamey County: Upton State: TX Zip Code: 79752  
Phone Number: 432-652-3333  
Email Address: [REDACTED]

**U.S. Army Corps of Engineers District**

Indicate the U.S. Army Corps of Engineers district in which the facility is located:

- Albuquerque, NM       Galveston, TX  
 Fort Worth, TX       Tulsa, OK

**Local Government Jurisdiction**

Within City Limits of: City of McCamey

Within Extraterritorial Jurisdiction of: City of McCamey

Is the facility located in an area in which the governing body of the municipality or county has prohibited the storage, processing, or disposal of municipal or industrial solid waste?

Yes     No

If "Yes", provide a copy of the ordinance as an attachment.

**Applicant Signature Page**

**Site Operator (Permittee or Registrant Name) or Authorized Signatory**

I certify under penalty of law that this document and all attachments were prepared under my direction or supervision in accordance with a system designed to assure that qualified personnel properly gather and evaluate the information submitted. Based on my inquiry of the person or persons who manage the system, or those persons directly responsible for gathering the information, the information submitted is, to the best of my knowledge and belief, true, accurate, and complete. I am aware there are significant penalties for submitting false information, including the possibility of fine and imprisonment for knowing violations.

Name: Patty Jones Title: City Secretary  
Email Address: [REDACTED]  
Signature: *Patty Jones* Date: 4/24/2026

**Authorization by Facility Owner for Operator to Submit Application**

To be completed by the facility owner if the application is submitted by an operator who is not the facility owner.

I am the owner of the facility that is the subject of this application, and authorize the operator, \_\_\_\_\_ to submit this application pursuant to 30 TAC 305.43(c).

Name: n/a Title: \_\_\_\_\_  
Email Address: \_\_\_\_\_  
Signature: \_\_\_\_\_ Date: \_\_\_\_\_

**Notary**

SUBSCRIBED AND SWORN to before me by the said *Patty Jones*

On this 24 day of April, 2026

My commission expires on the 23 day of February, 2028

*Elodia Gomez*

Notary Public In and for *Waller County* (notary's jurisdiction, including county and state)

Note: Application Must Bear Signature & Seal of Notary Public

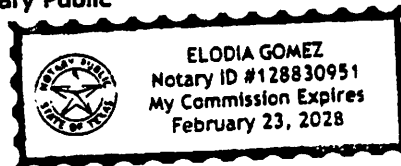

**Property Owner Affidavit**

**Property Owner Affidavit for Landfill Facility**

I acknowledge in accordance with 30 TAC 330.59(d)(2) that the State of Texas may hold me either jointly or severally responsible for the operation, maintenance, and closure and post-closure care of the facility. For a facility where waste will remain after closure, I acknowledge that I have a responsibility to file with the county deed records an affidavit to the public advising that the land will be used for a solid waste facility prior to the time that the facility actually begins operating as a municipal solid waste landfill facility, and to file a final recording upon completion of disposal operations and closure of the landfill units according to 30 TAC 330.19 (relating to Deed Recordation). I further acknowledge that the facility owner or operator and the State of Texas shall have access to the property during the active life and post-closure care period for the purpose of inspection and maintenance.

Name: Patty Jones

Email Address: [REDACTED]

Signature: *Patty Jones* Date: 4/24/2020

**Property Owner Affidavit for Processing Facility**

I acknowledge in accordance with 30 TAC 330.59(d)(2) that the State of Texas may hold me either jointly or severally responsible for the operation, maintenance, and closure of the facility. I further acknowledge that the facility owner or operator and the State of Texas shall have access to the property during the active life and post-closure care period for the purpose of inspection and maintenance.

Name: \_\_\_\_\_

Email Address: \_\_\_\_\_

Signature: \_\_\_\_\_ Date: \_\_\_\_\_

**Notary**

SUBSCRIBED AND SWORN to before me by the said *Patty Jones*

On this 24 day of April, 2020

My commission expires on the 23 day of February, 2028

*Elodia Gomez*  
Notary Public in and for

*Upton County* (notary's jurisdiction, including county and state)

Note: Application Must Bear Signature & Seal of Notary Public

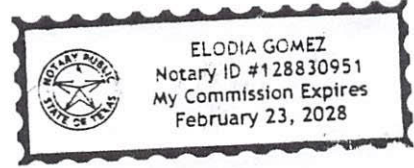

**Part I Attachments**

Refer to instruction document TCEQ 00650-instr<sup>5</sup> for professional engineer seal requirements.

**Attachments Table 1. Required attachments.**

Required Attachments	Attachment Number
Supplementary Technical Report [30 TAC 305.45(a)(8)]	
Property Legal Description [30 TAC 330.59(d)(1)]	
Property Metes and Bounds Description [30 TAC 330.59(d)(1)]	
Facility Legal Description [30 TAC 330.59(d)(1)]	
Facility Metes and Bounds Description [30 TAC 330.59(d)(1)]	
Metes and Bounds Drawings [30 TAC 330.59(d)(1)]	
On-Site Easements Drawing [30 TAC 330.61(c)(10)]	
Land Ownership Map [30 TAC 330.59(c)(3)]	#5
Landowners List [30 TAC 330.59(c)(3)]	#6
Mailing Labels (In electronic file, in Avery 5160 format; see Instructions) [30 TAC 281.5(7)]	#7
General Location Maps [30 TAC 330.59(c)(2)]	
Texas Department of Transportation (TxDOT) County Map [30 TAC 330.59(c)(2)]	
General Topographic Maps [30 TAC 330.61(e)]	
Verification of Legal Status / Legal Authority (certificate of incorporation) [30 TAC 281.5 and 330.59(e)]	
Evidence of Competency [30 TAC 330.59(f)]	
Signatory Authority Documentation [30 TAC 305.44 and 330.59(g)]	#8
TCEQ Core Data Form(s) TCEQ-10400 <sup>6</sup> [30 TAC 281.5(7)]	#1

<sup>5</sup> [www.tceq.texas.gov/downloads/permitting/waste-permits/msw/forms/00650-instr.pdf](http://www.tceq.texas.gov/downloads/permitting/waste-permits/msw/forms/00650-instr.pdf)  
<sup>6</sup> [www.tceq.texas.gov/permitting/central\\_registry/guidance.html](http://www.tceq.texas.gov/permitting/central_registry/guidance.html)

**Attachments Table 2. Additional attachments as applicable.**

Additional Attachments (select all that apply and add others as needed)	Attachment Number
<input checked="" type="checkbox"/> Plain Language Summary Form TCEQ-20947 <sup>7</sup> [30 TAC 39.405(k)]	# 1
<input type="checkbox"/> Public Involvement Plan Form TCEQ-20960 <sup>8</sup>	
<input checked="" type="checkbox"/> Fee Payment Receipt	# 2
<input type="checkbox"/> Confidential Documents	
<input type="checkbox"/> Waste Storage, Processing and Disposal Ordinances [Texas Health and Safety Code, Section 363.112 <sup>9</sup> ]	
<input type="checkbox"/> Final Plat Record of Property Description [30 TAC 330.59(d)(1)(B)]	
Other (describe):	
Other (describe):	
Other (describe):	

<sup>7</sup> [www.tceq.texas.gov/downloads/permitting/waste-permits/msw/forms/20947-Instr.pdf](http://www.tceq.texas.gov/downloads/permitting/waste-permits/msw/forms/20947-Instr.pdf)

<sup>8</sup> [www.tceq.texas.gov/downloads/agency/decisions/hearings/environmental-equity/pip-form-tceq-20960.pdf](http://www.tceq.texas.gov/downloads/agency/decisions/hearings/environmental-equity/pip-form-tceq-20960.pdf)  
<sup>9</sup> [www.tceq.texas.gov/downloads/agency/decisions/hearings/environmental-equity/instructions-for-pip-form-tceq-20960.pdf](http://www.tceq.texas.gov/downloads/agency/decisions/hearings/environmental-equity/instructions-for-pip-form-tceq-20960.pdf)

<sup>9</sup> [statutes.capitol.texas.gov/Docs/HS/htm/HS.363.htm#363.112](http://statutes.capitol.texas.gov/Docs/HS/htm/HS.363.htm#363.112)



# Texas Commission on Environmental Quality Application Form for Municipal Solid Waste Permit or Registration Modification or Temporary Authorization

## Application Tracking Information

Facility Name: City of McCamey  
Permittee or Registrant Name: City of McCamey  
MSW Authorization Number: 566  
Initial Submission Date: 02-17-2026  
Revision Date: 04/08/2026

Instructions for completing this form are provided in [form TCEQ-20650-instr<sup>1</sup>](#). If you have questions, contact the Municipal Solid Waste Permits Section by email to [mswper@tceq.texas.gov](mailto:mswper@tceq.texas.gov), or by phone at 512-239-2335.

## Application Data

### 1. Submission Type

Initial Submission       Notice of Deficiency (NOD) Response

### 2. Authorization Type

Permit       Registration

### 3. Application Type

Modification with Public Notice       Modification without Public Notice  
 Temporary Authorization (TA)       Modification for Name Change or Transfer

### 4. Application Fee

#### Amount

The application fee for a modification or temporary authorization is \$150.

#### Payment Method

Online through ePay portal [www3.tceq.texas.gov/epay/](http://www3.tceq.texas.gov/epay/)

If paid online, enter ePay Trace Number: \_\_\_\_\_

Check # 29681

<sup>1</sup> [www.tceq.texas.gov/downloads/permitting/waste-permits/msw/forms/20650-instr.pdf](http://www.tceq.texas.gov/downloads/permitting/waste-permits/msw/forms/20650-instr.pdf)

**5. Electronic Versions of Application**

For modifications that require public notice, TCEQ will publish electronic versions of the applications online. Applicants must provide complete electronic copies of their initial applications, responses to notices of deficiencies, and the final technically complete versions. (Refer to instructions for this form for how to submit electronically.)

**6. Party Responsible for Mailing Notice**

For modifications that require notice, indicate who will be responsible for mailing notice:

Applicant                       Agent in Service                       Consultant

Contact Name: Patty Jones

Title: City Secretary

Email Address: [REDACTED]

**7. Confidential Documents**

Does the application contain confidential documents?

Yes     No

If "Yes", reference the confidential documents in the application, but submit the confidential documents as an attachment in a separate binder marked "CONFIDENTIAL."

**8. Facility General Information**

Facility Name: City of McCamey Landfill

Contact Name: Patty Jones                      Title: City Secretary

MSW Authorization Number (if existing): 566

Regulated Entity Reference Number: **RN** 102696051

Physical or Street Address: FM 305 1.25 miles SE of FM 1901/FM305 intersection

City: McCamey                      County: Upton                      State: TX                      Zip Code: 79752

Phone Number: 4326523333

Latitude (Decimal Degrees): 31.11083

Longitude (Decimal Degrees): -102.20167

**9. Facility Types**

Type I                       Type IV                       Type V

Type IAE                       Type IVAE

**10. Description of the Revisions to the Facility**

Provide a brief description of revisions to permit or registration conditions and supporting documents referred to by the permit or registration, and a reference to the specific provisions under which the modification or temporary authorization application is being made. Also, provide an explanation of why the modification or temporary authorization is needed:

The City of McCamey is requesting a change in the permitted days and operating hours for public operation. Current permitted times are Tuesday 9-12 / 1-4 and Saturday 9-1.

Requested public operating times and work days for landfill attendant are:

Tuesday, Wednesday, Thursday and Saturday 9-12 / 1-6.

**11. Facility Contact Information**

**Site Operator (Permittee or Registrant)**

Name: City of McCamey

Customer Reference Number: **CN** 600669535

Contact Name: Patty Jones Title: City Secretary

Mailing Address: PO Box 1409

City: McCamey County: Upton State: TX Zip Code: 79752

Phone Number: 432-652-3333

Email Address: [REDACTED]

Texas Secretary of State (SOS) Filing Number: \_\_\_\_\_

**Operator (if different from Site Operator)**

Name: \_\_\_\_\_

Customer Reference Number: **CN** \_\_\_\_\_

Contact Name: \_\_\_\_\_ Title: \_\_\_\_\_

Mailing Address: \_\_\_\_\_

City: \_\_\_\_\_ County: \_\_\_\_\_ State: \_\_\_\_\_ Zip Code: \_\_\_\_\_

Phone Number: \_\_\_\_\_

Email Address: \_\_\_\_\_

Texas Secretary of State (SOS) Filing Number: \_\_\_\_\_

**Consultant (if applicable)**

Firm Name: \_\_\_\_\_

Consultant Name: \_\_\_\_\_

Texas Board of Professional Engineers Firm Registration Number: \_\_\_\_\_

Contact Name: \_\_\_\_\_ Title: \_\_\_\_\_

Mailing Address: \_\_\_\_\_

City: \_\_\_\_\_ County: \_\_\_\_\_ State: \_\_\_\_\_ Zip Code: \_\_\_\_\_

Phone Number: \_\_\_\_\_

Email Address: \_\_\_\_\_

**Agent in Service (required for out-of-state applicants)**

Name: \_\_\_\_\_

Mailing Address: \_\_\_\_\_

City: \_\_\_\_\_ County: \_\_\_\_\_ State: TX Zip Code: \_\_\_\_\_

Phone Number: \_\_\_\_\_

Email Address: \_\_\_\_\_

**12. Ownership Status of the Facility**

Is this a modification that changes the legal description, the property owner, or the Site Operator (Permittee or Registrant)?

Yes  No

If the answer is "No", skip the next question and proceed to signature page.

Does the Site Operator (Permittee or Registrant) own all the facility units and all the facility property?

Yes  No

If "No", provide the following information for other owners.

Owner Name: \_\_\_\_\_

Mailing Address: \_\_\_\_\_

City: \_\_\_\_\_ County: \_\_\_\_\_ State: \_\_\_\_\_ Zip Code: \_\_\_\_\_

Phone Number: \_\_\_\_\_

Email Address: \_\_\_\_\_

**Signature Page**

**Facility Owner or Authorized Operator Signature**

I certify under penalty of law that this document and all attachments were prepared under my direction or supervision in accordance with a system designed to assure that qualified personnel properly gather and evaluate the information submitted. Based on my inquiry of the person or persons who manage the system, or those persons directly responsible for gathering the information, the information submitted is, to the best of my knowledge and belief, true, accurate, and complete. I am aware there are significant penalties for submitting false information, including the possibility of fine and imprisonment for knowing violations.

Name: Patty Jones Title: City Secretary

Email Address: [REDACTED]

Signature: *Patty Jones* Date: 4/24/2026

**Owner Authorization for Operator to Submit Application**

To be completed by the facility owner if the application is signed by authorized operator.

I hereby authorize \_\_\_\_\_ any application, submit additional information as may be requested by the Commission; and/or appear for me at any hearing or before the Texas Commission on Environmental Quality in conjunction with this request for a Texas Water Code or Texas Solid Waste Disposal Act permit. I further understand that I am responsible for the contents of this application, for oral statements given by my authorized representative in support of the application, and for compliance with the terms and conditions of any permit which might be issued based upon this application.

Facility Owner Name: \_\_\_\_\_

Email Address: \_\_\_\_\_

Signature: \_\_\_\_\_ Date: \_\_\_\_\_

**Notary**

SUBSCRIBED AND SWORN to before me by the said \_\_\_\_\_

On this 24<sup>th</sup> day of April, 2026

My commission expires on the 23 day of February, 2028

*Elodia Gomez*

Notary Public in and for  
*Noton* County, Texas

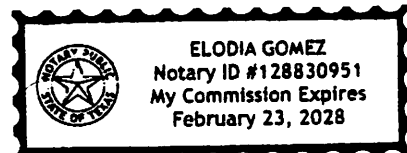

Note: Application Must Bear Signature and Seal of Notary Public

## Attachments to Application for Municipal Solid Waste Modification or Temporary Authorization

**Table 1. Attachments Required for All Modifications and Temporary Authorizations**

Attachment	Attachment Number
TCEQ Core Data Form(s) .....	#1
Fee Payment Receipt .....	#2
Confidential Documents (if applicable) .....	N/A
Marked (redline/strikeout) Pages .....	#3
Unmarked Revised Pages .....	#4

**Table 2. Additional Attachments for Modifications Requiring Public Notice**

Attachment	Attachment Number
Land Ownership Map .....	#5
Landowners List .....	#6

**Table 3. Additional Attachments for Permit or Registration Name Change or Transfer Modification**

Attachment	Attachment Number
Land Ownership Map .....	_____
Landowners List .....	_____
Property Legal Description.....	_____
Property Metes and Bounds Description .....	_____
Metes and Bounds Drawings .....	_____
Final Plat Record of Property (if applicable) .....	_____
On-Site Easements Drawing .....	_____
Property Owner Affidavit .....	_____
Verification of Legal Status .....	_____
Evidence of Competency .....	_____

#2

4/7/2026 10:36 AM  
CITY OF MCCAMEY GF  
XXXXXX8013

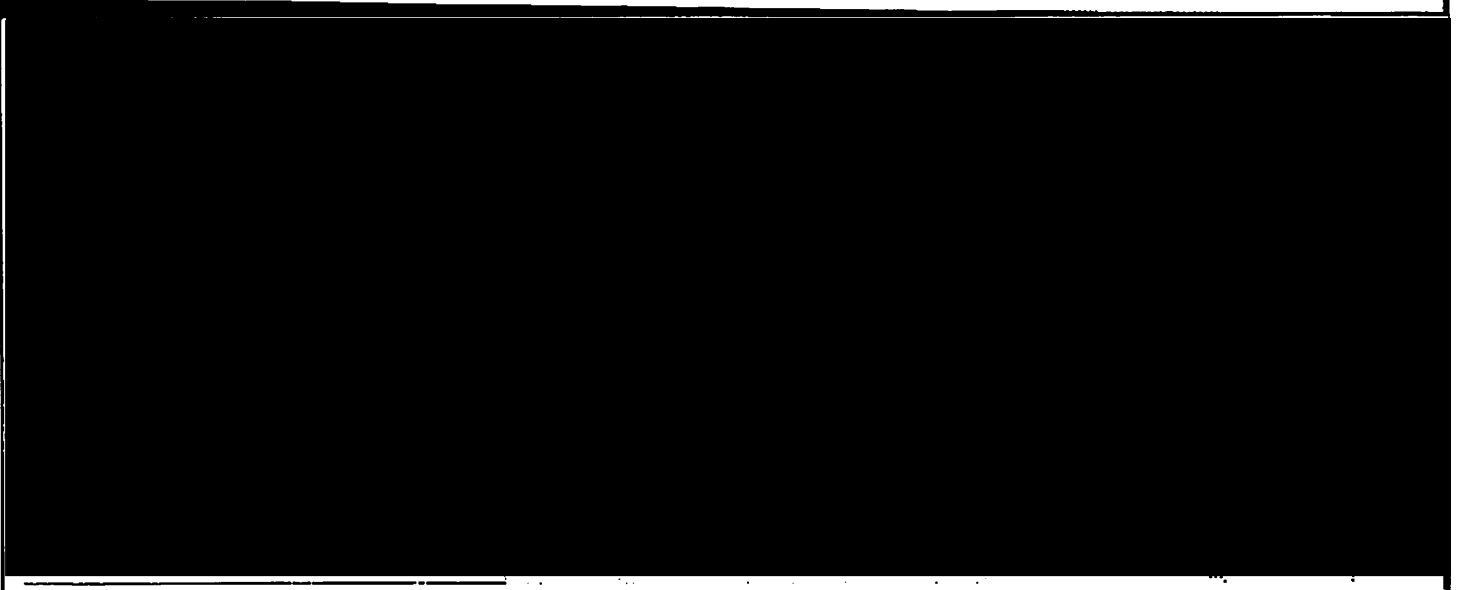
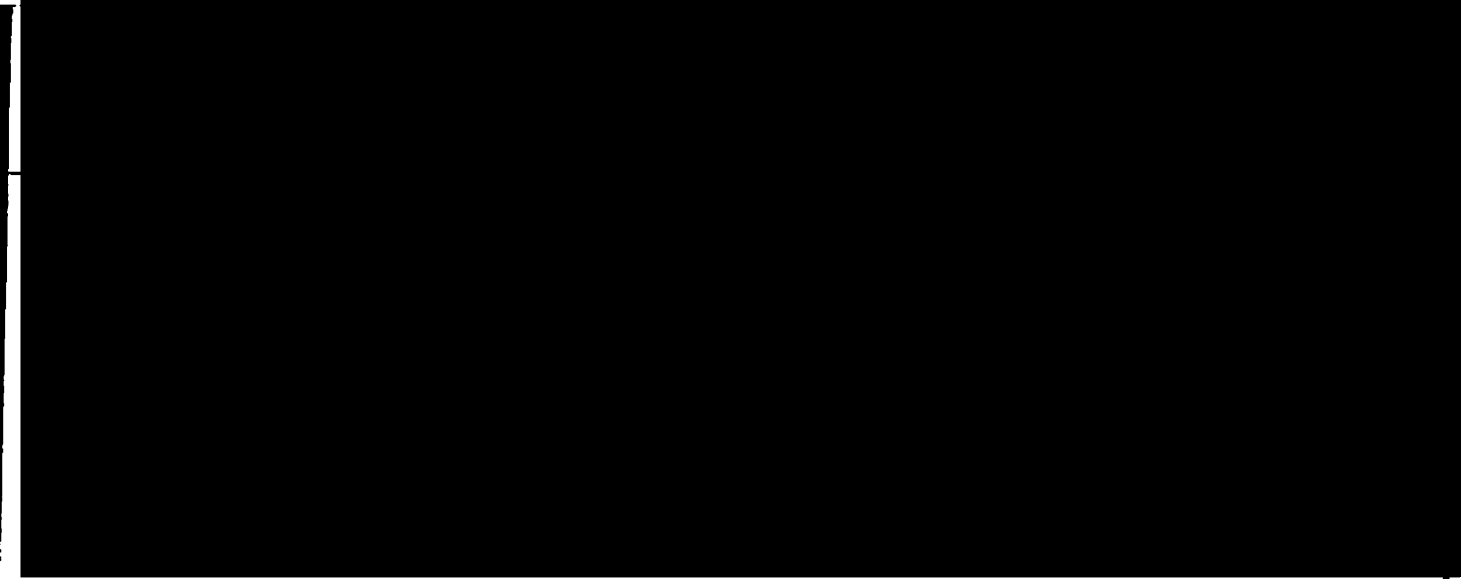

**Amount:** \$-150.00  
**Statement Description:** Check(C21 Inclearings)  
**Check Number:** 29681  
**Posted Date:** 2/27/2026  
**Type:** Debit  
**Status:** Posted

#3

**CITY OF McCAMEY**

**PART III  
SITE DEVELOPMENT PLAN**

**ATTACHMENT 14**

**CITY OF McCAMEY MSW LANDFILL  
McCAMEY, UPTON COUNTY, TEXAS  
TCEQ PERMIT NO. MSW-566**

**LANDFILL GAS MANAGEMENT PLAN**



FOR PERMITTING PURPOSES ONLY

*Prepared by:*



***Landgraf, Crutcher and Associates, Inc.***

TRANSPORTATION • ENVIRONMENTAL • CIVIL ENGINEERS ODESSA, TEXAS  
Phone (916) 332-5056 Fax (915) 332-8818 E-Mail [lca@lcaodessa.com](mailto:lca@lcaodessa.com)

September 13, 1995  
September 22, 2006  
Revised: February 7, 2007

**CITY OF McCAMEY MSW LANDFILL  
LANDFILL GAS MANAGEMENT PLAN**

**TABLE OF CONTENTS  
30 TAC §330.63(g)**

**§330.371 SUBCHAPTER I: LANDFILL GAS MANAGEMENT PLAN ..... 1**

**§330.371(a)(1) Methane Concentrations in Structures ..... 1**

**§330.371(a)(2) Methane Concentrations at Boundaries ..... 1**

**§330.371(b) MONITORING PROGRAM ..... 1**

**§330.371(b)(1) Factors In which Monitoring Program is Based Upon ..... 1**

**§330.371(b)(2) Minimum Frequency of Monitoring ..... 2**

**§330.371(c) EXCEEDING METHANE GAS LEVELS ..... 2**

**§330.371(c)(1) Immediate Response ..... 2**

**§330.371(c)(2) Required Documentation ..... 2**

**§330.371(c)(3) Remediation Plan ..... 2**

**§330.371(d) ALTERNATIVE SCHEDULES ..... 2**

**§330.371(e) PERIOD OF GAS MONITORING ..... 2**

**§330.371(f) MODIFICATIONS TO GAS MONITORING ..... 3**

**§330.371(g) COMPONENTS OF THE GAS MANAGEMENT PLAN ..... 3**

**§330.371(h) PERIMETER MONITORING NETWORK ..... 4**

**§330.371(h)(1) Initial Monitoring at Small MSWLFs ..... 4**

**§330.371(h)(2) Permanent Monitoring System ..... 4**

**§330.371(i) & (j) MONITORING PROVISIONS ..... 4**

**§330.371(k) MONITORING FREQUENCY ..... 4**

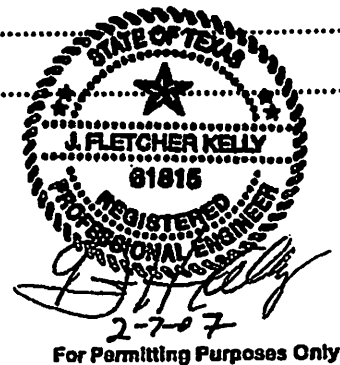

**CITY OF McCAMEY LANDFILL  
LANDFILL GAS MANAGEMENT PLAN  
30 TAC §330.63(g)  
PART III**

**§330.371 SUBCHAPTER I: LANDFILL GAS MANAGEMENT PLAN**

The City of McCamey will prepare and follow an approved landfill gas management plan, unless otherwise stated by the TCEQ. The City of McCamey will ensure the following requirements of Subchapter I (relating to Landfill Gas Management) are achieved.

**30 TAC §330.371(a)(1) Methane Concentrations in Structures**

The concentration of methane gas generated at the facility shall not exceed 1.25 percent by volume in facility structures.

**30 TAC §330.371(a)(2) Methane Concentrations at Boundaries**

The concentration of methane gas shall not exceed 5% by volume in monitoring points, probes, subsurface soils, or other matrices at the facility boundary as defined by the legal description in the permit.

**30 TAC §330.371(b) MONITORING PROGRAM**

A routine methane monitoring program will be implemented to ensure paragraph §330.371(a) is met.

**30 TAC §330.371(b)(1) Factors in which Monitoring Program is Based Upon:**

- (A) Soil conditions;
- (B) the hydrogeologic conditions surrounding the facility;
- (C) the hydraulic conditions surrounding the facility;
- (D) the location of facility structures and property boundaries; and
- (E) the location of utility lines and pipelines crossing the facility.

Primarily, the arid exempt status, limited rainfall, and small amounts of waste being landfilled will produce minimum amounts of methane. There is nothing to indicate that the particular soil types or geologic formations within the sector depths will be influenced by the small amounts of methane gas that will be generated. Hydraulic conditions shall also not be impacted.

---

The on-site enclosed structures will be monitored with the portable equipment at the same frequency and occurrence as the sub-surface monitoring.

The placement of gas monitoring probe (GMP) locations are typically widened when there are no homes or commercial establishments within close proximity to the boundaries and are placed closer together where underground utilities are located to aid in quicker detection.

**30 TAC §330.371(b)(2) Minimum Frequency of Monitoring**

Methane monitoring will be performed every three (3) months (quarterly) beginning approximately 30 days after the TCEQ approval of this plan. The executive director may alter the monitor frequency if it is deemed necessary by the TCEQ.

**30 TAC §330.371(c) EXCEEDING METHANE GAS LEVELS**

The following procedures will be performed should the levels of methane gas exceed the levels stated in paragraph §330.371(a) of this section.

**30 TAC §330.371(c)(1) Immediate Response**

In the event of an exceedance, the Permittee will immediately take all necessary steps to ensure protection of human health and notify the executive director, local and county officials, emergency officials, and the public.

**30 TAC §330.371(c)(2) Required Documentation**

Within 7 days of detection, an entry will be made in the operating record. The entry will include the date of detection, the level(s) detected and their location(s) using grid marker designations, key officials notified, and a description of the steps taken to protect human health.

**30 TAC §330.371(c)(3) Remediation Plan**

Within 60 days from detection, the Permittee will prepare a remediation plan for the methane gas releases. This plan will be placed in the operating record, and a copy of the plan will be submitted to the executive director at the TCEQ. The plan will describe the nature and extent of the problem and the proposed remedy. After review, the executive director may require additional measures to ensure remediation. Upon implementation of the plan, the Permittee will notify the executive director.

**30 TAC §330.371(d) ALTERNATIVE SCHEDULES**

The executive director may establish alternative schedules for demonstrating compliance with paragraphs §330.371(b) and (c) of this section either at the discretion of the executive director or at the request of the Permittee.

**30 TAC §330.371(e) PERIOD OF GAS MONITORING**

Gas monitoring will begin after the introduction of waste into the site and will continue for a period of five years after the final closure for the Type IV-AE facility, or until the Permittee receives written authorization to reduce the program. Authorization to reduce the gas monitoring will be based upon demonstration by the Permittee that there is no potential for gas migration beyond the property boundary. Demonstration of this proposal will be supported by data collected and additional studies as required.

### **30 TAC §330.371(f) MODIFICATIONS TO GAS MONITORING**

Gas monitoring and control systems will be modified as needed to reflect changing on-site and adjacent land uses. The post-closure land use at the site will not interfere with the function of gas monitoring and control systems. The underground utility trenches that cross the landfill facility boundary will be vented and monitored regularly.

### **30 TAC §330.371(g) COMPONENTS OF THE GAS MANAGEMENT PLAN**

This gas management plan consists of the following items:

- (1) A description of how the landfill gases will be managed and controlled;  
Landfill gas will be managed and controlled by placement of daily, intermediate, and final cover along with subsurface monitoring around the perimeter of the facility using portable equipment and probes as allowed by 30 TAC §330.371(h)(1). Locations for sampling will be conducted following the Site Development Plan for sequence of sector construction.
- (2) A description of the proposed monitoring systems and procedures to be used during maintenance.

#### Monitoring/Sampling Equipment

The portable gas detector is made by MSA (Mine Safety Appliance, Co.), Serial No. 63602, Model 2A, Part No. 89220 with a UL rating, or equivalent.

#### Preparatory Activities

1. Initiate field records.
2. Verify calibration of field detector.
3. Review map of monitoring locations (see Part III, Attachment 1 for monitoring locations).

#### Sub-surface Monitoring Procedures

1. Perform monitoring probe maintenance check. The monitoring probes will be maintained between monitoring cycles in accordance with the manufacturer's instructions.
2. A bar-hole probe will be inserted three (3) feet deep, or as specified by the manufacturers operating manual.
3. Conduct a methane reading that was maintained during evacuation for at least 30 seconds.
4. Record all technical data (i.e. - monitoring location, monitoring date and levels of methane detected) on the data sheet. Additional information may be included if deemed necessary, such as instrument calibration not performed, weather condition, etc.
5. Place points on the locations where sampling occurred on a copy of the Grid Marker System (Part III, Attachment 1 of the Site Development Plan).

- (3) A backup plan to be used if the main gas monitoring system described above breaks down or becomes ineffective.

The system may fail if the portable methane detector is deemed inoperable. In the event that the system fails, the Permittee will purchase/lease another combustible detector with a minimum range of 0-100 of LEL as soon as possible.

**Record Keeping**

All quarterly sampling results will be kept on file at the City of McCamey City Hall within the operating record for inspection by the TCEQ if requested. The City of McCamey will immediately notify TCEQ when any methane is detected above the regulatory limits.

**30 TAC §330.371(h) PERIMETER MONITORING NETWORK**

**30 TAC §330.371(h)(1) Initial Monitoring at Small MSWLFs**

The facility is a Type IV-AE MSWLF; therefore, the facility will have a subsurface monitoring system around the perimeter of the site using a combination of portable equipment and probes at a spacing of no less than 1,000 feet between probes. If methane levels show the presence of methane gas above a concentration of 0.5% by volume, for any four consecutive quarters, a permanent monitoring system will be installed.

**30 TAC §330.371(h)(2) Permanent Monitoring System**

If a permanent methane monitoring system is required in the future, gas monitoring wells (GMW) will be installed. The design will be submitted to TCEQ for approval and a permit modification will be requested.

**30 TAC §330.371(i) & (j) MONITORING PROVISIONS**

The on-site enclosed structures will be monitored with the portable equipment at the same frequency and occurrence as the sub-surface monitoring. Sampling for specified trace gases may be required by the executive director when there is a possibility of acute or chronic exposure due to carcinogenic or toxic compounds.

**30 TAC §330.371(k) MONITORING FREQUENCY**

Methane monitoring will be performed every three months (quarterly) from the initial acceptance of waste into the site.

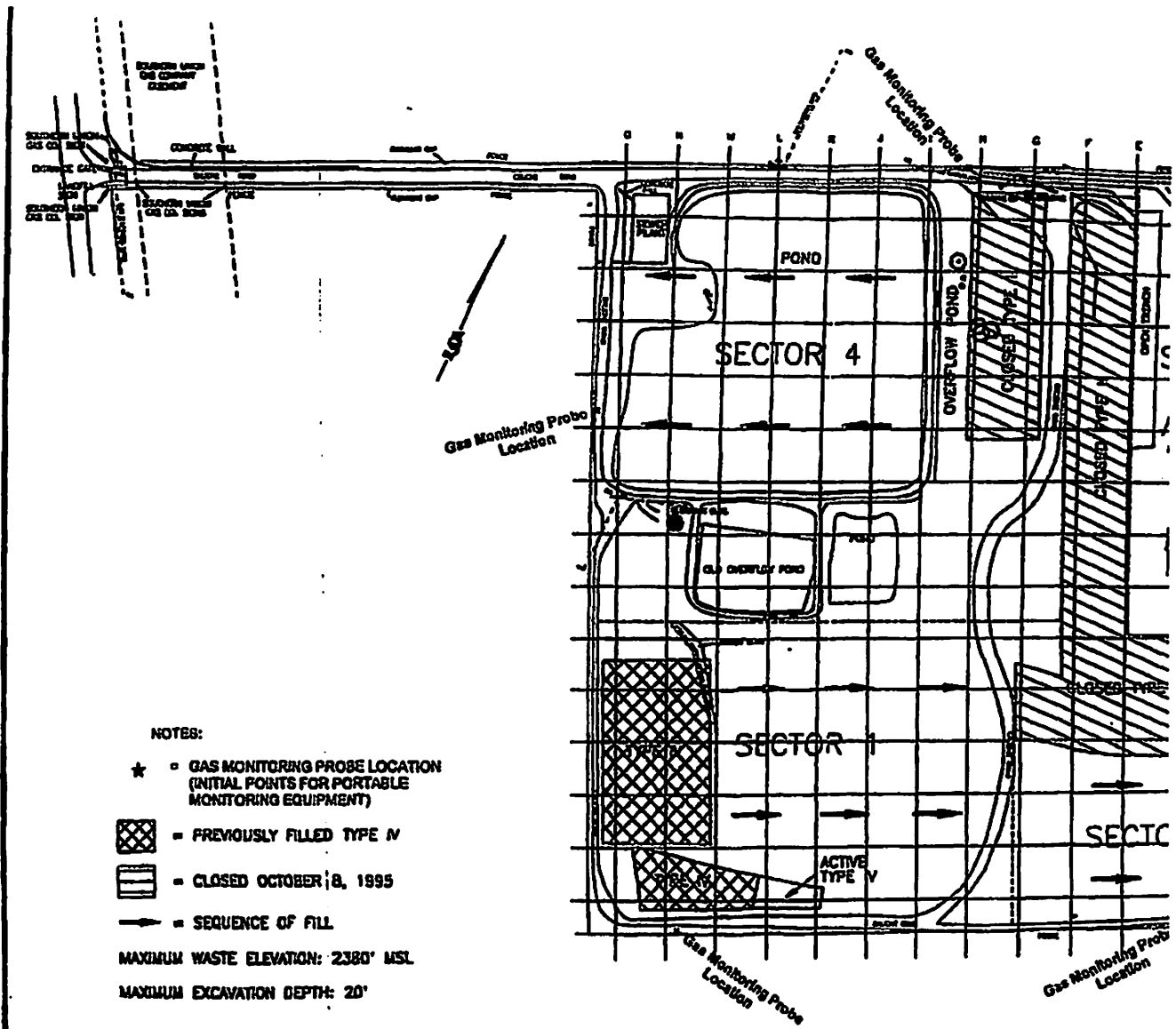

- NOTES:**
- ★ □ GAS MONITORING PROBE LOCATION (INITIAL POINTS FOR PORTABLE MONITORING EQUIPMENT)
  - ▣ PREVIOUSLY FILLED TYPE IV
  - ▨ CLOSED OCTOBER 18, 1995
  - SEQUENCE OF FILL
- MAXIMUM WASTE ELEVATION: 2380' MSL  
 MAXIMUM EXCAVATION DEPTH: 20'

SHEET NO. 82206	PROJECT NO. GAS MONITORING PROBE LOCATIONS	DATE 5/95	DRAWN BY JJA	CHECKED BY JJA	SCALE OF DRAWING DATE 5/95 23 No. 15-211 273 No. 1501(24)	Landgraf, Crotcher and Associates, Inc. CONSULTING ENGINEERS, CIVIL ENGINEERS 60 EAST TOWN OF DENVER, CO 80202	CITY OF McCAMEY LAN TNRC PERMIT NO. MS1
--------------------	---	--------------	-----------------	-------------------	--	--	--

**CITY OF McCAMEY LANDFILL  
McCAMEY, UPTON COUNTY, TEXAS  
TCEQ PERMIT NO. MSW - 566**

**PART IV  
SITE OPERATING PLAN**

**SUBMITTED BY:**

**CITY OF McCAMEY  
P.O. BOX 1409  
McCAMEY, UPTON COUNTY,  
TEXAS 79752**

***Prepared by:***

**Landgraf, Crutcher and Associates, Inc.  
TBPE NO. 1363  
521 N. Texas Ave.  
Odessa, Texas 79761  
432-332-5058**

**September 13, 1995**

**Revised:**

**February 7, 2007**

**September 2, 2009**

**December 7, 2009**

**August 19, 2025**

**For Permitting Purposes Only**

**CITY OF McCAMEY LANDFILL  
PART IV**

**TABLE OF CONTENTS**

§330.65 CONTENTS OF PART IV OF THE APPLICATION ..... 1

§330.125 RECORDKEEPING REQUIREMENTS ..... 1

§330.127 SITE OPERATING PLAN..... 3

§330.127(1) Landfill Personnel ..... 3

§330.127(2) Equipment ..... 4

§330.127(3) Operational Requirements..... 4

§330.127(4) Personnel Training ..... 6

§330.127(5) Detection and Prevention of the Disposal of Prohibited Waste ..... 7

§330.129 FIRE PROTECTION ..... 9

§330.131 ACCESS CONTROL..... 12

§330.133 UNLOADING OF WASTE..... 13

§330.135 FACILITY OPERATING HOURS ..... 14

§330.137 SITE SIGN..... 14

§330.139 CONTROL OF WINDBLOWN SOLID WASTE AND LITTER ..... 15

§330.141 EASEMENTS AND BUFFER ZONES ..... 15

§330.143 LANDFILL MARKERS AND BENCHMARK..... 15

§330.145 MATERIALS ALONG THE ROUTE TO THE SITE ..... 16

§330.147 DISPOSAL OF LARGE ITEMS ..... 16

§330.149 ODOR-MANAGEMENT PLAN ..... 16

§330.151 DISEASE VECTOR CONTROL ..... 17

§330.153 SITE ACCESS ROADS..... 17

§330.155 SALVAGING AND SCAVENGING..... 18

§330.157 ENDANGERED SPECIES PROTECTION ..... 18

§330.159 LANDFILL GAS CONTROL ..... 18

City of McCamey, Landfill

---

§330.161 OIL, GAS, AND WATER WELLS ..... 18

§330.163 COMPACTION ..... 18

§330.165 LANDFILL COVER ..... 19

§330.167 PONDED WATER ..... 19

§330.169 WASTE IN ENCLOSED CONTAINERS OR ENCLOSED VEHICLES  
ACCEPTED AT TYPE IV LANDFILLS ..... 19

§330.171 DISPOSAL OF SPECIAL WASTES ..... 20

§330.173 DISPOSAL OF INDUSTRIAL WASTES ..... 20

§330.175 VISUAL SCREENING OF DEPOSITED WASTE ..... 20

§330.177 LEACHATE AND GAS CONDENSATE RECIRCULATION ..... 20

**For Permitting Purposes Only  
pages i through ii**

**CITY OF McCAMEY LANDFILL  
PART IV - SITE OPERATING PLAN  
30 TAC §330.65**

**§330.65 CONTENTS OF PART IV OF THE APPLICATION**

The information contained in this section is the Site Operating Plan has been prepared for the City of McCamey Landfill consistent with 30 TAC §330.65 and contains the information required by 30 TAC §330.121 - §330.179. This SOP includes provisions for site management and site operating personnel to meet the general and site-specific requirements included in Subchapter D: Operational Standards for Solid Waste Land Disposal Sites for the day-to-day operation of the facility.

The City of McCamey Landfill is a Type IV-AE municipal solid waste management facility located within a 50 acre tract of land, which lies 1.25 miles southeast of the intersection of FM 305 and FM 1901, 1,000 feet east of FM 305, approximately 2 miles southeast of the City of McCamey, Upton County, Texas. The primary function of the facility is municipal solid waste disposal.

The facility provides waste disposal for the City of McCamey and the surrounding areas for an estimated site life of approximately 100 years based on the site life calculations included in Part III, D. The City of McCamey anticipates it will have a maximum waste acceptance rate not to exceed 20 tons of Type IV waste per day.

**§330.125 RECORDKEEPING REQUIREMENTS**

A copy of the permit, the approved site development plan, the site operating plan, the final closure plan, the post-closure maintenance plan, the landfill gas management plan, and any other required plan or other related document shall be maintained at the facility, 209 E 6TH St, McCamey, Upton County, Texas, or an alternate location approved by the executive director. This requirement shall be considered a part of the operating record for the facility.

The following records will be kept, maintained and filed as part of the site's Site Operating Record. Log books and schedules may be used.

- Access Control Inspection and Maintenance
- Daily Litter Pickup
- Windblown Waste and Litter Control Operations
- Management of Disposal of Large Items
- Dust Nuisance Control Efforts
- Access Roadway Regrading
- Salvaged Material Storage Nuisance Control Efforts
- Access Control Breach and Repair Notices
- Fire Occurrence Notices
- Documentation of Compliance with Approved Odor Management Plan
- Ponding Prevention Plan Compliance Documentation
- Special Waste Operational Plan Compliance Documentation

In addition to the plans and documents listed above, the information listed in Table 1 will be recorded and retained in the Site Operating Record. This information will be placed in the Site Operating Record within seven working days of completion or upon receipt of analytical data, as appropriate.

The Site Operating Record will be maintained in an organized format, which allows the information to be easily located and retrieved. All information contained in the Site Operating Record will be furnished upon request to the TCEQ executive director and will be made available for inspection by the executive director.

City of McCamey, Landfill

All information contained within the Site Operating Record and the different required plans will be retained for the active life of the facility including the post-closure care period.

**Table 1.0 Site Operating Record**

<b>Records to be Maintained</b>	<b>Rule Citation</b>
1. Inspection records, training procedures, and notification procedures relating to excluding the receipt of prohibited waste	§330.125(b)(2)
2. All results from gas monitoring and any remediation plans relating to explosive and other gases (if required)	§330.125(b)(3)
3. Not applicable.	§330.125(b)(4)
4. Not applicable.	§330.125(b)(5)
5. Closure and post-closure care plans and any monitoring, testing, or analytical data relating to post-closure requirements	§330.125(b)(6)
6. Any and all cost estimates and financial assurance documentation relating to financial assurance for closure and post-closure requirements.	§330.125(b)(7)
7. Any and all information demonstrating continued compliance with the small community exemption criteria.	§330.125(b)(8)
8. Copies of all correspondence and responses relating to the operation of the facility, modifications to the permit, approvals, and other matters pertaining to technical assistance.	§330.125(b)(9)
9. Any and all documents, manifests, trip tickets, etc., involving special waste	§330.125(b)(10)
10. Not Applicable	§330.125(b)(11)
11. Any other document(s) specified by the approved permit or by the executive director	§330.125(b)(12)
12. Alternative schedules and notification requirements if applicable.	§330.125(g)
13. Records to document the annual acceptance rate, quarterly solid waste summary reports and the annual solid waste summary reports requirement by 30 TAC §330.675.	§330.125(h)
14. Load inspection records.	§330.127(5)(B)
15. Fire occurrence notices.	§330.129
16. Inspection records and training procedures relating to fire prevention and site safety.	§330.129
17. Access control breach and repair notices.	§330.131
18. All site inspection and maintenance documentation.	§330.131
19. Record(s) of each unauthorized material removal event.	§330.133(b)
20. Record of alternative operating hours if applicable.	§330.135(b)
21. Water, crude oil and/or natural gas well location and plugging reports if applicable.	§330.161(a)-(c)
22. Cover inspection records.	§330.165(h)
23. Not Applicable	§330.171(c)(3)(B)
24. Not Applicable	§330.171(c)(3)(B)
25. Not Applicable	§330.171(c)(3)(H)

**§330.127 SITE OPERATING PLAN**

The Site Operating Plan (SOP) will provide the site management and site operating personnel instructions in the proper operation of the site and in following and documenting the proper procedures in the day-to-day operations. The SOP will be retained during the active life of the site and throughout the post-closure care maintenance period.

**§330.127(1) Landfill Personnel**

The City of McCamey MSW Landfill will be staffed with qualified individuals experienced with municipal solid waste disposal operations and earthmoving construction projects. See Table 2 below for the City of McCamey MSW Landfill personnel types and descriptions.

**Table 2 – Personnel Type and Descriptions**

Title	Number	Minimum Qualifications	Function
Landfill Manager/ Supervisor	1	Maintains a Class B license as defined in §30.210213	Responsible for: <ul style="list-style-type: none"> <li>• Ensuring overall compliance with Chapter 330</li> <li>• Long term landfill management</li> <li>• Staff management</li> <li>• Budgeting</li> <li>• Managing the working face and daily fill and cover placement operations; grading and excavating; equipment maintenance; waste leveling and compaction; application of daily cover, and general site maintenance.</li> <li>• Levies fees on landfill customers, keeps appropriate records, controls site access, and provides general customer direction and information.</li> </ul>
Equipment Operator	1	6 months minimum experience in equipment operation or on the job training by supervisor and training by landfill manager in SOP requirements for daily cover and unauthorized waste	Responsible for: <ul style="list-style-type: none"> <li>• Grading and excavating; equipment maintenance; waste leveling and compaction; application of daily cover, and general site maintenance.</li> <li>• Operators are responsible for keeping the working face in the smallest area practical and screening for unauthorized waste.</li> <li>• Pickup wind blown litter as directed.</li> </ul>
Gate Attendant	1	Training by landfill manager in the SOP rules, record keeping requirements, and waste screening training course (e.g., I.I.E.D.)	Responsible for: <ul style="list-style-type: none"> <li>• Levies fees on landfill customers, keeps appropriate records, controls site access, screening for unauthorized waste, and provides general customer direction and information.</li> </ul>

Other site personnel or laborer(s) may be employed from time to time in categories such as maintenance, construction, litter abatement, and general site cleanup. Site laborers may be permanent or part-time.

**§330.127(2) Equipment**

Initial on-site equipment will consist of the equipment presented in the following table.

**Table 3 – Landfill Facility Equipment List**

Description	Quantity	Size ( <i>may vary</i> )	Function
Dozer	1	D3C, 933C or equivalent	Excavation of soil; waste and soil spreading and compaction; transportation of daily cover.
Pickup Truck(s)	Varies	Varies	Personnel use for litter control; maintenance.
Compactor	1	BC 67 or equivalent	Pushing and compaction of solid waste

Additional owned or rental equipment, such as, track front-end loaders, hydraulic excavators, road tractors and backhoes may be provided as necessary to enhance operational efficiency. At infrequent times, such as during equipment breakdown or periodic maintenance, additional equipment will be stationed at other city facilities and transported to the landfill as needed. Other equivalent types of equipment may be substituted on an as-needed basis to adequately maintain the landfill and meet the operational standards required by the commission's regulations in accordance with all applicable Local, State, and Federal regulations.

**§330.127(3) Operational Requirements**

Table 4 outlines the site inspection and maintenance list of the facility. The Item, Task, Frequency, Inspector and Inspection Documentation are also included.

**City of McCamey, Landfill**

**Table 4 – Site Inspection and Maintenance List – Operational Requirements**

<b>Item</b>	<b>Task</b>	<b>Frequency</b>	<b>Inspector</b>
<b>Fence/Gates</b>	Inspect perimeter fence and gates for damage. Make repairs if necessary.	Weekly	Landfill Manager / Supervisor or Design
<b>Windblown Waste</b>	Police working face area, wind fences, access roads, entrance areas, and perimeter fence for loose trash. Clean up as necessary.	Daily as specified in §330.139	Landfill Manager / Supervisor or Design
<b>Waste Spilled on Route to the Site</b>	Police the entrance areas and all roads at least 2 miles from the site entrances for loose trash. Clean up as necessary.	Daily as specified in §330.145	Landfill Manager / Supervisor or Design
<b>Landfill Markers</b>	Inspect all landfill markers for damage, color-coding, and general location. Correct or replace damaged markers within 15 days of discovery.	Monthly	Landfill Manager / Supervisor or Design
<b>Site Access Road</b>	Inspect site access road for damage from vehicle traffic, erosion, or excessive mud accumulation. Maintain as needed with crushed rock or stone. Grading equipment will be used weekly or as necessary to control or remove mud accumulations on roads as well as minimize depressions, ruts, and potholes.	Daily – more often during wet weather or extended dry weather periods.	Landfill Manager / Supervisor or Design
<b>Daily Cover</b>	Inspect for proper placement, thickness, and compaction. Correct problems as needed. Verify that vectors are not an issue.	Daily at the active face and all daily cover areas will be inspected.	Landfill Manager / Supervisor or Design
<b>Intermediate Cover</b>	Inspect for proper placement, thickness, erosion, and compaction and for presence of waste or other contamination. Correct problems as needed.	Weekly and within 72-hours of a rainfall event of 0.5 inches or more.	Landfill Manager / Supervisor or Design
<b>Final Cover</b>	Inspect for proper placement, thickness, compaction, slope, settlement and erosion. Maintenance will be ongoing throughout post closure care period. Correct problems as needed.	Weekly and within 72-hours of a rainfall event of 0.5 inches or more.	Landfill Manager / Supervisor or Design
<b>Site Signs</b>	Inspect all site signs for damage, general location, and accuracy of posted information.	Weekly	Landfill Manager / Supervisor or Design
<b>Ponded Water</b>	Inspect site for unauthorized ponded water areas as described in §330.167. Correct problems as necessary.	Weekly and within 72-hours of a rainfall event of 0.5 inches or more.	Landfill Manager / Supervisor or Design
<b>Odor</b>	Inspect the perimeter of the site to assess the performance of site operations to control odor.	Daily	Landfill Manager / Supervisor or Design

**Site Operating Plan**

September 13, 1995

Revised: February 7, 2007; September 2, 2009, December 7, 2009 August 19, 2025

Prepared by: Landgraf, Cru

City of McCamey, Landfill

**§330.127(4) Personnel Training**

Personnel training records will be maintained in accordance with 30 TAC §335.586(d) and (e).

Personnel operator licenses issued in accordance with 30 TAC, Subchapter F (relating to Municipal Solid Waste Facility Supervisors) will be maintained as required.

Table 5 lists the applicable training requirements per 30 TAC §335.586(a) and (c) by position.

**Table 5 – Job Positions, Descriptions and Training Requirements**

<u>Position</u>	<u>Job Description</u>	<u>Training</u>											
		Site Orientation	Site Operations	Endangered Species	Haz Waste Identification	Safety (Job specific)	Fire Prevention	Load Inspection	Emergency Response	License	Litter Control	Random Inspections	
Landfill Manager/ Supervisor	<ul style="list-style-type: none"> <li>Responsible for all landfill activities,</li> <li>Ensure adequate staffing and inspections,</li> <li>Manage LF staff and waste operations</li> </ul>	X	X	X	X	X	X	X	X	X	A or B	X	X
Equipment Operator	<ul style="list-style-type: none"> <li>Compact waste,</li> <li>Visual inspection of waste,</li> <li>Apply cover</li> </ul>	X	X	X	X	X	X	X	X		X	X	
Gate Attendant	<ul style="list-style-type: none"> <li>Take receipts,</li> <li>Visual inspection of loads,</li> <li>Direct vehicles to unloading areas</li> </ul>	X	X	X	X	X	X	X	X		X	X	

More detailed job descriptions along with written descriptions of the type and amount of introductory and continued training provided to each employee will be maintained in the facility Site Operating Record.

**Training Requirements**

City of McCamey will ensure that the landfill manager/supervisor (M/S) at the site is knowledgeable in the proper operation of a municipal solid waste landfill and the current operational standards required by the TCEQ. The M/S will be an experienced manager/supervisor and will maintain a Class A, B, or C license (as defined in 30 TAC §30.210) as required in 30 TAC §30.213. It will be the responsibility of the landfill M/S to ensure that all landfill personnel are properly trained and are operating the landfill in accordance with this SOP and operational standards required by the permit and the TCEQ municipal solid waste regulations.

## City of McCamey, Landfill

---

The personnel training program will be directed by a person trained in waste management procedures, and will include instruction that teach facility personnel waste management procedures and contingency plan implementation relevant to the positions in which they are employed.

New employees will receive a comprehensive overview of all aspects of landfill operations, focusing on information that is necessary to protect the health and welfare of the new employee and enable them to perform their duties in accordance with this SOP and operational standards required by the permit and the TCEQ municipal solid waste regulations. Following initial training, new employee training will continue during periodic training sessions consisting of on-the-job training.

The City of McCamey Landfill personnel will receive training through a combination of classroom instruction and on-the-job training. The training program will provide instruction to personnel to allow performance of their duties to ensure facility compliance. This training program will be directed by a senior staff member of the City of McCamey that is experienced and trained in municipal solid waste management procedures. The facility personnel will be trained in procedures relevant to the position they are employed. In-house training will address the following topics:

- Safety
- Fire protection, prevention, and evacuation
- Fire extinguisher use
- Emergency response
- Litter control and windblown waste pick-up
- Hazardous waste and PCB waste detection and control (waste screening), if applicable
- Prohibited waste management
- Properties of methane gas and safety procedures for methane gas, if applicable
- Random inspection procedures

The City of McCamey MSW Landfill facility personnel must successfully complete the in-house training program within 6 months of employment or assignment to this facility. Documentation of training will be placed in the site operating record as required by Recordkeeping Requirements section of the SOP.

The City Administrator, landfill manager/supervisor, and other personnel will receive training at TCEQ-sponsored or approved training courses, as deemed appropriate by City of McCamey management. The Institute for Infrastructure in Environmental Development (IIED) provides courses in the Class A, B, C, and D certification for municipal solid waste facilities, waste screening, transfer station, and safety. The IIED provides training and certification in accordance with §330.381 through §330.391. Other qualified TCEQ or other consultants may also provide training as appropriate.

### **§330.127(5) Detection and Prevention of the Disposal of Prohibited Waste**

#### **Prohibited Wastes**

The acceptance and disposal of the following prohibited wastes shall not be allowed at this site.

- Regulated hazardous waste as defined in 40 Code of Federal Regulations (CFR) Part 261, will not be accepted for disposal or disposed.
- Polychlorinated Biphenyls (PCBs) waste as defined in accordance with 40 CFR Part 761, will not be accepted for disposal or disposed.
- Lead acid storage batteries will not be intentionally or knowingly accepted for disposal.
- Do-it-Yourself (DIY) used motor vehicle oil will not be intentionally or knowingly accepted for disposal.
- Used-oil filters from internal combustion engines will not be intentionally or knowingly accepted for disposal.

## City of McCamey, Landfill

- Items containing chlorinated fluorocarbons (CFC's), such as refrigerators, freezers, and air conditioners, will only be accepted at the site if the generator or transporter provides written certification that the CFC has been evacuated from the unit and that it was not knowingly allowed to escape into the atmosphere. The M/S will verify that the refrigerant has been evacuated from the appliance or shipment of appliances previously. Such verification will include a signed statement from the person from whom the appliance or shipment of appliances is obtained that all refrigerant that had not leaked previously has been recovered from the appliance or shipment of appliances in accordance with 40 CFR §82.156 (g) or (h) as applicable. This statement will include the name and address of the person who recovered the refrigerant and the date the refrigerant was recovered or a contract that refrigerant will be removed prior to delivery. The facility will notify persons who may deliver such items of the requirement to verify evacuation of refrigerant by signage or letter.
- Liquid waste (any waste material that is determined to contain "free liquids" as deemed by EPA Method 9095 (Paint Filter Test), as described in "Test Methods for Evaluating Solid Wastes, Physical Chemical Methods" (EPA Publication Number SW-846)) will not be disposed of unless it is:
  - Bulk or non-containerized liquid waste that is:
    - Household waste other than septic waste; or
  - Contained liquid waste; and
    - The container is a small container similar in size to that normally found in household waste;
    - The container is designated to hold liquids for use other than storage; or the waste is a household waste.
- Regulated Asbestos Contained Materials (RACM) will not be accepted.
- Class 1 Industrial Waste will not be disposed.

### **Measures for Controlling Prohibited Wastes**

Procedures to detect and control the receipt of prohibited wastes include:

1. Informing facility customers of prohibited wastes by posting one or more signs at the facility entrance listing prohibited wastes.
2. Providing customers (regular and one-time or occasional) with a written list of prohibited wastes.
3. Informing all drivers of incoming waste vehicles and operators of any transfer stations that have indicated they will deliver waste to the facility for disposal of prohibited wastes by:
  - Posting one or more signs at the facility entrance listing prohibited wastes.
  - Providing all vehicle drivers and transfer station operators with a written list of prohibited wastes.
4. Facility personnel training and activities:
  - Training for appropriate facility personnel responsible for inspecting or observing incoming loads to recognize regulated hazardous waste and PCB waste.
  - Random inspections of incoming loads in accordance with procedures described in this section.
  - Maintaining records of all inspections.
  - Notification of the executive director of any incident involving a regulated hazardous waste or a PCB waste.
  - Remediation of any regulated hazardous waste or PCB waste discovered at the facility in accordance with §335.349.

Facility personnel will be trained to inspect vehicles and identify regulated hazardous waste, polychlorinated biphenyl (PCB) waste, and other prohibited wastes described above. Training for random inspections to recognize prohibited waste will be incorporated into other training programs (e.g., safety meetings). All training will be documented within seven days of said training and will become part

## City of McCamey, Landfill

---

of the site operating record. The personnel will be trained to look for the following indications of prohibited waste:

- Yellow hazardous waste or PCB labels;
- DOT hazard placards or markings;
- Liquids;
- 55-gallon drums;
- 85-gallon overpack drums;
- Powders or dusts;
- Vehicles that contain loads which have a visible emission, smoke, strong chemical odor, or cause physical symptoms (irritation of the eyes, nose, throat, skin, nausea, dizziness, or headache);
- Bright or unusual colored wastes; and
- Sludges

If landfill personnel identify any of the above indications with an incoming load, then that load will be directed to an area out of the flow of traffic, and the personnel will further assess the load.

If the load is determined to contain prohibited waste or if there is any possibility that it may be prohibited waste, the load will be rejected and directed back to the generator. All landfill personnel will be diligent in looking for trucks bringing in waste loads from potential sources of prohibited waste such as industrial facilities, microelectronics manufacturers, electronic companies, metal plating industry, automotive and vehicle repair service companies, and dry cleaning establishments.

The TCEQ and other appropriate agencies will be notified if any hazardous waste or PCB waste is unloaded at the facility.

### **Random Inspections**

Incoming waste is controlled in three ways to preclude the inadvertent receipt of prohibited wastes. One level of control is to inform customers of the types of waste that are to be excluded. A second control is to inform all vehicle drivers and transfer station operators of the restrictions. Personnel will be informed of the typical visible characteristics of these materials. A third control is provided through random inspections.

Due to the low waste stream volume entering the landfill (approximately 4 vehicles per day), random inspections will be made no less than once per week of all vehicles entering the landfill. For a random inspection, personnel will select an incoming vehicle for inspection, and direct the selected load to the area of the working face. Inspections based on internal profiling procedures will count towards the total of random inspections. Once the selected load arrives at the working face, personnel will direct the vehicle to a separate location of the working face and out of the flow of normal landfill traffic. As the load is dumped, personnel will visually inspect the contents.

Records of all inspections will be maintained as part of the operating record. The record will include the date and time of inspection, the name and address of the hauling company and driver, the type of vehicle, the size and source of the load, contents of the load, indicators of prohibited waste, and results of the inspection.

### **§330.129 FIRE PROTECTION**

#### **Fire Protection Plan**

The following steps are taken regularly at the facility to prevent fires:

## City of McCamey, Landfill

---

- Prohibiting open burning of waste is at all times at the landfill, unless requested from the permittee and approved by the TCEQ in accordance with §111.201 - §111.219.
- Preventing burning waste from incoming waste loads from being dumped in the active area of the landfill. Personnel will be alert for signs of burning waste such as smoke, steam, or heat being released from incoming waste loads.
- Fuel spills will be contained and cleaned up immediately. Soil contaminated with spilled fuel will be excavated and, if authorized, disposed of at the working face. Contaminated soils may be excavated using a shovel for small areas or with heavy equipment as appropriate.
- Landfill equipment will not remain in the vicinity of exposed waste overnight.
- Equipment that is used at the working face will be routinely cleaned as deemed necessary to remove combustible waste and caked material, which can cause equipment overheating and increase fire potential. If equipment is cleaned at the working face, the amount of water used will be minimized.
- Dead trees, brush, or vegetation adjacent to the active portion of the landfill will be removed immediately, and grass and weeds mowed at least semi-annually so that forest, grass, or brush fires cannot spread to the landfill or off-site.
- Smoking is not permitted on the active areas of the landfill site.
- Soil cover and non-flammable alternate covers will be used on a daily basis.

### Procedures in the Event of a Fire:

Landfill staff will take the following steps if a fire is discovered:

- Contact the local fire department.
- Alert other facility personnel.
- Assess extent of fire, possibilities for the fire to spread, and alternatives for extinguishing the fire.
- Upon arrival of local fire department personnel, direct them to the fire and provide assistance as appropriate.
- Do not attempt to fight the fire alone. Do not attempt to fight the fire without adequate personal protective equipment. Be familiar with the use and limitations of firefighting equipment available onsite.

### Fire Fighting Methods:

Fire fighting methods for burning solid waste include smothering with soil, separating burning material from other waste, spraying with water if available from an on-site water truck. Small fires might be controlled with hand-held extinguishers. If the fire is at an active disposal area, if possible, the burning waste will be isolated or pushed away immediately before the fire can spread, or firebreaks will be cut around the fire before it can spread. If moving the waste is not possible, or if it is unsafe, efforts will be made to cover the working face with earth immediately to smother the fire. The faster that soil can be placed over the fire, the more effective this method will be in controlling and extinguishing the fire. If a fire is in the working face, the burning area will be isolated and pushed away from the working face quickly, or firebreaks will be cut around the fire before it can spread. If this is not possible or this is unsafe, efforts to cover the working face with earth will be initiated immediately to smother the fire. The stockpiled daily earthen cover material may be used for firefighting purposes.

If a fire occurs on a vehicle or pieces of equipment, the equipment operator will bring the vehicle or equipment to a safe stop. If safety of personnel will allow, the vehicle will be parked away from fuel supplies, uncovered solid wastes, and other vehicles. The engine will be shut off and the brake engaged to prevent movement of the vehicle or piece of equipment.

City of McCamey, Landfill

Earthen Material Coverage:

Landfill fires will normally be extinguished by smothering with cover material spread by a dozer or other suitable equipment. A minimum of 167 cubic yards of soil or enough soil to cover the working face with at least six inches of compacted soil will be stockpiled within 1,500 feet of the working face for this purpose.

For example, 167 cubic yards of soil required for a six-inch cover on a maximum 50' x 150' active working face with over a twenty percent contingency included is calculated as follows:

$$7,500 \text{ s.f.} \times 0.5 \text{ ft depth} = 3,750 \text{ ft}^3$$

$$3,750 \text{ ft}^3 / 27 \text{ ft}^3/\text{yd}^3 = 139 \text{ yd}^3 \times 120\% \text{ contingency} = 167 \text{ yd}^3 \text{ for stockpile}$$

A daily log will be maintained documenting the location of the stockpile, the distance of the stockpile from the working face, the volume of the stockpile, the use and replacement of soil for fire control, and demonstration that the amount of stockpiled soil is adequate to cover the largest working face in use on that day. The operator will, at all times, maintain sufficient equipment for moving the soil stockpile and placing a six-inch soil cover over the working face within one hour of detecting a fire at the working face.

Earthen Material Distance from Working Face:

A stockpile of earthen material adequately sized to cover the working face will be maintained at all times within 1,500 feet (i.e. in order to cover the working face within one hour, as provided in the following demonstration) of the working face or active disposal area. The source will be sized to cover the working face with a six-inch layer of earthen material. The following calculations are presented to demonstrate the adequacy of earthen material stockpile that will be maintained within 1,500 feet of the working face.

Demonstration of Stockpile Adequacy: The typical size of the working face will be approximately 50' x 150' (7,500 square feet). For covering this size of working face, the required stockpile will be 167 cubic yards (i.e., 7,500 sq.ft. x 0.5 ft (cover) = 3,750 cubic feet or 139 cubic yards x 120% contingency = 167 total cubic yards). This earthen volume would be distributed across the working face by one of the earthmovers on-site. Additional equipment will be used, if applicable, to smother the fire within one hour of being detected.

Example calculations:

Volume of Daily cover:	167	cy
Size of Haul Trucks:	8	cy
Number of Haul Trucks:	2	
Number of Loads:	21	
Time to Load:	1	min
Average Truck Speed:	30	mph
Average Truck Speed:	2,640	ftm
Average Equipment Trip Time:	15	min
Average Truck Time Round Trip:	2	min
Length of Time to Cover Working Face:	<u>32-47</u>	min
Distance From Working Face:	1,500	ft

Fire Equipment:

The site will be equipped with fire extinguishers of a type, size, location, and number as recommended by the local fire department. Each fire extinguisher will be fully charged and ready for use at all times. Each extinguisher will be inspected on an annual basis and recharged as necessary. A qualified service

## City of McCamey, Landfill

---

company will perform these inspections, and all extinguishers will displace a current inspection tag. Inspection and recharging will be performed following each use. At a minimum, all landfill equipment and vehicles will be equipped with Class ABC fire extinguishers with a minimum U-L rating of 1A:10B:C.

### Fire Protection Training:

Training of on-site personnel in firefighting techniques, fire prevention, response, and the fire protection aspects of the SOP will be provided, by established professionals, on an annual basis. Personnel will be familiar with the use and limitations of firefighting equipment available onsite. Records of this training will be included in the Site Operating Record for the facility.

### TCEQ Notification:

After any fire (related to waste management activities that cannot be extinguished within 10 minutes of discovery) occurs, the TCEQ regional office will be contacted. The notification to the regional office will include:

- Contact by telephone as soon as possible, but no later than four hours following fire discovery, and
- Provide a written description of the cause and extent of the fire and the resulting fire response within 14 days of fire detection.

Landfill fires frequently cause concern on the part of nearby landowners, who turn to the TCEQ's regional office for information. Because of this, the facility will provide to the appropriate TCEQ regional office as much information as possible regarding the fire and fire-fighting efforts, as soon as possible after the fire occurs.

The fire prevention and fire control procedures for the facility will be revisited following the occurrence of a significant fire to determine if modifications are warranted.

## **§330.131 ACCESS CONTROL**

### Site Security:

Public access will be controlled to minimize unauthorized vehicular traffic, unauthorized and illegal dumping, and public exposure to hazards associated with landfills. Controlled access will be obtained by fences and gates. A four foot tall barbed wire fence is constructed along the perimeter of the County owned property surrounding the Landfill and a lockable pipe gate is located at the Facility entrance. A perimeter fencing consisting of barbed wire, woven wire, wooden fencing, plastic fencing, pipe fencing, or other suitable material will be maintained around the Facility. A lockable gate constructed of suitable fencing materials is maintained at the facility entrance as shown on the site layout plan. The gate will be locked at all times when the facility is not accepting waste.

### Vehicle Access:

Public access roads to the landfill are paved, all-weather roads. Entry to the active portion of the site will be restricted to designated personnel, approved waste haulers, and properly identified persons whose entry is authorized by site management. Visitors may be allowed on the active area only when accompanied by a site representative. Signage will be provided along the entrance road directing traffic to the unloading area. The operator will restrict site access to authorized vehicles and direct these vehicles appropriately.

**City of McCamey, Landfill**

---

Waste hauling vehicles will be directed to appropriate fill areas by signs located along the landfill haul road and access road. These vehicles will deposit their loads and depart the site. Private, commercial, or public solid waste vehicles will not be allowed access to any areas other than the active portion of the landfill. Site personnel will provide traffic directions as necessary to facilitate safe movement of vehicles.

Within the site, signs will be placed along the landfill haul road and access road at a frequency adequate for users to be able to understand where disposal areas are and which roads are to be used. Roads not being used for access to disposal areas will be blocked or otherwise marked for no entry.

The facility will comply with the following schedule and notification requirements for any access breach:

<b>Requirements</b>	<b>Access Breach Repaired within 8 hours</b>	<b>Access Break Not permanently repaired in 8 hours</b>
Notify region office of breach and repair schedule	Not required	Within 24 hours
Make temporary repairs	Not required	Within 24 hours
Make permanent repairs	Within 8 hours	Within schedule submitted to regional office in initial notice
Notify regional office when permanent repair completed	Not required	Within schedule submitted to regional office in initial notice

**§330.133 UNLOADING OF WASTE**

The unloading of solid waste is to be confined to as small an area as practical. The maximum size of the unloading area will be approximately 50 feet in length by 100 feet in width.

The unloading of waste in unauthorized areas is prohibited. Any waste deposited in an unauthorized area will be removed immediately and disposed of properly. Trained personnel will monitor all incoming loads of waste, and will direct traffic to the appropriate unloading area. There will be one general purpose waste unloading area. Trained personnel will also be on duty during operating hours at the working face to direct and monitor unloading of solid waste.

Trained personnel will monitor the incoming waste. These personnel will be familiar with the rules and regulations governing the various types of waste that can or cannot be accepted into the facility, including knowledge of 30 TAC §330.133. The personnel will also have a basic understanding of both industrial and hazardous waste and their transportation and disposal requirements. The facility is not required to accept any solid waste that may cause problems in maintaining full and continuous compliance with the permit.

Certain wastes are prohibited from disposal at this facility. Prohibited wastes are described in 'Detection and Prevention of the Disposal of Prohibited Wastes' section of this plan. The unloading of prohibited wastes at the facility will not be allowed. Necessary steps will be taken by the site superintendent to ensure compliance. Landfill personnel have the authority and responsibility to reject unauthorized loads, have unauthorized material removed by the transporter, and/or assess appropriate surcharges, and have the unauthorized material removed by on-site personnel or otherwise properly managed by the facility. Any prohibited waste not discovered until after unloading will be placed back in the offending transporter's vehicle, if possible, or otherwise returned promptly to the transporter or generator of the

## City of McCamey, Landfill

---

waste. The driver may be advised where the waste may be disposed of legally and will be responsible for the proper disposal of this rejected waste.

In the event the unauthorized waste is not discovered until after the vehicle that delivered it is gone, the waste will be segregated and controlled as necessary. An effort will first be made to identify the entity that deposited the prohibited waste and have them return to the site and properly dispose of the waste. In the event that identification is not possible, the landfill manager/supervisor will notify the TCEQ and seek guidance on how to dispose of the waste as soon as practical. A record of unauthorized material removal will be maintained in the Site Operating Record.

Only those persons operating vehicles that comply with the following requirements will be authorized by the landfill to dispose of waste at this site:

- All vehicles and equipment used for the collection and transportation of waste will be operated, and maintained to prevent loss of waste material and to limit health and safety hazards to landfill personnel and the public.
- Collection vehicles and equipment will be maintained in a sanitary condition to preclude odors and fly breeding.
- Collection vehicles not equipped with an enclosed transport body will use other devices such as nets or tarpaulins to preclude accidental spillage.

Landfill personnel will keep vigilant watch for compliance with operating requirements. Signs with directional arrows and/or portable traffic barricades will help to restrict traffic to designated disposal locations. Signs will be placed along the access route to the current disposal area. In addition, rules for waste disposal and prohibited waste will be prominently displayed on signs at the site entrance.

### **§330.135 FACILITY OPERATING HOURS**

The hours of waste operation are as follows:

- The facility will be open to the public between the hours of ~~9:00 a.m. and 12:00 p.m., and 1:00 p.m. and 4:00 p.m. Tuesday through Wednesday,~~ and ~~9:00 a.m. and 16:00 p.m. Saturday,~~ except for certain holidays. These hours will be posted on a sign at the entrance of the landfill.
- The site operating hours are from ~~7:00 a.m. to 6:00 p.m. Tuesday through Wednesday,~~ and ~~7:00 a.m. and to 37:00 p.m. Saturday,~~ except for certain holidays.

Public and operating hours shall be Tuesday, Wednesday, Thursday and Saturday 9-12 and 1-6.

Daily cover will be applied as soon as possible, but not more than one hour after closure to the public on the working face.

In addition, the facility may request alternative operating hours to accommodate special occasions, special purpose events, holidays, or other special occurrences. Alternative operating hours will be documented in the operating record. The facility will notify the regional office five days in advance for these alternative hours.

When warranted, the facility supervisor will request approval from the commission's regional office to allow additional temporary operating hours to address disaster or other emergency situations, or other unforeseen circumstances (such as traffic delays or adverse weather) that could result in the disruption of waste management services in the area. The facility supervisor will document the reason or reasons for the delay for each day on which a delay occurs and place the documentation in the operating record.

### **§330.137 SITE SIGN**

A conspicuous sign measuring a minimum four feet by four feet will be maintained at the public entrance to the site. The sign states, in letters at least three inches high, the following information:

City of McCamey, Landfill

- **Type of MSW Facility:** City of McCamey - Type IV-AE MSW Landfill
- **Authorized by TCEQ Permit Number:** MSW Permit No. 566
- **Hours of Operation:** Open to the Public - Tuesday through Wednesday Tuesday, Wednesday,  
9:00 a.m. and 12:00 p.m. Thursday and Saturday  
1:00 p.m. and 4:00 p.m. 9-12 and 1-6  
Saturday  
9:00 a.m. and 1:00 p.m.
- **Emergency 24-hour Contact Number:** (432) 693-2422/208-5384 432-530-5963
- **Local Emergency Fire Department Number:** (432) 693-2422-911

The sign will be visible and readable from the facility entrance. A sign prohibiting receipt of hazardous waste and closed drums and prohibiting smoking will be posted near the facility entrance. A sign will be prominently displayed at the facility entrance stating that all loads will be properly covered or otherwise secured.

**§330.139 CONTROL OF WINDBLOWN SOLID WASTE AND LITTER**

Windblown waste and litter will be controlled through several methods, including proper unloading, compaction, and cover procedures. The use of portable litter control fences (as necessary), the orientation of the working face relative to the prevailing wind direction, stockpiles and landscaping and maintaining the active working face to as small an area as practical will provide control of windblown waste and litter. Personnel will police the landfill site, including fences, access roads, and the entrance gate, every operating day to pick up and return windblown waste and litter to the active working face and perform such other litter control measures, as necessary.

A log of daily cleanup will be placed in the operating record.

Daily cover will be placed on top of the waste lift as soon as it is practical for any portion of the lift that reaches recommended lift height. The Type IV working face will be covered at least weekly.

**§330.141 EASEMENTS AND BUFFER ZONES**

Southern Union Gas Company has an easement across the entrance road of the landfill, parallel to F.M. 305. This easement has no affect on landfill operations. (see Site Development Plan, Attachment 1.

No solid waste unloading, storage, disposal, or processing operations will occur within any easement, buffer zone, or right-of-way that crosses the site. No solid waste disposal will occur within 25 feet of the center line of any utility line or pipeline easement, unless otherwise authorized by the executive director. All pipeline and utility easements are clearly marked with posts, which extend at least six feet above ground level, spaced at intervals no greater than 300 feet. The buffer zones may vary around the perimeter of the site, but in no case will they be less than 50 feet. All buffer zones, as depicted in the site design, will be clearly marked as specified by TCEQ rules.

**§330.143 LANDFILL MARKERS AND BENCHMARK**

Landfill markers clearly mark significant features as described in 30 TAC §330.143(b). The markers are steel or wooden posts (or other TCEQ-approved material) and extend at least 6 feet above the ground surface. The markers will be maintained unobscured by vegetation and will be placed in sufficient numbers to clearly indicate the required boundaries. Markers that are removed, or destroyed, or determined to not meet regulatory requirements will be replaced within 15 days of their removal or destruction. Landfill markers will be inspected on a monthly basis and will be maintained and repaired on a scheduled basis. Markers are repainted, repaired, or replaced to maintain visibility within 15 days.

Guidelines for type, placement, and color coding of markers are provided below. The required landfill markers are:

Site Operating Plan

Page 15

September 13, 1995

Prepared by: Landgraf, Crutcher, and Associates, Inc. TBPE NO. 1363

Revised: February 7, 2007; September 2, 2009, December 7, 2009 August 19, 2025

**City of McCamey, Landfill**

<b>Marker</b>	<b>Color</b>
Site Boundary	Black
Buffer Zone	Yellow
Easements	Green
Grid System	White
Floodplain	Blue

A permanent benchmark has been established at the facility. The benchmark is a bronze <sup>or brass</sup> survey marker set in concrete with the elevation and the survey date stamped on it. The benchmark will be repaired or reset within 30 days of any disturbance of the benchmark.

**§330.145 MATERIALS ALONG THE ROUTE TO THE SITE**

The City of McCamey Landfill will take steps to encourage that vehicles hauling waste to the landfill are enclosed or provided with a tarpaulin, net, or other means to effectively secure the load in order to prevent the escape of any part of the load by blowing or spilling. The City of McCamey Landfill will take actions such as posting signs, reporting offenders to proper law enforcement officers, adding surcharges, or similar measures. On days when the landfill is in operation, the operator will clean up waste materials spilled along and within the right-of-way of public access roads serving the facility for a distance of two miles in either direction from any entrances used for the delivery of waste to the facility at least one time each day. City of McCamey Landfill will consult with the Texas Department of Transportation or county and/or local governments with maintenance authority over the roads, concerning the cleanup of public access roads and rights-of-way.

**§330.147 DISPOSAL OF LARGE ITEMS**

Large, heavy, or bulky items which cannot be incorporated in the regular spreading, compaction, and covering operations at landfills will be recycled. This special area will be moved from time to time to accommodate the working conditions. This special collection area will be designated as a large-item salvage area. City of McCamey Landfill will remove the items from the site often enough to prevent these items from becoming a nuisance and to preclude the discharge of any pollutants from the area.

Items classified as large, heavy or bulky can include, but are not limited to, white goods (household appliances), air condition units, metal tanks, large metal pieces, and automobiles.

Refrigerators, freezers, air conditions, and any other items containing chlorinated fluorocarbon (CFC) will be handled in accordance with 40 CFR §82.156(f), as amended.

**§330.149 ODOR MANAGEMENT PLAN**

City of McCamey Landfill will comply with commission rules concerning burning and air pollution control. The City of McCamey Landfill will ensure that any unit of the municipal solid waste facility does not violate any applicable requirement of the approved state implementation plan developed under the Federal Clean Air Act, §110, as amended, and 30 TAC §330.5(d) of this title (relating to General Prohibitions), which prohibits the open burning of waste at any municipal solid waste landfill facility.

City of McCamey will ensure that the municipal solid waste facility does not violate any applicable air quality requirement in Part III, Attachment 14 - Landfill Gas Management Plan.

**Odor Management Plan:**

Sources of Odor. Potential odor sources associated with a municipal solid waste landfill facility include the wastes being delivered to the landfill, the open working face, ponded water, and landfill gas. Many of

## City of McCamey, Landfill

---

the wastes received at the landfill have the potential for becoming an odor source as they biodegrade during the decomposition process. Pondered water and landfill gas could become sources of odor as well.

**Odor Control.** Methods used to control odors include waste management procedures, the placement of cover materials, the control of pondered water, and landfill gas control. These methods, described below, are also included in Part III, Attachment 14 – Landfill Gas Management Plan.

Wastes will be deposited at the working face, spread into layers that can be readily compacted, and covered with a minimum of six inches of soil or with an approved alternate daily cover material. Dead animals will be covered immediately upon placement into the working face with three feet of waste or two feet of soil. Waste that is identified as particularly odorous by landfill personnel will be buried immediately upon receipt in the working face with prompt compaction and covered with incoming waste and/or daily cover.

### **§330.151 DISEASE VECTOR CONTROL**

The need for vector control (control of rodents, flies, mosquitoes, etc.) will be minimized through daily site operations. Activities designed to control on-site populations of disease vectors include minimization of the size of the active working face; placement and compaction of daily, intermediate, and final cover; preventing pondered water at the site; and following the detailed procedures described in this SOP. The City of McCamey Landfill will conduct daily inspections to observe waste disposal operations to remove areas that may be conducive to insects and rodents. These areas will be promptly eliminated in accordance with procedures established in this SOP. Should daily site operations not control vectors, a licensed professional will apply pesticides to ensure that proper chemicals are used and that they are properly applied.

### **§330.153 SITE ACCESS ROADS**

City of McCamey will abide by the following aspects regarding site access roads:

Tracked mud and associated debris at the entrance to the facility and on the public roadway at the entrance to the facility and trash on public roadways will be removed at least once per day on days when mud and associated debris are being tracked onto the public roadway, to the extent that mud can be reasonable considered to be associated with landfill operations.

The City of McCamey Landfill will keep records to demonstrate compliance with the requirement.

Dust from on-site and other access roadways will not become a nuisance to surrounding areas. A water source and necessary equipment or other means of dust control approved by the TCEQ executive director will be provided.

Litter and any other debris on-site and other access roadways will be picked up at least daily and taken to the disposal area.

Access roadways will be regraded to minimize depressions, ruts, and potholes.

For tracking of mud and trash onto public roadways, the paved entrance road and crushed-stone (or similar material) internal roads will provide mud control for the waste hauling vehicles prior to exiting the site and returning to public access roads.

For dust from on-site and other access roadways, the landfill haul roads and access roads will be maintained in a reasonable dust-free condition by periodic spraying from a water truck.

## City of McCamey, Landfill

---

For maintenance of on-site and other access roadways, in addition to stockpiles or crushed stone, the facility may stockpile concrete rubble, masonry, or other similar material used in maintaining passable access roads. Grading equipment will be used weekly or as necessary to control or remove mud accumulations on roads.

### **§330.155 SALVAGING AND SCAVENGING**

Salvaging will not be allowed to interfere with prompt sanitary disposal of solid waste or to create public health nuisances. Salvaged materials will be considered as potential recyclable materials and will be stored in a designated collection area. The collection area will be identified in the site operating record. Salvaged items will be recycled often enough to prevent an excessive accumulation of the material at the site to prevent odor or other nuisance conditions from developing and to eliminate the risk of discharge of pollutants. Scavenging will not be allowed.

Pesticide, fungicide, rodenticide, and herbicide containers will not be salvaged unless they are salvaged through a state-supported recycling program. Salvaging of special waste will be prohibited. Salvaging of wastes will not occur where waste has been covered with daily cover.

### **§330.157 ENDANGERED SPECIES PROTECTION**

The facility and the operation of the facility will not result in the destruction or adverse modification of the critical habitat of endangered or threatened species, or cause or contribute to the taking of any endangered or threatened species.

An assessment of the potential effects of the landfill on threatened and/or endangered species was conducted based upon data available from the Texas Parks and Wildlife Department. The results of the evaluation are that the Texas Parks and Wildlife Department's Texas Heritage Program has no presently known occurrences of sensitive species or natural communities in the vicinity of the landfill.

### **§330.159 LANDFILL GAS CONTROL**

Due to the minimal amount of Type II waste (less than 6 acres) deposited at the landfill and because all future waste will be construction and demolition debris only, it is not anticipated that migration of landfill gas will occur.

The control and monitoring of landfill gas for the City of McCamey Landfill will be in accordance with Part III, Attachment 14 - Landfill Gas Management Plan. The Landfill Gas Management Plan was developed in accordance with §330.5663(a)(g). The gas management plan provides for inclusion of applicable documentation in the Site Operating Record, and for submittal to the executive director.

### **§330.161 OIL, GAS, AND WATER WELLS**

There are no known water wells or oil wells on the landfill property. If a water well is encountered City of McCamey, within 30 days of such a discovery, provide the executive director with such notification and written certification that such wells have been capped, plugged, and closed in accordance with all applicable rules and regulations of the commission or other state agency.

If a crude oil or natural gas wells, or other wells associated with mineral recovery is encountered that is under the jurisdiction of the Railroad Commission of Texas, City of McCamey shall provide the executive director with written notification of the location of any such well within 30 days after discovery during the course of facility development. Within 30 days after plugging of such well, City of McCamey

## City of McCamey, Landfill

will give written certification to the TCEQ that the wells have been properly capped, plugged, and closed in accordance with all applicable rules and regulations of the Railroad Commission of Texas.

### **§330.163 COMPACTION**

Uniform compaction levels throughout the site will be promoted by limiting the thickness of each compaction layer and the use of landfill equipment. Deposition of materials along the working faces will be controlled by site personnel.

### **§330.165 LANDFILL COVER**

- (a) **Weekly Cover** – The City of McCamey Landfill will apply six inches of well-compacted earthen material not previously mixed with garbage, rubbish, or other solid waste at a rate no less than weekly. Runoff from areas that have intact weekly cover is not considered as having come into contact with the working face or leachate.
- (b) **Intermediate Cover** – The City of McCamey Landfill will cover all areas that have received waste but will be inactive for longer than 180 days with intermediate or final cover. Intermediate cover will include six inches of suitable earthen material that is capable of sustaining native plant growth and will be seeded or sodded following its application in order to control erosion, or will be a material approved by the executive director that will otherwise control erosion. This intermediate cover will be not less than 12 inches of suitable earthen material. The intermediate cover will be graded to prevent ponding of water, and plant growth or other erosion control features will be maintained. Runoff from areas which have received intermediate cover will not be considered as having come into contact with the working face or leachate for the purpose of 30 TAC §330.305(g) of this title (relating to Site Development Plan).
- (c) **Alternate Material Daily Cover** – The City of McCamey Landfill does not plan to use alternate material daily cover (ADC); however, if the City decides to utilize ADC, the City will request a temporary authorization under 30 TAC §305.70(m) followed by a permit modification in accordance with 30 TAC §305.70(k)(1).
- (d) **Final Cover** – The City of McCamey Landfill will install final cover over the landfill in accordance with the site Closure Plan – Part III, Attachment 12 and Subchapter K of 30 TAC Chapter 330 (relating to Closure and Post-Closure).
- (e) **Erosion of Cover** – The City of McCamey Landfill will maintain the final cover system during and after construction. During the active life of the site, the landfill will inspect the final cover system on a weekly basis, in addition to immediately following a significant rainfall event. Erosion gullies or washed-out areas of the intermediate or final cover will be repaired within 5 days of detection. Repair of final cover includes restoring cover, grading, compacting, and seeding as required. Should additional time be required for repairs due to weather related delays, the landfill will request from the regional office approval of an alternate schedule. Post-closure care inspection and repair procedures of the final cover are outlined in Part III, Attachment 13 – Post-Closure Plan.
- (f) **Cover Inspection Record** – The City of McCamey Landfill will keep a cover application record on site readily available for inspection by commission representatives and authorized agents or employees of local governments having jurisdiction. This record will specify the date cover (no exposed waste) was accomplished, how it was accomplished, and the last area covered. This applies to daily, intermediate, and alternate daily cover. For final cover, this record will specify the area covered, the date cover was applied, and the thickness applied that date. Each entry will be certified by the signature of the on-site supervisor that the work was accomplished as stated in the record.

### **§330.167 PONDED WATER**

The ponding of water over waste on a landfill, regardless of its origin, will be prevented. Pounded water that occurs in the active portion of the landfill or on the closed landfill will be eliminated and the area in which the ponding occurred will be filled in and regraded within seven days of the occurrence.

## City of McCamey, Landfill

---

If the ponded water has come into contact with waste, or waste-contaminated soils, it will be eliminated by pumping it from the area as quickly as possible and disposed of at a TCEQ authorized treatment facility.

### **§330.169 WASTE IN ENCLOSED CONTAINERS OR ENCLOSED VEHICLES ACCEPTED AT TYPE IV LANDFILLS**

No waste in enclosed containers or enclosed vehicles will be accepted. If in the future the City chooses to accept waste in enclosed containers or enclosed vehicles, it will be in accordance with the requirements in §330.169(1)–(3).

### **§330.171 DISPOSAL OF SPECIAL WASTES**

The acceptance and/or disposal of a special waste as defined in 30 TAC §330.2 (relating to Definitions) which is not specifically identified in subsections (c) or (d) of 30 TAC §330.171, or in 30 TAC §330.173 (relating to Disposal of Industrial Wastes) will not be accepted at the City of McCamey Landfill without prior written approval from the executive director, with the exception of dead animals and/or slaughterhouse waste, and nonregulated asbestos-containing materials (non-RACM). Dead animals and/or slaughterhouse waste are covered by three feet of other solid waste or at least two feet of earthen material immediately upon receipt. Non-RACM will be placed on the active working face and under no circumstances will any material containing non-RACM be placed on any surface or roadway that is subject to vehicular traffic or disposed of by any other means by which the material could be crumbled into a friable state.

### **§330.173 DISPOSAL OF INDUSTRIAL WASTES**

The City of McCamey Landfill will not accept Class 1 industrial solid waste. The facility will accept the following:

- Class 2 and Class 3 Industrial Nonhazardous Waste (e.g., plant trash, card board, wood pallets, adhesive glue, rubber gloves, packing sawdust, and plastic wrap) that can be routinely disposed of without special handling or processing. The Class 2 and Class 3 wastes will be disposed of at the City of McCamey Landfill without interfering with facility operations. These waste streams must exhibit the same disposal characteristics as routine municipal solid waste. The management of these waste streams may not cause the operation of the facility to deviate from the operational standards or other applicable Federal, State or Local regulations.

### **§330.175 VISUAL SCREENING OF DEPOSITED WASTE**

The City of McCamey Landfill will visually screen any deposited waste materials where the executive director determines that screening is necessary or where permit or design requirements so dictate.

### **§330.177 LEACHATE AND GAS CONDENSATE RECIRCULATION**

Leachate or gas condensate recirculation or application is prohibited at the City of McCamey Landfill.

# CYPRIC NATURAL

**CITY OF McCAMEY LANDFILL  
McCAMEY, UPTON COUNTY, TEXAS  
TCEQ PERMIT NO. MSW - 566**

**PART IV  
SITE OPERATING PLAN**

**SUBMITTED BY:**

**CITY OF McCAMEY  
P.O. BOX 1409  
McCAMEY, UPTON COUNTY,  
TEXAS 79752**

***Prepared by:***

**Landgraf, Crutcher and Associates, Inc.  
TBPE NO. 1363  
521 N. Texas Ave.  
Odessa, Texas 79761  
432-332-5058**

**September 13, 1995  
Revised:  
February 7, 2007  
September 2, 2009  
December 7, 2009**



*John F. Landgraf*  
*10 Dec 09*  
**For Permitting Purposes Only**

**CITY OF McCAMEY LANDFILL  
PART IV**

**TABLE OF CONTENTS**

§330.65 CONTENTS OF PART IV OF THE APPLICATION ..... 1

§330.125 RECORDKEEPING REQUIREMENTS ..... 1

§330.127 SITE OPERATING PLAN ..... 3

§330.127(1) Landfill Personnel ..... 3

§330.127(2) Equipment ..... 4

§330.127(3) Operational Requirements ..... 4

§330.127(4) Personnel Training ..... 6

§330.127(5) Detection and Prevention of the Disposal of Prohibited Waste ..... 7

§330.129 FIRE PROTECTION ..... 9

§330.131 ACCESS CONTROL ..... 12

§330.133 UNLOADING OF WASTE ..... 13

§330.135 FACILITY OPERATING HOURS ..... 14

§330.137 SITE SIGN ..... 14

§330.139 CONTROL OF WINDBLOWN SOLID WASTE AND LITTER ..... 15

§330.141 EASEMENTS AND BUFFER ZONES ..... 15

§330.143 LANDFILL MARKERS AND BENCHMARK ..... 15

§330.145 MATERIALS ALONG THE ROUTE TO THE SITE ..... 16

§330.147 DISPOSAL OF LARGE ITEMS ..... 16

§330.149 ODOR MANAGEMENT PLAN ..... 16

§330.151 DISEASE VECTOR CONTROL ..... 17

§330.153 SITE ACCESS ROADS ..... 17

§330.155 SALVAGING AND SCAVENGING ..... 18

§330.157 ENDANGERED SPECIES PROTECTION ..... 18

§330.159 LANDFILL GAS CONTROL ..... 18

*John F. Landgraf*

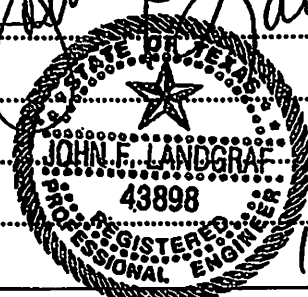

10/2/09

City of McCamey, Landfill

§330.161 OIL, GAS, AND WATER WELLS..... 18

§330.163 COMPACTION ..... 18

§330.165 LANDFILL COVER ..... 19

§330.167 PONDED WATER ..... 19

§330.169 WASTE IN ENCLOSED CONTAINERS OR ENCLOSED VEHICLES  
ACCEPTED AT TYPE IV LANDFILLS..... 19

§330.171 DISPOSAL OF SPECIAL WASTES ..... 20

§330.173 DISPOSAL OF INDUSTRIAL WASTES ..... 20

§330.175 VISUAL SCREENING OF DEPOSITED WASTE..... 20

§330.177 LEACHATE AND GAS CONDENSATE RECIRCULATION ..... 20

*John F. Landgraf*



For Permitting Purpose Only  
10/18/2009  
pages i through ii

**CITY OF McCAMEY LANDFILL  
PART IV - SITE OPERATING PLAN  
30 TAC §330.65**

**§330.65 CONTENTS OF PART IV OF THE APPLICATION**

The information contained in this section is the Site Operating Plan has been prepared for the City of McCamey Landfill consistent with 30 TAC §330.65 and contains the information required by 30 TAC §330.121 - §330.179. This SOP includes provisions for site management and site operating personnel to meet the general and site-specific requirements included in Subchapter D: Operational Standards for Solid Waste Land Disposal Sites for the day-to-day operation of the facility.

The City of McCamey Landfill is a Type IV-AE municipal solid waste management facility located within a 50 acre tract of land, which lies 1.25 miles southeast of the intersection of FM 305 and FM 1901, 1,000 feet east of FM 305, approximately 2 miles southeast of the City of McCamey, Upton County, Texas. The primary function of the facility is municipal solid waste disposal.

The facility provides waste disposal for the City of McCamey and the surrounding areas for an estimated site life of approximately 100 years based on the site life calculations included in Part III, D. The City of McCamey anticipates it will have a maximum waste acceptance rate not to exceed 20 tons of Type IV waste per day.

**§330.125 RECORDKEEPING REQUIREMENTS**

A copy of the permit, the approved site development plan, the site operating plan, the final closure plan, the post-closure maintenance plan, the landfill gas management plan, and any other required plan or other related document shall be maintained at the facility, 209 E 6TH St, McCamey, Upton County, Texas, or an alternate location approved by the executive director. This requirement shall be considered a part of the operating record for the facility.

The following records will be kept, maintained and filed as part of the site's Site Operating Record. Log books and schedules may be used.

- Access Control Inspection and Maintenance
- Daily Litter Pickup
- Windblown Waste and Litter Control Operations
- Management of Disposal of Large Items
- Dust Nuisance Control Efforts
- Access Roadway Regrading
- Salvaged Material Storage Nuisance Control Efforts
- Access Control Breach and Repair Notices
- Fire Occurrence Notices
- Documentation of Compliance with Approved Odor Management Plan
- Ponding Prevention Plan Compliance Documentation
- Special Waste Operational Plan Compliance Documentation

In addition to the plans and documents listed above, the information listed in Table 1 will be recorded and retained in the Site Operating Record. This information will be placed in the Site Operating Record within seven working days of completion or upon receipt of analytical data, as appropriate.

The Site Operating Record will be maintained in an organized format, which allows the information to be easily located and retrieved. All information contained in the Site Operating Record will be furnished upon request to the TCEQ executive director and will be made available for inspection by the executive director.

City of McCamey, Landfill

All information contained within the Site Operating Record and the different required plans will be retained for the active life of the facility including the post-closure care period.

**Table 1.0 Site Operating Record**

<b>Records to be Maintained</b>	<b>Rule Citation</b>
1. Inspection records, training procedures, and notification procedures relating to excluding the receipt of prohibited waste	§330.125(b)(2)
2. All results from gas monitoring and any remediation plans relating to explosive and other gases (if required)	§330.125(b)(3)
3. Not applicable.	§330.125(b)(4)
4. Not applicable.	§330.125(b)(5)
5. Closure and post-closure care plans and any monitoring, testing, or analytical data relating to post-closure requirements	§330.125(b)(6)
6. Any and all cost estimates and financial assurance documentation relating to financial assurance for closure and post-closure requirements.	§330.125(b)(7)
7. Any and all information demonstrating continued compliance with the small community exemption criteria.	§330.125(b)(8)
8. Copies of all correspondence and responses relating to the operation of the facility, modifications to the permit, approvals, and other matters pertaining to technical assistance.	§330.125(b)(9)
9. Any and all documents, manifests, trip tickets, etc., involving special waste	§330.125(b)(10)
10. Not Applicable	§330.125(b)(11)
11. Any other document(s) specified by the approved permit or by the executive director	§330.125(b)(12)
12. Alternative schedules and notification requirements if applicable.	§330.125(g)
13. Records to document the annual acceptance rate, quarterly solid waste summary reports and the annual solid waste summary reports requirement by 30 TAC §330.675.	§330.125(h)
14. Load inspection records.	§330.127(5)(B)
15. Fire occurrence notices.	§330.129
16. Inspection records and training procedures relating to fire prevention and site safety.	§330.129
17. Access control breach and repair notices.	§330.131
18. All site inspection and maintenance documentation.	§330.131
19. Record(s) of each unauthorized material removal event.	§330.133(b)
20. Record of alternative operating hours if applicable.	§330.135(b)
21. Water, crude oil and/or natural gas well location and plugging reports if applicable.	§330.161(a)-(c)
22. Cover inspection records.	§330.165(h)
23. Not Applicable	§330.171(c)(3)(B)
24. Not Applicable	§330.171(c)(3)(B)
25. Not Applicable	§330.171(c)(3)(H)

**§330.127 SITE OPERATING PLAN**

The Site Operating Plan (SOP) will provide the site management and site operating personnel instructions in the proper operation of the site and in following and documenting the proper procedures in the day-to-day operations. The SOP will be retained during the active life of the site and throughout the post-closure care maintenance period.

**§330.127(1) Landfill Personnel**

The City of McCamey MSW Landfill will be staffed with qualified individuals experienced with municipal solid waste disposal operations and earthmoving construction projects. See Table 2 below for the City of McCamey MSW Landfill personnel types and descriptions.

**Table 2 – Personnel Type and Descriptions**

Title	Number	Minimum Qualifications	Function
Landfill Manager/ Supervisor	1	Maintains a Class B license as defined in §30.213	Responsible for: <ul style="list-style-type: none"> <li>• Ensuring overall compliance with Chapter 330</li> <li>• Long term landfill management</li> <li>• Staff management</li> <li>• Budgeting</li> <li>• Managing the working face and daily fill and cover placement operations; grading and excavating; equipment maintenance; waste leveling and compaction; application of daily cover, and general site maintenance.</li> <li>• Levies fees on landfill customers, keeps appropriate records, controls site access, and provides general customer direction and information.</li> </ul>
Equipment Operator	1	6 months minimum experience in equipment operation or on the job training by supervisor and training by landfill manager in SOP requirements for daily cover and unauthorized waste	Responsible for: <ul style="list-style-type: none"> <li>• Grading and excavating; equipment maintenance; waste leveling and compaction; application of daily cover, and general site maintenance.</li> <li>• Operators are responsible for keeping the working face in the smallest area practical and screening for unauthorized waste.</li> <li>• Pickup wind blown litter as directed.</li> </ul>
Gate Attendant	1	Training by landfill manager in the SOP rules, record keeping requirements, and waste screening training course (e.g., I.I.E.D.)	Responsible for: <ul style="list-style-type: none"> <li>• Levies fees on landfill customers, keeps appropriate records, controls site access, screening for unauthorized waste, and provides general customer direction and information.</li> </ul>

Other site personnel or laborer(s) may be employed from time to time in categories such as maintenance, construction, litter abatement, and general site cleanup. Site laborers may be permanent or part-time.

**§330.127(2) Equipment**

Initial on-site equipment will consist of the equipment presented in the following table.

**Table 3 – Landfill Facility Equipment List**

Description	Quantity	Size (may vary)	Function
Dozer	1	D3C, 933C or equivalent	Excavation of soil; waste and soil spreading and compaction; transportation of daily cover.
Pickup Truck(s)	Varies	Varies	Personnel use for litter control; maintenance.

Compactor 1 BC 67 or equivalent Pushing and compaction of solid waste  
Additional owned or rental equipment, such as, track front-end loaders, hydraulic excavators, road tractors and backhoes may be provided as necessary to enhance operational efficiency. At infrequent times, such as during equipment breakdown or periodic maintenance, additional equipment will be stationed at other city facilities and transported to the landfill as needed. Other equivalent types of equipment may be substituted on an as-needed basis to adequately maintain the landfill and meet the operational standards required by the commission's regulations in accordance with all applicable Local, State, and Federal regulations.

**§330.127(3) Operational Requirements**

Table 4 outlines the site inspection and maintenance list of the facility. The Item, Task, Frequency, Inspector and Inspection Documentation are also included.

**Table 4 – Site Inspection and Maintenance List – Operational Requirements**

Item	Task	Frequency	Inspector
Fence/Gates	Inspect perimeter fence and gates for damage. Make repairs if necessary.	Weekly	Landfill Manager / Supervisor or Design
Windblown Waste	Police working face area, wind fences, access roads, entrance areas, and perimeter fence for loose trash. Clean up as necessary.	Daily as specified in §330.139	Landfill Manager / Supervisor or Design
Waste Spilled on Route to the Site	Police the entrance areas and all roads at least 2 miles from the site entrances for loose trash. Clean up as necessary.	Daily as specified in §330.145	Landfill Manager / Supervisor or Design
Landfill Markers	Inspect all landfill markers for damage, color-coding, and general location. Correct or replace damaged markers within 15 days of discovery.	Monthly	Landfill Manager / Supervisor or Design
Site Access Road	Inspect site access road for damage from vehicle traffic, erosion, or excessive mud accumulation. Maintain as needed with crushed rock or stone. Grading equipment will be used weekly or as necessary to control or remove mud accumulations on roads as well as minimize depressions, ruts, and potholes.	Daily – more often during wet weather or extended dry weather periods.	Landfill Manager / Supervisor or Design
Daily Cover	Inspect for proper placement, thickness, and compaction. Correct problems as needed. Verify that vectors are not an issue.	Daily at the active face and all daily cover areas will be inspected.	Landfill Manager / Supervisor or Design
Intermediate Cover	Inspect for proper placement, thickness, erosion, and compaction and for presence of waste or other contamination. Correct problems as needed.	Weekly and within 72-hours of a rainfall event of 0.5 inches or more.	Landfill Manager / Supervisor or Design
Final Cover	Inspect for proper placement, thickness, compaction, slope, settlement and erosion. Maintenance will be ongoing throughout post closure care period. Correct problems as needed.	Weekly and within 72-hours of a rainfall event of 0.5 inches or more.	Landfill Manager / Supervisor or Design
Site Signs	Inspect all site signs for damage, general location, and accuracy of posted information.	Weekly	Landfill Manager / Supervisor or Design
Ponded Water	Inspect site for unauthorized ponded water areas as described in §330.167. Correct problems as necessary.	Weekly and within 72-hours of a rainfall event of 0.5 inches or more.	Landfill Manager / Supervisor or Design
Odor	Inspect the perimeter of the site to assess the performance of site operations to control odor.	Daily	Landfill Manager / Supervisor or Design

Site Operating Plan

September 13, 1995

Revised: February 7, 2007; September 2, 2009, December 7, 2009 August 19, 2025

Prepared by: Landgraf, Cru

City of McCamey, Landfill

**§330.127(4) Personnel Training**

Personnel training records will be maintained in accordance with 30 TAC §335.586(d) and (e).

Personnel operator licenses issued in accordance with 30 TAC, Subchapter F (relating to Municipal Solid Waste Facility Supervisors) will be maintained as required.

Table 5 lists the applicable training requirements per 30 TAC §335.586(a) and (c) by position.

**Table 5 – Job Positions, Descriptions and Training Requirements**

<u>Position</u>	<u>Job Description</u>	<u>Training</u>										
		Site Orientation	Site Operations	Endangered Species	Haz Waste Identification	Safety (Job specific)	Fire Prevention	Load Inspection	Emergency Response	License	Litter Control	Random Inspections
Landfill Manager/ Supervisor	<ul style="list-style-type: none"> <li>Responsible for all landfill activities,</li> <li>Ensure adequate staffing and inspections,</li> <li>Manage LF staff and waste operations</li> </ul>	X	X	X	X	X	X	X	X	A or B	X	X
Equipment Operator	<ul style="list-style-type: none"> <li>Compact waste,</li> <li>Visual inspection of waste,</li> <li>Apply cover</li> </ul>	X	X	X	X	X	X	X	X		X	X
Gate Attendant	<ul style="list-style-type: none"> <li>Take receipts,</li> <li>Visual inspection of loads,</li> <li>Direct vehicles to unloading areas</li> </ul>	X	X	X	X	X	X	X	X		X	X

More detailed job descriptions along with written descriptions of the type and amount of introductory and continued training provided to each employee will be maintained in the facility Site Operating Record.

**Training Requirements**

City of McCamey will ensure that the landfill manager/supervisor (M/S) at the site is knowledgeable in the proper operation of a municipal solid waste landfill and the current operational standards required by the TCEQ. The M/S will be an experienced manager/supervisor and will maintain a Class A, B, or C license (as defined in 30 TAC §30.210) as required in 30 TAC §30.213. It will be the responsibility of the landfill M/S to ensure that all landfill personnel are properly trained and are operating the landfill in accordance with this SOP and operational standards required by the permit and the TCEQ municipal solid waste regulations.

## City of McCamey, Landfill

---

The personnel training program will be directed by a person trained in waste management procedures, and will include instruction that teach facility personnel waste management procedures and contingency plan implementation relevant to the positions in which they are employed.

New employees will receive a comprehensive overview of all aspects of landfill operations, focusing on information that is necessary to protect the health and welfare of the new employee and enable them to perform their duties in accordance with this SOP and operational standards required by the permit and the TCEQ municipal solid waste regulations. Following initial training, new employee training will continue during periodic training sessions consisting of on-the-job training.

The City of McCamey Landfill personnel will receive training through a combination of classroom instruction and on-the-job training. The training program will provide instruction to personnel to allow performance of their duties to ensure facility compliance. This training program will be directed by a senior staff member of the City of McCamey that is experienced and trained in municipal solid waste management procedures. The facility personnel will be trained in procedures relevant to the position they are employed. In-house training will address the following topics:

- Safety
- Fire protection, prevention, and evacuation
- Fire extinguisher use
- Emergency response
- Litter control and windblown waste pick-up
- Hazardous waste and PCB waste detection and control (waste screening), if applicable
- Prohibited waste management
- Properties of methane gas and safety procedures for methane gas, if applicable
- Random inspection procedures

The City of McCamey MSW Landfill facility personnel must successfully complete the in-house training program within 6 months of employment or assignment to this facility. Documentation of training will be placed in the site operating record as required by Recordkeeping Requirements section of the SOP.

The City Administrator, landfill manager/supervisor, and other personnel will receive training at TCEQ-sponsored or approved training courses, as deemed appropriate by City of McCamey management. The Institute for Infrastructure in Environmental Development (IIED) provides courses in the Class A, B, C, and D certification for municipal solid waste facilities, waste screening, transfer station, and safety. The IIED provides training and certification in accordance with §330.381 through §330.391. Other qualified TCEQ or other consultants may also provide training as appropriate.

### **§330.127(5) Detection and Prevention of the Disposal of Prohibited Waste**

#### **Prohibited Wastes**

The acceptance and disposal of the following prohibited wastes shall not be allowed at this site.

- Regulated hazardous waste as defined in 40 Code of Federal Regulations (CFR) Part 261, will not be accepted for disposal or disposed.
- Polychlorinated Biphenyls (PCBs) waste as defined in accordance with 40 CFR Part 761, will not be accepted for disposal or disposed.
- Lead acid storage batteries will not be intentionally or knowingly accepted for disposal.
- Do-it-Yourself (DIY) used motor vehicle oil will not be intentionally or knowingly accepted for disposal.
- Used-oil filters from internal combustion engines will not be intentionally or knowingly accepted for disposal.

- Items containing chlorinated fluorocarbons (CFC's), such as refrigerators, freezers, and air conditioners, will only be accepted at the site if the generator or transporter provides written certification that the CFC has been evacuated from the unit and that it was not knowingly allowed to escape into the atmosphere. The M/S will verify that the refrigerant has been evacuated from the appliance or shipment of appliances previously. Such verification will include a signed statement from the person from whom the appliance or shipment of appliances is obtained that all refrigerant that had not leaked previously has been recovered from the appliance or shipment of appliances in accordance with 40 CFR §82.156 (g) or (h) as applicable. This statement will include the name and address of the person who recovered the refrigerant and the date the refrigerant was recovered or a contract that refrigerant will be removed prior to delivery. The facility will notify persons who may deliver such items of the requirement to verify evacuation of refrigerant by signage or letter.
- Liquid waste (any waste material that is determined to contain "free liquids" as deemed by EPA Method 9095 (Paint Filter Test), as described in "Test Methods for Evaluating Solid Wastes, Physical Chemical Methods" (EPA Publication Number SW-846)) will not be disposed of unless it is:
  - Bulk or non-containerized liquid waste that is:
    - Household waste other than septic waste; or
  - Contained liquid waste; and
    - The container is a small container similar in size to that normally found in household waste;
    - The container is designated to hold liquids for use other than storage; or the waste is a household waste.
- Regulated Asbestos Contained Materials (RACM) will not be accepted.
- Class 1 Industrial Waste will not be disposed.

#### **Measures for Controlling Prohibited Wastes**

Procedures to detect and control the receipt of prohibited wastes include:

1. Informing facility customers of prohibited wastes by posting one or more signs at the facility entrance listing prohibited wastes.
2. Providing customers (regular and one-time or occasional) with a written list of prohibited wastes.
3. Informing all drivers of incoming waste vehicles and operators of any transfer stations that have indicated they will deliver waste to the facility for disposal of prohibited wastes by:
  - Posting one or more signs at the facility entrance listing prohibited wastes.
  - Providing all vehicle drivers and transfer station operators with a written list of prohibited wastes.
4. Facility personnel training and activities:
  - Training for appropriate facility personnel responsible for inspecting or observing incoming loads to recognize regulated hazardous waste and PCB waste.
  - Random inspections of incoming loads in accordance with procedures described in this section.
  - Maintaining records of all inspections.
  - Notification of the executive director of any incident involving a regulated hazardous waste or a PCB waste.
  - Remediation of any regulated hazardous waste or PCB waste discovered at the facility in accordance with §335.349.

Facility personnel will be trained to inspect vehicles and identify regulated hazardous waste, polychlorinated biphenyl (PCB) waste, and other prohibited wastes described above. Training for random inspections to recognize prohibited waste will be incorporated into other training programs (e.g., safety meetings). All training will be documented within seven days of said training and will become part

## City of McCamey, Landfill

---

of the site operating record. The personnel will be trained to look for the following indications of prohibited waste:

- Yellow hazardous waste or PCB labels;
- DOT hazard placards or markings;
- Liquids;
- 55-gallon drums;
- 85-gallon overpack drums;
- Powders or dusts;
- Vehicles that contain loads which have a visible emission, smoke, strong chemical odor, or cause physical symptoms (irritation of the eyes, nose, throat, skin, nausea, dizziness, or headache);
- Bright or unusual colored wastes; and
- Sludges

If landfill personnel identify any of the above indications with an incoming load, then that load will be directed to an area out of the flow of traffic, and the personnel will further assess the load.

If the load is determined to contain prohibited waste or if there is any possibility that it may be prohibited waste, the load will be rejected and directed back to the generator. All landfill personnel will be diligent in looking for trucks bringing in waste loads from potential sources of prohibited waste such as industrial facilities, microelectronics manufacturers, electronic companies, metal plating industry, automotive and vehicle repair service companies, and dry cleaning establishments.

The TCEQ and other appropriate agencies will be notified if any hazardous waste or PCB waste is unloaded at the facility.

### **Random Inspections**

Incoming waste is controlled in three ways to preclude the inadvertent receipt of prohibited wastes. One level of control is to inform customers of the types of waste that are to be excluded. A second control is to inform all vehicle drivers and transfer station operators of the restrictions. Personnel will be informed of the typical visible characteristics of these materials. A third control is provided through random inspections.

Due to the low waste stream volume entering the landfill (approximately 4 vehicles per day), random inspections will be made no less than once per week of all vehicles entering the landfill. For a random inspection, personnel will select an incoming vehicle for inspection, and direct the selected load to the area of the working face. Inspections based on internal profiling procedures will count towards the total of random inspections. Once the selected load arrives at the working face, personnel will direct the vehicle to a separate location of the working face and out of the flow of normal landfill traffic. As the load is dumped, personnel will visually inspect the contents.

Records of all inspections will be maintained as part of the operating record. The record will include the date and time of inspection, the name and address of the hauling company and driver, the type of vehicle, the size and source of the load, contents of the load, indicators of prohibited waste, and results of the inspection.

### **§330.129 FIRE PROTECTION**

#### **Fire Protection Plan**

The following steps are taken regularly at the facility to prevent fires:

## City of McCamey, Landfill

---

- Prohibiting open burning of waste is at all times at the landfill, unless requested from the permittee and approved by the TCEQ in accordance with §111.201 - §111.219.
- Preventing burning waste from incoming waste loads from being dumped in the active area of the landfill. Personnel will be alert for signs of burning waste such as smoke, steam, or heat being released from incoming waste loads.
- Fuel spills will be contained and cleaned up immediately. Soil contaminated with spilled fuel will be excavated and, if authorized, disposed of at the working face. Contaminated soils may be excavated using a shovel for small areas or with heavy equipment as appropriate.
- Landfill equipment will not remain in the vicinity of exposed waste overnight.
- Equipment that is used at the working face will be routinely cleaned as deemed necessary to remove combustible waste and caked material, which can cause equipment overheating and increase fire potential. If equipment is cleaned at the working face, the amount of water used will be minimized.
- Dead trees, brush, or vegetation adjacent to the active portion of the landfill will be removed immediately, and grass and weeds mowed at least semi-annually so that forest, grass, or brush fires cannot spread to the landfill or off-site.
- Smoking is not permitted on the active areas of the landfill site.
- Soil cover and non-flammable alternate covers will be used on a daily basis.

### Procedures in the Event of a Fire:

Landfill staff will take the following steps if a fire is discovered:

- Contact the local fire department.
- Alert other facility personnel.
- Assess extent of fire, possibilities for the fire to spread, and alternatives for extinguishing the fire.
- Upon arrival of local fire department personnel, direct them to the fire and provide assistance as appropriate.
- Do not attempt to fight the fire alone. Do not attempt to fight the fire without adequate personal protective equipment. Be familiar with the use and limitations of firefighting equipment available onsite.

### Fire Fighting Methods:

Fire fighting methods for burning solid waste include smothering with soil, separating burning material from other waste, spraying with water if available from an on-site water truck. Small fires might be controlled with hand-held extinguishers. If the fire is at an active disposal area, if possible, the burning waste will be isolated or pushed away immediately before the fire can spread, or firebreaks will be cut around the fire before it can spread. If moving the waste is not possible, or if it is unsafe, efforts will be made to cover the working face with earth immediately to smother the fire. The faster that soil can be placed over the fire, the more effective this method will be in controlling and extinguishing the fire. If a fire is in the working face, the burning area will be isolated and pushed away from the working face quickly, or firebreaks will be cut around the fire before it can spread. If this is not possible or this is unsafe, efforts to cover the working face with earth will be initiated immediately to smother the fire. The stockpiled daily earthen cover material may be used for firefighting purposes.

If a fire occurs on a vehicle or pieces of equipment, the equipment operator will bring the vehicle or equipment to a safe stop. If safety of personnel will allow, the vehicle will be parked away from fuel supplies, uncovered solid wastes, and other vehicles. The engine will be shut off and the brake engaged to prevent movement of the vehicle or piece of equipment.

**Earthen Material Coverage:**

Landfill fires will normally be extinguished by smothering with cover material spread by a dozer or other suitable equipment. A minimum of 167 cubic yards of soil or enough soil to cover the working face with at least six inches of compacted soil will be stockpiled within 1,500 feet of the working face for this purpose.

For example, 167 cubic yards of soil required for a six-inch cover on a maximum 50' x 150' active working face with over a twenty percent contingency included is calculated as follows:

$$7,500 \text{ s.f.} \times 0.5 \text{ ft depth} = 3,750 \text{ ft}^3$$

$$3,750 \text{ ft}^3 / 27 \text{ ft}^3/\text{yd}^3 = 139 \text{ yd}^3 \times 120\% \text{ contingency} = 167 \text{ yd}^3 \text{ for stockpile}$$

A daily log will be maintained documenting the location of the stockpile, the distance of the stockpile from the working face, the volume of the stockpile, the use and replacement of soil for fire control, and demonstration that the amount of stockpiled soil is adequate to cover the largest working face in use on that day. The operator will, at all times, maintain sufficient equipment for moving the soil stockpile and placing a six-inch soil cover over the working face within one hour of detecting a fire at the working face.

**Earthen Material Distance from Working Face:**

A stockpile of earthen material adequately sized to cover the working face will be maintained at all times within 1,500 feet (i.e. in order to cover the working face within one hour, as provided in the following demonstration) of the working face or active disposal area. The source will be sized to cover the working face with a six-inch layer of earthen material. The following calculations are presented to demonstrate the adequacy of earthen material stockpile that will be maintained within 1,500 feet of the working face.

**Demonstration of Stockpile Adequacy:** The typical size of the working face will be approximately 50' x 150' (7,500 square feet). For covering this size of working face, the required stockpile will be 167 cubic yards (i.e., 7,500 sq.ft. x 0.5 ft (cover) = 3,750 cubic feet or 139 cubic yards x 120% contingency = 167 total cubic yards). This earthen volume would be distributed across the working face by one of the earthmovers on-site. Additional equipment will be used, if applicable, to smother the fire within one hour of being detected.

Example calculations:

Volume of Daily cover:	167	cy
Size of Haul Trucks:	8	cy
Number of Haul Trucks:	2	
Number of Loads:	21	
Time to Load:	1	min
Average Truck Speed:	30	mph
Average Truck Speed:	2,640	fpm
Average Equipment Trip Time:	15	min
Average Truck Time Round Trip:	2	min
Length of Time to Cover Working Face:	47	min
Distance From Working Face:	1,500	ft

**Fire Equipment:**

The site is equipped with fire extinguishers of a type, size, location, and number as recommended by the local fire department. Each fire extinguisher will be fully charged and ready for use at all times. Each extinguisher will be inspected on an annual basis and recharged as necessary. A qualified service

## City of McCamey, Landfill

---

company will perform these inspections, and all extinguishers will displace a current inspection tag. Inspection and recharging will be performed following each use. At a minimum, all landfill equipment and vehicles are equipped with Class ABC fire extinguishers with a minimum U-L rating of 1A:10B:C.

### Fire Protection Training:

Training of on-site personnel in firefighting techniques, fire prevention, response, and the fire protection aspects of the SOP will be provided, by established professionals, on an annual basis. Personnel will be familiar with the use and limitations of firefighting equipment available onsite. Records of this training will be included in the Site Operating Record for the facility.

### TCEQ Notification:

After any fire (related to waste management activities that cannot be extinguished within 10 minutes of discovery) occurs, the TCEQ regional office will be contacted. The notification to the regional office will include:

- Contact by telephone as soon as possible, but no later than four hours following fire discovery, and
- Provide a written description of the cause and extent of the fire and the resulting fire response within 14 days of fire detection.

Landfill fires frequently cause concern on the part of nearby landowners, who turn to the TCEQ's regional office for information. Because of this, the facility will provide to the appropriate TCEQ regional office as much information as possible regarding the fire and fire-fighting efforts, as soon as possible after the fire occurs.

The fire prevention and fire control procedures for the facility will be revisited following the occurrence of a significant fire to determine if modifications are warranted.

## **§330.131 ACCESS CONTROL**

### Site Security:

Public access will be controlled to minimize unauthorized vehicular traffic, unauthorized and illegal dumping, and public exposure to hazards associated with landfills. Controlled access will be obtained by fences and gates. A four foot tall barbed wire fence is constructed along the perimeter of the County owned property surrounding the Landfill and a lockable pipe gate is located at the Facility entrance. A perimeter fencing consisting of barbed wire, woven wire, wooden fencing, plastic fencing, pipe fencing, or other suitable material will be maintained around the Facility. A lockable gate constructed of suitable fencing materials is maintained at the facility entrance as shown on the site layout plan. The gate will be locked at all times when the facility is not accepting waste.

### Vehicle Access:

Public access roads to the landfill are paved, all-weather roads. Entry to the active portion of the site will be restricted to designated personnel, approved waste haulers, and properly identified persons whose entry is authorized by site management. Visitors may be allowed on the active area only when accompanied by a site representative. Signage will be provided along the entrance road directing traffic to the unloading area. The operator will restrict site access to authorized vehicles and direct these vehicles appropriately.

Waste hauling vehicles will be directed to appropriate fill areas by signs located along the landfill haul road and access road. These vehicles will deposit their loads and depart the site. Private, commercial, or

## City of McCarney, Landfill

public solid waste vehicles will not be allowed access to any areas other than the active portion of the landfill. Site personnel will provide traffic directions as necessary to facilitate safe movement of vehicles.

Within the site, signs will be placed along the landfill haul road and access road at a frequency adequate for users to be able to understand where disposal areas are and which roads are to be used. Roads not being used for access to disposal areas will be blocked or otherwise marked for no entry.

The facility will comply with the following schedule and notification requirements for any access breach:

<b>Requirements</b>	<b>Access Breach Repaired within 8 hours</b>	<b>Access Break Not permanently repaired in 8 hours</b>
<b>Notify region office of breach and repair schedule</b>	<b>Not required</b>	<b>Within 24 hours</b>
<b>Make temporary repairs</b>	<b>Not required</b>	<b>Within 24 hours</b>
<b>Make permanent repairs</b>	<b>Within 8 hours</b>	<b>Within schedule submitted to regional office in initial notice</b>
<b>Notify regional office when permanent repair completed</b>	<b>Not required</b>	<b>Within schedule submitted to regional office in initial notice</b>

### **§330.133 UNLOADING OF WASTE**

The unloading of solid waste is to be confined to as small an area as practical. The maximum size of the unloading area will be approximately 50 feet in length by 100 feet in width.

The unloading of waste in unauthorized areas is prohibited. Any waste deposited in an unauthorized area will be removed immediately and disposed of properly. Trained personnel will monitor all incoming loads of waste, and will direct traffic to the appropriate unloading area. There will be one general purpose waste unloading area. Trained personnel will also be on duty during operating hours at the working face to direct and monitor unloading of solid waste.

Trained personnel will monitor the incoming waste. These personnel will be familiar with the rules and regulations governing the various types of waste that can or cannot be accepted into the facility, including knowledge of 30 TAC §330.133. The personnel will also have a basic understanding of both industrial and hazardous waste and their transportation and disposal requirements. The facility is not required to accept any solid waste that may cause problems in maintaining full and continuous compliance with the permit.

Certain wastes are prohibited from disposal at this facility. Prohibited wastes are described in 'Detection and Prevention of the Disposal of Prohibited Wastes' section of this plan. The unloading of prohibited wastes at the facility will not be allowed. Necessary steps will be taken by the site superintendent to ensure compliance. Landfill personnel have the authority and responsibility to reject unauthorized loads, have unauthorized material removed by the transporter, and/or assess appropriate surcharges, and have the unauthorized material removed by on-site personnel or otherwise properly managed by the facility. Any prohibited waste not discovered until after unloading will be placed back in the offending transporter's vehicle, if possible, or otherwise returned promptly to the transporter or generator of the waste. The driver may be advised where the waste may be disposed of legally and will be responsible for the proper disposal of this rejected waste.

## City of McCamey, Landfill

---

In the event the unauthorized waste is not discovered until after the vehicle that delivered it is gone, the waste will be segregated and controlled as necessary. An effort will first be made to identify the entity that deposited the prohibited waste and have them return to the site and properly dispose of the waste. In the event that identification is not possible, the landfill manager/supervisor will notify the TCEQ and seek guidance on how to dispose of the waste as soon as practical. A record of unauthorized material removal will be maintained in the Site Operating Record.

Only those persons operating vehicles that comply with the following requirements will be authorized by the landfill to dispose of waste at this site:

- All vehicles and equipment used for the collection and transportation of waste will be operated, and maintained to prevent loss of waste material and to limit health and safety hazards to landfill personnel and the public.
- Collection vehicles and equipment will be maintained in a sanitary condition to preclude odors and fly breeding.
- Collection vehicles not equipped with an enclosed transport body will use other devices such as nets or tarpaulins to preclude accidental spillage.

Landfill personnel will keep vigilant watch for compliance with operating requirements. Signs with directional arrows and/or portable traffic barricades will help to restrict traffic to designated disposal locations. Signs will be placed along the access route to the current disposal area. In addition, rules for waste disposal and prohibited waste will be prominently displayed on signs at the site entrance.

### **§330.135 FACILITY OPERATING HOURS**

The hours of waste operation are as follows:

- The facility will be open to the public between the hours of 9:00 a.m. and 12:00 p.m., and 1:00 p.m. and 6:00 p.m. Tuesday, and 9:00 a.m. and 6:00 p.m. Saturday, except for certain holidays. These hours will be posted on a sign at the entrance of the landfill.
- The site operating hours are from 7:00 a.m. to 6:00 p.m. Tuesday, and 7:00 a.m. to 7:00 p.m. Saturday, except for certain holidays.

Daily cover will be applied as soon as possible, but not more than one hour after closure to the public on the working face.

In addition, the facility may request alternative operating hours to accommodate special occasions, special purpose events, holidays, or other special occurrences. Alternative operating hours will be documented in the operating record. The facility will notify the regional office five days in advance for these alternative hours.

When warranted, the facility supervisor will request approval from the commission's regional office to allow additional temporary operating hours to address disaster or other emergency situations, or other unforeseen circumstances (such as traffic delays or adverse weather) that could result in the disruption of waste management services in the area. The facility supervisor will document the reason or reasons for the delay for each day on which a delay occurs and place the documentation in the operating record.

### **§330.137 SITE SIGN**

A conspicuous sign measuring a minimum four feet by four feet will be maintained at the public entrance to the site. The sign states, in letters at least three inches high, the following information:

- **Type of MSW Facility:** City of McCamey - Type IV-AE MSW Landfill
- **Authorized by TCEQ Permit Number:** MSW Permit No. 566

City of McCamey, Landfill

- **Hours of Operation: Open to the Public - Tuesday** TUESDAY, WEDNESDAY, THURSDAY  
9:00 a.m. and 12:00 p.m. 9-12 / 1-6  
1:00 p.m. and 4:00 p.m.  
**Saturday**  
9:00 a.m. and 1:00 p.m. 9-12 / 1-6
- **Emergency 24-hour Contact Number:** (432) 208-5384
- **Local Emergency Fire Department Number:** (432) 693-2422

The sign will be visible and readable from the facility entrance. A sign prohibiting receipt of hazardous waste and closed drums and prohibiting smoking will be posted near the facility entrance. A sign will be prominently displayed at the facility entrance stating that all loads will be properly covered or otherwise secured.

**§330.139 CONTROL OF WINDBLOWN SOLID WASTE AND LITTER**

Windblown waste and litter will be controlled through several methods, including proper unloading, compaction, and cover procedures. The use of portable litter control fences (as necessary), the orientation of the working face relative to the prevailing wind direction, stockpiles and landscaping and maintaining the active working face to as small an area as practical will provide control of windblown waste and litter. Personnel will police the landfill site, including fences, access roads, and the entrance gate, every operating day to pick up and return windblown waste and litter to the active working face and perform such other litter control measures, as necessary.

A log of daily cleanup will be placed in the operating record.

Daily cover will be placed on top of the waste lift as soon as it is practical for any portion of the lift that reaches recommended lift height. The Type IV working face will be covered at least weekly.

**§330.141 EASEMENTS AND BUFFER ZONES**

Southern Union Gas Company has an easement across the entrance road of the landfill, parallel to F.M. 305. This easement has no affect on landfill operations. (see Site Development Plan, Attachment 1.

No solid waste unloading, storage, disposal, or processing operations will occur within any easement, buffer zone, or right-of-way that crosses the site. No solid waste disposal will occur within 25 feet of the center line of any utility line or pipeline easement, unless otherwise authorized by the executive director. All pipeline and utility easements are clearly marked with posts, which extend at least six feet above ground level, spaced at intervals no greater than 300 feet. The buffer zones may vary around the perimeter of the site, but in no case will they be less than 50 feet. All buffer zones, as depicted in the site design, will be clearly marked as specified by TCEQ rules.

**§330.143 LANDFILL MARKERS AND BENCHMARK**

Landfill markers clearly mark significant features as described in 30 TAC §330.143(b). The markers are steel or wooden posts (or other TCEQ-approved material) and extend at least 6 feet above the ground surface. The markers will be maintained unobscured by vegetation and will be placed in sufficient numbers to clearly indicate the required boundaries. Markers that are removed, destroyed, or determined to not meet regulatory requirements will be replaced within 15 days of their removal or destruction. Landfill markers will be inspected on a monthly basis and will be maintained and repaired on a scheduled basis. Markers are repainted, repaired, or replaced to maintain visibility within 15 days.

Guidelines for type, placement, and color coding of markers are provided below. The required landfill markers are:

<b>Marker</b>	<b>Color</b>
Site Boundary	Black
Buffer Zone	Yellow
Easements	Green
Grid System	White
Floodplain	Blue

A permanent benchmark has been established at the facility. The benchmark is a bronze survey marker set in concrete with the elevation and the survey date stamped on it. The benchmark will be repaired or reset within 30 days of any disturbance of the benchmark.

**§330.145 MATERIALS ALONG THE ROUTE TO THE SITE**

The City of McCamey Landfill will take steps to encourage that vehicles hauling waste to the landfill are enclosed or provided with a tarpaulin, net, or other means to effectively secure the load in order to prevent the escape of any part of the load by blowing or spilling. The City of McCamey Landfill will take actions such as posting signs, reporting offenders to proper law enforcement officers, adding surcharges, or similar measures. On days when the landfill is in operation, the operator will clean up waste materials spilled along and within the right-of-way of public access roads serving the facility for a distance of two miles in either direction from any entrances used for the delivery of waste to the facility at least one time each day. City of McCamey Landfill will consult with the Texas Department of Transportation or county and/or local governments with maintenance authority over the roads, concerning the cleanup of public access roads and rights-of-way.

**§330.147 DISPOSAL OF LARGE ITEMS**

Large, heavy, or bulky items which cannot be incorporated in the regular spreading, compaction, and covering operations at landfills will be recycled. This special area will be moved from time to time to accommodate the working conditions. This special collection area will be designated as a large-item salvage area. City of McCamey Landfill will remove the items from the site often enough to prevent these items from becoming a nuisance and to preclude the discharge of any pollutants from the area.

Items classified as large, heavy or bulky can include, but are not limited to, white goods (household appliances), air condition units, metal tanks, large metal pieces, and automobiles.

Refrigerators, freezers, air conditions, and any other items containing chlorinated fluorocarbon (CFC) will be handled in accordance with 40 CFR §82.156(f), as amended.

**§330.149 ODOR MANAGEMENT PLAN**

City of McCamey Landfill will comply with commission rules concerning burning and air pollution control. The City of McCamey Landfill will ensure that any unit of the municipal solid waste facility does not violate any applicable requirement of the approved state implementation plan developed under the Federal Clean Air Act, §110, as amended, and 30 TAC §330.5(d) of this title (relating to General Prohibitions), which prohibits the open burning of waste at any municipal solid waste landfill facility.

City of McCamey will ensure that the municipal solid waste facility does not violate any applicable air quality requirement in Part III, Attachment 14 - Landfill Gas Management Plan.

**Odor Management Plan:**

Sources of Odor. Potential odor sources associated with a municipal solid waste landfill facility include the wastes being delivered to the landfill, the open working face, ponded water, and landfill gas. Many of

## City of McCamey, Landfill

---

For maintenance of on-site and other access roadways, in addition to stockpiles or crushed stone, the facility may stockpile concrete rubble, masonry, or other similar material used in maintaining passable access roads. Grading equipment will be used weekly or as necessary to control or remove mud accumulations on roads.

### **§330.155 SALVAGING AND SCAVENGING**

Salvaging will not be allowed to interfere with prompt sanitary disposal of solid waste or to create public health nuisances. Salvaged materials will be considered as potential recyclable materials and will be stored in a designated collection area. The collection area will be identified in the site operating record. Salvaged items will be recycled often enough to prevent an excessive accumulation of the material at the site to prevent odor or other nuisance conditions from developing and to eliminate the risk of discharge of pollutants. Scavenging will not be allowed.

Pesticide, fungicide, rodenticide, and herbicide containers will not be salvaged unless they are salvaged through a state-supported recycling program. Salvaging of special waste will be prohibited. Salvaging of wastes will not occur where waste has been covered with daily cover.

### **§330.157 ENDANGERED SPECIES PROTECTION**

The facility and the operation of the facility will not result in the destruction or adverse modification of the critical habitat of endangered or threatened species, or cause or contribute to the taking of any endangered or threatened species.

An assessment of the potential effects of the landfill on threatened and/or endangered species was conducted based upon data available from the Texas Parks and Wildlife Department. The results of the evaluation are that the Texas Parks and Wildlife Department's Texas Heritage Program has no presently known occurrences of sensitive species or natural communities in the vicinity of the landfill.

### **§330.159 LANDFILL GAS CONTROL**

Due to the minimal amount of Type II waste (less than 6 acres) deposited at the landfill and because all future waste will be construction and demolition debris only, it is not anticipated that migration of landfill gas will occur.

The control and monitoring of landfill gas for the City of McCamey Landfill will be in accordance with Part III, Attachment 14 - Landfill Gas Management Plan. The Landfill Gas Management Plan was developed in accordance with §330.63(g). The gas management plan provides for inclusion of applicable documentation in the Site Operating Record, and for submittal to the executive director.

### **§330.161 OIL, GAS, AND WATER WELLS**

There are no known water wells or oil wells on the landfill property. If a water well is encountered City of McCamey, within 30 days of such a discovery, provide the executive director with such notification and written certification that such wells have been capped, plugged, and closed in accordance with all applicable rules and regulations of the commission or other state agency.

If a crude oil or natural gas wells, or other wells associated with mineral recovery is encountered that is under the jurisdiction of the Railroad Commission of Texas, City of McCamey shall provide the executive director with written notification of the location of any such well within 30 days after discovery during the course of facility development. Within 30 days after plugging of such well, City of McCamey will give written certification to the TCEQ that the wells have been properly capped, plugged, and closed in accordance with all applicable rules and regulations of the Railroad Commission of Texas.

**§330.163 COMPACTION**

Uniform compaction levels throughout the site will be promoted by limiting the thickness of each compaction layer and the use of landfill equipment. Deposition of materials along the working faces will be controlled by site personnel.

**§330.165 LANDFILL COVER**

- (a) **Weekly Cover** – The City of McCamey Landfill will apply six inches of well-compacted earthen material not previously mixed with garbage, rubbish, or other solid waste at a rate no less than weekly. Runoff from areas that have intact weekly cover is not considered as having come into contact with the working face or leachate.
- (b) **Intermediate Cover** – The City of McCamey Landfill will cover all areas that have received waste but will be inactive for longer than 180 days with intermediate or final cover. Intermediate cover will include six inches of suitable earthen material that is capable of sustaining native plant growth and will be seeded or sodded following its application in order to control erosion, or will be a material approved by the executive director that will otherwise control erosion. This intermediate cover will be not less than 12 inches of suitable earthen material. The intermediate cover will be graded to prevent ponding of water, and plant growth or other erosion control features will be maintained. Runoff from areas which have received intermediate cover will not be considered as having come into contact with the working face or leachate for the purpose of 30 TAC §330.305(g) of this title (relating to Site Development Plan).
- (c) **Alternative Material Daily Cover** – The City of McCamey Landfill does not plan to use alternate material daily cover (ADC); however, if the City decides to utilize ADC, the City will request a temporary authorization under 30 TAC §305.70(m) followed by a permit modification in accordance with 30 TAC §305.70(k)(1).
- (d) **Final Cover** – The City of McCamey Landfill will install final cover over the landfill in accordance with the site Closure Plan – Part III, Attachment 12 and Subchapter K of 30 TAC Chapter 330 (relating to Closure and Post-Closure).
- (e) **Erosion of Cover** – The City of McCamey Landfill will maintain the final cover system during and after construction. During the active life of the site, the landfill will inspect the final cover system on a weekly basis, in addition to immediately following a significant rainfall event. Erosion gullies or washed-out areas of the intermediate or final cover will be repaired within 5 days of detection. Repair of final cover includes restoring cover, grading, compacting, and seeding as required. Should additional time be required for repairs due to weather related delays, the landfill will request from the regional office approval of an alternate schedule. Post-closure care inspection and repair procedures of the final cover are outlined in Part III, Attachment 13 – Post-Closure Plan.
- (f) **Cover Inspection Record** – The City of McCamey Landfill will keep a cover application record on site readily available for inspection by commission representatives and authorized agents or employees of local governments having jurisdiction. This record will specify the date cover (no exposed waste) was accomplished, how it was accomplished, and the last area covered. This applies to daily, intermediate, and alternate daily cover. For final cover, this record will specify the area covered, the date cover was applied, and the thickness applied that date. Each entry will be certified by the signature of the on-site supervisor that the work was accomplished as stated in the record.

**§330.167 PONDED WATER**

The ponding of water over waste on a landfill, regardless of its origin, will be prevented. Pounded water that occurs in the active portion of the landfill or on the closed landfill will be eliminated and the area in which the ponding occurred will be filled in and regraded within seven days of the occurrence.

## City of McCamey, Landfill

---

If the ponded water has come into contact with waste, or waste-contaminated soils, it will be eliminated by pumping it from the area as quickly as possible and disposed of at a TCEQ authorized treatment facility.

### **§330.169 WASTE IN ENCLOSED CONTAINERS OR ENCLOSED VEHICLES ACCEPTED AT TYPE IV LANDFILLS**

No waste in enclosed containers or enclosed vehicles will be accepted. If in the future the City chooses to accept waste in enclosed containers or enclosed vehicles, it will be in accordance with the requirements in §330.169(1) – (3).

### **§330.171 DISPOSAL OF SPECIAL WASTES**

The acceptance and/or disposal of a special waste as defined in 30 TAC §330.2 (relating to Definitions) which is not specifically identified in subsections (c) or (d) of 30 TAC §330.171, or in 30 TAC §330.173 (relating to Disposal of Industrial Wastes) will not be accepted at the City of McCamey Landfill without prior written approval from the executive director, with the exception of dead animals and/or slaughterhouse waste, and nonregulated asbestos-containing materials (non-RACM). Dead animals and/or slaughterhouse waste are covered by three feet of other solid waste or at least two feet of earthen material immediately upon receipt. Non-RACM will be placed on the active working face and under no circumstances will any material containing non-RACM be placed on any surface or roadway that is subject to vehicular traffic or disposed of by any other means by which the material could be crumbled into a friable state.

### **§330.173 DISPOSAL OF INDUSTRIAL WASTES**

The City of McCamey Landfill will not accept Class 1 industrial solid waste. The facility will accept the following:

- Class 2 and Class 3 Industrial Nonhazardous Waste (e.g., plant trash, card board, wood pallets, adhesive glue, rubber gloves, packing sawdust, and plastic wrap) that can be routinely disposed of without special handling or processing. The Class 2 and Class 3 wastes will be disposed of at the City of McCamey Landfill without interfering with facility operations. These waste streams must exhibit the same disposal characteristics as routine municipal solid waste. The management of these waste streams may not cause the operation of the facility to deviate from the operational standards or other applicable Federal, State or Local regulations.

### **§330.175 VISUAL SCREENING OF DEPOSITED WASTE**

The City of McCamey Landfill will visually screen any deposited waste materials where the executive director determines that screening is necessary or where permit or design requirements so dictate.

### **§330.177 LEACHATE AND GAS CONDENSATE RECIRCULATION**

Leachate or gas condensate recirculation or application is prohibited at the City of McCamey Landfill.

X:\8240 McCamey Landfill\SOP Mod\NOD\Site Operating Plan 12-7-09 cln.doc

#5

COPY

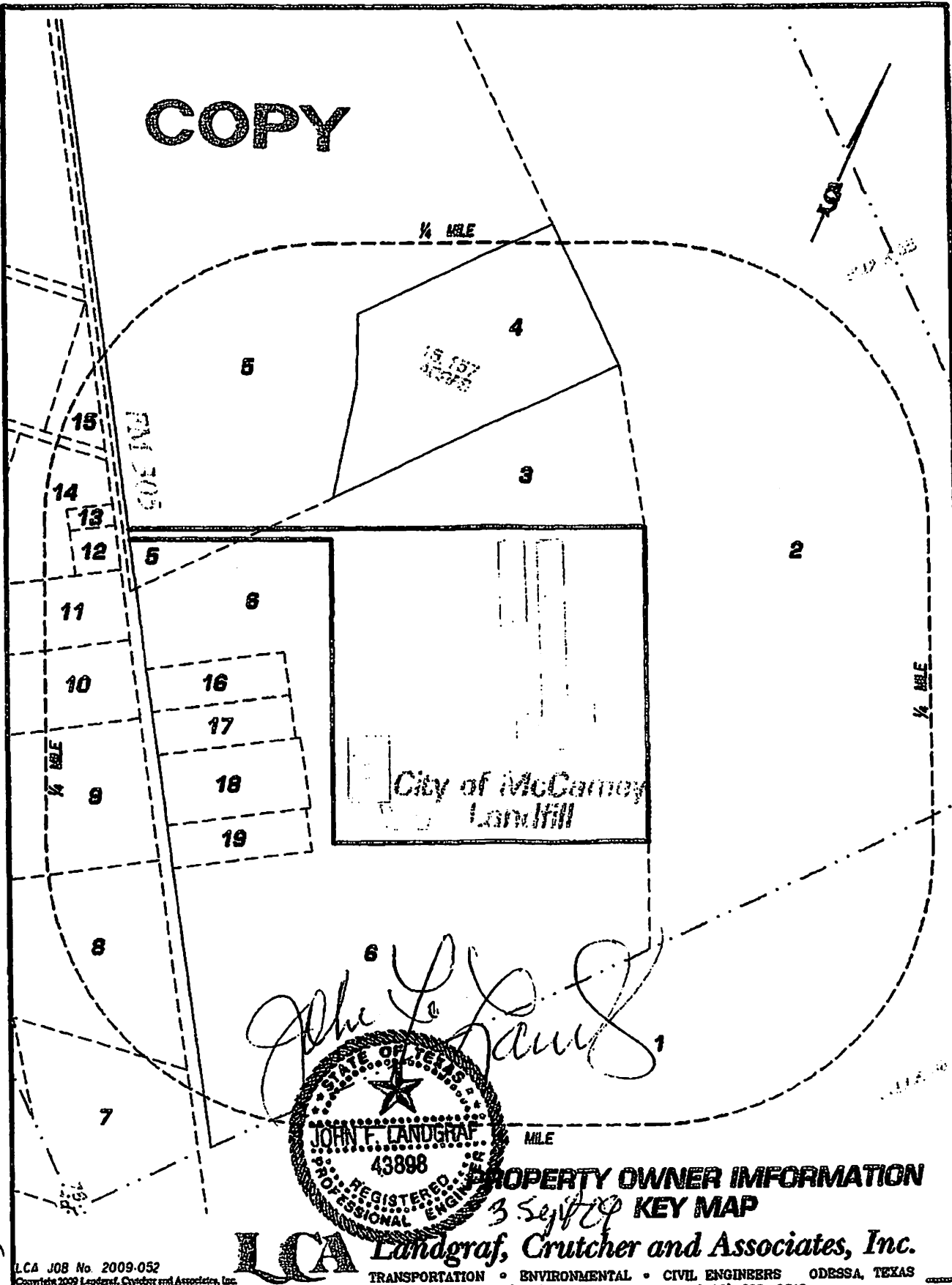

*John F. Landgraf*

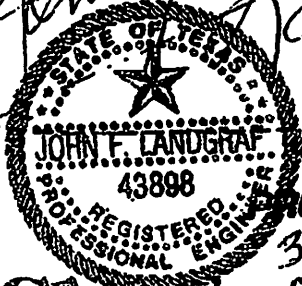

PROPERTY OWNER INFORMATION  
3 Sept 09 KEY MAP

**LCA** Landgraf, Crutcher and Associates, Inc.  
TRANSPORTATION • ENVIRONMENTAL • CIVIL ENGINEERS ODESSA, TEXAS  
Phone # (432) 332-6058 Fax # (432) 332-6612

# Upton CAD

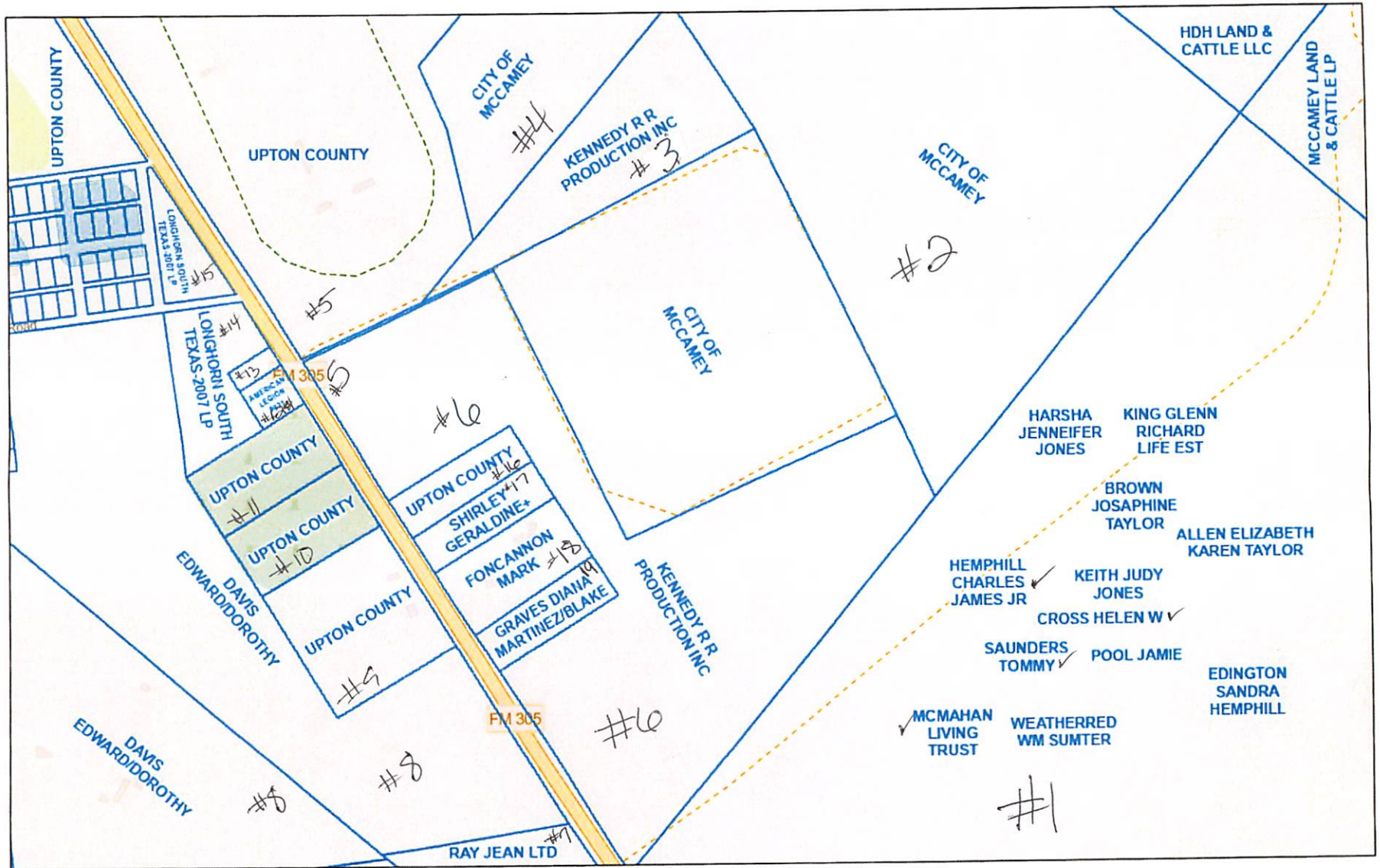

2/17/2026, 4:44:20 PM

- - - Lot Lines
- Parcels

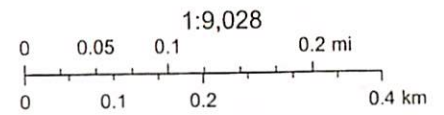

Map data © OpenStreetMap contributors, Microsoft, Facebook, Google, Esri  
Community Maps contributors, Map layer by Esri

Upton CAD

This product is for informational purposes and is not prepared for, or be suitable for legal, engineering, or surveying purposes. Information contained on this map is not warranted and the Appraisal District or Pritchard & Abbott, Inc. is not liable for any errors.

#6

City of McCamey

Landfill #566

Landowners Information – adjacent properties

#1 Charles James Hemphill Jr  
6018 FM 503  
Valera, TX 76884

Jennifer Jones Harsh  
185 E Saddle Club Rd  
Belle Rive, IL 62810

Elizabeth Karen Taylor Allen  
915 Galveston  
Coleman, TX 76834

Helen W Cross  
500 Stone Manor Dr  
McGregor, TX 76657

McMahan Living Trust  
405 Blue Daze Ct  
Burleson, TX 76028

Judy Jones Keith  
8809 Grand Ave  
North Richland Hills, TX 76180

Josaphine Taylor Brown  
2519 Brown Ranch Lane  
Beeville, TX 78102

Glenn Richard King Life Estate  
4850 Cromwell Dr Apt 112  
Kyle, TX 78640-6422

Tommy Saunders  
300 Cr 417  
Coleman, TX 76834

Jamie Pool  
13229 FM 2303  
Stephenville, TX 76401

Sandra Hemphill Edington  
1440 CR 422  
Coleman, TX 76834

WM Sumter Weatherred  
1814 S Colorado  
Coleman, TX 76834

#2 City of McCamey  
PO Box 1409  
McCamey, TX 79752

#3 RR Kennedy Production Inc  
PO Box 5677  
Abilene, TX 79608

#4 City of McCamey  
PO Box 1409  
McCamey, TX 79752

#5 Upton County  
PO Box 482  
Rankin, TX 79778

#6 RR Kennedy Production Inc  
PO Box 5677  
Abilene, TX 79608

- #7 RayJean LTD  
PO Box 1527  
McCamey, TX 79752
  
- #8 Edward and Dorothy Davis  
PO Box 1395  
McCamey, TX 79752
  
- #9 Upton County  
PO Box 482  
Rankin, TX 79778
  
- #10 Upton County  
PO Box 482  
Rankin, TX 79778
  
- #11 Upton County  
PO Box 482  
Rankin, TX 79778
  
- #12 American Legion #421  
PO Box 308  
McCamey, TX 79752
  
- #13 VFW of US – Young-McCollum Post #5071  
PO Box 1081  
McCamey, TX 79752
  
- #14 Longhorn South Texas – 2007 LP  
1801 W Texas Ave  
Midland, TX 79701
  
- #15 Longhorn South Texas – 2007 LP  
1801 W Texas Ave  
Midland, TX 79701

- #16 Upton County  
PO Box 482  
Rankin, TX 79778
  
- #17 Geraldine Shirley and Vikki Bradley  
1203 N 15<sup>th</sup> St  
Wolfforth, TX 79382
  
- #18 Mark Foncannon  
PO Box 205  
McCamey, TX 79752
  
- #19 Diana Martinez Graves  
PO Box 154  
McCamey, TX 79752

Upton, TX

Southwest Abstract & Title Company

Examiner: swat.bgray

1006 N Rankin St.

Order:

Folder:

Created: 04/23/2026

Updated: 04/23/2026

RS: (Search 2)

Inst. count: 10

Printed: 04/23/2026

RS cert. date: 11/13/2025

Plant cert. dates: 01/01/1880-11/13/2025 05:00

OP/PDEED 847/415 2011-150765 01/01/2011 01/19/2011 \$0.00

DUNCAN 5 REAL ESTATE LP
LAURA AMACKER EAVES
ROBERT KENT AMACKER
H&TC RY (H/36); S#; 4; B: 36

DUNCAN 5 REAL ESTATE LP
LAURA AMACKER EAVES
ROBERT KENT AMACKER

OP/AGMT 1126/724 2021-185326 12/14/2020 04/20/2021 \$0.00

Pioneer Natural Resources USA Inc
SINOCHM PETROLEUM USA LP
H&TC RY CO [H]; S#; 4; B: 36

OP/DISD 1159/315 2022-188930 06/01/2022 06/07/2022 \$0.00

TAYLOR RUTH ANN HEMPHILL TRUSTEE
ANNE ELIZABETH HEMPHILL FAMILY LIVING TRUST
H&TC RY CO [H]; S#; 4; B: 36, Ac. 63.21 (V599/41)

CHILDREN OF RUTH ANN HEMPHILL TAYLOR
BROWN JOSAPHINE TAYLOR
ALLEN ELIZABETH KAREN TAYLOR
EDINGTON SANDRA HEMPHILL
POOL JAMIE
HEMPHILL CHARLES JAMES JR

OP/AMEND 1170/443 2022-190582 05/31/2013 10/17/2022 \$0.00

Pioneer Natural Resources USA Inc
SINOCHM PETROLEUM USA LP
SINOCHM PERMIAN USA LLC
H&TC RY CO [H]; S#; 4; B: 36 (NO AC GIVEN)

OP/HAFDD 1199/650 2023-194078 10/02/2023 10/13/2023 \$0.00

DAVIS JAY AFFIANT
DODSON HENRY AFFIANT
WEATHERRED LUCY OLA WHITE DECEASED ESTATE
H&TC RY CO [H]; S#; 4; B: 36, Ac. 63.21 (V599/41)

WEATHERRED JAMES MARTIN
HEMPHILL ANNE ELIZABETH WEATHERRED
WEATHERRED WILLIE MAE

OP/SPWD 1215/1 2024-195570 04/02/2024 04/17/2024 \$0.00

HP MORRISON FAMILY PROPERTIES LTD
HPMP GENPAR LLC
H&TC RY CO [H]; S#; 4; B: 36

LONG ATLAS RANCH LLC
UPTON COUNTY WATER LLC

Notes: PREF=944/160 EXCEPTIONS PREF=190/292 PREF=190/294 PREF=196/270 PREF=196/274 PREF=310/186 PREF=320/279 PREF=391/409
PREF=391/407 PREF=749/795 PREF=749/799 PREF=749/803 PREF=749/807 PREF=749/812 PREF=750/740 PREF=759/34 PREF=758/802 PREF=785/543
PREF=920/802 PREF=1134/658 PREF=1140/166 PREF=1156/685 PREF=1156/691 PREF=60/57 PREF=441/487 PREF=453/434 PREF=454/392 PREF=456/134
PREF=753/241 PREF=753/322 PREF=753/375 PREF=753/378 PREF=753/381 PREF=754/125 PREF=895/486 PREF=922/152 PREF=996/364 PREF=1138/690
PREF=1161/33 PREF=227/443 PREF=364/311 PREF=364/447 PREF=442/693 PREF=455/197 PREF=558/711 PREF=594/87 PREF=596/304 PREF=596/307
PREF=597/352 PREF=600/77 PREF=616/348 PREF=700/553 PREF=702/825 PREF=720/734 PREF=720/735 PREF=720/736 PREF=720/737 PREF=720/738
PREF=720/739 PREF=722/92 PREF=735/864 PREF=735/868 PREF=735/872 PREF=735/876 PREF=735/880 PREF=735/884 PREF=788/486 PREF=890/556
PREF=918/497 PREF=920/792 PREF=920/797 PREF=921/23 PREF=968/399 PREF=1054/660 PREF=1140/208 PREF=1192/873 PREF=24/438 PREF=39/388
PREF=188/89 PREF=243/352 PREF=427/161 PREF=574/719 PREF=880/430 PREF=880/438 PREF=880/452 PREF=880/460 PREF=880/468 PREF=880/476
PREF=1108/692 PREF=1108/699 PREF=1150/187 PREF=27/298 PREF=34/584 PREF=39/321 PREF=39/463 PREF=211/283 PREF=347/20 PREF=347/147
PREF=512/567 PREF=702/828 PREF=722/551 PREF=994/243 PREF=1039/491 PREF=1054/527 PREF=1054/577 PREF=1056/536 PREF=1076/1 PREF=1100/431
PREF=1155/528 PREF=1155/535 PREF=1181/354 PREF=1178/208 PREF=604/683 PREF=636/719 PREF=641/61 PREF=641/63 PREF=641/65 PREF=641/67
PREF=641/573 PREF=642/677 PREF=644/594 PREF=651/26 PREF=904/356 PREF=904/364 PREF=904/371 PREF=904/378 PREF=904/385 9V04/392
PREF=904/399 PREF=904/407 PREF=904/414 PREF=904/421 PREF=904/429 PREF=904/436 PREF=1088/721 PREF=1188/802 PREF=1190/470 PREF=1190/476
PREF=1190/482

all #1

**Upton, TX**

**Southwest Abstract & Title Company**

Examiner: swat bgray

1006 N Rankin St.

Order:

Folder:

Created: 04/23/2026

Updated: 04/23/2026

RS: (Search 2)

Inst. count: 10

Printed: 04/23/2026

RS cert. date: 11/13/2025

Plant cert dates: 01/01/1880-11/13/2025 05:00

OP/SPWD 1215/17 2024-195571 04/02/2024 04/17/2024 \$4,712,545.00

NFM TEXAS PROPERTIES LP  
NFM TEXAS GENPAR LLC

H&TC RY CO [H]; S#: 4; B: 36

LONG ATLAS RANCH LLC  
UPTON COUNTY WATER LLC

Notes: PREF=944/160 EXCEPTIONS PREF=190/292 PREF=190/294 PREF=196/270 PREF=196/274 PREF=310/186 PREF=320/279 PREF=391/409  
PREF=391/407 PREF=749/795 PREF=749/799 PREF=749/803 PREF=749/807 PREF=749/812 PREF=750/740 PREF=759/34 PREF=758/802 PREF=785/543  
PREF=920/802 PREF=1134/658 PREF=1140/166 PREF=1156/685 PREF=1156/691 PREF=60/57 PREF=441/487 PREF=453/434 PREF=454/392 PREF=456/134  
PREF=753/241 PREF=753/322 PREF=753/375 PREF=753/378 PREF=753/381 PREF=754/125 PREF=895/486 PREF=922/152 PREF=996/364 PREF=1138/690  
PREF=1161/33 PREF=227/443 PREF=364/311 PREF=364/447 PREF=442/693 PREF=455/197 PREF=558/711 PREF=594/87 PREF=596/304 PREF=596/307  
PREF=597/352 PREF=600/77 PREF=616/348 PREF=700/553 PREF=702/825 PREF=720/734 PREF=720/735 PREF=720/736 PREF=720/737 PREF=720/738  
PREF=720/739 PREF=722/92 PREF=735/864 PREF=735/868 PREF=735/872 PREF=735/876 PREF=735/880 PREF=735/884 PREF=788/486 PREF=890/556  
PREF=918/497 PREF=920/792 PREF=921/23 PREF=968/399 PREF=1054/660 PREF=1140/208 PREF=1192/873 PREF=24/438 PREF=39/388  
PREF=188/89 PREF=243/352 PREF=427/161 PREF=574/719 PREF=880/430 PREF=880/438 PREF=880/452 PREF=880/460 PREF=880/468 PREF=880/476  
PREF=1108/692 PREF=1108/699 PREF=1150/187 PREF=27/298 PREF=34/584 PREF=39/321 PREF=39/463 PREF=211/283 PREF=347/20 PREF=347/147  
PREF=512/567 PREF=702/828 PREF=722/551 PREF=994/243 PREF=1039/491 PREF=1054/527 PREF=1054/577 PREF=1056/536 PREF=1076/1 PREF=1100/431  
PREF=1155/528 PREF=1155/535 PREF=1181/354 PREF=1178/208 PREF=604/683 PREF=636/719 PREF=641/61 PREF=641/63 PREF=641/65 PREF=641/67  
PREF=641/573 PREF=642/677 PREF=644/594 PREF=651/26 PREF=904/356 PREF=904/364 PREF=904/371 PREF=904/378 PREF=904/385 9V04/392  
PREF=904/399 PREF=904/407 PREF=904/414 PREF=904/421 PREF=904/429 PREF=904/436 PREF=1088/721 PREF=1188/802 PREF=1190/470 PREF=1190/476  
PREF=1190/482

OP/SPWD 1228/122 2024-197097 09/11/2024 10/07/2024 \$0.00

KING GLENN RICHARD INDEPENDENT EXECUTOR  
KING SUSAN CAROLE DECEASED ESTATE

H&TC RY CO [H], S#: 4; B: 36; Ac: 72.8449

KING GLENN RICHARD  
CONTELLA DINA ELIZABETH

OP/MEMO 1242/75 2025-198294 01/16/2025 02/05/2025 \$0.00

DUNCAN FIVER REAL ESTATE LP  
DUNCAN FIVER MANAGEMENT LLC

H&TC RY CO [H], S#: 4; B: 36

TIPPETT SOLAR LLC

Notes: PREF=757/313 PREF=2005-136208 PREF=824/635 PREF=2009-147609 PREF=847/415 PREF=2011-150765

OP/MEMO 1250/864 2025-199399 04/11/2024 05/08/2025 \$0.00

DUNCAN FIVE REAL ESTATE LP  
DUNCAN FIVE MANAGEMENT LLC  
TIPPETT SOLAR LLC

H&TC RY CO [H], S#: 4; B: 36  
H&TC RY CO [H], S#: 4; B: 36

DUNCAN FIVE REAL ESTATE LP  
DUNCAN FIVE MANAGEMENT LLC  
TIPPETT SOLAR LLC

Notes: PREF=1242/75 PREF=198294 PREF=757/313 PREF=136208 PREF=824/635 PREF=147609 PREF=847/415 PREF=150765

Notes:

-----

Searches:-----

Exception 1 searches

(Except) Join: <M> and (<P> or <P>)  
Entry date(s): 01/01/2021-04/23/2026

Include empty Survey properties  
Include prior references  
Apply prior references restrictions  
Prior references level: 3  
Forward references level: 3

Surveys:

Name(s):  
H&TC RY (H/36) / 4 / / 36 /  
H&TC RY CO [H] / 4 / / 36 /

**Upton, TX**

**Southwest Abstract & Title Company**

Examiner: swat bgray

1006 N Rankin St.

Order:

Folder:

Created: 04/23/2026

Updated: 04/23/2026

RS: (Search 1)

Inst. count: 18

Printed: 04/23/2026

RS cert. date: 11/13/2025

Plant cert. dates: 01/01/1880-11/13/2025 05:00

OP/WD 973/140 2016-167733 07/05/2016 07/11/2016 \$0.00

CAPPS RANDALL

H&TC RY CO [H], S#: 78, B: 35 (Notes=196.91 AC)

MCCAMEY LAND & CATTLE LP

Notes: PREF 841/262

OP/AGMT 1126/724 2021-185326 12/14/2020 04/20/2021 \$0.00

Pioneer Natural Resources USA Inc

H&TC RY CO [H], S#: 78, B: 35

SINOCHEM PETROLEUM USA LP

*outside Boundary*

OP/WD 1128/313 2021-185512 09/24/2020 05/05/2021 \$0.00

Charles Graves

H&TC RY CO [H], S#: 78, B: 35, Ac: 2.938

ALBERT MARTINEZ

OP/EASE 1144/885 2021-187350 05/10/2021 11/29/2021 \$0.00

UPTON COUNTY

H&TC RY CO [H], S#: 78, B: 35, Ac: 19.602 (5 FEET EASEMENT V793/242)

MCCAMEY COUNTRY CLUB

AEP TEXAS INC

Notes: EASEMENT AND RIGHT OF WAY;

OP/CDEED 1166/755 2022-190114 10/10/2014 08/24/2022 310154GEO \$0.00

LYNCH DARCEY E

H&TC RY CO. SURVEY, S#: 78, B: 35, Ac: 2.938

LYNCH DARCEY E INDEPENDENT EXECUTRIX

LYNCH BILLY LEON ESTATE

GRAVES CHARLES

Notes: PREF=2014-00163744 PREF=507/164

OP/WDVL 1167/270 2022-190186 08/29/2022 09/01/2022 LSAT310154GEO \$155,138.00

MARTINEZ ALBERT

H&TC RY CO. SURVEY, S#: 78, B: 35, Ac: 2.938 (V1128/313)

GRAVES BLAKE

MARTINEZ DIANA

OP/DT 1167/273 2022-190187 08/29/2022 09/01/2022 310154 \$155,138.00

GRAVES BLAKE

H&TC RY CO. SURVEY, S#: 78, B: 35, Ac: 2.938 (V1128/313)

MARTINEZ DIANA

SOUTHWEST STAGE FUNDING LLC DBA

Cascade Financial Services

PATTERSON MICHAEL H TRUSTEE

MORTGAGE ELECTRONIC REGISTRATION SYSTEMS INC

OP/AMEND 1170/443 2022-190582 05/31/2013 10/17/2022 \$0.00

Pioneer Natural Resources USA Inc

H&TC RY CO. SURVEY, S#: 78, B: 35 (NO AC GIVEN)

SINOCHEM PETROLEUM USA LP

SINOCHEM PERMIAN USA LLC

*Outside Boundary*

#5

N/A

#17

#15

#17

#19

#19

N/A

Upton, TX

Southwest Abstract & Title Company

Examiner: swat.bgray

1006 N Rankin St.

Order:

Folder:

Created: 04/23/2026

Updated: 04/23/2026

RS: (Search 1)

Inst. count: 18

Printed: 04/23/2026

RS cert. date: 11/13/2025

Plant cert. dates: 01/01/1880-11/13/2025 05:00

OP/CORR 1170/876 2022-190622 08/26/2022 10/20/2022 310154GEO \$0.00

ORTIZ GEOFFREY AFFIANT  
LONE STAR ABSTRACT & TITLE CO INC

H&TC RY CO SURVEY, S#: 78, B: 35, Ac: 2.938 (V1128/313)

#19

MARTINEZ ALBERT  
GRAVES BLAKE  
MARTINEZ DIANA

Notes: PREF=190187 PREF=1167/270

OP/SOL 1171/135 2022-190653 10/03/2022 10/25/2022 310154GEO \$0.00

MARTINEZ ALBERT

H&TC RY CO SURVEY, S#: 78, B: 35, Ac: 2.938 (V1128/313)

#19

GRAVES BLAKE  
MARTINEZ DIANA

OP/AWD 1171/479 2022-190702 10/27/2022 10/31/2022 \$0.00

BOLEN GARY

H&TC RY CO [H], S#: 78, B: 35, Ac: 9.96 (SURFACE ESTATE ONLY NW PART)

#11

UPTON COUNTY

OP/EASE 1214/746 2024-195542 07/31/2023 04/16/2024 \$0.00

CITY OF MCCAMEY

H&TC RY CO [H], S#: 78, B: 35, Ac: 50 (V120/317)

AEP TEXAS INC

Landfill

OP/SPWD 1215/1 2024-195570 04/02/2024 04/17/2024 \$0.00

HP MORRISON FAMILY PROPERTIES LTD  
HPMP GENPAR LLC

H&TC RY CO [H], S#: 78, B: 35

LONG ATLAS RANCH LLC  
UPTON COUNTY WATER LLC

Notes: PREF=944/160 EXCEPTIONS PREF=190/292 PREF=190/294 PREF=196/270 PREF=196/274 PREF=310/186 PREF=320/279 PREF=391/409  
PREF=391/407 PREF=749/795 PREF=749/799 PREF=749/803 PREF=749/807 PREF=749/812 PREF=750/740 PREF=759/34 PREF=758/802 PREF=785/543  
PREF=920/802 PREF=1134/658 PREF=1140/166 PREF=1156/685 PREF=1156/691 PREF=60/57 PREF=441/487 PREF=453/434 PREF=454/392 PREF=456/134  
PREF=753/241 PREF=753/322 PREF=753/375 PREF=753/378 PREF=753/381 PREF=754/125 PREF=895/486 PREF=922/152 PREF=996/364 PREF=1138/690  
PREF=1161/33 PREF=227/443 PREF=364/311 PREF=364/447 PREF=442/693 PREF=455/197 PREF=558/711 PREF=594/87 PREF=596/304 PREF=596/307  
PREF=597/352 PREF=600/77 PREF=616/348 PREF=700/553 PREF=702/825 PREF=720/734 PREF=720/735 PREF=720/736 PREF=720/737 PREF=720/738  
PREF=720/739 PREF=722/92 PREF=735/864 PREF=735/868 PREF=735/872 PREF=735/876 PREF=735/880 PREF=735/884 PREF=788/486 PREF=890/556  
PREF=918/497 PREF=920/792 PREF=920/797 PREF=921/23 PREF=968/399 PREF=1054/660 PREF=1140/208 PREF=1192/873 PREF=24/438 PREF=39/388  
PREF=188/89 PREF=243/352 PREF=427/161 PREF=574/719 PREF=880/430 PREF=880/438 PREF=880/452 PREF=880/460 PREF=880/468 PREF=880/476  
PREF=1108/692 PREF=1108/699 PREF=1150/187 PREF=27/298 PREF=34/584 PREF=39/321 PREF=39/463 PREF=211/283 PREF=347/20 PREF=347/147  
PREF=512/567 PREF=702/828 PREF=722/551 PREF=994/243 PREF=1039/491 PREF=1054/527 PREF=1054/577 PREF=1056/536 PREF=1076/1 PREF=1100/431  
PREF=1155/528 PREF=1155/535 PREF=1181/354 PREF=1178/208 PREF=604/683 PREF=636/719 PREF=641/61 PREF=641/63 PREF=641/65 PREF=641/67  
PREF=641/573 PREF=642/677 PREF=644/594 PREF=651/26 PREF=904/356 PREF=904/364 PREF=904/371 PREF=904/378 PREF=904/385 9V04/392  
PREF=904/399 PREF=904/407 PREF=904/414 PREF=904/421 PREF=904/429 PREF=904/436 PREF=1088/721 PREF=1188/802 PREF=1190/470 PREF=1190/476  
PREF=1190/482

#1

Upton, TX

Southwest Abstract & Title Company

Examiner: swat.bgray

1006 N Rankin St.

Order:

Folder:

Created: 04/23/2026

Updated: 04/23/2026

RS: (Search 1)

Inst. count: 18

Printed: 04/23/2026

RS cert. date: 11/13/2025

Plant cert. dates: 01/01/1880-11/13/2025 05:00

OP/SPWD 1215/17 2024-195571 04/02/2024 04/17/2024 \$4,712,545.00

NFM TEXAS PROPERTIES LP
NFM TEXAS GENPAR LLC

H&TC RY CO [H]; S#: 78; B: 35

LONG ATLAS RANCH LLC
UPTON COUNTY WATER LLC

Notes: PREF=944/160 EXCEPTIONS PREF=190/292 PREF=190/294 PREF=196/270 PREF=196/274 PREF=310/186 PREF=320/279 PREF=391/409
PREF=391/407 PREF=749/795 PREF=749/799 PREF=749/803 PREF=749/807 PREF=749/812 PREF=750/740 PREF=759/34 PREF=758/802 PREF=785/543
PREF=920/802 PREF=1134/658 PREF=1140/166 PREF=1156/685 PREF=1156/691 PREF=60/57 PREF=441/487 PREF=453/434 PREF=454/392 PREF=456/134
PREF=753/241 PREF=753/322 PREF=753/375 PREF=753/378 PREF=753/381 PREF=754/125 PREF=895/486 PREF=922/152 PREF=996/364 PREF=1138/690
PREF=1161/33 PREF=227/443 PREF=364/311 PREF=364/447 PREF=442/693 PREF=455/197 PREF=558/711 PREF=594/87 PREF=596/304 PREF=596/307
PREF=597/352 PREF=600/77 PREF=616/348 PREF=700/553 PREF=702/825 PREF=720/734 PREF=720/735 PREF=720/736 PREF=720/737 PREF=720/738
PREF=720/739 PREF=722/92 PREF=735/864 PREF=735/868 PREF=735/872 PREF=735/876 PREF=735/880 PREF=735/884 PREF=788/486 PREF=890/556
PREF=918/497 PREF=920/792 PREF=920/797 PREF=921/23 PREF=968/399 PREF=1054/660 PREF=1140/208 PREF=1192/873 PREF=24/438 PREF=39/388
PREF=188/89 PREF=243/352 PREF=427/161 PREF=574/719 PREF=880/430 PREF=880/438 PREF=880/452 PREF=880/460 PREF=880/468 PREF=880/476
PREF=1108/692 PREF=1108/699 PREF=1150/187 PREF=27/298 PREF=34/584 PREF=39/321 PREF=39/463 PREF=211/283 PREF=347/20 PREF=347/147
PREF=512/567 PREF=702/828 PREF=722/551 PREF=994/243 PREF=1039/491 PREF=1054/527 PREF=1054/577 PREF=1056/536 PREF=1076/1 PREF=1100/431
PREF=1155/528 PREF=1155/535 PREF=1181/354 PREF=1178/208 PREF=604/683 PREF=636/719 PREF=641/61 PREF=641/63 PREF=641/65 PREF=641/67
PREF=641/573 PREF=642/677 PREF=644/594 PREF=651/26 PREF=904/356 PREF=904/364 PREF=904/371 PREF=904/378 PREF=904/385 9V04/392
PREF=904/399 PREF=904/407 PREF=904/414 PREF=904/421 PREF=904/429 PREF=904/436 PREF=1088/721 PREF=1188/802 PREF=1190/470 PREF=1190/476
PREF=1190/482

#1

TXSUT/TXSUT / 2024-24-231-DCTX-01416 04/23/2024 04/23/2024 \$8,217.43

Upton County Appraisal District

H&TC RY CO [H]; S#: 78; B: 35; Ac: 1.91 (V1037/154)

JARAMILLO LISA MARIE

outside boundary

N/A

OP/MRD 1245/547 2025-198767 02/01/2025 03/24/2025 \$0.00

COLEMAN JASON G

H&TC RY CO. SURVEY; S#: 78; B: 35 (NO AC GIVEN)

TOC HOLDINGS LLC

outside boundary

N/A

OP/MEMO 1248/47 2025-199112 03/14/2025 04/16/2025 \$0.00

MCCAMEY LAND & CATTLE LP
ELEMENTARY MANAGEMENT GROUP LLC

H&TC RY CO [H]; S#: 78; B: 35 (Notes=196.91 AC)

REDEUX ENERGY PARTNERS LLC

Notes: PREF=1242/84 PREF=198295

#6

OP/LEASE 1251/47 2025-199407 04/22/2025 05/08/2025 \$0.00

REDEUX ENERGY PARTNERS LLC

H&TC RY CO [H]; S#: 78; B: 35 (Notes=196.91 AC)

GOLDEN SKY SOLAR LLC

Notes: PREF=1248/47 PREF=2025-00199112

#6

Notes:
-----

Searches:-----
Exception 1 searches

(Except) Join: <M> and (<P> or <P>)
Entry date(s): 01/01/2021-04/23/2026

Include empty Survey properties
Include prior references
Apply prior references restrictions
Prior references level: 3
Forward references level: 3

Surveys:

Name(s):
H&TC RY (H/35) / 78 / / 35 /
H&TC RY CO [H] / 78 / / 35 /
H&TC RY CO. SURVEY / 78 / / 35 /

## Upton, TX

Examiner: swat.bgray

Order:

RS: (Search 1)

## Southwest Abstract & Title Company

1006 N Rankin St.

Folder:

Inst. count: 18

Created: 04/23/2026 Updated: 04/23/2026

Printed: 04/23/2026 RS cert. date: 11/13/2025

Plant cert. dates: 01/01/1880-11/13/2025 05:00



#7

Charles James Hemphill Jr  
6018 FM 503  
Valera, TX 76884

Saundra Hemphill Edington  
1440 CR 422  
Coleman, TX 76834

Upton County  
PO Box 482  
Rankin, TX 79778

Jennifer Jones Harsh  
185 E Saddle Club Rd  
Belle Rive, IL 62810

WM Sumter Weatherred  
1814 S Colorado  
Coleman, TX 76834

Upton County  
PO Box 482  
Rankin, TX 79778

Elizabeth Karen Taylor Allen  
915 Galveston  
Coleman, TX 76834

City of McCamey  
PO Box 1409  
McCamey, TX 79752

American Legion #421  
PO Box 308  
McCamey, TX 79752

Helen W Cross  
500 Stone Manor Dr  
McGregor, TX 76657

RR Kennedy Production Inc  
PO Box 5677  
Abilene, TX 79608

VFW of US – Young-McCollum Post  
#5071  
PO Box 1081  
McCamey, TX 79752

McMahan Living Trust  
405 Blue Daze Ct  
Burleson, TX 76028

City of McCamey  
PO Box 1409  
McCamey, TX 79752

Longhorn South Texas – 2007 LP  
1801 W Texas Ave  
Midland, TX 79701

Judy Jones Keith  
8809 Grand Ave  
North Richland Hills, TX 76180

Upton County  
PO Box 482  
Rankin, TX 79778

Longhorn South Texas – 2007 LP  
1801 W Texas Ave  
Midland, TX 79701

Josaphine Taylor Brown  
2519 Brown Ranch Lane  
Beeville, TX 78102

RR Kennedy Production Inc  
PO Box 5677  
Abilene, TX 79608

Upton County  
PO Box 482  
Rankin, TX 79778

Glenn Richard King Life Estate  
4850 Cromwell Dr Apt 112  
Kyle, TX 78640-6422

RayJean LTD  
PO Box 1527  
McCamey, TX 79752

Geraldine Shirley and Vikki Bradley  
1203 N 15<sup>th</sup> St  
Wolfforth, TX 79382

Tommy Saunders  
300 Cr 417  
Coleman, TX 76834

Edward and Dorothy Davis  
PO Box 1395  
McCamey, TX 79752

Mark Foncannon  
PO Box 205  
McCamey, TX 79752

Jamie Pool  
13229 FM 2303  
Stephenville, TX 76401

Upton County  
PO Box 482  
Rankin, TX 79778

Diana Martinez Graves  
PO Box 154  
McCamey, TX 79752

Charles James Hemphill Jr  
6018 FM 503  
Valera, TX 76884

Saundra Hemphill Edington  
1440 CR 422  
Coleman, TX 76834

Upton County  
PO Box 482  
Rankin, TX 79778

Jennifer Jones Harsh  
185 E Saddle Club Rd  
Belle Rive, IL 62810

WM Sumter Weatherred  
1814 S Colorado  
Coleman, TX 76834

Upton County  
PO Box 482  
Rankin, TX 79778

Elizabeth Karen Taylor Allen  
915 Galveston  
Coleman, TX 76834

City of McCamey  
PO Box 1409  
McCamey, TX 79752

American Legion #421  
PO Box 308  
McCamey, TX 79752

Helen W Cross  
500 Stone Manor Dr  
McGregor, TX 76657

RR Kennedy Production Inc  
PO Box 5677  
Abilene, TX 79608

VFW of US – Young-McCollum Post  
#5071  
PO Box 1081  
McCamey, TX 79752

McMahan Living Trust  
405 Blue Daze Ct  
Burlleson, TX 76028

City of McCamey  
PO Box 1409  
McCamey, TX 79752

Longhorn South Texas – 2007 LP  
1801 W Texas Ave  
Midland, TX 79701

Judy Jones Keith  
8809 Grand Ave  
North Richland Hills, TX 76180

Upton County  
PO Box 482  
Rankin, TX 79778

Longhorn South Texas – 2007 LP  
1801 W Texas Ave  
Midland, TX 79701

Josaphine Taylor Brown  
2519 Brown Ranch Lane  
Beeville, TX 78102

RR Kennedy Production Inc  
PO Box 5677  
Abilene, TX 79608

Upton County  
PO Box 482  
Rankin, TX 79778

Glenn Richard King Life Estate  
4850 Cromwell Dr Apt 112  
Kyle, TX 78640-6422

RayJean LTD  
PO Box 1527  
McCamey, TX 79752

Geraldine Shirley and Vikki Bradley  
1203 N 15<sup>th</sup> St  
Wolfforth, TX 79382

Tommy Saunders  
300 Cr 417  
Coleman, TX 76834

Edward and Dorothy Davis  
PO Box 1395  
McCamey, TX 79752

Mark Foncannon  
PO Box 205  
McCamey, TX 79752

Jamie Pool  
13229 FM 2303  
Stephenville, TX 76401

Upton County  
PO Box 482  
Rankin, TX 79778

Diana Martinez Graves  
PO Box 154  
McCamey, TX 79752

Charles James Hemphill Jr  
6018 FM 503  
Valera, TX 76884

Saundra Hemphill Edington  
1440 CR 422  
Coleman, TX 76834

Upton County  
PO Box 482  
Rankin, TX 79778

Jennifer Jones Harsh  
185 E Saddle Club Rd  
Belle Rive, IL 62810

WM Sumter Weatherred  
1814 S Colorado  
Coleman, TX 76834

Upton County  
PO Box 482  
Rankin, TX 79778

Elizabeth Karen Taylor Allen  
915 Galveston  
Coleman, TX 76834

City of McCamey  
PO Box 1409  
McCamey, TX 79752

American Legion #421  
PO Box 308  
McCamey, TX 79752

Helen W Cross  
500 Stone Manor Dr  
McGregor, TX 76657

RR Kennedy Production Inc  
PO Box 5677  
Abilene, TX 79608

VFW of US – Young-McCollum Post  
#5071  
PO Box 1081  
McCamey, TX 79752

McMahan Living Trust  
405 Blue Daze Ct  
Burluson, TX 76028

City of McCamey  
PO Box 1409  
McCamey, TX 79752

Longhorn South Texas – 2007 LP  
1801 W Texas Ave  
Midland, TX 79701

Judy Jones Keith  
8809 Grand Ave  
North Richland Hills, TX 76180

Upton County  
PO Box 482  
Rankin, TX 79778

Longhorn South Texas – 2007 LP  
1801 W Texas Ave  
Midland, TX 79701

Josaphine Taylor Brown  
2519 Brown Ranch Lane  
Beeville, TX 78102

RR Kennedy Production Inc  
PO Box 5677  
Abilene, TX 79608

Upton County  
PO Box 482  
Rankin, TX 79778

Glenn Richard King Life Estate  
4850 Cromwell Dr Apt 112  
Kyle, TX 78640-6422

RayJean LTD  
PO Box 1527  
McCamey, TX 79752

Geraldine Shirley and Vikki Bradley  
1203 N 15<sup>th</sup> St  
Wolfforth, TX 79382

Tommy Saunders  
300 Cr 417  
Coleman, TX 76834

Edward and Dorothy Davis  
PO Box 1395  
McCamey, TX 79752

Mark Foncannon  
PO Box 205  
McCamey, TX 79752

Jamie Pool  
13229 FM 2303  
Stephenville, TX 76401

Upton County  
PO Box 482  
Rankin, TX 79778

Diana Martinez Graves  
PO Box 154  
McCamey, TX 79752

#8

**OFFICIAL MINUTES – REGULAR MEETING  
CITY OF MCCAMEY  
MONDAY APRIL 13, 2026**

The City Council met for a Called Meeting on Monday April 13, 2026 in Council Chambers, City Hall, 207 East Sixth Street, McCamey, Texas, to act on the agenda posted for the meeting.

**PRESENT:** Mayor Pedro Rosales, Mayor Pro-Tem Noe Marquez, Alderman Ward 2 Ilda Lujan, Alderman Ward 3 Juan Galan, Alderman Ward 3 Angel Armendarez, City Attorney Melanie Spratt, City Secretary Patty Jones.

**ABSENT:** Alderman Ward 1 Vilma Rodriguez, Alderman Ward 1 Cindy Zuniga

**STAFF:** Ramon Venegas, Edward Fuentes, Ellen Crossland, Jacqueline Bend, Elodia Gomez

**GUESTS:** Nandy Zarate, Linda Zarate, Tom Feiler - Invenergy

1. Call meeting to Order.

Mayor Rosales called the meeting to order at 7:30

2. Pledge of Allegiance.

Mayor Rosales led the Pledge.

3. Prayer.

Alderman Angel Armendarez led the Prayer.

4. PUBLIC COMMENTS

Nandy Zarate asked about the status on the installation of the fire hydrant near E Nimitz. Edward Fuentes responded that all the supplies were on hand, but that this was not a simple project and several repairs and issues had to be completed over the past month. Nandy then stated that with the rain, his carport had flooded again and checked to see if the City could do anything about that. Nandy then asked the council if they knew the new culvert at E 5<sup>th</sup> and Grimes had been lifted out of the ground, Ramon stated that they had been notified over the weekend and that the contractor had been contacted and repairs would be made. Nandy asked about the survey for E Nimitz. Patty responded that the survey had been scheduled, but we had to wait for the company to complete the work and put us on the schedule.

5. Approve minutes of the Regular Meeting held March 16, 2026.  
Ilda Lujan motioned to approve the minutes of the Regular Meeting held March 16, 2026.  
Juan Galan seconded the motion. All voted in favor.

6. Review of financial reports for month ending March 2026.

General Fund Revenues to date	\$ 756,661.25
General Fund Expenses to date	\$ 471,093.44
Water & Sewer Fund Revenues to date	\$ 756,730.37
Water & Sewer Fund Expenses to date	\$ 814,275.67

7. Approve bills submitted for payment.

Ilda Lujan motioned to pay the bills. Angel Armendarez seconded. All voted in favor.

8. Discuss and act on allowing Nexterra to close the 100 block of East 5th for a proposed block party (date to be determined).

Noe Marquez motioned to allow Nexterra to close the 100 block of East 5<sup>th</sup> Street, after 5 pm, on the date they set for the block party. Juan Galan seconded. All voted in favor.

9. Discuss and act on proposed water infrastructure engineering analysis for Invenergy West Royal Project.

Tom Feiler with Invenergy addressed the Council on a proposed gas powered “peak usage” plant to potentially be located north of McCamey on Hwy 385. The initial review of the proposed plant location includes the proximity of high capacity electrical transmission lines, natural gas supply and water. Invenergy is requesting a water infrastructure engineering analysis on McCamey’s water system in order to determine what upgrades would be needed to accommodate the potential water use by the plant. The cost of the analysis would be paid by Invenergy. Attorney Spratt asked what type of customer would the plant be serving, like data centers? Mr. Feiler responded this plant would put power out onto the grid during peak usage times, and that power would then be purchased by any variety of consumers. Mr. Feiler spoke about the permit application that is currently waiting for final approval, and that it allows for plant usage capped at 40% of the time, and potential water usage from the City of McCamey would increase current yearly usage by 6-9% (over current average usage of 1.6 million gallons per year). Mayor Rosales asked about wastewater. Mr. Feiler responded that multiple options were available for wastewater, including going into the sewer, evaporation ponds, or aquifer recharge. Juan Galan asked about the noise levels. Response was 45 decibels at 500 feet (approximately the same as a dishwasher). Melanie Spratt asked to review any agreement concerning Invenergy agreeing to pay for the engineering analysis. Mr. Feiler will get that information to the City for review. Edward asked what other cities in Texas have similar projects already up and running. Mr. Feiler will send information on smaller towns in Texas that have projects so that McCamey can talk to those cities about any impacts. Ilda Lujan motioned to postpone decision pending advise of attorney on the agreement. Juan Galan seconded . All voted in favor.

10. Discuss and act on acting as a fiscal sponsor for a local non-profit organization (Doug Mowgi and Keny Wyland – organizers) that would allow them to write smaller (non-federal) grants.  
Zoom meeting was scheduled for an incorrect date. Ilda Lujan motioned to not move forward with proposal. Noe Marquez seconded. All voted in favor.
11. Discuss and act on Verkada/Abacus proposal for security cameras.  
Council requested further information on providing internet access at Landfill and Santa Fe Park to potentially reduce yearly cost of camera cell phone access charges. Angel Armendarez motioned to postpone. Ilda Lujan seconded. All voted in favor.
12. Discuss and act on repairs and maintenance to City Water tower located behind City Hall (Alley at the 200 block of E 6th St).  
Proposals for repairs to the 100K gallon water tank were reviewed. Council requested more detailed information on warranties provided by each vendor, cost of payment plans to spread cost of repairs over multiple years. Council also requested each vendor provide details for bringing water tower into compliance with TCEQ and OSHA updated requirements. Ilda Lujan motioned to postpone final decision. Noe Marquez seconded. All voted in favor.
13. Discuss and act on proposal from Cave Consulting to update website and transition to a .gov domain.  
Ilda Lujan motioned to accept the proposal for option #1 (the turnkey). Juan Galan seconded. All voted in favor.
14. Discuss and act on roof repairs on equipment shed at City Hall.  
Ilda Lujan asked if this project could be delayed due to other projects taking priority. Ramon said yes, this can be delayed. Mayor Rosales called for a motion on the roof repairs. Agenda item dies for lack of motion.
15. Discuss and act on sending out RFP for electricity provider, current contract expires November 2026.  
Ilda Lujan motioned to begin the RFP process. Angel Armendarez seconded. All voted in favor.
16. Discuss and act on awarding Downtown Revitalization Grant RFP for Grant Administration.  
The only proposal for services received was from Public Management. Ilda Lujan motioned to award the administration of the Downtown Revitalization Grant to Public Management. Juan Galan seconded. All voted in favor.
17. Discuss and act on setting workshop date to review City fee schedule.  
Angel Armendarez motioned to set the workshop prior to the regular meeting scheduled for Monday May 11, 2026 at 5:45. Ilda Lujan seconded. All voted in favor.

18. Discuss and act on setting pay rate for summer employees.  
Ilda Lujan motioned to set the pay rate for Summer employees at \$15 per hour. Juan Galan seconded. All voted in favor.
19. Discuss and act on implementing a “No Trespassing” policy for City Hall.  
Attorney Spratt recommended implementing this policy due to an incident at City Hall with a belligerent customer. Patty will contact the Upton County Sheriff’s office to file a report for harassing behavior, and have a no trespass warning issued. A letter will follow the Sheriff’s warning, and customer will be advised on options to pay bill. Ilda Lujan motioned to contact UCSO to issues the no trespass warning. Noe Marquez seconded. All voted in favor.
20. Discuss and act on designating City Secretary Patty Jones an authorized delegate signer for the TCEQ SOP modification documents.  
Angel Armendarez motioned to allow City Secretary Patty Jones to sign the TCEQ SOP update documents. Noe Marquez seconded. All voted in favor.
21. Discuss and act on overpayment of \$208.93 to Upton County Appraisal District.  
Ilda Lujan motioned to allow UCAD to retain the \$208.93 overpayment. Juan Galan seconded. All voted in favor.
22. Discuss and act on allowing City Secretary Patty Jones to attend the TML Budgeting Workshop in Austin June 9-11 2026.  
Angel Armendarez motioned to allow Patty to attend workshop. Noe Marquez seconded. All voted in favor. Only cost of workshop and hotel will be charged to the City.
23. REPORTS:
- Cost of Gas Report / review of Gas rate adjustment document  
Cost of Gas for March 2026 .4699 Ccf February .7741 Ccf
  - Sales Tax Collections Report April 2026 \$57,930.31
  - Code Enforcement Report  
15 contacts made through letters, 3 properties clean / brought up to code, 3 final notices sent
  - Animal Control Report  
5 dogs/1 cat picked up, 2 deceased animals removed, 5 redeemed, 1 adopted, 3 currently in pound, 1 warning / 1 citation issued, 4 after hours call outs.
  - Water Dept / Streets Report  
2 taps installed, 2 sewer issues, large leak on Monroe, fire hydrants inspected, set up to remove meter from old High School prior to demolition. Landfill pushed and rules for brush pile reviewed with attendant.  
Parks mowed and watering. A variety of Animal Control calls. Spoke to TXDOT about repair on Burleson and E 9<sup>th</sup> needing additional asphalt added due to settling.
  - Secretary Report  
TCEQ Emergency Preparedness Plan has been approved. Working on updating Code of Ordinances regarding tampering with meters. Any type of tampering (including turning your own water on) will result in criminal charges. Permian Paving has been contacted to

complete repair of culvert that came out of the ground at Grimes and E 5<sup>th</sup> - they will get the repairs scheduled. TCEQ Landfill SOP has 14 NODs (notice of deficiencies). Most have been corrected, but requested Mineral Rights Owners on each property will require research at the Abstract Office in Rankin. Cost will be either \$25 per document or \$170 per hour for 20 properties.

24. Adjourn.

Mayor Rosales adjourned the meeting at 9:13.

\_\_\_\_\_  
Pedro Rosales, Mayor

Attest: \_\_\_\_\_  
Patty Jones, City Secretary



## Texas Commission on Environmental Quality Plain Language Summary of Municipal Solid Waste Permit or Permit Amendment Application

Applicants are required by public notice rules in Title 30 Texas Administrative Code, Chapter 39, Section [39.405\(k\)](#)<sup>1</sup> to provide this summary of an application.

### A. Purpose of the Proposed Facility

A Type IV AE municipal landfill for proper municipal waste disposal

### B. Information About the Applicant

Name: City of McCamey

Applicant Type: Municipal

Facility Name: City of McCamey Landfill

Permit Application Number: 566

Customer Number (CN): 600669535

Regulated Entity Reference Number (RN): 102696051

### C. Location of the Proposed Facility

Facility Address (or description of site location if no address):

1.25 MILES SE OF FM 305 AND FM 1901 INTERSECTION 1000 FEET E OF FM 305 MCCAMEY TX

Link to Map of Facility Location ([TCEQ Location Mapper](#)<sup>2</sup>):

### D. Information about Facility Operation

What types of waste would be received?

Municipal solid waste except those that are prohibited.

What geographical area would the wastes come from?

Upton County

<sup>1</sup> [www.tceq.texas.gov/goto/view-30tac](http://www.tceq.texas.gov/goto/view-30tac)

<sup>2</sup> [www.tceq.texas.gov/gis/hb-610-viewer](http://www.tceq.texas.gov/gis/hb-610-viewer)

**What days and hours would the facility operate?**

**Tuesday 9-12 and 1-6, Wednesday 9-12 and 1-6, Thursday 9-12 and 1-6 and Saturday 9-12 and 1-6**

**At what rate would wastes be accepted?**

**Not exceed 20 tons per day or as limited by permit**

**How would wastes be managed?**

**In accordance with the SOP Table 4 Site Inspection and Maintenance List - Operational Requirements**

**E. Pollution Control Methods**

**What methods would the facility use for containing wastes and odors, and monitoring for releases?**

**In accordance with 330.149 Odor Management Plan on page 16 and 17 of the SOP**

**What methods would the facility use or require for preventing litter or spills, and for cleanup of litter and spills?**

**In accordance with 330.139 for Control of Windblown waste and litter in the SOP on page 15.**

#9



## Comisión de Calidad Ambiental de Texas

### Resumen en lenguaje sencillo de la solicitud de permiso municipal de residuos sólidos o de modificación del permiso

Los solicitantes están obligados por las normas de notificación pública del Título 30 del Código Administrativo de Texas, Capítulo 39, Sección [39.405\(k\)](#)<sup>1</sup> a proporcionar este resumen de una solicitud.

#### A. Objetivo de la instalación propuesta

Tipo IV AE vertedero municipal para la correcta eliminación de residuos municipales

#### B. Información sobre el solicitante

Nombre: Ciudad de McCamey

Tipo de solicitante: Gobierno municipal

Nombre de la instalación: Vertedero de Ciudad de McCamey

Número de solicitud de permiso: 566

Número de cliente (CN): 600669535

Número de referencia de la entidad regulada (RN): 102696051

#### C. Ubicación de la instalación propuesta

Dirección del establecimiento (o descripción de la ubicación del sitio si no hay dirección):

1.25 millas al sureste de la intersección de FM 305 y FM 1901; 1000 pies al este de FM 305, McCamey, TX.

Enlace al mapa de ubicación de las instalaciones en [TCEQ Location Mapper](#)<sup>2</sup>:

<https://arcg.is/HrqWP1>

#### D. Información sobre el funcionamiento de las instalaciones

¿Qué tipos de residuos se recibirían?

Residuos sólidos municipales, excepto aquellos que estén prohibidos.

¿De qué zona geográfica procederían los residuos?

Condado de Upton

<sup>1</sup> [www.tceq.texas.gov/goto/view-30tac](http://www.tceq.texas.gov/goto/view-30tac)

<sup>2</sup> [www.tceq.texas.gov/gis/hb-610-viewer](http://www.tceq.texas.gov/gis/hb-610-viewer)

¿Qué días y horas funcionará la instalación?

Martes de 9 a 12 y de 1 a 6; miércoles de 9 a 12 y de 1 a 6; jueves de 9 a 12 y de 1 a 6; y sábado de 9 a 12 y de 1 a 6.

¿A qué ritmo se aceptarían los residuos?

No exceder las 20 toneladas diarias o el límite establecido en el permiso.

¿Cómo se gestionarían los residuos?

De conformidad con la Tabla 4 del SOP: Lista de inspección y mantenimiento del sitio — Requisitos operativos

#### **E. Métodos de control de la contaminación**

¿Qué métodos utilizará la instalación para contener los residuos y los olores, y para controlar las emisiones?

De conformidad con la sección 330.149, «Plan de gestión de olores», en las páginas 16 y 17 del SOP.

¿Qué métodos utilizaría o exigiría la instalación para evitar la basura o los derrames, y para la limpieza de la basura y los derrames?

De conformidad con la sección 330.139, sobre el control de residuos y basura arrastrados por el viento, en el SOP de la página 15.