



Administrative Package Cover Page

This file contains the following documents:

1. Summary of application (in plain language)
 - English
 - Alternative Language (Spanish)
2. First Notice (NORI-Notice of Receipt of Application and Intent to Obtain a Permit)
 - English
 - Alternative Language (Spanish)
3. Application materials



Portada de Paquete Administrativo

Este archivo contiene los siguientes documentos:

1. Resumen en lenguaje sencillo (PLS, por sus siglas en inglés) de la actividad propuesta
 - Inglés
 - Idioma alternativo (español)
2. Primer aviso (NORI, por sus siglas en inglés)
 - Inglés
 - Idioma alternativo (español)
3. Solicitud original



TEXAS COMMISSION ON ENVIRONMENTAL QUALITY

PLAIN LANGUAGE SUMMARY FOR TPDES OR TLAP PERMIT APPLICATIONS

Plain Language Summary Template and Instructions for Texas Pollutant Discharge Elimination System (TPDES) and Texas Land Application (TLAP) Permit Applications

Applicants should use this template to develop a plain language summary as required by [Title 30, Texas Administrative Code \(30 TAC\), Chapter 39, Subchapter H](#). Applicants may modify the template as necessary to accurately describe their facility as long as the summary includes the following information: (1) the function of the proposed plant or facility; (2) the expected output of the proposed plant or facility; (3) the expected pollutants that may be emitted or discharged by the proposed plant or facility; and (4) how the applicant will control those pollutants, so that the proposed plant will not have an adverse impact on human health or the environment.

Fill in the highlighted areas below to describe your facility and application in plain language. Instructions and examples are provided below. Make any other edits necessary to improve readability or grammar and to comply with the rule requirements.

If you are subject to the alternative language notice requirements in [30 TAC Section 39.426](#), **you must provide a translated copy of the completed plain language summary in the appropriate alternative language as part of your application package**. For your convenience, a Spanish template has been provided below.

ENGLISH TEMPLATE FOR TPDES or TLAP NEW/RENEWAL/AMENDMENT APPLICATIONS DOMESTIC WASTEWATER/STORMWATER

The following summary is provided for this pending water quality permit application being reviewed by the Texas Commission on Environmental Quality as required by 30 TAC Chapter 39. The information provided in this summary may change during the technical review of the application and is not a federal enforceable representation of the permit application.

The City of La Ward (CN 600641708) operates the City of La Ward Wastewater Treatment Plant (RN 102287562), a wastewater treatment plant. The facility is located at approximately 1,200 feet northeast of the intersection of FM 616 and SH 172, in La Ward, Jackson County, Texas 77970. This application is for the renewal Texas Pollutant Discharge Elimination System (TPDES) Permit No. WQ0013479001 (EPA I.D. No. TX0105104) to authorize the discharge of treated wastewater at a volume not to exceed a daily average flow of 24,000 gallons per day. The discharge route is from one block north of the intersection of FM 616 and State Hwy 172, turn East on Rio Grande; travel 4 blocks on paved road to Palacios St.; continue East on dirt road 1 block; turn north and the plant is on your left.

Discharges from the facility are expected to contain The pollutants expected from the discharge are: CBOD₅, Total Suspended Solids, Ammonia Nitrogen, Nitrate Nitrogen, Total Kjeldahl Nitrogen Sulfate, Chloride, Total Phosphorus, pH, Dissolved Oxygen, Chlorine Residual, Enterococci, Total Dissolved Solids, Oil & Grease, and Alkalinity. The discharge is treated wastewater and is treated by Extended aeration activated sludge plant. Process

TEXAS COMMISSION ON ENVIRONMENTAL QUALITY



NOTICE OF RECEIPT OF APPLICATION AND INTENT TO OBTAIN WATER QUALITY PERMIT RENEWAL

PERMIT NO. WQ0013479001

APPLICATION. City of La Ward, P.O. Box 178, La Ward, Texas 77970, has applied to the Texas Commission on Environmental Quality (TCEQ) to renew Texas Pollutant Discharge Elimination System (TPDES) Permit No. WQ0013479001 (EPA I.D. No. TX0105104) to authorize the discharge of treated wastewater at a volume not to exceed a daily average flow of 24,000 gallons per day. The domestic wastewater treatment facility is located approximately 1,200 feet northeast of the intersection of Farm-to-Market Road 616 and State Highway 172, in the city of La Ward, in Jackson County, Texas 77970. The discharge route is from the plant site to a series of ditches; thence to an unnamed tributary; thence to West Carancahua Creek; thence to Carancahua Creek; thence to Carancahua Bay. TCEQ received this application on November 15, 2024. The permit application will be available for viewing and copying at La Ward Post Office, 13059 State Highway 172, La Ward, in Jackson County, Texas prior to the date this notice is published in the newspaper. The application, including any updates, and associated notices are available electronically at the following webpage:

<https://www.tceq.texas.gov/permitting/wastewater/pending-permits/tpdes-applications>. This link to an electronic map of the site or facility's general location is provided as a public courtesy and not part of the application or notice. For the exact location, refer to the application.

<https://gisweb.tceq.texas.gov/LocationMapper/?marker=-96.461111,28.845555&level=18>

ADDITIONAL NOTICE. TCEQ's Executive Director has determined the application is administratively complete and will conduct a technical review of the application. After technical review of the application is complete, the Executive Director may prepare a draft permit and will issue a preliminary decision on the application. **Notice of the Application and Preliminary Decision will be published and mailed to those who are on the county-wide mailing list and to those who are on the mailing list for this application. That notice will contain the deadline for submitting public comments.**

PUBLIC COMMENT / PUBLIC MEETING. You may submit public comments or request a public meeting on this application. The purpose of a public meeting is to provide the opportunity to submit comments or to ask questions about the application. TCEQ will hold a public meeting if the Executive Director determines that there is a significant degree of public interest in the application or if requested by a local legislator. A public meeting is not a contested case hearing.

OPPORTUNITY FOR A CONTESTED CASE HEARING. After the deadline for submitting public comments, the Executive Director will consider all timely comments and prepare a response to all relevant and material, or significant public comments. **Unless the application is directly referred for a contested case hearing, the response to comments, and the Executive Director's decision on the application, will be mailed to everyone who submitted public comments and to those persons who are on the mailing list for this application.** If comments are received, the mailing will also provide instructions for requesting reconsideration of the Executive Director's decision and for requesting a contested case hearing. A contested case hearing is a legal proceeding similar to a civil trial in state district court.

TO REQUEST A CONTESTED CASE HEARING, YOU MUST INCLUDE THE FOLLOWING ITEMS IN YOUR REQUEST: your name, address, phone number; applicant's name and proposed permit number; the location and distance of your property/activities relative to the proposed facility; a specific description of how you would be adversely affected by the facility in a way not common to the general public; a list of all disputed issues of fact that you submit during the comment period and, the statement "[I/we] request a contested case hearing." If the request for contested case hearing is filed on behalf of a group or association, the request must designate the group's representative for receiving future correspondence; identify by name and physical address an individual member of the group who would be adversely affected by the proposed facility or activity; provide the information discussed above regarding the affected member's location and distance from the facility or activity; explain how and why the member would be affected; and explain how the interests the group seeks to protect are relevant to the group's purpose.

Following the close of all applicable comment and request periods, the Executive Director will forward the application and any requests for reconsideration or for a contested case hearing to the TCEQ Commissioners for their consideration at a scheduled Commission meeting.

The Commission may only grant a request for a contested case hearing on issues the requestor submitted in their timely comments that were not subsequently withdrawn. **If a hearing is granted, the subject of a hearing will be limited to disputed issues of fact or mixed questions of fact and law relating to relevant and material water quality concerns submitted during the comment period.**

TCEQ may act on an application to renew a permit for discharge of wastewater without providing an opportunity for a contested case hearing if certain criteria are met.

MAILING LIST. If you submit public comments, a request for a contested case hearing or a reconsideration of the Executive Director's decision, you will be added to the mailing list for this specific application to receive future public notices mailed by the Office of the Chief Clerk. In addition, you may request to be placed on: (1) the permanent mailing list for a specific applicant name and permit number; and/or (2) the mailing list for a specific county. If you wish to be placed on the permanent and/or the county mailing list, clearly specify which list(s) and send your request to TCEQ Office of the Chief Clerk at the address below.

INFORMATION AVAILABLE ONLINE. For details about the status of the application, visit the Commissioners' Integrated Database at www.tceq.texas.gov/goto/cid. Search the database using the permit number for this application, which is provided at the top of this notice.

AGENCY CONTACTS AND INFORMATION. All public comments and requests must be submitted either electronically at <https://www14.tceq.texas.gov/epic/eComment/>, or in writing to the Texas Commission on Environmental Quality, Office of the Chief Clerk, MC-105, P.O. Box 13087, Austin, Texas 78711-3087. Please be aware that any contact information you provide, including your name, phone number, email address and physical address will become part of the agency's public record. For more information about this permit application or the permitting process, please call the TCEQ Public Education Program, Toll Free, at 1-800-687-4040 or visit their website at www.tceq.texas.gov/goto/pep. Si desea información en Español, puede llamar al 1-800-687-4040.

Further information may also be obtained from City of La Ward at the address stated above or by calling Mr. Scott Mason, P.E., G&W Engineers, Inc., at 361-552-4509.

Issuance Date: 01/06/2024



TCEQ Core Data Form

For detailed instructions on completing this form, please read the Core Data Form Instructions or call 512-239-5175.

SECTION I: General Information

| | | |
|---|---|---|
| 1. Reason for Submission (If other is checked please describe in space provided.) | | |
| <input type="checkbox"/> New Permit, Registration or Authorization (Core Data Form should be submitted with the program application.) | | |
| <input type="checkbox"/> Renewal (Core Data Form should be submitted with the renewal form) | <input type="checkbox"/> Other | |
| 2. Customer Reference Number (if issued) | Follow this link to search for CN or RN numbers in Central Registry** | 3. Regulated Entity Reference Number (if issued) |
| CN 600641708 | | RN 102287562 |

SECTION II: Customer Information

| | | | | | |
|--|---------|--|----|---|--|
| 4. General Customer Information | | 5. Effective Date for Customer Information Updates (mm/dd/yyyy) | | 7/18/2024 | |
| <input type="checkbox"/> New Customer <input checked="" type="checkbox"/> Update to Customer Information <input type="checkbox"/> Change in Regulated Entity Ownership | | | | | |
| <input type="checkbox"/> Change in Legal Name (Verifiable with the Texas Secretary of State or Texas Comptroller of Public Accounts) | | | | | |
| <i>The Customer Name submitted here may be updated automatically based on what is current and active with the Texas Secretary of State (SOS) or Texas Comptroller of Public Accounts (CPA).</i> | | | | | |
| 6. Customer Legal Name (If an individual, print last name first: eg: Doe, John) | | | | <i>If new Customer, enter previous Customer below:</i> | |
| The City of La Ward | | | | | |
| 7. TX SOS/CPA Filing Number | | 8. TX State Tax ID (11 digits) | | 9. Federal Tax ID (9 digits) | 10. DUNS Number (if applicable) |
| 742462813 | | 742462813 | | 828506787 | |
| 11. Type of Customer: | | <input type="checkbox"/> Corporation | | <input type="checkbox"/> Individual | Partnership: <input type="checkbox"/> General <input type="checkbox"/> Limited |
| Government: <input checked="" type="checkbox"/> City <input type="checkbox"/> County <input type="checkbox"/> Federal <input type="checkbox"/> Local <input type="checkbox"/> State <input type="checkbox"/> Other | | <input type="checkbox"/> Sole Proprietorship | | <input type="checkbox"/> Other: | |
| 12. Number of Employees | | | | 13. Independently Owned and Operated? | |
| <input checked="" type="checkbox"/> 0-20 <input type="checkbox"/> 21-100 <input type="checkbox"/> 101-250 <input type="checkbox"/> 251-500 <input type="checkbox"/> 501 and higher | | | | <input checked="" type="checkbox"/> Yes <input type="checkbox"/> No | |
| 14. Customer Role (Proposed or Actual) – as it relates to the Regulated Entity listed on this form. Please check one of the following | | | | | |
| <input type="checkbox"/> Owner <input type="checkbox"/> Operator <input checked="" type="checkbox"/> Owner & Operator <input type="checkbox"/> Other: | | | | | |
| <input type="checkbox"/> Occupational Licensee <input type="checkbox"/> Responsible Party <input type="checkbox"/> VCP/BSA Applicant | | | | | |
| 15. Mailing Address: | | | | | |
| P.O. Box 178 | | | | | |
| City | La Ward | State | TX | ZIP | 77970 |
| ZIP + 4 | | | | | |
| 16. Country Mailing Information (if outside USA) | | | | 17. E-Mail Address (if applicable) | |
| | | | | | |
| 18. Telephone Number | | 19. Extension or Code | | 20. Fax Number (if applicable) | |
| | | | | | |

SECTION III: Regulated Entity Information

21. General Regulated Entity Information (If 'New Regulated Entity' is selected, a new permit application is also required.)

☐ New Regulated Entity ☐ Update to Regulated Entity Name ☒ Update to Regulated Entity Information

The Regulated Entity Name submitted may be updated, in order to meet TCEQ Core Data Standards (removal of organizational endings such as Inc, LP, or LLC).

22. Regulated Entity Name (Enter name of the site where the regulated action is taking place.)

City of La Ward Wastewater Treatment Plant

23. Street Address of the Regulated Entity:

(No PO Boxes)

| | | | | | | | |
|------|---------|-------|----|-----|-------|---------|--|
| City | La Ward | State | TX | ZIP | 77970 | ZIP + 4 | |
|------|---------|-------|----|-----|-------|---------|--|

24. County

Jackson

If no Street Address is provided, fields 25-28 are required.

25. Description to Physical Location:

approximately 1,200 feet northeast of the intersection of FM 616 and SH 172

26. Nearest City

State

Nearest ZIP Code

La Ward

TX

77970

Latitude/Longitude are required and may be added/updated to meet TCEQ Core Data Standards. (Geocoding of the Physical Address may be used to supply coordinates where none have been provided or to gain accuracy).

27. Latitude (N) In Decimal:

28.8455

28. Longitude (W) In Decimal:

-96.46103

Degrees

Minutes

Seconds

Degrees

Minutes

Seconds

28

50'

43.8"

-96

27'

39.7"

29. Primary SIC Code

(4 digits)

30. Secondary SIC Code

(4 digits)

31. Primary NAICS Code

(5 or 6 digits)

32. Secondary NAICS Code

(5 or 6 digits)

4952

22132

33. What is the Primary Business of this entity? (Do not repeat the SIC or NAICS description.)

34. Mailing Address:

P.O. Box 178

City

La Ward

State

TX

ZIP

77970

ZIP + 4

35. E-Mail Address:

koch_wr@yahoo.com

36. Telephone Number

37. Extension or Code

38. Fax Number (if applicable)

(361) 781-2929

() -

39. TCEQ Programs and ID Numbers Check all Programs and write in the permits/registration numbers that will be affected by the updates submitted on this form. See the Core Data Form instructions for additional guidance.

| | | | | |
|--|--|---|--|---|
| <input type="checkbox"/> Dam Safety | <input type="checkbox"/> Districts | <input type="checkbox"/> Edwards Aquifer | <input type="checkbox"/> Emissions Inventory Air | <input type="checkbox"/> Industrial Hazardous Waste |
| | | | | |
| <input type="checkbox"/> Municipal Solid Waste | <input type="checkbox"/> New Source Review Air | <input type="checkbox"/> OSSF | <input type="checkbox"/> Petroleum Storage Tank | <input type="checkbox"/> PWS |
| | | | | |
| <input type="checkbox"/> Sludge | <input type="checkbox"/> Storm Water | <input type="checkbox"/> Title V Air | <input type="checkbox"/> Tires | <input type="checkbox"/> Used Oil |
| | | | | |
| <input type="checkbox"/> Voluntary Cleanup | <input checked="" type="checkbox"/> Wastewater | <input type="checkbox"/> Wastewater Agriculture | <input type="checkbox"/> Water Rights | <input type="checkbox"/> Other: |
| | WQ0013479001 | | | |

SECTION IV: Preparer Information

| | | | |
|-----------------------------|----------------------|-----------------------|---------------------------|
| 40. Name: | Scott P. Mason | 41. Title: | Senior Engineer |
| 42. Telephone Number | 43. Ext./Code | 44. Fax Number | 45. E-Mail Address |
| (361) 552-4509 | | (361) 552-4987 | smason@gwengineers.com |

SECTION V: Authorized Signature

46. By my signature below, I certify, to the best of my knowledge, that the information provided in this form is true and complete, and that I have signature authority to submit this form on behalf of the entity specified in Section II, Field 6 and/or as required for the updates to the ID numbers identified in field 39.

| | | | |
|-------------------------|---|-------------------|-------------------|
| Company: | G&W Engineers, Inc. | Job Title: | Senior Engineer |
| Name (In Print): | Scott P. Mason | Phone: | (361) 552- 4509 |
| Signature: |  | Date: | 11/14/24 |

TCEQ DOMESTIC WASTEWATER PERMIT APPLICATION
DOMESTIC ADMINISTRATIVE REPORT

for

CITY OF LA WARD
PERMIT NO. WQ0013479001
P.O. BOX 178, La Ward, Texas 77970

Administrative Report 1.0

Exhibits

- A. Administrative Report 1.0: ORIGINAL USGS TOPO MAP
- B. Administrative Report 1.0: ORIGINAL USGS TOPO MAP



TEXAS COMMISSION ON ENVIRONMENTAL QUALITY

DOMESTIC WASTEWATER PERMIT APPLICATION CHECKLIST

Complete and submit this checklist with the application.

APPLICANT NAME: The City of La Ward

PERMIT NUMBER (If new, leave blank): WQ00 13479001

Indicate if each of the following items is included in your application.

| | Y | N | | Y | N |
|------------------------------|-------------------------------------|-------------------------------------|--------------------------|-------------------------------------|-------------------------------------|
| Administrative Report 1.0 | <input checked="" type="checkbox"/> | <input type="checkbox"/> | Original USGS Map | <input checked="" type="checkbox"/> | <input type="checkbox"/> |
| Administrative Report 1.1 | <input type="checkbox"/> | <input checked="" type="checkbox"/> | Affected Landowners Map | <input type="checkbox"/> | <input checked="" type="checkbox"/> |
| SPIF | <input checked="" type="checkbox"/> | <input type="checkbox"/> | Landowner Disk or Labels | <input type="checkbox"/> | <input checked="" type="checkbox"/> |
| Core Data Form | <input checked="" type="checkbox"/> | <input type="checkbox"/> | Buffer Zone Map | <input type="checkbox"/> | <input checked="" type="checkbox"/> |
| Public Involvement Plan Form | <input checked="" type="checkbox"/> | <input type="checkbox"/> | Flow Diagram | <input checked="" type="checkbox"/> | <input type="checkbox"/> |
| Technical Report 1.0 | <input checked="" type="checkbox"/> | <input type="checkbox"/> | Site Drawing | <input checked="" type="checkbox"/> | <input type="checkbox"/> |
| Technical Report 1.1 | <input type="checkbox"/> | <input checked="" type="checkbox"/> | Original Photographs | <input type="checkbox"/> | <input checked="" type="checkbox"/> |
| Worksheet 2.0 | <input checked="" type="checkbox"/> | <input type="checkbox"/> | Design Calculations | <input type="checkbox"/> | <input checked="" type="checkbox"/> |
| Worksheet 2.1 | <input type="checkbox"/> | <input checked="" type="checkbox"/> | Solids Management Plan | <input type="checkbox"/> | <input checked="" type="checkbox"/> |
| Worksheet 3.0 | <input type="checkbox"/> | <input checked="" type="checkbox"/> | Water Balance | <input type="checkbox"/> | <input checked="" type="checkbox"/> |
| Worksheet 3.1 | <input type="checkbox"/> | <input checked="" type="checkbox"/> | | | |
| Worksheet 3.2 | <input type="checkbox"/> | <input checked="" type="checkbox"/> | | | |
| Worksheet 3.3 | <input type="checkbox"/> | <input checked="" type="checkbox"/> | | | |
| Worksheet 4.0 | <input type="checkbox"/> | <input checked="" type="checkbox"/> | | | |
| Worksheet 5.0 | <input type="checkbox"/> | <input checked="" type="checkbox"/> | | | |
| Worksheet 6.0 | <input checked="" type="checkbox"/> | <input type="checkbox"/> | | | |
| Worksheet 7.0 | <input type="checkbox"/> | <input checked="" type="checkbox"/> | | | |

For TCEQ Use Only

Segment Number _____ County _____
Expiration Date _____ Region _____
Permit Number _____



TEXAS COMMISSION ON ENVIRONMENTAL QUALITY

DOMESTIC WASTEWATER PERMIT APPLICATION ADMINISTRATIVE REPORT 1.0

For any questions about this form, please contact the Applications Review and Processing Team at 512-239-4671.

Section 1. Application Fees (Instructions Page 26)

Indicate the amount submitted for the application fee (check only one).

| Flow | New/Major Amendment | Renewal |
|---------------------|-------------------------------------|--|
| <0.05 MGD | \$350.00 <input type="checkbox"/> | \$315.00 <input checked="" type="checkbox"/> |
| ≥0.05 but <0.10 MGD | \$550.00 <input type="checkbox"/> | \$515.00 <input type="checkbox"/> |
| ≥0.10 but <0.25 MGD | \$850.00 <input type="checkbox"/> | \$815.00 <input type="checkbox"/> |
| ≥0.25 but <0.50 MGD | \$1,250.00 <input type="checkbox"/> | \$1,215.00 <input type="checkbox"/> |
| ≥0.50 but <1.0 MGD | \$1,650.00 <input type="checkbox"/> | \$1,615.00 <input type="checkbox"/> |
| ≥1.0 MGD | \$2,050.00 <input type="checkbox"/> | \$2,015.00 <input type="checkbox"/> |

Minor Amendment (for any flow) \$150.00 ☐

Payment Information:

Mailed Check/Money Order Number:

Check/Money Order Amount:

Name Printed on Check:

EPAY Voucher Number:

Copy of Payment Voucher enclosed? Yes ☐

Section 2. Type of Application (Instructions Page 26)

a. Check the box next to the appropriate authorization type.

- ☒ Publicly-Owned Domestic Wastewater
- ☐ Privately-Owned Domestic Wastewater
- ☐ Conventional Wastewater Treatment

b. Check the box next to the appropriate facility status.

- ☒ Active ☐ Inactive

c. Check the box next to the appropriate permit type.

- ☒ TPDES Permit
- ☐ TLAP
- ☐ TPDES Permit with TLAP component

☐ Subsurface Area Drip Dispersal System (SADDS)

d. Check the box next to the appropriate application type

☐ New

☐ Major Amendment with Renewal

☐ Minor Amendment with Renewal

☐ Major Amendment without Renewal

☐ Minor Amendment without Renewal

☒ Renewal without changes

☐ Minor Modification of permit

e. For amendments or modifications, describe the proposed changes: [Click to enter text.](#)

f. For existing permits:

Permit Number: WQ00 13479001

EPA I.D. (TPDES only): TX 0105104

Expiration Date: April 3, 2025

Section 3. Facility Owner (Applicant) and Co-Applcant Information (Instructions Page 26)

A. The owner of the facility must apply for the permit.

What is the Legal Name of the entity (applicant) applying for this permit?

The City of La Ward

(The legal name must be spelled exactly as filed with the Texas Secretary of State, County, or in the legal documents forming the entity.)

If the applicant is currently a customer with the TCEQ, what is the Customer Number (CN)?

You may search for your CN on the TCEQ website at <http://www15.tceq.texas.gov/crpub/>

CN: 600641708

What is the name and title of the person signing the application? The person must be an executive official meeting signatory requirements in 30 TAC § 305.44.

Prefix: Mr.

Last Name, First Name: Koch, Richard

Title: Mayor

Credential: [Click to enter text.](#)

B. **Co-applicant information.** Complete this section only if another person or entity is required to apply as a co-permittee.

What is the Legal Name of the co-applicant applying for this permit?

[Click to enter text.](#)

(The legal name must be spelled exactly as filed with the TX SOS, with the County, or in the legal documents forming the entity.)

If the co-applicant is currently a customer with the TCEQ, what is the Customer Number (CN)?

You may search for your CN on the TCEQ website at: <http://www15.tceq.texas.gov/crpub/>

CN: [Click to enter text.](#)

What is the name and title of the person signing the application? The person must be an executive official meeting signatory requirements in 30 TAC § 305.44.

Prefix: [Click to enter text.](#)

Last Name, First Name: [Click to enter text.](#)

Title: [Click to enter text.](#)

Credential: [Click to enter text.](#)

Provide a brief description of the need for a co-permittee: [Click to enter text.](#)

C. Core Data Form

Complete the Core Data Form for each customer and include as an attachment. If the customer type selected on the Core Data Form is **Individual**, complete **Attachment 1** of Administrative Report 1.0. [Click to enter text.](#)

Section 4. Application Contact Information (Instructions Page 27)

This is the person(s) TCEQ will contact if additional information is needed about this application. Provide a contact for administrative questions and technical questions.

A. Prefix: Mr. Last Name, First Name: Koch, Richard
Title: Mayor Credential: [Click to enter text.](#)
Organization Name: The City of La Ward
Mailing Address: P.O. Box 178 City, State, Zip Code: La Ward, Texas, 77970
Phone No.: 361-781-2929 E-mail Address: koch_wr@yahoo.com
Check one or both: ☒ Administrative Contact ☐ Technical Contact

B. Prefix: Mr. Last Name, First Name: Mason, Scott
Title: Senior Engineer Credential: P.E.
Organization Name: G&W Engineers, Inc.
Mailing Address: 205 W Live Oak City, State, Zip Code: Port Lavaca, Texas, 77979
Phone No.: 361-552-4509 E-mail Address: smason@gwengineers.com
Check one or both: ☐ Administrative Contact ☒ Technical Contact

Section 5. Permit Contact Information (Instructions Page 27)

Provide the names and contact information for two individuals that can be contacted throughout the permit term.

A. Prefix: Mr. Last Name, First Name: Koch, Richard
Title: Mayor Credential: [Click to enter text.](#)
Organization Name: The City of La Ward
Mailing Address: P.O. Box 178 City, State, Zip Code: La Ward, Texas, 77970
Phone No.: 361-781-2929 E-mail Address: koch_wr@yahoo.com
B. Prefix: Ms. Last Name, First Name: Akes, Debbie
Title: Mayor Pro-Tem Credential: [Click to enter text.](#)
Organization Name: The City of La Ward
Mailing Address: P.O. Box 178 City, State, Zip Code: La Ward, Texas, 77970
Phone No.: 361-554-2823 E-mail Address: debbie2685@icloud.com

Section 6. Billing Contact Information (Instructions Page 27)

The permittee is responsible for paying the annual fee. The annual fee will be assessed to permits ***in effect on September 1 of each year***. The TCEQ will send a bill to the address provided in this section. The permittee is responsible for terminating the permit when it is no longer needed (using form TCEQ-20029).

Prefix: Mr. Last Name, First Name: Koch, Richard
Title: Mayor Credential: Click to enter text.
Organization Name: The City of La Ward
Mailing Address: P.O. Box 178 City, State, Zip Code: La Ward, Texas, 7790
Phone No.: 361-781-2929 E-mail Address: Koch_wr@yahoo.com

Section 7. DMR/MER Contact Information (Instructions Page 27)

Provide the name and complete mailing address of the person delegated to receive and submit Discharge Monitoring Reports (DMR) (EPA 3320-1) or maintain Monthly Effluent Reports (MER).

Prefix: Mr. Last Name, First Name: Zamora, Joe , Jr.
Title: Operator Credential: Click to enter text.
Organization Name: The City of La Ward
Mailing Address: P.O. Box 273 City, State, Zip Code: Wadsworth, Texas, 77483
Phone No.: 979-240-0457 E-mail Address: jzamora@jzutilities.com

Section 8. Public Notice Information (Instructions Page 27)

A. Individual Publishing the Notices

Prefix: Mr. Last Name, First Name: Mason, Scott
Title: Senior Engineer Credential: P.E.
Organization Name: G&W Engineers, Inc.
Mailing Address: 205 W Live Oak City, State, Zip Code: Port Lavaca, Texas, 77979
Phone No.: 361-552-4509 E-mail Address: smason@gwengineers.com

B. Method for Receiving Notice of Receipt and Intent to Obtain a Water Quality Permit Package

Indicate by a check mark the preferred method for receiving the first notice and instructions:

- ☒ E-mail Address
☐ Fax
☒ Regular Mail

C. Contact permit to be listed in the Notices

Prefix: Mr. Last Name, First Name: Mason, Scott
Title: Senior Engineer Credential: P.E.

Organization Name: G&W Engineers, Inc.

Mailing Address: 205 W Live Oak

City, State, Zip Code: Port Lavaca, Texas, 77979

Phone No.: 361-552-4509

E-mail Address: smason@gwengineers.com

D. Public Viewing Information

If the facility or outfall is located in more than one county, a public viewing place for each county must be provided.

Public building name: La Ward Post Office

Location within the building: Main Lobby

Physical Address of Building: 13059 TX-172, La Ward TX, 77970

City: La Ward

County: Jackson

Contact (Last Name, First Name): Malek, Angelina

Phone No.: 361-781-2237 Ext.: Click to enter text.

E. Bilingual Notice Requirements

This information is **required** for **new, major amendment, minor amendment or minor modification, and renewal** applications.

This section of the application is only used to determine if alternative language notices will be needed. Complete instructions on publishing the alternative language notices will be in your public notice package.

Please call the bilingual/ESL coordinator at the nearest elementary and middle schools and obtain the following information to determine whether an alternative language notices are required.

1. Is a bilingual education program required by the Texas Education Code at the elementary or middle school nearest to the facility or proposed facility?

☐ Yes ☒ No

If **no**, publication of an alternative language notice is not required; **skip to** Section 9 below.

2. Are the students who attend either the elementary school or the middle school enrolled in a bilingual education program at that school?

☐ Yes ☐ No

3. Do the students at these schools attend a bilingual education program at another location?

☐ Yes ☐ No

4. Would the school be required to provide a bilingual education program but the school has waived out of this requirement under 19 TAC §89.1205(g)?

☐ Yes ☐ No

5. If the answer is **yes** to **question 1, 2, 3, or 4**, public notices in an alternative language are required. Which language is required by the bilingual program? Click to enter text.

F. Plain Language Summary Template

Complete the Plain Language Summary (TCEQ Form 20972) and include as an attachment.

Attachment: [Click to enter text.](#)

G. Public Involvement Plan Form

Complete the Public Involvement Plan Form (TCEQ Form 20960) for each application for a **new permit or major amendment to a permit** and include as an attachment.

Attachment: [Click to enter text.](#)

Section 9. Regulated Entity and Permitted Site Information (Instructions Page 29)

- A. If the site is currently regulated by TCEQ, provide the Regulated Entity Number (RN) issued to this site. RN 102287562

Search the TCEQ's Central Registry at <http://www15.tceq.texas.gov/crpub/> to determine if the site is currently regulated by TCEQ.

- B. Name of project or site (the name known by the community where located):

City of La Ward Wastewater Treatment Plant

- C. Owner of treatment facility: The City of La Ward

Ownership of Facility: ☒ Public ☐ Private ☐ Both ☐ Federal

- D. Owner of land where treatment facility is or will be:

Prefix: [Click to enter text.](#) Last Name, First Name: The City of La Ward

Title: [Click to enter text.](#) Credential: [Click to enter text.](#)

Organization Name: The City of La Ward

Mailing Address: P.O. Box 178 City, State, Zip Code: La Ward, Texas, 77970

Phone No.: [Click to enter text.](#) E-mail Address: [Click to enter text.](#)

If the landowner is not the same person as the facility owner or co-applicant, attach a lease agreement or deed recorded easement. See instructions.

Attachment: [Click to enter text.](#)

- E. Owner of effluent disposal site:

Prefix: [Click to enter text.](#) Last Name, First Name: [Click to enter text.](#)

Title: [Click to enter text.](#) Credential: [Click to enter text.](#)

Organization Name: [Click to enter text.](#)

Mailing Address: [Click to enter text.](#) City, State, Zip Code: [Click to enter text.](#)

Phone No.: [Click to enter text.](#) E-mail Address: [Click to enter text.](#)

If the landowner is not the same person as the facility owner or co-applicant, attach a lease agreement or deed recorded easement. See instructions.

Attachment: [Click to enter text.](#)

- F. Owner sewage sludge disposal site (if authorization is requested for sludge disposal on property owned or controlled by the applicant):

Prefix: [Click to enter text.](#) Last Name, First Name: [Click to enter text.](#)

Title: [Click to enter text.](#) Credential: [Click to enter text.](#)

Organization Name: [Click to enter text.](#)

Mailing Address: [Click to enter text.](#)

City, State, Zip Code: [Click to enter text.](#)

Phone No.: [Click to enter text.](#)

E-mail Address: [Click to enter text.](#)

If the landowner is not the same person as the facility owner or co-applicant, attach a lease agreement or deed recorded easement. See instructions.

Attachment: [Click to enter text.](#)

Section 10. TPDES Discharge Information (Instructions Page 31)

A. Is the wastewater treatment facility location in the existing permit accurate?

☒ Yes ☐ No

If **no**, or a new permit application, please give an accurate description:

[Click to enter text.](#)

B. Are the point(s) of discharge and the discharge route(s) in the existing permit correct?

☒ Yes ☐ No

If **no**, or a new or amendment permit application, provide an accurate description of the point of discharge and the discharge route to the nearest classified segment as defined in 30 TAC Chapter 307:

[Click to enter text.](#)

City nearest the outfall(s): La Ward

County in which the outfalls(s) is/are located: Jackson

C. Is or will the treated wastewater discharge to a city, county, or state highway right-of-way, or a flood control district drainage ditch?

☒ Yes ☐ No

If **yes**, indicate by a check mark if:

☒ Authorization granted ☐ Authorization pending

For **new and amendment** applications, provide copies of letters that show proof of contact and the approval letter upon receipt.

Attachment: [Click to enter text.](#)

D. For all applications involving an average daily discharge of 5 MGD or more, provide the names of all counties located within 100 statute miles downstream of the point(s) of discharge: [Click to enter text.](#)

Section 11. TLAP Disposal Information (Instructions Page 32)

A. For TLAPs, is the location of the effluent disposal site in the existing permit accurate?

☐ Yes ☐ No

If **no**, or a new or amendment permit application, provide an accurate description of the disposal site location:

Click to enter text.

- B. City nearest the disposal site: Click to enter text.
- C. County in which the disposal site is located: Click to enter text.
- D. For TLAPs, describe the routing of effluent from the treatment facility to the disposal site:

Click to enter text.

- E. For TLAPs, please identify the nearest watercourse to the disposal site to which rainfall runoff might flow if not contained: Click to enter text.

Section 12. Miscellaneous Information (Instructions Page 32)

- A. Is the facility located on or does the treated effluent cross American Indian Land?
- ☐ Yes ☒ No
- B. If the existing permit contains an onsite sludge disposal authorization, is the location of the sewage sludge disposal site in the existing permit accurate?
- ☐ Yes ☐ No ☒ Not Applicable

If No, or if a new onsite sludge disposal authorization is being requested in this permit application, provide an accurate location description of the sewage sludge disposal site.

Click to enter text.

- C. Did any person formerly employed by the TCEQ represent your company and get paid for service regarding this application?

☐ Yes ☒ No

If yes, list each person formerly employed by the TCEQ who represented your company and was paid for service regarding the application: Click to enter text.

- D. Do you owe any fees to the TCEQ?

☐ Yes ☒ No

If yes, provide the following information:

Account number: Click to enter text.

Amount past due: Click to enter text.

- E. Do you owe any penalties to the TCEQ?

☐ Yes ☒ No

If yes, please provide the following information:

Enforcement order number: Click to enter text.

Amount past due: Click to enter text.

Section 13. Attachments (Instructions Page 33)

Indicate which attachments are included with the Administrative Report. Check all that apply:

- ☐ Lease agreement or deed recorded easement, if the land where the treatment facility is located or the effluent disposal site are not owned by the applicant or co-applicant.
- ☐ Original full-size USGS Topographic Map with the following information:
 - Applicant's property boundary
 - Treatment facility boundary
 - Labeled point of discharge for each discharge point (TPDES only)
 - Highlighted discharge route for each discharge point (TPDES only)
 - Onsite sewage sludge disposal site (if applicable)
 - Effluent disposal site boundaries (TLAP only)
 - New and future construction (if applicable)
 - 1 mile radius information
 - 3 miles downstream information (TPDES only)
 - All ponds.
- ☐ Attachment 1 for Individuals as co-applicants
- ☐ Other Attachments. Please specify: [Click to enter text.](#)

Section 14. Signature Page (Instructions Page 34)

If co-applicants are necessary, each entity must submit an original, separate signature page.

Permit Number: WQ0013479001

Applicant: The City of La Ward

Certification:

I certify under penalty of law that this document and all attachments were prepared under my direction or supervision in accordance with a system designed to assure that qualified personnel properly gather and evaluate the information submitted. Based on my inquiry of the person or persons who manage the system, or those persons directly responsible for gathering the information, the information submitted is, to the best of my knowledge and belief, true, accurate, and complete. I am aware there are significant penalties for submitting false information, including the possibility of fine and imprisonment for knowing violations.

I further certify that I am authorized under 30 Texas Administrative Code § 305.44 to sign and submit this document, and can provide documentation in proof of such authorization upon request.

Signatory name (typed or printed):

Signatory title:

Signature: William R Koch Date: 11-15-2024
(Use blue ink)

Subscribed and Sworn to before me by the said William R. Koch
on this 15th day of November, 2024.
My commission expires on the 20th day of June, 2027.

Glynis King
Notary Public

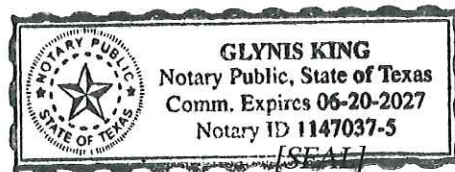

Calhoun
County, Texas

TEXAS COMMISSION ON ENVIRONMENTAL QUALITY

SUPPLEMENTAL PERMIT INFORMATION FORM (SPIF)

FOR AGENCIES REVIEWING DOMESTIC OR INDUSTRIAL TPDES WASTEWATER PERMIT APPLICATIONS

TCEQ USE ONLY:

Application type: ____Renewal ____Major Amendment ____Minor Amendment ____New

County: _____ Segment Number: _____

Admin Complete Date: _____

Agency Receiving SPIF:

____ Texas Historical Commission

____ U.S. Fish and Wildlife

____ Texas Parks and Wildlife Department

____ U.S. Army Corps of Engineers

This form applies to TPDES permit applications only. (Instructions, Page 53)

Complete this form as a separate document. TCEQ will mail a copy to each agency as required by our agreement with EPA. If any of the items are not completely addressed or further information is needed, we will contact you to provide the information before issuing the permit. Address each item completely.

Do not refer to your response to any item in the permit application form. Provide each attachment for this form separately from the Administrative Report of the application. The application will not be declared administratively complete without this SPIF form being completed in its entirety including all attachments. Questions or comments concerning this form may be directed to the Water Quality Division's Application Review and Processing Team by email at WQ-ARPTeam@tceq.texas.gov or by phone at (512) 239-4671.

The following applies to all applications:

1. Permittee: The City of La Ward

Permit No. WQ00 13479001

EPA ID No. TX 0105104

Address of the project (or a location description that includes street/highway, city/vicinity, and county):

From one block north of the intersection of FM 616 and State Hwy 172, turn East on Rio Grande; travel 4 blocks on paved road to Palacios St.; continue East on dirt road 1 block; turn north and the plant is on your left

Provide the name, address, phone and fax number of an individual that can be contacted to answer specific questions about the property.

Prefix (Mr., Ms., Miss): Mr.

First and Last Name: Richard Koch

Credential (P.E, P.G., Ph.D., etc.):

Title: Mayor

Mailing Address: P.O. Box 178

City, State, Zip Code: La Ward, Texas, 77970

Phone No.: 361-781-2929 Ext.: Fax No.: 361-872-2468

E-mail Address: Koch_wr@yahoo.com

2. List the county in which the facility is located: Jackson
3. If the property is publicly owned and the owner is different than the permittee/applicant, please list the owner of the property.

N/A

4. Provide a description of the effluent discharge route. The discharge route must follow the flow of effluent from the point of discharge to the nearest major watercourse (from the point of discharge to a classified segment as defined in 30 TAC Chapter 307). If known, please identify the classified segment number.

Through an 8" pipe to "Sewer Ditch"; thence to "Briscoe Ditch"; thence to an unnamed tributary; thence to "West Caranchua Creek"; thence to "Caranchua Creek"; thence to "Caranchua Bay" in Segment No. 2456 of the Bays and Estuaries.

5. Please provide a separate 7.5-minute USGS quadrangle map with the project boundaries plotted and a general location map showing the project area. Please highlight the discharge route from the point of discharge for a distance of one mile downstream. (This map is required in addition to the map in the administrative report).

Provide original photographs of any structures 50 years or older on the property.

Does your project involve any of the following? Check all that apply.

- ☐ Proposed access roads, utility lines, construction easements
- ☐ Visual effects that could damage or detract from a historic property's integrity
- ☐ Vibration effects during construction or as a result of project design
- ☐ Additional phases of development that are planned for the future
- ☐ Sealing caves, fractures, sinkholes, other karst features

☐ Disturbance of vegetation or wetlands

1. List proposed construction impact (surface acres to be impacted, depth of excavation, sealing of caves, or other karst features):

N/A

2. Describe existing disturbances, vegetation, and land use:

N/A

THE FOLLOWING ITEMS APPLY ONLY TO APPLICATIONS FOR NEW TPDES PERMITS AND MAJOR AMENDMENTS TO TPDES PERMITS

3. List construction dates of all buildings and structures on the property:

4. Provide a brief history of the property, and name of the architect/builder, if known.



TEXAS COMMISSION ON ENVIRONMENTAL QUALITY

PLAIN LANGUAGE SUMMARY FOR TPDES OR TLAP PERMIT APPLICATIONS

Plain Language Summary Template and Instructions for Texas Pollutant Discharge Elimination System (TPDES) and Texas Land Application (TLAP) Permit Applications

Applicants should use this template to develop a plain language summary as required by [Title 30, Texas Administrative Code \(30 TAC\), Chapter 39, Subchapter H](#). Applicants may modify the template as necessary to accurately describe their facility as long as the summary includes the following information: (1) the function of the proposed plant or facility; (2) the expected output of the proposed plant or facility; (3) the expected pollutants that may be emitted or discharged by the proposed plant or facility; and (4) how the applicant will control those pollutants, so that the proposed plant will not have an adverse impact on human health or the environment.

Fill in the highlighted areas below to describe your facility and application in plain language. Instructions and examples are provided below. Make any other edits necessary to improve readability or grammar and to comply with the rule requirements.

If you are subject to the alternative language notice requirements in [30 TAC Section 39.426](#), **you must provide a translated copy of the completed plain language summary in the appropriate alternative language as part of your application package**. For your convenience, a Spanish template has been provided below.

ENGLISH TEMPLATE FOR TPDES or TLAP NEW/RENEWAL/AMENDMENT APPLICATIONS DOMESTIC WASTEWATER/STORMWATER

The following summary is provided for this pending water quality permit application being reviewed by the Texas Commission on Environmental Quality as required by 30 TAC Chapter 39. The information provided in this summary may change during the technical review of the application and is not a federal enforceable representation of the permit application.

The City of La Ward (CN 600641708) operates the City of La Ward Wastewater Treatment Plant (RN 102287562), a wastewater treatment plant. The facility is located at approximately 1,200 feet northeast of the intersection of FM 616 and SH 172, in La Ward, Jackson County, Texas 77970. This application is for the renewal Texas Pollutant Discharge Elimination System (TPDES) Permit No. WQ0013479001 (EPA I.D. No. TX0105104) to authorize the discharge of treated wastewater at a volume not to exceed a daily average flow of 24,000 gallons per day. The discharge route is from one block north of the intersection of FM 616 and State Hwy 172, turn East on Rio Grande; travel 4 blocks on paved road to Palacios St.; continue East on dirt road 1 block; turn north and the plant is on your left.

Discharges from the facility are expected to contain The pollutants expected from the discharge are: CBOD₅, Total Suspended Solids, Ammonia Nitrogen, Nitrate Nitrogen, Total Kjeldahl Nitrogen Sulfate, Chloride, Total Phosphorus, pH, Dissolved Oxygen, Chlorine Residual, Enterococci, Total Dissolved Solids, Oil & Grease, and Alkalinity. The discharge is treated wastewater and is treated by Extended aeration activated sludge plant. Process

includes screening, aeration, chemical feed and clarification. The treated effluent flows by gravity to the discharge route. The sludge is taken off-site for further processing.



U.S. DEPARTMENT OF THE INTERIOR
U.S. GEOLOGICAL SURVEY



LA WARD QUADRANGLE
TEXAS - JACKSON COUNTY
7.5-MINUTE SERIES

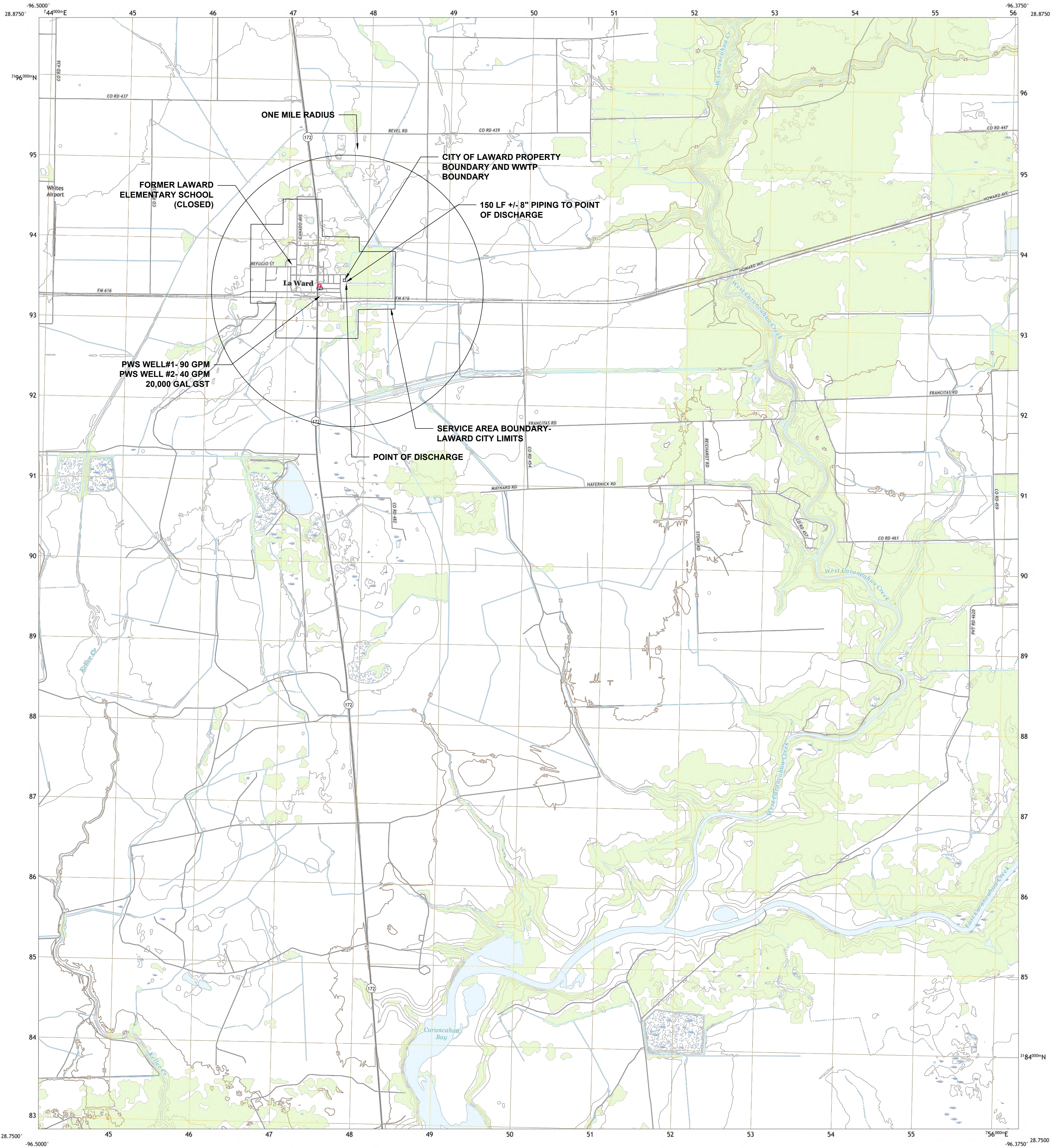

Produced by the United States Geological Survey

North American Datum of 1983 (NAD83)
World Geodetic System of 1984 (WGS84). Projection and
1 000-meter grid-Universal Transverse Mercator, Zone 14R
This map is not a legal document. Boundaries may be
generalized for this map scale. Private lands within government
reservations may not be shown. Obtain permission before
entering private lands.

Imagery.....NAP, September 2016 - December 2016
Roads.....U.S. Census Bureau, 2015 - 2018
Names.....GAS, 1979 - 2021
Hydrography.....National Hydrography Dataset, 2003 - 2018
Contours.....National Elevation Dataset, 2019 - 2020
Boundaries.....Multiple sources; see metadata file, 2019 - 2021
Wetlands.....FWS National Wetlands Inventory Not Available

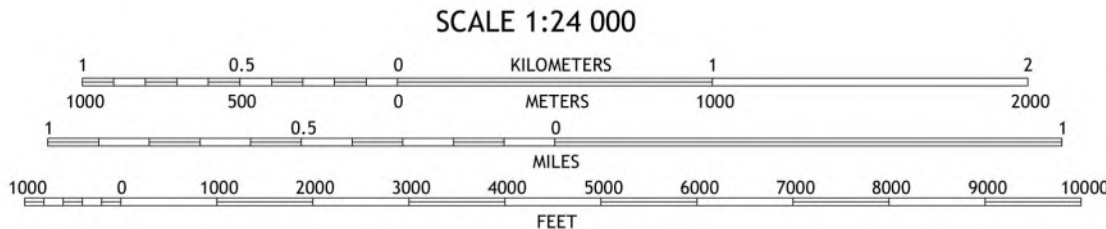
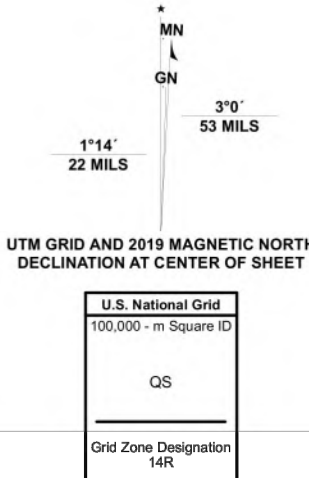

CONTOUR INTERVAL 5 FEET
NORTH AMERICAN VERTICAL DATUM OF 1988
This map was produced to conform with the
National Geospatial Program US Topo Product Standard.



| | | | |
|----|----|----|-----------------|
| 1 | 2 | 3 | 1 Manson |
| 4 | 5 | 6 | 2 Francitas NW |
| 7 | 8 | 9 | 3 Francitas NE |
| 10 | 11 | 12 | 4 Lottia |
| 13 | 14 | 15 | 5 Francitas |
| 16 | 17 | 18 | 6 Point Comfort |
| 19 | 20 | 21 | 7 Olivia |
| 22 | 23 | 24 | 8 Turtle Bay |

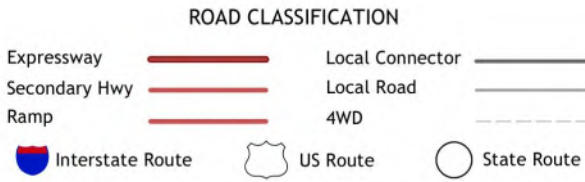

LA WARD, TX
2022

EXHIBIT A





U.S. DEPARTMENT OF THE INTERIOR
U.S. GEOLOGICAL SURVEY



LA WARD QUADRANGLE
TEXAS - JACKSON COUNTY
7.5-MINUTE SERIES

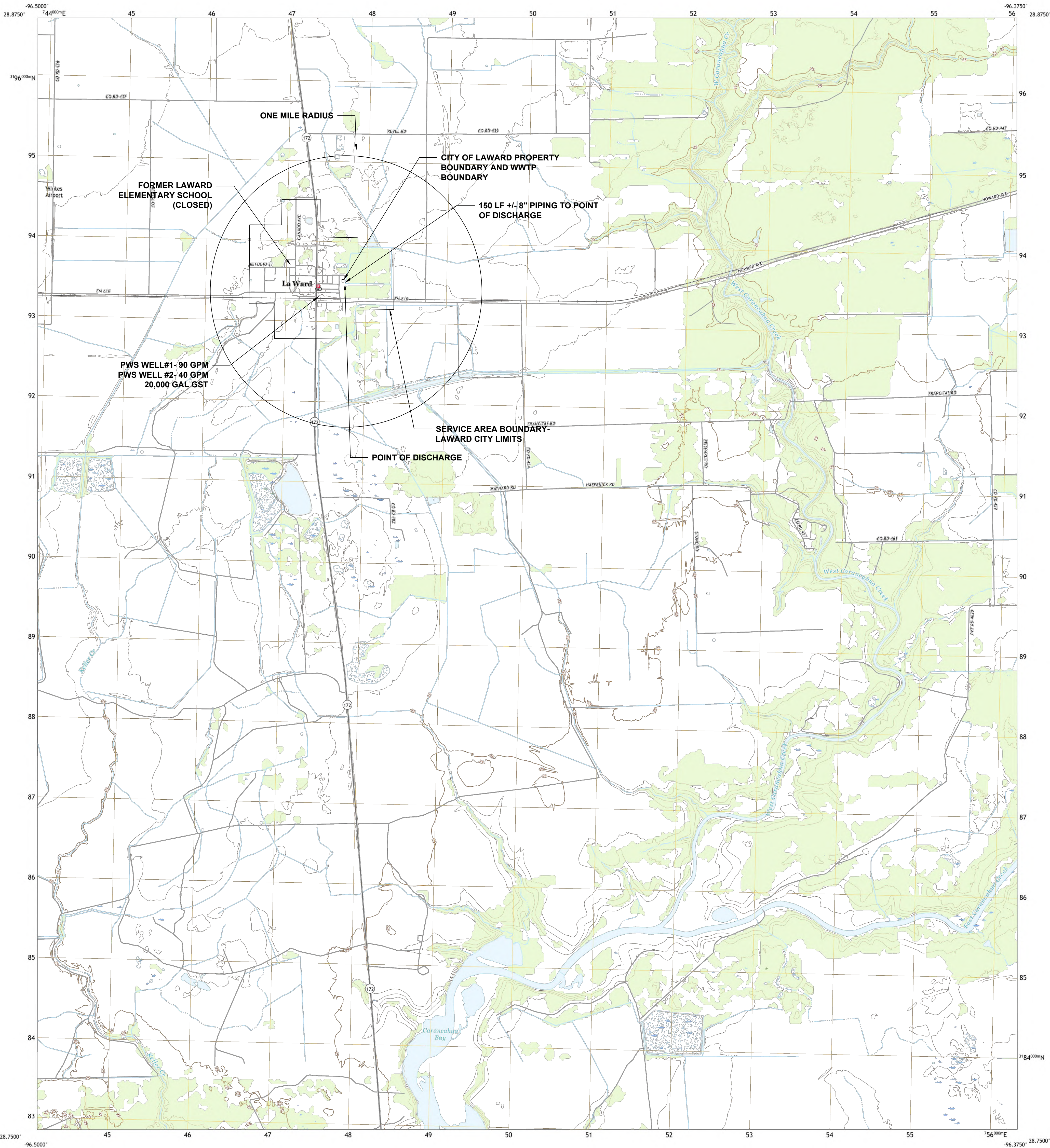

Produced by the United States Geological Survey
North American Datum of 1983 (NAD83)
World Geodetic System of 1984 (WGS84). Projection and
1 000-meter grid: Universal Transverse Mercator, Zone 14R
This map is not a legal document. Boundaries may be
generalized for this map scale. Private lands within government
reservations may not be shown. Obtain permission before
entering private lands.

Imagery.....NAIP, September 2016 - December 2016
Roads.....U.S. Census Bureau, 2015 - 2018
Names.....GNIS, 1979 - 2021
Hydrography.....National Hydrography Dataset, 2003 - 2018
Contours.....National Elevation Dataset, 2019 - 2020
Boundaries.....Multiple sources; see metadata file 2019 - 2021
Wetlands.....FWS National Wetlands Inventory Not Available

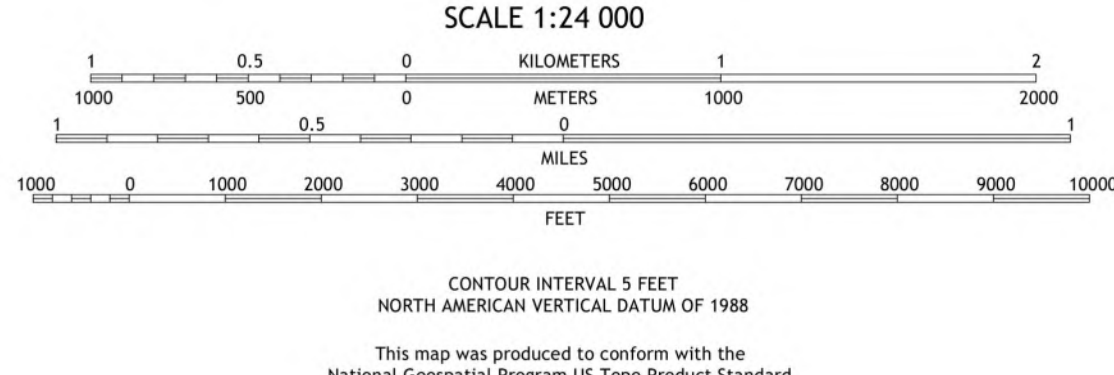
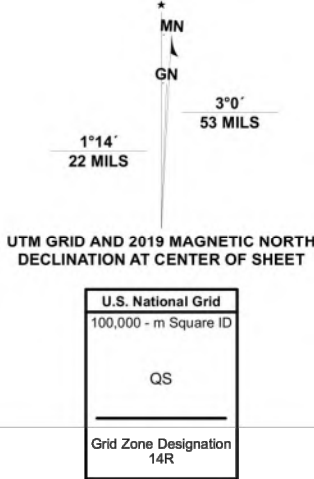

| | | |
|---|---|---|
| 1 | 2 | 3 |
| 4 | 5 | 6 |
| 7 | 8 | 9 |

1. Manson
2. Francitas NE
3. Francitas NW
4. Litta
5. Francitas
6. Point Comfort
7. Olivia
8. Turtle Bay

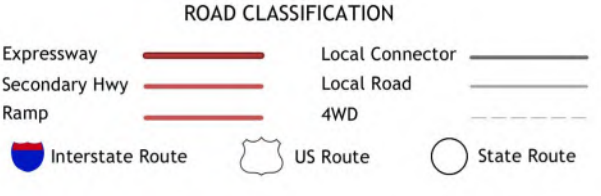

LA WARD, TX
2022

EXHIBIT B



TCEQ DOMESTIC WASTEWATER PERMIT APPLICATION
DOMESTIC TECHNICAL REPORT

for

CITY OF LA WARD
PERMIT NO. WQ0013479001
P.O. BOX 178, La Ward, Texas 77970

Technical Report 1.0

Technical Report Worksheet 2.0

Technical Report Worksheet 6.0

Exhibits

D. Technical Report 1.0 : FLOW DIAGRAM

E. Technical Report 1.0 : SITE DRAWING (2 sheets)

F. Technical Report 1.0 : ANALYSIS OF TREATED EFFLUENT BACKUP

H. Technical Report 1.0 : DRAINAGE AGREEMENT, WWPR LOG No. 03913/091,
TCEQ APPROVAL LETTER



TEXAS COMMISSION ON ENVIRONMENTAL QUALITY

DOMESTIC WASTEWATER PERMIT APPLICATION TECHNICAL REPORT 1.0

For any questions about this form, please contact the Domestic Wastewater Permitting Team at 512-239-4671.

The following information is required for all renewal, new, and amendment applications.

Section 1. Permitted or Proposed Flows (Instructions Page 43)

A. Existing/Interim I Phase

Design Flow (MGD): 0.024

2-Hr Peak Flow (MGD): 0.096

Estimated construction start date: Click to enter text.

Estimated waste disposal start date: Click to enter text.

B. Interim II Phase

Design Flow (MGD): Click to enter text.

2-Hr Peak Flow (MGD): Click to enter text.

Estimated construction start date: Click to enter text.

Estimated waste disposal start date: Click to enter text.

C. Final Phase

Design Flow (MGD): Click to enter text.

2-Hr Peak Flow (MGD): Click to enter text.

Estimated construction start date: Click to enter text.

Estimated waste disposal start date: Click to enter text.

D. Current Operating Phase

Provide the startup date of the facility: 3/29/2001

Section 2. Treatment Process (Instructions Page 43)

A. Current Operating Phase

Provide a detailed description of the treatment process. **Include the type of treatment plant, mode of operation, and all treatment units.** Start with the plant's head works and

finish with the point of discharge. Include all sludge processing and drying units. **If more than one phase exists or is proposed, a description of *each phase* must be provided.**

The treatment process is activated sludge-extended aeration. The raw wastewater comes to a splitter box, which equally splits the flow to two identical treatment processes. The wastewater enters initially an aeration chamber, then passes to the clarifier, from which the flow from each side is brought together and enters the chlorine contact chamber for disinfection; from the bottom of each clarifier, sludge is either returned to the aeration chamber or to the aerated sludge holding tank.

B. Treatment Units

In Table 1.0(1), provide the treatment unit type, the number of units, and dimensions (length, width, depth) of each treatment unit, accounting for ***all*** phases of operation.

Table 1.0(1) - Treatment Units

| Treatment Unit Type | Number of Units | Dimensions (L x W x D) |
|--------------------------|-----------------|------------------------|
| Aeration | 4 | 13'x6'x8.58' |
| Aeration | 2 | 5.42'x6'x8.58' |
| Clarifier | 2 | 13'x6'x8.58' |
| Aerated Sludge Holding | 2 | 7.33'x6'x8.58' |
| Chlorine Contact Chamber | 1 | 13'x6'x2.75 |
| | | |

C. Process Flow Diagram

Provide flow diagrams for the existing facilities and **each** proposed phase of construction.

Attachment: [Click to enter text.](#)

Section 3. Site Information and Drawing (Instructions Page 44)

Provide the TPDES discharge outfall latitude and longitude. Enter N/A if not applicable.

- Latitude: 28° 50' 43.8"
- Longitude: -96° 27' 39.7"

Provide the TLAP disposal site latitude and longitude. Enter N/A if not applicable.

- Latitude: [Click to enter text.](#)
- Longitude: [Click to enter text.](#)

Provide a site drawing for the facility that shows the following:

- The boundaries of the treatment facility;
- The boundaries of the area served by the treatment facility;
- If land disposal of effluent, the boundaries of the disposal site and all storage/holding ponds; and
- If sludge disposal is authorized in the permit, the boundaries of the land application or disposal site.

Attachment: [Click to enter text.](#)

Provide the name **and** a description of the area served by the treatment facility.

The City of La Ward

Collection System Information **for wastewater TPDES permits only**: Provide information for each **uniquely owned** collection system, existing and new, served by this facility, including satellite collection systems. **Please see the instructions for a detailed explanation and examples.**

Collection System Information

| Collection System Name | Owner Name | Owner Type | Population Served |
|------------------------|------------|-----------------|-------------------|
| | | Choose an item. | |
| | | Choose an item. | |
| | | Choose an item. | |
| | | Choose an item. | |

Section 4. Unbuilt Phases (Instructions Page 45)

Is the application for a renewal of a permit that contains an unbuilt phase or phases?

☐ Yes ☒ No

If **yes**, does the existing permit contain a phase that has not been constructed **within five years** of being authorized by the TCEQ?

☐ Yes ☐ No

If **yes**, provide a detailed discussion regarding the continued need for the unbuilt phase. **Failure to provide sufficient justification may result in the Executive Director recommending denial of the unbuilt phase or phases.**

Click to enter text.

Section 5. Closure Plans (Instructions Page 45)

Have any treatment units been taken out of service permanently, or will any units be taken out of service in the next five years?

☐ Yes ☒ No

If **yes**, was a closure plan submitted to the TCEQ?

☐ Yes ☐ No

If yes, provide a brief description of the closure and the date of plan approval.

Click to enter text.

Section 6. Permit Specific Requirements (Instructions Page 45)

For applicants with an existing permit, check the Other Requirements or Special Provisions of the permit.

A. Summary transmittal

Have plans and specifications been approved for the existing facilities and each proposed phase?

☒ Yes ☐ No

If yes, provide the date(s) of approval for each phase: 6/27/2000, 9/27/2013

Provide information, including dates, on any actions taken to meet a *requirement or provision* pertaining to the submission of a summary transmittal letter. **Provide a copy of an approval letter from the TCEQ, if applicable.**

Attached is - Summary Transmittal Letter dated 9.19.13 (WWPR Log NO. 0913/091; - TCEQ Approval Letter dated 1.15.14 (correction of letter dated 9.27.13)

B. Buffer zones

Have the buffer zone requirements been met?

☒ Yes ☐ No

Provide information below, including dates, on any actions taken to meet the conditions of the buffer zone. If available, provide any new documentation relevant to maintaining the buffer zones.

Click to enter text.

C. Other actions required by the current permit

Does the *Other Requirements* or *Special Provisions* section in the existing permit require submission of any other information or other required actions? Examples include Notification of Completion, progress reports, soil monitoring data, etc.

☒ Yes ☐ No

If **yes**, provide information below on the status of any actions taken to meet the conditions of an *Other Requirement* or *Special Provision*.

Completion Notice dated 6.23.14

D. Grit and grease treatment

1. *Acceptance of grit and grease waste*

Does the facility have a grit and/or grease processing facility onsite that treats and decants or accepts transported loads of grit and grease waste that are discharged directly to the wastewater treatment plant prior to any treatment?

☐ Yes ☒ No

If **No**, stop here and continue with Subsection E. Stormwater Management.

2. *Grit and grease processing*

Describe below how the grit and grease waste is treated at the facility. In your description, include how and where the grit and grease is introduced to the treatment works and how it is separated or processed. Provide a flow diagram showing how grit and grease is processed at the facility.

Click to enter text.

3. *Grit disposal*

Does the facility have a Municipal Solid Waste (MSW) registration or permit for grit disposal?

☐ Yes ☐ No

If **No**, contact the TCEQ Municipal Solid Waste team at 512-239-2335. Note: A registration or permit is required for grit disposal. Grit shall not be combined with treatment plant sludge. See the instruction booklet for additional information on grit disposal requirements and restrictions.

Describe the method of grit disposal.

Click to enter text.

4. Grease and decanted liquid disposal

Note: A registration or permit is required for grease disposal. Grease shall not be combined with treatment plant sludge. For more information, contact the TCEQ Municipal Solid Waste team at 512-239-2335.

Describe how the decant and grease are treated and disposed of after grit separation.

Click to enter text.

E. Stormwater management

1. Applicability

Does the facility have a design flow of 1.0 MGD or greater in any phase?

☐ Yes ☒ No

Does the facility have an approved pretreatment program, under 40 CFR Part 403?

☐ Yes ☒ No

If no to both of the above, then skip to Subsection F, Other Wastes Received.

2. MSGP coverage

Is the stormwater runoff from the WWTP and dedicated lands for sewage disposal currently permitted under the TPDES Multi-Sector General Permit (MSGP), TXR050000?

☐ Yes ☐ No

If yes, please provide MSGP Authorization Number and skip to Subsection F, Other Wastes Received:

TXR05 Click to enter text. or TXRNE Click to enter text.

If no, do you intend to seek coverage under TXR050000?

☐ Yes ☐ No

3. Conditional exclusion

Alternatively, do you intend to apply for a conditional exclusion from permitting based TXR050000 (Multi Sector General Permit) Part II B.2 or TXR050000 (Multi Sector General Permit) Part V, Sector T 3(b)?

☐ Yes ☐ No

If yes, please explain below then proceed to Subsection F, Other Wastes Received:

Click to enter text.

4. **Existing coverage in individual permit**

Is your stormwater discharge currently permitted through this individual TPDES or TLAP permit?

☐ Yes ☐ No

If yes, provide a description of stormwater runoff management practices at the site that are authorized in the wastewater permit then skip to Subsection F, Other Wastes Received.

Click to enter text.

5. **Zero stormwater discharge**

Do you intend to have no discharge of stormwater via use of evaporation or other means?

☐ Yes ☐ No

If yes, explain below then skip to Subsection F. Other Wastes Received.

Click to enter text.

Note: If there is a potential to discharge any stormwater to surface water in the state as the result of any storm event, then permit coverage is required under the MSGP or an individual discharge permit. This requirement applies to all areas of facilities with treatment plants or systems that treat, store, recycle, or reclaim domestic sewage, wastewater or sewage sludge (including dedicated lands for sewage sludge disposal located within the onsite property boundaries) that meet the applicability criteria of above. You have the option of obtaining coverage under the MSGP for direct discharges, (recommended), or obtaining coverage under this individual permit.

6. **Request for coverage in individual permit**

Are you requesting coverage of stormwater discharges associated with your treatment plant under this individual permit?

☐ Yes ☐ No

If yes, provide a description of stormwater runoff management practices at the site for which you are requesting authorization in this individual wastewater permit and describe whether you intend to comingle this discharge with your treated effluent or discharge it via a separate dedicated stormwater outfall. Please also indicate if you intend to divert stormwater to the treatment plant headworks and indirectly discharge it to water in the state.

Click to enter text.

Note: Direct stormwater discharges to waters in the state authorized through this individual permit will require the development and implementation of a stormwater pollution prevention plan (SWPPP) and will be subject to additional monitoring and reporting requirements. Indirect discharges of stormwater via headworks recycling will require compliance with all individual permit requirements including 2-hour peak flow limitations. All stormwater discharge authorization requests will require additional information during the technical review of your application.

F. Discharges to the Lake Houston Watershed

Does the facility discharge in the Lake Houston watershed?

☐ Yes ☒ No

If yes, attach a Sewage Sludge Solids Management Plan. See Example 5 in the instructions.

Click to enter text.

G. Other wastes received including sludge from other WWTPs and septic waste

1. Acceptance of sludge from other WWTPs

Does or will the facility accept sludge from other treatment plants at the facility site?

☐ Yes ☒ No

If yes, attach sewage sludge solids management plan. See Example 5 of the instructions.

In addition, provide the date the plant started or is anticipated to start accepting sludge, an estimate of monthly sludge acceptance (gallons or millions of gallons), an estimate of the BOD₅ concentration of the sludge, and the design BOD₅ concentration of the influent from the collection system. Also note if this information has or has not changed since the last permit action.

Click to enter text.

Note: Permits that accept sludge from other wastewater treatment plants may be required to have influent flow and organic loading monitoring.

2. Acceptance of septic waste

Is the facility accepting or will it accept septic waste?

☐ Yes ☒ No

If yes, does the facility have a Type V processing unit?

☐ Yes ☐ No

If yes, does the unit have a Municipal Solid Waste permit?

☐ Yes ☐ No

If **yes to any of the above**, provide the date the plant started or is anticipated to start accepting septic waste, an estimate of monthly septic waste acceptance (gallons or millions of gallons), an estimate of the BOD₅ concentration of the septic waste, and the design BOD₅ concentration of the influent from the collection system. Also note if this information has or has not changed since the last permit action.

Click to enter text.

Note: Permits that accept sludge from other wastewater treatment plants may be required to have influent flow and organic loading monitoring.

3. Acceptance of other wastes (not including septic, grease, grit, or RCRA, CERCLA or as discharged by IUs listed in Worksheet 6)

Is or will the facility accept wastes that are not domestic in nature excluding the categories listed above?

☐ Yes ☒ No

If **yes**, provide the date that the plant started accepting the waste, an estimate how much waste is accepted on a monthly basis (gallons or millions of gallons), a description of the entities generating the waste, and any distinguishing chemical or other physical characteristic of the waste. Also note if this information has or has not changed since the last permit action.

Click to enter text.

Section 7. Pollutant Analysis of Treated Effluent (Instructions Page 50)

Is the facility in operation?

☒ Yes ☐ No

If **no**, this section is not applicable. Proceed to Section 8.

If **yes**, provide effluent analysis data for the listed pollutants. **Wastewater treatment facilities** complete Table 1.0(2). **Water treatment facilities** discharging filter backwash water, complete Table 1.0(3). Provide copies of the laboratory results sheets. **These tables are not applicable for a minor amendment without renewal.** See the instructions for guidance.

Note: The sample date must be within 1 year of application submission.

Table 1.0(2) – Pollutant Analysis for Wastewater Treatment Facilities

| Pollutant | Average Conc. | Max Conc. | No. of Samples | Sample Type | Sample Date/Time |
|-------------------------------|---------------|-----------|----------------|-------------|------------------|
| CBOD ₅ , mg/l | | | 1 | GRAB | 11/12/24 |
| Total Suspended Solids, mg/l | | | 1 | GRAB | 11/12/24 |
| Ammonia Nitrogen, mg/l | | | 1 | GRAB | 11/12/24 |
| Nitrate Nitrogen, mg/l | | | 1 | GRAB | 11/12/24 |
| Total Kjeldahl Nitrogen, mg/l | | | 1 | GRAB | 11/12/24 |

| | | | | | |
|---|--|--|---|------|----------|
| Sulfate, mg/l | | | 1 | GRAB | 11/12/24 |
| Chloride, mg/l | | | 1 | GRAB | 11/12/24 |
| Total Phosphorus, mg/l | | | 1 | GRAB | 11/12/24 |
| pH, standard units | | | 1 | GRAB | 11/12/24 |
| Dissolved Oxygen*, mg/l | | | 1 | GRAB | 11/12/24 |
| Chlorine Residual, mg/l | | | 1 | GRAB | 11/12/24 |
| <i>E.coli</i> (CFU/100ml) freshwater | | | 1 | GRAB | 11/12/24 |
| Enterococci (CFU/100ml) saltwater | | | | | |
| Total Dissolved Solids, mg/l | | | 1 | GRAB | 11/12/24 |
| Electrical Conductivity, μ mohs/cm, † | | | | | |
| Oil & Grease, mg/l | | | 1 | GRAB | 11/12/24 |
| Alkalinity (CaCO ₃)*, mg/l | | | 1 | GRAB | 11/12/24 |

*TPDES permits only

†TLAP permits only

Table 1.0(3) – Pollutant Analysis for Water Treatment Facilities

| Pollutant | Average Conc. | Max Conc. | No. of Samples | Sample Type | Sample Date/Time |
|---------------------------------------|---------------|-----------|----------------|-------------|------------------|
| Total Suspended Solids, mg/l | | | | | |
| Total Dissolved Solids, mg/l | | | | | |
| pH, standard units | | | | | |
| Fluoride, mg/l | | | | | |
| Aluminum, mg/l | | | | | |
| Alkalinity (CaCO ₃), mg/l | | | | | |

Section 8. Facility Operator (Instructions Page 50)

Facility Operator Name: Joe Zamora Jr.

Facility Operator's License Classification and Level: Wastewater Treatment Operator

Facility Operator's License Number: WW0037170

Section 9. Sludge and Biosolids Management and Disposal (Instructions Page 51)

A. WWTP's Biosolids Management Facility Type

Check all that apply. See instructions for guidance

- ☐ Design flow \geq 1 MGD
- ☐ Serves \geq 10,000 people
- ☐ Class I Sludge Management Facility (per 40 CFR § 503.9)

- ☐ Biosolids generator
- ☐ Biosolids end user – land application (onsite)
- ☐ Biosolids end user – surface disposal (onsite)
- ☐ Biosolids end user – incinerator (onsite)

B. WWTP's Biosolids Treatment Process

Check all that apply. See instructions for guidance.

- ☐ Aerobic Digestion
- ☒ Air Drying (or sludge drying beds)
- ☐ Lower Temperature Composting
- ☐ Lime Stabilization
- ☐ Higher Temperature Composting
- ☐ Heat Drying
- ☐ Thermophilic Aerobic Digestion
- ☐ Beta Ray Irradiation
- ☐ Gamma Ray Irradiation
- ☐ Pasteurization
- ☐ Preliminary Operation (e.g. grinding, de-gritting, blending)
- ☐ Thickening (e.g. gravity thickening, centrifugation, filter press, vacuum filter)
- ☐ Sludge Lagoon
- ☐ Temporary Storage (< 2 years)
- ☐ Long Term Storage (>= 2 years)
- ☐ Methane or Biogas Recovery
- ☐ Other Treatment Process: [Click to enter text.](#)

C. Biosolids Management

Provide information on the *intended* biosolids management practice. Do not enter every management practice that you want authorized in the permit, as the permit will authorize all biosolids management practices listed in the instructions. Rather indicate the management practice the facility plans to use.

Biosolids Management

| Management Practice | Handler or Preparer Type | Bulk or Bag Container | Amount (dry metric tons) | Pathogen Reduction Options | Vector Attraction Reduction Option |
|---------------------------------|---------------------------------|---------------------------------|--------------------------|---------------------------------|------------------------------------|
| Choose an item. | Choose an item. | Choose an item. | | Choose an item. | Choose an item. |

| Management Practice | Handler or Preparer Type | Bulk or Bag Container | Amount (dry metric tons) | Pathogen Reduction Options | Vector Attraction Reduction Option |
|---------------------|--------------------------|-----------------------|--------------------------|----------------------------|------------------------------------|
| Choose an item. | Choose an item. | Choose an item. | | Choose an item. | Choose an item. |
| Choose an item. | Choose an item. | Choose an item. | | Choose an item. | Choose an item. |

If "Other" is selected for Management Practice, please explain (e.g. monofill or transport to another WWTP): [Click to enter text.](#)

D. Disposal site

Disposal site name: City of Rosenberg Plant No 2

TCEQ permit or registration number: WQ0010607002

County where disposal site is located: Fort Bend

E. Transportation method

Method of transportation (truck, train, pipe, other): Truck

Name of the hauler: MagnaFlow Environmental

Hauler registration number: 21484

Sludge is transported as a:

Liquid ☒ semi-liquid ☐ semi-solid ☐ solid ☐

Section 10. Permit Authorization for Sewage Sludge Disposal (Instructions Page 53)

A. Beneficial use authorization

Does the existing permit include authorization for land application of sewage sludge for beneficial use?

☐ Yes ☒ No

If **yes**, are you requesting to continue this authorization to land apply sewage sludge for beneficial use?

☐ Yes ☐ No

If **yes**, is the completed **Application for Permit for Beneficial Land Use of Sewage Sludge (TCEQ Form No. 10451)** attached to this permit application (see the instructions for details)?

☐ Yes ☐ No

B. Sludge processing authorization

Does the existing permit include authorization for any of the following sludge processing, storage or disposal options?

Sludge Composting ☐ Yes ☒ No

Marketing and Distribution of sludge ☐ Yes ☒ No

Sludge Surface Disposal or Sludge Monofill ☐ Yes ☒ No

Temporary storage in sludge lagoons ☐ Yes ☒ No

If **yes** to any of the above sludge options and the applicant is requesting to continue this authorization, is the completed **Domestic Wastewater Permit Application: Sewage Sludge Technical Report (TCEQ Form No. 10056)** attached to this permit application?

☐ Yes ☐ No

Section 11. Sewage Sludge Lagoons (Instructions Page 53)

Does this facility include sewage sludge lagoons?

☐ Yes ☒ No

If yes, complete the remainder of this section. If no, proceed to Section 12.

A. Location information

The following maps are required to be submitted as part of the application. For each map, provide the Attachment Number.

- Original General Highway (County) Map:
Attachment: [Click to enter text.](#)
- USDA Natural Resources Conservation Service Soil Map:
Attachment: [Click to enter text.](#)
- Federal Emergency Management Map:
Attachment: [Click to enter text.](#)
- Site map:
Attachment: [Click to enter text.](#)

Discuss in a description if any of the following exist within the lagoon area. Check all that apply.

- ☐ Overlap a designated 100-year frequency flood plain
- ☐ Soils with flooding classification
- ☐ Overlap an unstable area
- ☐ Wetlands
- ☐ Located less than 60 meters from a fault
- ☐ None of the above

Attachment: [Click to enter text.](#)

If a portion of the lagoon(s) is located within the 100-year frequency flood plain, provide the protective measures to be utilized including type and size of protective structures:

[Click to enter text.](#)

B. Temporary storage information

Provide the results for the pollutant screening of sludge lagoons. These results are in addition to pollutant results in *Section 7 of Technical Report 1.0*.

Nitrate Nitrogen, mg/kg: [Click to enter text.](#)

Total Kjeldahl Nitrogen, mg/kg: [Click to enter text.](#)

Total Nitrogen (=nitrate nitrogen + TKN), mg/kg: [Click to enter text.](#)

Phosphorus, mg/kg: [Click to enter text.](#)

Potassium, mg/kg: [Click to enter text.](#)

pH, standard units: [Click to enter text.](#)

Ammonia Nitrogen mg/kg: [Click to enter text.](#)

Arsenic: [Click to enter text.](#)

Cadmium: [Click to enter text.](#)

Chromium: [Click to enter text.](#)

Copper: [Click to enter text.](#)

Lead: [Click to enter text.](#)

Mercury: [Click to enter text.](#)

Molybdenum: [Click to enter text.](#)

Nickel: [Click to enter text.](#)

Selenium: [Click to enter text.](#)

Zinc: [Click to enter text.](#)

Total PCBs: [Click to enter text.](#)

Provide the following information:

Volume and frequency of sludge to the lagoon(s): [Click to enter text.](#)

Total dry tons stored in the lagoons(s) per 365-day period: [Click to enter text.](#)

Total dry tons stored in the lagoons(s) over the life of the unit: [Click to enter text.](#)

C. Liner information

Does the active/proposed sludge lagoon(s) have a liner with a maximum hydraulic conductivity of 1×10^{-7} cm/sec?

☐ Yes ☐ No

If yes, describe the liner below. Please note that a liner is required.

[Click to enter text.](#)

D. Site development plan

Provide a detailed description of the methods used to deposit sludge in the lagoon(s):

Click to enter text.

Attach the following documents to the application.

- Plan view and cross-section of the sludge lagoon(s)
Attachment: [Click to enter text.](#)
- Copy of the closure plan
Attachment: [Click to enter text.](#)
- Copy of deed recordation for the site
Attachment: [Click to enter text.](#)
- Size of the sludge lagoon(s) in surface acres and capacity in cubic feet and gallons
Attachment: [Click to enter text.](#)
- Description of the method of controlling infiltration of groundwater and surface water from entering the site
Attachment: [Click to enter text.](#)
- Procedures to prevent the occurrence of nuisance conditions
Attachment: [Click to enter text.](#)

E. Groundwater monitoring

Is groundwater monitoring currently conducted at this site, or are any wells available for groundwater monitoring, or are groundwater monitoring data otherwise available for the sludge lagoon(s)?

☐ Yes ☐ No

If groundwater monitoring data are available, provide a copy. Provide a profile of soil types encountered down to the groundwater table and the depth to the shallowest groundwater as a separate attachment.

Attachment: [Click to enter text.](#)

Section 12. Authorizations/Compliance/Enforcement (Instructions Page 55)

A. Additional authorizations

Does the permittee have additional authorizations for this facility, such as reuse authorization, sludge permit, etc?

☐ Yes ☒ No

If yes, provide the TCEQ authorization number and description of the authorization:

Click to enter text.

B. Permittee enforcement status

Is the permittee currently under enforcement for this facility?

☐ Yes ☒ No

Is the permittee required to meet an implementation schedule for compliance or enforcement?

☐ Yes ☒ No

If **yes** to either question, provide a brief summary of the enforcement, the implementation schedule, and the current status:

Click to enter text.

Section 13. RCRA/CERCLA Wastes (Instructions Page 55)

A. RCRA hazardous wastes

Has the facility received in the past three years, does it currently receive, or will it receive RCRA hazardous waste?

☐ Yes ☒ No

B. Remediation activity wastewater

Has the facility received in the past three years, does it currently receive, or will it receive CERCLA wastewater, RCRA remediation/corrective action wastewater or other remediation activity wastewater?

☐ Yes ☒ No

C. Details about wastes received

If **yes** to either Subsection A or B above, provide detailed information concerning these wastes with the application.

Attachment: [Click to enter text.](#)

Section 14. Laboratory Accreditation (Instructions Page 56)

All laboratory tests performed must meet the requirements of *30 TAC Chapter 25, Environmental Testing Laboratory Accreditation and Certification*, which includes the following general exemptions from National Environmental Laboratory Accreditation Program (NELAP) certification requirements:

- The laboratory is an in-house laboratory and is:
 - periodically inspected by the TCEQ; or
 - located in another state and is accredited or inspected by that state; or
 - performing work for another company with a unit located in the same site; or
 - performing pro bono work for a governmental agency or charitable organization.
- The laboratory is accredited under federal law.
- The data are needed for emergency-response activities, and a laboratory accredited under the Texas Laboratory Accreditation Program is not available.
- The laboratory supplies data for which the TCEQ does not offer accreditation.

The applicant should review 30 TAC Chapter 25 for specific requirements.

The following certification statement shall be signed and submitted with every application. See the Signature Page section in the Instructions, for a list of designated representatives who may sign the certification.

CERTIFICATION:

I certify that all laboratory tests submitted with this application meet the requirements of *30 TAC Chapter 25, Environmental Testing Laboratory Accreditation and Certification*.

Printed Name:

Title:

Signature: 
Date: 11-15-24

DOMESTIC WASTEWATER PERMIT APPLICATION

WORKSHEET 2.0: RECEIVING WATERS

The following information is required for all TPDES permit applications.

Section 1. Domestic Drinking Water Supply (Instructions Page 64)

Is there a surface water intake for domestic drinking water supply located within 5 miles downstream from the point or proposed point of discharge?

☐ Yes ☒ No

If **no**, proceed to Section 2. If **yes**, provide the following:

Owner of the drinking water supply: [Click to enter text.](#)

Distance and direction to the intake: [Click to enter text.](#)

Attach a USGS map that identifies the location of the intake.

Attachment: [Click to enter text.](#)

Section 2. Discharge into Tidally Affected Waters (Instructions Page 64)

Does the facility discharge into tidally affected waters?

☐ Yes ☒ No

If **no**, proceed to Section 3. If **yes**, complete the remainder of this section. If no, proceed to Section 3.

A. Receiving water outfall

Width of the receiving water at the outfall, in feet: [Click to enter text.](#)

B. Oyster waters

Are there oyster waters in the vicinity of the discharge?

☐ Yes ☐ No

If **yes**, provide the distance and direction from outfall(s).

[Click to enter text.](#)

C. Sea grasses

Are there any sea grasses within the vicinity of the point of discharge?

☐ Yes ☐ No

If **yes**, provide the distance and direction from the outfall(s).

[Click to enter text.](#)

Section 3. Classified Segments (Instructions Page 64)

Is the discharge directly into (or within 300 feet of) a classified segment?

☐ Yes ☒ No

If **yes**, this Worksheet is complete.

If **no**, complete Sections 4 and 5 of this Worksheet.

Section 4. Description of Immediate Receiving Waters (Instructions Page 65)

Name of the immediate receiving waters: Unnamed Ditch

A. Receiving water type

Identify the appropriate description of the receiving waters.

- ☐ Stream
- ☐ Freshwater Swamp or Marsh
- ☐ Lake or Pond

Surface area, in acres: Click to enter text.

Average depth of the entire water body, in feet: Click to enter text.

Average depth of water body within a 500-foot radius of discharge point, in feet:
Click to enter text.

- ☒ Man-made Channel or Ditch
- ☐ Open Bay
- ☐ Tidal Stream, Bayou, or Marsh
- ☐ Other, specify: Click to enter text.

B. Flow characteristics

If a stream, man-made channel or ditch was checked above, provide the following. For existing discharges, check one of the following that best characterizes the area *upstream* of the discharge. For new discharges, characterize the area *downstream* of the discharge (check one).

- ☒ Intermittent - dry for at least one week during most years
- ☐ Intermittent with Perennial Pools - enduring pools with sufficient habitat to maintain significant aquatic life uses
- ☐ Perennial - normally flowing

Check the method used to characterize the area upstream (or downstream for new dischargers).

- ☐ USGS flow records
- ☐ Historical observation by adjacent landowners
- ☒ Personal observation
- ☐ Other, specify: Click to enter text.

C. Downstream perennial confluences

List the names of all perennial streams that join the receiving water within three miles downstream of the discharge point.

West Caranchua Creek, Caranchua Creek

D. Downstream characteristics

Do the receiving water characteristics change within three miles downstream of the discharge (e.g., natural or man-made dams, ponds, reservoirs, etc.)?

☐ Yes ☒ No

If yes, discuss how.

Click to enter text.

E. Normal dry weather characteristics

Provide general observations of the water body during normal dry weather conditions.

Downstream of the discharge point the ditch had clear water with a slow flow

Date and time of observation: 11/15/24 11:40 am

Was the water body influenced by stormwater runoff during observations?

☐ Yes ☒ No

Section 5. General Characteristics of the Waterbody (Instructions Page 66)

A. Upstream influences

Is the immediate receiving water upstream of the discharge or proposed discharge site influenced by any of the following? Check all that apply.

☐ Oil field activities

☐ Urban runoff

☐ Upstream discharges

☐ Agricultural runoff

☐ Septic tanks

☐ Other(s), specify: Click to enter text.

B. Waterbody uses

Observed or evidences of the following uses. Check all that apply.

- | | |
|--|--|
| <input type="checkbox"/> Livestock watering | <input type="checkbox"/> Contact recreation |
| <input type="checkbox"/> Irrigation withdrawal | <input type="checkbox"/> Non-contact recreation |
| <input type="checkbox"/> Fishing | <input type="checkbox"/> Navigation |
| <input type="checkbox"/> Domestic water supply | <input type="checkbox"/> Industrial water supply |
| <input type="checkbox"/> Park activities | <input type="checkbox"/> Other(s), specify: Click to enter text. |

C. Waterbody aesthetics

Check one of the following that best describes the aesthetics of the receiving water and the surrounding area.

- ☐ Wilderness: outstanding natural beauty; usually wooded or unpastured area; water clarity exceptional
- ☒ Natural Area: trees and/or native vegetation; some development evident (from fields, pastures, dwellings); water clarity discolored
- ☐ Common Setting: not offensive; developed but uncluttered; water may be colored or turbid
- ☐ Offensive: stream does not enhance aesthetics; cluttered; highly developed; dumping areas; water discolored

DOMESTIC WASTEWATER PERMIT APPLICATION

WORKSHEET 6.0: INDUSTRIAL WASTE CONTRIBUTION

The following is required for all publicly owned treatment works.

Section 1. All POTWs (Instructions Page 89)

A. Industrial users (IUs)

Provide the number of each of the following types of industrial users (IUs) that discharge to your POTW and the daily flows from each user. See the Instructions for definitions of Categorical IUs, Significant IUs – non-categorical, and Other IUs.

If there are no users, enter 0 (zero).

Categorical IUs:

Number of IUs: 0

Average Daily Flows, in MGD: 0

Significant IUs – non-categorical:

Number of IUs: 0

Average Daily Flows, in MGD: 0

Other IUs:

Number of IUs: 0

Average Daily Flows, in MGD: 0

B. Treatment plant interference

In the past three years, has your POTW experienced treatment plant interference (see instructions)?

☐ Yes ☒ No

If yes, identify the dates, duration, description of interference, and probable cause(s) and possible source(s) of each interference event. Include the names of the IUs that may have caused the interference.

Click to enter text.

C. Treatment plant pass through

In the past three years, has your POTW experienced pass through (see instructions)?

☐ Yes ☒ No

If **yes**, identify the dates, duration, a description of the pollutants passing through the treatment plant, and probable cause(s) and possible source(s) of each pass through event. Include the names of the IUs that may have caused pass through.

[Click to enter text.](#)

D. Pretreatment program

Does your POTW have an approved pretreatment program?

☐ Yes ☒ No

If **yes**, complete Section 2 only of this Worksheet.

Is your POTW required to develop an approved pretreatment program?

☐ Yes ☐ No

If **yes**, complete Section 2.c. and 2.d. only, and skip Section 3.

If **no to either question above**, skip Section 2 and complete Section 3 for each significant industrial user and categorical industrial user.

E. Service Area Map

Attach a map indicating the service area of the POTW. The map should include the applicant's service area boundaries and the location of any known industrial users discharging to the POTW. Please see the instructions for guidance.

Attachment: [Click to enter text.](#)

Section 2. POTWs with Approved Programs or Those Required to Develop a Program (Instructions Page 90)

A. Substantial modifications

Have there been any **substantial modifications** to the approved pretreatment program that have not been submitted to the TCEQ for approval according to *40 CFR §403.18*?

☐ Yes ☐ No

If **yes**, identify the modifications that have not been submitted to TCEQ, including the purpose of the modification.

Click to enter text.

B. Non-substantial modifications

Have there been any **non-substantial modifications** to the approved pretreatment program that have not been submitted to TCEQ for review and acceptance?

☐ Yes ☐ No

If yes, identify all non-substantial modifications that have not been submitted to TCEQ, including the purpose of the modification.

Click to enter text.

C. Effluent parameters above the MAL

In Table 6.0(1), list all parameters measured above the MAL in the POTW's effluent monitoring during the last three years. Submit an attachment if necessary.

Table 6.0(1) – Parameters Above the MAL

| Pollutant | Concentration | MAL | Units | Date |
|-----------|---------------|-----|-------|------|
| | | | | |
| | | | | |
| | | | | |
| | | | | |
| | | | | |
| | | | | |

D. Industrial user interruptions

Has any SIU, CIU, or other IU caused or contributed to any problems (excluding interferences or pass throughs) at your POTW in the past three years?

☐ Yes ☐ No

If yes, identify the industry, describe each episode, including dates, duration, description of the problems, and probable pollutants.

Click to enter text.

Section 3. Significant Industrial User (SIU) Information and Categorical Industrial User (CIU) (Instructions Page 90)

A. General information

Company Name: [Click to enter text.](#)

SIC Code: [Click to enter text.](#)

Contact name: [Click to enter text.](#)

Address: [Click to enter text.](#)

City, State, and Zip Code: [Click to enter text.](#)

Telephone number: [Click to enter text.](#)

Email address: [Click to enter text.](#)

B. Process information

Describe the industrial processes or other activities that affect or contribute to the SIU(s) or CIU(s) discharge (i.e., process and non-process wastewater).

[Click to enter text.](#)

C. Product and service information

Provide a description of the principal product(s) or services performed.

[Click to enter text.](#)

D. Flow rate information

See the Instructions for definitions of “process” and “non-process wastewater.”

Process Wastewater:

Discharge, in gallons/day: [Click to enter text.](#)

Discharge Type: ☐ Continuous ☐ Batch ☐ Intermittent

Non-Process Wastewater:

Discharge, in gallons/day: [Click to enter text.](#)

Discharge Type: ☐ Continuous ☐ Batch ☐ Intermittent

E. Pretreatment standards

Is the SIU or CIU subject to technically based local limits as defined in the instructions?

☐ Yes ☐ No

Is the SIU or CIU subject to categorical pretreatment standards found in *40 CFR Parts 405-471*?

☐ Yes ☐ No

If subject to categorical pretreatment standards, indicate the applicable category and subcategory for each categorical process.

Category: Subcategories: [Click to enter text.](#)

[Click or tap here to enter text.](#) [Click to enter text.](#)

Category: [Click to enter text.](#)

Subcategories: [Click to enter text.](#)

Category: [Click to enter text.](#)

Subcategories: [Click to enter text.](#)

Category: [Click to enter text.](#)

Subcategories: [Click to enter text.](#)

Category: [Click to enter text.](#)

Subcategories: [Click to enter text.](#)

F. Industrial user interruptions

Has the SIU or CIU caused or contributed to any problems (e.g., interferences, pass through, odors, corrosion, blockages) at your POTW in the past three years?

☐ Yes ☐ No

If yes, identify the SIU, describe each episode, including dates, duration, description of problems, and probable pollutants.

[Click to enter text.](#)



U.S. DEPARTMENT OF THE INTERIOR
U.S. GEOLOGICAL SURVEY



LA WARD QUADRANGLE
TEXAS - JACKSON COUNTY
7.5-MINUTE SERIES

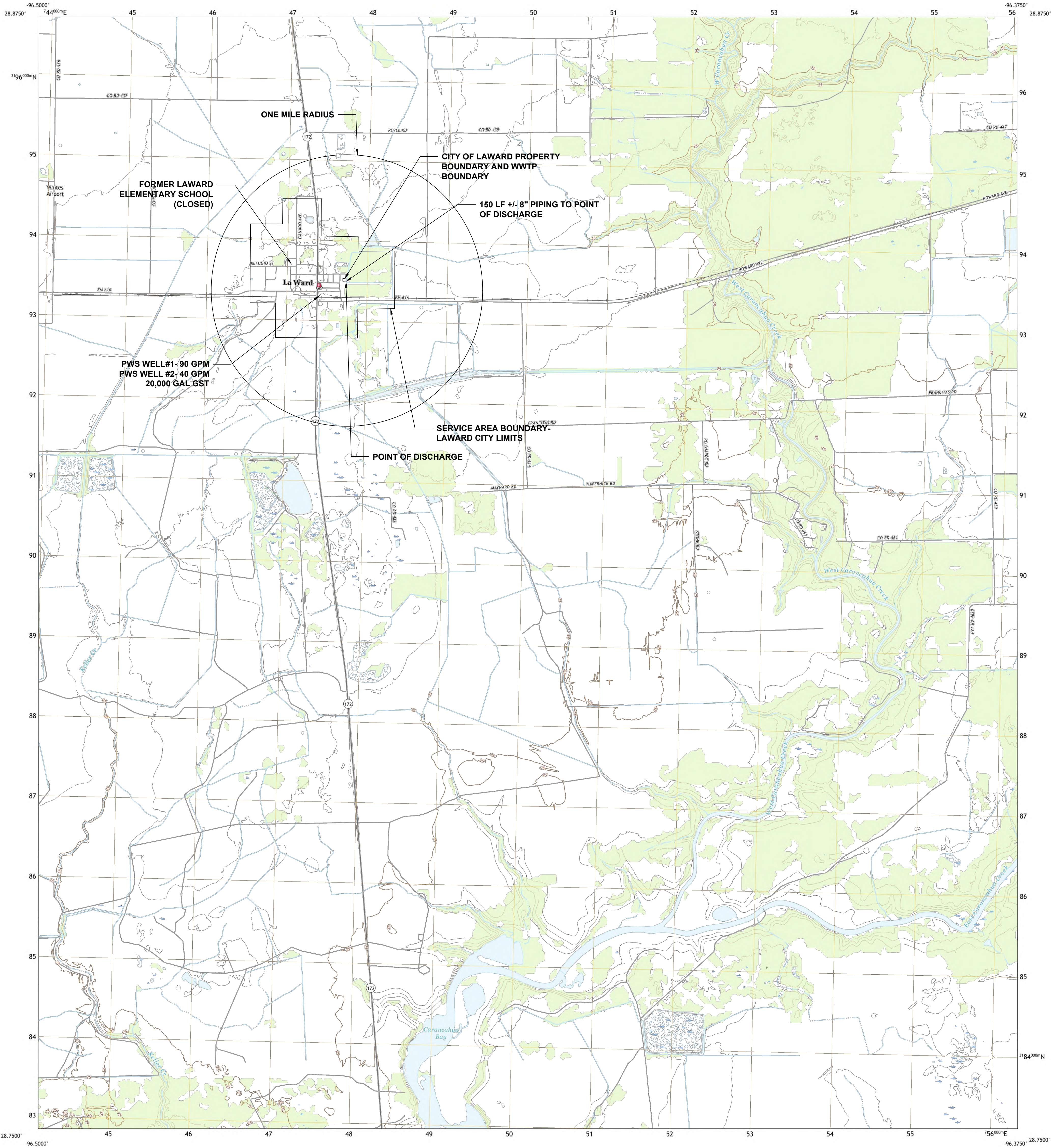

Produced by the United States Geological Survey
North American Datum of 1983 (NAD83)
World Geodetic System of 1984 (WGS84). Projection and
1 000-meter grid/Universal Transverse Mercator, Zone 14R
This map is not a legal document. Boundaries may be
generalized for this map scale. Private lands within government
reservations may not be shown. Obtain permission before
entering private lands.
Imagery.....NAIP, September 2016 - December 2016
Roads.....U.S. Census Bureau, 2015 - 2018
Names.....GNIS, 1979 - 2021
Hydrography.....National Hydrography Dataset, 2003 - 2018
Contours.....National Elevation Dataset, 2019 - 2020
Boundaries.....Multiple sources; see metadata file 2019 - 2021
Wetlands.....FWS National Wetlands Inventory Not Available

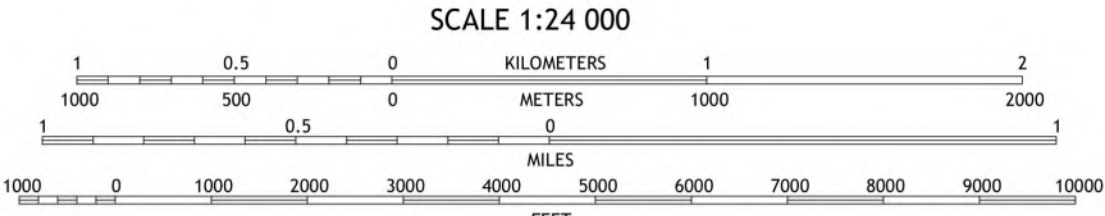
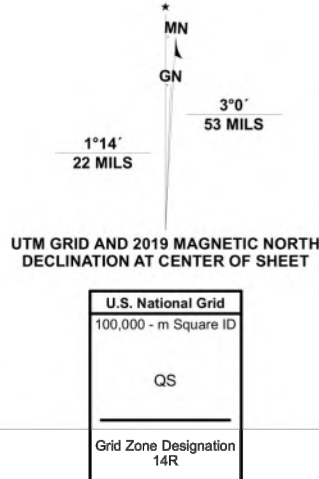

CONTOUR INTERVAL 5 FEET
NORTH AMERICAN VERTICAL DATUM OF 1988
This map was produced to conform with the
National Geospatial Program US Topo Product Standard.



| | | |
|---|---|---|
| 1 | 2 | 3 |
| 4 | 5 | 6 |
| 7 | 8 | 9 |

1 Manson
2 Frantias NW
3 Frantias NE
4 Lolita
5 Frantias
6 Point Comfort
7 Olivia
8 Turtle Bay

ROAD CLASSIFICATION
Expressway
Secondary Hwy
Ramp
Interstate Route
US Route
State Route
Local Connector
Local Road
4WD

LA WARD, TX
2022

EXHIBIT E 1 of 2



NSN 7 6 4 3 0 1 6 3 9 6 6 8 0
NSA REF NO. USGS X 2 4 K 2 4 1 8 9

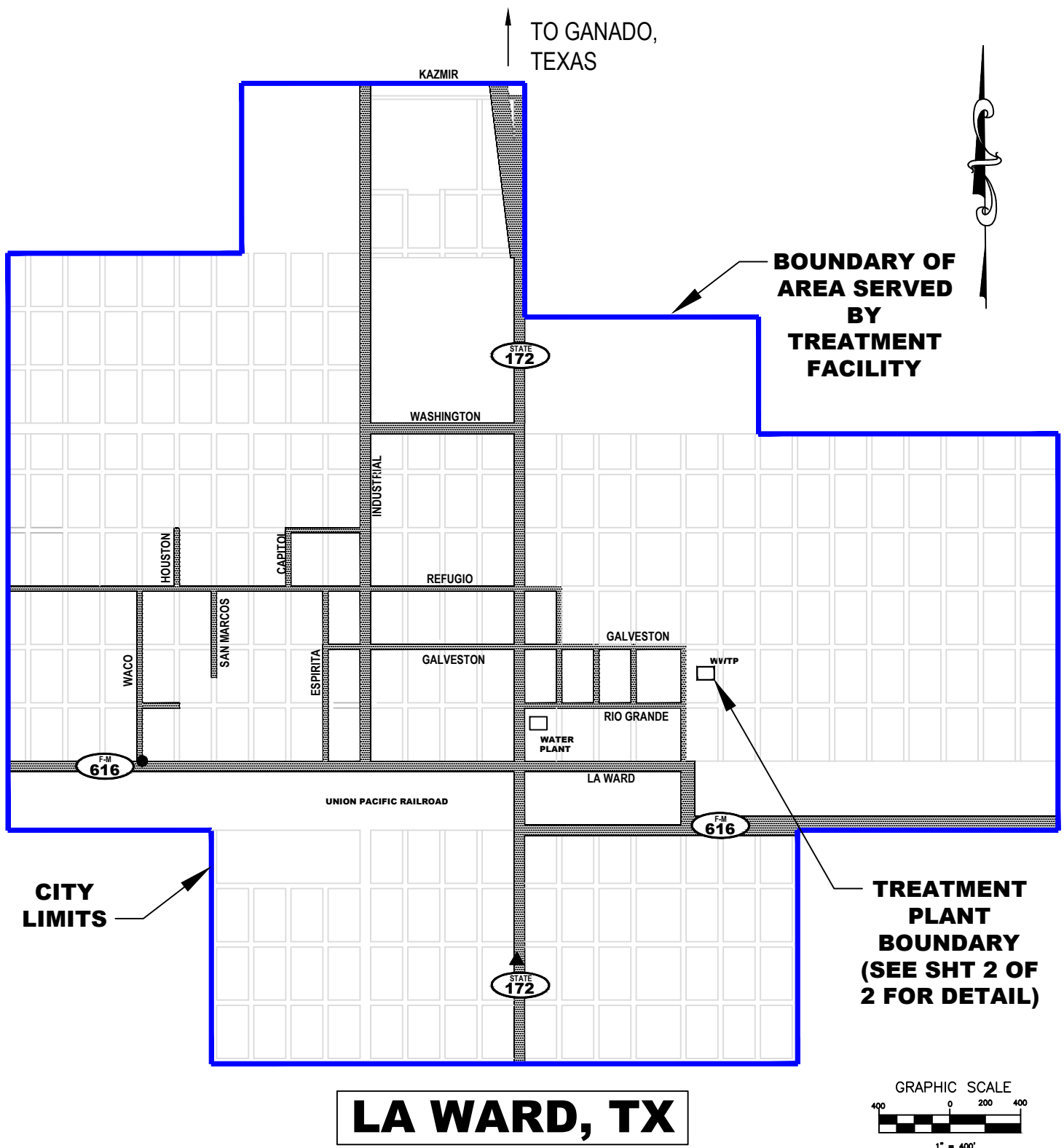

SITE DRAWING

TECHNICAL REPORT 1.0 ITEM 4
CITY OF LA WARD WQ0013479001

EXHIBIT E
SHEET 1 OF 2

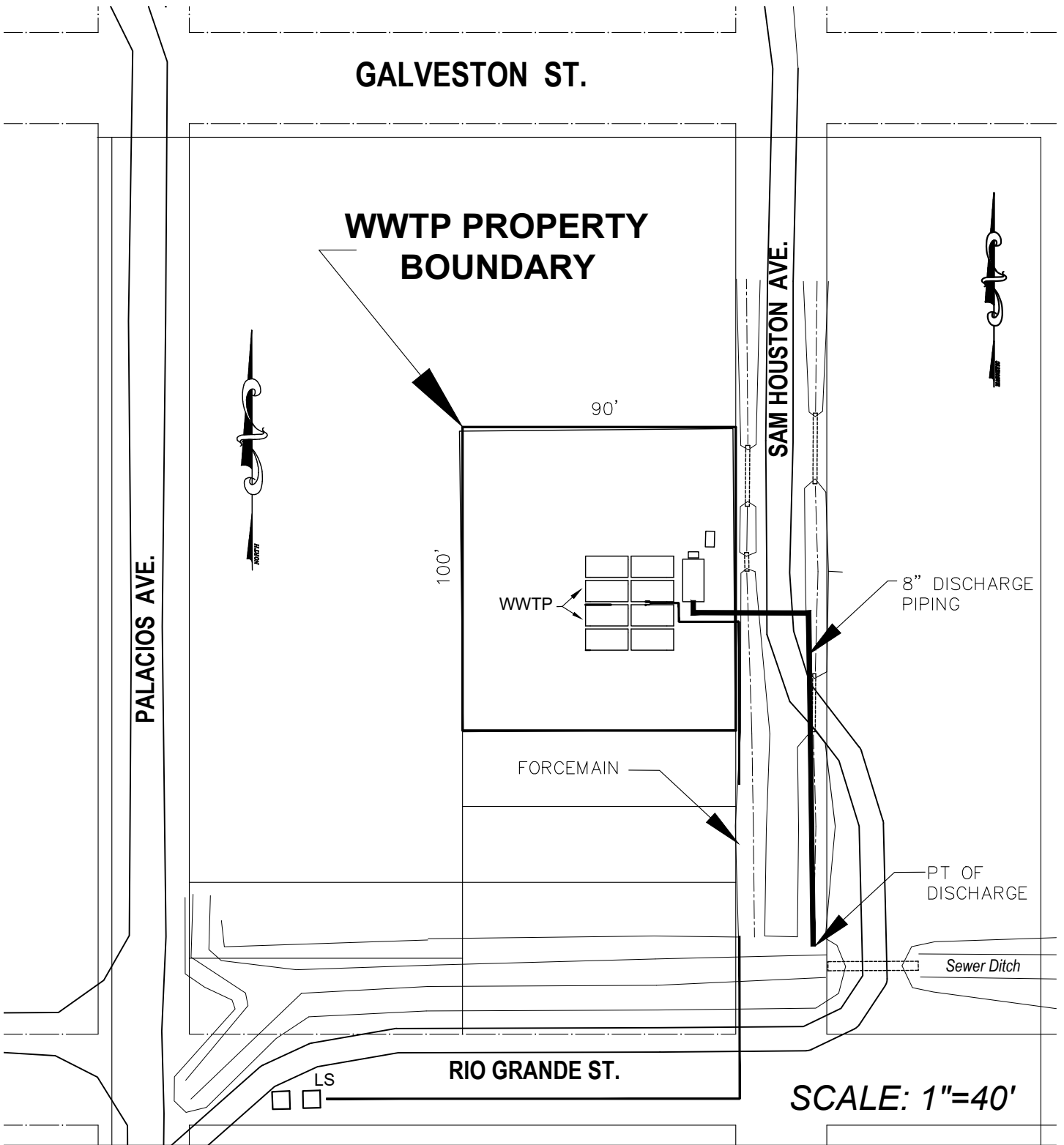

DETAIL SITE DRAWING
TECHNICAL REPORT 1.0 ITEM 1
150' BUFFER ZONE

EXHIBIT F (Technical Report 1.0)

- ANALYSIS OF TREATED EFFLUENT BACKUP

EXHIBIT H (Technical Report 1.0)

- DRAINAGE AGREEMENT
- WWPR LOG No. 03913/091
- TCEQ APPROVAL LETTER

JACKSON COUNTY, COUNTY WIDE DRAINAGE DISTRICT
2066 STATE HIGHWAY 111 SOUTH
EDNA, TEXAS 77957
PHONE 361-782-5401

May 8, 2013

JoAnna P. Weaver, P.E.
G&W Project Engineer
205 W. Live Oak
Port Lavaca, Texas 77979

JoAnna Weaver,

Jackson County, County Wide Drainage District Board of Directors have no problem with discharging waste water into Sewer Ditch, IV-A-8-c, and Brisco Ditch, IV-A-8. The Board of Directors agreed as long as TCEQ has no objections to discharging water into Sewer Ditch and Brisco Ditch which drains into West Caranchua Creek.

If you have any more questions, please contact Donnie Slatter, Manager at (361)782-5401.

Sincerely,



Donnie Slatter
Manager

G&W

9/25/2013 CW-YES
ENGINEERS, INC.

09/13/09/1

40512
DWI/WQ

205 W. Live Oak • Port Lavaca, TX 77979 • p: (361)552-4509 • f: (361)552-4987
Texas Firm Registration No. F04188

CN 600641708
RN 102287562

September 19, 2013

EXECUTIVE DIRECTOR
MC 109
TCBQ
P.O. Box 13087
Austin, Texas 78711-3087

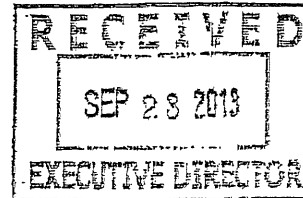

RE: CHAPTER 217 SUMMARY TRANSMITTAL LETTER
WASTEWATER TREATMENT PLANT EXPANSION AND OTHER WASTEWATER SYSTEM
IMPROVEMENTS
City of La Ward, Texas
TPDES Permit Number: WQ0013479001

The purpose of this letter is to provide the TCBQ with the following information about the above referenced project in order to comply with the requirements of §217.6(c) of the TCBQ's rules titled Design Criteria for Domestic Wastewater Systems.

1. Name and Address of the Design Firm: *G & W Engineers, Inc.
205 West Live Oak Street
Port Lavaca, Texas 77979*
2. Name, Phone Number and Facsimile Number of the Design Engineer: *Joanna P. Weaver, P.E. #61535
Phone: (361)552-4509
Fax: (361)552-4987*
3. The county where the project will be located: *Jackson County*
4. An identifying name for the project: *Wastewater Treatment Plant Expansion and Other
Wastewater Systems Improvements
TxCDBG Contract No. 712179*
5. Name(s) of person(s) that proposes to operate the collection system: *Larry Dayton ID # 45-02-6515*
6. the collection system owner's name, the treatment facility permit number, and facility name:
*City of LaWard
TPDES Permit Number WQ0013479001
City of LaWard Wastewater Treatment Plant*

7. Compliance Statement:

The Plans and Specifications, which describe the project identified in this letter, are in substantial compliance with all the requirements of Chapter 217, except as noted in the attached "TCEQ Requests for Variance to 30TAC217" document prepared by Larry Green, P.E., President of the existing plant manufacturer, Process Engineered Equipment Company.

8. Variance Certification Statement:

Any variances from the requirements of Chapter 217 will not threaten public health or environment, based on the best professional judgment of the design engineer, herein identified, who prepared the report and the project plans and specifications.

9. Project Description and Scope:

The proposed project is being funded in part by TxCDBG Contract No. 712179. The project involves two parts:

1) Wastewater Treatment Plant Expansion

Construction of a 12,000 gal/day packaged Wastewater Treatment Plant (WWTP) to work in parallel with the existing 12,000 gal/day WWTP manufactured by Process Engineered Equipment Company (PEECO). The existing WWTP will be modified as necessary to work in parallel with the new plant. Modifications to the existing plant shall include removing the division panel between the Chlorine Contact Chamber (CCC) and the Aerated Sludge Holding Basin (ASH) in order to enlarge the ASH and constructing a new separate Chlorine Contact Chamber to disinfect the effluent from both 12,000 gal/day trains. The existing Chlorine disinfection system will be modified to add two automatic feed pumps which will adjust the dosage of Cl_2 relative to the flow of the effluent stream.

An application for a Major Amendment to the wastewater discharge permit no. WQ0013479001 was submitted to TCEQ on July 8, 2013. This application is to increase the discharge flow limit from 13,000 gal/day to 24,000 gal/day. The application was declared Administratively Complete on August 2, 2013. We have received information from Jim Mickalk of TCEQ that the new permit will have an Effluent Limitation requirement of 10 mg/l for BOD and 15 mg/l TSS.

The new plant is designed to meet the following design requirements in accordance with 30TAC217 and the attached variance requests:

Average daily Flow (Qa): 12,000 gallons
Two Hour Average Peak Flow (4Qa): 2000 gal/hour
Raw Sewage: 200 mg/l BOD and 200 mg/l TSS
Effluent Quality: 10 mg/l BOD and 15 mg/l TSS

The plant, will operate in extended aeration mode just like the existing plant. Once construction is complete and the plant is in full operation, the raw wastewater will come via a 2" PVC pipe to a new splitter box that will equally split the flow to the two identical treatment processes. The wastewater enters initially in an aeration chamber, then passes to the clarifier, from which the flow from each side is brought together and will enter the new CCC for disinfection. From the bottom of each clarifier, sludge is either returned to the aeration chamber or to the ASH. The effluent will discharge from the CCC via an 8" PVC pipe and connect to the existing 8" PVC pipe which flows to the Point of Discharge.

The requested variances from Chapter 217 are attached hereto. There are no innovative or nonconforming technologies proposed as part of this project.

2) New Wastewater Collection System gravity mains.

Construction of approximately 332 lf of 8" and 214 lf of 6" ASTM D-3034 (SDR 26) PVC by open trench for use as a wastewater gravity line for first time sewer service. The project includes installation of one (1) new FRP Manhole; one (1) end of the line cleanout; five (5) new sewer service taps; connection to an existing 8" stub-out of an existing manhole; and property abandonment of four (4) existing septic tanks in accordance with 30TAC285.36. (Note two of the existing homes share one septic tank, resulting in one (1) less required septic tank abandonment than new service connections.)

The purpose of this portion of the project is to provide first time sewer service to five homes currently utilizing aging on-site septic systems.

There will be an alternate bid for an additional approximately 135 lf of 8" ASTM D-3034 (SDR 26) PVC sewer main by open trench, two (2) new sewer service connections, and two (2) septic tank abandonments.

There are no variances from the requirements of Chapter 217 being requested for this portion of the project and there are no innovative or non-conforming technologies proposed as part of this project.

10. Signature and Seal of the design engineer of the project identified herein:

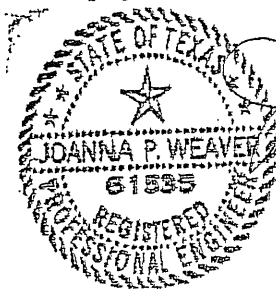

JoAnna P. Weaver, P.E.

Texas Serial No. 61535

Date:

9.19.2013

Respectfully Submitted,
G & W ENGINEERS, INC.

JoAnna P. "Jody" Weaver, P.E.

Sr. Project Engineer

cell: 361-920-4508

jweaver@gwengineers.com

att: TCEQ Requests for Variance to 30TAC217.(3 pages)

xc: TCEQ, Region 14, Corpus Christi
Richard Koch, Mayor City of La Ward
file 5606.002



PROCESS ENGINEERED EQUIPMENT COMPANY

438 MCBRIDE • P.O. BOX 9549
CORPUS CHRISTI, TEXAS 78469-9549

TELEPHONE: F-003760

PHONE (361) 289-8891

FAX (361) 289-7733

EMAIL mail@peeco.com

www.peeco.com

Over 45 Years in Texas

29 May 2013

Ms. JoAnna P. Weaver, P.E.
G & W Engineers, Inc
205 West Live Oak
Port Lavaca, Texas 77979

Re: City of La Ward, Wastewater Treatment Facility
TCEQ Requests for Variance to 30TAC217

Dear Ms. Weaver,

The following certification and variance requests are provided for inclusion with the TCEQ plan review project summary transmittal letter required by 30TAC217.6. It should be noted that the scope herein is limited to design, equipment and installation provided by PEECO for the subject project.

Based on past experience and conversations with TCEQ we expect no objections to the requested variances, but it is required that they be requested for each project individually. If you have any question or if you need further technical justification please let us know.

Sincerely,
Process Engineered Equipment Co.

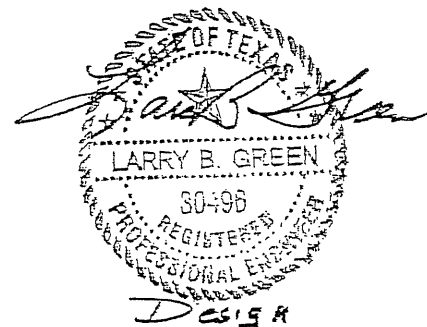

Larry B. Green, P.E.
President



CERTIFICATION

This statement is intended as compliance with 30TAC217.6 (7) & (8) and as certification by Process Engineered Equipment Co. (dba PEECO) that the domestic wastewater treatment plant design, equipment and installation proposed for the subject project by PEECO are in accordance with 30TAC217 with exception of the following variances. PEECO further certifies that none of the requested variances will threaten public health or environment.

Process Engineered Equipment Company

Larry B. Green, P.E.
President

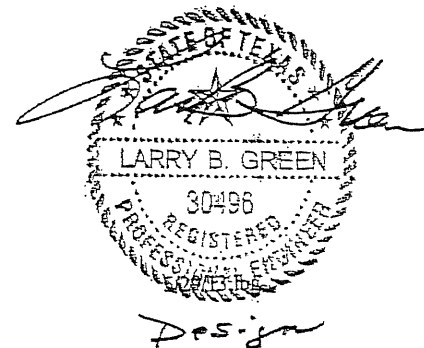

30TAC217 Request for Variances

REQUESTED VARIANCES

As required by 30TAC217.6(9)(B) the following are brief descriptions of the requested variances and reason for the requests. Further descriptive and technical discussion per 30TAC217.4 will be provided on request per 30TAC217.4(f)

SUBCHAPTER B - TREATMENT FACILITY DESIGN REQUIREMENTS

217.33(2)(A) Flow Measurement

The proposed facility will be equipped with flow meter as required by 217.33. The primary device will be a 30" V-notch weir and the secondary device will be an ultrasonic flow meter with instantaneous, totalizing and data logging features. The variance request is to 217.33(2)(A) which requires a straight channel approach of 20 times maximum head. Design maximum head will be about 6.5 inches, so 130 inches (10.8 ft) would be required. The proposed chlorine contact chamber is 6.0 ft wide X 13.0 ft long X 3.0 ft deep, which would comply with the requirement except the basin has three baffles which create laminar flow to move from side to side across the 6 ft width. The primary purpose of the baffles is to improve mixing. The last baffle will be about 4 feet in front of the V Notch weir. The basin width and water depth will allow a very low velocity and laminar flow approach to the V-notch. Field testing indicates that meter accuracy is within 2% for the lower 15% of head range and within less than 1% for the upper 85% of range.

SUBCHAPTER F - ACTIVATED SLUDGE

217.152(B)(5) - Scum Removal

The requirement is for a "mechanical" scum removal device. The proposed clarifiers are equipped with an air lift pump and an adjustable level cone, or trough for removal of floating scum and other solids. The inlet cone is adjusted to skim ¼ to ½ inches below water surface level at zero flow over the outlet weir. Water and scum are sucked downward and then lifted by the airlift to the aeration basin. We are not sure that this arrangement needs a variance from the "mechanical" requirement, but it is definitely a "positive" scum return system. The cone can remove scum within an approximate 3'-6" radius and the skimmer can be operated intermittently or continuous. In considering this variance, if it is one, it should be noted that the clarifier basin is rectangular, 6'-0" wide X 13'-0" long with 2 air lift educators, an inlet baffle, an effluent scum baffle and an effluent weir box mounted within. There is not enough space for a moving type device.

217.152(e) Sludge Collection Equipment

The requirement is that a clarifier that is part of a "facility" with a design flow of greater than 10,000 gpd must include mechanical sludge collecting equipment. Our variance request for the proposed facility is that the term "facility limit" be changed to "process train limit" and that the 10,000 gpd limit be revised to 12,000 gpd, and the requirement for a collection mechanism be deleted.

The existing and proposed clarifiers would utilize a PEECO standard "Ribwall" ® precast concrete basin that is 6.0 ft wide X 13.0 ft long X 10.17 ft deep, internally. When these basins are used to make a clarifier, square openings are cast in the bottom floor and precast hoppers 3.75 ft deep are placed below the floor. The finished structure provides a 2-hopper clarifier basin with a vertical side water depth of 8'-1" and a capacity of 4714 gallons above the top of the hoppers. Each hopper slopes at a 60 degree angle to a 1'-0" square bottom.

If Equation F.1, 217.152.(g)(3), $SWD = 160Q + 4$, is applied to this basin, using an 8'-0" SWD, the resulting allowable average daily flow, Q is 25,000 gpd for each of the proposed clarifiers. The requested variance is to rate each of the clarifier basins at 50% of this value.

30TAC217 Request for Variances

PEBCO Drawing 21-8245-0, Section AA shows the clarifier layout and dimensions. Note that flow enters the narrow end of the clarifier where a sloping baffle slows velocity and distributes flow downward and across the basin width. The two hoppers are in series and settleable solids must travel the length of the basin. For more than thirty five years PEBECO has used this type of clarifier basin for facilities with a design 2-hour maximum average flow rate (Peak Flow) of up to 62,500 gpd, per clarifier, and we do not know of any failure to perform at design conditions, nor have we received any operator complaints related to the design.

It should also be noted that one of these clarifiers rated at the 2.0 hour retention time of 217.154(c)(1), Table F2 would be suitable for a peak flow of 56,600 gpd. For enhanced secondary the 2.2 hour retention time would allow a peak flow of 51,400 gpd.

Based on the above we request a variance for the proposed hopper clarifier and for deletion of sludge collection equipment.

217.153(b)(1) Aeration Basin Freeboard

The variance request is to allow 15 inch freeboard in lieu of the required 18 inches.

This variance has been allowed for PEBECO treatment facilities many times over the past 40 years. The chief reason for increased freeboard in aeration is to help decrease the possibility of light foam being blown from the basins during startup. PEBECO "Ribwall" @ precast concrete structures allow the basins to be completely covered. All openings in the top deck are covered with grating. There are commonly two, 4'-0" X 3'-0" openings or one, 10'-6" X 3'-0" opening. This design allows the top to be 30 % open. The remaining concrete cover, and specifically the 1'-3" top lip around the perimeter act to contain any floating foam that may occur. Also, the partially covered top decreases the effects of wind blowing into the basins.

217.153(c)(4) Dewatering

The variance request is that portable pumps be considered an adequate method of dewatering aeration basins. The requirement is that each aeration basin be provided with a "dedicated" means for dewatering. None of the aeration tanks is equipped with what might be considered a "dedicated" means. The plan for dewatering the aeration basins, and all other basins, is to obtain a portable submersible pump or trailer mounted self priming pump to transfer liquid or sludge from the aeration basin to the clarifier, digester or a haul truck.

217.155(b)(2)(a)(i) Diffuser Clean Water Oxygen Transfer Efficiency.

A variance is requested is to allow clean water transfer efficiency of 6% as acceptable even in the absence of certified lab testing results

The proposed facility would be equipped with PEBECO Model 610 diffusers that have been used as our standard since 1973. At that time the original manufacturer, Engineered Products, Inc., Clearwater, Florida, provided sales literature and technical data stating that the average tested diffuser clean water efficiency for these diffusers was 14%. Maintenance instructions cautioned that if the diffusers were not serviced annually the efficiency could drop to as low as 6% due to clogging and accumulation of trash. Engineered Products dissolved their company in about 1990 and PEBECO began to manufacture the diffusers. However, the certified test results are no longer available and PEBECO has not conducted testing that would comply with this requirement. From the beginning in 1973 PEBECO has used a design clean water transfer efficiency of 6% based on recommended minimum values published in USEPA design manuals.

When corrected for wastewater values of $\alpha=0.90$, $\beta=0.95$, $T=27^{\circ}\text{C}$ the resultant correction for wastewater transfer efficiency is 0.658. Using this value and the proposed 6% clean water transfer efficiency the calculated wastewater oxygen transfer efficiency is 3.9%. This is the value used by PEBECO and is complies with the 4.0% minimum allowed by Table F.4 to obtain minimum air flow required.

Bryan W. Shaw, Ph.D., P.E., *Chairman*
Toby Baker, *Commissioner*
Zak Cover, *Commissioner*
Richard A. Hyde, P.E., *Interim Executive Director*



TEXAS COMMISSION ON ENVIRONMENTAL QUALITY

Protecting Texas by Reducing and Preventing Pollution

January 15, 2014

JoAnna P. Weaver, P.E.
G & W Engineers, Inc.
205 West Live Oak Street
Port Lavaca, Texas 77979

Re: City of LaWard
City of LaWard Wastewater Treatment Plant
Permit No. WQ0013479-001
WWPR Log No. 0913/091
CN600641708, RN102287562
Jackson County

(This is a reissuance correcting the letter dated September 27, 2013).

Dear Ms. Weaver:

We have received the project summary transmittal letter dated September 19, 2013.

The rules which regulate the design, installation and testing of domestic wastewater projects are found in 30 TAC, Chapter 217, of the Texas Commission on Environmental Quality (TCEQ) rules titled, Design Criteria for Wastewater Systems.

Section 217.6(d), relating to case-by-case reviews, states in part that upon submittal of a summary transmittal letter, the executive director may approve of the project without reviewing a complete set of plans and specifications.

Under the authority of §217.6(e) a technical review of complete plans and specifications is not required. However, the project proposed in the summary transmittal letter is approved for construction. Please note, that this conditional approval does not relieve the applicant of any responsibilities to obtain all other necessary permits or authorizations, such as wastewater treatment permit or other authorization as required by Chapter 26 of the Texas Water Code. Below are provisions of the Chapter 217 regulations, which must be met as a condition of approval. These items are provided as a reminder. If you have already met these requirements, please disregard this additional notice.

1. You must keep certain materials on file for the life of the project and provide them to TCEQ upon request. These materials include an engineering report, test results, a summary transmittal letter, and the final version of the project plans and specifications. These materials shall be prepared and sealed by a Professional Engineer licensed in the State of Texas and must show substantial compliance with Chapter 217. All plans and specifications must conform to any waste discharge requirements authorized in a permit by the TCEQ. Certain specific items which shall be addressed in the engineering report are discussed in §217.6(c). Additionally, the engineering report

JoAnna P. Weaver, P.E.

Page 2

January 15, 2014

must include all constants, graphs, equations, and calculations needed to show substantial compliance with Chapter 217. The items which shall be included in the summary transmittal letter are addressed in §217.6(c)(1)-(10).

2. Any deviations from Chapter 217 shall be disclosed in the summary transmittal letter and the technical justifications for those deviations shall be provided in the engineering report. Any deviations from Chapter 217 shall be based on the best professional judgement of the licensed professional engineer sealing the materials and the engineer's judgement that the design would not result in a threat to public health or the environment.
3. Any variance from a Chapter 217 requirement disclosed in your summary transmittal letter is approved. If in the future, additional variances from the Chapter 217 requirements are desired for the project, each variance must be requested in writing by the design engineer. Then, the TCEQ will consider granting a written approval to the variance from the rules for the specific project and the specific circumstances.
4. Within 60 days of the completion of construction, an appointed engineer shall notify both the Wastewater Permits Section of the TCEQ and the appropriate Region Office of the date of completion. The engineer shall also provide written certification that all construction, materials, and equipment were substantially in accordance with the approved project, the rules of the TCEQ, and any change orders filed with the TCEQ. All notifications, certifications, and change orders must include the signed and dated seal of a Professional Engineer licensed in the State of Texas.

This approval does not mean that future projects will be approved without a complete plans and specifications review. The TCEQ will provide a notification of intent to review whenever a project is to undergo a complete plans and specifications review. Please be reminded of §217.5 of the rules which states, "Approval given by the executive director...shall not relieve the sewerage system owner or the design engineer of any liabilities or responsibilities with respect to the proper design, construction, or authorized operation of the project in accordance with applicable commission rules."

If you have any questions or if we can be of any further assistance, please call me at (512) 239-4552.

Sincerely,

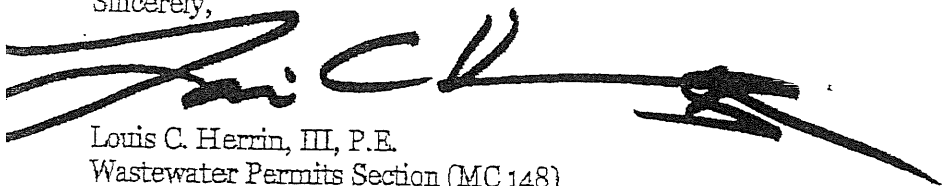

Louis C. Herrin, III, P.E.
Wastewater Permits Section (MC 148)
Water Quality Division
Texas Commission on Environmental Quality

LCH/yds

cc: TCEQ, Region 14 Office



EXHIBIT G (Technical Report 1.0 Item 7c)

- Completion Notice

G&W ENGINEERS, INC.

205 W. Live Oak • Port Lavaca, TX 77979 • p: (361)552-4509 • f: (361)552-4987
Texas Firm Registration No. F04188

June 23, 2014

Mr. Louis Herrin, III, P.E.
Wastewater Permits Section (MC 148)
Water Quality Division
TCEQ
P.O. Box 13087, MC 148
Austin, Texas 78711-3087

RE: CHAPTER 217.14 COMPLETION NOTICE
WASTEWATER TREATMENT PLANT EXPANSION AND OTHER WASTEWATER SYSTEM
IMPROVEMENTS
City of La Ward, Texas
TPDES Permit Number: WQ0013479001
WWPR Log No. 0913/091
CN600641708, RN102287562
Jackson County

This letter serves as notification that construction of the above referenced project is complete as of June 13, 2014.
The start-up date for the new expansion to the wastewater treatment plant was May 27, 2014.

I hereby certify that all construction, materials, and equipment were substantially in accordance with the approved project, the rules of the TCEQ, and any change orders filed with TCEQ.

Signature and Seal of the design engineer of the project identified herein:

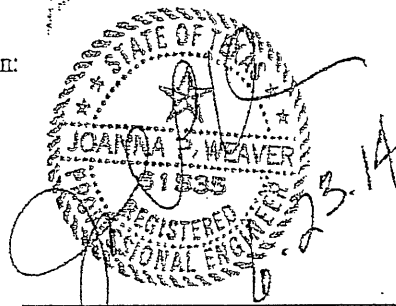

JoAnna P. Weaver, P.E.
Texas Serial No. 61535
Date:

Respectfully Submitted,
G & W ENGINEERS, INC.

JoAnna P. "Jody" Weaver, P.E.
Sr. Project Engineer
jweaver@gwengineers.com

xc: TCEQ, Region 14, Corpus Christi, Richard Koch, Mayor City of LaWard, file 5606.002

Francesca Findlay

From: smason@gwengineers.com
Sent: Friday, December 6, 2024 12:58 PM
To: Francesca Findlay; koch_wr@yahoo.com
Cc: Erwin Madrid
Subject: RE: WQ0013479001 City of La Ward

I did not receive the email on November 18th as my email address was incorrect on your email.

Mayor Koch received it, but didn't realize I hadn't because of the error.

We will do our best to address this on or before the deadline.

Thank you,

Scott P. Mason, P.E.

Lead Project Engineer

G&W Engineers, Inc.
205 W. Live Oak
Port Lavaca, Texas 77979
P: (361) 552-4509
smason@gwengineers.com

From: Francesca Findlay <Francesca.Findlay@tceq.texas.gov>
Sent: Friday, December 6, 2024 10:40 AM
To: smason@gwengineers.com; koch_wr@yahoo.com
Cc: Erwin Madrid <Erwin.Madrid@tceq.texas.gov>
Subject: RE: WQ0013479001 City of La Ward

Good morning,

I apologize, I forgot to attach the nod that was sent on the 18th of November, 2024.

Thank you,

Francesca Findlay
License & Permit Specialist
ARP Team | Water Quality Division
512-239-2441
Texas Commission on Environmental Quality



Please consider whether it is necessary to print this e-mail

How is our customer service? Fill out our online customer satisfaction survey at <http://www.tceq.texas.gov/customersurvey>.

From: Francesca Findlay
Sent: Friday, December 6, 2024 10:00 AM
To: 'smason@gwengineers.com' <smason@gwengineers.com>; koch_wr@yahoo.com
Cc: Erwin Madrid <Erwin.Madrid@tceq.texas.gov>
Subject: FW: WQ0013479001 City of La Ward

Good morning,

I have attached the email that I sent on the 18th of November. I did send an email to the address of wr@yahoo.com and it came back as undeliverable. Please let me know if you need anything else.

Thank you,

Francesca Findlay
License & Permit Specialist
ARP Team | Water Quality Division
512-239-2441
Texas Commission on Environmental Quality



Please consider whether it is necessary to print this e-mail

How is our customer service? Fill out our online customer satisfaction survey at <http://www.tceq.texas.gov/customersurvey>.

From: Francesca Findlay
Sent: Monday, November 18, 2024 4:45 PM
To: koch_wr@yahoo.com
Cc: smason@gwengineers.com
Subject: FW: WQ0013479001 City of La Ward

Dear Mr. Koch:

The attached Notice of Deficiency letter sent on November 18, 2024, requesting additional information needed to declare the application administratively complete. Please send the complete response to my attention December 3, 2024.

Thank you,

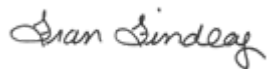

Francesca Findlay
License & Permit Specialist
ARP Team | Water Quality Division
512-239-2441
Texas Commission on Environmental Quality



Please consider whether it is necessary to print this e-mail

The content of this e-mail (including any attachments) is strictly confidential and may be commercially sensitive. If you are not, or believe you may not be, the intended recipient, please advise the sender immediately by return e-mail, delete this e-mail and destroy any copies.

Erwin Madrid

From: Erwin Madrid
Sent: Thursday, December 5, 2024 9:46 AM
To: 'wr@yahoo.com'; smason@gwengineers.com
Cc: Francesca Findlay
Subject: Application for Permit No. WQ0013479001 – Notice of Deficiency 30-Day Will Return Letter
Attachments: WQ0013479001_Will Return Ltr.pdf
Importance: High

Dear applicant,

The attached Notice of Deficiency 30-Day Will Return Letter was mailed on **December 5, 2024**, requesting additional information needed to declare the application administratively complete. Please mail an original and two copies (with a cover letter) of the complete response by **January 4, 2025**.

Regards,

Erwin Madrid
Team Lead
ARP Team | Water Quality Division
512-239-2191
Texas Commission on Environmental Quality



Please consider whether it is necessary to print this e-mail.

December 09, 2024

Francesca Findlay
Application Review and Processing Team, MC-148
Texas Commission on Environmental Quality
P.O. Box 13087
Austin, Texas 78711-3087

RE: Application to Renew, for Permit No.: WQ0013479001 (EPA I.D. No. TX0105104)
Applicant Name: City of La Ward (CN600641708)
Site Name: City of La Ward WWTP (RN102287562)
Type of Application: Renewal without changes

Dear Plan Review Team,

G&W Engineers, Inc. was retained to by the City of La Ward to submit the necessary application Submittal for the Renewal of the current Wastewater Treatment Facility permit to the TCEQ. This is in response to the email sent on November 18, 2024 to address the following two (2) comments about the submittal.

1. *1. Administrative Report 1.0, Section 1: Please provide payment information a check/Money Order Number, Name printed on check, or a Epay Voucher number. **The administrative report 1.0 section 1 page 2 of 17 has been updated to reflect the correct payment information. Please see the attached updated 10053 form page 2.***
2. *The following is a portion of the NORI which contains information relevant to your application. Please read it carefully and indicate if it contains any errors or omissions. The complete notice will be sent to you once the application is declared administratively complete.*

APPLICATION. *City of La Ward, P.O. Box 178, La Ward, Texas 77970, has applied to the Texas Commission on Environmental Quality (TCEQ) to renew Texas Pollutant Discharge Elimination System (TPDES) Permit No. WQ0013479001 (EPA I.D. No. TX0105104) to authorize the discharge of treated wastewater at a volume not to exceed a daily average flow of 24,000 gallons per day. The domestic wastewater treatment facility is located approximately 1,200 feet notheast of the intersection of Farm-to-Market Road 616 and State Highway 172, in the city of La Ward, in Jackson County, Texas 77970. The discharge route is from the plant site to a series of ditches; thence to an unnamed tributary; thence to West Carancahua Creek; thence to Carancahua Creek; thence to Carancahua Bay. TCEQ received this application on November 15, 2024. The permit application will be available for viewing and copying at La Ward Post Office, 13059 State Highway 172, La Ward Texas 77970, La Ward, in Jackson County, Texas prior to the date this notice is published in the newspaper. The application, including any updates, and associated notices are available electronically at the following webpage: <https://www.tceq.texas.gov/permitting/wastewater/pending-permits/tpdes-applications>. This link*

to an electronic map of the site or facility's general location is provided as a public courtesy and not part of the application or notice. For the exact location, refer to the application.

<https://gisweb.tceq.texas.gov/LocationMapper/?marker=-96.461111,28.845555&level=18>

*Further information may also be obtained from City of La Ward at the address stated above or by calling Mr. Scott Mason, P.E., Senior Engineer, at 361-552-4509 The above Notice of Receipt of Application and Intent to Obtain a Water Quality Permit has been read and no errors or omissions have been found. **The above Notice of Receipt of Application and Intent to Obtain a Water Quality Permit has been read and the information is correct. There appears to be a typographical error in the word "northeast" when describing the facility location.***

Sincerely,



Scott P. Mason, P.E.
Lead Project Engineer
G&W Engineers, Inc.



TEXAS COMMISSION ON ENVIRONMENTAL QUALITY

**DOMESTIC WASTEWATER PERMIT APPLICATION
ADMINISTRATIVE REPORT 1.0**

For any questions about this form, please contact the Applications Review and Processing Team at 512-239-4671.

Section 1. Application Fees (Instructions Page 26)

Indicate the amount submitted for the application fee (check only one).

| Flow | New/Major Amendment | Renewal |
|---------------------|-------------------------------------|--|
| <0.05 MGD | \$350.00 <input type="checkbox"/> | \$315.00 <input checked="" type="checkbox"/> |
| ≥0.05 but <0.10 MGD | \$550.00 <input type="checkbox"/> | \$515.00 <input type="checkbox"/> |
| ≥0.10 but <0.25 MGD | \$850.00 <input type="checkbox"/> | \$815.00 <input type="checkbox"/> |
| ≥0.25 but <0.50 MGD | \$1,250.00 <input type="checkbox"/> | \$1,215.00 <input type="checkbox"/> |
| ≥0.50 but <1.0 MGD | \$1,650.00 <input type="checkbox"/> | \$1,615.00 <input type="checkbox"/> |
| ≥1.0 MGD | \$2,050.00 <input type="checkbox"/> | \$2,015.00 <input type="checkbox"/> |

Minor Amendment (for any flow) \$150.00 ☐

Payment Information:

Mailed Check/Money Order Number: 2078
Check/Money Order Amount: \$315.00
Name Printed on Check: City of La Ward

EPAY Voucher Number: Click to enter text.

Copy of Payment Voucher enclosed? Yes ☐

Section 2. Type of Application (Instructions Page 26)

a. Check the box next to the appropriate authorization type.

- ☒ Publicly-Owned Domestic Wastewater
☐ Privately-Owned Domestic Wastewater
☐ Conventional Wastewater Treatment

b. Check the box next to the appropriate facility status.

- ☒ Active ☐ Inactive

c. Check the box next to the appropriate permit type.

- ☒ TPDES Permit
☐ TLAP
☐ TPDES Permit with TLAP component

Francesca Findlay

From: smason@gwengineers.com
Sent: Thursday, December 12, 2024 11:46 AM
To: koch_wr@yahoo.com
Cc: Francesca Findlay
Subject: RE: WQ0013479001 City of La Ward

Follow Up Flag: Follow up
Flag Status: Flagged

Mayor Koch,

Could you please respond to the TCEQ and their question below with a reply all.

I know we have always used the LaWard Post Office as the viewing place in the past.

My understanding is that access to the Post Office is Public. Most post office locations offer copying services and I know that a copy could be made on request at the fire station/community center. Could you verify?

Scott P. Mason, P.E.

Lead Project Engineer

G&W Engineers, Inc.
205 W. Live Oak
Port Lavaca, Texas 77979
P: (361) 552-4509
smason@gwengineers.com

From: Francesca Findlay <Francesca.Findlay@tceq.texas.gov>
Sent: Thursday, December 12, 2024 10:53 AM
To: smason@gwengineers.com; koch_wr@yahoo.com
Subject: RE: WQ0013479001 City of La Ward

Good morning,

I am in the process of admin. Completing your application. Please verify that the public viewing area La Ward Post Office has public access to view and copy the application.

Thank you,

Francesca Findlay
License & Permit Specialist
ARP Team | Water Quality Division
512-239-2441
Texas Commission on Environmental Quality



Please consider whether it is necessary to print this e-mail

How is our customer service? Fill out our online customer satisfaction survey at <http://www.tceq.texas.gov/customersurvey>.

From: smason@gwengineers.com <smason@gwengineers.com>
Sent: Tuesday, December 10, 2024 3:56 PM
To: Francesca Findlay <Francesca.Findlay@tceq.texas.gov>; koch_wr@yahoo.com
Cc: Erwin Madrid <Erwin.Madrid@tceq.texas.gov>
Subject: RE: WQ0013479001 City of La Ward

Francesca,

Please see our official response to the November 18, 2024 email.

Please let us know if paper copies mailed are still required or not as the NOD requests.

If they are please provide address.

Thank you,

Scott P. Mason, P.E.

Lead Project Engineer

G&W Engineers, Inc.
205 W. Live Oak
Port Lavaca, Texas 77979
P: (361) 552-4509
smason@gwengineers.com

From: Francesca Findlay <Francesca.Findlay@tceq.texas.gov>
Sent: Friday, December 6, 2024 10:40 AM
To: smason@gwengineers.com; koch_wr@yahoo.com
Cc: Erwin Madrid <Erwin.Madrid@tceq.texas.gov>
Subject: RE: WQ0013479001 City of La Ward

Good morning,

I apologize, I forgot to attach the nod that was sent on the 18th of November, 2024.

Thank you,

Francesca Findlay
License & Permit Specialist
ARP Team | Water Quality Division
512-239-2441
Texas Commission on Environmental Quality



Please consider whether it is necessary to print this e-mail

How is our customer service? Fill out our online customer satisfaction survey at <http://www.tceq.texas.gov/customersurvey>.

From: Francesca Findlay
Sent: Friday, December 6, 2024 10:00 AM
To: 'smason@gwengineers.com' <smason@gwengineers.com>; koch_wr@yahoo.com
Cc: Erwin Madrid <Erwin.Madrid@tceq.texas.gov>
Subject: FW: WQ0013479001 City of La Ward

Good morning,

I have attached the email that I sent on the 18th of November. I did send an email to the address of wr@yahoo.com and it came back as undeliverable. Please let me know if you need anything else.

Thank you,

Francesca Findlay
License & Permit Specialist
ARP Team | Water Quality Division
512-239-2441
Texas Commission on Environmental Quality



Please consider whether it is necessary to print this e-mail

How is our customer service? Fill out our online customer satisfaction survey at <http://www.tceq.texas.gov/customersurvey>.

From: Francesca Findlay
Sent: Monday, November 18, 2024 4:45 PM
To: koch_wr@yahoo.com
Cc: smason@gwengineers.com
Subject: FW: WQ0013479001 City of La Ward

Dear Mr. Koch:

The attached Notice of Deficiency letter sent on November 18, 2024, requesting additional information needed to declare the application administratively complete. Please send the complete response to my attention December 3, 2024.

Thank you,

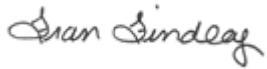

Francesca Findlay
License & Permit Specialist
ARP Team | Water Quality Division
512-239-2441
Texas Commission on Environmental Quality



Please consider whether it is necessary to print this e-mail

The content of this e-mail (including any attachments) is strictly confidential and may be commercially sensitive. If you are not, or believe you may not be, the intended recipient, please advise the sender immediately by return e-mail, delete this e-mail and destroy any copies.

Francesca Findlay

From: Francesca Findlay
Sent: Thursday, December 12, 2024 10:53 AM
To: smason@gwengineers.com; koch_wr@yahoo.com
Subject: RE: WQ0013479001 City of La Ward

Follow Up Flag: Follow up
Flag Status: Flagged

Good morning,

I am in the process of admin. Completing your application. Please verify that the public viewing area La Ward Post Office has public access to view and copy the application.

Thank you,

Francesca Findlay
License & Permit Specialist
ARP Team | Water Quality Division
512-239-2441
Texas Commission on Environmental Quality



Please consider whether it is necessary to print this e-mail

How is our customer service? Fill out our online customer satisfaction survey at <http://www.tceq.texas.gov/customersurvey>.

From: smason@gwengineers.com <smason@gwengineers.com>
Sent: Tuesday, December 10, 2024 3:56 PM
To: Francesca Findlay <Francesca.Findlay@tceq.texas.gov>; koch_wr@yahoo.com
Cc: Erwin Madrid <Erwin.Madrid@tceq.texas.gov>
Subject: RE: WQ0013479001 City of La Ward

Francesca,

Please see our official response to the November 18, 2024 email.

Please let us know if paper copies mailed are still required or not as the NOD requests.

If they are please provide address.

Thank you,

Scott P. Mason, P.E.

Lead Project Engineer

G&W Engineers, Inc.
205 W. Live Oak
Port Lavaca, Texas 77979
P: (361) 552-4509
smason@gwengineers.com

From: Francesca Findlay <Francesca.Findlay@tceq.texas.gov>
Sent: Friday, December 6, 2024 10:40 AM
To: smason@gwengineers.com; koch_wr@yahoo.com
Cc: Erwin Madrid <Erwin.Madrid@tceq.texas.gov>
Subject: RE: WQ0013479001 City of La Ward

Good morning,

I apologize, I forgot to attach the nod that was sent on the 18th of November, 2024.

Thank you,

Francesca Findlay
License & Permit Specialist
ARP Team | Water Quality Division
512-239-2441
Texas Commission on Environmental Quality



Please consider whether it is necessary to print this e-mail

How is our customer service? Fill out our online customer satisfaction survey at <http://www.tceq.texas.gov/customersurvey>.

From: Francesca Findlay
Sent: Friday, December 6, 2024 10:00 AM
To: 'smason@gwengineers.com' <smason@gwengineers.com>; koch_wr@yahoo.com
Cc: Erwin Madrid <Erwin.Madrid@tceq.texas.gov>
Subject: FW: WQ0013479001 City of La Ward

Good morning,

I have attached the email that I sent on the 18th of November. I did send an email to the address of wr@yahoo.com and it came back as undeliverable. Please let me know if you need anything else.

Thank you,

Francesca Findlay

License & Permit Specialist
ARP Team | Water Quality Division
512-239-2441
Texas Commission on Environmental Quality



Please consider whether it is necessary to print this e-mail

How is our customer service? Fill out our online customer satisfaction survey at <http://www.tceq.texas.gov/customersurvey>.

From: Francesca Findlay
Sent: Monday, November 18, 2024 4:45 PM
To: koch_wr@yahoo.com
Cc: smason@gwegineers.com
Subject: FW: WQ0013479001 City of La Ward

Dear Mr. Koch:

The attached Notice of Deficiency letter sent on November 18, 2024, requesting additional information needed to declare the application administratively complete. Please send the complete response to my attention December 3, 2024.

Thank you,

A handwritten signature in cursive script, appearing to read "Francesca Findlay".

Francesca Findlay
License & Permit Specialist
ARP Team | Water Quality Division
512-239-2441
Texas Commission on Environmental Quality



Please consider whether it is necessary to print this e-mail

The content of this e-mail (including any attachments) is strictly confidential and may be commercially sensitive. If you are not, or believe you may not be, the intended recipient, please advise the sender immediately by return e-mail, delete this e-mail and destroy any copies.