



Administrative Package Cover Page

This file contains the following documents:

1. Summary of application (in plain language)
 - English
 - Alternative Language (Spanish)
 2. First Notice (NORI-Notice of Receipt of Application and Intent to Obtain a Permit)
 - English
 - Alternative Language (Spanish)
 3. Application materials
-



Portada de Paquete Administrativo

Este archivo contiene los siguientes documentos:

1. Resumen en lenguaje sencillo (PLS, por sus siglas en inglés) de la actividad propuesta
 - Inglés
 - Idioma alternativo (español)
2. Primer aviso (NORI, el Aviso de Recepción de Solicitud e Intención de Obtener un Permiso)
 - Inglés
 - Idioma alternativo (español)
3. Solicitud original

Plain Language Summary Template and Instructions for Texas Pollutant Discharge Elimination System (TPDES) and Texas Land Application (TLAP) Permit Applications

The following summary is provided for this pending water quality permit application being reviewed by the Texas Commission on Environmental Quality as required by 30 Texas Administrative Code Chapter 39. The information provided in this summary may change during the technical review of the application and are not federal enforceable representations of the permit application.

Northeast Harris County Municipal Utility District No. 1, c/o Allen Boone Humphries Robinson, LLP (CN600630081) operates Northeast Harris County MUD 1 WWTP RN104780796 a domestic wastewater treatment plant for Northeast Harris County MUD No. 1. The facility is located approximately 2,050 feet south of the intersection of Beaumont Highway and Miller Road Number 3 in Houston, Harris County, Texas 77049.

This application is a renewal to discharge 400,000 gallons per day of treated domestic wastewater from the plant site into Edgewood Village Detention Pond thence to Carpenters Bayou thence to Houston Ship Channel Tidal Segment in No. 1006 of the San Jacinto River Basin.

Discharges from the facility are expected to contain five-day carbonaceous biochemical oxygen demand (CBOD₅), total suspended solids (TSS), ammonia nitrogen (NH₃-N), and *Escherichia coli*. Additional potential pollutants are included in the Domestic Technical Report 1.0, Section 7. Pollutant Analysis of Treated Effluent and Domestic Worksheet 4.0 in the permit application package. Domestic wastewater is treated after being pumped from the onsite lift station to the headworks which consists of three (3) bar screens. From the headworks, flow continues to two (2) rectangular aeration basins. Flow from the aeration basins passes into one of the one (1) 34-foot diameter circular clarifier. The clarifier underflow is returned to the headworks or wasted to the two (2) aerobic digester basins. Clarified effluent is passed into two (2) chlorine contact basin and then discharges into Edgewood Village Detention Pond thence to Carpenters Bayou thence to Houston Ship Channel Tidal Segment in No. 1006 of the San Jacinto River Basin.

**PLANTILLA EN ESPAÑOL PARA SOLICITUDES
NUEVAS/RENOVACIONES/ENMIENDAS TPDES o TLAP**

AGUAS RESIDUALES DOMÉSTICAS

El siguiente resumen se proporciona para esta solicitud de permiso de calidad del agua pendiente que está siendo revisada por la Comisión de Calidad Ambiental de Texas según lo requerido por el Capítulo 39 del Código Administrativo de Texas 30. La información proporcionada en este resumen puede cambiar durante la revisión técnica de la solicitud y no son representaciones federales exigibles de la solicitud de permiso.

El Distrito de Servicios Públicos Municipales del Noreste del Condado de Harris No. 1, c/o Allen Boone Humphries Robinson, LLP (CN600630081) opera la EDAR MUD 1 del Noreste del Condado de Harris RN104780796 una planta de tratamiento de aguas residuales domésticas para el MUD No. 1 del Noreste del Condado de Harris. La instalación está ubicada aproximadamente a 2,050 pies al sur de la intersección de Beaumont Highway y Miller Road Number 3 en Houston, Harris County, Texas 77049.

Esta solicitud es una renovación para descargar 400,000 galones por día de aguas residuales domésticas tratadas desde el sitio de la planta en el estanque de detención de Edgewood Village, de allí a Carpenters Bayou, y de allí al segmento de marea del canal de navegación de Houston en el No. 1006 de la cuenca del río San Jacinto.

Se espera que las descargas de la instalación contengan una demanda bioquímica carbonosa de oxígeno (CBOD5), sólidos suspendidos totales (SST), nitrógeno amoniacal (NH3-N) y Escherichia coli. En la sección 7 del Informe Técnico Doméstico 1.0 se incluyen contaminantes potenciales adicionales. Análisis de Contaminantes de Efluentes Tratados y Hoja de Trabajo Doméstico 4.0 en el paquete de solicitud de permisos. Las aguas residuales domésticas se tratan después de ser bombeadas desde la estación de bombeo in situ hasta la cabecera, que consta de tres (3) cribas de barra. Desde las obras de cabecera, el flujo continúa hacia dos (2) cuencas de aireación rectangulares. El flujo de las cuencas de aireación pasa a uno de los (1) clarificadores circulares de 34 pies de diámetro. El flujo inferior del clarificador se devuelve a las obras de cabecera o se desperdicia a las dos (2) cuencas del digestor aeróbico. El efluente clarificado se pasa a dos (2) cuencas de contacto con cloro y luego se descarga en el estanque de detención de Edgewood Village, de allí a Carpenters Bayou, y de allí al segmento de marea del canal de navegación de Houston en el No. 1006 de la cuenca del río San Jacinto.

TEXAS COMMISSION ON ENVIRONMENTAL QUALITY



NOTICE OF RECEIPT OF APPLICATION AND INTENT TO OBTAIN WATER QUALITY PERMIT RENEWAL

PERMIT NO. WQ0014653001

APPLICATION. Northeast Harris County Municipal Utility District No. 1, c/o Allen Boone Humphries Robinson, LLP, 3200 Southwest Freeway, Suite 2600, Houston, Texas 77027, has applied to the Texas Commission on Environmental Quality (TCEQ) to renew Texas Pollutant Discharge Elimination System (TPDES) Permit No. WQ0014653001 (EPA I.D. No. TX0128261) to authorize the discharge of treated wastewater at a volume not to exceed a daily average flow of 400,000 gallons per day. The domestic wastewater treatment facility is located at approximately 2,050 feet south of the intersection of Beaumont Highway and Miller Road 3, near the city of Houston, in Harris County, Texas 77049. The discharge route is from the plant site to a detention pond; thence to Carpenters Bayou; thence to Houston Ship Channel Tidal. TCEQ received this application on September 16, 2024. The permit application will be available for viewing and copying at TCEQ Region 12 Office, reception area, 5425 Polk Street, Suite H, Houston, Texas prior to the date this notice is published in the newspaper. The application, including any updates, and associated notices are available electronically at the following webpage: <https://www.tceq.texas.gov/permitting/wastewater/pending-permits/tpdes-applications>. This link to an electronic map of the site or facility's general location is provided as a public courtesy and not part of the application or notice. For the exact location, refer to the application.
<https://gisweb.tceq.texas.gov/LocationMapper/?marker=-95.164166,29.846666&level=18>

ALTERNATIVE LANGUAGE NOTICE. Alternative language notice in Spanish is available at: <https://www.tceq.texas.gov/permitting/wastewater/pending-permits/tpdes-applications>. El aviso de idioma alternativo en español está disponible en <https://www.tceq.texas.gov/permitting/wastewater/pending-permits/tpdes-applications>.

ADDITIONAL NOTICE. TCEQ's Executive Director has determined the application is administratively complete and will conduct a technical review of the application. After technical review of the application is complete, the Executive Director may prepare a draft permit and will issue a preliminary decision on the application. **Notice of the Application and Preliminary Decision will be published and mailed to those who are on the county-wide mailing list and to those who are on the mailing list for this application. That notice will contain the deadline for submitting public comments.**

PUBLIC COMMENT / PUBLIC MEETING. You may submit public comments or request a public meeting on this application. The purpose of a public meeting is to provide the opportunity to submit comments or to ask questions about the application. TCEQ will hold a

public meeting if the Executive Director determines that there is a significant degree of public interest in the application or if requested by a local legislator. A public meeting is not a contested case hearing.

OPPORTUNITY FOR A CONTESTED CASE HEARING. After the deadline for submitting public comments, the Executive Director will consider all timely comments and prepare a response to all relevant and material, or significant public comments. **Unless the application is directly referred for a contested case hearing, the response to comments, and the Executive Director's decision on the application, will be mailed to everyone who submitted public comments and to those persons who are on the mailing list for this application.** If comments are received, the mailing will also provide instructions for requesting reconsideration of the Executive Director's decision and for requesting a contested case hearing. A contested case hearing is a legal proceeding similar to a civil trial in state district court.

TO REQUEST A CONTESTED CASE HEARING, YOU MUST INCLUDE THE FOLLOWING ITEMS IN YOUR REQUEST: your name, address, phone number; applicant's name and proposed permit number; the location and distance of your property/activities relative to the proposed facility; a specific description of how you would be adversely affected by the facility in a way not common to the general public; a list of all disputed issues of fact that you submit during the comment period and, the statement "[I/we] request a contested case hearing." If the request for contested case hearing is filed on behalf of a group or association, the request must designate the group's representative for receiving future correspondence; identify by name and physical address an individual member of the group who would be adversely affected by the proposed facility or activity; provide the information discussed above regarding the affected member's location and distance from the facility or activity; explain how and why the member would be affected; and explain how the interests the group seeks to protect are relevant to the group's purpose.

Following the close of all applicable comment and request periods, the Executive Director will forward the application and any requests for reconsideration or for a contested case hearing to the TCEQ Commissioners for their consideration at a scheduled Commission meeting.

The Commission may only grant a request for a contested case hearing on issues the requestor submitted in their timely comments that were not subsequently withdrawn. **If a hearing is granted, the subject of a hearing will be limited to disputed issues of fact or mixed questions of fact and law relating to relevant and material water quality concerns submitted during the comment period.**

TCEQ may act on an application to renew a permit for discharge of wastewater without providing an opportunity for a contested case hearing if certain criteria are met.

MAILING LIST. If you submit public comments, a request for a contested case hearing or a reconsideration of the Executive Director's decision, you will be added to the mailing list for this specific application to receive future public notices mailed by the Office of the Chief Clerk. In addition, you may request to be placed on: (1) the permanent mailing list for a specific applicant name and permit number; and/or (2) the mailing list for a specific county. If you wish to be placed on the permanent and/or the county mailing list, clearly specify which list(s) and send your request to TCEQ Office of the Chief Clerk at the address below.

INFORMATION AVAILABLE ONLINE. For details about the status of the application, visit the Commissioners' Integrated Database at www.tceq.texas.gov/goto/cid. Search the database using the permit number for this application, which is provided at the top of this notice.

AGENCY CONTACTS AND INFORMATION. All public comments and requests must be submitted either electronically at <https://www14.tceq.texas.gov/epic/eComment/>, or in writing to the Texas Commission on Environmental Quality, Office of the Chief Clerk, MC-105, P.O. Box 13087, Austin, Texas 78711-3087. Please be aware that any contact information you provide, including your name, phone number, email address and physical address will become part of the agency's public record. For more information about this permit application or the permitting process, please call the TCEQ Public Education Program, Toll Free, at 1-800-687-4040 or visit their website at www.tceq.texas.gov/goto/pep. Si desea información en Español, puede llamar al 1-800-687-4040.

Further information may also be obtained from Northeast Harris County Municipal Utility District No. 1 at the address stated above or by calling Mr. Jason Hajduk, P.E., IDS Engineering Group, at 713-462-3178.

Issuance Date: December 12, 2024

Comisión de Calidad Ambiental del Estado de Texas



AVISO DE RECIBO DE LA SOLICITUD Y EL INTENTO DE OBTENER PERMISO PARA LA CALIDAD DEL AGUA RENOVACION

PERMISO NO. WQ0014653001

SOLICITUD. Northeast Harris County Municipal Utility District No. 1, c/o Allen Boone Humphries Robinson, LLP, 3200 Southwest Freeway, Suite 2600, Houston, Texas 77027, ha solicitado a la Comisión de Calidad Ambiental del Estado de Texas (TCEQ) para renovar el Permiso No. WQ0014653001 (EPA I.D. No. TX0128261) del Sistema de Eliminación de Descargas de Contaminantes de Texas (TPDES) para autorizar la descarga de aguas residuales tratadas en un volumen que no sobrepasa un flujo promedio diario de 400,000 galones por día. La planta está ubicada aproximadamente 2,050 pies al sur de la intersección de Beaumont Highway y Miller Road Número 3, cerca de la ciudad de Houston, en el condado de Harris, Texas, 77049. La ruta de descarga es del sitio de la planta a descargado a un estanque de detención, de allí al pantano de Carpenters, de allí a Houston Ship Channel Tidal. La TCEQ recibió esta solicitud el 16 de septiembre de 2024. La solicitud para el permiso está disponible para leerla y copiarla en Oficina de la Región 12 de TCEQ, área de recepción, 5425 Polk Street, Suite H, Houston, Texas. La solicitud (cualquier actualización y aviso inclusive) está disponible electrónicamente en la siguiente página web:

<https://www.tceq.texas.gov/permitting/wastewater/pending-permits/tpdes-applications>. Este enlace a un mapa electrónico de la ubicación general del sitio o de la instalación es proporcionado como una cortesía y no es parte de la solicitud o del aviso. Para la ubicación exacta, consulte la solicitud.

<https://gisweb.tceq.texas.gov/LocationMapper/?marker=-95.164166,29.846666&level=18>

AVISO ADICIONAL. El Director Ejecutivo de la TCEQ ha determinado que la solicitud es administrativamente completa y conducirá una revisión técnica de la solicitud. Después de completar la revisión técnica, el Director Ejecutivo puede preparar un borrador del permiso y emitirá una Decisión Preliminar sobre la solicitud. **El aviso de la solicitud y la decisión preliminar serán publicados y enviado a los que están en la lista de correo de las personas a lo largo del condado que desean recibir los avisos y los que están en la lista de correo que desean recibir avisos de esta solicitud. El aviso dará la fecha límite para someter comentarios públicos.**

COMENTARIO PUBLICO / REUNION PUBLICA. Usted puede presentar comentarios públicos o pedir una reunión pública sobre esta solicitud. El propósito de una reunión pública es dar la oportunidad de presentar comentarios o hacer preguntas acerca de la solicitud. La TCEQ realiza una reunión pública si el Director Ejecutivo determina que hay un grado de interés público suficiente en la solicitud o si un legislador local lo pide. Una reunión pública no es una audiencia administrativa de lo contencioso.

OPORTUNIDAD DE UNA AUDIENCIA ADMINISTRATIVA DE LO CONTENCIOSO. Después del plazo para presentar comentarios públicos, el Director Ejecutivo considerará todos los comentarios apropiados y preparará una respuesta a todo los comentarios públicos esenciales, pertinentes, o significativos. **A menos que la solicitud haya sido referida directamente a una audiencia administrativa de lo contencioso, la respuesta a los comentarios y la decisión del Director Ejecutivo sobre la solicitud serán enviados por correo a todos los que presentaron un comentario público y a las personas que están en la lista para recibir avisos sobre esta solicitud.** Si se reciben comentarios, el aviso también proveerá instrucciones para pedir una reconsideración de la decisión del Director Ejecutivo y para pedir una audiencia administrativa de lo contencioso. Una audiencia administrativa de lo contencioso es un procedimiento legal similar a un procedimiento legal civil en un tribunal de distrito del estado.

PARA SOLICITAR UNA AUDIENCIA DE CASO IMPUGNADO, USTED DEBE INCLUIR EN SU SOLICITUD LOS SIGUIENTES DATOS: su nombre, dirección, y número de teléfono; el nombre del solicitante y número del permiso; la ubicación y distancia de su propiedad/actividad con respecto a la instalación; una descripción específica de la forma cómo usted sería afectado adversamente por el sitio de una manera no común al público en general; una lista de todas las cuestiones de hecho en disputa que usted presente durante el período de comentarios; y la declaración "[Yo/nosotros] solicito/solicitamos una audiencia de caso impugnado". Si presenta la petición para una audiencia de caso impugnado de parte de un grupo o asociación, debe identificar una persona que representa al grupo para recibir correspondencia en el futuro; identificar el nombre y la dirección de un miembro del grupo que sería afectado adversamente por la planta o la actividad propuesta; proveer la información indicada anteriormente con respecto a la ubicación del miembro afectado y su distancia de la planta o actividad propuesta; explicar cómo y porqué el miembro sería afectado; y explicar cómo los intereses que el grupo desea proteger son pertinentes al propósito del grupo.

Después del cierre de todos los períodos de comentarios y de petición que aplican, el Director Ejecutivo enviará la solicitud y cualquier petición para reconsideración o para una audiencia de caso impugnado a los Comisionados de la TCEQ para su consideración durante una reunión programada de la Comisión. La Comisión sólo puede conceder una solicitud de una audiencia de caso impugnado sobre los temas que el solicitante haya presentado en sus comentarios oportunos que no fueron

retirados posteriormente. Si se concede una audiencia, el tema de la audiencia estará limitado a cuestiones de hecho en disputa o cuestiones mixtas de hecho y de derecho relacionadas a intereses pertinentes y materiales de calidad del agua que se hayan presentado durante el período de comentarios. Si ciertos criterios se cumplen, la TCEQ puede actuar sobre una solicitud para renovar un permiso sin proveer una oportunidad de una audiencia administrativa de lo contencioso.

LISTA DE CORREO. Si somete comentarios públicos, un pedido para una audiencia administrativa de lo contencioso o una reconsideración de la decisión del Director Ejecutivo, la Oficina del Secretario Principal enviará por correo los avisos públicos en relación con la solicitud. Además, puede pedir que la TCEQ ponga su nombre en una o más de las listas de correos siguientes (1) la lista de correo permanente para recibir los avisos de el solicitante indicado por nombre y número del permiso específico y/o (2) la lista de correo de todas las solicitudes en un condado específico. Si desea que se agregue su nombre en una de las listas designe cual lista(s) y envía por correo su pedido a la Oficina del Secretario Principal de la TCEQ.

CONTACTOS E INFORMACIÓN DE LA TCEQ. Todos los comentarios escritos del público y los para pedidos una reunión deben ser presentados a la Oficina del Secretario Principal, MC 105, TCEQ, P.O. Box 13087, Austin, TX 78711-3087 o por el internet at www.tceq.texas.gov/about/comments.html. Tenga en cuenta que cualquier información personal que usted proporcione, incluyendo su nombre, número de teléfono, dirección de correo electrónico y dirección física pasarán a formar parte del registro público de la Agencia. Si necesita más información en Español sobre esta solicitud para un permiso o el proceso del permiso, por favor llame a El Programa de Educación Pública de la TCEQ, sin cobro, al 1-800-687-4040. La información general sobre la TCEQ puede ser encontrada en nuestro sitio de la red: www.tceq.texas.gov.

También se puede obtener información adicional del Northeast Harris County Municipal Utility District No. 1 a la dirección indicada arriba o llamando a Mr. Jason Hajduk, P.E., al 713-462-3178.

Fecha de emisión 12 de Diciembre de 2024.



September 13, 2024

Executive Director
Applications Review and Processing Team (MC148)
Texas Commission on Environmental Quality
12100 Park 35 Circle
Austin, Texas 78753

Reference: Northeast Harris County Municipal Utility District No. 1
Domestic Wastewater Permit Renewal Application
Permit No. WQ0014653001; IDS Project No. 1441-003-04

Executive Director:

Enclosed please find one (1) original and three (3) copies of the domestic wastewater treatment plant permit application submitted on behalf of the District.

One (1) check for the application fee in the amount of \$1,215.00 has been sent to the Texas Commission on Environmental Quality Financial Administration Division (MC 214).

Respectfully,

A handwritten signature in blue ink, appearing to read 'Jason Hajduk', is written over a faint, light blue circular watermark that contains the text 'Water Quality Applications Team'.

Jason A. Hajduk, P.E.
Senior Vice President



Enclosures

X:\1400\144100304 TPDES Renewal 2025\Eng-PM\Reports\Transmittal 2024-09-13.docx

ORIGINAL

TCEQ Domestic Wastewater Permit Application Renewal

Northeast Harris County Municipal Utility District No. 1
Permit No. WQ0014653001

IDS Project No. 1441-003-04

September 2024



9/10/24





August 12, 2024

Executive Director
Applications Review and Processing Team (MC 148)
Texas Commission on Environmental Quality
12100 Park 35 Circle
Austin, Texas 78753

Reference: Northeast Harris County MUD No. 1
Domestic Wastewater Discharge Permit Application Renewal
TPDES Permit No. WQ0014653001; EPA ID No. TX0128261
IDS Job No. 1441-003-04

Dear Sir or Madam,

Transmitted herewith please find:

One (1) Original and (3) copies of the Domestic Wastewater Treatment Plant Permit Application Renewal submitted on behalf of Northeast Harris County MUD 1.

One (1) check for the permit renewal application fee in the amount of \$1,215.00 has been sent to the TCEQ Financial Administration Division, Cashier's Office (MC 214). A copy of the check has been included within the attached package to expedite processing.

Sincerely,

A handwritten signature in blue ink, appearing to read 'J. Hajduk', is positioned above the printed name.

Jason Hajduk, P.E.
Senior Vice President

Enclosures

\\fs3\Projects\1400\144100304 TPDES Renewal 2025\TCEQ - Permit Renewal Application Transmittal Letter.doc.docx

August 12, 2024

Texas Commission on Environmental Quality
Financial Administration Division
Cashier's Office, MC-214
12100 Park 35 Circle
Austin, Texas 78753

Reference: Northeast Harris County MUD No. 1
Domestic Wastewater Discharge Permit Application Renewal
TPDES Permit No. WQ0014653001; EPA ID No. TX0128261
IDS Job No. 1441-003-04

Dear Sir or Madam,

Transmitted herewith please find:

(1) One check for the permit renewal application fee in the amount of \$1,215.00

Sincerely,



Jason Hajduk, P.E.
Senior Vice President

Enclosures

\\fs3\Projects\1400\144100303 TPDES Renewal 2025\Cover Letter for Check.docx

Table of Contents

➤ Administrative Report 1.0

➤ SPIF

➤ Technical Report 1.0

- Worksheet 2.0
- Worksheet 6.0

➤ Attachments

1	USGS 7.5' Quadrangle Map (Admin. Rpt. 1.0, 13.)
2	Description of Treatment Process (Tech. Rpt. 1.0, 2.a.)
3	Dimensions of Treatment Units (Tech. Rpt. 1.0, 2.b.)
4	Flow Diagram (Tech. Rpt. 1.0, 2.c.)
5	Site Drawing (Tech Rpt. 1.0, 3.)
6	Phase 1 and 2 Approval Letter (Tech. Rpt. 1.0, 6.a.)
7	Sludge Disposal Information (Tech. Rpt. 1.0, 9.d.)
8	Sewage Sludge Solids Management Plan (Tech. Rpt. 1.0, 12.)
9	Core Data Form (Admin. Rept. 1.0)
10	Pollutant Analysis Sample Results



TEXAS COMMISSION ON ENVIRONMENTAL QUALITY

DOMESTIC WASTEWATER PERMIT APPLICATION CHECKLIST

Complete and submit this checklist with the application.

APPLICANT NAME: Northeast Harris County MUD 1

PERMIT NUMBER (If new, leave blank): WQ00 0014653001

Indicate if each of the following items is included in your application.

	Y	N		Y	N
Administrative Report 1.0	<input checked="" type="checkbox"/>	<input type="checkbox"/>	Original USGS Map	<input checked="" type="checkbox"/>	<input type="checkbox"/>
Administrative Report 1.1	<input type="checkbox"/>	<input checked="" type="checkbox"/>	Affected Landowners Map	<input type="checkbox"/>	<input checked="" type="checkbox"/>
SPIF	<input checked="" type="checkbox"/>	<input type="checkbox"/>	Landowner Disk or Labels	<input type="checkbox"/>	<input checked="" type="checkbox"/>
Core Data Form	<input checked="" type="checkbox"/>	<input type="checkbox"/>	Buffer Zone Map	<input type="checkbox"/>	<input checked="" type="checkbox"/>
Public Involvement Plan Form	<input type="checkbox"/>	<input checked="" type="checkbox"/>	Flow Diagram	<input checked="" type="checkbox"/>	<input type="checkbox"/>
Technical Report 1.0	<input checked="" type="checkbox"/>	<input type="checkbox"/>	Site Drawing	<input checked="" type="checkbox"/>	<input type="checkbox"/>
Technical Report 1.1	<input type="checkbox"/>	<input checked="" type="checkbox"/>	Original Photographs	<input type="checkbox"/>	<input checked="" type="checkbox"/>
Worksheet 2.0	<input checked="" type="checkbox"/>	<input type="checkbox"/>	Design Calculations	<input type="checkbox"/>	<input checked="" type="checkbox"/>
Worksheet 2.1	<input type="checkbox"/>	<input checked="" type="checkbox"/>	Solids Management Plan	<input checked="" type="checkbox"/>	<input type="checkbox"/>
Worksheet 3.0	<input type="checkbox"/>	<input checked="" type="checkbox"/>	Water Balance	<input type="checkbox"/>	<input checked="" type="checkbox"/>
Worksheet 3.1	<input type="checkbox"/>	<input checked="" type="checkbox"/>			
Worksheet 3.2	<input type="checkbox"/>	<input checked="" type="checkbox"/>			
Worksheet 3.3	<input type="checkbox"/>	<input checked="" type="checkbox"/>			
Worksheet 4.0	<input type="checkbox"/>	<input checked="" type="checkbox"/>			
Worksheet 5.0	<input type="checkbox"/>	<input checked="" type="checkbox"/>			
Worksheet 6.0	<input checked="" type="checkbox"/>	<input type="checkbox"/>			
Worksheet 7.0	<input type="checkbox"/>	<input checked="" type="checkbox"/>			

For TCEQ Use Only

Segment Number _____ County _____
Expiration Date _____ Region _____
Permit Number _____



TEXAS COMMISSION ON ENVIRONMENTAL QUALITY

**DOMESTIC WASTEWATER PERMIT APPLICATION
ADMINISTRATIVE REPORT 1.0**

For any questions about this form, please contact the Applications Review and Processing Team at 512-239-4671.

Section 1. Application Fees (Instructions Page 26)

Indicate the amount submitted for the application fee (check only one).

Flow	New/Major Amendment	Renewal
<0.05 MGD	\$350.00 <input type="checkbox"/>	\$315.00 <input type="checkbox"/>
≥0.05 but <0.10 MGD	\$550.00 <input type="checkbox"/>	\$515.00 <input type="checkbox"/>
≥0.10 but <0.25 MGD	\$850.00 <input type="checkbox"/>	\$815.00 <input type="checkbox"/>
≥0.25 but <0.50 MGD	\$1,250.00 <input type="checkbox"/>	\$1,215.00 <input checked="" type="checkbox"/>
≥0.50 but <1.0 MGD	\$1,650.00 <input type="checkbox"/>	\$1,615.00 <input type="checkbox"/>
≥1.0 MGD	\$2,050.00 <input type="checkbox"/>	\$2,015.00 <input type="checkbox"/>

Minor Amendment (for any flow) \$150.00 ☐

Payment Information:

Mailed Check/Money Order Number: 220013
Check/Money Order Amount: \$1,215.00
Name Printed on Check: IDS Engineering Group

EPAY Voucher Number: N/A

Copy of Payment Voucher enclosed? Yes ☐

Section 2. Type of Application (Instructions Page 26)

a. Check the box next to the appropriate authorization type.

- ☒ Publicly-Owned Domestic Wastewater
☐ Privately-Owned Domestic Wastewater
☐ Conventional Wastewater Treatment

b. Check the box next to the appropriate facility status.

- ☒ Active ☐ Inactive

c. Check the box next to the appropriate permit type.

- ☒ TPDES Permit
☐ TLAP
☐ TPDES Permit with TLAP component
☐ Subsurface Area Drip Dispersal System (SADDS)

d. Check the box next to the appropriate application type

- ☐ New
☐ Major Amendment with Renewal
☐ Major Amendment without Renewal
☐ Renewal without changes
☐ Minor Amendment with Renewal
☐ Minor Amendment without Renewal
☒ Minor Modification of permit

e. For amendments or modifications, describe the proposed changes: Updating the current phase of the plant from Interim I to Interim II.

f. For existing permits:

Permit Number: WQ00 14653001

EPA I.D. (TPDES only): TX 0128261

Expiration Date: 03-30-2025

Section 3. Facility Owner (Applicant) and Co-Applcant Information (Instructions Page 26)

A. The owner of the facility must apply for the permit.

What is the Legal Name of the entity (applicant) applying for this permit?

Northeast Harris County MUD 1

(The legal name must be spelled exactly as filed with the Texas Secretary of State, County, or in the legal documents forming the entity.)

If the applicant is currently a customer with the TCEQ, what is the Customer Number (CN)?

You may search for your CN on the TCEQ website at <http://www15.tceq.texas.gov/crpub/>

CN: 600630081

What is the name and title of the person signing the application? The person must be an executive official meeting signatory requirements in 30 TAC § 305.44.

Prefix:

Last Name, First Name: Jim Moffatt

Title: President

Credential:

B. Co-applcant information. Complete this section only if another person or entity is required to apply as a co-permittee.

What is the Legal Name of the co-applcant applying for this permit?

N/A

(The legal name must be spelled exactly as filed with the TX SOS, with the County, or in the

legal documents forming the entity.)

If the co-applicant is currently a customer with the TCEQ, what is the Customer Number (CN)?
You may search for your CN on the TCEQ website at: <http://www15.tceq.texas.gov/crpub/>

CN: N/A

What is the name and title of the person signing the application? The person must be an executive official meeting signatory requirements in 30 TAC § 305.44.

Prefix: N/A

Last Name, First Name: N/A

Title: N/A

Credential: N/A

Provide a brief description of the need for a co-permittee: N/A

C. Core Data Form

Complete the Core Data Form for each customer and include as an attachment. If the customer type selected on the Core Data Form is **Individual**, complete **Attachment 1** of Administrative Report 1.0. 9

Section 4. Application Contact Information (Instructions Page 27)

This is the person(s) TCEQ will contact if additional information is needed about this application. Provide a contact for administrative questions and technical questions.

- A. Prefix: Last Name, First Name: Hajduk, Jason
Title: District Engineer Credential: P.E.
Organization Name: IDS Engineering Group
Mailing Address: 13430 Northwest Freeway, Suite 700 City, State, Zip Code: Houston, TX
77040
Phone No.: 713-462-3178 E-mail Address: JHajduk@idseg.com
Check one or both: ☒ Administrative Contact ☒ Technical Contact
- B. Prefix: Last Name, First Name:
Title: Credential:
Organization Name:
Mailing Address: City, State, Zip Code:
Phone No.: E-mail Address:
Check one or both: ☐ Administrative Contact ☐ Technical Contact

Section 5. Permit Contact Information (Instructions Page 27)

Provide the names and contact information for two individuals that can be contacted throughout the permit term.

- A. Prefix: Last Name, First Name: Hajduk, Jason
Title: District Engineer Credential: P.E.
Organization Name: IDS Engineering Group

Mailing Address: 13430 Northwest Freeway, Suite 700
77040

City, State, Zip Code: Houston, TX

Phone No.: 713-462-3178

E-mail Address: JHajduk@idseg.com

B. Prefix:

Last Name, First Name: Moffatt, James

Title: President

Credential:

Organization Name: Northeast Harris County MUD 1

Mailing Address: 3200 southwest Freeway, Suite 2600
77027

City, State, Zip Code: Houston, TX

Phone No.: 713-860-6400

E-mail Address:

Section 6. Billing Contact Information (Instructions Page 27)

The permittee is responsible for paying the annual fee. The annual fee will be assessed to permits ***in effect on September 1 of each year***. The TCEQ will send a bill to the address provided in this section. The permittee is responsible for terminating the permit when it is no longer needed (using form TCEQ-20029).

Prefix:

Last Name, First Name: Davenport, Derek

Title:

Credential:

Organization Name: Mclennan & Associates LP

Mailing Address: 1717 St. James Place, Suite 500

City, State, Zip Code: Houston, TX 77056

Phone No.: 281-920-4000

E-mail Address:

Section 7. DMR/MER Contact Information (Instructions Page 27)

Provide the name and complete mailing address of the person delegated to receive and submit Discharge Monitoring Reports (DMR) (EPA 3320-1) or maintain Monthly Effluent Reports (MER).

Prefix:

Last Name, First Name: Williams, Mike

Title: Operator

Credential:

Organization Name: Municipal Operations & Consulting

Mailing Address: 20141 Schiel Road

City, State, Zip Code: Cypress, TX 77433

Phone No.: 281-367-5511

E-mail Address: mwilliams@municipalops.com

Section 8. Public Notice Information (Instructions Page 27)

A. Individual Publishing the Notices

Prefix:

Last Name, First Name: Hajduk, Jason

Title: District Engineer

Credential: P.E.

Organization Name: IDS Engineering Group

Mailing Address: 13430 Northwest Fwy, Suite 700

City, State, Zip Code: Houston, TX 77040

Phone No.: 713-462-3178

E-mail Address: JHajduk@idseg.com

B. Method for Receiving Notice of Receipt and Intent to Obtain a Water Quality Permit Package

Indicate by a check mark the preferred method for receiving the first notice and instructions:

☒ E-mail Address

☐ Fax

☐ Regular Mail

C. Contact permit to be listed in the Notices

Prefix: Last Name, First Name: Hajduk, Jason

Title: District Engineer Credential: P.E.

Organization Name: IDS Engineering Group

Mailing Address: 13430 Northwest Fwy, Suite 700 City, State, Zip Code: Houston, TX 77040

Phone No.: 713-462-3178 E-mail Address: JHajduk@idseg.com

D. Public Viewing Information

If the facility or outfall is located in more than one county, a public viewing place for each county must be provided.

Public building name: TCEQ Region 12 Office

Location within the building: at reception area

Physical Address of Building: 5425 Polk, Suite H

City: Houston County: Harris

Contact (Last Name, First Name):

Phone No.: 713-767-3500 Ext.:

E. Bilingual Notice Requirements

This information is required for new, major amendment, minor amendment or minor modification, and renewal applications.

This section of the application is only used to determine if alternative language notices will be needed. Complete instructions on publishing the alternative language notices will be in your public notice package.

Please call the bilingual/ESL coordinator at the nearest elementary and middle schools and obtain the following information to determine whether an alternative language notices are required.

1. Is a bilingual education program required by the Texas Education Code at the elementary or middle school nearest to the facility or proposed facility?

☒ Yes ☐ No

If **no**, publication of an alternative language notice is not required; **skip** to Section 9 below.

2. Are the students who attend either the elementary school or the middle school enrolled in a bilingual education program at that school?

☒ Yes ☐ No

3. Do the students at these schools attend a bilingual education program at another location?

☐ Yes ☒ No

4. Would the school be required to provide a bilingual education program but the school has waived out of this requirement under 19 TAC §89.1205(g)?

☐ Yes ☒ No

5. If the answer is **yes** to **question 1, 2, 3, or 4**, public notices in an alternative language are required. Which language is required by the bilingual program?

F. Plain Language Summary Template

Complete the Plain Language Summary (TCEQ Form 20972) and include as an attachment.

Attachment:

G. Public Involvement Plan Form

Complete the Public Involvement Plan Form (TCEQ Form 20960) for each application for a **new permit or major amendment to a permit** and include as an attachment.

Attachment:

Section 9. Regulated Entity and Permitted Site Information (Instructions Page 29)

A. If the site is currently regulated by TCEQ, provide the Regulated Entity Number (RN) issued to this site. **RN 104780796**

Search the TCEQ's Central Registry at <http://www15.tceq.texas.gov/crpub/> to determine if the site is currently regulated by TCEQ.

B. Name of project or site (the name known by the community where located):

Northeast Harris County MUD 1 Wastewater Treatment Plant

C. Owner of treatment facility: Northeast Harris County MUD 1

Ownership of Facility: ☒ Public ☐ Private ☐ Both ☐ Federal

D. Owner of land where treatment facility is or will be:

Prefix: Last Name, First Name: Northeast Harris County MUD 1

Title: Credential:

Organization Name:

Mailing Address: 3200 Southeast Fwy, Suite 2600 City, State, Zip Code: Houston, TX 77027

Phone No.: 713-860-6400 E-mail Address:

If the landowner is not the same person as the facility owner or co-applicant, attach a lease agreement or deed recorded easement. See instructions.

Attachment: N/A

E. Owner of effluent disposal site:

Prefix: N/A

Last Name, First Name: N/A

Title: N/A

Credential: N/A

Organization Name: N/A

Mailing Address: N/A

City, State, Zip Code: N/A

Phone No.: N/A

E-mail Address: N/A

If the landowner is not the same person as the facility owner or co-applicant, attach a lease agreement or deed recorded easement. See instructions.

Attachment:

F. Owner sewage sludge disposal site (if authorization is requested for sludge disposal on property owned or controlled by the applicant):

Prefix: N/A

Last Name, First Name: N/A

Title: N/A

Credential: N/A

Organization Name: N/A

Mailing Address: N/A

City, State, Zip Code: N/A

Phone No.: N/A

E-mail Address: N/A

If the landowner is not the same person as the facility owner or co-applicant, attach a lease agreement or deed recorded easement. See instructions.

Attachment:

Section 10. TPDES Discharge Information (Instructions Page 31)

A. Is the wastewater treatment facility location in the existing permit accurate?

☒ Yes ☐ No

If **no**, or a new permit application, please give an accurate description:

N/A

B. Are the point(s) of discharge and the discharge route(s) in the existing permit correct?

☒ Yes ☐ No

If **no**, or a new or amendment permit application, provide an accurate description of the point of discharge and the discharge route to the nearest classified segment as defined in 30 TAC Chapter 307:

N/A

City nearest the outfall(s): City of Houston, ETJ

County in which the outfalls(s) is/are located: Harris

C. Is or will the treated wastewater discharge to a city, county, or state highway right-of-way, or a flood control district drainage ditch?

☒ Yes ☐ No

If **yes**, indicate by a check mark if:

- ☐ Authorization granted ☐ Authorization pending

For **new and amendment** applications, provide copies of letters that show proof of contact and the approval letter upon receipt.

Attachment: N/A

- D. For all applications involving an average daily discharge of 5 MGD or more, provide the names of all counties located within 100 statute miles downstream of the point(s) of discharge: N/A

Section 11. TLAP Disposal Information (Instructions Page 32)

- A. For TLAPs, is the location of the effluent disposal site in the existing permit accurate?

☒ Yes ☐ No

If **no**, or a **new or amendment permit application**, provide an accurate description of the disposal site location:

N/A

- B. City nearest the disposal site: N/A

- C. County in which the disposal site is located: N/A

- D. For TLAPs, describe the routing of effluent from the treatment facility to the disposal site:

N/A

- E. For TLAPs, please identify the nearest watercourse to the disposal site to which rainfall runoff might flow if not contained: N/A

Section 12. Miscellaneous Information (Instructions Page 32)

- A. Is the facility located on or does the treated effluent cross American Indian Land?

☐ Yes ☒ No

- B. If the existing permit contains an onsite sludge disposal authorization, is the location of the sewage sludge disposal site in the existing permit accurate?

☐ Yes ☐ No ☒ Not Applicable

If No, or if a new onsite sludge disposal authorization is being requested in this permit application, provide an accurate location description of the sewage sludge disposal site.

N/A

C. Did any person formerly employed by the TCEQ represent your company and get paid for service regarding this application?

☐ Yes ☒ No

If yes, list each person formerly employed by the TCEQ who represented your company and was paid for service regarding the application: N/A

D. Do you owe any fees to the TCEQ?

☐ Yes ☒ No

If yes, provide the following information:

Account number: N/A

Amount past due: N/A

E. Do you owe any penalties to the TCEQ?

☐ Yes ☒ No

If yes, please provide the following information:

Enforcement order number: N/A

Amount past due: N/A

Section 13. Attachments (Instructions Page 33)

Indicate which attachments are included with the Administrative Report. Check all that apply:

☐ Lease agreement or deed recorded easement, if the land where the treatment facility is located or the effluent disposal site are not owned by the applicant or co-applicant.

☒ Original full-size USGS Topographic Map with the following information:

- Applicant's property boundary
- Treatment facility boundary
- Labeled point of discharge for each discharge point (TPDES only)
- Highlighted discharge route for each discharge point (TPDES only)
- Onsite sewage sludge disposal site (if applicable)
- Effluent disposal site boundaries (TLAP only)
- New and future construction (if applicable)
- 1 mile radius information
- 3 miles downstream information (TPDES only)
- All ponds.

☐ Attachment 1 for Individuals as co-applicants

☒ Other Attachments. Please specify: Core Data Form- See Attachment

Section 14. Signature Page (Instructions Page 34)

If co-applicants are necessary, each entity must submit an original, separate signature page.

Permit Number: WQ0014653001

Applicant: Northeast Harris County MUD 1

Certification:

I certify under penalty of law that this document and all attachments were prepared under my direction or supervision in accordance with a system designed to assure that qualified personnel properly gather and evaluate the information submitted. Based on my inquiry of the person or persons who manage the system, or those persons directly responsible for gathering the information, the information submitted is, to the best of my knowledge and belief, true, accurate, and complete. I am aware there are significant penalties for submitting false information, including the possibility of fine and imprisonment for knowing violations.

I further certify that I am authorized under 30 Texas Administrative Code § 305.44 to sign and submit this document, and can provide documentation in proof of such authorization upon request.

Signatory name (typed or printed): Jim Moffatt

Signatory title: President

Signature:  Date: 9/9/2024
(Use blue ink)

Subscribed and Sworn to before me by the said JAMES MOFFATT
on this 9TH day of SEPTEMBER, 2024.
My commission expires on the 18TH day of NOVEMBER, 2024.

VONDA RILEY
Notary Public

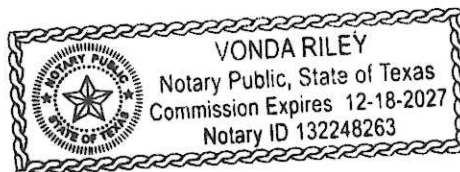

[SEAL]

HARRIS
County, Texas

DOMESTIC WASTEWATER PERMIT APPLICATION

SUPPLEMENTAL PERMIT INFORMATION FORM (SPIF)

This form applies to TPDES permit applications only. Complete and attach the Supplemental Permit information Form (SPIF) (TCEQ Form 20971).

Attachment:

TEXAS COMMISSION ON ENVIRONMENTAL QUALITY

SUPPLEMENTAL PERMIT INFORMATION FORM (SPIF)

FOR AGENCIES REVIEWING DOMESTIC OR INDUSTRIAL TPDES WASTEWATER PERMIT APPLICATIONS

TCEQ USE ONLY:

Application type: ____Renewal ____Major Amendment ____Minor Amendment ____New

County: _____ Segment Number: _____

Admin Complete Date: _____

Agency Receiving SPIF:

____ Texas Historical Commission _____ U.S. Fish and Wildlife

____ Texas Parks and Wildlife Department _____ U.S. Army Corps of Engineers

This form applies to TPDES permit applications only. (Instructions, Page 53)

Complete this form as a separate document. TCEQ will mail a copy to each agency as required by our agreement with EPA. If any of the items are not completely addressed or further information is needed, we will contact you to provide the information before issuing the permit. Address each item completely.

Do not refer to your response to any item in the permit application form. Provide each attachment for this form separately from the Administrative Report of the application. The application will not be declared administratively complete without this SPIF form being completed in its entirety including all attachments. Questions or comments concerning this form may be directed to the Water Quality Division's Application Review and Processing Team by email at WQ-ARPTeam@tceq.texas.gov or by phone at (512) 239-4671.

The following applies to all applications:

1. Permittee: Northeast Harris County MUD 1

Permit No. WQ00 14653001

EPA ID No. TX 0128261

Address of the project (or a location description that includes street/highway, city/vicinity, and county):

14998 1/2 Beaumont Hwy, Houston TX 77049; Approximately 1600 ft southeast of the intersection of Carpenter's Bayou and Beaumont Highway and then east of the West Canal approximately 3400 feet north right-of-way of U.S. Highway No. 90. Houston-Harris County, TX.

Provide the name, address, phone and fax number of an individual that can be contacted to answer specific questions about the property.

Prefix (Mr., Ms., Miss):

First and Last Name: Jason Hajduk

Credential (P.E, P.G., Ph.D., etc.): P.E.

Title: District Engineer

Mailing Address: 13430 Northwest Fwy, Suite 700

City, State, Zip Code: Houston, TX 77040

Phone No.: 713-462-3178 Ext.: Fax No.:

E-mail Address: JHajduk@idseg.com

2. List the county in which the facility is located: Harris
3. If the property is publicly owned and the owner is different than the permittee/applicant, please list the owner of the property.

N/A

4. Provide a description of the effluent discharge route. The discharge route must follow the flow of effluent from the point of discharge to the nearest major watercourse (from the point of discharge to a classified segment as defined in 30 TAC Chapter 307). If known, please identify the classified segment number.

A point located along the Edgewood Village Detention basin approximately 1600 feet southeast of the intersection of Carpenter's Bayou and Beaumont Highway, thence following east into carpenter's Bayou, Segment No. 1006 B.

5. Please provide a separate 7.5-minute USGS quadrangle map with the project boundaries plotted and a general location map showing the project area. Please highlight the discharge route from the point of discharge for a distance of one mile downstream. (This map is required in addition to the map in the administrative report).

Provide original photographs of any structures 50 years or older on the property.

Does your project involve any of the following? Check all that apply.

- ☐ Proposed access roads, utility lines, construction easements
- ☐ Visual effects that could damage or detract from a historic property's integrity
- ☐ Vibration effects during construction or as a result of project design
- ☐ Additional phases of development that are planned for the future
- ☐ Sealing caves, fractures, sinkholes, other karst features

☐ Disturbance of vegetation or wetlands

1. List proposed construction impact (surface acres to be impacted, depth of excavation, sealing of caves, or other karst features):

N/A- Construction Complete

2. Describe existing disturbances, vegetation, and land use:

Approximately 2 acres impacted with the excavation of sewer line to an approximate depth of 8 feet and power line to an approximate depth of 3 feet. Vegetative cover was removed from underneath wastewater treatment unit.

THE FOLLOWING ITEMS APPLY ONLY TO APPLICATIONS FOR NEW TPDES PERMITS AND MAJOR AMENDMENTS TO TPDES PERMITS

3. List construction dates of all buildings and structures on the property:

N/A

4. Provide a brief history of the property, and name of the architect/builder, if known.

N/A

WATER QUALITY PERMIT

PAYMENT SUBMITTAL FORM

Use this form to submit the Application Fee, if the mailing the payment.

- Complete items 1 through 5 below.
- Staple the check or money order in the space provided at the bottom of this document.
- **Do Not mail this form with the application form.**
- Do not mail this form to the same address as the application.
- Do not submit a copy of the application with this form as it could cause duplicate permit entries.

Mail this form and the check or money order to:

BY REGULAR U.S. MAIL

Texas Commission on Environmental Quality
Financial Administration Division
Cashier's Office, MC-214
P.O. Box 13088
Austin, Texas 78711-3088

BY OVERNIGHT/EXPRESS MAIL

Texas Commission on Environmental Quality
Financial Administration Division
Cashier's Office, MC-214
12100 Park 35 Circle
Austin, Texas 78753

Fee Code: WQP **Waste Permit No:** [Click to enter text.](#)

1. Check or Money Order Number: [Click to enter text.](#)
2. Check or Money Order Amount: 1,215.00
3. Date of Check or Money Order: [Click to enter text.](#)
4. Name on Check or Money Order: IDS Engineering Group
5. APPLICATION INFORMATION

Name of Project or Site: Northeast Harris County MUD 1 Wastewater Treatment Plant

Physical Address of Project or Site: 14998 1/2 Beaumont Hwy, Houston TX 77049

If the check is for more than one application, attach a list which includes the name of each Project or Site (RE) and Physical Address, exactly as provided on the application.

Staple Check or Money Order in This Space

ATTACHMENT 1

INDIVIDUAL INFORMATION

Section 1. Individual Information (Instructions Page 41)

Complete this attachment if the facility applicant or co-applicant is an individual. Make additional copies of this attachment if both are individuals.

Prefix (Mr., Ms., Miss):

Full legal name (Last Name, First Name, Middle Initial):

Driver's License or State Identification Number:

Date of Birth:

Mailing Address:

City, State, and Zip Code:

Phone Number: Fax Number:

E-mail Address:

CN:

For Commission Use Only:

Customer Number:

Regulated Entity Number:

Permit Number:

DOMESTIC WASTEWATER PERMIT APPLICATION CHECKLIST OF COMMON DEFICIENCIES

Below is a list of common deficiencies found during the administrative review of domestic wastewater permit applications. To ensure the timely processing of this application, please review the items below and indicate by checking Yes that each item is complete and in accordance applicable rules at 30 TAC Chapters 21, 281, and 305. If an item is not required this application, indicate by checking N/A where appropriate. Please do not submit the application until the items below have been addressed.

Core Data Form (TCEQ Form No. 10400) ☒ Yes
(Required for all application types. Must be completed in its entirety and signed.
Note: Form may be signed by applicant representative.)

Correct and Current Industrial Wastewater Permit Application Forms ☒ Yes
(TCEQ Form Nos. 10053 and 10054. Version dated 6/25/2018 or later.)

Water Quality Permit Payment Submittal Form (Page 19) ☒ Yes
(Original payment sent to TCEQ Revenue Section. See instructions for mailing address.)

7.5 Minute USGS Quadrangle Topographic Map Attached ☒ Yes
(Full-size map if seeking "New" permit.
8 ½ x 11 acceptable for Renewals and Amendments)

Current/Non-Expired, Executed Lease Agreement or Easement ☒ N/A ☐ Yes

Landowners Map ☒ N/A ☐ Yes
(See instructions for landowner requirements)

Things to Know:

- All the items shown on the map must be labeled.
- The applicant's complete property boundaries must be delineated which includes boundaries of contiguous property owned by the applicant.
- The applicant cannot be its own adjacent landowner. You must identify the landowners immediately adjacent to their property, regardless of how far they are from the actual facility.
- If the applicant's property is adjacent to a road, creek, or stream, the landowners on the opposite side must be identified. Although the properties are not adjacent to applicant's property boundary, they are considered potentially affected landowners. If the adjacent road is a divided highway as identified on the USGS topographic map, the applicant does not have to identify the landowners on the opposite side of the highway.

Landowners Cross Reference List ☒ N/A ☐ Yes
(See instructions for landowner requirements)

Landowners Labels or USB Drive attached ☒ N/A ☐ Yes
(See instructions for landowner requirements)

Original signature per 30 TAC § 305.44 – Blue Ink Preferred ☒ Yes
(If signature page is not signed by an elected official or principle executive officer,
a copy of signature authority/delegation letter must be attached)

Plain Language Summary ☒ Yes



TEXAS COMMISSION ON ENVIRONMENTAL QUALITY

DOMESTIC WASTEWATER PERMIT APPLICATION TECHNICAL REPORT 1.0

For any questions about this form, please contact the Domestic Wastewater Permitting Team at 512-239-4671.

The following information is required for all renewal, new, and amendment applications.

Section 1. Permitted or Proposed Flows (Instructions Page 43)

A. Existing/Interim I Phase

Design Flow (MGD): 0.100

2-Hr Peak Flow (MGD): 0.400

Estimated construction start date: N/A

Estimated waste disposal start date: N/A

B. Interim II Phase

Design Flow (MGD): 0.250

2-Hr Peak Flow (MGD): 1.000

Estimated construction start date: N/A

Estimated waste disposal start date: N/A

C. Final Phase

Design Flow (MGD): 0.400

2-Hr Peak Flow (MGD): 1.600

Estimated construction start date: Fall 2026

Estimated waste disposal start date: Fall 2026

D. Current Operating Phase

Provide the startup date of the facility: October 15, 2022

Section 2. Treatment Process (Instructions Page 43)

A. Current Operating Phase

Provide a detailed description of the treatment process. **Include the type of treatment plant, mode of operation, and all treatment units.** Start with the plant's head works and

finish with the point of discharge. Include all sludge processing and drying units. **If more than one phase exists or is proposed, a description of *each phase* must be provided.**

See attachment No. 2

B. Treatment Units

In Table 1.0(1), provide the treatment unit type, the number of units, and dimensions (length, width, depth) of **each treatment unit, accounting for *all* phases of operation.**

Table 1.0(1) - Treatment Units

Treatment Unit Type	Number of Units	Dimensions (L x W x D)
See Attachment No.3		

C. Process Flow Diagram

Provide flow diagrams for the existing facilities and **each** proposed phase of construction.

Attachment: 4

Section 3. Site Information and Drawing (Instructions Page 44)

Provide the TPDES discharge outfall latitude and longitude. Enter N/A if not applicable.

- Latitude: 29.847085
- Longitude: -95.164345

Provide the TLAP disposal site latitude and longitude. Enter N/A if not applicable.

- Latitude: 29.847573
- Longitude: -95.163717

Provide a site drawing for the facility that shows the following:

- The boundaries of the treatment facility;
- The boundaries of the area served by the treatment facility;
- If land disposal of effluent, the boundaries of the disposal site and all storage/holding ponds; and
- If sludge disposal is authorized in the permit, the boundaries of the land application or disposal site.

Attachment: 5

Provide the name **and** a description of the area served by the treatment facility.

Northeast Harris County Municipal Utility District No.1

Collection System Information **for wastewater TPDES permits only**: Provide information for each **uniquely owned** collection system, existing and new, served by this facility, including satellite collection systems. **Please see the instructions for a detailed explanation and examples.**

Collection System Information

Collection System Name	Owner Name	Owner Type	Population Served
		Choose an item.	
		Choose an item.	
		Choose an item.	
		Choose an item.	

Section 4. Unbuilt Phases (Instructions Page 45)

Is the application for a renewal of a permit that contains an unbuilt phase or phases?

☒ Yes ☐ No

If **yes**, does the existing permit contain a phase that has not been constructed **within five years** of being authorized by the TCEQ?

☒ Yes ☐ No

If **yes**, provide a detailed discussion regarding the continued need for the unbuilt phase. **Failure to provide sufficient justification may result in the Executive Director recommending denial of the unbuilt phase or phases.**

Slow down in the economy has not required the expansion at this time. Plant expansion will be needed for future developments.

Section 5. Closure Plans (Instructions Page 45)

Have any treatment units been taken out of service permanently, or will any units be taken out of service in the next five years?

☐ Yes ☒ No

If **yes**, was a closure plan submitted to the TCEQ?

☐ Yes ☐ No

If yes, provide a brief description of the closure and the date of plan approval.

N/A

Section 6. Permit Specific Requirements (Instructions Page 45)

For applicants with an existing permit, check the Other Requirements or Special Provisions of the permit.

A. Summary transmittal

Have plans and specifications been approved for the existing facilities and each proposed phase?

☒ Yes ☐ No

If yes, provide the date(s) of approval for each phase: Phase 1: June 14, 2007, Phase 2: June 25, 2020

Provide information, including dates, on any actions taken to meet a *requirement or provision* pertaining to the submission of a summary transmittal letter. **Provide a copy of an approval letter from the TCEQ, if applicable.**

See Attachment No.6

B. Buffer zones

Have the buffer zone requirements been met?

☒ Yes ☐ No

Provide information below, including dates, on any actions taken to meet the conditions of the buffer zone. If available, provide any new documentation relevant to maintaining the buffer zones.

On March 28, 2011 TCEQ issued a conditional approval for the Odor Nuisance Prevention Plan that was submitted by the permittee on March 16, 2011

C. Other actions required by the current permit

Does the *Other Requirements* or *Special Provisions* section in the existing permit require submission of any other information or other required actions? Examples include Notification of Completion, progress reports, soil monitoring data, etc.

☒ Yes ☐ No

If **yes**, provide information below on the status of any actions taken to meet the conditions of an *Other Requirement* or *Special Provision*.

Provide Notification of completion Form 20007 prior to completion of Final Phase.

D. Grit and grease treatment

1. *Acceptance of grit and grease waste*

Does the facility have a grit and/or grease processing facility onsite that treats and decants or accepts transported loads of grit and grease waste that are discharged directly to the wastewater treatment plant prior to any treatment?

☐ Yes ☒ No

If **No**, stop here and continue with Subsection E. Stormwater Management.

2. *Grit and grease processing*

Describe below how the grit and grease waste is treated at the facility. In your description, include how and where the grit and grease is introduced to the treatment works and how it is separated or processed. Provide a flow diagram showing how grit and grease is processed at the facility.

N/A

3. *Grit disposal*

Does the facility have a Municipal Solid Waste (MSW) registration or permit for grit disposal?

☐ Yes ☒ No

If **No**, contact the TCEQ Municipal Solid Waste team at 512-239-2335. Note: A registration or permit is required for grit disposal. Grit shall not be combined with treatment plant sludge. See the instruction booklet for additional information on grit disposal requirements and restrictions.

Describe the method of grit disposal.

N/A

4. Grease and decanted liquid disposal

Note: A registration or permit is required for grease disposal. Grease shall not be combined with treatment plant sludge. For more information, contact the TCEQ Municipal Solid Waste team at 512-239-2335.

Describe how the decant and grease are treated and disposed of after grit separation.

N/A

E. Stormwater management

1. Applicability

Does the facility have a design flow of 1.0 MGD or greater in any phase?

☐ Yes ☒ No

Does the facility have an approved pretreatment program, under 40 CFR Part 403?

☐ Yes ☒ No

If no to both of the above, then skip to Subsection F, Other Wastes Received.

2. MSGP coverage

Is the stormwater runoff from the WWTP and dedicated lands for sewage disposal currently permitted under the TPDES Multi-Sector General Permit (MSGP), TXR050000?

☐ Yes ☒ No

If yes, please provide MSGP Authorization Number and skip to Subsection F, Other Wastes Received:

TXR05 or TXRNE

If no, do you intend to seek coverage under TXR050000?

☐ Yes ☒ No

3. Conditional exclusion

Alternatively, do you intend to apply for a conditional exclusion from permitting based TXR050000 (Multi Sector General Permit) Part II B.2 or TXR050000 (Multi Sector General Permit) Part V, Sector T 3(b)?

☐ Yes ☒ No

If yes, please explain below then proceed to Subsection F, Other Wastes Received:

N/A

4. Existing coverage in individual permit

Is your stormwater discharge currently permitted through this individual TPDES or TLAP permit?

☐ Yes ☒ No

If yes, provide a description of stormwater runoff management practices at the site that are authorized in the wastewater permit then skip to Subsection F, Other Wastes Received.

N/A

5. Zero stormwater discharge

Do you intend to have no discharge of stormwater via use of evaporation or other means?

☐ Yes ☒ No

If yes, explain below then skip to Subsection F. Other Wastes Received.

N/A

Note: If there is a potential to discharge any stormwater to surface water in the state as the result of any storm event, then permit coverage is required under the MSGP or an individual discharge permit. This requirement applies to all areas of facilities with treatment plants or systems that treat, store, recycle, or reclaim domestic sewage, wastewater or sewage sludge (including dedicated lands for sewage sludge disposal located within the onsite property boundaries) that meet the applicability criteria of above. You have the option of obtaining coverage under the MSGP for direct discharges, (recommended), or obtaining coverage under this individual permit.

6. Request for coverage in individual permit

Are you requesting coverage of stormwater discharges associated with your treatment plant under this individual permit?

☐ Yes ☒ No

If yes, provide a description of stormwater runoff management practices at the site for which you are requesting authorization in this individual wastewater permit and describe whether you intend to comingle this discharge with your treated effluent or discharge it via a separate dedicated stormwater outfall. Please also indicate if you

intend to divert stormwater to the treatment plant headworks and indirectly discharge it to water in the state.

N/A

Note: Direct stormwater discharges to waters in the state authorized through this individual permit will require the development and implementation of a stormwater pollution prevention plan (SWPPP) and will be subject to additional monitoring and reporting requirements. Indirect discharges of stormwater via headworks recycling will require compliance with all individual permit requirements including 2-hour peak flow limitations. All stormwater discharge authorization requests will require additional information during the technical review of your application.

F. Discharges to the Lake Houston Watershed

Does the facility discharge in the Lake Houston watershed?

☒ Yes ☐ No

If yes, attach a Sewage Sludge Solids Management Plan. See Example 5 in the instructions. See [Attachment No. 8](#)

G. Other wastes received including sludge from other WWTPs and septic waste

1. Acceptance of sludge from other WWTPs

Does or will the facility accept sludge from other treatment plants at the facility site?

☐ Yes ☒ No

If yes, attach sewage sludge solids management plan. See Example 5 of instructions.

In addition, provide the date the plant started or is anticipated to start accepting sludge, an estimate of monthly sludge acceptance (gallons or millions of gallons), an estimate of the BOD₅ concentration of the sludge, and the design BOD₅ concentration of the influent from the collection system. Also note if this information has or has not changed since the last permit action.

N/A

Note: Permits that accept sludge from other wastewater treatment plants may be required to have influent flow and organic loading monitoring.

2. Acceptance of septic waste

Is the facility accepting or will it accept septic waste?

☐ Yes ☒ No

If yes, does the facility have a Type V processing unit?

☐ Yes ☐ No

If yes, does the unit have a Municipal Solid Waste permit?

☐ Yes ☐ No

If **yes to any of the above**, provide the date the plant started or is anticipated to start accepting septic waste, an estimate of monthly septic waste acceptance (gallons or millions of gallons), an estimate of the BOD₅ concentration of the septic waste, and the design BOD₅ concentration of the influent from the collection system. Also note if this information has or has not changed since the last permit action.

N/A

Note: Permits that accept sludge from other wastewater treatment plants may be required to have influent flow and organic loading monitoring.

3. Acceptance of other wastes (not including septic, grease, grit, or RCRA, CERCLA or as discharged by IUs listed in Worksheet 6)

Is or will the facility accept wastes that are not domestic in nature excluding the categories listed above?

☐ Yes ☒ No

If **yes**, provide the date that the plant started accepting the waste, an estimate how much waste is accepted on a monthly basis (gallons or millions of gallons), a description of the entities generating the waste, and any distinguishing chemical or other physical characteristic of the waste. Also note if this information has or has not changed since the last permit action.

N/A

Section 7. Pollutant Analysis of Treated Effluent (Instructions Page 50)

Is the facility in operation?

☒ Yes ☐ No

If **no**, this section is not applicable. Proceed to Section 8.

If **yes**, provide effluent analysis data for the listed pollutants. **Wastewater treatment facilities** complete Table 1.0(2). **Water treatment facilities** discharging filter backwash water, complete Table 1.0(3). Provide copies of the laboratory results sheets. **These tables are not applicable for a minor amendment without renewal.** See the instructions for guidance.

Note: The sample date must be within 1 year of application submission.

Table1.0(2) – Pollutant Analysis for Wastewater Treatment Facilities

Pollutant	Average Conc.	Max Conc.	No. of Samples	Sample Type	Sample Date/Time
CBOD ₅ , mg/l	<2.0	<2.0	1	Composite	06/21-9:22
Total Suspended Solids, mg/l	<1.00	<1.00	1	Composite	06/21-9:22
Ammonia Nitrogen, mg/l	<0.1	<0.1	1	Composite	06/21-9:22
Nitrate Nitrogen, mg/l	36.4	36.4	1	Grab	06/21-9:22
Total Kjeldahl Nitrogen, mg/l	3.9	3.9	1	Composite	06/21-9:22
Sulfate, mg/l	35.4	35.4	1	Composite	06/21-9:22
Chloride, mg/l	110	110	1	Composite	06/21-9:22
Total Phosphorus, mg/l	3.91	3.91	1	Composite	06/21-9:22
pH, standard units	8.4	8.4	1	Grab	06/7-8:17
Dissolved Oxygen*, mg/l	7.1	7.1	1	Grab	07/26-8:55
Chlorine Residual, mg/l	<0.25U	<0.25U	1	Grab	06/21-9:22
<i>E.coli</i> (CFU/100ml) freshwater	<1.00	<1.00	1	Grab	06/21-9:22
Enterococci (CFU/100ml) saltwater	<1.00	<1.00	1	Grab	06/21-9:22
Total Dissolved Solids, mg/l	570	570	1	Composite	06/21-9:22
Electrical Conductivity, μ mohs/cm, †	1178	1178	1	Composite	06/21-9:22
Oil & Grease, mg/l	<5.00	<5.00	1	Composite	06/21-9:22
Alkalinity (CaCO ₃)*, mg/l	7.8	7.8	1	Composite	06/21-9:22

*TPDES permits only

†TLAP permits only

Table1.0(3) – Pollutant Analysis for Water Treatment Facilities

Pollutant	Average Conc.	Max Conc.	No. of Samples	Sample Type	Sample Date/Time
Total Suspended Solids, mg/l					

Pollutant	Average Conc.	Max Conc.	No. of Samples	Sample Type	Sample Date/Time
Total Dissolved Solids, mg/l					
pH, standard units					
Fluoride, mg/l					
Aluminum, mg/l					
Alkalinity (CaCO ₃), mg/l					

Section 8. Facility Operator (Instructions Page 50)

Facility Operator Name: Mike Williams

Facility Operator's License Classification and Level:

Facility Operator's License Number: Cert. No. 4558384-2

Section 9. Sludge and Biosolids Management and Disposal (Instructions Page 51)

A. WWTP's Biosolids Management Facility Type

Check all that apply. See instructions for guidance

- ☐ Design flow \geq 1 MGD
- ☐ Serves \geq 10,000 people
- ☐ Class I Sludge Management Facility (per 40 CFR § 503.9)
- ☐ Biosolids generator
- ☐ Biosolids end user - land application (onsite)
- ☐ Biosolids end user - surface disposal (onsite)
- ☐ Biosolids end user - incinerator (onsite)

B. WWTP's Biosolids Treatment Process

Check all that apply. See instructions for guidance.

- ☒ Aerobic Digestion
- ☐ Air Drying (or sludge drying beds)
- ☐ Lower Temperature Composting
- ☐ Lime Stabilization
- ☐ Higher Temperature Composting
- ☐ Heat Drying
- ☐ Thermophilic Aerobic Digestion
- ☐ Beta Ray Irradiation
- ☐ Gamma Ray Irradiation
- ☐ Pasteurization

- ☐ Preliminary Operation (e.g. grinding, de-gritting, blending)
- ☐ Thickening (e.g. gravity thickening, centrifugation, filter press, vacuum filter)
- ☐ Sludge Lagoon
- ☐ Temporary Storage (< 2 years)
- ☐ Long Term Storage (>= 2 years)
- ☐ Methane or Biogas Recovery
- ☐ Other Treatment Process:

C. Biosolids Management

Provide information on the *intended* biosolids management practice. Do not enter every management practice that you want authorized in the permit, as the permit will authorize all biosolids management practices listed in the instructions. Rather indicate the management practice the facility plans to use.

Biosolids Management

Management Practice	Handler or Preparer Type	Bulk or Bag Container	Amount (dry metric tons)	Pathogen Reduction Options	Vector Attraction Reduction Option
Other (Transport)					

If "Other" is selected for Management Practice, please explain (e.g. monofill or transport to another WWTP):

D. Disposal site

Disposal site name: See attachment No. 7

TCEQ permit or registration number: See attachment No. 7

County where disposal site is located: See attachment No. 7

E. Transportation method

Method of transportation (truck, train, pipe, other): Truck

Name of the hauler: Magna Flow Environmental Inc.

Hauler registration number: 21484

Sludge is transported as a:

Liquid ☒ semi-liquid ☐ semi-solid ☐ solid ☐

Section 10. Permit Authorization for Sewage Sludge Disposal (Instructions Page 53)

A. Beneficial use authorization

Does the existing permit include authorization for land application of sewage sludge for beneficial use?

☐ Yes ☒ No

If yes, are you requesting to continue this authorization to land apply sewage sludge for beneficial use?

☐ Yes ☐ No

If yes, is the completed **Application for Permit for Beneficial Land Use of Sewage Sludge (TCEQ Form No. 10451)** attached to this permit application (see the instructions for details)?

☐ Yes ☐ No

B. Sludge processing authorization

Does the existing permit include authorization for any of the following sludge processing, storage or disposal options?

Sludge Composting	<input type="checkbox"/> Yes	<input checked="" type="checkbox"/> No
Marketing and Distribution of sludge	<input type="checkbox"/> Yes	<input checked="" type="checkbox"/> No
Sludge Surface Disposal or Sludge Monofill	<input type="checkbox"/> Yes	<input checked="" type="checkbox"/> No
Temporary storage in sludge lagoons	<input type="checkbox"/> Yes	<input checked="" type="checkbox"/> No

If yes to any of the above sludge options and the applicant is requesting to continue this authorization, is the completed **Domestic Wastewater Permit Application: Sewage Sludge Technical Report (TCEQ Form No. 10056)** attached to this permit application?

☐ Yes ☐ No

Section 11. Sewage Sludge Lagoons (Instructions Page 53)

Does this facility include sewage sludge lagoons?

☐ Yes ☒ No

If yes, complete the remainder of this section. If no, proceed to Section 12.

A. Location information

The following maps are required to be submitted as part of the application. For each map, provide the Attachment Number.

- Original General Highway (County) Map:
Attachment: N/A
- USDA Natural Resources Conservation Service Soil Map:
Attachment: N/A
- Federal Emergency Management Map:
Attachment: N/A
- Site map:
Attachment: N/A

Discuss in a description if any of the following exist within the lagoon area. Check all that apply.

- ☐ Overlap a designated 100-year frequency flood plain
- ☐ Soils with flooding classification
- ☐ Overlap an unstable area
- ☐ Wetlands
- ☐ Located less than 60 meters from a fault
- ☐ None of the above

Attachment:

If a portion of the lagoon(s) is located within the 100-year frequency flood plain, provide the protective measures to be utilized including type and size of protective structures:

N/A

B. Temporary storage information

Provide the results for the pollutant screening of sludge lagoons. These results are in addition to pollutant results in *Section 7 of Technical Report 1.0*.

Nitrate Nitrogen, mg/kg:

Total Kjeldahl Nitrogen, mg/kg:

Total Nitrogen (=nitrate nitrogen + TKN), mg/kg:

Phosphorus, mg/kg:

Potassium, mg/kg:

pH, standard units:

Ammonia Nitrogen mg/kg:

Arsenic:

Cadmium:

Chromium:

Copper:

Lead:

Mercury:

Molybdenum:

Nickel:

Selenium:

Zinc:

Total PCBs:

Provide the following information:

Volume and frequency of sludge to the lagoon(s):

Total dry tons stored in the lagoons(s) per 365-day period:

Total dry tons stored in the lagoons(s) over the life of the unit:

C. Liner information

Does the active/proposed sludge lagoon(s) have a liner with a maximum hydraulic conductivity of 1×10^{-7} cm/sec?

☐ Yes ☐ No

If yes, describe the liner below. Please note that a liner is required.

N/A

D. Site development plan

Provide a detailed description of the methods used to deposit sludge in the lagoon(s):

N/A

Attach the following documents to the application.

- Plan view and cross-section of the sludge lagoon(s)

Attachment:

- Copy of the closure plan

Attachment:

- Copy of deed recordation for the site

Attachment:

- Size of the sludge lagoon(s) in surface acres and capacity in cubic feet and gallons

Attachment:

- Description of the method of controlling infiltration of groundwater and surface water from entering the site

Attachment:

- Procedures to prevent the occurrence of nuisance conditions

Attachment:

E. Groundwater monitoring

Is groundwater monitoring currently conducted at this site, or are any wells available for groundwater monitoring, or are groundwater monitoring data otherwise available for the sludge lagoon(s)?

☐ Yes ☐ No

If groundwater monitoring data are available, provide a copy. Provide a profile of soil types encountered down to the groundwater table and the depth to the shallowest groundwater as a separate attachment.

Attachment:

Section 12. Authorizations/Compliance/Enforcement (Instructions Page 55)

A. Additional authorizations

Does the permittee have additional authorizations for this facility, such as reuse authorization, sludge permit, etc?

☐ Yes ☒ No

If yes, provide the TCEQ authorization number and description of the authorization:

N/A

B. Permittee enforcement status

Is the permittee currently under enforcement for this facility?

☐ Yes ☒ No

Is the permittee required to meet an implementation schedule for compliance or enforcement?

☐ Yes ☒ No

If yes to either question, provide a brief summary of the enforcement, the implementation schedule, and the current status:

N/A

Section 13. RCRA/CERCLA Wastes (Instructions Page 55)

A. RCRA hazardous wastes

Has the facility received in the past three years, does it currently receive, or will it receive RCRA hazardous waste?

☐ Yes ☒ No

B. Remediation activity wastewater

Has the facility received in the past three years, does it currently receive, or will it receive CERCLA wastewater, RCRA remediation/corrective action wastewater or other remediation activity wastewater?

☐ Yes ☒ No

C. Details about wastes received

If **yes** to either Subsection A or B above, provide detailed information concerning these wastes with the application.

Attachment: N/A

Section 14. Laboratory Accreditation (Instructions Page 56)

All laboratory tests performed must meet the requirements of *30 TAC Chapter 25, Environmental Testing Laboratory Accreditation and Certification*, which includes the following general exemptions from National Environmental Laboratory Accreditation Program (NELAP) certification requirements:

- The laboratory is an in-house laboratory and is:
 - periodically inspected by the TCEQ; or
 - located in another state and is accredited or inspected by that state; or
 - performing work for another company with a unit located in the same site; or
 - performing pro bono work for a governmental agency or charitable organization.
- The laboratory is accredited under federal law.
- The data are needed for emergency-response activities, and a laboratory accredited under the Texas Laboratory Accreditation Program is not available.
- The laboratory supplies data for which the TCEQ does not offer accreditation.

The applicant should review 30 TAC Chapter 25 for specific requirements.

The following certification statement shall be signed and submitted with every application. See the Signature Page section in the Instructions, for a list of designated representatives who may sign the certification.

CERTIFICATION:

I certify that all laboratory tests submitted with this application meet the requirements of *30 TAC Chapter 25, Environmental Testing Laboratory Accreditation and Certification*.

Printed Name: Jim Moffatt

Title: President

Signature: _____

Date: _____



DOMESTIC WASTEWATER PERMIT APPLICATION

WORKSHEET 2.0: RECEIVING WATERS

The following information is required for all TPDES permit applications.

Section 1. Domestic Drinking Water Supply (Instructions Page 64)

Is there a surface water intake for domestic drinking water supply located within 5 miles downstream from the point or proposed point of discharge?

☐ Yes ☒ No

If **no**, proceed to Section 2. If **yes**, provide the following:

Owner of the drinking water supply: N/A

Distance and direction to the intake: N/A

Attach a USGS map that identifies the location of the intake.

Attachment: N/A

Section 2. Discharge into Tidally Affected Waters (Instructions Page 64)

Does the facility discharge into tidally affected waters?

☐ Yes ☒ No

If **no**, proceed to Section 3. If **yes**, complete the remainder of this section. If **no**, proceed to Section 3.

A. Receiving water outfall

Width of the receiving water at the outfall, in feet: 12

B. Oyster waters

Are there oyster waters in the vicinity of the discharge?

☐ Yes ☒ No

If **yes**, provide the distance and direction from outfall(s).

N/A

C. Sea grasses

Are there any sea grasses within the vicinity of the point of discharge?

☐ Yes ☒ No

If **yes**, provide the distance and direction from the outfall(s).

N/A

Section 3. Classified Segments (Instructions Page 64)

Is the discharge directly into (or within 300 feet of) a classified segment?

☐ Yes ☒ No

If **yes**, this Worksheet is complete.

If **no**, complete Sections 4 and 5 of this Worksheet.

Section 4. Description of Immediate Receiving Waters (Instructions Page 65)

Name of the immediate receiving waters:

A. Receiving water type

Identify the appropriate description of the receiving waters.

☒ Stream

☐ Freshwater Swamp or Marsh

☐ Lake or Pond

Surface area, in acres:

Average depth of the entire water body, in feet:

Average depth of water body within a 500-foot radius of discharge point, in feet:

☐ Man-made Channel or Ditch

☐ Open Bay

☐ Tidal Stream, Bayou, or Marsh

☐ Other, specify:

B. Flow characteristics

If a stream, man-made channel or ditch was checked above, provide the following. For existing discharges, check one of the following that best characterizes the area *upstream* of the discharge. For new discharges, characterize the area *downstream* of the discharge (check one).

☐ Intermittent - dry for at least one week during most years

☐ Intermittent with Perennial Pools - enduring pools with sufficient habitat to maintain significant aquatic life uses

☒ Perennial - normally flowing

Check the method used to characterize the area upstream (or downstream for new dischargers).

☐ USGS flow records

☐ Historical observation by adjacent landowners

☐ Personal observation

☒ Other, specify: 30 TAC 307.10(4) Appendix D

C. Downstream perennial confluences

List the names of all perennial streams that join the receiving water within three miles downstream of the discharge point.

No perennial streams known that join Carpenters Bayou within three miles downstream of discharge.

D. Downstream characteristics

Do the receiving water characteristics change within three miles downstream of the discharge (e.g., natural or man-made dams, ponds, reservoirs, etc.)?

☐ Yes ☒ No

If yes, discuss how.

N/A

E. Normal dry weather characteristics

Provide general observations of the water body during normal dry weather conditions.

Water flowing half full at a width of approximately 20 feet

Date and time of observation: June 21 2024

Was the water body influenced by stormwater runoff during observations?

☐ Yes ☒ No

Section 5. General Characteristics of the Waterbody (Instructions Page 66)

A. Upstream influences

Is the immediate receiving water upstream of the discharge or proposed discharge site influenced by any of the following? Check all that apply.

- | | |
|---|---|
| <input type="checkbox"/> Oil field activities | <input type="checkbox"/> Urban runoff |
| <input type="checkbox"/> Upstream discharges | <input type="checkbox"/> Agricultural runoff |
| <input type="checkbox"/> Septic tanks | <input checked="" type="checkbox"/> Other(s), specify: <u>Sheldon Reservoir</u> |
- approximately 2600 feet upstream of discharge. No other influence known.

B. Waterbody uses

Observed or evidences of the following uses. Check all that apply.

- | | |
|--|--|
| <input type="checkbox"/> Livestock watering | <input type="checkbox"/> Contact recreation |
| <input type="checkbox"/> Irrigation withdrawal | <input type="checkbox"/> Non-contact recreation |
| <input type="checkbox"/> Fishing | <input type="checkbox"/> Navigation |
| <input type="checkbox"/> Domestic water supply | <input type="checkbox"/> Industrial water supply |
| <input type="checkbox"/> Park activities | <input checked="" type="checkbox"/> Other(s), specify: <u>None of the above uses known</u> |

C. Waterbody aesthetics

Check one of the following that best describes the aesthetics of the receiving water and the surrounding area.

- ☐ Wilderness: outstanding natural beauty; usually wooded or unpastured area; water clarity exceptional
- ☒ Natural Area: trees and/or native vegetation; some development evident (from fields, pastures, dwellings); water clarity discolored
- ☐ Common Setting: not offensive; developed but uncluttered; water may be colored or turbid
- ☐ Offensive: stream does not enhance aesthetics; cluttered; highly developed; dumping areas; water discolored

DOMESTIC WASTEWATER PERMIT APPLICATION WORKSHEET 6.0: INDUSTRIAL WASTE CONTRIBUTION

The following is required for all publicly owned treatment works.

Section 1. All POTWs (Instructions Page 89)

A. Industrial users (IUs)

Provide the number of each of the following types of industrial users (IUs) that discharge to your POTW and the daily flows from each user. See the Instructions for definitions of Categorical IUs, Significant IUs - non-categorical, and Other IUs.

If there are no users, enter 0 (zero).

Categorical IUs:

Number of IUs: None

Average Daily Flows, in MGD: 0

Significant IUs - non-categorical:

Number of IUs: None

Average Daily Flows, in MGD: 0

Other IUs:

Number of IUs: None

Average Daily Flows, in MGD: 0

B. Treatment plant interference

In the past three years, has your POTW experienced treatment plant interference (see instructions)?

☐ Yes ☒ No

If yes, identify the dates, duration, description of interference, and probable cause(s) and possible source(s) of each interference event. Include the names of the IUs that may have caused the interference.

N/A

C. Treatment plant pass through

In the past three years, has your POTW experienced pass through (see instructions)?

☐ Yes ☒ No

If **yes**, identify the dates, duration, a description of the pollutants passing through the treatment plant, and probable cause(s) and possible source(s) of each pass through event. Include the names of the IUs that may have caused pass through.

N/A

D. Pretreatment program

Does your POTW have an approved pretreatment program?

☐ Yes ☒ No

If **yes**, complete Section 2 only of this Worksheet.

Is your POTW required to develop an approved pretreatment program?

☐ Yes ☒ No

If **yes**, complete Section 2.c. and 2.d. only, and skip Section 3.

If **no to either question above**, skip Section 2 and complete Section 3 for each significant industrial user and categorical industrial user.

Section 2. POTWs with Approved Programs or Those Required to Develop a Program (Instructions Page 90)

A. Substantial modifications

Have there been any **substantial modifications** to the approved pretreatment program that have not been submitted to the TCEQ for approval according to *40 CFR §403.18*?

☐ Yes ☒ No

If **yes**, identify the modifications that have not been submitted to TCEQ, including the purpose of the modification.

N/A

B. Non-substantial modifications

Have there been any **non-substantial modifications** to the approved pretreatment program that have not been submitted to TCEQ for review and acceptance?

☐ Yes ☒ No

If yes, identify all non-substantial modifications that have not been submitted to TCEQ, including the purpose of the modification.

N/A

C. Effluent parameters above the MAL

In Table 6.0(1), list all parameters measured above the MAL in the POTW's effluent monitoring during the last three years. Submit an attachment if necessary.

Table 6.0(1) – Parameters Above the MAL

Pollutant	Concentration	MAL	Units	Date
N/A				

D. Industrial user interruptions

Has any SIU, CIU, or other IU caused or contributed to any problems (excluding interferences or pass throughs) at your POTW in the past three years?

☐ Yes ☒ No

If yes, identify the industry, describe each episode, including dates, duration, description of the problems, and probable pollutants.

N/A

Section 3. Significant Industrial User (SIU) Information and Categorical Industrial User (CIU) (Instructions Page 90)

A. General information

Company Name: N/A

SIC Code:

Contact name:

Address:

City, State, and Zip Code:

Telephone number:

Email address:

B. Process information

Describe the industrial processes or other activities that affect or contribute to the SIU(s) or CIU(s) discharge (i.e., process and non-process wastewater).

N/A

C. Product and service information

Provide a description of the principal product(s) or services performed.

N/A

D. Flow rate information

See the Instructions for definitions of “process” and “non-process wastewater.”

Process Wastewater:

Discharge, in gallons/day: N/A

Discharge Type: ☐ Continuous ☐ Batch ☐ Intermittent

Non-Process Wastewater:

Discharge, in gallons/day: N/A

Discharge Type: ☐ Continuous ☐ Batch ☐ Intermittent

E. Pretreatment standards

Is the SIU or CIU subject to technically based local limits as defined in the instructions?

☐ Yes ☐ N/A ☐ No

Is the SIU or CIU subject to categorical pretreatment standards found in *40 CFR Parts 405-471*?

☐ Yes ☐ N/A ☐ No

If subject to categorical pretreatment standards, indicate the applicable category and subcategory for each categorical process.

Category: Subcategories: N/A

Click or tap here to enter text.

Category:

Subcategories:

Category:

Subcategories:

Category:

Subcategories:

Category:

Subcategories:

F. Industrial user interruptions

Has the SIU or CIU caused or contributed to any problems (e.g., interferences, pass through, odors, corrosion, blockages) at your POTW in the past three years?

☐ Yes ☐ N/A ☐ No

If yes, identify the SIU, describe each episode, including dates, duration, description of problems, and probable pollutants.

--

Attachments

Attachment No.

- 1 USGS 7.5' Quadrangle Map (Admin. Rpt. 1.0, 13.)
- 2 Description of Treatment Process (Tech. Rpt. 1.0, 2.a.)
- 3 Dimensions of Treatment Units (Tech. Rpt. 1.0, 2.b.)
- 4 Flow Diagram (Tech. Rpt. 1.0, 2.c.)
- 5 Site Drawing (Tech Rpt. 1.0, 3.)
- 6 Phase 1 and 2 Approval Letter (Tech. Rpt. 1.0, 6.a.)
- 7 Sludge Disposal Information (Tech. Rpt. 1.0, 9.d.)
- 8 Sewage Sludge Solids Management Plan (Tech. Rpt. 1.0, 12.)
- 9 Core Data Form (Admin. Rept. 1.0)
- 10 Pollutant Analysis Sample Results

Attachment No. 1:
USGS 7.5' Quadrangle Map



JACINTO CITY QUADRANGLE
TEXAS-HARRIS CO.
7.5 MINUTE SERIES (TOPOGRAPHIC)



Produced by the United States Geological Survey
Topography copyright 1976. Flannery derived from imagery
taken 1955. Survey control based on 1976
North American Datum of 1983 (NAD 83). Projection and
1000-meter grid. Universal Transverse Mercator, zone 15
18 000-foot ticks. Zone Coordinate System of 1983
(zone 15 central meridian)
North American Datum of 1977 (NAD 77) is shown by dashed
contour lines. The center of the shift between NAD 83 and NAD 77
for 7.5-minute quadrants are obtainable from National Geodetic
Survey NADCON software

17°16' 00" 1976 MAGNETIC NORTH

SCALE 1:24 000

CONTOUR INTERVAL 5 FEET
NATIONAL GEODETIC VERTICAL DATUM OF 1929
TO CONVERT FROM FEET TO METERS, MULTIPLY BY 0.3048

THIS MAP COMPLIES WITH NATIONAL MAP ACCURACY STANDARDS
FOR SALE BY U. S. GEOLOGICAL SURVEY, P.O. BOX 35286, DENVER, COLORADO 80225
A FOLDER DESCRIBING TOPOGRAPHIC MAPS AND SYMBOLS IS AVAILABLE ON REQUEST

[illegible]

1	2	3
4		5
6	7	8

ADJOINING 1,5' SQUARES HAVE

RECEIVED
MAY 31 2000
LDS HISTORICAL MAP ARCHIVES

JACINTO CITY, TX
1995

NOMA-69437 SW-SERIES V002

NOMA-69437 SW-SERIES V002

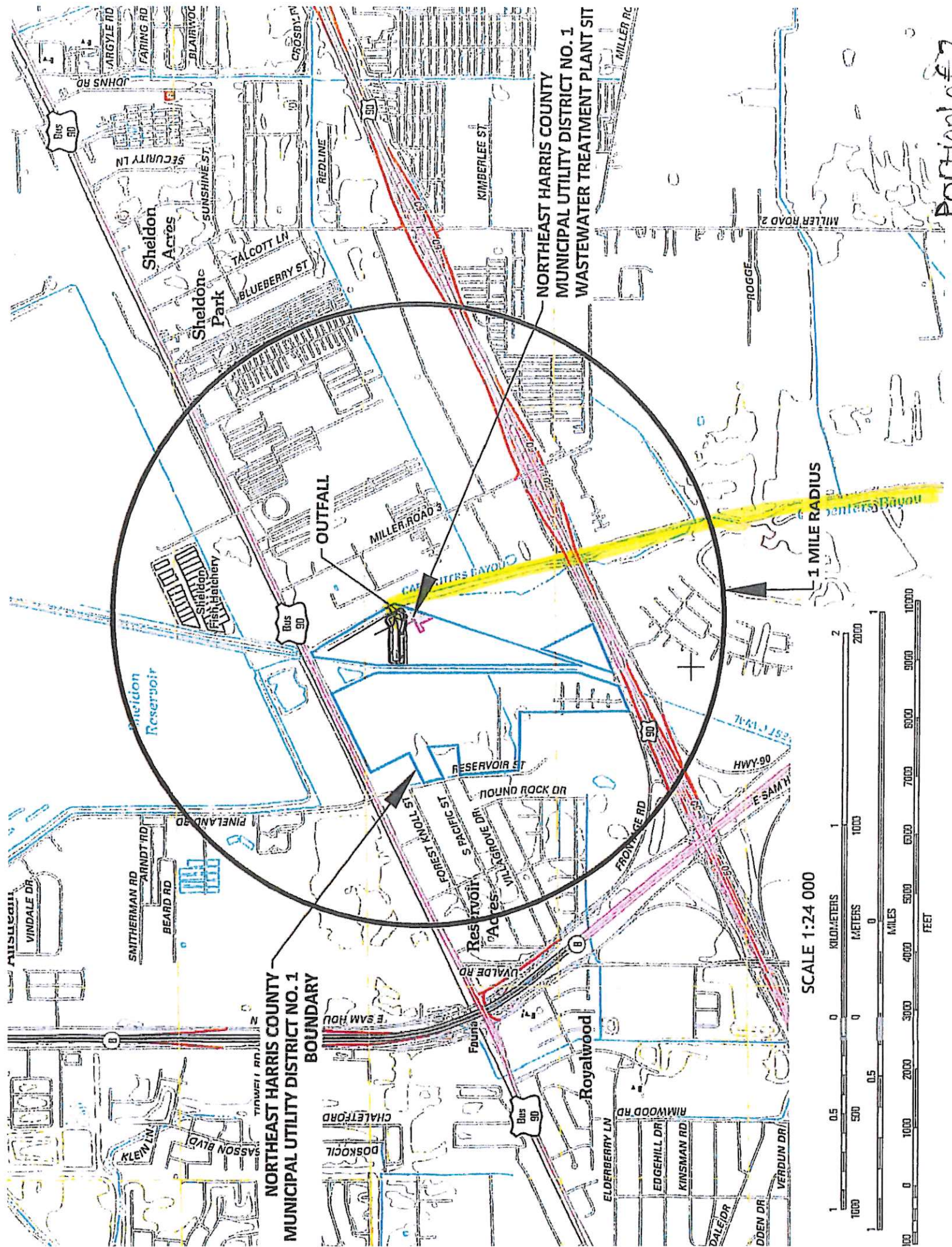

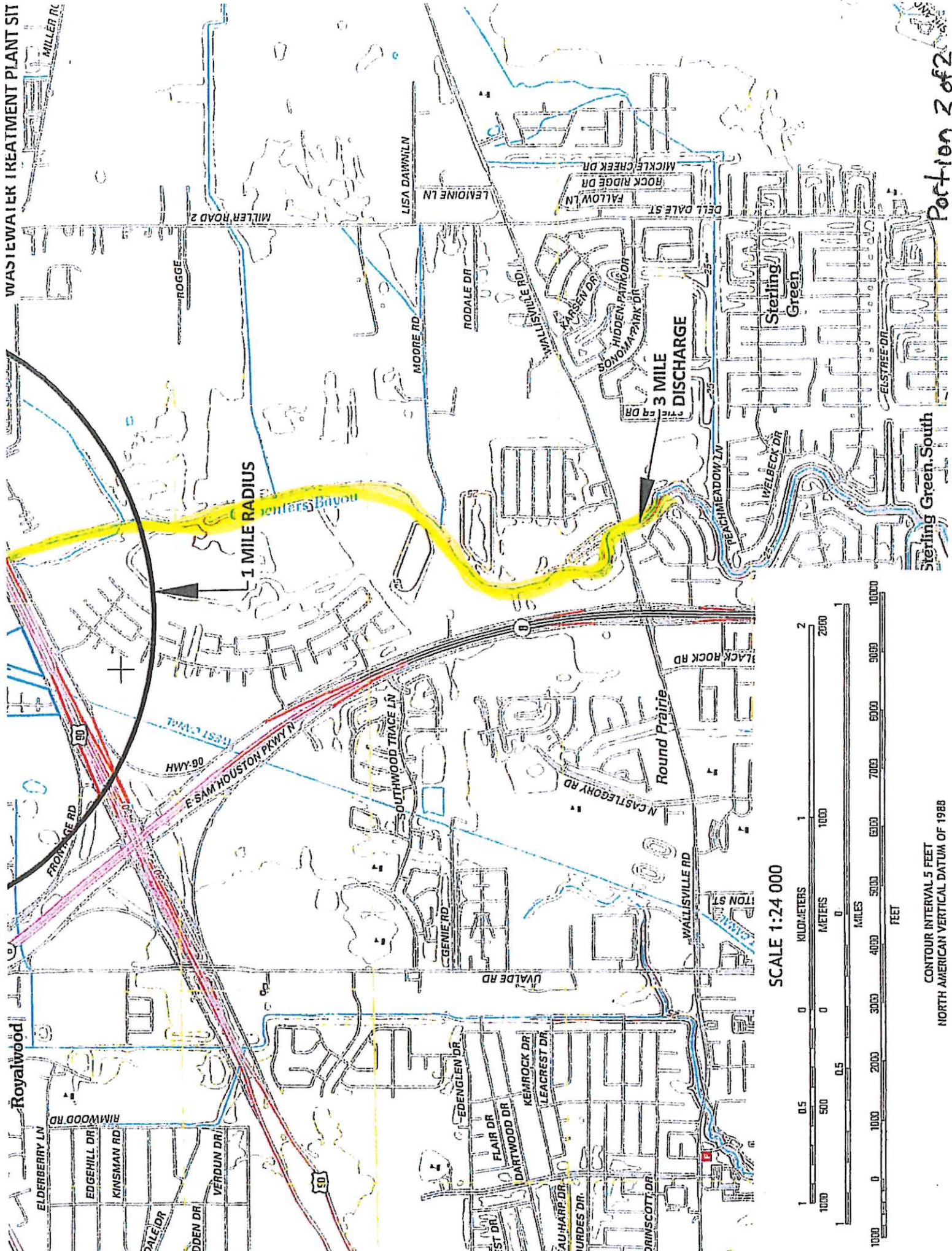

SCALE 1:24 000

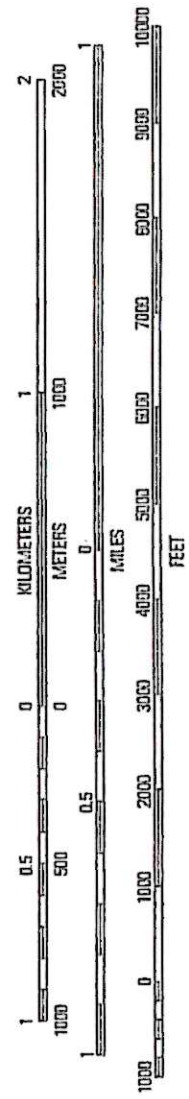

CONTOUR INTERVAL 5 FEET
NORTH AMERICAN VERTICAL DATUM OF 1988

Attachment No. 2:

**Description of Treatment Process
(Tech. Rpt. 1.0, 2.a.)**

3. Treatment Units

a. Description

Existing Interim Phase II – 0.250 MGD: The treatment process continues to be a complete mix activated sludge process with single stage nitrification. The included additional 0.150 MGD of treatment capacity that provides additional leased steel tankage for additional clarification, aeration, and digestion. This enables the plant to handle an average daily flow of 0.250 MGD with a 1.00 MGD peak flow (4Q). Plant influent is pumped from the onsite lift station to the headworks which has a manually cleaned bar screen. Flow continues from the head works into two (2) aeration basins with a total volume of 15,364 CF. Effluent from the aeration basins is channeled into one (1) 34' diameter circular clarifier having a surface area of 908 SF. The clarifier underflow is returned to the headworks or wasted into four aerobic digester basins having a total volume of 8,160 CF. Settled effluent flows from the clarifiers into two (2) chlorine contact basin having a total volume of 2,070 CF. Flow continues to exit the plant through a 18" pipe, thence into a 24" discharge pipe that transports treated effluent to a detention pond, thence into Carpenters Bayou. Sludge is disposed of by a certified contract hauler and the digester supernatant is returned to the aeration basin.

Proposed Final Phase – 0.400 MGD: The leased steel tankage will be replaced by permanent concrete structures built on the WWTP site, at which time the lease will be terminated and the steel tanks removed. The treatment process will continue to be a complete mix activated sludge process with single stage nitrification. The future expansion includes an additional 0.150 MGD of treatment capacity. This will enable the plant to handle an average daily flow of 0.400 MGD with a 1.60 MGD peak flow (4Q). From the headworks, flow continues to two (2) aeration basins (19,440 CF total). Effluent from the aeration basins is channeled into two (2) circular clarifiers (one 34 ft diameter and one 24 ft diameter) having a combined surface area of 1,360 SF. The clarifier underflow is returned to the headworks or wasted into two (2) aerobic digester basins having a total volume of 13,770 CF. Settled effluent flows from the clarifiers into a chlorine contact basin having a total volume of 3,150 CF. Flow will continue to exit the plant through a 18" pipe and thence into a 24" discharge pipe that transports treated effluent to a detention pond, thence into Carpenters Bayou. Sludge will be disposed by a certified contract hauler and the digester supernatant will be returned to the aeration basin.

Attachment No. 3:

**Dimensions of Treatment Units
(Tech. Rpt. 1.0, 2.b.)**

3. Treatment Units

c. Dimensions

	Existing Interim II Phase - 0.250 MGD						Final Phase - 0.400 MGD					
	Length (ft)	Width (ft)	Height (ft)	Diameter (ft)	Length (ft)	Width (ft)	Length (ft)	Width (ft)	Height (ft)	Diameter (ft)	Length (ft)	Width (ft)
Aeration Basin	20	12	11.5	NA	2	15	48	15	15.0	NA		
Clarifier	NA	NA	11.50	34	1	NA	NA	NA	15.00	34		
Aerobic Digestor	14	12	11.50	NA	2	17	30	17	15.00	NA		
Chlorine Contact Basin	22	11	11.50	NA	1	15	20	15	12.00	NA		

Attachment No. 4:

**Flow Diagram
(Tech. Rpt. 1.0, 2.c.)**

MODE OF TREATMENT COMPLETE MIX ACTIVATED SLUDGE WITH NITRIFICATION

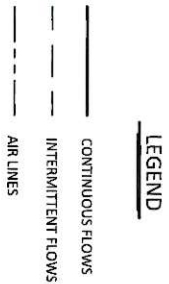
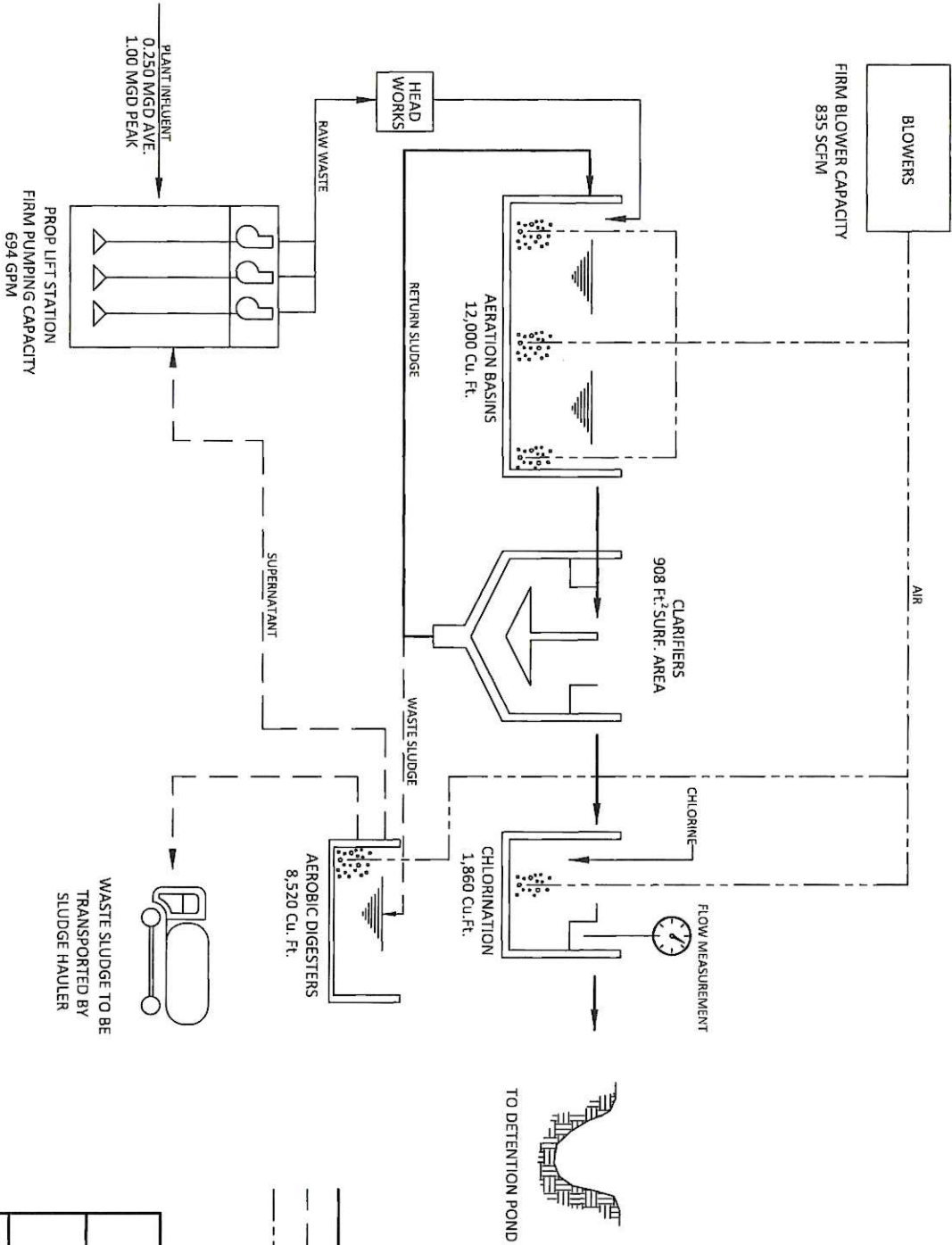

WASTEWATER TREATMENT PLANT
FOR NORTHEAST HARRIS COUNTY MUD NO 1

EXISTING II PHASE - 0.250 MGD
WWTP PROCESS FLOW DIAGRAM

IDS
Engineering Group

13333 HWY. 290
HOUSTON, TX 77060
713.462.1178

ATTACH. NO.:
1441-003-01
DATE:
JULY 2015

MODE OF TREATMENT COMPLETE MIX ACTIVATED SLUDGE WITH NITRIFICATION

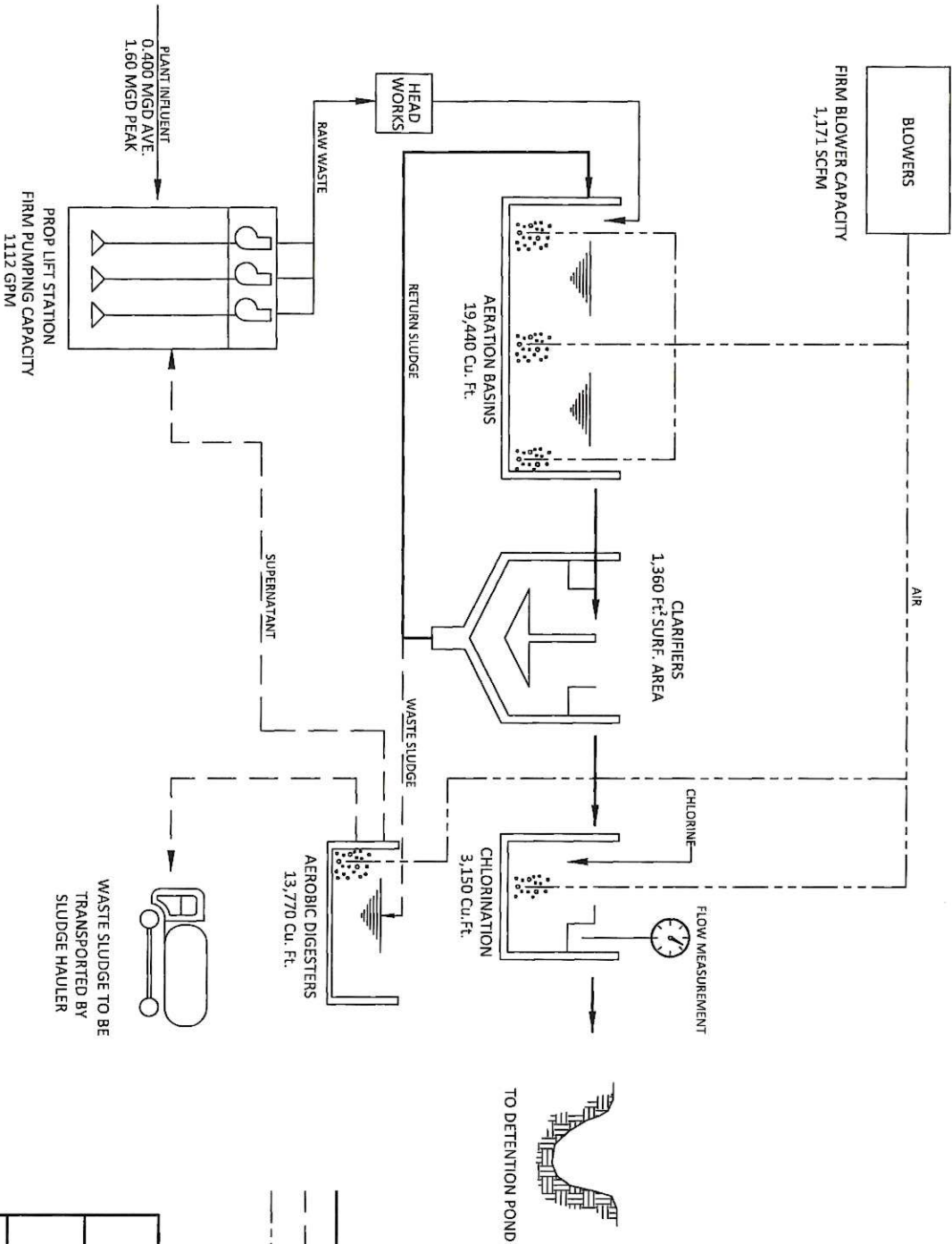

LEGEND

- CONTINUOUS FLOWS
- - - INTERMITTENT FLOWS
- - - AIR LINES

WASTEWATER TREATMENT PLANT FOR NORTHEAST HARRIS COUNTY MUD NO. 1	
FINAL PHASE - 0.400 MGD WWTP PROCESS FLOW DIAGRAM	
 13433 NW Freeway, Houston, TX 77040 713.462.3178 TPOES 144100301	ATTACH. NO.: 4 JOB NO.: 1441-003-01 DATE: JULY 2015

Attachment No. 5:

**Site Drawing
(Tech. Rpt. 1.0, 3.)**

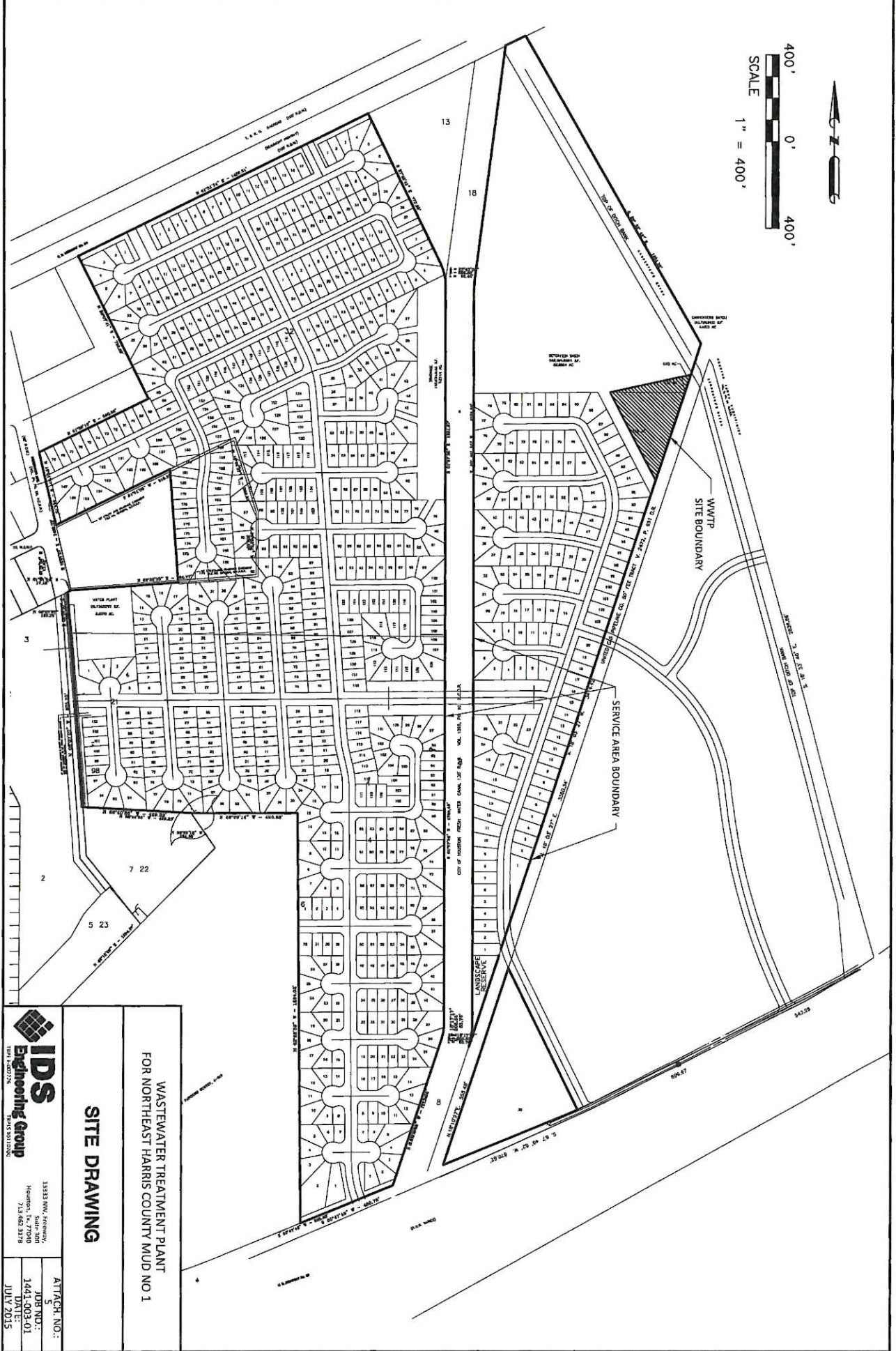

Attachment No. 6:

**Phase 1 and 2 Approval Letter
(Tech. Rpt. 1.0, 6.a.)**

Kathleen Hartnett White, *Chairman*
Larry R. Soward, *Commissioner*
H. S. Buddy Garcia, *Commissioner*
Glenn Shankle, *Executive Director*

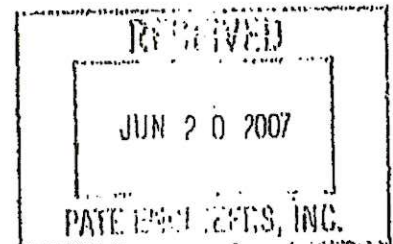

TEXAS COMMISSION ON ENVIRONMENTAL QUALITY

Protecting Texas by Reducing and Preventing Pollution

June 14, 2007

Mr. David J. Ross, P.E.
Pate Engineers, Inc.
13333 Northwest Freeway, Suite 300
Houston, Texas 77040

Re: Woodinere Development Co, L.P.
Interim (0.100 MGD) WWTP (Phase I)
Texas Commission on Environmental Quality Permit No. 14653-001
WWPR Log No. 0607/034
CN602463333 RN104780796
Harris County

Dear Mr. Ross:

We have received the project summary transmittal letter dated June 12, 2007.

The rules which regulate the design, installation and testing of domestic wastewater projects are found in 30 TAC, Chapter 317, of the Texas Commission on Environmental Quality (TCEQ) rules titled, Design Criteria for Sewerage Systems.

Section 317.1(a)(3)(D), relating to case-by-case reviews, states in part that upon submittal of a summary transmittal letter, the executive director may approve of the project without reviewing a complete set of plans and specifications.

Under the authority of §317.1(a)(3)(D) a technical review of complete plans and specifications is not required. However, the project proposed in the summary transmittal letter is approved for construction. Please note, that this conditional approval does not relieve the applicant of any responsibilities to obtain all other necessary permits or authorizations, such as wastewater treatment permit or other authorization as required by Chapter 26 of the Texas Water Code. Below are provisions of the Chapter 317 regulations, which must be met as a condition of approval. These items are provided as a reminder. If you have already met these requirements, please disregard this additional notice.

1. You must keep certain materials on file for the life of the project and provide them to TCEQ upon request. These materials include an engineering report, test results, a summary transmittal letter, and the final version of the project plans and specifications. These materials shall be prepared and sealed by a Professional Engineer licensed in the State of Texas and must show substantial compliance with Chapter 317. All plans and specifications must conform to any waste discharge requirements authorized in a permit by the TCEQ. Certain specific items which shall be addressed in the engineering report are discussed in §317.1(c)-(d). Additionally, the engineering report must include all constants, graphs, equations, and calculations needed to show substantial compliance with Chapter 317. The items which shall be included in the summary transmittal letter are addressed in §317.1(a)(3)(D).

Mr. David I. Ross, P.E.
Page 2
June 14, 2007

2. Any deviations from Chapter 317 shall be disclosed in the summary transmittal letter and the technical justifications for those deviations shall be provided in the engineering report. Any deviations from Chapter 317 shall be based on the best professional judgement of the licensed professional engineer sealing the materials and the engineer's judgement that the design would not result in a threat to public health or the environment.
3. Any variance from a Chapter 317 requirement disclosed in your summary transmittal letter is approved. If in the future, additional variances from the Chapter 317 requirements are desired for the project, each variance must be requested in writing by the design engineer. Then, the TCEQ will consider granting a written approval to the variance from the rules for the specific project and the specific circumstances.
4. Within 60 days of the completion of construction, an appointed engineer shall notify both the Wastewater Permits Section of the TCEQ and the appropriate Region Office of the date of completion. The engineer shall also provide written certification that all construction, materials, and equipment were substantially in accordance with the approved project, the rules of the TCEQ, and any change orders filed with the TCEQ. All notifications, certifications, and change orders must include the signed and dated seal of a Professional Engineer licensed in the State of Texas.

This approval does not mean that future projects will be approved without a complete plans and specifications review. The TCEQ will provide a notification of intent to review whenever a project is to undergo a complete plans and specifications review. Please be reminded of §317.1(a)(2) of the rules which states, "Approval given by the executive director...shall not relieve the sewerage system owner or the design engineer of any liabilities or responsibilities with respect to the proper design, construction, or authorized operation of the project in accordance with applicable commission rules."

If you have any questions or if we can be of any further assistance, please call me at (512) 239-4552.

Sincerely,



Louis C. Herrin, III, P.E.
Wastewater Permits Section (MC 148)
Water Quality Division
Texas Commission on Environmental Quality

LCH/jh

cc: TCEQ, Region 12 Office

Jon Niemann, *Chairman*
Emily Lindley, *Commissioner*
Bobby Janecka, *Commissioner*
Toby Baker, *Executive Director*



TEXAS COMMISSION ON ENVIRONMENTAL QUALITY

Protecting Texas by Reducing and Preventing Pollution

June 25, 2020

Kameron H. Pugh, P.E.
IDS ENGINEERING GROUP
13430 Northwest Freeway, Suite 700
Houston, TX 77040

Re: Northeast Harris County MUD 1
WWTP Ph. 2 Expansion from 0.10 MGD TO 0.25 MGD
Permit No. WQ0014653-001
WWPR Log No. 0620/080
CN600630081, RN104780796
Harris County

Dear Mr. Pugh:

TCEQ received the project summary transmittal letter dated 6/15/2020.

The rules which regulate the design, installation and testing of domestic wastewater projects are found in 30 TAC, Chapter 217, of the Texas Commission on Environmental Quality (TCEQ) rules titled, Design Criteria for Wastewater Systems.

Section 217.6(e), relating to case-by-case reviews, states in part that upon submittal of a summary transmittal letter, the executive director may approve of the project without reviewing a complete set of plans and specifications.

Under the authority of §217.6(e) a technical review of complete plans and specifications is not required. **However, the project proposed in the summary transmittal letter is approved for construction. Please note, that this conditional approval does not relieve the applicant of any responsibilities to obtain all other necessary permits or authorizations, such as wastewater treatment permit or other authorization as required by Chapter 26 of the Texas Water Code.** Below are provisions of the Chapter 217 regulations, which must be met as a condition of approval. These items are provided as a reminder. If you have already met these requirements, please disregard this additional notice.

- You must keep certain materials on file for the life of the project and provide them to TCEQ upon request. These materials include an engineering report, test results, a summary transmittal letter, and the final version of the project plans and specifications. These materials shall be prepared and sealed by a Professional Engineer licensed in the State of Texas and must show substantial compliance with Chapter 217. All plans and specifications must conform to any waste discharge requirements authorized in a permit by the TCEQ. Certain specific items which shall be addressed in the engineering report are discussed in §217.10. Additionally, the engineering report must include all constants, graphs, equations, and calculations needed to show substantial compliance with Chapter 217.

Kameron H. Pugh, P.E.
Page 2
June 25, 2020

- Any variance from a Chapter 217 requirement disclosed in your summary transmittal letter is approved. If in the future, additional variances from the Chapter 217 requirements are desired for the project, each variance must be requested in writing by the design engineer. Then, the TCEQ will consider granting a written approval to the variance from the rules for the specific project and the specific circumstances.
- Within 60 days of the completion of construction, an appointed engineer shall notify both the Wastewater Permits Section of the TCEQ and the appropriate Region Office of the date of completion. The engineer shall also provide written certification that all construction, materials, and equipment were substantially in accordance with the approved project, the rules of the TCEQ, and any change orders filed with the TCEQ. All notifications, certifications, and change orders must include the signed and dated seal of a Professional Engineer licensed in the State of Texas.

This approval does not mean that future projects will be approved without a complete plans and specifications review. The TCEQ will provide a notification of intent to review whenever a project is to undergo a complete plans and specifications review. Please be reminded of 30 TAC §217.7(a) of the rules which states, "Approval given by the executive director or other authorized review authority does not relieve an owner of any liability or responsibility with respect to designing, constructing, or operating a collection system or treatment facility in accordance with applicable commission rules and the associated wastewater permit".

If you have any questions, or if we can be of any further assistance, please call me at (512) 239-1372.

Sincerely,



Paul A. Brochi, P.E.
Wastewater Permits Section (MC 148)
Water Quality Division
Texas Commission on Environmental Quality

PAB/tc

Attachment No. 7:

**Sludge Disposal Information
(Tech. Rpt. 1.0, 9.b)**

TCEQ Permit or Registration No.	Type	Permittee Name	Facility County
730015	SLUDGE WTP	BAYTOWN AREA WATER AUTHORITY	HARRIS
730026	SLUDGE WTP	MAGNA-FLOW INTERNATIONAL INC	BRAZORIA
730035	SLUDGE WTP	CITY OF HOUSTON	HARRIS
730037	SLUDGE WTP	MAGNA-FLOW INTERNATIONAL INC	BRAZORIA
730049	SLUDGE WTP	GULF COAST WATER AUTHORITY	GALVESTON
730083	SLUDGE WTP	MAGNA-FLOW INTERNATIONAL INC	BRAZORIA
730104	SLUDGE WTP	ELLIS WALKER	WALKER
730127	SLUDGE WTP	GULF COAST WATER AUTHORITY	GALVESTON
730128	SLUDGE WTP	GULF COAST WATER AUTHORITY	GALVESTON
730159	SLUDGE WTP	LOWER NECHES VALLEY AUTHORITY	CHAMBERS
730211	SLUDGE WTP	TERRA RENEWAL SERVICES INC	WALKER
WQ0003523000	SLUDGE DISPOSAL	CITY OF HOUSTON	HARRIS
WQ0004441000	SLUDGE CLASS B	SYNAGRO OF TEXAS-CDR INC	COLORADO
WQ0004445000	SLUDGE CLASS B	K-3 RESOURCES LP	WALLER
WQ0004446000	SLUDGE CLASS B	K-3 RESOURCES LP	WALLER
WQ0004448000	SLUDGE CLASS B	K-3 RESOURCES LP	WALLER
WQ0004449000	SLUDGE CLASS B	K-3 RESOURCES LP	WALLER
WQ0004450000	SLUDGE CLASS B	K-3 RESOURCES LP	WALLER
WQ0004451000	SLUDGE CLASS B	SYNAGRO OF TEXAS-CDR INC	COLORADO
WQ0004454000	SLUDGE CLASS B	K-3 RESOURCES LP	WALLER
WQ0004456000	SLUDGE CLASS B	K-3 RESOURCES LP	HARRIS
WQ0004460000	SLUDGE CLASS B	DENALI WATER SOLUTIONS LLC	LIBERTY
WQ0004462000	SLUDGE CLASS B	TRS ENVIROGANICS INC	WALLER
WQ0004518000	SLUDGE CLASS B	K-3 RESOURCES LP	WALLER
WQ0004671000	SLUDGE CLASS B	SYNAGRO OF TEXAS-CDR INC	WHARTON
WQ0004723000	SLUDGE CLASS B	SYNAGRO OF TEXAS-CDR INC	COLORADO
WQ0004896000	SLUDGE CLASS B	BONO BROTHERS INC	FORT BEND

Attachment No. 8:

**Sewage Sludge Solids Management Plan
(Tech. Rpt. 1.0, 12.)**

SLUDGE MANAGEMENT PLAN - Proposed Northeast Harris County MUD 1 Wastewater Facility

Phase II Capacity of Digester

Design Volume	0.250	MGD Influent Flow
Minimum Retention Time	15	days
Digester Volume	10,000	ft ³
Digester Dimensions	2 @ 14' L x 12' W x 11.5' D	2 @ 20' L x 12' Wx11.5'
Digester Sludge Retention Time	40	days

CBOD5 Removal	Influent concentration	200.0	mg/l
	Effluent concentration	10.0	mg/l
	Net removal	190.0	mg/l

Solids Generated	100% Flow	75% Flow	50% Flow	25% Flow
Pounds BOD5/day removed	396	297	198	99
Pounds of dry sludge produced*	125	94	62	31
Pounds of wet sludge produced**	8,319	6,239	4,160	2,080
Volume of wet sludge produced (gal)	1,000	750	500	250
Volume of wet sludge produced (ft ³)	134	100	67	33

*Assuming 0.315 pounds of dry sludge produced per pound of BOD5 removed.

**Assuming 1.5% solids.

MLSS operating range = 3000 mg/l

The sludge is wasted from the clarifier to the aerobic digester. At the digester the sludge is further processed to achieve sludge stabilization. Some sludge from the clarifier is also returned to the aeration basins.

Removal Schedule (days)	100% Flow	75% Flow	50% Flow	25% Flow
Days between sludge removal	75	100	150	299

Following stabilization the sludge will be periodically removed from the digester and hauled offsite by a registered hauler to a registered site.

SLUDGE MANAGEMENT PLAN - Proposed Northeast Harris County MUD 1 Wastewater Facility

Final Phase Capacity of Digester

Design Volume	0.400 MGD Influent Flow
Minimum Retention Time	15 days
Digester Volume	19,440 ft ³
Digester Dimensions	2 @ 30' L x 17' W x 15' D
Digester Sludge Retention Time	40 days

CBOD5 Removal	Influent concentration	200.0 mg/l
	Effluent concentration	10.0 mg/l
	Net removal	190.0 mg/l

Solids Generated	100% Flow	75% Flow	50% Flow	25% Flow
Pounds BOD5/day removed	634	475	317	158
Pounds of dry sludge produced*	200	150	100	50
Pounds of wet sludge produced**	13,311	9,983	6,655	3,328
Volume of wet sludge produced (gal)	1,600	1,200	800	400
Volume of wet sludge produced (ft ³)	214	160	107	53

*Assuming 0.315 pounds of dry sludge produced per pound of BOD5 removed.

**Assuming 1.5% solids.

MLSS operating range = 3000 mg/l

The sludge is wasted from the clarifier to the aerobic digester. At the digester the sludge is further processed to achieve sludge stabilization. Some sludge from the clarifier is also returned to the aeration basins.

Removal Schedule (days)	100% Flow	75% Flow	50% Flow	25% Flow
Days between sludge removal	91	121	182	364

Following stabilization the sludge will be periodically removed from the digester and hauled offsite by a registered hauler to a registered site.

**Attachment No. 9:
Core Data Form
(Admin. Rept. 1.0)**



TCEQ Core Data Form

For detailed instructions on completing this form, please read the Core Data Form Instructions or call 512-239-5175.

SECTION I: General Information

1. Reason for Submission (If other is checked please describe in space provided.) <input type="checkbox"/> New Permit, Registration or Authorization (Core Data Form should be submitted with the program application.) <input type="checkbox"/> Renewal (Core Data Form should be submitted with the renewal form) <input checked="" type="checkbox"/> Other Updating the current phase of the plant.		
2. Customer Reference Number (if issued) CN 600630081	Follow this link to search for CN or RN numbers in Central Registry**	3. Regulated Entity Reference Number (if issued) RN 104780796

SECTION II: Customer Information

4. General Customer Information		5. Effective Date for Customer Information Updates (mm/dd/yyyy)	
<input type="checkbox"/> New Customer <input type="checkbox"/> Update to Customer Information <input type="checkbox"/> Change in Regulated Entity Ownership <input type="checkbox"/> Change in Legal Name (Verifiable with the Texas Secretary of State or Texas Comptroller of Public Accounts)			
<i>The Customer Name submitted here may be updated automatically based on what is current and active with the Texas Secretary of State (SOS) or Texas Comptroller of Public Accounts (CPA).</i>			
6. Customer Legal Name (If an individual, print last name first: eg: Doe, John) Northeast Harris County MUD 1		<i>If new Customer, enter previous Customer below:</i>	
7. TX SOS/CPA Filing Number N/A	8. TX State Tax ID (11 digits) N/A	9. Federal Tax ID (9 digits) N/A	10. DUNS Number (if applicable) N/A
11. Type of Customer: <input type="checkbox"/> Corporation Government: <input type="checkbox"/> City <input type="checkbox"/> County <input type="checkbox"/> Federal <input type="checkbox"/> Local <input type="checkbox"/> State <input checked="" type="checkbox"/> Other		<input type="checkbox"/> Individual <input type="checkbox"/> Sole Proprietorship	Partnership: <input type="checkbox"/> General <input type="checkbox"/> Limited <input checked="" type="checkbox"/> Other: Municipal Utility District
12. Number of Employees <input checked="" type="checkbox"/> 0-20 <input type="checkbox"/> 21-100 <input type="checkbox"/> 101-250 <input type="checkbox"/> 251-500 <input type="checkbox"/> 501 and higher		13. Independently Owned and Operated? <input type="checkbox"/> Yes <input checked="" type="checkbox"/> No	
14. Customer Role (Proposed or Actual) – as it relates to the Regulated Entity listed on this form. Please check one of the following <input checked="" type="checkbox"/> Owner <input type="checkbox"/> Operator <input type="checkbox"/> Owner & Operator <input type="checkbox"/> Other: <input type="checkbox"/> Occupational Licensee <input type="checkbox"/> Responsible Party <input type="checkbox"/> VCP/BSA Applicant			
15. Mailing Address:	3200 Southeast Fwy, Suite 2600		
	Allen Boone Humphries Robinson LLP		
	City	State	ZIP
	Houston	TX	77027
		ZIP + 4	7537
16. Country Mailing Information (if outside USA) N/A		17. E-Mail Address (if applicable) N/A	
18. Telephone Number		19. Extension or Code	20. Fax Number (if applicable)

SECTION III: Regulated Entity Information**21. General Regulated Entity Information** (If 'New Regulated Entity' is selected, a new permit application is also required.)
☐ New Regulated Entity
 ☐ Update to Regulated Entity Name
 ☐ Update to Regulated Entity Information

The Regulated Entity Name submitted may be updated, in order to meet TCEQ Core Data Standards (removal of organizational endings such as Inc, LP, or LLC).

22. Regulated Entity Name (Enter name of the site where the regulated action is taking place.)

Northeast Harris County MUD 1 Wastewater Treatment Plant

23. Street Address of the Regulated Entity:

Northeast Harris County MUD 1

(No PO Boxes)

City

State

ZIP

ZIP + 4

24. County

If no Street Address is provided, fields 25-28 are required.

25. Description to Physical Location:

The site is approx. 2,300 feet south of the intersection of Miller Rd 3 and Beaumont Highway and is approx. 300 west of Carpenters Bayou.

26. Nearest City**State****Nearest ZIP Code**

Houston

TX

77049

Latitude/Longitude are required and may be added/updated to meet TCEQ Core Data Standards. (Geocoding of the Physical Address may be used to supply coordinates where none have been provided or to gain accuracy).

27. Latitude (N) In Decimal:

29.847

28. Longitude (W) In Decimal:

-95.164

Degrees

Minutes

Seconds

Degrees

Minutes

Seconds

29

50

49.2

95

9

50.4

29. Primary SIC Code**30. Secondary SIC Code****31. Primary NAICS Code****32. Secondary NAICS Code**

(4 digits)

(4 digits)

(5 or 6 digits)

(5 or 6 digits)

33. What is the Primary Business of this entity? (Do not repeat the SIC or NAICS description.)**34. Mailing****Address:**

City

State

ZIP

ZIP + 4

35. E-Mail Address:**36. Telephone Number****37. Extension or Code****38. Fax Number** (if applicable)

() -

() -

39. TCEQ Programs and ID Numbers Check all Programs and write in the permits/registration numbers that will be affected by the updates submitted on this form. See the Core Data Form instructions for additional guidance.

<input type="checkbox"/> Dam Safety	<input type="checkbox"/> Districts	<input type="checkbox"/> Edwards Aquifer	<input type="checkbox"/> Emissions Inventory Air	<input type="checkbox"/> Industrial Hazardous Waste
<input type="checkbox"/> Municipal Solid Waste	<input type="checkbox"/> New Source Review Air	<input type="checkbox"/> OSSF	<input type="checkbox"/> Petroleum Storage Tank	<input type="checkbox"/> PWS
<input type="checkbox"/> Sludge	<input type="checkbox"/> Storm Water	<input type="checkbox"/> Title V Air	<input type="checkbox"/> Tires	<input type="checkbox"/> Used Oil
<input type="checkbox"/> Voluntary Cleanup	<input checked="" type="checkbox"/> Wastewater	<input type="checkbox"/> Wastewater Agriculture	<input type="checkbox"/> Water Rights	<input type="checkbox"/> Other:
	WQ0014653001			

SECTION IV: Preparer Information

40. Name:	Jason Hajduk			41. Title:	District Engineer
42. Telephone Number	43. Ext./Code	44. Fax Number	45. E-Mail Address		
(713) 467-3178		() -	JHajduk@idseg.com		

SECTION V: Authorized Signature

46. By my signature below, I certify, to the best of my knowledge, that the information provided in this form is true and complete, and that I have signature authority to submit this form on behalf of the entity specified in Section II, Field 6 and/or as required for the updates to the ID numbers identified in field 39.

Company:	Northeast Harris County MUD 1	Job Title:	Board President	
Name (In Print):	Jim Moffatt		Phone:	(713) 467- 3178
Signature:			Date:	9/9/2024

Attachment No. 10:

Pollutant Analysis Sample Results



P.O. Box 1089 Coldspring, Texas 77331

Website: eastexlabs.com

Email: eastexlab@eastex.net

Tel: 936 653 3249



Laboratory Analysis Report

Client: Northeast Harris County MUD 1
Municipal Operations and Consulting
20141 Schiel Road
Cypress, TX 77433

FINAL REPORT

Project ID: NE HC MUD 1 Influent
Report for: June, 2024
Customer ID: C-NHC1
Page 1 of 1

SAMPLING DATA	DATE COLLECTED	6/7/2024	6/14/2024	6/21/2024	6/28/2024	Method No.	
		6/7/2024	6/14/2024	6/21/2024	6/28/2024		
	DATE RECEIVED	6/7/2024	6/14/2024	6/21/2024	6/28/2024		
	TIME COLLECTED	8:17	9:05	9:35	10:18		
	SAMPLING POINT	Influent	Influent	Influent	Influent		
	TYPE OF SAMPLE	Grab	Grab	Grab	Grab		
	COLLECTED BY	ANM	DMP	DMP	DMZ		
	SAMPLE NUMBER	C4F2449-01	C4F4634-01	C4F6895-01	C4F9091-01	Avg	Max #/Day
FIELD DATA		6/7/2024	6/14/2024	6/21/2024	6/28/2024		
		8:17	9:05	9:35	10:18		
		ANM	DMP	DMP	DMZ		
SM 4500 H + B	pH (std unit)	8.4	8.5	8.5	8.5		

ANALYSIS DATA

Ammonia as N mg/L *A	Results	96.9	99.8	76.0	71.4	SM 4500 NH3 G	
	Analysis Date	6/13/2024 13:11	6/18/2024 17:22	6/24/2024 22:04	7/1/2024 18:29	86.0	99.8
	Analyst	AED	AED	AED	AED		
BOD 5 mg/L *A	Results	200	321	378	347	SM 5210 B	
	Analysis Date	6/7/2024 18:50	6/14/2024 18:12	6/21/2024 18:20	6/28/2024 18:19	312	378
	Analyst	MSK	MJP	MSK	MJP		
TSS mg/L *A	Results	258	338	537	3170	SM 2540 D	
	Analysis Date	6/11/2024 15:59	6/18/2024 14:34	6/25/2024 15:21	7/2/2024 15:34	1080	3170
	Analyst	KRT	SEJ	KRT	SEJ		

*NELAC Status: A=Accredited, N=Accreditation not offered, O=Not Accredited, P=Approved

C4F2449-01	Ammonia as N	31	CCB out of range.
C4F2449-01	BOD 5	1	Dilution water blank > 0.20 mg/L DO uptake.
C4F2449-01	BOD 5	53	RPD Recovery outside acceptance limits due to matrix interference.
C4F4634-01	BOD 5	1	Dilution water blank > 0.20 mg/L DO uptake.
C4F4634-01	BOD 5	13	LCS associated with sample batch outside of acceptance limits.
C4F6895-01	BOD 5	1	Dilution water blank > 0.20 mg/L DO uptake.
C4F6895-01	BOD 5	13	LCS associated with sample batch outside of acceptance limits.
C4F9091-01	BOD 5	1	Dilution water blank > 0.20 mg/L DO uptake.

Sampling and analyses are performed in accordance with EPA and TCEQ guidelines for QA. Records are available for inspection. Field tests, bacteriologicals, phenols, and oil and grease analyses are performed on grab samples; see the chain of custody for complete details. All Field Data marked "Clic" are reported at the request of our client, Eastex has no bearing on the accuracy, nor the method used in these instances. All metal analyses are performed at the Coldspring Laboratory unless otherwise indicated. Alkalinity titrated to pH 4.5 endpoint. The test results in this report relate only to the samples received and the report shall not be reproduced except in full with the approval of the laboratory.

Natalia Bondar – Wet Lab Technical Director



P.O. Box 1089 Coldspring, Texas 77331

Website: eastexlabs.com

Email: eastexlab@eastex.net

Tel: 936 653 3249



Quality Control Report

Customer: Northeast Harris County MUD 1

Project: NE HC MUD 1 Influent

Page 1 of 1

Test Units Method														
Batch	Blank	Standard		% Rec.	Note	Spike		Lab ID	Duplicate				Original	
		True	Found			% Rec.	Note		Result	Dup	RPD	Note	MRL	Order ID
Ammonia as N mg/L SM 4500 NH3 G														
B4F1874	<0.1	4.00	4.00	100	<WL	107	<WL	C4F2255-01	2.9	2.8	5.063	<WL	0.1	C4F2449-01
B4F3135	<0.1	4.00	3.90	97.6	<WL	84.6	<WL	C4F4820-01	2.4	2.5	6.575	<WL	0.1	C4F4634-01
B4F4606	<0.1	4.00	4.07	102	<WL	95.6	<WL	C4F6966-01	2.5	2.4	0.775	<WL	0.1	C4F6895-01
B4G0004	<0.1	4.00	3.87	96.7	<WL	96.6	<WL	C4F9202-01	2.4	2.4	0.041	<WL	0.1	C4F9091-01
BOD 5 mg/L SM 5210 B														
B4F1537	<2.0	198	187	94.6	<WL	---	--	C4F2276-01	243	408	50.49	>CL	2.0	C4F2449-01
B4F2986	<2.0	198	160	80.7	>CL	---	--	C4F4602-01	65.2	66.6	2.048	<WL	2.0	C4F4634-01
B4F4302	<2.0	198	165	83.2	>CL	---	--	C4F6813-01	258	218	16.65	<WL	2.0	C4F6895-01
B4F6079	<2.0	198	197	99.3	<WL	---	--	C4F9051-01	358	365	1.826	<WL	2.0	C4F9091-01
TSS mg/L SM 2540 D														
B4F1732	<1.0	---	---	---	--	---	--	C4F2407-01	50.0	54.0	7.692	<WL	1.0	C4F2449-01
B4F3234	<1.0	---	---	---	--	---	--	C4F4634-01	338	356	5.187	<WL	1.0	C4F4634-01
B4F4829	<1.0	---	---	---	--	---	--	C4F6810-01	216	220	1.834	<WL	1.0	C4F6895-01
B4G0263	<1.0	---	---	---	--	---	--	C4F9012-01	172	178	3.428	<WL	1.0	C4F9091-01

NOTE <WL is within warning limits

>WL is outside warning limits but within control limits

>CL is outside control limits



P.O. Box 1089 Coldspring Tx 77331
Website: eastexlabs.com
Email: eastexlab@eastex.net
Tel: 936 653 3249



Northeast Harris County MUD 1
Municipal Operations and Consulting
20141 Schiel Road
Cypress, TX 77433

LABORATORY ANALYTICAL REPORT

Project: NE HC MUD 1 Short PR

Sample Site:	Effluent	Sample Number:	Collector: DMP						
Sample Type:	Grab	C4F6236-01	Sampled: 06/21/2024 9:22						
Sample Matrix:	Water		Received: 06/21/2024 15:10						
Client Matrix:	Water								
Analyte	Result	Reporting Limit	Units	Nelac Status	Batch	Analyzed	Analyst	Method	Notes
pH	7.8		std unit	N	B4F5708	06/21/2024 09:22	DMP	SM 4500 H + B	
Alkalinity	220	20.0	mg CaCO ₃ /L	A	B4F4896	06/26/2024 14:37	KRH	SM 2320 B	
Ammonia as N	<0.1	0.1	mg/L	A	B4F4611	06/24/2024 22:04	AED	SM 4500 NH ₃ G	
CBOD 5	<2.0	2.0	mg/L	A	B4F4305	06/22/2024 18:50	TBB	SM 5210 B	
Chloride	110	5.0	mg/L	A	B4F4179	06/21/2024 16:40	OCR	EPA 300.0	
Conductivity	1178	10	µmhos/cm @25C	A	B4F4598	06/24/2024 14:40	ARB	SM 2510 B	
E coli IDEXX	1	1	mpn/100ml	A	B4F4656	06/21/2024 15:51	HIS	Colilert 18	
Nitrate as N	36.4	0.05	mg/L	A	B4F4179	06/21/2024 16:40	OCR	EPA 300.0	
Sulfate	35.4	4.0	mg/L	A	B4F4179	06/21/2024 16:40	OCR	EPA 300.0	
TDS	570	10.0	mg/L	A	B4F4595	06/24/2024 12:15	ARB	SM 2540 C	
TKN	3.9	1.0	mg/L	A	B4F5375	06/27/2024 08:00	CNS	EPA 351.2	13, 23, B
Total Phosphorus	3.91	0.0600	mg/L	A	B4F5636	06/28/2024 15:27	KJH	EPA 200.7	
TSS	2.6	1.0	mg/L	A	B4F4817	06/25/2024 13:38	KRT	SM 2540 D	



P.O. Box 1089 Coldspring Tx 77331
Website: eastexlabs.com
Email: eastexlab@eastex.net
Tel: 936 653 3249



Northeast Harris County MUD 1
Municipal Operations and Consulting
20141 Schiel Road
Cypress, TX 77433

EPA 300.0 - Quality Control
Eastex Environmental Laboratory - Coldspring

Analyte	Result	Reporting Limit	Units	Spike Level	Source Result	%REC	%REC Limits	RPD	RPD Limit	Notes
Batch B4F4179 - No Prep										
Blank (B4F4179-BLK1)				Prepared & Analyzed: 06/21/24						
Chloride	ND	5.0	mg/L							
Nitrate as N	ND	0.05	mg/L							
Sulfate	ND	4.0	mg/L							
LCS (B4F4179-BS1)				Prepared & Analyzed: 06/21/24						
Chloride	23.6		mg/L	25.0		94.2	90-110			
Nitrate as N	1.4639		mg/L	1.50		97.6	90-110			
Sulfate	18.8		mg/L	20.0		94.1	90-110			
Matrix Spike (B4F4179-MS1)				Source: C4F6236-01		Prepared & Analyzed: 06/21/24				
Chloride	220	5.0	mg/L	125	110	88.3	80-120			
Nitrate as N	43.8674	0.05	mg/L	7.50	36.3681	100	80-120			
Sulfate	143	4.0	mg/L	100	35.4	107	80-120			
Matrix Spike Dup (B4F4179-MSD1)				Source: C4F6236-01		Prepared & Analyzed: 06/21/24				
Chloride	220	5.0	mg/L	125	110	87.9	80-120	0.259	20	
Nitrate as N	43.7755	0.05	mg/L	7.50	36.3681	98.8	80-120	0.210	20	
Sulfate	142	4.0	mg/L	100	35.4	107	80-120	0.323	20	
Batch B4F4305 - No Prep										
Blank (B4F4305-BLK2)				Prepared & Analyzed: 06/22/24						
CBOD 5	ND	2.0	mg/L							
LCS (B4F4305-BS2)				Prepared & Analyzed: 06/22/24						
CBOD 5	183		mg/L	198		92.5	84.59-115.402			
Duplicate (B4F4305-DUP2)				Source: C4F6236-01		Prepared & Analyzed: 06/22/24				
CBOD 5	0.350	2.0	mg/L		1.15			107	30	



P.O. Box 1089 Coldspring Tx 77331
Website: eastexlabs.com
Email: eastexlab@eastex.net
Tel: 936 653 3249



Northeast Harris County MUD 1
Municipal Operations and Consulting
20141 Schiel Road
Cypress, TX 77433

SM 2540 C - Quality Control
Eastex Environmental Laboratory - Coldspring

Analyte	Result	Reporting Limit	Units	Spike Level	Source Result	%REC	%REC Limits	RPD	RPD Limit	Notes
Batch B4F4595 - No Prep										
Blank (B4F4595-BLK1)				Prepared & Analyzed: 06/24/24						
TDS	ND	10.0	mg/L							
LCS (B4F4595-BS1)				Prepared & Analyzed: 06/24/24						
TDS	310		mg/L	300		103	80-120			
Duplicate (B4F4595-DUP1)				Source: C4F6236-01 Prepared & Analyzed: 06/24/24						
TDS	570	10.0	mg/L		570			0.00	10	
Batch B4F4598 - No Prep										
Blank (B4F4598-BLK1)				Prepared & Analyzed: 06/24/24						
Conductivity	ND	10	µmhos/cm @25C							
LCS (B4F4598-BS1)				Prepared & Analyzed: 06/24/24						
Conductivity	1001		µmhos/cm @25C	1000		100	80-120			
Duplicate (B4F4598-DUP1)				Source: C4F6236-01 Prepared & Analyzed: 06/24/24						
Conductivity	1177	10	µmhos/cm @25C		1178			0.0849	20	
Batch B4F4611 - No Prep										
Blank (B4F4611-BLK1)				Prepared & Analyzed: 06/24/24						
Ammonia as N	ND	0.1	mg/L							
LCS (B4F4611-BS1)				Prepared & Analyzed: 06/24/24						
Ammonia as N	4.03		mg/L	4.00		101	90-110			
Matrix Spike (B4F4611-MS1)				Source: C4F6236-01 Prepared & Analyzed: 06/24/24						
Ammonia as N	2.4	0.1	mg/L	2.50	ND	95.8	80-120			
Matrix Spike Dup (B4F4611-MSD1)				Source: C4F6236-01 Prepared & Analyzed: 06/24/24						
Ammonia as N	2.4	0.1	mg/L	2.50	ND	95.4	80-120	0.418	20	



P.O. Box 1089 Coldspring Tx 77331
Website: eastexlabs.com
Email: eastexlab@eastex.net
Tel: 936 653 3249



Northeast Harris County MUD 1
Municipal Operations and Consulting
20141 Schiel Road
Cypress, TX 77433

Colilert 18 - Quality Control
Eastex Environmental Laboratory - Coldspring

Analyte	Result	Reporting Limit	Units	Spike Level	Source Result	%REC	%REC Limits	RPD	RPD Limit	Notes
Batch B4F4656 - No Prep Micro										
Blank (B4F4656-BLK1)				Prepared & Analyzed: 06/21/24						
E coli IDEXX	ND	1	mpn/100ml							
Duplicate (B4F4656-DUP1)				Source: C4F6945-01 Prepared & Analyzed: 06/21/24						
E coli IDEXX	ND	10	mpn/100ml		ND				200	
Batch B4F4817 - No Prep										
Blank (B4F4817-BLK1)				Prepared & Analyzed: 06/25/24						
TSS	ND	1.0	mg/L							
Duplicate (B4F4817-DUP1)				Source: C4F7244-01 Prepared & Analyzed: 06/25/24						
TSS	78.0	1.0	mg/L		72.0			8.00	10	
Batch B4F4896 - No Prep										
Blank (B4F4896-BLK1)				Prepared & Analyzed: 06/26/24						
Alkalinity	ND	20.0	mg CaCO ₃ /L							
LCS (B4F4896-BS1)				Prepared & Analyzed: 06/26/24						
Alkalinity	46.0		mg CaCO ₃ /L	50.0		92.0	80-120			
Duplicate (B4F4896-DUP1)				Source: C4F6236-01 Prepared & Analyzed: 06/26/24						
Alkalinity	220	20.0	mg CaCO ₃ /L		220			0.00	20	
Batch B4F5375 - SM 4500 Norg C										
Blank (B4F5375-BLK1)				Prepared & Analyzed: 06/27/24						
TKN	0.560	1.0	mg/L							B
LCS (B4F5375-BS1)				Prepared & Analyzed: 06/27/24						
TKN	11.2		mg/L	10.0		112	90-110			13, B
Matrix Spike (B4F5375-MS1)				Source: C4F6236-01 Prepared & Analyzed: 06/27/24						
TKN	10.2	1.0	mg/L	10.0	3.92	62.7	80-120			13, 23, B
Matrix Spike Dup (B4F5375-MSD1)				Source: C4F6236-01 Prepared & Analyzed: 06/27/24						
TKN	9.40	1.0	mg/L	10.0	3.92	54.8	80-120	8.07	20	13, B

EASTEX ENVIRONMENTAL LABORATORY, INC.
P.O. Box 1089 * Goldspring, TX 77331
(936) 653-3249 * (800) 525-0508
P.O. Box 631375 * Nacogdoches, TX 75963-1375
(936) 569-8879 * FAX (936) 569-9924

White Copy-Follows Samples
Yellow Copy-Laboratory
Pink Copy-Client Copy

REPORT TO:

INVOICE TO:

www.eastexlabs.com

[illegible]



P.O. Box 1089 Coldspring Tx 77331
Website: eastexlabs.com
Email: eastexlab@eastex.net
Tel: 936 653 3249



Northeast Harris County MUD 1
Municipal Operations and Consulting
20141 Schiel Road
Cypress, TX 77433

LABORATORY ANALYTICAL REPORT

Project: NE HC MUD 1 Short PR

Sample Site:	Effluent	Sample Number:	Collector:	DMP					
Sample Type:	Grab	C407997-01	Sampled:	07/26/2024 8:55					
Sample Matrix:	Water		Received:	07/26/2024 15:25					
Client Matrix:	Water								
Analyte	Result	Reporting Limit	Units	Nelac Status	Batch	Analyzed	Analyst	Method	Notes
DO	7.1		mg/L	N	B4G4611	07/26/2024 08:55	DMP	SM 4500 O G	

Analyte	Result	Reporting Limit	Units	Spike Level	Source Result	%REC	%REC Limits	RPD	RPD Limit	Notes
---------	--------	-----------------	-------	-------------	---------------	------	-------------	-----	-----------	-------

Mark Bourgeois

Mark Bourgeois, Special Projects Manager

Qualifiers

EASTEX ENVIRONMENTAL LABORATORY INC

P.O. Box 1089 * Goldspring, TX 77331
(936) 653-3249 * (800) 525-0508

P.O. Box 631375 * Nacogdoches, TX 75963-1375
(936) 569-8879 * FAX (936) 569-8951

White Copy-Follows Samples
Yellow Copy-laboratory
Pink Copy-Client Copy

REPORT TO:

INVOICE TO:

www.eastexlabs.com

[illegible]

December 11, 2024

Ms. Rachel Ellis
Texas Commission on Environmental Quality
Applications Review and Processing Team (MC 148)
Water Quality Division
12100 Park 35 Circle
Austin, TX 78753

Reference: Application Renew Permit No. WQ0014653001 (EPA I.D. No. TX0128261)
Rayford Road Municipal Utility District (CN600630081)
Regulated Entity Number: RN104780796
IDS Project No. 1441-003-04

Dear Ms. Ellis:

Please find attached to this email our complete response to your December 3, 2024 comments.

Administrative Completeness Review Comments:

Comment No. 1 – TCEQ Core Data Form, Section II, Item 15: The mailing address is listed as, 3200 Southeast Freeway, Suite 2600, Houston, Texas 77027. However, after verifying the address on USPS we have found the address should be Southwest Freeway. Please update this section of the CDF and return with the response to this letter.

Response: The address on the CDF has been updated to Southwest Freeway.

Comment No. 2 – Administrative Report 1.0, Section 2-d: The checked box for the type of application is, "Minor Modification", this is incorrect please update this section and re-check the box listed, "Minor Amendment with Renewal". Please return this page with the response to this letter.

Response: Correct box has been checked to reflect minor amendment with renewal.

Comment No. 3 – Administrative Report 1.0, Section 10-A: Update site address to match on all forms. (Abbreviated comment).

Response: Site location has been updated on all applicable pages. It has not changed since the last permit.

Comment No. 4 – Administrative Report 1.0, Section 10-C: In this section you answered "yes" to treated discharge to a city, county, or state highway right-of-way, or flood control district drainage ditch. However, you did not answer the second portion of this question, "if yes, indicate if authorized". Please check on of the provided boxes and return this updated page with response to this letter.

Response: Authorized box checked in following portion.

Comment No. 5 – The following is a portion of the NORI which contains information relevant to your application. Please read it carefully and indicate if it contains any errors or omissions. The complete notice will be sent to you once the application is declared administratively complete.

Response: Minor comments provide on attached scan. Please see attached.

Comment No. 6 – Please use the attached Plain Language Summary (PLS) Template to provide a plain language summary in English. Please provide the PLS in a Microsoft Word document.

Response: PLS provided in email.

Comment No. 7 – Section 8, Item E, Item No. 5 of Administrative Report 1.0 indicates that public notices in Spanish are required. Please use the attached PLS Spanish template to translate the plain language summary into Spanish. Please provide in a Microsoft Word Document.

Response: Spanish PLS provided in email.

Comment No. 8 – The application indicates that public notices in Spanish are required. After confirming the portion of the NORI above does not contain any errors or omissions, please use the attached template to translate the NORI into Spanish. Only the first and last paragraphs are unique to the application and require translation. Please provide the translated Spanish NORI in a Microsoft Word document.

Response: Spanish NORI provided in email.

If you have any further questions or need additional information, please do not hesitate to call me at (832) 590-7150 or via email at wowens@idseg.com

Respectfully,



Weston Owens
Design Engineer
Enclosure

S:\Projects\1400\144100304 TPDES Renewal 2025\Eng-PM\Corres\TCEQ\NOD\Files to TCEQ\TCEQ Response Transmittal Letter.docx

c. Check the box next to the appropriate permit type.

- ☒ TPDES Permit
☐ TLAP
☐ TPDES Permit with TLAP component
☐ Subsurface Area Drip Dispersal System (SADDS)

d. Check the box next to the appropriate application type

- | | |
|---|---|
| <input type="checkbox"/> New | |
| <input type="checkbox"/> Major Amendment <u>with</u> Renewal | <input checked="" type="checkbox"/> Minor Amendment <u>with</u> Renewal |
| <input type="checkbox"/> Major Amendment <u>without</u> Renewal | <input type="checkbox"/> Minor Amendment <u>without</u> Renewal |
| <input type="checkbox"/> Renewal without changes | <input type="checkbox"/> Minor Modification of permit |

e. For amendments or modifications, describe the proposed changes: Updating the current phase of the plant from Interim I to Interim II.

f. For existing permits:

Permit Number: WQ00 14653001

EPA I.D. (TPDES only): TX 0128261

Expiration Date: 03-30-2025

Section 3. Facility Owner (Applicant) and Co-Applclicant Information (Instructions Page 26)

A. The owner of the facility must apply for the permit.

What is the Legal Name of the entity (applicant) applying for this permit?

Northeast Harris County MUD 1

(The legal name must be spelled exactly as filed with the Texas Secretary of State, County, or in the legal documents forming the entity.)

If the applicant is currently a customer with the TCEQ, what is the Customer Number (CN)?

You may search for your CN on the TCEQ website at <http://www15.tceq.texas.gov/crpub/>

CN: 600630081

What is the name and title of the person signing the application? The person must be an executive official meeting signatory requirements in 30 TAC § 305.44.

Prefix:

Last Name, First Name: Jim Moffatt

Title: President

Credential:

B. Co-applicant information. Complete this section only if another person or entity is required to apply as a co-permittee.

What is the Legal Name of the co-applicant applying for this permit?

N/A

(The legal name must be spelled exactly as filed with the TX SOS, with the County, or in the

E. Owner of effluent disposal site:

Prefix: N/A

Last Name, First Name: N/A

Title: N/A

Credential: N/A

Organization Name: N/A

Mailing Address: N/A

City, State, Zip Code: N/A

Phone No.: N/A

E-mail Address: N/A

If the landowner is not the same person as the facility owner or co-applicant, attach a lease agreement or deed recorded easement. See instructions.

Attachment:

F. Owner sewage sludge disposal site (if authorization is requested for sludge disposal on property owned or controlled by the applicant):

Prefix: N/A

Last Name, First Name: N/A

Title: N/A

Credential: N/A

Organization Name: N/A

Mailing Address: N/A

City, State, Zip Code: N/A

Phone No.: N/A

E-mail Address: N/A

If the landowner is not the same person as the facility owner or co-applicant, attach a lease agreement or deed recorded easement. See instructions.

Attachment:

Section 10. TPDES Discharge Information (Instructions Page 31)

A. Is the wastewater treatment facility location in the existing permit accurate?

☒ Yes ☐ No

If **no**, or a new permit application, please give an accurate description:

N/A

B. Are the point(s) of discharge and the discharge route(s) in the existing permit correct?

☒ Yes ☐ No

If **no**, or a new or amendment permit application, provide an accurate description of the point of discharge and the discharge route to the nearest classified segment as defined in 30 TAC Chapter 307:

N/A

City nearest the outfall(s): City of Houston, ETJ

County in which the outfalls(s) is/are located: Harris

C. Is or will the treated wastewater discharge to a city, county, or state highway right-of-way, or a flood control district drainage ditch?

☒ Yes ☐ No

If **yes**, indicate by a check mark if:

☒ Authorization granted ☐ Authorization pending

For **new and amendment** applications, provide copies of letters that show proof of contact and the approval letter upon receipt.

Attachment: N/A

- D. For all applications involving an average daily discharge of 5 MGD or more, provide the names of all counties located within 100 statute miles downstream of the point(s) of discharge: N/A

Section 11. TLAP Disposal Information (Instructions Page 32)

- A. For TLAPs, is the location of the effluent disposal site in the existing permit accurate?

☒ Yes ☐ No

If **no, or a new or amendment permit application**, provide an accurate description of the disposal site location:

N/A

- B. City nearest the disposal site: N/A

- C. County in which the disposal site is located: N/A

- D. For **TLAPs**, describe the routing of effluent from the treatment facility to the disposal site:

N/A

- E. For **TLAPs**, please identify the nearest watercourse to the disposal site to which rainfall runoff might flow if not contained: N/A

Section 12. Miscellaneous Information (Instructions Page 32)

- A. Is the facility located on or does the treated effluent cross American Indian Land?

☐ Yes ☒ No

- B. If the existing permit contains an onsite sludge disposal authorization, is the location of the sewage sludge disposal site in the existing permit accurate?

☐ Yes ☐ No ☒ Not Applicable

If No, or if a new onsite sludge disposal authorization is being requested in this permit application, provide an accurate location description of the sewage sludge disposal site.

N/A



TCEQ Core Data Form

For detailed instructions on completing this form, please read the Core Data Form Instructions or call 512-239-5175.

SECTION I: General Information

1. Reason for Submission (If other is checked please describe in space provided.)		
<input type="checkbox"/> New Permit, Registration or Authorization (Core Data Form should be submitted with the program application.)		
<input type="checkbox"/> Renewal (Core Data Form should be submitted with the renewal form)		<input checked="" type="checkbox"/> Other Updating the current phase of the plant.
2. Customer Reference Number (if issued)	Follow this link to search for CN or RN numbers in Central Registry**	3. Regulated Entity Reference Number (if issued)
CN 600630081		RN 104780796

SECTION II: Customer Information

4. General Customer Information		5. Effective Date for Customer Information Updates (mm/dd/yyyy)			
<input type="checkbox"/> New Customer <input type="checkbox"/> Update to Customer Information <input type="checkbox"/> Change in Regulated Entity Ownership <input type="checkbox"/> Change in Legal Name (Verifiable with the Texas Secretary of State or Texas Comptroller of Public Accounts)					
<i>The Customer Name submitted here may be updated automatically based on what is current and active with the Texas Secretary of State (SOS) or Texas Comptroller of Public Accounts (CPA).</i>					
6. Customer Legal Name (If an individual, print last name first: eg: Doe, John)				<i>If new Customer, enter previous Customer below:</i>	
Northeast Harris County MUD 1					
7. TX SOS/CPA Filing Number		8. TX State Tax ID (11 digits)		9. Federal Tax ID (9 digits)	10. DUNS Number (if applicable)
N/A		N/A		N/A	N/A
11. Type of Customer:		<input type="checkbox"/> Corporation		<input type="checkbox"/> Individual	Partnership: <input type="checkbox"/> General <input type="checkbox"/> Limited
Government: <input type="checkbox"/> City <input type="checkbox"/> County <input type="checkbox"/> Federal <input type="checkbox"/> Local <input type="checkbox"/> State <input checked="" type="checkbox"/> Other		<input type="checkbox"/> Sole Proprietorship		<input checked="" type="checkbox"/> Other: Municipal Utility District	
12. Number of Employees				13. Independently Owned and Operated?	
<input checked="" type="checkbox"/> 0-20 <input type="checkbox"/> 21-100 <input type="checkbox"/> 101-250 <input type="checkbox"/> 251-500 <input type="checkbox"/> 501 and higher				<input type="checkbox"/> Yes <input checked="" type="checkbox"/> No	
14. Customer Role (Proposed or Actual) – as it relates to the Regulated Entity listed on this form. Please check one of the following					
<input checked="" type="checkbox"/> Owner <input type="checkbox"/> Operator <input type="checkbox"/> Owner & Operator <input type="checkbox"/> Other: <input type="checkbox"/> Occupational Licensee <input type="checkbox"/> Responsible Party <input type="checkbox"/> VCP/BSA Applicant					
15. Mailing Address:		3200 Southwest Fwy, Suite 2600			
		Allen Boone Humphries Robinson LLP			
City		Houston		State	TX
ZIP		77027		ZIP + 4	7537
16. Country Mailing Information (if outside USA)				17. E-Mail Address (if applicable)	
N/A				N/A	
18. Telephone Number		19. Extension or Code		20. Fax Number (if applicable)	

SECTION III: Regulated Entity Information**21. General Regulated Entity Information** (If 'New Regulated Entity' is selected, a new permit application is also required.)
☐ New Regulated Entity ☐ Update to Regulated Entity Name ☐ Update to Regulated Entity Information

The Regulated Entity Name submitted may be updated, in order to meet TCEQ Core Data Standards (removal of organizational endings such as Inc, LP, or LLC).

22. Regulated Entity Name (Enter name of the site where the regulated action is taking place.)

Northeast Harris County MUD 1 Wastewater Treatment Plant

23. Street Address of the Regulated Entity:

Northeast Harris County MUD 1

(No PO Boxes)

City

State

ZIP

ZIP + 4

24. County

If no Street Address is provided, fields 25-28 are required.

25. Description to Physical Location:

The site is approx. 2,050 feet south of the intersection of Beaumont Highway and Miller Road Number 3, in Harris County, Texas 77049.

26. Nearest City

State

Nearest ZIP Code

Houston

TX

77049

Latitude/Longitude are required and may be added/updated to meet TCEQ Core Data Standards. (Geocoding of the Physical Address may be used to supply coordinates where none have been provided or to gain accuracy).

27. Latitude (N) In Decimal:

29.847

28. Longitude (W) In Decimal:

-95.164

Degrees

Minutes

Seconds

Degrees

Minutes

Seconds

29

50

49.2

95

9

50.4

29. Primary SIC Code**30. Secondary SIC Code****31. Primary NAICS Code****32. Secondary NAICS Code**

(4 digits)

(4 digits)

(5 or 6 digits)

(5 or 6 digits)

33. What is the Primary Business of this entity? (Do not repeat the SIC or NAICS description.)**34. Mailing**

Address:

City

State

ZIP

ZIP + 4

35. E-Mail Address:**36. Telephone Number****37. Extension or Code****38. Fax Number** (if applicable)

() -

() -

39. TCEQ Programs and ID Numbers Check all Programs and write in the permits/registration numbers that will be affected by the updates submitted on this form. See the Core Data Form instructions for additional guidance.

<input type="checkbox"/> Dam Safety	<input type="checkbox"/> Districts	<input type="checkbox"/> Edwards Aquifer	<input type="checkbox"/> Emissions Inventory Air	<input type="checkbox"/> Industrial Hazardous Waste
<input type="checkbox"/> Municipal Solid Waste	<input type="checkbox"/> New Source Review Air	<input type="checkbox"/> OSSF	<input type="checkbox"/> Petroleum Storage Tank	<input type="checkbox"/> PWS
<input type="checkbox"/> Sludge	<input type="checkbox"/> Storm Water	<input type="checkbox"/> Title V Air	<input type="checkbox"/> Tires	<input type="checkbox"/> Used Oil
<input type="checkbox"/> Voluntary Cleanup	<input checked="" type="checkbox"/> Wastewater	<input type="checkbox"/> Wastewater Agriculture	<input type="checkbox"/> Water Rights	<input type="checkbox"/> Other:
	WQ0014653001			

SECTION IV: Preparer Information

40. Name:	Jason Hajduk		41. Title:	District Engineer
42. Telephone Number	43. Ext./Code	44. Fax Number	45. E-Mail Address	
(713) 467-3178		() -	JHajduk@idseg.com	

SECTION V: Authorized Signature

46. By my signature below, I certify, to the best of my knowledge, that the information provided in this form is true and complete, and that I have signature authority to submit this form on behalf of the entity specified in Section II, Field 6 and/or as required for the updates to the ID numbers identified in field 39.

Company:	Northeast Harris County MUD 1	Job Title:	Board President
Name (In Print):	Jim Moffatt	Phone:	(713) 467- 3178
Signature:		Date:	9/9/2024

TEXAS COMMISSION ON ENVIRONMENTAL QUALITY

SUPPLEMENTAL PERMIT INFORMATION FORM (SPIF)

FOR AGENCIES REVIEWING DOMESTIC OR INDUSTRIAL TPDES WASTEWATER PERMIT APPLICATIONS

TCEQ USE ONLY:

Application type: ____Renewal ____Major Amendment ____Minor Amendment ____New

County: _____ Segment Number: _____

Admin Complete Date: _____

Agency Receiving SPIF:

____ Texas Historical Commission

____ U.S. Fish and Wildlife

____ Texas Parks and Wildlife Department

____ U.S. Army Corps of Engineers

This form applies to TPDES permit applications only. (Instructions, Page 53)

Complete this form as a separate document. TCEQ will mail a copy to each agency as required by our agreement with EPA. If any of the items are not completely addressed or further information is needed, we will contact you to provide the information before issuing the permit. Address each item completely.

Do not refer to your response to any item in the permit application form. Provide each attachment for this form separately from the Administrative Report of the application. The application will not be declared administratively complete without this SPIF form being completed in its entirety including all attachments. Questions or comments concerning this form may be directed to the Water Quality Division's Application Review and Processing Team by email at WQ-ARPTeam@tceq.texas.gov or by phone at (512) 239-4671.

The following applies to all applications:

1. Permittee: Northeast Harris County MUD 1

Permit No. WQ00 14653001EPA ID No. TX 0128261

Address of the project (or a location description that includes street/highway, city/vicinity, and county):

14998 1/2 Beaumont Hwy, Houston TX 77049; Approximately 2,050 feet south of the intersection of Beaumont Highway and Miller Road Number 3, in Harris County, Texas 77049.

Provide the name, address, phone and fax number of an individual that can be contacted to answer specific questions about the property.

Prefix (Mr., Ms., Miss):

First and Last Name: Jason Hajduk

Credential (P.E, P.G., Ph.D., etc.): P.E.

Title: District Engineer

Mailing Address: 13430 Northwest Fwy, Suite 700

City, State, Zip Code: Houston, TX 77040

Phone No.: 713-462-3178 Ext.: Fax No.:

E-mail Address: JHajduk@idseg.com

2. List the county in which the facility is located: Harris
3. If the property is publicly owned and the owner is different than the permittee/applicant, please list the owner of the property.

N/A

4. Provide a description of the effluent discharge route. The discharge route must follow the flow of effluent from the point of discharge to the nearest major watercourse (from the point of discharge to a classified segment as defined in 30 TAC Chapter 307). If known, please identify the classified segment number.

A point located along the Edgewood Village Detention basin approximately 2,050 feet south of the intersection of Beaumont Highway and Miller Road Number 3, in Harris County, Texas 77049.

5. Please provide a separate 7.5-minute USGS quadrangle map with the project boundaries plotted and a general location map showing the project area. Please highlight the discharge route from the point of discharge for a distance of one mile downstream. (This map is required in addition to the map in the administrative report).

Provide original photographs of any structures 50 years or older on the property.

Does your project involve any of the following? Check all that apply.

- ☐ Proposed access roads, utility lines, construction easements
- ☐ Visual effects that could damage or detract from a historic property's integrity
- ☐ Vibration effects during construction or as a result of project design
- ☐ Additional phases of development that are planned for the future
- ☐ Sealing caves, fractures, sinkholes, other karst features