



Administrative Package Cover Page

This file contains the following documents:

1. Summary of application (in plain language)
 - English
 - Alternative Language (Spanish)
 - Alternative Language (Vietnamese)
 2. First Notice (NORI-Notice of Receipt of Application and Intent to Obtain a Permit)
 - English
 - Alternative Language (Spanish)
 - Alternative Language (Vietnamese)
 3. Application materials
-



Portada de Paquete Administrativo

Este archivo contiene los siguientes documentos:

1. Resumen en lenguaje sencillo (PLS, por sus siglas en inglés) de la actividad propuesta
 - Inglés
 - Idioma alternativo (español)
 - Idioma alternativo (vietnamita)
2. Primer aviso (NORI, por sus siglas en inglés)
 - Inglés
 - Idioma alternativo (español)
 - Idioma alternative (vietnamita)
3. Solicitud original

PLANTILLA EN ESPAÑOL PARA SOLICITUDES NUEVAS/RENOVACIONES/ENMIENDAS DE TPDES o TLAP

AGUAS RESIDUALES Introduzca 'INDUSTRIALES' o 'DOMÉSTICAS' aquí /AGUAS PLUVIALES

El siguiente resumen se proporciona para esta solicitud de permiso de calidad del agua pendiente que está siendo revisada por la Comisión de Calidad Ambiental de Texas según lo requerido por el Capítulo 39 del Código Administrativo de Texas 30. La información proporcionada en este resumen puede cambiar durante la revisión técnica de la solicitud y no es una representación ejecutiva fedérale de la solicitud de permiso.

Jimmy Edwin Cole, Jr. (CN605724418) propone operar la Planta de Tratamiento de Aguas Residuales de Jimmy Cole Rentals (RN 110898053), un proceso de lodos activados con nitrificación operado en el modo de mezcla completa. La instalación está ubicada en 23520 Camino Sharp, en Montgomery, Condado de Montgomery, Texas 77356.. Esta solicitud es para una renovación aplicación para descargar a un flujo promedio diario de 25,000 galones por día de aguas residuales domésticas tratadas.

Se espera que las descargas de la instalación contengan demanda bioquímica de oxígeno carbonoso de cinco días (CBOD₅), solidos totalmente suspendidos (TSS), nitrógeno amoniacal (NH₄-N), y *Escherichia coli*. Los contaminantes potenciales adicionales se incluyen en el Informe Técnico Domésticas 1.0, Seccion 7 Análisis de Contaminantes de Efluente Tratado en el paquete de solicitud de permisos. Las aguas residuales domésticas. está tratado por una planta de proceso de lodos activados y las unidades de tratamiento incluirán una pantalla de barras, balsa de selector, balsa de aireación, clarificador finale, digestora de lodos, y cámara de contacto de cloro.

PLANTILLA EN ESPAÑOL PARA SOLICITUDES NUEVAS/RENOVACIONES/ENMIENDAS DE TPDES o TLAP

AGUAS RESIDUALES Introduzca 'INDUSTRIALES' o 'DOMÉSTICAS' aquí /AGUAS PLUVIALES

El siguiente resumen se proporciona para esta solicitud de permiso de calidad del agua pendiente que está siendo revisada por la Comisión de Calidad Ambiental de Texas según lo requerido por el Capítulo 39 del Código Administrativo de Texas 30. La información proporcionada en este resumen puede cambiar durante la revisión técnica de la solicitud y no es una representación ejecutiva fedérale de la solicitud de permiso.

Jimmy Edwin Cole, Jr. (CN605724418) propone operar la Planta de Tratamiento de Aguas Residuales de Jimmy Cole Rentals (RN 110898053), un proceso de lodos activados con nitrificación operado en el modo de mezcla completa. La instalación está ubicada en 23520 Camino Sharp, en Montgomery, Condado de Montgomery, Texas 77356.. Esta solicitud es para una renovación aplicación para descargar a un flujo promedio diario de 25,000 galones por día de aguas residuales domésticas tratadas.

Se espera que las descargas de la instalación contengan demanda bioquímica de oxígeno carbonoso de cinco días (CBOD₅), sólidos totalmente suspendidos (TSS), nitrógeno amoniacal (NH₄-N), y *Escherichia coli*. Los contaminantes potenciales adicionales se incluyen en el Informe Técnico Domésticas 1.0, Sección 7 Análisis de Contaminantes de Efluente Tratado en el paquete de solicitud de permisos. Las aguas residuales domésticas. está tratado por una planta de proceso de lodos activados y las unidades de tratamiento incluirán una pantalla de barras, balsa de selector, balsa de aireación, clarificador finale, digestora de lodos, y cámara de contacto de cloro.

TEXAS COMMISSION ON ENVIRONMENTAL QUALITY



NOTICE OF RECEIPT OF APPLICATION AND INTENT TO OBTAIN WATER QUALITY PERMIT RENEWAL

PERMIT NO. WQ0015838001

APPLICATION. Jimmy Edwin Cole, Jr., P.O. Box 864, Montgomery, Texas 77356, has applied to the Texas Commission on Environmental Quality (TCEQ) to renew Texas Pollutant Discharge Elimination System (TPDES) Permit No. WQ0015838001 (EPA I.D. No. TX0139726) to authorize the discharge of treated wastewater at a volume not to exceed a daily average flow of 25,000 gallons per day. The domestic wastewater treatment facility is located at 23520 Sharp Road, near the city of Montgomery, in Montgomery County, Texas 77356. The discharge route is from the plant site to an unnamed tributary of Little Lake Creek; thence to Little Lake Creek; thence to Lake Conroe. TCEQ received this application on November 20, 2024. The permit application will be available for viewing and copying at Charles B. Stewart-West Branch Library, 202 Bessie Price Owen Drive, Montgomery, in Montgomery County, Texas prior to the date this notice is published in the newspaper. The application, including any updates, and associated notices are available electronically at the following webpage:

<https://www.tceq.texas.gov/permitting/wastewater/pending-permits/tpdes-applications>. This link to an electronic map of the site or facility's general location is provided as a public courtesy and not part of the application or notice. For the exact location, refer to the application.

<https://gisweb.tceq.texas.gov/LocationMapper/?marker=-95.713725,30.432328&level=18>

ALTERNATIVE LANGUAGE NOTICE. Alternative language notice in Spanish is available at: <https://www.tceq.texas.gov/permitting/wastewater/pending-permits/tpdes-applications>.

El aviso de idioma alternativo en español está disponible en

<https://www.tceq.texas.gov/permitting/wastewater/pending-permits/tpdes-applications>.

ADDITIONAL NOTICE. TCEQ's Executive Director has determined the application is administratively complete and will conduct a technical review of the application. After technical review of the application is complete, the Executive Director may prepare a draft permit and will issue a preliminary decision on the application. **Notice of the Application and Preliminary Decision will be published and mailed to those who are on the county-wide mailing list and to those who are on the mailing list for this application. That notice will contain the deadline for submitting public comments.**

PUBLIC COMMENT / PUBLIC MEETING. You may submit public comments or request a public meeting on this application. The purpose of a public meeting is to provide the opportunity to submit comments or to ask questions about the application. TCEQ will hold a public meeting if the Executive Director determines that there is a significant degree of public

interest in the application or if requested by a local legislator. A public meeting is not a contested case hearing.

OPPORTUNITY FOR A CONTESTED CASE HEARING. After the deadline for submitting public comments, the Executive Director will consider all timely comments and prepare a response to all relevant and material, or significant public comments. **Unless the application is directly referred for a contested case hearing, the response to comments, and the Executive Director's decision on the application, will be mailed to everyone who submitted public comments and to those persons who are on the mailing list for this application.** If comments are received, the mailing will also provide instructions for requesting reconsideration of the Executive Director's decision and for requesting a contested case hearing. A contested case hearing is a legal proceeding similar to a civil trial in state district court.

TO REQUEST A CONTESTED CASE HEARING, YOU MUST INCLUDE THE FOLLOWING ITEMS IN YOUR REQUEST: your name, address, phone number; applicant's name and proposed permit number; the location and distance of your property/activities relative to the proposed facility; a specific description of how you would be adversely affected by the facility in a way not common to the general public; a list of all disputed issues of fact that you submit during the comment period and, the statement "[I/we] request a contested case hearing." If the request for contested case hearing is filed on behalf of a group or association, the request must designate the group's representative for receiving future correspondence; identify by name and physical address an individual member of the group who would be adversely affected by the proposed facility or activity; provide the information discussed above regarding the affected member's location and distance from the facility or activity; explain how and why the member would be affected; and explain how the interests the group seeks to protect are relevant to the group's purpose.

Following the close of all applicable comment and request periods, the Executive Director will forward the application and any requests for reconsideration or for a contested case hearing to the TCEQ Commissioners for their consideration at a scheduled Commission meeting.

The Commission may only grant a request for a contested case hearing on issues the requestor submitted in their timely comments that were not subsequently withdrawn. **If a hearing is granted, the subject of a hearing will be limited to disputed issues of fact or mixed questions of fact and law relating to relevant and material water quality concerns submitted during the comment period.**

TCEQ may act on an application to renew a permit for discharge of wastewater without providing an opportunity for a contested case hearing if certain criteria are met.

MAILING LIST. If you submit public comments, a request for a contested case hearing or a reconsideration of the Executive Director's decision, you will be added to the mailing list for this specific application to receive future public notices mailed by the Office of the Chief Clerk. In addition, you may request to be placed on: (1) the permanent mailing list for a specific applicant name and permit number; and/or (2) the mailing list for a specific county. If you wish to be placed on the permanent and/or the county mailing list, clearly specify which list(s) and send your request to TCEQ Office of the Chief Clerk at the address below.

INFORMATION AVAILABLE ONLINE. For details about the status of the application, visit the Commissioners' Integrated Database at www.tceq.texas.gov/goto/cid. Search the database using the permit number for this application, which is provided at the top of this notice.

AGENCY CONTACTS AND INFORMATION. All public comments and requests must be submitted either electronically at <https://www14.tceq.texas.gov/epic/eComment/>, or in writing to the Texas Commission on Environmental Quality, Office of the Chief Clerk, MC-105, P.O. Box 13087, Austin, Texas 78711-3087. Please be aware that any contact information you provide, including your name, phone number, email address and physical address will become part of the agency's public record. For more information about this permit application or the permitting process, please call the TCEQ Public Education Program, Toll Free, at 1-800-687-4040 or visit their website at www.tceq.texas.gov/goto/pep. Si desea información en Español, puede llamar al 1-800-687-4040.

Further information may also be obtained from Jimmy Edwin Cole Jr. at the address stated above or by calling Ms. Shelley Young, P.E., WaterEngineers, Inc., at 281-373-0500.

Issuance Date: December 18, 2024

Comisión de Calidad Ambiental del Estado de Texas



AVISO DE RECIBO DE LA SOLICITUD Y EL INTENTO DE OBTENER PERMISO PARA LA CALIDAD DEL AGUA RENOVACION

PERMISO PROPUESTO NO. WQ0015838001

SOLICITUD. Jimmy Edwin Cole Jr., P.O. Box 864, Montgomery, Tejas 77356, ha solicitado a la Comisión de Calidad Ambiental del Estado de Texas (TCEQ) para renovar Permiso No. WQ0015838001 (EPA I.D. No. TX0139726) del Sistema de Eliminación de Descargas de Contaminantes de Texas (TPDES) para autorizar la descarga de aguas residuales tratadas en un volumen que no sobrepasa un flujo medio diario de 25,000 galones por día. La planta está ubicada 23520 Camino Sharp, en la ciudad de Montgomery, en el Condado de Montgomery, Tejas 77356. La ruta de descarga es del sitio a tributario sin nombre de Little Lake Creek, de ahí a Little Lake Creek; de ahí a Lago Conroe. La TCEQ recibió esta solicitud el 20 de Noviembre de 2024. La solicitud para el permiso está disponible para leerla y copiarla en Biblioteca de Charles B. Stewart – Sucursal Oeste, 202 Camino Bessie Price Owen, Montgomery, en Condado de Montgomery, Tejas, antes de la fecha de publicación de este aviso en el periódico. La aplicación, incluidas las actualizaciones y los avisos asociados, están disponibles electrónicamente en la siguiente pagina web:

<https://www.tceq.texas.gov/permitting/wastewater/pending-permits/tpdes-applications>.

Este enlace a un mapa electrónico de la ubicación general del sitio o de la instalación es proporcionado como una cortesía y no es parte de la solicitud o del aviso. Para la ubicación exacta, consulte la solicitud.

<https://gisweb.tceq.texas.gov/LocationMapper/?marker=-95.713725,30.432328&level=18>

AVISO ADICIONAL. El Director Ejecutivo de la TCEQ ha determinado que la solicitud es administrativamente completa y conducirá una revisión técnica de la solicitud. Después de completar la revisión técnica, el Director Ejecutivo puede preparar un borrador del permiso y emitirá una Decisión Preliminar sobre la solicitud. **El aviso de la solicitud y la decisión preliminar serán publicados y enviado a los que están en la lista de correo de las personas a lo largo del condado que desean recibir los avisos y los que están en la lista de correo que desean recibir avisos de esta solicitud. El aviso dará la fecha límite para someter comentarios públicos.**

COMENTARIO PUBLICO / REUNION PUBLICA. Usted puede presentar **comentarios públicos o pedir una reunión pública sobre esta solicitud.** El propósito de una reunión pública es dar la oportunidad de presentar comentarios o hacer preguntas acerca de la solicitud. La TCEQ realiza una reunión pública si el Director Ejecutivo determina que hay un grado de interés público suficiente en la solicitud o si un legislador local lo pide. Una reunión

pública no es una audiencia administrativa de lo contencioso.

OPORTUNIDAD DE UNA AUDIENCIA ADMINISTRATIVA DE LO CONTENCIOSO.

Después del plazo para presentar comentarios públicos, el Director Ejecutivo considerará todos los comentarios apropiados y preparará una respuesta a todo los comentarios públicos esenciales, pertinentes, o significativos. **A menos que la solicitud haya sido referida directamente a una audiencia administrativa de lo contencioso, la respuesta a los comentarios y la decisión del Director Ejecutivo sobre la solicitud serán enviados por correo a todos los que presentaron un comentario público y a las personas que están en la lista para recibir avisos sobre esta solicitud. Si se reciben comentarios, el aviso también proveerá instrucciones para pedir una reconsideración de la decisión del Director Ejecutivo y para pedir una audiencia administrativa de lo contencioso.** Una audiencia administrativa de lo contencioso es un procedimiento legal similar a un procedimiento legal civil en un tribunal de distrito del estado.

PARA SOLICITAR UNA AUDIENCIA DE CASO IMPUGNADO, USTED DEBE INCLUIR EN SU SOLICITUD LOS SIGUIENTES DATOS: su nombre, dirección, y número de teléfono; el nombre del solicitante y número del permiso; la ubicación y distancia de su propiedad/actividad con respecto a la instalación; una descripción específica de la forma cómo usted sería afectado adversamente por el sitio de una manera no común al público en general; una lista de todas las cuestiones de hecho en disputa que usted presente durante el período de comentarios; y la declaración "[Yo/nosotros] solicito/solicitamos una audiencia de caso impugnado". Si presenta la petición para una audiencia de caso impugnado de parte de un grupo o asociación, debe identificar una persona que representa al grupo para recibir correspondencia en el futuro; identificar el nombre y la dirección de un miembro del grupo que sería afectado adversamente por la planta o la actividad propuesta; proveer la información indicada anteriormente con respecto a la ubicación del miembro afectado y su distancia de la planta o actividad propuesta; explicar cómo y porqué el miembro sería afectado; y explicar cómo los intereses que el grupo desea proteger son pertinentes al propósito del grupo.

Después del cierre de todos los períodos de comentarios y de petición que aplican, el Director Ejecutivo enviará la solicitud y cualquier petición para reconsideración o para una audiencia de caso impugnado a los Comisionados de la TCEQ para su consideración durante una reunión programada de la Comisión. La Comisión sólo puede conceder una solicitud de una audiencia de caso impugnado sobre los temas que el solicitante haya presentado en sus comentarios oportunos que no fueron retirados posteriormente. Si se concede una audiencia, el tema de la audiencia estará limitado a cuestiones de hecho en disputa o cuestiones mixtas de hecho y de derecho relacionadas a intereses pertinentes y materiales de calidad del agua que se hayan presentado durante el período de comentarios.

LISTA DE CORREO. Si somete comentarios públicos, un pedido para una audiencia administrativa de lo contencioso o una reconsideración de la decisión del Director Ejecutivo, la Oficina del Secretario Principal enviará por correo los avisos públicos en relación con la solicitud. Además, puede pedir que la TCEQ ponga su nombre en una o más de las listas correos siguientes (1) la lista de correo permanente para recibir los avisos de el solicitante indicado por nombre y número del permiso específico y/o (2) la lista de correo de todas las solicitudes en un condado específico. Si desea que se agregue su nombre en una de las listas designe cual lista(s) y envía por correo su pedido a la Oficina del Secretario Principal de la

TCEQ.

CONTACTOS E INFORMACIÓN A LA AGENCIA. Todos los comentarios públicos y solicitudes deben ser presentadas electrónicamente vía

<http://www14.tceq.texas.gov/epic/eComment/> o por escrito dirigidos a la Comisión de Texas de Calidad Ambiental, Oficial de la Secretaría (Office of Chief Clerk), MC-105, P.O. Box 13087, Austin, Texas 78711-3087. Tenga en cuenta que cualquier información personal que usted proporcione, incluyendo su nombre, número de teléfono, dirección de correo electrónico y dirección física pasarán a formar parte del registro público de la Agencia. Para obtener más información acerca de esta solicitud de permiso o el proceso de permisos, llame al programa de educación pública de la TCEQ, gratis, al 1-800-687-4040. Si desea información en Español, puede llamar al 1-800-687-4040.

También se puede obtener información adicional del Jimmy Edwin Cole, Jr., a la dirección indicada arriba o llamando a Shelley Young, P.E., WaterEngineers, Inc., al 281-373-0500.

Fecha de emisión 18 de diciembre 2024

WATERENGINEERS, INC.

WATER & WASTEWATER TREATMENT CONSULTANTS

17230 HUFFMEISTER ROAD, SUITE A~CYPRESS, TEXAS 77429-1643

TEL: 281-373-0500 FAX: 281-373-1113

Overnight by UPS

November 19, 2024

Executive Director
Water Quality Applications Team (MC 148)
Texas Commission on Environmental Quality
12100 Park 35 Circle
Austin, Texas 78753

Re: Jimmy Edwin Cole, Jr.
Application for a Renewal to TPDES No. WQ0015838001
Jimmy Cole Rentals Wastewater Treatment Plant in Montgomery County

Dear Sir/Ms:

Enclosed please find the original and one copy of the Application for a Renewal to TPDES No. WQ0015838001 for the Jimmy Cole Rentals Wastewater Treatment Plant in Montgomery County.

Please contact Shelley Young, P.E. at 281-373-0500 or at syoung@waterengineers.com if there are any questions related to the material presented in the application.

Sincerely,
WATERENGINEERS, INC.



Shelley Young, P.E.

Encl: As noted

**APPLICATION FOR A RENEWAL WITH A MINOR AMENDMENT TO
TEXAS POLLUTION DISCHARGE ELIMINATION SYSTEM PERMIT
NO. WQ0015838001**

FOR

**JIMMY COLE RENTALS
WASTEWATER TREATMENT PLANT**

**JIMMY EDWIN COLE, JR.
P.O. BOX 864
MONTGOMERY, TX 77356**

PREPARED BY:

WATERENGINEERS, INC.
WATER & WASTEWATER TREATMENT CONSULTANTS
17230 HUFFMEISTER ROAD, SUITE A, CYPRESS, TEXAS 77429
TEL: 281-373-0500 FAX: 281-373-1113

NOVEMBER 2024

APPLICATION FOR A RENEWAL WITH A MINOR AMENDMENT TO
TEXAS POLLUTION DISCHARGE ELIMINATION SYSTEM PERMIT NO.
WQ0015838001

FOR

JIMMY COLE RENTALS

WASTEWATER TREATMENT PLANT

TABLE OF CONTENTS

Description	Reference Page Numbers(s)	Reference Question
TCEQ Domestic Wastewater Permit Application Domestic Administrative Report 1.0	1-11	
TCEQ Domestic Wastewater Permit Application Domestic Technical Report 1.0	Technical Report 1-18	
Domestic Worksheet 2.0 – Receiving Waters	Technical Report 25-28	
Attachment ADMIN.01 USGS Topographic Map	Administrative Report 1.0 Page 10	13
Attachment ADMIN.02 Proof of Application Fee	Administrative Report 1.0 Page 10	13
Attachment ADMIN.03 Core Data Form	Administrative Report 1.0 Page 4	3C
Attachment ADMIN.04 Plain Language Summary	Administrative Report 1.0 Page 7	8F
Attachment ADMIN.09 Supplemental Permit Information Form (SPIF)	Administrative Report Page 14	
Attachment TECH.02 Process Flow Diagram	Technical Report 1.0 Page 2	2C
Attachment TECH.03 Site Drawing (Including Wind Rose)	Technical Report Page 2 Page 23	3 7



TEXAS COMMISSION ON ENVIRONMENTAL QUALITY

DOMESTIC WASTEWATER PERMIT APPLICATION CHECKLIST

Complete and submit this checklist with the application.

APPLICANT NAME: Jimmy Edwin Cole, Jr.

PERMIT NUMBER (If new, leave blank): WQ00 15838001

Indicate if each of the following items is included in your application.

	Y	N		Y	N
Administrative Report 1.0	<input checked="" type="checkbox"/>	<input type="checkbox"/>	Original USGS Map	<input checked="" type="checkbox"/>	<input type="checkbox"/>
Administrative Report 1.1	<input type="checkbox"/>	<input checked="" type="checkbox"/>	Affected Landowners Map	<input type="checkbox"/>	<input checked="" type="checkbox"/>
SPIF	<input checked="" type="checkbox"/>	<input type="checkbox"/>	Landowner Disk or Labels	<input type="checkbox"/>	<input checked="" type="checkbox"/>
Core Data Form	<input checked="" type="checkbox"/>	<input type="checkbox"/>	Buffer Zone Map	<input type="checkbox"/>	<input checked="" type="checkbox"/>
Public Involvement Plan Form	<input type="checkbox"/>	<input checked="" type="checkbox"/>	Flow Diagram	<input checked="" type="checkbox"/>	<input type="checkbox"/>
Technical Report 1.0	<input checked="" type="checkbox"/>	<input type="checkbox"/>	Site Drawing	<input checked="" type="checkbox"/>	<input type="checkbox"/>
Technical Report 1.1	<input type="checkbox"/>	<input checked="" type="checkbox"/>	Original Photographs	<input type="checkbox"/>	<input checked="" type="checkbox"/>
Worksheet 2.0	<input checked="" type="checkbox"/>	<input type="checkbox"/>	Design Calculations	<input type="checkbox"/>	<input checked="" type="checkbox"/>
Worksheet 2.1	<input type="checkbox"/>	<input checked="" type="checkbox"/>	Solids Management Plan	<input type="checkbox"/>	<input checked="" type="checkbox"/>
Worksheet 3.0	<input type="checkbox"/>	<input checked="" type="checkbox"/>	Water Balance	<input type="checkbox"/>	<input checked="" type="checkbox"/>
Worksheet 3.1	<input type="checkbox"/>	<input checked="" type="checkbox"/>			
Worksheet 3.2	<input type="checkbox"/>	<input checked="" type="checkbox"/>			
Worksheet 3.3	<input type="checkbox"/>	<input checked="" type="checkbox"/>			
Worksheet 4.0	<input type="checkbox"/>	<input checked="" type="checkbox"/>			
Worksheet 5.0	<input type="checkbox"/>	<input checked="" type="checkbox"/>			
Worksheet 6.0	<input type="checkbox"/>	<input checked="" type="checkbox"/>			
Worksheet 7.0	<input type="checkbox"/>	<input checked="" type="checkbox"/>			

For TCEQ Use Only

Segment Number _____ County _____
Expiration Date _____ Region _____
Permit Number _____



TEXAS COMMISSION ON ENVIRONMENTAL QUALITY

**DOMESTIC WASTEWATER PERMIT APPLICATION
ADMINISTRATIVE REPORT 1.0**

For any questions about this form, please contact the Applications Review and Processing Team at 512-239-4671.

Section 1. Application Fees (Instructions Page 26)

Indicate the amount submitted for the application fee (check only one).

Flow	New/Major Amendment	Renewal
<0.05 MGD	\$350.00 <input type="checkbox"/>	\$315.00 <input checked="" type="checkbox"/>
≥0.05 but <0.10 MGD	\$550.00 <input type="checkbox"/>	\$515.00 <input type="checkbox"/>
≥0.10 but <0.25 MGD	\$850.00 <input type="checkbox"/>	\$815.00 <input type="checkbox"/>
≥0.25 but <0.50 MGD	\$1,250.00 <input type="checkbox"/>	\$1,215.00 <input type="checkbox"/>
≥0.50 but <1.0 MGD	\$1,650.00 <input type="checkbox"/>	\$1,615.00 <input type="checkbox"/>
≥1.0 MGD	\$2,050.00 <input type="checkbox"/>	\$2,015.00 <input type="checkbox"/>

Minor Amendment (for any flow) \$150.00 ☐

Payment Information:

Mailed Check/Money Order Number: 1454
Check/Money Order Amount: \$315.00
Name Printed on Check: WaterEngineers, Inc.

EPAY Voucher Number: Click to enter text.

Copy of Payment Voucher enclosed? Yes ☐

Section 2. Type of Application (Instructions Page 26)

a. Check the box next to the appropriate authorization type.

- ☐ Publicly-Owned Domestic Wastewater
☒ Privately-Owned Domestic Wastewater
☐ Conventional Wastewater Treatment

b. Check the box next to the appropriate facility status.

- ☐ Active ☒ Inactive

- c. Check the box next to the appropriate permit type.
- ☒ TPDES Permit
 - ☐ TLAP
 - ☐ TPDES Permit with TLAP component
 - ☐ Subsurface Area Drip Dispersal System (SADDS)
- d. Check the box next to the appropriate application type
- ☐ New
 - ☐ Major Amendment with Renewal
 - ☐ Major Amendment without Renewal
 - ☐ Renewal without changes
 - ☒ Minor Amendment with Renewal
 - ☐ Minor Amendment without Renewal
 - ☐ Minor Modification of permit
- e. For amendments or modifications, describe the proposed changes: Add an interim flow of 0.015 mgd
- f. For existing permits:
- Permit Number: WQ00 15838001
- EPA I.D. (TPDES only): TX 0139726
- Expiration Date: May 26, 2025

Section 3. Facility Owner (Applicant) and Co-Applclicant Information (Instructions Page 26)

A. The owner of the facility must apply for the permit.

What is the Legal Name of the entity (applicant) applying for this permit?

Jimmy Edwin Cole, Jr.

(The legal name must be spelled exactly as filed with the Texas Secretary of State, County, or in the legal documents forming the entity.)

If the applicant is currently a customer with the TCEQ, what is the Customer Number (CN)?

You may search for your CN on the TCEQ website at <http://www15.tceq.texas.gov/crpub/>

CN: 605724418

What is the name and title of the person signing the application? The person must be an executive official meeting signatory requirements in 30 TAC § 305.44.

Prefix: Mr.

Last Name, First Name: Cole, Jr., Jimmy Edwin

Title: Owner

Credential: Click to enter text.

B. Co-applclicant information. Complete this section only if another person or entity is required to apply as a co-permittee.

What is the Legal Name of the co-applclicant applying for this permit?

Click to enter text.

(The legal name must be spelled exactly as filed with the TX SOS, with the County, or in the

legal documents forming the entity.)

If the co-applicant is currently a customer with the TCEQ, what is the Customer Number (CN)?
You may search for your CN on the TCEQ website at: <http://www15.tceq.texas.gov/crpub/>

CN: Click to enter text.

What is the name and title of the person signing the application? The person must be an executive official meeting signatory requirements in 30 TAC § 305.44.

Prefix: Click to enter text.

Last Name, First Name: Click to enter text.

Title: Click to enter text.

Credential: Click to enter text.

Provide a brief description of the need for a co-permittee: Click to enter text.

C. Core Data Form

Complete the Core Data Form for each customer and include as an attachment. If the customer type selected on the Core Data Form is **Individual**, complete **Attachment 1** of Administrative Report 1.0. [ADMIN.03](#)

Section 4. Application Contact Information (Instructions Page 27)

This is the person(s) TCEQ will contact if additional information is needed about this application. Provide a contact for administrative questions and technical questions.

A. Prefix: Ms.

Last Name, First Name: Young, Shelley

Title: Engineer

Credential: P.E.

Organization Name: WaterEngineers, Inc.

Mailing Address: 17230 Huffmeister Road, Suite A City, State, Zip Code: Cypress, TX 77429

Phone No.: 281-373-0500

E-mail Address: syoun@waterengineers.com

Check one or both: ☒ Administrative Contact ☒ Technical Contact

B. Prefix: Click to enter text.

Last Name, First Name: Click to enter text.

Title: Click to enter text.

Credential: Click to enter text.

Organization Name: Click to enter text.

Mailing Address: Click to enter text. City, State, Zip Code: Click to enter text.

Phone No.: Click to enter text.

E-mail Address: Click to enter text.

Check one or both: ☐ Administrative Contact ☐ Technical Contact

Section 5. Permit Contact Information (Instructions Page 27)

Provide the names and contact information for two individuals that can be contacted throughout the permit term.

A. Prefix: Mr.

Last Name, First Name: Cole, Jr., Jimmy Edwin

Title: Owner

Credential: Click to enter text.

Organization Name: N/A

Mailing Address: P.O. Box 864

City, State, Zip Code: Montgomery, TX 77356

Phone No.: 936-537-8291

E-mail Address: jcoleelectric@yahoo.com

B. Prefix: Mr.

Last Name, First Name: Cole, Jacob

Title: Click to enter text.

Credential: Click to enter text.

Organization Name: N/A

Mailing Address: P.O. Box 864

City, State, Zip Code: Montgomery, TX 77356

Phone No.: 936-537-8291

E-mail Address: jcoleelectric@yahoo.com

Section 6. Billing Contact Information (Instructions Page 27)

The permittee is responsible for paying the annual fee. The annual fee will be assessed to permits ***in effect on September 1 of each year***. The TCEQ will send a bill to the address provided in this section. The permittee is responsible for terminating the permit when it is no longer needed (using form TCEQ-20029).

Prefix: Mr.

Last Name, First Name: Cole, Jr., Jimmy Edwin

Title: Owner

Credential: Click to enter text.

Organization Name: N/A

Mailing Address: P.O. Box 864

City, State, Zip Code: Montgomery, TX 77356

Phone No.: 936-537-8291

E-mail Address: jcoleelectric@yahoo.com

Section 7. DMR/MER Contact Information (Instructions Page 27)

Provide the name and complete mailing address of the person delegated to receive and submit Discharge Monitoring Reports (DMR) (EPA 3320-1) or maintain Monthly Effluent Reports (MER).

Prefix: Mr.

Last Name, First Name: Cole, Jr., Jimmy Edwin

Title: Owner

Credential: Click to enter text.

Organization Name: N/A

Mailing Address: P.O. Box 864

City, State, Zip Code: Montgomery, TX 77356

Phone No.: 936-537-8291

E-mail Address: jcoleelectric@yahoo.com

Section 8. Public Notice Information (Instructions Page 27)

A. Individual Publishing the Notices

Prefix: Ms.

Last Name, First Name: Young, Shelley

Title: Engineer

Credential: P.E.

Organization Name: WaterEngineers, Inc.

Mailing Address: 17230 Huffmeister Rd, Ste A City, State, Zip Code: Cypress, TX 77429

Phone No.: 281-373-0500

E-mail Address: syoung@waterengineers.com

B. Method for Receiving Notice of Receipt and Intent to Obtain a Water Quality Permit Package

Indicate by a check mark the preferred method for receiving the first notice and instructions:

- ☒ E-mail Address
☐ Fax
☐ Regular Mail

C. Contact permit to be listed in the Notices

Prefix: Ms. Last Name, First Name: Young, Shelley

Title: Engineer Credential: P.E.

Organization Name: WaterEngineers, Inc.

Mailing Address: 17230 Huffmeister Rd, Ste A City, State, Zip Code: Cypress, TX 77429

Phone No.: 281-373-0500 E-mail Address: syoung@waterengineers.com

D. Public Viewing Information

If the facility or outfall is located in more than one county, a public viewing place for each county must be provided.

Public building name: Charles B. Stewart-West Branch Library

Location within the building: Reference Desk

Physical Address of Building: 202 Bessie Price Owen Dr.

City: Montgomery 77356 County: Montgomery

Contact (Last Name, First Name): Mat Wilson

Phone No.: 936-522-2799 Ext.: Click to enter text.

E. Bilingual Notice Requirements

This information is **required** for **new, major amendment, minor amendment or minor modification, and renewal** applications.

This section of the application is only used to determine if alternative language notices will be needed. Complete instructions on publishing the alternative language notices will be in your public notice package.

Please call the bilingual/ESL coordinator at the nearest elementary and middle schools and obtain the following information to determine whether an alternative language notices are required.

1. Is a bilingual education program required by the Texas Education Code at the elementary or middle school nearest to the facility or proposed facility?

☒ Yes ☐ No

If **no**, publication of an alternative language notice is not required; **skip to** Section 9 below.

2. Are the students who attend either the elementary school or the middle school enrolled in a bilingual education program at that school?

☒ Yes ☐ No

3. Do the students at these schools attend a bilingual education program at another location?

☐ Yes ☒ No

4. Would the school be required to provide a bilingual education program but the school has waived out of this requirement under 19 TAC §89.1205(g)?

☐ Yes ☒ No

5. If the answer is **yes** to **question 1, 2, 3, or 4**, public notices in an alternative language are required. Which language is required by the bilingual program? Spanish

F. Plain Language Summary Template

Complete the Plain Language Summary (TCEQ Form 20972) and include as an attachment.

Attachment: ADMIN.04

G. Public Involvement Plan Form

Complete the Public Involvement Plan Form (TCEQ Form 20960) for each application for a **new permit or major amendment to a permit** and include as an attachment.

Attachment: N/A

Section 9. Regulated Entity and Permitted Site Information (Instructions Page 29)

A. If the site is currently regulated by TCEQ, provide the Regulated Entity Number (RN) issued to this site. **RN** 110898053

Search the TCEQ's Central Registry at <http://www15.tceq.texas.gov/crpub/> to determine if the site is currently regulated by TCEQ.

B. Name of project or site (the name known by the community where located):

Jimmy Cole Rentals WWTP

C. Owner of treatment facility: Jimmy Edwin Cole, Jr.

Ownership of Facility: ☐ Public ☒ Private ☐ Both ☐ Federal

D. Owner of land where treatment facility is or will be:

Prefix: Mr.

Last Name, First Name: Cole, Jr., Jimmy Edwin

Title: Owner

Credential: Click to enter text.

Organization Name: N/A

Mailing Address: P.O. Box 864

City, State, Zip Code: Montgomery, TX 77356

Phone No.: 936-537-8291

E-mail Address: jcoleelectric@yahoo.com

If the landowner is not the same person as the facility owner or co-applicant, attach a lease agreement or deed recorded easement. See instructions.

Attachment: Click to enter text.

E. Owner of effluent disposal site:

Prefix: Click to enter text.

Last Name, First Name: Click to enter text.

Title: Click to enter text.

Credential: Click to enter text.

Organization Name: Click to enter text.

Mailing Address: Click to enter text.

City, State, Zip Code: Click to enter text.

Phone No.: Click to enter text.

E-mail Address: Click to enter text.

If the landowner is not the same person as the facility owner or co-applicant, attach a lease agreement or deed recorded easement. See instructions.

Attachment: Click to enter text.

F. Owner sewage sludge disposal site (if authorization is requested for sludge disposal on property owned or controlled by the applicant):

Prefix: Click to enter text.

Last Name, First Name: Click to enter text.

Title: Click to enter text.

Credential: Click to enter text.

Organization Name: Click to enter text.

Mailing Address: Click to enter text.

City, State, Zip Code: Click to enter text.

Phone No.: Click to enter text.

E-mail Address: Click to enter text.

If the landowner is not the same person as the facility owner or co-applicant, attach a lease agreement or deed recorded easement. See instructions.

Attachment: Click to enter text.

Section 10. TPDES Discharge Information (Instructions Page 31)

A. Is the wastewater treatment facility location in the existing permit accurate?

☒ Yes ☐ No

If **no**, or a new permit application, please give an accurate description:

Click to enter text.

B. Are the point(s) of discharge and the discharge route(s) in the existing permit correct?

☒ Yes ☐ No

If **no**, or a new or amendment permit application, provide an accurate description of the point of discharge and the discharge route to the nearest classified segment as defined in 30 TAC Chapter 307:

Click to enter text.

City nearest the outfall(s): Waller

County in which the outfalls(s) is/are located: Harris

C. Is or will the treated wastewater discharge to a city, county, or state highway right-of-way, or a flood control district drainage ditch?

☐ Yes ☒ No

If **yes**, indicate by a check mark if:

- ☐ Authorization granted ☐ Authorization pending

For **new and amendment** applications, provide copies of letters that show proof of contact and the approval letter upon receipt.

Attachment: Click to enter text.

- D. For all applications involving an average daily discharge of 5 MGD or more, provide the names of all counties located within 100 statute miles downstream of the point(s) of discharge: Click to enter text.

Section 11. TLAP Disposal Information (Instructions Page 32)

- A. For TLAPs, is the location of the effluent disposal site in the existing permit accurate?

☐ Yes ☐ No

If **no, or a new or amendment permit application**, provide an accurate description of the disposal site location:

Click to enter text.

- B. City nearest the disposal site: Click to enter text.

- C. County in which the disposal site is located: Click to enter text.

- D. For TLAPs, describe the routing of effluent from the treatment facility to the disposal site:

Click to enter text.

- E. For TLAPs, please identify the nearest watercourse to the disposal site to which rainfall runoff might flow if not contained: Click to enter text.

Section 12. Miscellaneous Information (Instructions Page 32)

- A. Is the facility located on or does the treated effluent cross American Indian Land?

☐ Yes ☒ No

- B. If the existing permit contains an onsite sludge disposal authorization, is the location of the sewage sludge disposal site in the existing permit accurate?

☐ Yes ☐ No ☒ Not Applicable

If No, or if a new onsite sludge disposal authorization is being requested in this permit application, provide an accurate location description of the sewage sludge disposal site.

Click to enter text.

C. Did any person formerly employed by the TCEQ represent your company and get paid for service regarding this application?

☐ Yes ☒ No

If yes, list each person formerly employed by the TCEQ who represented your company and was paid for service regarding the application: Click to enter text.

D. Do you owe any fees to the TCEQ?

☐ Yes ☒ No

If yes, provide the following information:

Account number: Click to enter text.

Amount past due: Click to enter text.

E. Do you owe any penalties to the TCEQ?

☐ Yes ☒ No

If yes, please provide the following information:

Enforcement order number: Click to enter text.

Amount past due: Click to enter text.

Section 13. Attachments (Instructions Page 33)

Indicate which attachments are included with the Administrative Report. Check all that apply:

- ☐ Lease agreement or deed recorded easement, if the land where the treatment facility is located or the effluent disposal site are not owned by the applicant or co-applicant.
- ☒ Original full-size USGS Topographic Map with the following information:
 - Applicant's property boundary
 - Treatment facility boundary
 - Labeled point of discharge for each discharge point (TPDES only)
 - Highlighted discharge route for each discharge point (TPDES only)
 - Onsite sewage sludge disposal site (if applicable)
 - Effluent disposal site boundaries (TLAP only)
 - New and future construction (if applicable)
 - 1 mile radius information
 - 3 miles downstream information (TPDES only)
 - All ponds.
- ☒ Attachment 1 for Individuals as co-applicants
- ☒ Other Attachments. Please specify: Admin.02-Proof of Application Fee, Admin.03-Core Data Form, Admin.04-Plain Language Summary, Admin.09-SPIF

Section 14. Signature Page (Instructions Page 34)

If co-applicants are necessary, each entity must submit an original, separate signature page.

Permit Number: WQ0015838001

Applicant: Jimmy Edwin Cole, Jr.

Certification:

I certify under penalty of law that this document and all attachments were prepared under my direction or supervision in accordance with a system designed to assure that qualified personnel properly gather and evaluate the information submitted. Based on my inquiry of the person or persons who manage the system, or those persons directly responsible for gathering the information, the information submitted is, to the best of my knowledge and belief, true, accurate, and complete. I am aware there are significant penalties for submitting false information, including the possibility of fine and imprisonment for knowing violations.

I further certify that I am authorized under 30 Texas Administrative Code § 305.44 to sign and submit this document, and can provide documentation in proof of such authorization upon request.

Signatory name (typed or printed): Jimmy Edwin Cole, Jr.

Signatory title: Owner

Signature: _____

(Use blue ink)

Date: 11/13/2024

Subscribed and Sworn to before me by the said Jimmy Edwin Cole Jr

on this 13th day of November, 20 24.

My commission expires on the 21st day of October, 20 28.

Alma Gamboa

Notary Public

Montgomery
County, Texas

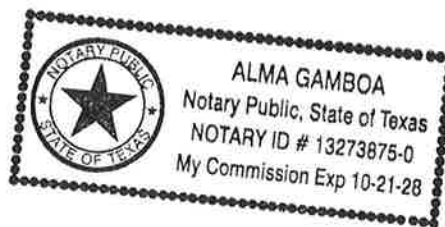

[SEAL]

DOMESTIC WASTEWATER PERMIT APPLICATION

SUPPLEMENTAL PERMIT INFORMATION FORM (SPIF)

This form applies to TPDES permit applications only. Complete and attach the Supplemental Permit information Form (SPIF) (TCEQ Form 20971).

Attachment: Admin.09



TEXAS COMMISSION ON ENVIRONMENTAL QUALITY

DOMESTIC WASTEWATER PERMIT APPLICATION TECHNICAL REPORT 1.0

For any questions about this form, please contact the Domestic Wastewater Permitting Team at 512-239-4671.

The following information is required for all renewal, new, and amendment applications.

Section 1. Permitted or Proposed Flows (Instructions Page 43)

A. Existing/Interim I Phase

Design Flow (MGD): 0.015

2-Hr Peak Flow (MGD): 0.060

Estimated construction start date: currently under construction

Estimated waste disposal start date: Q1 2025

B. Interim II Phase

Design Flow (MGD): Click to enter text.

2-Hr Peak Flow (MGD): Click to enter text.

Estimated construction start date: Click to enter text.

Estimated waste disposal start date: Click to enter text.

C. Final Phase

Design Flow (MGD): 0.025

2-Hr Peak Flow (MGD): 0.100

Estimated construction start date: unknown

Estimated waste disposal start date: unknown

D. Current Operating Phase

Provide the startup date of the facility: not yet operational

Section 2. Treatment Process (Instructions Page 43)

A. Current Operating Phase

Provide a detailed description of the treatment process. **Include the type of treatment plant, mode of operation, and all treatment units.** Start with the plant's head works and

finish with the point of discharge. Include all sludge processing and drying units. **If more than one phase exists or is proposed, a description of *each phase* must be provided.**

Flow will enter the activated sludge process with nitrification process through a coarse bar screen into the equalization/anoxic zone; thence to the aeration basin; thence to the clarifier; thence to the chlorine contact chamber for disinfection and discharge. Sludge from the bottom of the clarifier is either returned to the equalization/anoxic zone or wasted to the digester.

B. Treatment Units

In Table 1.0(1), provide the treatment unit type, the number of units, and dimensions (length, width, depth) of **each treatment unit, accounting for *all* phases of operation.**

Table 1.0(1) - Treatment Units

Treatment Unit Type	Number of Units	Dimensions (L x W x D)
Equalization Basin	1	10' W x 8' L x 9.58 ft. SWD
Aeration Basin	1	10' W x 12' L x 9.58 ft. SWD
Clarifier	1	10 ft. diam. x 9.5 ft. SWD
Chlorine Contact	1	19.36 sq. ft. x 7.0 ft. SWD
Digester	1	50.17 sq. ft. x 9.58 ft. SWD
Currently, it is not known if	the final phase will be needed	

C. Process Flow Diagram

Provide flow diagrams for the existing facilities and **each** proposed phase of construction.

Attachment: TECH.02

Section 3. Site Information and Drawing (Instructions Page 44)

Provide the TPDES discharge outfall latitude and longitude. Enter N/A if not applicable.

- Latitude: 30.432847
- Longitude: -95.712731

Provide the TLAP disposal site latitude and longitude. Enter N/A if not applicable.

- Latitude: N/A
- Longitude: N/A

Provide a site drawing for the facility that shows the following:

- The boundaries of the treatment facility;
- The boundaries of the area served by the treatment facility;
- If land disposal of effluent, the boundaries of the disposal site and all storage/holding ponds; and
- If sludge disposal is authorized in the permit, the boundaries of the land application or disposal site.

Attachment: TECH.03

Provide the name **and** a description of the area served by the treatment facility.

The facility will provide wastewater treatment to a mobile home park.

Collection System Information **for wastewater TPDES permits only:** Provide information for each **uniquely owned** collection system, existing and new, served by this facility, including satellite collection systems. **Please see the instructions for a detailed explanation and examples.**

Collection System Information

Collection System Name	Owner Name	Owner Type	Population Served
Jimmy Cole Rentals Collection System	Jimmy Edwin Cole, Jr.	Privately Owned	
		Choose an item.	
		Choose an item.	
		Choose an item.	

Section 4. Unbuilt Phases (Instructions Page 45)

Is the application for a renewal of a permit that contains an unbuilt phase or phases?

☒ Yes ☐ No

If **yes**, does the existing permit contain a phase that has not been constructed **within five years** of being authorized by the TCEQ?

☒ Yes ☐ No

If **yes**, provide a detailed discussion regarding the continued need for the unbuilt phase. **Failure to provide sufficient justification may result in the Executive Director recommending denial of the unbuilt phase or phases.**

The WWTP is currently under construction

Section 5. Closure Plans (Instructions Page 45)

Have any treatment units been taken out of service permanently, or will any units be taken out of service in the next five years?

☐ Yes ☒ No

If **yes**, was a closure plan submitted to the TCEQ?

☐ Yes ☐ No

If **yes**, provide a brief description of the closure and the date of plan approval.

Click to enter text.

Section 6. Permit Specific Requirements (Instructions Page 45)

For applicants with an existing permit, check the Other Requirements or Special Provisions of the permit.

A. Summary transmittal

Have plans and specifications been approved for the existing facilities and each proposed phase?

☒ Yes ☐ No

If **yes**, provide the date(s) of approval for each phase: 5/27/2021

Provide information, including dates, on any actions taken to meet a *requirement or provision* pertaining to the submission of a summary transmittal letter. **Provide a copy of an approval letter from the TCEQ, if applicable.**

N/A

B. Buffer zones

Have the buffer zone requirements been met?

☒ Yes ☐ No

Provide information below, including dates, on any actions taken to meet the conditions of the buffer zone. If available, provide any new documentation relevant to maintaining the buffer zones.

N/A

C. Other actions required by the current permit

Does the *Other Requirements* or *Special Provisions* section in the existing permit require submission of any other information or other required actions? Examples include Notification of Completion, progress reports, soil monitoring data, etc.

☐ Yes ☒ No

If **yes**, provide information below on the status of any actions taken to meet the conditions of an *Other Requirement* or *Special Provision*.

Click to enter text.

D. Grit and grease treatment

1. Acceptance of grit and grease waste

Does the facility have a grit and/or grease processing facility onsite that treats and decants or accepts transported loads of grit and grease waste that are discharged directly to the wastewater treatment plant prior to any treatment?

☐ Yes ☒ No

If **No**, stop here and continue with Subsection E. Stormwater Management.

2. Grit and grease processing

Describe below how the grit and grease waste is treated at the facility. In your description, include how and where the grit and grease is introduced to the treatment works and how it is separated or processed. Provide a flow diagram showing how grit and grease is processed at the facility.

Click to enter text.

3. Grit disposal

Does the facility have a Municipal Solid Waste (MSW) registration or permit for grit disposal?

☐ Yes ☒ No

If **No**, contact the TCEQ Municipal Solid Waste team at 512-239-2335. Note: A registration or permit is required for grit disposal. Grit shall not be combined with treatment plant sludge. See the instruction booklet for additional information on grit disposal requirements and restrictions.

Describe the method of grit disposal.

Click to enter text.

4. *Grease and decanted liquid disposal*

Note: A registration or permit is required for grease disposal. Grease shall not be combined with treatment plant sludge. For more information, contact the TCEQ Municipal Solid Waste team at 512-239-2335.

Describe how the decant and grease are treated and disposed of after grit separation.

Click to enter text.

E. Stormwater management

1. *Applicability*

Does the facility have a design flow of 1.0 MGD or greater in any phase?

☐ Yes ☒ No

Does the facility have an approved pretreatment program, under 40 CFR Part 403?

☐ Yes ☒ No

If no to both of the above, then skip to Subsection F, Other Wastes Received.

2. *MSGP coverage*

Is the stormwater runoff from the WWTP and dedicated lands for sewage disposal currently permitted under the TPDES Multi-Sector General Permit (MSGP), TXR050000?

☐ Yes ☐ No

If yes, please provide MSGP Authorization Number and skip to Subsection F, Other Wastes Received:

TXR05 Click to enter text. or TXRNE Click to enter text.

If no, do you intend to seek coverage under TXR050000?

☐ Yes ☐ No

3. *Conditional exclusion*

Alternatively, do you intend to apply for a conditional exclusion from permitting based TXR050000 (Multi Sector General Permit) Part II B.2 or TXR050000 (Multi Sector General Permit) Part V, Sector T 3(b)?

☐ Yes ☐ No

If yes, please explain below then proceed to Subsection F, Other Wastes Received:

Click to enter text.

4. Existing coverage in individual permit

Is your stormwater discharge currently permitted through this individual TPDES or TLAP permit?

☐ Yes ☐ No

If yes, provide a description of stormwater runoff management practices at the site that are authorized in the wastewater permit then skip to Subsection F, Other Wastes Received.

Click to enter text.

5. Zero stormwater discharge

Do you intend to have no discharge of stormwater via use of evaporation or other means?

☐ Yes ☐ No

If yes, explain below then skip to Subsection F. Other Wastes Received.

Click to enter text.

Note: If there is a potential to discharge any stormwater to surface water in the state as the result of any storm event, then permit coverage is required under the MSGP or an individual discharge permit. This requirement applies to all areas of facilities with treatment plants or systems that treat, store, recycle, or reclaim domestic sewage, wastewater or sewage sludge (including dedicated lands for sewage sludge disposal located within the onsite property boundaries) that meet the applicability criteria of above. You have the option of obtaining coverage under the MSGP for direct discharges, (recommended), or obtaining coverage under this individual permit.

6. Request for coverage in individual permit

Are you requesting coverage of stormwater discharges associated with your treatment plant under this individual permit?

☐ Yes ☐ No

If yes, provide a description of stormwater runoff management practices at the site for which you are requesting authorization in this individual wastewater permit and describe whether you intend to comingle this discharge with your treated effluent or discharge it via a separate dedicated stormwater outfall. Please also indicate if you intend to divert stormwater to the treatment plant headworks and indirectly discharge it to water in the state.

Click to enter text.

Note: Direct stormwater discharges to waters in the state authorized through this individual permit will require the development and implementation of a stormwater pollution prevention plan (SWPPP) and will be subject to additional monitoring and reporting requirements. Indirect discharges of stormwater via headworks recycling will require compliance with all individual permit requirements including 2-hour peak flow limitations. All stormwater discharge authorization requests will require additional information during the technical review of your application.

F. Discharges to the Lake Houston Watershed

Does the facility discharge in the Lake Houston watershed?

☐ Yes ☒ No

If yes, attach a Sewage Sludge Solids Management Plan. See Example 5 in the instructions.
[Click to enter text.](#)

G. Other wastes received including sludge from other WWTPs and septic waste

1. Acceptance of sludge from other WWTPs

Does or will the facility accept sludge from other treatment plants at the facility site?

☐ Yes ☒ No

If yes, attach sewage sludge solids management plan. See Example 5 of the instructions.

In addition, provide the date the plant started or is anticipated to start accepting sludge, an estimate of monthly sludge acceptance (gallons or millions of gallons), an estimate of the BOD₅ concentration of the sludge, and the design BOD₅ concentration of the influent from the collection system. Also note if this information has or has not changed since the last permit action.

Click to enter text.

Note: Permits that accept sludge from other wastewater treatment plants may be required to have influent flow and organic loading monitoring.

2. Acceptance of septic waste

Is the facility accepting or will it accept septic waste?

☐ Yes ☒ No

If yes, does the facility have a Type V processing unit?

☐ Yes ☐ No

If yes, does the unit have a Municipal Solid Waste permit?

☐ Yes ☐ No

If **yes** to any of the above, provide the date the plant started or is anticipated to start accepting septic waste, an estimate of monthly septic waste acceptance (gallons or millions of gallons), an estimate of the BOD₅ concentration of the septic waste, and the design BOD₅ concentration of the influent from the collection system. Also note if this information has or has not changed since the last permit action.

Click to enter text.

Note: Permits that accept sludge from other wastewater treatment plants may be required to have influent flow and organic loading monitoring.

3. Acceptance of other wastes (not including septic, grease, grit, or RCRA, CERCLA or as discharged by IUs listed in Worksheet 6)

Is or will the facility accept wastes that are not domestic in nature excluding the categories listed above?

☐ Yes ☒ No

If **yes**, provide the date that the plant started accepting the waste, an estimate how much waste is accepted on a monthly basis (gallons or millions of gallons), a description of the entities generating the waste, and any distinguishing chemical or other physical characteristic of the waste. Also note if this information has or has not changed since the last permit action.

Click to enter text.

Section 7. Pollutant Analysis of Treated Effluent (Instructions Page 50)

Is the facility in operation?

☐ Yes ☒ No

If **no**, this section is not applicable. Proceed to Section 8.

If **yes**, provide effluent analysis data for the listed pollutants. **Wastewater treatment facilities** complete Table 1.0(2). **Water treatment facilities** discharging filter backwash water, complete Table 1.0(3). Provide copies of the laboratory results sheets. **These tables are not applicable for a minor amendment without renewal.** See the instructions for guidance.

Note: The sample date must be within 1 year of application submission.

Table 1.0(2) – Pollutant Analysis for Wastewater Treatment Facilities

Pollutant	Average Conc.	Max Conc.	No. of Samples	Sample Type	Sample Date/Time
CBOD ₅ , mg/l					
Total Suspended Solids, mg/l					
Ammonia Nitrogen, mg/l					
Nitrate Nitrogen, mg/l					

Total Kjeldahl Nitrogen, mg/l					
Sulfate, mg/l					
Chloride, mg/l					
Total Phosphorus, mg/l					
pH, standard units					
Dissolved Oxygen*, mg/l					
Chlorine Residual, mg/l					
<i>E.coli</i> (CFU/100ml) freshwater					
Enterococci (CFU/100ml) saltwater					
Total Dissolved Solids, mg/l					
Electrical Conductivity, μ mohs/cm, †					
Oil & Grease, mg/l					
Alkalinity (CaCO ₃)*, mg/l					

*TPDES permits only

†TLAP permits only

Table 1.0(3) – Pollutant Analysis for Water Treatment Facilities

Pollutant	Average Conc.	Max Conc.	No. of Samples	Sample Type	Sample Date/Time
Total Suspended Solids, mg/l					
Total Dissolved Solids, mg/l					
pH, standard units					
Fluoride, mg/l					
Aluminum, mg/l					
Alkalinity (CaCO ₃), mg/l					

Section 8. Facility Operator (Instructions Page 50)

Facility Operator Name: FloWatch, Inc.

Facility Operator's License Classification and Level: C or higher

Facility Operator's License Number: OC0000181

Section 9. Sludge and Biosolids Management and Disposal (Instructions Page 51)

A. WWTP's Biosolids Management Facility Type

Check all that apply. See instructions for guidance

- ☐ Design flow \geq 1 MGD
- ☐ Serves \geq 10,000 people
- ☐ Class I Sludge Management Facility (per 40 CFR § 503.9)
- ☒ Biosolids generator
- ☐ Biosolids end user – land application (onsite)
- ☐ Biosolids end user – surface disposal (onsite)
- ☐ Biosolids end user – incinerator (onsite)

B. WWTP's Biosolids Treatment Process

Check all that apply. See instructions for guidance.

- ☒ Aerobic Digestion
- ☐ Air Drying (or sludge drying beds)
- ☐ Lower Temperature Composting
- ☐ Lime Stabilization
- ☐ Higher Temperature Composting
- ☐ Heat Drying
- ☐ Thermophilic Aerobic Digestion
- ☐ Beta Ray Irradiation
- ☐ Gamma Ray Irradiation
- ☐ Pasteurization
- ☐ Preliminary Operation (e.g. grinding, de-gritting, blending)
- ☐ Thickening (e.g. gravity thickening, centrifugation, filter press, vacuum filter)
- ☐ Sludge Lagoon
- ☐ Temporary Storage (< 2 years)
- ☐ Long Term Storage (≥ 2 years)
- ☐ Methane or Biogas Recovery
- ☐ Other Treatment Process: Click to enter text.

C. Biosolids Management

Provide information on the *intended* biosolids management practice. Do not enter every management practice that you want authorized in the permit, as the permit will authorize all biosolids management practices listed in the instructions. Rather indicate the management practice the facility plans to use.

Biosolids Management

Management Practice	Handler or Preparer Type	Bulk or Bag Container	Amount (dry metric tons)	Pathogen Reduction Options	Vector Attraction Reduction Option
Other	Off-site Third-Party Handler or Preparer	Not Applicable		Domestic Septage: pH	Choose an item.
Choose an item.	Choose an item.	Choose an item.		Choose an item.	Choose an item.
Choose an item.	Choose an item.	Choose an item.		Choose an item.	Choose an item.

If "Other" is selected for Management Practice, please explain (e.g. monofill or transport to another WWTP): Transport to another WWTP

D. Disposal site

Disposal site name: Mt. Houston Road MUD WWTP

TCEQ permit or registration number: WQ0011154001

County where disposal site is located: Harris

E. Transportation method

Method of transportation (truck, train, pipe, other): truck

Name of the hauler: Magna Flow Environmental

Hauler registration number: 21484

Sludge is transported as a:

Liquid ☒ semi-liquid ☐ semi-solid ☐ solid ☐

Section 10. Permit Authorization for Sewage Sludge Disposal (Instructions Page 53)

A. Beneficial use authorization

Does the existing permit include authorization for land application of sewage sludge for beneficial use?

☐ Yes ☒ No

If **yes**, are you requesting to continue this authorization to land apply sewage sludge for beneficial use?

☐ Yes ☐ No

If **yes**, is the completed **Application for Permit for Beneficial Land Use of Sewage Sludge (TCEQ Form No. 10451)** attached to this permit application (see the instructions for details)?

☐ Yes ☐ No

B. Sludge processing authorization

Does the existing permit include authorization for any of the following sludge processing, storage or disposal options?

- | | | |
|--|------------------------------|--|
| Sludge Composting | <input type="checkbox"/> Yes | <input checked="" type="checkbox"/> No |
| Marketing and Distribution of sludge | <input type="checkbox"/> Yes | <input checked="" type="checkbox"/> No |
| Sludge Surface Disposal or Sludge Monofill | <input type="checkbox"/> Yes | <input checked="" type="checkbox"/> No |
| Temporary storage in sludge lagoons | <input type="checkbox"/> Yes | <input checked="" type="checkbox"/> No |

If **yes** to any of the above sludge options and the applicant is requesting to continue this authorization, is the completed **Domestic Wastewater Permit Application: Sewage Sludge Technical Report (TCEQ Form No. 10056)** attached to this permit application?

- ☐ Yes ☐ No

Section 11. Sewage Sludge Lagoons (Instructions Page 53)

Does this facility include sewage sludge lagoons?

- ☐ Yes ☒ No

If yes, complete the remainder of this section. If no, proceed to Section 12.

A. Location information

The following maps are required to be submitted as part of the application. For each map, provide the Attachment Number.

- Original General Highway (County) Map:
Attachment: [Click to enter text.](#)
- USDA Natural Resources Conservation Service Soil Map:
Attachment: [Click to enter text.](#)
- Federal Emergency Management Map:
Attachment: [Click to enter text.](#)
- Site map:
Attachment: [Click to enter text.](#)

Discuss in a description if any of the following exist within the lagoon area. Check all that apply.

- ☐ Overlap a designated 100-year frequency flood plain
- ☐ Soils with flooding classification
- ☐ Overlap an unstable area
- ☐ Wetlands
- ☐ Located less than 60 meters from a fault
- ☐ None of the above

Attachment: [Click to enter text.](#)

If a portion of the lagoon(s) is located within the 100-year frequency flood plain, provide the protective measures to be utilized including type and size of protective structures:

Click to enter text.

B. Temporary storage information

Provide the results for the pollutant screening of sludge lagoons. These results are in addition to pollutant results in *Section 7 of Technical Report 1.0*.

Nitrate Nitrogen, mg/kg: Click to enter text.

Total Kjeldahl Nitrogen, mg/kg: Click to enter text.

Total Nitrogen (=nitrate nitrogen + TKN), mg/kg: Click to enter text.

Phosphorus, mg/kg: Click to enter text.

Potassium, mg/kg: Click to enter text.

pH, standard units: Click to enter text.

Ammonia Nitrogen mg/kg: Click to enter text.

Arsenic: Click to enter text.

Cadmium: Click to enter text.

Chromium: Click to enter text.

Copper: Click to enter text.

Lead: Click to enter text.

Mercury: Click to enter text.

Molybdenum: Click to enter text.

Nickel: Click to enter text.

Selenium: Click to enter text.

Zinc: Click to enter text.

Total PCBs: Click to enter text.

Provide the following information:

Volume and frequency of sludge to the lagoon(s): Click to enter text.

Total dry tons stored in the lagoons(s) per 365-day period: Click to enter text.

Total dry tons stored in the lagoons(s) over the life of the unit: Click to enter text.

C. Liner information

Does the active/proposed sludge lagoon(s) have a liner with a maximum hydraulic conductivity of 1×10^{-7} cm/sec?

☐ Yes ☐ No

If yes, describe the liner below. Please note that a liner is required.

Click to enter text.

D. Site development plan

Provide a detailed description of the methods used to deposit sludge in the lagoon(s):

Click to enter text.

Attach the following documents to the application.

- Plan view and cross-section of the sludge lagoon(s)
Attachment: [Click to enter text.](#)
- Copy of the closure plan
Attachment: [Click to enter text.](#)
- Copy of deed recordation for the site
Attachment: [Click to enter text.](#)
- Size of the sludge lagoon(s) in surface acres and capacity in cubic feet and gallons
Attachment: [Click to enter text.](#)
- Description of the method of controlling infiltration of groundwater and surface water from entering the site
Attachment: [Click to enter text.](#)
- Procedures to prevent the occurrence of nuisance conditions
Attachment: [Click to enter text.](#)

E. Groundwater monitoring

Is groundwater monitoring currently conducted at this site, or are any wells available for groundwater monitoring, or are groundwater monitoring data otherwise available for the sludge lagoon(s)?

☐ Yes ☐ No

If groundwater monitoring data are available, provide a copy. Provide a profile of soil types encountered down to the groundwater table and the depth to the shallowest groundwater as a separate attachment.

Attachment: [Click to enter text.](#)

Section 12. Authorizations/Compliance/Enforcement (Instructions)

A. Additional authorizations

Does the permittee have additional authorizations for this facility, such as reuse authorization, sludge permit, etc?

☐ Yes ☒ No

If yes, provide the TCEQ authorization number and description of the authorization:

Click to enter text.

B. Permittee enforcement status

Is the permittee currently under enforcement for this facility?

☐ Yes ☒ No

Is the permittee required to meet an implementation schedule for compliance or enforcement?

☐ Yes ☒ No

If yes to either question, provide a brief summary of the enforcement, the implementation schedule, and the current status:

Click to enter text.

Section 13. RCRA/CERCLA Wastes (Instructions Page 55)**A. RCRA hazardous wastes**

Has the facility received in the past three years, does it currently receive, or will it receive RCRA hazardous waste?

☐ Yes ☒ No

B. Remediation activity wastewater

Has the facility received in the past three years, does it currently receive, or will it receive CERCLA wastewater, RCRA remediation/corrective action wastewater or other remediation activity wastewater?

☐ Yes ☒ No

C. Details about wastes received

If yes to either Subsection A or B above, provide detailed information concerning these wastes with the application.

Attachment: [Click to enter text.](#)

Section 14. Laboratory Accreditation (Instructions Page 56)

All laboratory tests performed must meet the requirements of *30 TAC Chapter 25, Environmental Testing Laboratory Accreditation and Certification*, which includes the following general exemptions from National Environmental Laboratory Accreditation Program (NELAP) certification requirements:

- The laboratory is an in-house laboratory and is:
 - periodically inspected by the TCEQ; or
 - located in another state and is accredited or inspected by that state; or
 - performing work for another company with a unit located in the same site; or
 - performing pro bono work for a governmental agency or charitable organization.
- The laboratory is accredited under federal law.
- The data are needed for emergency-response activities, and a laboratory accredited under the Texas Laboratory Accreditation Program is not available.
- The laboratory supplies data for which the TCEQ does not offer accreditation.

The applicant should review 30 TAC Chapter 25 for specific requirements.

The following certification statement shall be signed and submitted with every application. See the Signature Page section in the Instructions, for a list of designated representatives who may sign the certification.

CERTIFICATION:

I certify that all laboratory tests submitted with this application meet the requirements of *30 TAC Chapter 25, Environmental Testing Laboratory Accreditation and Certification*.

Printed Name: N/A – Plant not in operation

Title:

Signature: _____

Date: _____

DOMESTIC WASTEWATER PERMIT APPLICATION

WORKSHEET 2.0: RECEIVING WATERS

The following information is required for all TPDES permit applications.

Section 1. Domestic Drinking Water Supply (Instructions Page 64)

Is there a surface water intake for domestic drinking water supply located within 5 miles downstream from the point or proposed point of discharge?

☐ Yes ☒ No

If **no**, proceed to Section 2. If **yes**, provide the following:

Owner of the drinking water supply: [Click to enter text.](#)

Distance and direction to the intake: [Click to enter text.](#)

Attach a USGS map that identifies the location of the intake.

Attachment: [Click to enter text.](#)

Section 2. Discharge into Tidally Affected Waters (Instructions Page 64)

Does the facility discharge into tidally affected waters?

☐ Yes ☒ No

If **no**, proceed to Section 3. If **yes**, complete the remainder of this section. If **no**, proceed to Section 3.

A. Receiving water outfall

Width of the receiving water at the outfall, in feet: [Click to enter text.](#)

B. Oyster waters

Are there oyster waters in the vicinity of the discharge?

☐ Yes ☐ No

If **yes**, provide the distance and direction from outfall(s).

[Click to enter text.](#)

C. Sea grasses

Are there any sea grasses within the vicinity of the point of discharge?

☐ Yes ☐ No

If **yes**, provide the distance and direction from the outfall(s).

[Click to enter text.](#)

Section 3. Classified Segments (Instructions Page 64)

Is the discharge directly into (or within 300 feet of) a classified segment?

☐ Yes ☒ No

If **yes**, this Worksheet is complete.

If **no**, complete Sections 4 and 5 of this Worksheet.

Section 4. Description of Immediate Receiving Waters (Instructions Page 65)

Name of the immediate receiving waters: unnamed tributary of Little Lake Creek

A. Receiving water type

Identify the appropriate description of the receiving waters.

☒ Stream

☐ Freshwater Swamp or Marsh

☐ Lake or Pond

Surface area, in acres: Click to enter text.

Average depth of the entire water body, in feet: Click to enter text.

Average depth of water body within a 500-foot radius of discharge point, in feet:
Click to enter text.

☐ Man-made Channel or Ditch

☐ Open Bay

☐ Tidal Stream, Bayou, or Marsh

☐ Other, specify: Click to enter text.

B. Flow characteristics

If a stream, man-made channel or ditch was checked above, provide the following. For existing discharges, check one of the following that best characterizes the area *upstream* of the discharge. For new discharges, characterize the area *downstream* of the discharge (check one).

☒ Intermittent - dry for at least one week during most years

☐ Intermittent with Perennial Pools - enduring pools with sufficient habitat to maintain significant aquatic life uses

☐ Perennial - normally flowing

Check the method used to characterize the area upstream (or downstream for new dischargers).

☐ USGS flow records

☐ Historical observation by adjacent landowners

☒ Personal observation

☐ Other, specify: Click to enter text.

C. Downstream perennial confluences

List the names of all perennial streams that join the receiving water within three miles downstream of the discharge point.

Little Lake Creek

D. Downstream characteristics

Do the receiving water characteristics change within three miles downstream of the discharge (e.g., natural or man-made dams, ponds, reservoirs, etc.)?

☐ Yes ☒ No

If yes, discuss how.

3.5 – 4 miles downstream Little Lake Creek enters Lake Conroe

E. Normal dry weather characteristics

Provide general observations of the water body during normal dry weather conditions.

The unnamed tributary of Little Lake Creek in intermittent

Date and time of observation: 7/9/2019 @ 10:30

Was the water body influenced by stormwater runoff during observations?

☐ Yes ☒ No

Section 5. General Characteristics of the Waterbody (Instructions Page 66)

A. Upstream influences

Is the immediate receiving water upstream of the discharge or proposed discharge site influenced by any of the following? Check all that apply.

☐ Oil field activities

☐ Urban runoff

☐ Upstream discharges

☐ Agricultural runoff

☐ Septic tanks

☐ Other(s), specify: Click to enter text.

B. Waterbody uses

Observed or evidences of the following uses. Check all that apply.

- | | |
|--|---|
| <input type="checkbox"/> Livestock watering | <input type="checkbox"/> Contact recreation |
| <input type="checkbox"/> Irrigation withdrawal | <input type="checkbox"/> Non-contact recreation |
| <input type="checkbox"/> Fishing | <input type="checkbox"/> Navigation |
| <input type="checkbox"/> Domestic water supply | <input type="checkbox"/> Industrial water supply |
| <input type="checkbox"/> Park activities | <input checked="" type="checkbox"/> Other(s), specify: <u>unknown</u> |

C. Waterbody aesthetics

Check one of the following that best describes the aesthetics of the receiving water and the surrounding area.

- ☐ Wilderness: outstanding natural beauty; usually wooded or unpastured area; water clarity exceptional
- ☒ Natural Area: trees and/or native vegetation; some development evident (from fields, pastures, dwellings); water clarity discolored
- ☐ Common Setting: not offensive; developed but uncluttered; water may be colored or turbid
- ☐ Offensive: stream does not enhance aesthetics; cluttered; highly developed; dumping areas; water discolored

ATTACHMENT ADMIN.01

USGS Topographic Map

(Reference Administrative Report 1.0, Page 10, Question 13)

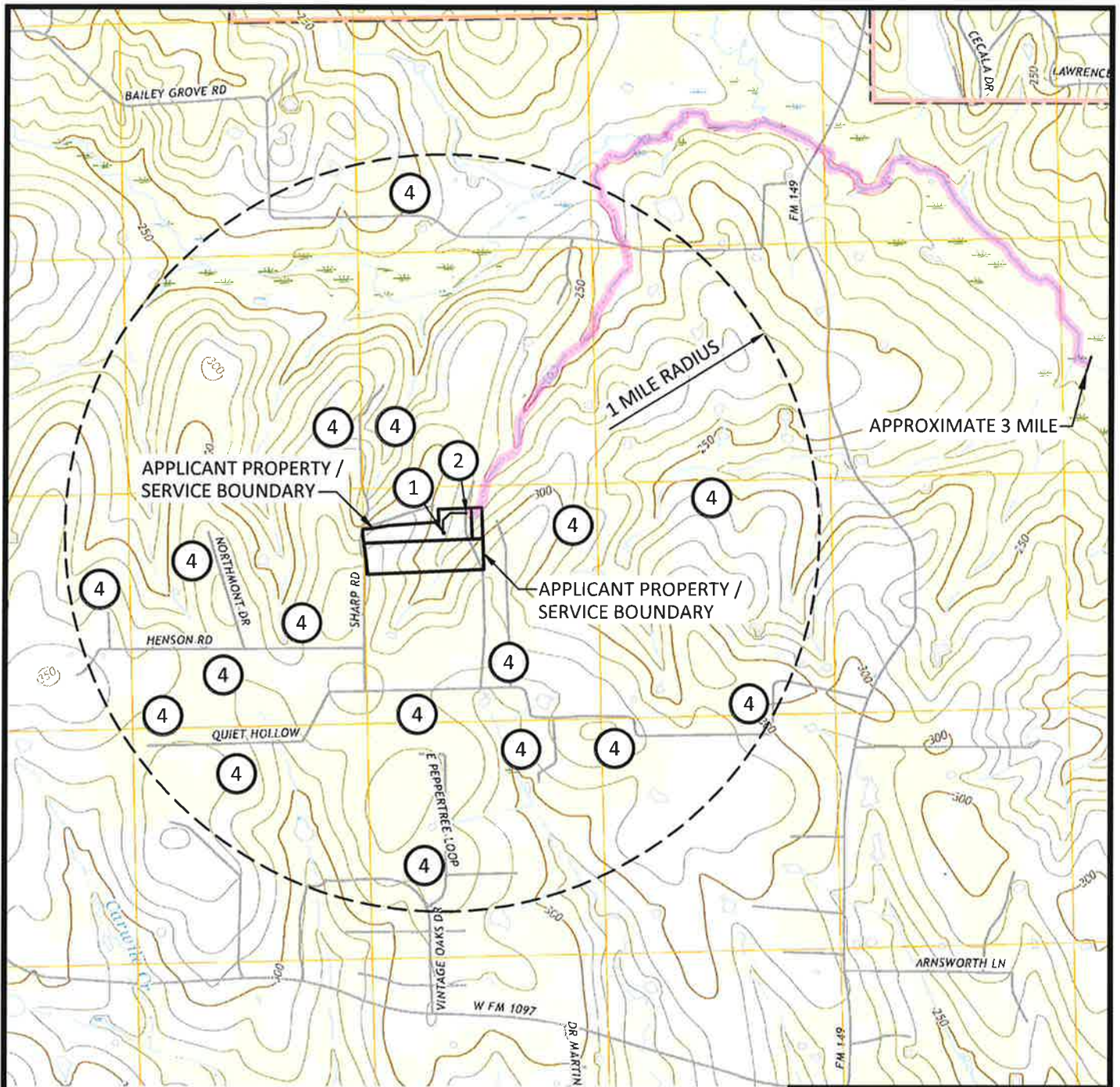

LEGEND

- 1 APPLICANT'S WASTEWATER TREATMENT PLANT
- 2 POINT OF DISCHARGE
- 3 COMMERCIAL DEVELOPMENT
- 4 HOUSING DEVELOPMENT
- 5 INDUSTRIAL SITE
- 6 PARK
- 7 SCHOOLS
- 8 RECREATIONAL AREA
- 9 PUBLIC WATER WELL
- 10 EXISTING WWTP (OWNED BY OTHERS)

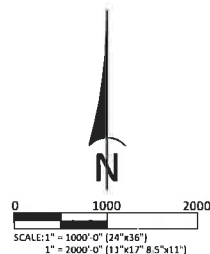

THIS DRAWING CONTAINS CONFIDENTIAL PROPRIETARY INFORMATION AND MAY NOT BE REPRODUCED, COPIED, OR USED TO CONSTRUCT ANY PROJECT OTHER THAN THAT FOR WHICH IT WAS ISSUED WITHOUT PRIOR PERMISSION FROM WATERENGINEERS, INC.

WATERENGINEERS, INC.
 Water & Wastewater Treatment Consultants
 TEXAS BOARD OF PROFESSIONAL ENGINEERS FIRM No. 2066
 17230 HUFFMEISTER ROAD TEL: 281-373-0500
 CYPRESS, TEXAS 77429 FAX: 281-373-1113

JIMMY EDWIN COLE, JR - APPLICANT
 JIMMY COLE RENTALS WWTP
 APPLICATION FOR RENEWAL WITH MINOR
 AMENDMENT TO TPDES PERMIT No.
 WQ00015838001

USGS MAP

DRAWN BY: BIR
 APPROVED BY: SBY
 SCALE: AS NOTED
 DATE: 11/11/2024
 JOB No.: 5913-24183

DWG. NO.:
ADMIN.01

ATTACHMENT ADMIN.02

Proof of Payment

(Reference Administrative Report 1.0, Page 10, Question 13)

ATTACHMENT ADMIN.03

Core Data Form

(Reference Administrative Report 1.0, Page 4, Section 3C)



TCEQ Use Only

TCEQ Core Data Form

For detailed instructions regarding completion of this form, please read the Core Data Form Instructions or call 512-239-5175.

SECTION I: General Information

1. Reason for Submission (If other is checked please describe in space provided.) <input type="checkbox"/> New Permit, Registration or Authorization (Core Data Form should be submitted with the program application.) <input checked="" type="checkbox"/> Renewal (Core Data Form should be submitted with the renewal form) <input checked="" type="checkbox"/> Other with minor amendment		
2. Customer Reference Number (if issued) CN 605724418	Follow this link to search for CN or RN numbers in Central Registry**	3. Regulated Entity Reference Number (if issued) RN 110898053

SECTION II: Customer Information

4. General Customer Information		5. Effective Date for Customer Information Updates (mm/dd/yyyy)	
<input type="checkbox"/> New Customer <input type="checkbox"/> Change in Legal Name (Verifiable with the Texas Secretary of State or Texas Comptroller of Public Accounts)		<input type="checkbox"/> Update to Customer Information <input type="checkbox"/> Change in Regulated Entity Ownership	
The Customer Name submitted here may be updated automatically based on what is current and active with the Texas Secretary of State (SOS) or Texas Comptroller of Public Accounts (CPA).			
6. Customer Legal Name (If an individual, print last name first: eg: Doe, John) Jimmy Edwin Cole, Jr.		If new Customer, enter previous Customer below:	
7. TX SOS/CPA Filing Number N/A	8. TX State Tax ID (11 digits) N/A	9. Federal Tax ID (9 digits)	10. DUNS Number (if applicable)
11. Type of Customer: <input type="checkbox"/> Corporation <input checked="" type="checkbox"/> Individual Government: <input type="checkbox"/> City <input type="checkbox"/> County <input type="checkbox"/> Federal <input type="checkbox"/> State <input type="checkbox"/> Other <input type="checkbox"/> Sole Proprietorship		Partnership: <input type="checkbox"/> General <input type="checkbox"/> Limited <input type="checkbox"/> Other:	
12. Number of Employees <input checked="" type="checkbox"/> 0-20 <input type="checkbox"/> 21-100 <input type="checkbox"/> 101-250 <input type="checkbox"/> 251-500 <input type="checkbox"/> 501 and higher		13. Independently Owned and Operated? <input checked="" type="checkbox"/> Yes <input type="checkbox"/> No	
14. Customer Role (Proposed or Actual) – as it relates to the Regulated Entity listed on this form. Please check one of the following: <input checked="" type="checkbox"/> Owner <input type="checkbox"/> Operator <input type="checkbox"/> Owner & Operator <input type="checkbox"/> Occupational Licensee <input type="checkbox"/> Responsible Party <input type="checkbox"/> Voluntary Cleanup Applicant <input type="checkbox"/> Other:			
15. Mailing Address: P.O. Box 864 City: Montgomery State: TX ZIP: 77356 ZIP + 4: 0864			
16. Country Mailing Information (if outside USA)		17. E-Mail Address (if applicable) jcoleelectric@yahoo.com	
18. Telephone Number (936) 537-8291	19. Extension or Code	20. Fax Number (if applicable) () -	

SECTION III: Regulated Entity Information

21. General Regulated Entity Information (If 'New Regulated Entity' is selected below this form should be accompanied by a permit application) <input type="checkbox"/> New Regulated Entity <input type="checkbox"/> Update to Regulated Entity Name <input type="checkbox"/> Update to Regulated Entity Information	
The Regulated Entity Name submitted may be updated in order to meet TCEQ Agency Data Standards (removal of organizational endings such as Inc, LP, or LLC.)	
22. Regulated Entity Name (Enter name of the site where the regulated action is taking place.) Jimmy Cole Rentals Wastewater Treatment Plant	

23. Street Address of the Regulated Entity: (No PO Boxes)	23520 Sharp Road							
	City	Montgomery	State	TX	ZIP	77356	ZIP + 4	
24. County	Montgomery							

Enter Physical Location Description if no street address is provided.

25. Description to Physical Location:								
26. Nearest City					State		Nearest ZIP Code	
Montgomery					TX		77356	
27. Latitude (N) In Decimal:		30.432328			28. Longitude (W) In Decimal:		95.713725	
Degrees	Minutes	Seconds	Degrees	Minutes	Seconds			
30	25	56.38	-95	42	49.41			
29. Primary SIC Code (4 digits)		30. Secondary SIC Code (4 digits)		31. Primary NAICS Code (5 or 6 digits)		32. Secondary NAICS Code (5 or 6 digits)		
6515				531190				
33. What is the Primary Business of this entity? (Do not repeat the SIC or NAICS description.)								
Mobile home park								
34. Mailing Address:		P.O. Box 864						
		City	Montgomery	State	TX	ZIP	77356	ZIP + 4
35. E-Mail Address:		jcoleelectric@yaghoo.com						
36. Telephone Number			37. Extension or Code			38. Fax Number (if applicable)		
(936) 537-8291						() -		

39. TCEQ Programs and ID Numbers Check all Programs and write in the permits/registration numbers that will be affected by the updates submitted on this form. See the Core Data Form instructions for additional guidance.

<input type="checkbox"/> Dam Safety	<input type="checkbox"/> Districts	<input type="checkbox"/> Edwards Aquifer	<input type="checkbox"/> Emissions Inventory Air	<input type="checkbox"/> Industrial Hazardous Waste
<input type="checkbox"/> Municipal Solid Waste	<input type="checkbox"/> New Source Review Air	<input type="checkbox"/> OSSF	<input type="checkbox"/> Petroleum Storage Tank	<input type="checkbox"/> PWS
<input type="checkbox"/> Sludge	<input type="checkbox"/> Storm Water	<input type="checkbox"/> Title V Air	<input type="checkbox"/> Tires	<input type="checkbox"/> Used Oil
<input type="checkbox"/> Voluntary Cleanup	<input checked="" type="checkbox"/> Waste Water	<input type="checkbox"/> Wastewater Agriculture	<input type="checkbox"/> Water Rights	<input type="checkbox"/> Other:
WQ0015838001				

SECTION IV: Preparer Information

40. Name:	Shelley Young	41. Title:	Consulting Engineer
42. Telephone Number	43. Ext./Code	44. Fax Number	45. E-Mail Address
(281) 373-0500		(281) 373-1113	syoung@waterengineers.com

SECTION V: Authorized Signature

46. By my signature below, I certify, to the best of my knowledge, that the information provided in this form is true and complete, and that I have signature authority to submit this form on behalf of the entity specified in Section II, Field 6 and/or as required for the updates to the ID numbers identified in field 39.

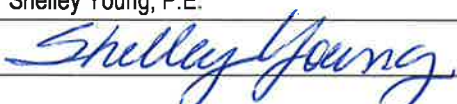
Company:	WaterEngineers, Inc.	Job Title:	Consulting Engineer
Name(In Print) :	Shelley Young, P.E.	Phone:	(281) 373-500
Signature:		Date:	11/11/2024

ATTACHMENT ADMIN.04

Plain Language Summary

(Reference Administrative Report 1.0, Page 7, Section 8F)



TEXAS COMMISSION ON ENVIRONMENTAL QUALITY

PLAIN LANGUAGE SUMMARY FOR TPDES OR TLAP PERMIT APPLICATIONS

Plain Language Summary Template and Instructions for Texas Pollutant Discharge Elimination System (TPDES) and Texas Land Application (TLAP) Permit Applications

Applicants should use this template to develop a plain language summary as required by Title 30, Texas Administrative Code (30 TAC), Chapter 39, Subchapter H. Applicants may modify the template as necessary to accurately describe their facility as long as the summary includes the following information: (1) the function of the proposed plant or facility; (2) the expected output of the proposed plant or facility; (3) the expected pollutants that may be emitted or discharged by the proposed plant or facility; and (4) how the applicant will control those pollutants, so that the proposed plant will not have an adverse impact on human health or the environment.

Fill in the highlighted areas below to describe your facility and application in plain language. Instructions and examples are provided below. Make any other edits necessary to improve readability or grammar and to comply with the rule requirements.

If you are subject to the alternative language notice requirements in 30 TAC Section 39.426, **you must provide a translated copy of the completed plain language summary in the appropriate alternative language as part of your application package**. For your convenience, a Spanish template has been provided below.

ENGLISH TEMPLATE FOR TPDES or TLAP NEW/RENEWAL/AMENDMENT APPLICATIONS Enter 'INDUSTRIAL' or 'DOMESTIC' here WASTEWATER/STORMWATER

The following summary is provided for this pending water quality permit application being reviewed by the Texas Commission on Environmental Quality as required by 30 TAC Chapter 39. The information provided in this summary may change during the technical review of the application and is not a federal enforceable representation of the permit application.

Jimmy Edwin Cole, Jr. (CN605724418) proposes to operate the Jimmy Cole Rentals Wastewater Treatment Plant (RN110898053), an activated sludge process with nitrification operated in the complete mix mode. The facility is located at 23520 Sharp Road, in Montgomery, Montgomery County, Texas 77356. This application for a renewal with minor amendment application to discharge a daily average flow of 25,000 gallons per day of treated domestic wastewater..

Discharges from the facility are expected to contain five-day carbonaceous biochemical oxygen demand (CBOD₅), total suspended solids (TSS), ammonia nitrogen (NH₃-N), and *Escherichia coli*. Additional potential pollutants are included in the Domestic Technical Report 1.0, Section 7. Pollutant Analysis of Treated Effluent in the permit application package. Domestic wastewater is treated by an activated sludge process plant and the treatment units include a bar screen, selector basin, aeration basin, final clarifier, sludge digester, and chlorine contact chamber.

**PLANTILLA EN ESPAÑOL PARA SOLICITUDES NUEVAS/RENOVACIONES/ENMIENDAS DE
TPDES o TLAP**

AGUAS RESIDUALES Introduzca 'INDUSTRIALES' o 'DOMÉSTICAS' aquí /AGUAS PLUVIALES

El siguiente resumen se proporciona para esta solicitud de permiso de calidad del agua pendiente que está siendo revisada por la Comisión de Calidad Ambiental de Texas según lo requerido por el Capítulo 39 del Código Administrativo de Texas 30. La información proporcionada en este resumen puede cambiar durante la revisión técnica de la solicitud y no es una representación ejecutiva fedérale de la solicitud de permiso.

Jimmy Edwin Cole, Jr. (CN605724418) propone operar la Planta de Tratamiento de Aguas Residuales de Jimmy Cole Rentals (RN 110898053), un proceso de lodos activados con nitrificación operado en el modo de mezcla completa. La instalación está ubicada en 23520 Camino Sharp, en Montgomery, Condado de Montgomery, Texas 77356.. Esta solicitud es para una renovación aplicación para descargar a un flujo promedio diario de 25,000 galones por día de aguas residuales domésticas tratadas.

Se espera que las descargas de la instalación contengan demanda bioquímica de oxígeno carbonoso de cinco días (CBOD₅), sólidos totalmente suspendidos (TSS), nitrógeno amoniacal (NH₄-N), y *Escherichia coli*. Los contaminantes potenciales adicionales se incluyen en el Informe Técnico Domésticas 1.0, Sección 7 Análisis de Contaminantes de Efluente Tratado en el paquete de solicitud de permisos. Las aguas residuales domésticas. está tratado por una planta de proceso de lodos activados y las unidades de tratamiento incluirán una pantalla de barras, balsa de selector, balsa de aireación, clarificador finale, digestora de lodos, y cámara de contacto de cloro.

ATTACHMENT ADMIN.09
Supplemental Permit Information Form
and USGS Map
(Reference Administrative Report Page 14)

TEXAS COMMISSION ON ENVIRONMENTAL QUALITY

SUPPLEMENTAL PERMIT INFORMATION FORM (SPIF)

FOR AGENCIES REVIEWING DOMESTIC OR INDUSTRIAL TPDES WASTEWATER PERMIT APPLICATIONS

TCEQ USE ONLY:

Application type: ____ Renewal ____ Major Amendment ____ Minor Amendment ____ New

County: _____ Segment Number: _____

Admin Complete Date: _____

Agency Receiving SPIF:

____ Texas Historical Commission

____ U.S. Fish and Wildlife

____ Texas Parks and Wildlife Department

____ U.S. Army Corps of Engineers

This form applies to TPDES permit applications only. (Instructions, Page 53)

Complete this form as a separate document. TCEQ will mail a copy to each agency as required by our agreement with EPA. If any of the items are not completely addressed or further information is needed, we will contact you to provide the information before issuing the permit. Address each item completely.

Do not refer to your response to any item in the permit application form. Provide each attachment for this form separately from the Administrative Report of the application. The application will not be declared administratively complete without this SPIF form being completed in its entirety including all attachments. Questions or comments concerning this form may be directed to the Water Quality Division's Application Review and Processing Team by email at WQ-ARPTeam@tceq.texas.gov or by phone at (512) 239-4671.

The following applies to all applications:

1. Permittee: Jimmy Edwin Cole, Jr.

Permit No. WQ00 15838001EPA ID No. TX 0139726

Address of the project (or a location description that includes street/highway, city/vicinity, and county):

23520 Sharp Road, Montgomery, Montgomery County, TX 77356

Provide the name, address, phone and fax number of an individual that can be contacted to answer specific questions about the property.

Prefix (Mr., Ms., Miss): Ms.

First and Last Name: Shelley Young

Credential (P.E, P.G., Ph.D., etc.): P.E.

Title: Engineer

Mailing Address: 17230 Huffmeister Road, Suite A

City, State, Zip Code: Cypress, TX 77429

Phone No.: 281-373-0500 Ext.: Click here to enter text Fax No.: 281-373-1113

E-mail Address: syoun@waterengineers.com

2. List the county in which the facility is located: Montgomery
3. If the property is publicly owned and the owner is different than the permittee/applicant, please list the owner of the property.

N/A

4. Provide a description of the effluent discharge route. The discharge route must follow the flow of effluent from the point of discharge to the nearest major watercourse (from the point of discharge to a classified segment as defined in 30 TAC Chapter 307). If known, please identify the classified segment number.

From the plant site to an unnamed tributary of Little Lake Creek; thence to Little Lake Creek; thence to Lake Conroe in Segment No. 1012 of the San Jacinto River Basin.

5. Please provide a separate 7.5-minute USGS quadrangle map with the project boundaries plotted and a general location map showing the project area. Please highlight the discharge route from the point of discharge for a distance of one mile downstream. (This map is required in addition to the map in the administrative report).

Provide original photographs of any structures 50 years or older on the property.

Does your project involve any of the following? Check all that apply.

- ☐ Proposed access roads, utility lines, construction easements
- ☐ Visual effects that could damage or detract from a historic property's integrity
- ☐ Vibration effects during construction or as a result of project design
- ☐ Additional phases of development that are planned for the future
- ☐ Sealing caves, fractures, sinkholes, other karst features

☐ Disturbance of vegetation or wetlands

1. List proposed construction impact (surface acres to be impacted, depth of excavation, sealing of caves, or other karst features):

Construction is currently underway. No additional construction is proposed.

2. Describe existing disturbances, vegetation, and land use:

See No. 1 above

THE FOLLOWING ITEMS APPLY ONLY TO APPLICATIONS FOR NEW TPDES PERMITS AND MAJOR AMENDMENTS TO TPDES PERMITS

3. List construction dates of all buildings and structures on the property:

N/A- renewal

4. Provide a brief history of the property, and name of the architect/builder, if known.

N/A- renewal

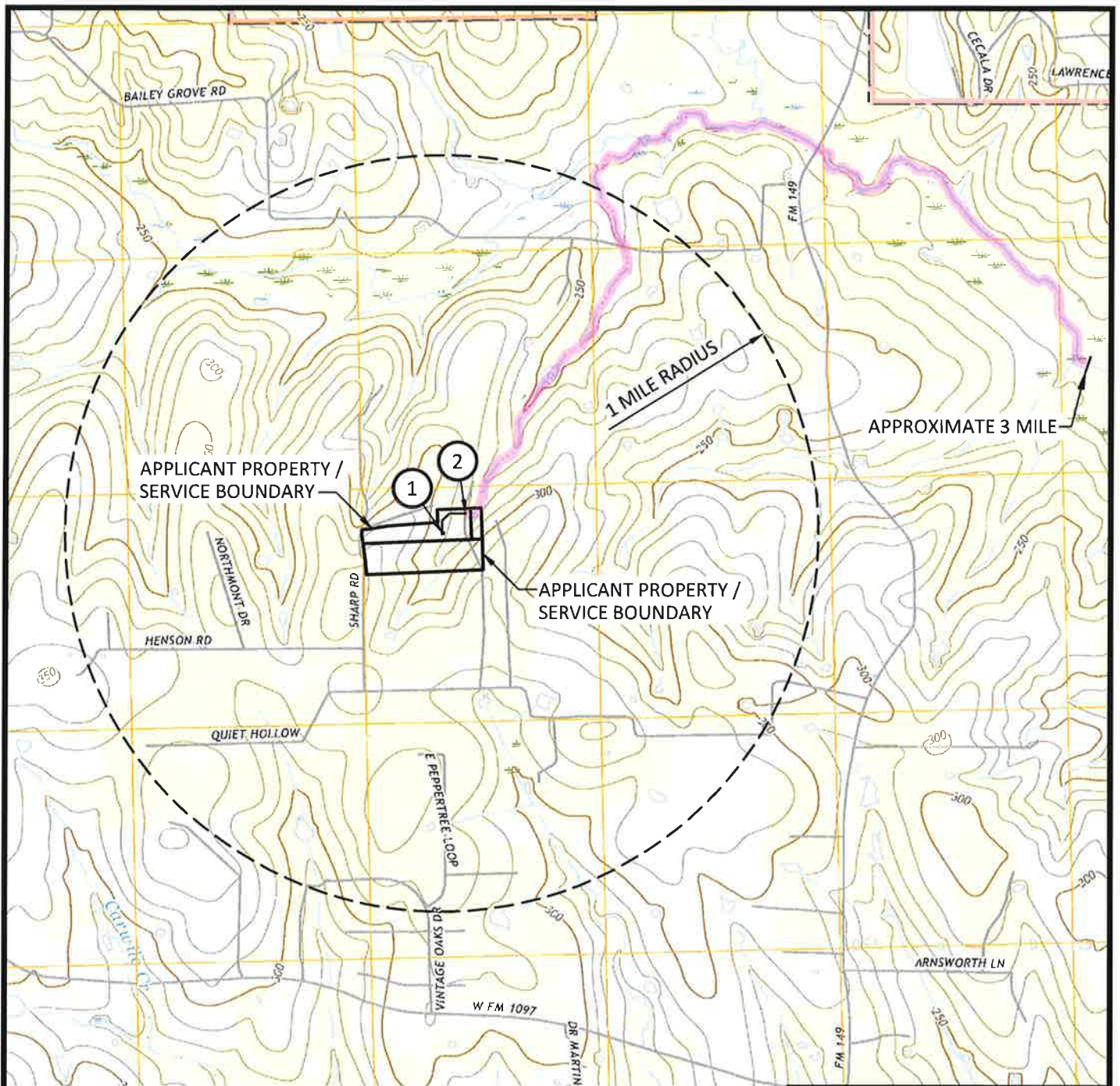

LEGEND

- 1 APPLICANT'S WASTEWATER TREATMENT PLANT
- 2 POINT OF DISCHARGE

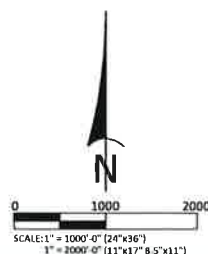

THIS DRAWING CONTAINS CONFIDENTIAL PROPRIETARY INFORMATION AND MAY NOT BE TRANSFERRED, REPRODUCED, OR USED TO CONSTRUCT ANY PROJECT OTHER THAN THAT FOR WHICH IT WAS ISSUED WITHOUT PRIOR PERMISSION FROM WATERENGINEERS, INC.

WATERENGINEERS, INC.
 Water & Wastewater Treatment Consultants
 TEXAS BOARD OF PROFESSIONAL ENGINEERS FIRM No. 2066
 17230 HUFFMEISTER ROAD TEL: 281-373-0500
 CYPRESS, TEXAS 77429 FAX: 281-373-1113

JIMMY EDWIN COLE, JR - APPLICANT
 JIMMY COLE RENTALS WWTP
 APPLICATION FOR RENEWAL WITH MINOR
 AMENDMENT TO TPDES PERMIT No.
 WQ00015838001

USGS MAP

DRAWN BY: BIR

APPROVED BY: SBY

SCALE: AS NOTED

DATE: 11/11/2024

JOB No.: 5913-24183

DWG. NO.:

ADMIN.09-1

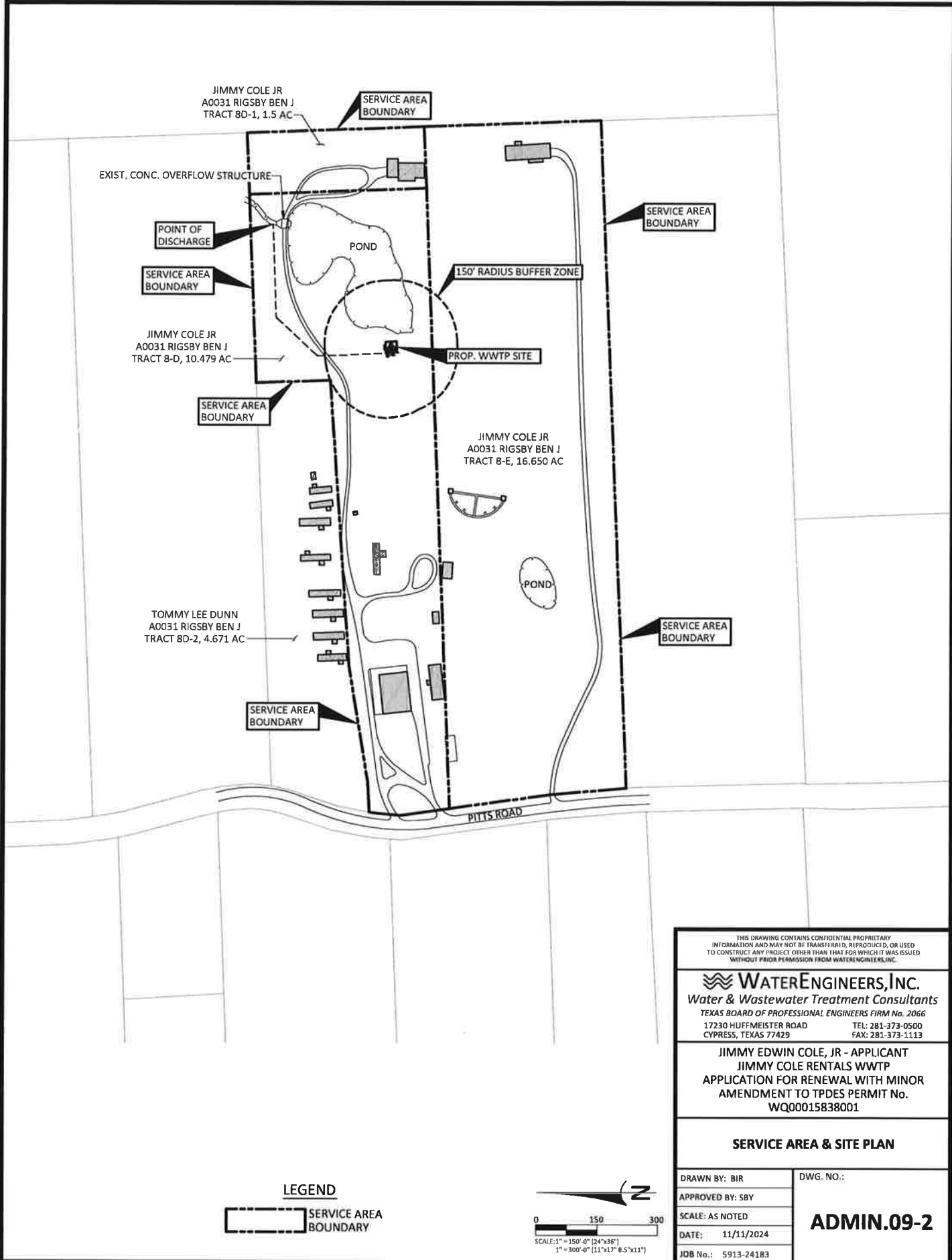

LEGEND

 SERVICE AREA BOUNDARY

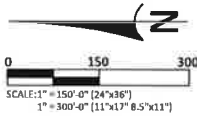

THIS DRAWING CONTAINS CONFIDENTIAL PROPRIETARY INFORMATION AND MAY NOT BE TRANSFERRED, REPRODUCED, OR USED TO CONSTRUCT ANY PROJECT OTHER THAN THAT FOR WHICH IT WAS ISSUED WITHOUT PRIOR PERMISSION FROM WATERENGINEERS, INC.

WaterEngineers, Inc.
Water & Wastewater Treatment Consultants
TEXAS BOARD OF PROFESSIONAL ENGINEERS FIRM No. 2066
17230 HUFFMEISTER ROAD TEL: 281-373-0500
CYPRESS, TEXAS 77429 FAX: 281-373-1113

JIMMY EDWIN COLE, JR - APPLICANT
JIMMY COLE RENTALS WWTP
APPLICATION FOR RENEWAL WITH MINOR
AMENDMENT TO TPDES PERMIT No.
WQ00015838001

SERVICE AREA & SITE PLAN

DRAWN BY: BIR
APPROVED BY: SBY
SCALE: AS NOTED
DATE: 11/11/2024
JOB No.: 5913-24183

DWG. NO.:

ADMIN.09-2

\\water\enr\cad\current\jacob\9313-24183 cole mlp gskt renewal 24\ADMIN.09-2 ADMIN.03.dwg

ATTACHMENT TECH.02

Process Flow Diagram

(Reference Technical Report Page 2, Question 2c)

DISCHARGE PIPE
TO UNKNOWN TRIBUTARY
TO LITTLE LAKE CREEK

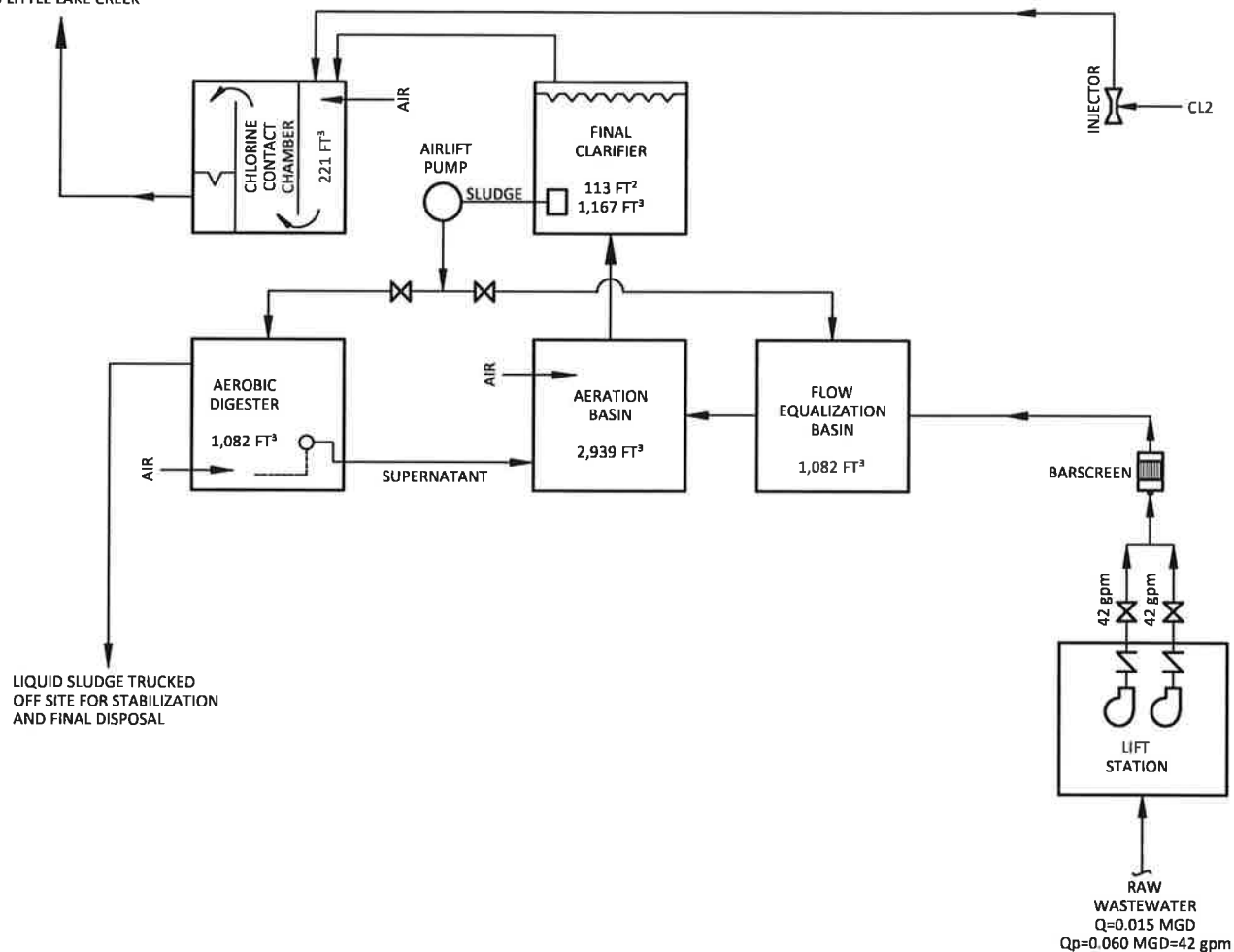

LIQUID SLUDGE TRUCKED
OFF SITE FOR STABILIZATION
AND FINAL DISPOSAL

THIS DRAWING CONTAINS CONFIDENTIAL PROPRIETARY
INFORMATION AND MAY NOT BE TRANSFERRED, REPRODUCED, OR USED
TO CONSTRUCT ANY PROJECT OTHER THAN THAT FOR WHICH IT WAS ISSUED
WITHOUT PRIOR PERMISSION FROM WATERENGINEERS, INC.

WATERENGINEERS, INC.
Water & Wastewater Treatment Consultants
TEXAS BOARD OF PROFESSIONAL ENGINEERS FIRM No. 2066
17230 HUFFMEISTER ROAD TEL: 281-373-0500
CYPRESS, TEXAS 77429 FAX: 281-373-1113

JIMMY EDWIN COLE, JR - APPLICANT
JIMMY COLE RENTALS WWTP
APPLICATION FOR RENEWAL WITH MINOR
AMENDMENT TO TPDES PERMIT No.
WQ00015838001

FLOW SCHEMATIC

DRAWN BY: BIR

APPROVED BY: SBY

SCALE: AS NOTED

DATE: 11/11/2024

JOB No.: 5913-19051

DWG. NO.:

TECH.02

ATTACHMENT TECH.03

Site Drawing

(Reference Technical Report Page 2, Question 3)

(Including Wind Rose)

(Reference Technical Report Page 23, Question 7)

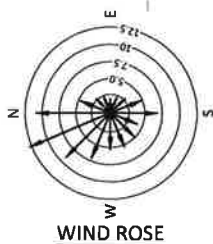
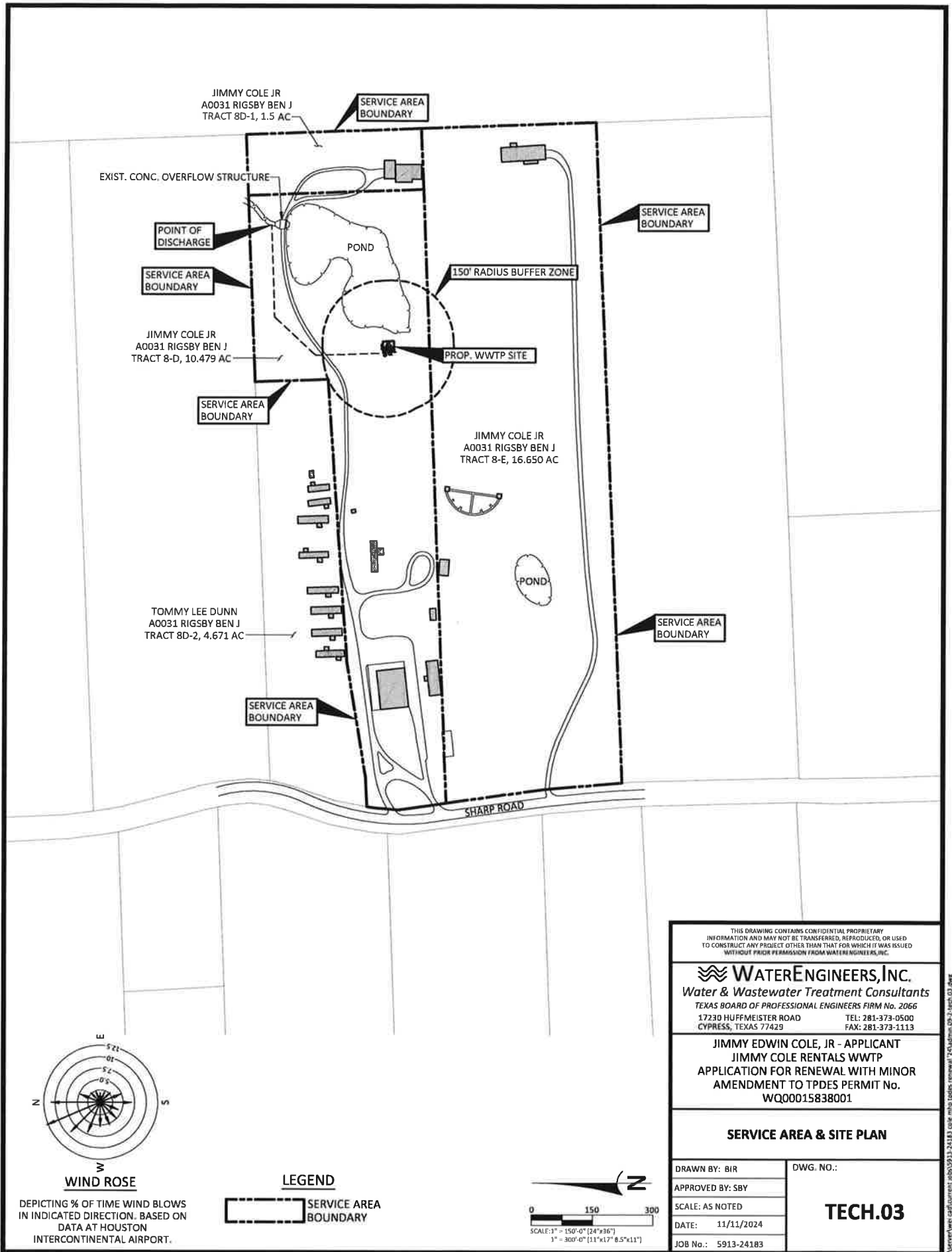

WIND ROSE

DEPICTING % OF TIME WIND BLOWS IN INDICATED DIRECTION. BASED ON DATA AT HOUSTON INTERCONTINENTAL AIRPORT.

LEGEND

 SERVICE AREA BOUNDARY

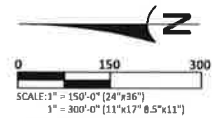

THIS DRAWING CONTAINS CONFIDENTIAL PROPRIETARY INFORMATION AND MAY NOT BE TRANSFERRED, REPRODUCED, OR USED TO CONSTRUCT ANY PROJECT OTHER THAN THAT FOR WHICH IT WAS ISSUED WITHOUT PRIOR PERMISSION FROM WATERENGINEERS, INC.

WaterENGINEERS, Inc.
Water & Wastewater Treatment Consultants
TEXAS BOARD OF PROFESSIONAL ENGINEERS FIRM No. 2066
17230 HUFFMEISTER ROAD TEL: 281-373-0500
CYPRESS, TEXAS 77429 FAX: 281-373-1113

JIMMY EDWIN COLE, JR - APPLICANT
JIMMY COLE RENTALS WWTP
APPLICATION FOR RENEWAL WITH MINOR
AMENDMENT TO TPDES PERMIT No.
WQ00015838001

SERVICE AREA & SITE PLAN

DRAWN BY: BIR	DWG. NO.:
APPROVED BY: SBY	
SCALE: AS NOTED	
DATE: 11/11/2024	
JOB No.: 5913-24183	

TECH.03

\\server\new\cadd\project\5913-24183\cadd\mwp\spdes\renewal\24183mwp-03.dwg

Your transaction is complete. Thank you for using TCEQ ePay.

Note: It may take up to 3 working days for this electronic payment to be processed and be reflected in the TCEQ ePay system. Print this receipt and the vouchers for your records. An email receipt has also been sent.

Transaction Information

Trace Number: 582EA000636659

Date: 12/03/2024 09:46 AM

Payment Method: ACH - Authorization 0088975874

ePay Actor: JIMMY COLE

Actor Email: jcoleelectric@yahoo.com

IP: 76.142.8.62

TCEQ Amount: \$3,198.06

Texas.gov Price: \$3,198.06*

* This service is provided by Texas.gov, the official website of Texas. The price of this service includes funds that support the ongoing operations and enhancements of Texas.gov, which is provided by a third party in partnership with the State.

Payment Contact Information

Name: JIMMY COLE

Company: JIMMY EDWIN COLE

Address: 10502 COMMERCE ROW SUITE 300, MONTGOMERY, TX 77356

Phone: 936-537-8291

Cart Items

Click on the voucher number to see the voucher details.

Voucher	Fee Description	AR Number	Amount
733556	CONSOLIDATED WATER QUALITY FEE (WWI + WQA)	23007648	\$3,198.06
TCEQ Amount:			\$3,198.06

[ePay Again](#)[Exit ePay](#)

Note: It may take up to 3 working days for this electronic payment to be processed and be reflected in the TCEQ ePay system. Print this receipt for your records.

Jon Niermann, *Chairman*
Bobby Janecka, *Commissioner*
Catarina R. Gonzales, *Commissioner*
Kelly Keel, *Executive Director*



TEXAS COMMISSION ON ENVIRONMENTAL QUALITY

Protecting Texas by Reducing and Preventing Pollution

December 13, 2024

CERTIFIED MAIL

Ms. Shelley Young, P.E.
Engineer
WaterEngineers, Inc.
17230 Huffmeister Road, Suite A
Cypress, Texas 77429

Re: Application to Renew Permit No. WQ0015838001 (EPA I.D. TX0139726)
Issued to Jimmy Edwin Cole, Jr.
CN605724418, RN110898053

Dear Ms. Young:

Our records indicate that we have not received a complete response to the Notice of Deficiency email sent November 25, 2024. The complete response to the Notice of Deficiency was due no later than December 9, 2024.

Applicants are required to respond to the Notice of Deficiency in a timely manner and failure to do so will result in the return of the permit application. If the complete response is not received within 30 days from the date of this letter, the permit application will be removed from our list of pending applications and the permit will be allowed to expire on May 26, 2025. If you have submitted your response to our requests for information, please disregard this letter.

This is the final notice that will be sent requesting information to administratively complete the application. Please mail a complete response and two copies to the attention of Ms. Francesca Findlay. If you have any questions, please do not hesitate to call me at (512) 239-2191.

Sincerely,

A handwritten signature in cursive script, reading "Erika Crespo".

Erika Crespo, Assistant Deputy Director
Water Quality Division

EC/em

Francesca Findlay

From: Erwin Madrid
Sent: Friday, December 13, 2024 12:28 PM
To: Shelley Young
Cc: Francesca Findlay
Subject: Application for Permit No. WQ0015838001 – Notice of Deficiency 30-Day Will Return Letter
Attachments: WQ0015838001_Will Return Ltr.pdf
Importance: High

Dear applicant,

The attached Notice of Deficiency 30-Day Will Return Letter was mailed on **December 13, 2024**, requesting additional information needed to declare the application administratively complete. Please mail an original and two copies (with a cover letter) of the complete response by **January 12, 2025**.

Regards,

Erwin Madrid
Team Lead
ARP Team | Water Quality Division
512-239-2191
Texas Commission on Environmental Quality



Please consider whether it is necessary to print this e-mail.

Francesca Findlay

From: Shelley Young <syoung@waterengineers.com>
Sent: Monday, December 16, 2024 9:48 AM
To: Francesca Findlay
Cc: Erwin Madrid
Subject: RE: WQ0015838001 Jimmy Edwin Cole, Jr.
Attachments: municipal-discharge-renew-spanish-nori.docx; TCEQ Payment.pdf

Hi Francesca,

My apologies for the delay in responding. Please find attached the Spanish version of the NORI and proof that fees have been paid.

The portion of the NORI included in your letter has one small error. In line 7 the word "to" in there twice.

Regards,
Shelley

Shelley B. Young, P.E.
WaterEngineers, Inc.
17230 Huffmeister Rd.
Cypress, TX ~ 77429
tel: 281-373-0500
fax: 281-373-1113
www.waterengineers.com

The contents of this e-mail and any attachment(s) are confidential, and the property of WaterEngineers, Inc.

From: Francesca Findlay <Francesca.Findlay@tceq.texas.gov>
Sent: Monday, November 25, 2024 2:01 PM
To: Shelley Young <syoung@waterengineers.com>
Subject: FW: WQ0015838001 Jimmy Edwin Cole, Jr.

Dear Ms. Young:

The attached Notice of Deficiency letter sent on November 25, 2024, requesting additional information needed to declare the application administratively complete. Please send the complete response to my attention December 9, 2024.

Thank you,

Francesca Findlay
License & Permit Specialist
ARP Team | Water Quality Division
512-239-2441
Texas Commission on Environmental Quality



Please consider whether it is necessary to print this e-mail

How is our customer service? Fill out our online customer satisfaction survey at <http://www.tceq.texas.gov/customersurvey>.

Erwin Madrid

From: Erwin Madrid
Sent: Friday, December 13, 2024 12:28 PM
To: Shelley Young
Cc: Francesca Findlay
Subject: Application for Permit No. WQ0015838001 – Notice of Deficiency 30-Day Will Return Letter
Attachments: WQ0015838001_Will Return Ltr.pdf
Importance: High

Dear applicant,

The attached Notice of Deficiency 30-Day Will Return Letter was mailed on **December 13, 2024**, requesting additional information needed to declare the application administratively complete. Please mail an original and two copies (with a cover letter) of the complete response by **January 12, 2025**.

Regards,

Erwin Madrid
Team Lead
ARP Team | Water Quality Division
512-239-2191
Texas Commission on Environmental Quality



Please consider whether it is necessary to print this e-mail.